

DA4832MC

DA4832MC-NB

Nominal Dimension:48W*6.6D*32H inches

- Durable solid popular wood frame
- Anti-fog glass
- 1 soft-close door
- Recess mount installation
- 4 wood shelves outside
- 3 adjustable glass shelves inside
- Metal alloy hardware with decorative porcelain
- Austria BLUM soft-close hinges system

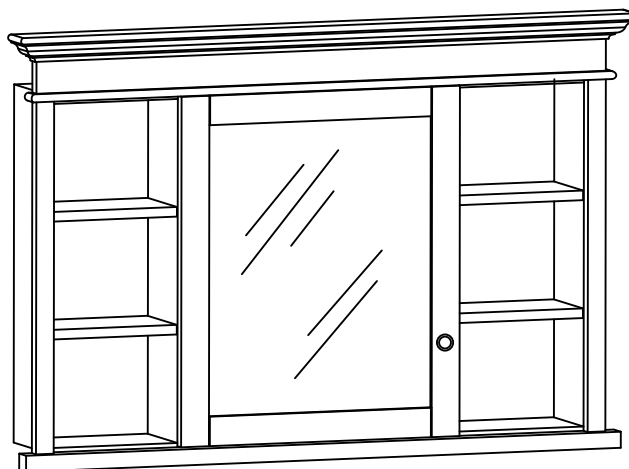

Technical drawing of the front elevation of the 'L' model cabinet. The drawing shows a symmetrical design with a central glass-paned door and two side doors. Dimensions are provided in inches and centimeters.

Overall Dimensions:





- Overall Width: 1220 (48.0")
- Overall Height: 813 (32.0")

Door and Panel Dimensions:

- Central Glass Door Height: 155 (6.1")
- Central Glass Door Width: 154 (6.0")
- Side Door Height: 202 (8.0")
- Side Door Width: 253 (10.0")
- Base Width: 1175 (46.3")

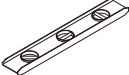
Technical drawing of the interior of a cabinet. The drawing shows a rectangular interior with a central section divided into three horizontal compartments by two horizontal dashed lines. The left and right sides of the interior are each divided into three vertical compartments by solid lines. The overall width of the interior is labeled as 1175 (46.3") at the bottom. The overall height of the interior is labeled as 813 (32.0") on the left side. The overall width of the cabinet, including the side panels, is labeled as 1220 (48.0") at the top. The drawing is a black and white line drawing with dashed lines indicating the internal divisions.

SUGGESTED TOOLS AND MATERIALS:

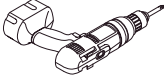

Electrical Drill1/8" Drill BitPencilPhillips ScrewdriverTape MeasureLevelSafety Glasses

INSTALLATION INSTRUCTLONS

We recommend consulting a professional if you are unfamiliar with installing bathroom fixtures and plumbing .We accept accepts no liability for any damage to the floor,medicine cabinet, vanity cabinet, sink,counter top,or personal injury during installation.

PART LIST:



SCREW WALL PLUG SCREW CAP SCREW CAP COVER SHELF CLIP GLASS SHELF



NOTE: Determine overall mirror dimensions before installation.
Requires two(2) person in installation.

Accessories and parts may vary from the picture above.Depends on the product model and size.

Recess Mount Installation

1 PREPARING THE INSTALLATION LOCATION



NOTE: Before installing, make sure all parts are present. Compare parts with the Hardware included list. If any part is missing or damaged,do not attempt to install the product.

- Determine placement and mark an opening 1/2 in. taller and wider than the cabinet (1).
- Cut along the center of the wall studs (2).

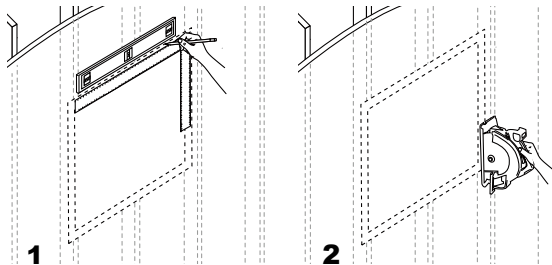

2 INSTALLING THE CABINET

- Secure the sill plate and header with nails (1).
- Insert the cabinet into the opening (2).

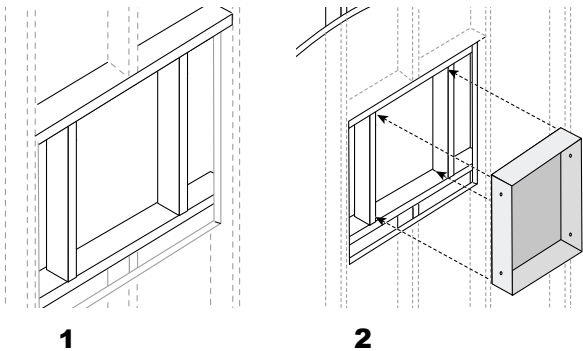

3 SECURING THE CABINET TO THE WALL

- Secure the cabinet to the wall through the sides with screws.

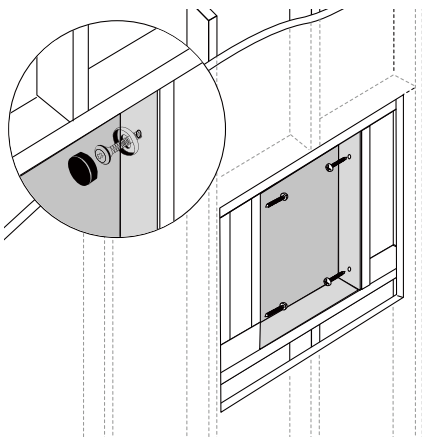

4 INSTALLING THE SHELVES

- Insert the shelf clips (A) into the holes on the left side of the cabinet. Repeat on the right side (B).
- Rest the glass shelves(C) on the shelf clips(A&B), then simultaneously press downward on both ends to securely fit the glass shelf into the shelf clips.

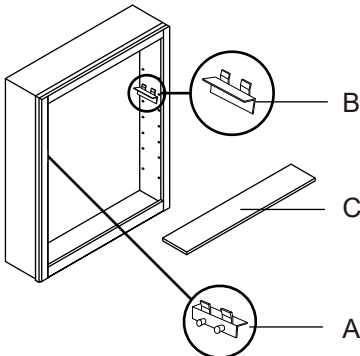

* No need to take off the door(s) before adjusting cabinet shelves.

Note: cabinet size, style and shape may vary from the picture above.Instructiona purpose only