

Series	Elite Workstation
Material	16 Gauge, Type 304 stainless steel
Installation Type	Top mount
Configuration	Double bowl
Finish	Satin brushed finish
Overall Dimensions	33" x 22"
Bowl Dimensions	14 1/2" x 16" x 10"
Drain Size	3 5/8"
Finish Available	Stainless Steel
Minimum cabinet size	36"
Template Included	Yes
Clips Included	Yes
Drain Location	Rear
Accessories Included	Strainer (x2), Bottom grid (x2), Drying rack and Cutting board



ACCESSORY
Strainer - L-1 x2
Bottom Grid - GR-3234 x2
Cutting Board - CB1711SW
Drying Rack - DR1713

MODEL	FINISH
WST-28-PK1	Stainless Steel

Stocked Color Options



Stainless Steel

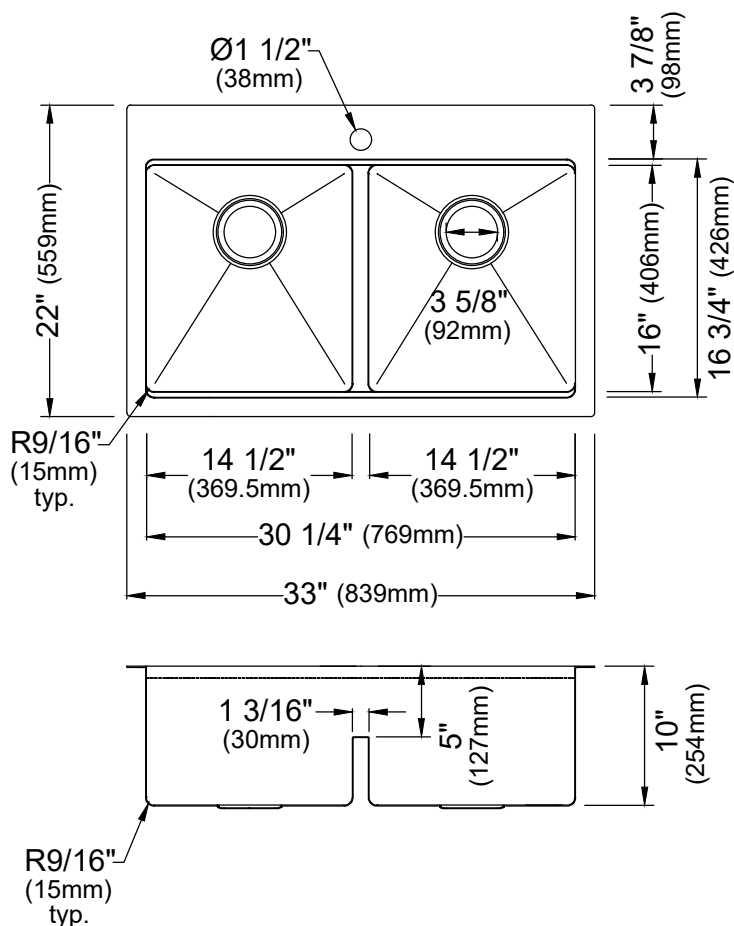

Listing and certifications:
cUPC

Limited lifetime warranty