

HISENSE REFRIGERATOR



HRS290P5FSE

Pureflat Infinite Series
Standard Depth Side-by-Side Refrigerator

- Ultra Capacity 29.1 cu.ft
- Ultra Tall Ice & Water Dispenser
- In-Door Ice Maker
- Vertical Metal Recessed Handle
- Surround LED Lighting (Ceiling & Side)
- Adjustable Gallon Door Storage

AVAILABLE COLORS



PERFORMANCE	
Refrigerator (cu. ft.)	18.6
Freezer (cu. ft.)	10.5
Total Capacity (cu. ft.)	29.1
ENERGY STAR® Certified	No
Energy Consumption (kWh/Year)	748
Safety Listing	UL Safety Listing
ICE & WATER SYSTEM	
Ice and Water Dispenser Type	Both
Ice / Water Location	External Dispenser
Dispenser Light	Yes
Ice Maker	Single in Freezer
Ice type	Cubed/ Crushed
Space-Saving In-Door Ice	Yes
Daily Ice Production	3.0 lbs
Ice Storage Capacity	5.0 lbs
Removable Ice Bin	Yes
Water Filtration	Yes
Filter Model	HX2019F-A
Water Inlet Pressure	207~700kPa
COOLING SYSTEM	
Temperature Sensors	3
Compressor Type	Durable Inverter
Refrigerant (Type and Volume)	R600a/2.47oz(70g)
Multi Air Flow Cooling	Yes
Evaporator	1
CONVENIENCE	
Display Type	External/ Membrane / White LED
Temperature Controls	Electronic/ Digital
Door Alarm	Yes
Child Safety Lock	Yes
Auto Closing Door Hinge	Yes
Leveling Legs	Yes
ADA Compliant	No
Sabbath Mode	Yes
Demo Mode	Yes
Gallon Door Storage	Yes
Noise Level (dB)	43

REFRIGERATOR	
Temperature Range (°F)	34°F~44°F
Door Type	Side Swing
No. of Shelves	3 Glass
Cantilevered Shelves	Inner Case Supported Type
Shelf Construction	Tempered Glass
Shelf Trim	White Décor
No. of Crisper Drawers	2
LED Lighting	Yes (Ceiling & Side)
No. of Door Bins	4(Gallon)
Door Bin Construction	1 Piece (Clear)
FREEZER	
Temperature Range (°F)	-11°F~7°F
Door Type	Side Swing
No. of Shelves	4 Glass
Cantilevered Shelves	Inner Case Supported Type
Shelf Construction	Tempered Glass
Shelf Trim	White Décor
No. of Freezer Drawers	1
LED Lighting	Yes (Ceiling LED)
No. of Door Bins	2
Door Bin Construction	1 Piece (Clear)
Ice Bin / In-Door Ice	Ice Maker & Ice Bin in Door
MATERIALS AND FINISHES	
Fingerprint-Resistant Door	Yes
Door Style	Flat
Door Texture	Smooth
Available Door Colors	Stainless Steel
Handle Type	Integrated
Hidden Hinges	Yes
Toe Grille	No
Reversible Door	No
Cabinet Color	Grey
Inner Liner Color	White

INSTALLATION DIMENSION	
Product (W x H x D)	35.9*70.3*34.0"
Width (Excluding Door)	35.8"
Width (Including Door)	35.9"
Common Width	36.0"
Width (Door Open 90° Excluding Handle)	39.9"
Width (Door Open 90° Including Handle)	39.9"
Width (Door Fully Open Excluding Handle)	61.4"
Depth (Excluding Handles)	34.0"
Depth (Including Handles)	34.0"
Depth (Less Door)	29.5"
Depth (to Hinge Cover)	22.0"
Depth (Door Open 90°)	57.8"
Depth Type	Standard Depth
Height (to Top of Hinge)	70.3"
Height (to Top of Door)	70.3"
Height (to Top of Case)	70.0"
Installation Clearance	Sides 1/2", Top 1/2", Back 2"
Carton (W x H x D)	38.2*75.3*36.7"
Weight (Unit/ Carton)	236lbs./ 258lbs.
INSTLIMITED WARRANTY	
Warranty	2-year limited
Parts & Labor	2 Years
Sealed System (Parts & Labor)	5 Years
Accessories	90 Days for Parts
UPC CODES	
HRS290P5FSE (Fingerprint-Resistant Stainless Steel)	810088367274

HISENSE REFRIGERATOR

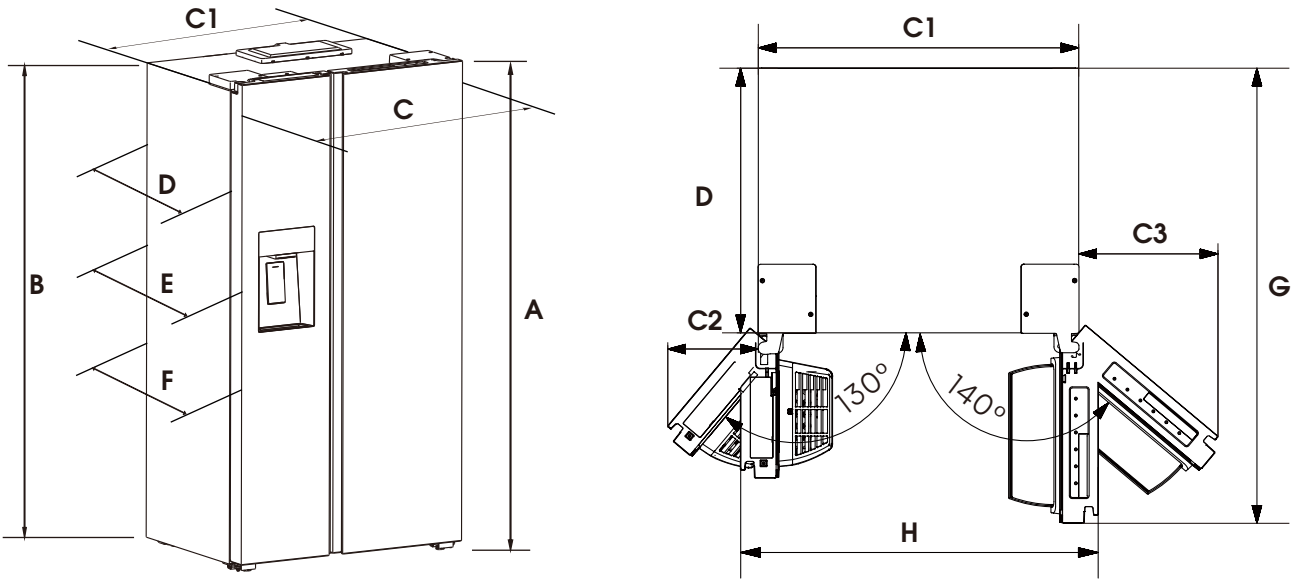

Model	Capacity	Height-with Overall "A"	Height-with Cabinet "B"	Width-with Door "C"	Width-with Cabinet "C1"	Depth-with Cabinet "D"	Depth-with Handle "E"	Depth-with Door "F"	Width-Door Open 130° "C2"	Width-Door Open 140° "C3"	Width-Door Open 90° "H"	Depth-Door Open 90° "G"
HRS290P5FSE	29.1 cu.ft	70.3" (1785mm)	70.0" (1778mm)	35.9" (912mm)	35.8" (908mm)	29.5" (750mm)	34.0" (864mm)	34.0" (864mm)	10.1" (257mm)	15.6" (395mm)	39.9" (1013mm)	57.8" (1290mm)
HRS290P5FBE	29.1 cu.ft	70.3" (1785mm)	70.0" (1778mm)	35.9" (912mm)	35.8" (908mm)	29.5" (750mm)	34.0" (864mm)	34.0" (864mm)	10.1" (257mm)	15.6" (395mm)	39.9" (1013mm)	57.8" (1290mm)
HRS290P5FWE	29.1 cu.ft	70.3" (1785mm)	70.0" (1778mm)	35.9" (912mm)	35.8" (908mm)	29.5" (750mm)	34.0" (864mm)	34.0" (864mm)	10.1" (257mm)	15.6" (395mm)	39.9" (1013mm)	57.8" (1290mm)

LOCATION REQUIREMENTS



To ensure proper ventilation for your refrigerator, allow for a 1/2"(12mm) space on each side and at the top. Allow at least 2.0"(51mm) between back of cabinet and the wall. If your refrigerator has an ice maker, allow extra space at the back for the water line connections.

If you are installing your refrigerator next to a fixed wall, leave 1.6"(40mm) minimum on the hinge side (some models require more) to allow for the door to swing open.

NOTE: This refrigerator is intended for use in a location where the temperature ranges from a minimum of 55F(13°C) to a maximum of 110°F(43°C).