

All Style Industries, LLC

2114 Sunset Vista Avenue Henderson, NV 89052

702-570-5520 or fax 702-754-2597

"mailto:info@stormcollar.com" www.spinflashing.com, or www.stormcollar.com

U.S. Patents 659156181, 664050381 and #7,770,335

Installation Instructions: Steep Slope Roofing

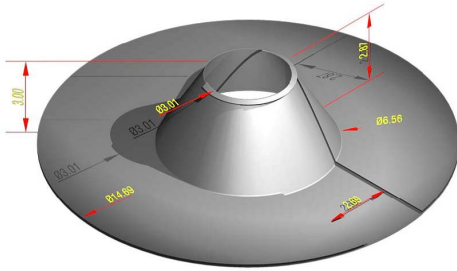

Please review the following installation instructions to receive the fine quality you expect when installing an All Style Retro-Spin Flashing.

One Retro-Spin Flashing Kit Includes:

1. One (1) Retro-Spin® Flashing assembly with tightly fitted interior, and exterior, impact extruded galvanized steel roof jacks.

Tools & Other Building Materials Required for Kit Installation:

1. One Hammer
2. (4) Four galvanized barbed shank roofing nails with 3/8" to 7/16" inch diameter flat heads.
3. Paintable Caulking for roof slopes under 3" & 12".
4. Spray Paint (optional)

Application of Retro-Spin:

A Retro-Spin Flashing allows installation of a new roof jack flashing around roof penetrations that are fixed. An example is an electric service mast. These fixed penetrations may not allow for a standard slide-on-from-the-top flashing installation. Retro-Spin Flashing allows for a flashing installation from the side.

Apply the roofing up to the roof penetration. Notch, or cut a hole, in the roofing material to allow the installation of the roofing product to the centerline of the roof penetration. Do not install the roofing material further than the penetration. Use the roofing materials manufacturer's recommendations for installing the roof up to and around roof penetrations.

Arrange the Retro-Spin Flashing so the interior and exterior flashings provide an open door to the center of the flashing. The cut-out slots will be in alignment.

Installation Instructions

Retro-Spin Flashing 2 of 2

Move the Retro-Spin Flashing to the roof penetration on the down slope side of the penetration. Pass the penetration, uphill, and inside the Retro-Spin Flashing. After the roof penetration is within the confines of the Spin-flashing, rotate the assembly 180 degrees. The action of rotation closes the door and surrounds the penetration. The doors should be on opposite sides of the flashing assembly with top cut out facing down slope.

If the cut out is facing up-Slope rotate the assembly so the flashing faces down slope. Never install the Retro-Spin flashing with the top door cut out facing up hill.

Center the Retro-Spin flashing on the roof penetration. With the door closed, and the assembly at 180 degrees face the door in the direction of the **down slope** of the roof deck. If the roof slope is greater to or equal to 3" and 12", no sealant or caulking is required at the closed door. On roof slopes below 3" and 12", inject a small amount of paintable caulking between the inside and outside flashings. On dead flat applications, solder shut the open door to create a watertight condition.

Now use the manufacturer's recommended procedures for installing a roof jack flashing into the steep slope-roofing product, and securely nail the Retro-Spin Flashing into place using 3/8" flat head roofing nails. Use nails long enough to penetrate through the Retro-Spin Flashing and into the roof deck a minimum of 3/4". Pre-punched nail holes provide placement guides for the fasteners.

Continue the installation of the roof system. Apply paint to the Retro-Spin flashing to match roof color and protect the metal.

All Retro-Spin Flashings include a 3" diameter opening, and since not all roof penetrations fit snugly, it is necessary to counter flash the penetration using a waterproof EPDM Retro-Split Storm Collar.