

LARGE STORAGE CABINET

installation instructions

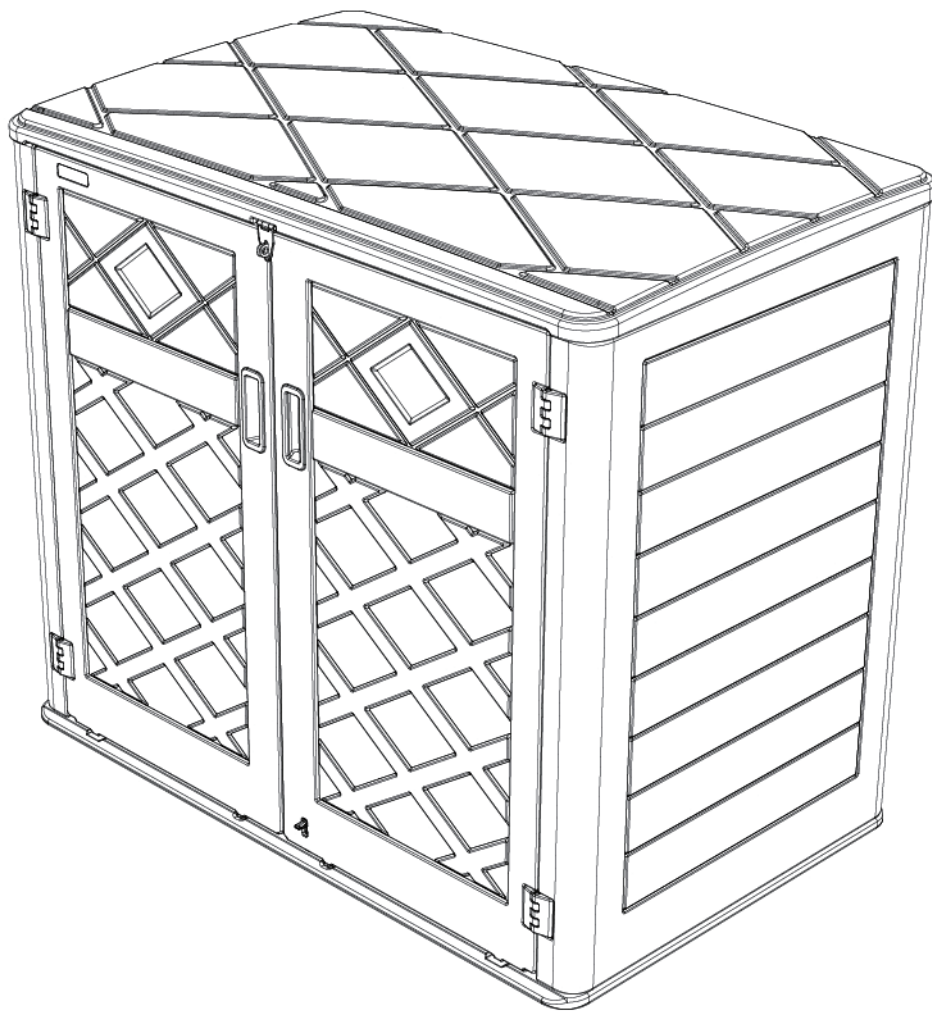

ABOUT PRODUCT ASSEMBLY

Do not assemble the storage shed on severe cold or strong windy days.

We would advise 2 person to assist in the assembly of the storage shed to secure parts in place.

Please check your package according to the PARTS LIST in the instructions to ensure that there are no missing or damaged before you starting assembly, kindly contact us if you find any wrong.

Please read instructions thoroughly prior to assembly, assemble all the parts according to the directions in this instructions, do not skip and steps

Our company provides extra hardware for use as spare parts for customer convenience. **Please save the spare parts.**

We would kindly advise you to follow the instructions in the manual to install, wrong assembly methods can result in damage to the inside of the hole to create links between the panels loose or unable to assembled properly.

LEVEL THE GROUND SURFACE

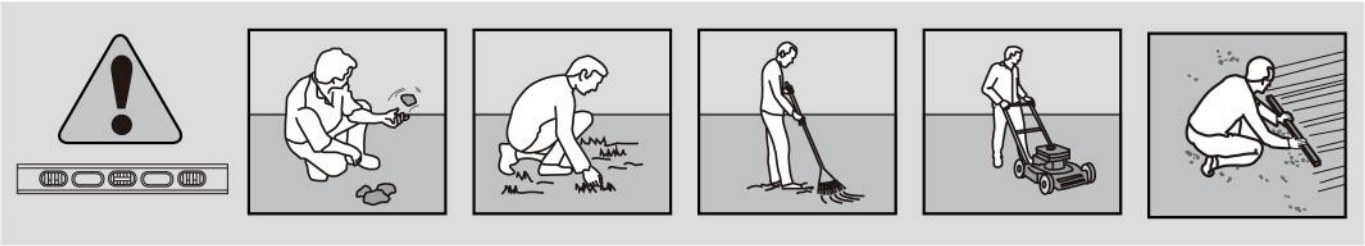

Level the ground surface before unpacking parts and beginning assembly.

TOOLS REQUIRED



Screwdriver

PARTS NUMBER POSITION

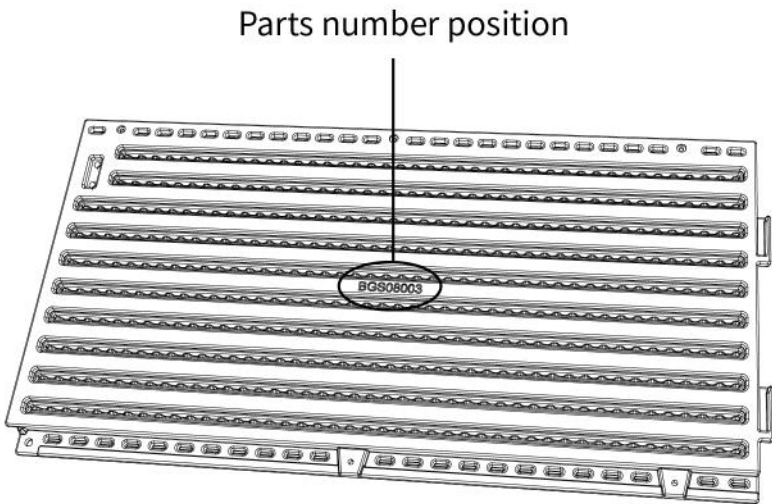

ABOUT PRODUCT MAINTENANCE

This storage shed should be far away from the open flame.

Do not use the storage shed in extreme weather conditions.

Do not stack more than 20 kg items on the storage shed roof all the time in case deformation of the roof.

At regular check the storage shed to ensure that it's stable and assembly integrity has been maintained.

Please keep doors closed and locked outdoor when the storage shed is not in use long time to prevent wind damaged or damaged by animals or bad people.

Do not store hot items(recently used grills, blowtorches etc.),flammable or caustic chemicals in the storage shed.

Wash the storage shed with a mild soap and water if there is any stain on the storage shed. Do not use a stiff brush,bleach,ammonia or any other caustic cleaners, as these may damage the storage shed or could result in permanent staining of the plastic.This is not manufacturing defect and is not covered under warranty.

If the environment permits, install the storage shed in a cool place, as prolonged exposure to direct sunlight may deform the panel and accelerate aging.

Parts List

A Carton

No.	Parts No.	Name	Material	Quantity	Specifications
1	BGS08001	Floor	HDPE	1	53*33.15*1.1 (inches)
2	BGS08008	Roof	HDPE	1	53.15*32.95*2.3 (inches)

B Carton

No.	Parts No.	Name	Material	Quantity	Specifications
3	BGS08002	Left back panel	HDPE	1	45.67*25*0.98 (inches)
4	BGS08003	Right back panel	HDPE	1	45.67*23.54*0.98 (inches)
5	BGS08004	Left side panel	HDPE	1	46.06*32.28*4.37 (inches)
6	BGS08005	Right side panel	HDPE	1	46.06*32.28*4.37 (inches)
7	BGS08006	Left door	HDPE	1	43.31*25.12*1.5 (inches)
8	BGS08007	Right door	HDPE	1	43.31*25.12*1.5 (inches)
9	GS0201014	Hinge assembly	Plastic	7	69.9x37.4x25 (mm)
10	GS0201015	L hinge folding assembly	Metal	1	35x25x15.5 (mm)
11	GS0201016	L-1	Metal	1	36.5x20x15.5 (mm)
12	GS0201017	L-2	Metal	1	36.5x20x20 (mm)
13	GS0201018	Latch-1	Metal	1	60.8x40x15 (mm)
14	GS0201019	Latch-2	Metal	1	87.9x42.04x12.8 (mm)
15	BGS08009	Support rod	Metal	1	580xΦ8
16	GS0201021	Support rod fixing piece	Metal	1	38x16x1.5 (mm)
17	Y202327	Large flat head cross bolt	Metal	8	M6x10 (mm)
18	GS0201028	Strengthen the block	Metal	14	58x18x1.2 (mm)
19	Y202333	Crosshead screw	Stainless steel	12	M4x10 (mm)
20	Y202338	Large flat head cross screw	Stainless steel	28	M5.5x19 (mm)

21	GS080001	Instruction	/	1	/
22	Y201069	Spare parts	/	1	/

please save the spare parts.

Wall Panels and Floor

Left side panel
BGS08004

Left back panel
BGS08002

Right back panel
BGS08003

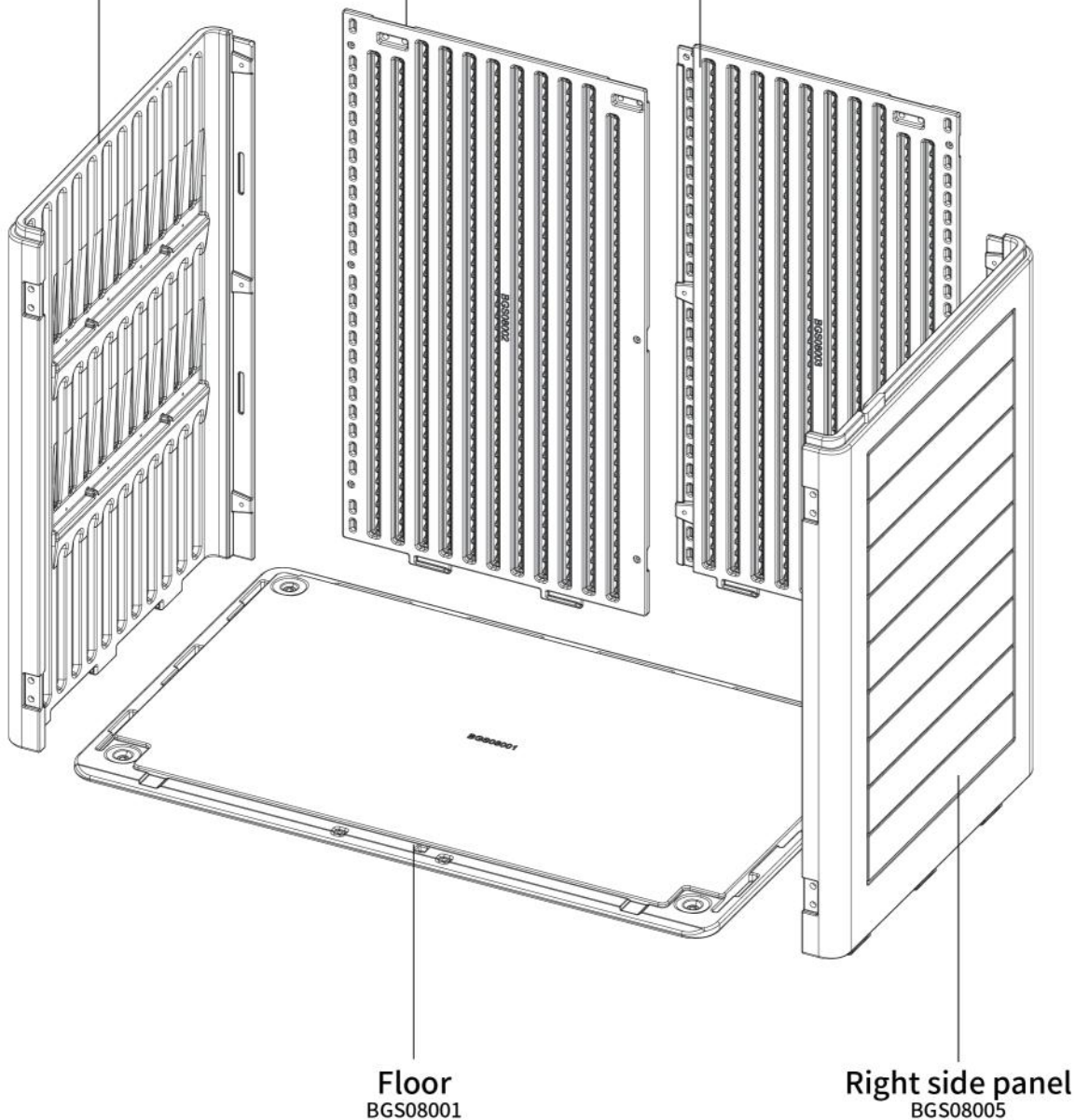
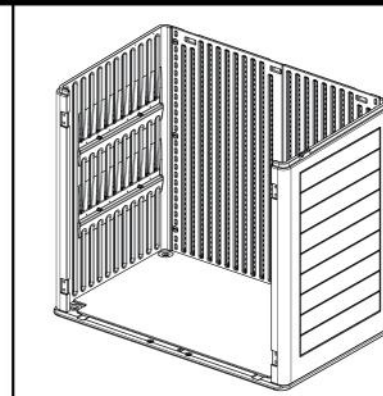

Doors and Roof

Roof
BGS08008

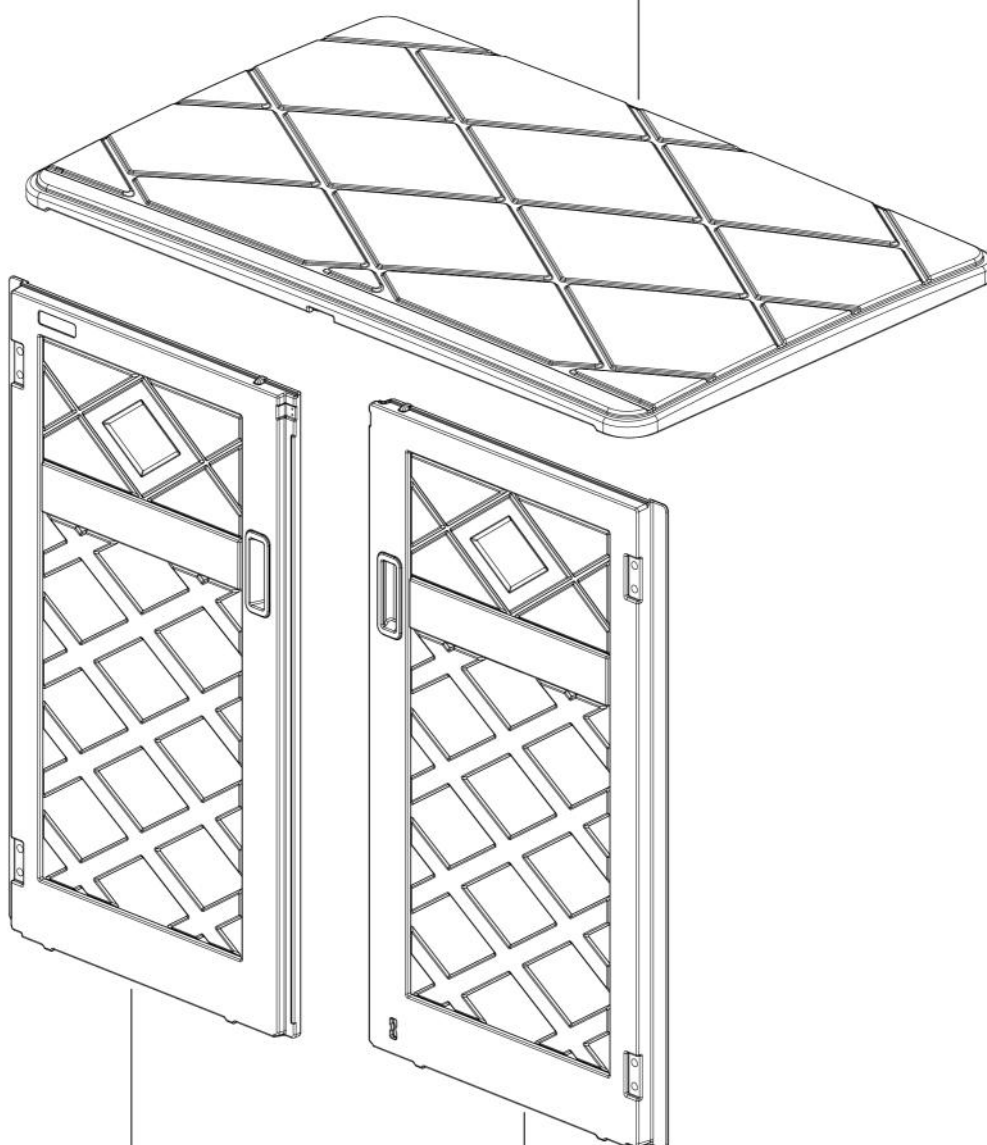

Left door
BGS08006

Right door
BGS08007

Hardware

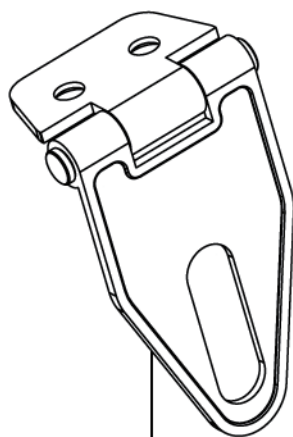

L hinge folding assembly
(GS0201015)x1pcs

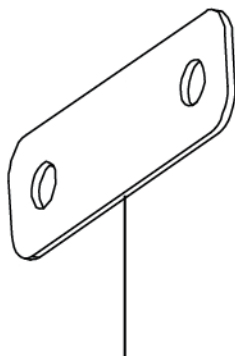

Strengthen the block
(GS0201028)x14pcs

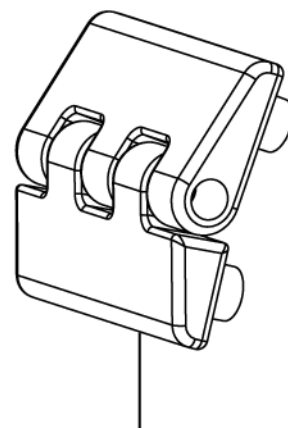

Hinge assembly
(GS0201014)x7pcs

Support rod fixing piece
(GS0201021)x1pcs

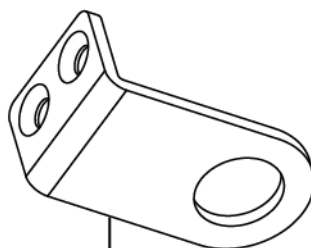

L-1
(GS0201016)x1pcs

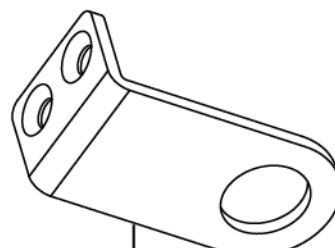

L-2
(GS0201017)x1pcs

Support rod
(BGS08009)x 1pcs

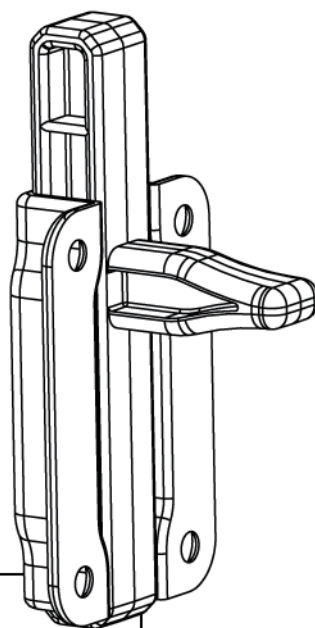

Latch-1
(GS0201018)x1pcs Latch-2
(GS0201019)x1pcs



Large flat head
cross bolt
Y202327
M6x10x 8pcs

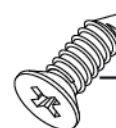

Crosshead screw
Y202333
M4x10x12pcs

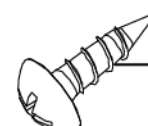

Large flat head
cross screw
Y202338
M5.5x19x28pcs

1 Right back panel to install

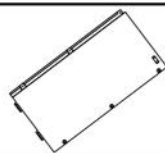

Right back panel
BGS08003

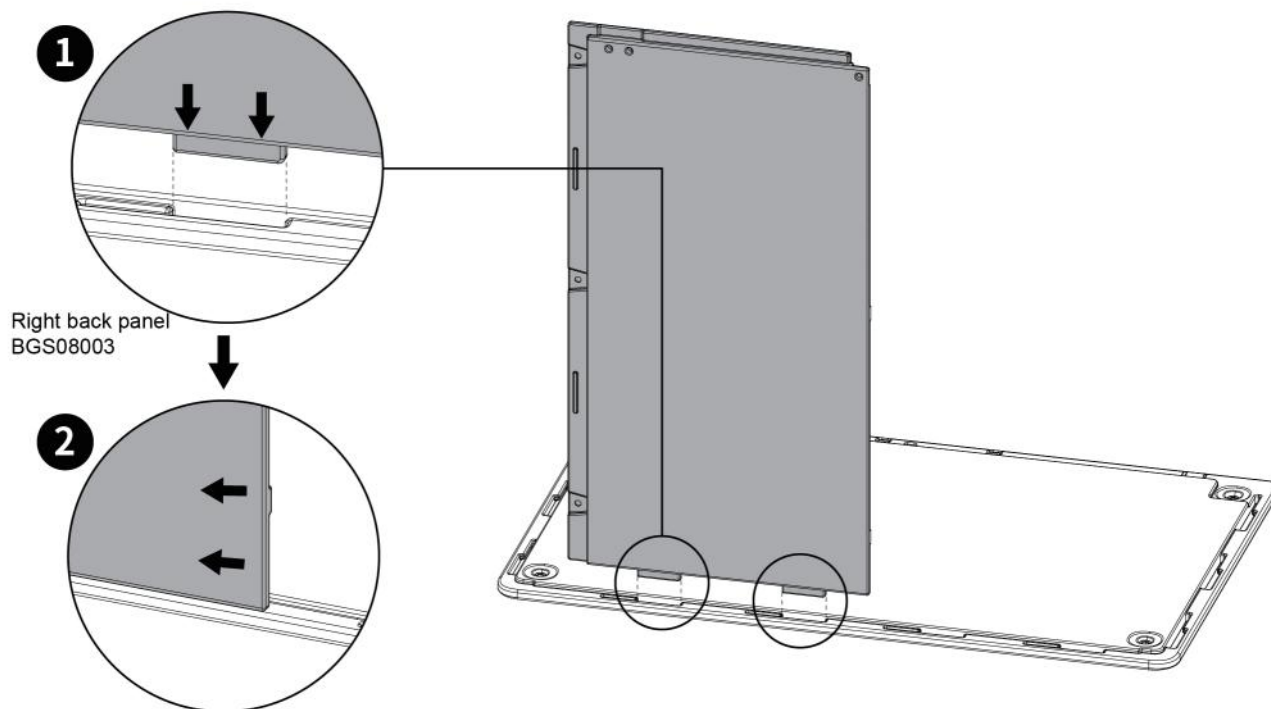

2 Left back panel to install

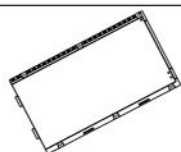

Left back panel
BGS08002

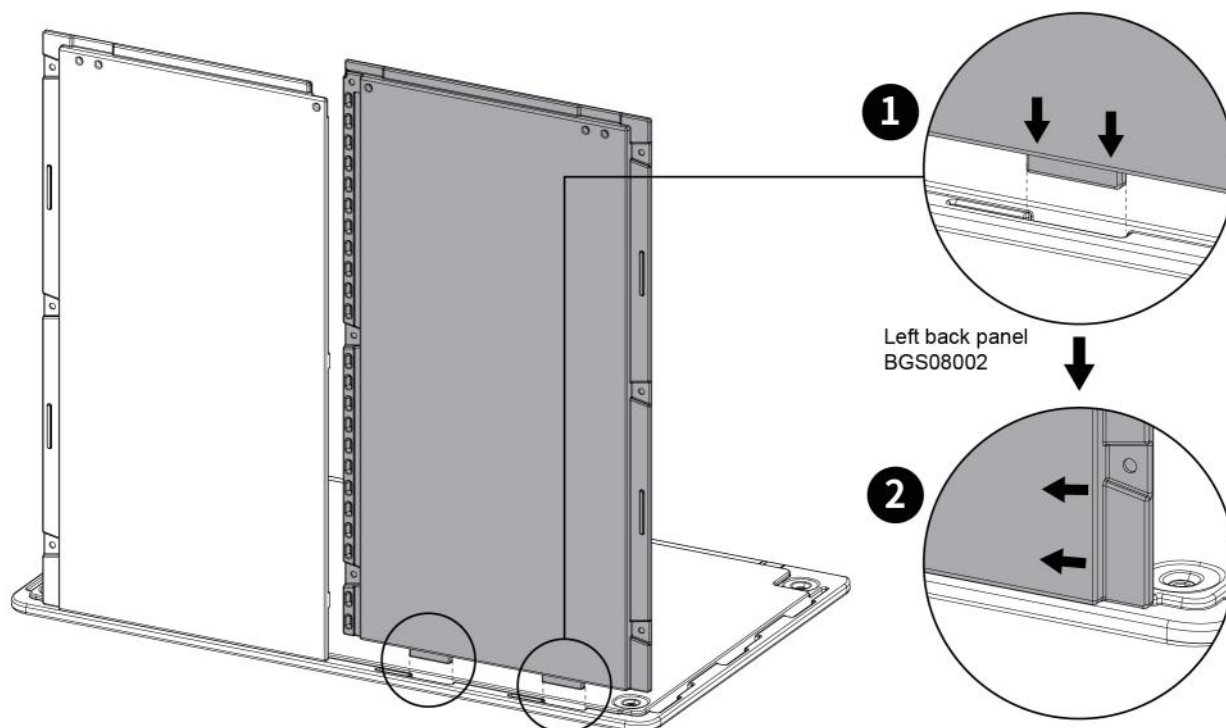

3 back panel to install



Large flat head cross bolt
Y202327
(M6x10)x2pcs

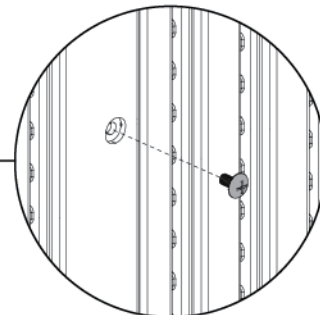
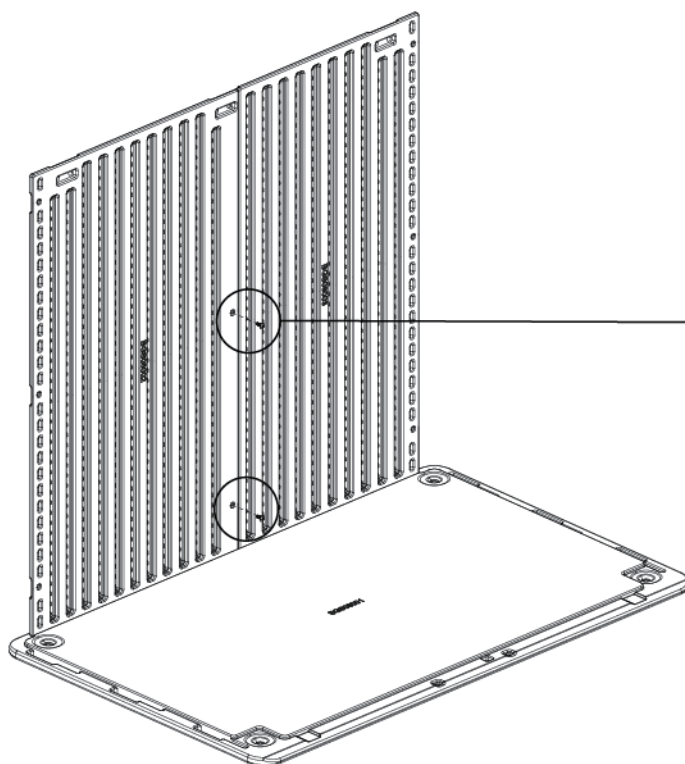

Large flat head cross bolt
Y202327
(M6x10)x2pcs

4 Left side panel to install

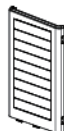

Left side panel
BGS08004

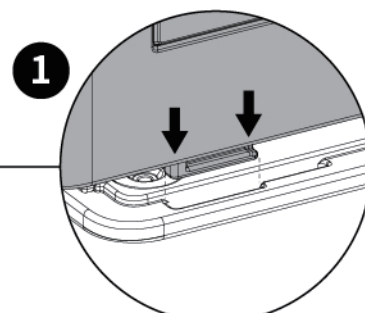
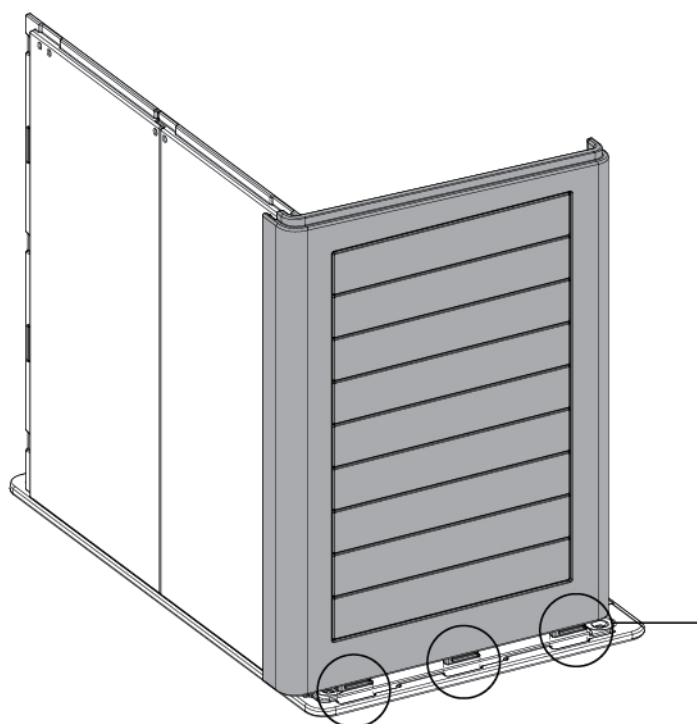

Left side panel
BGS08004

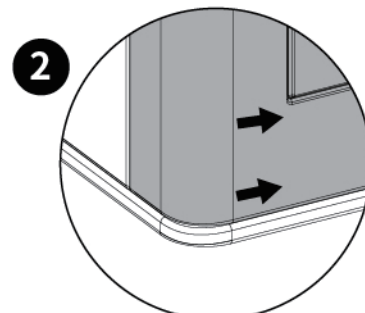

5 Left side panel to install



Large flat head cross bolt
Y202327
(M6x10)x3pcs

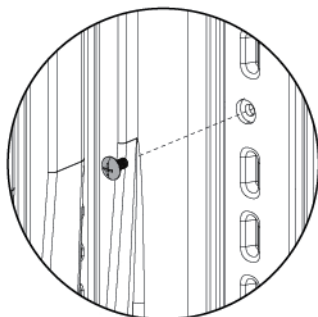

Large flat head cross bolt
Y202327
(M6x10)x3pcs

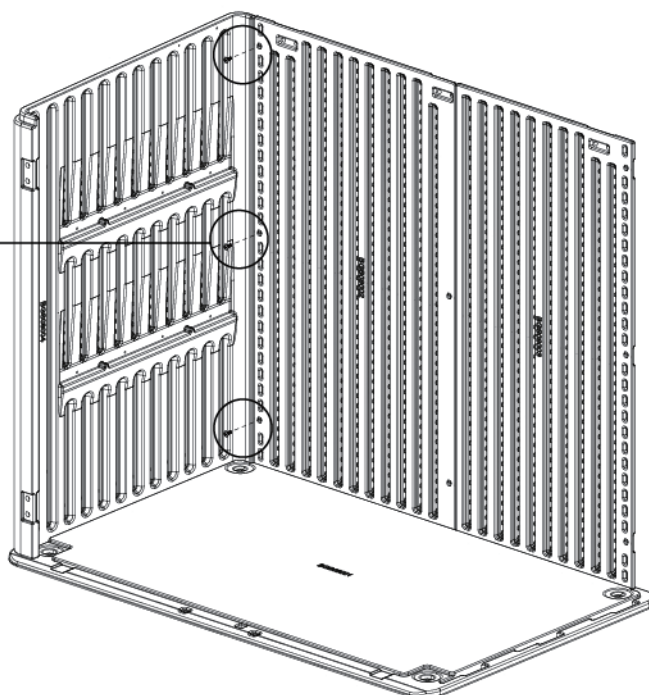

6 Right side panel to install

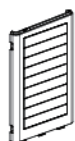

Right side panel
BGS08005

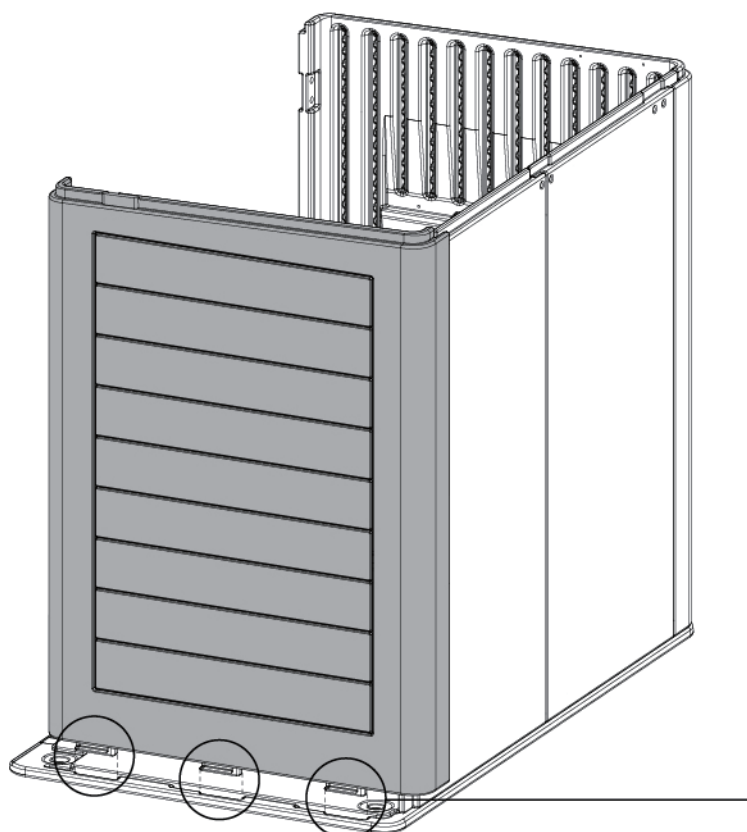

1

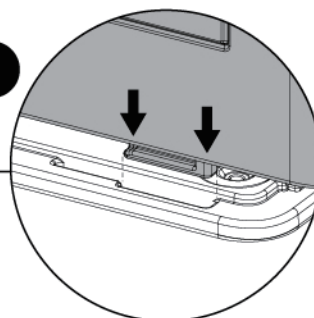

Right side panel
BGS08005

2

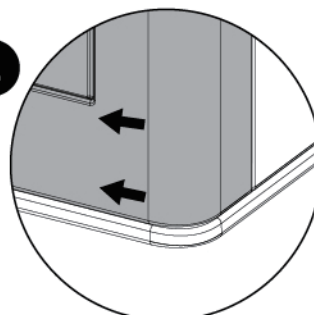

7 Right side panel to install

Large flat head cross bolt
Y202327
(M6x10)x3pcs

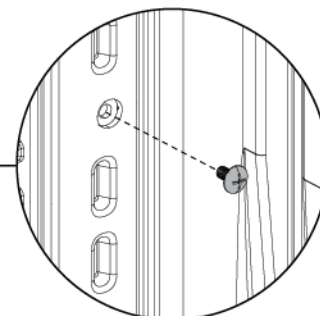
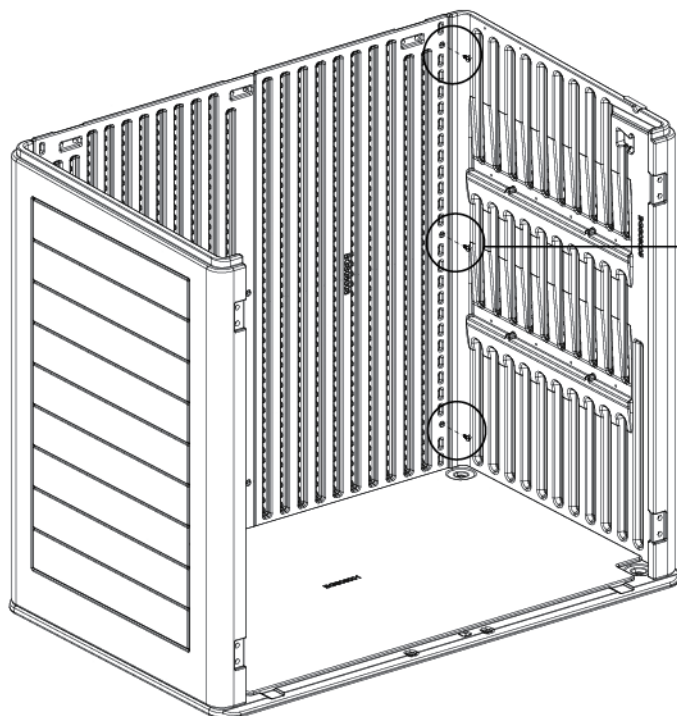

Large flat head cross bolt
Y202327
(M6x10)x3pcs

8 Right door accessories to install



Right door
BGS08007



Hinge assembly
(GS0201014)
x2pcs



Strengthen the block
(GS0201028)
x2pcs



Large flat head cross screw
Y202338
(M5.5x19)x4pcs

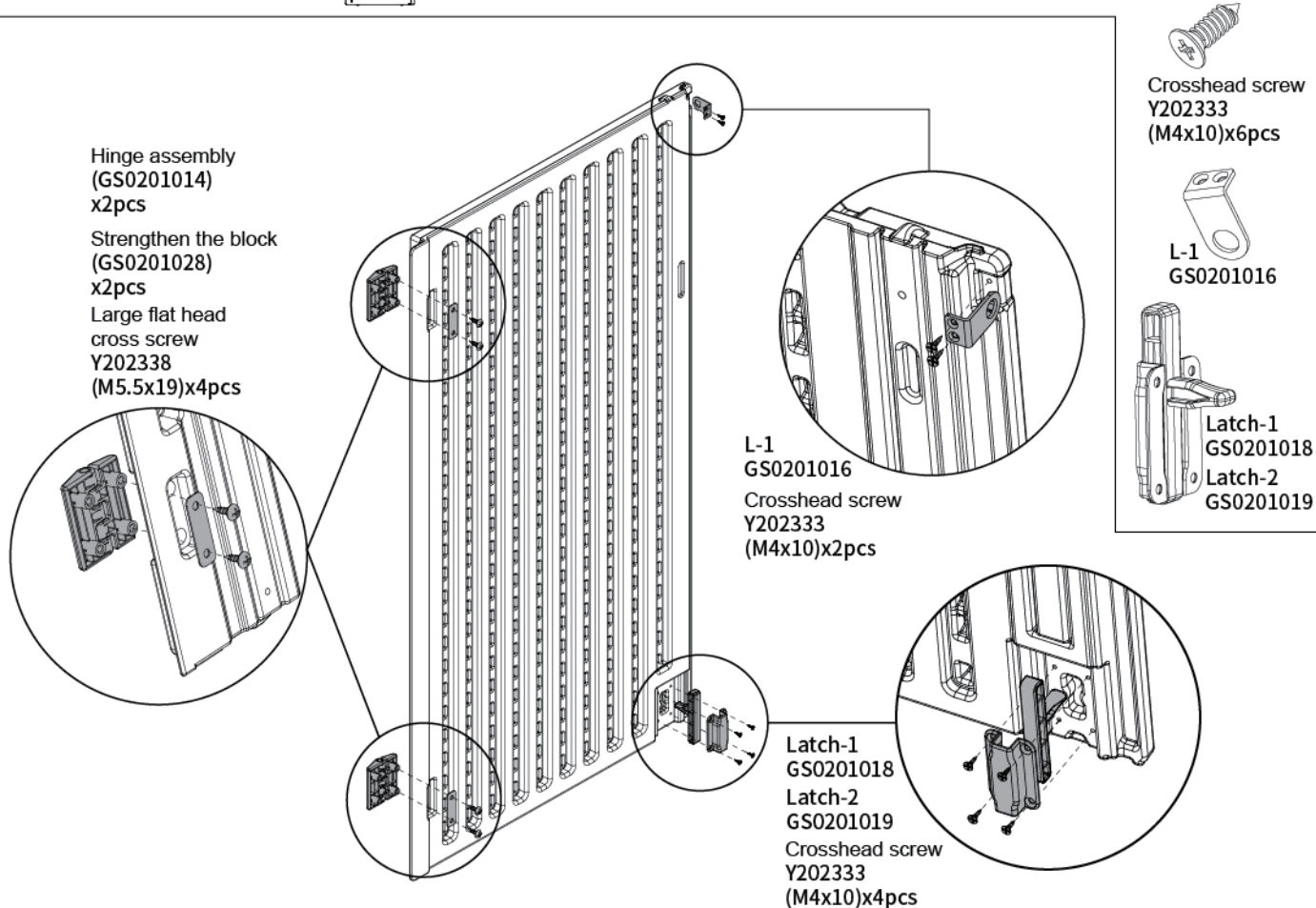

9

Left door accessories to install



Left door
BGS08006



Hinge assembly
(GS0201014)
x2pcs



Strengthen the block
(GS0201028)
x2pcs



Large flat head
cross screw
Y202338
(M5.5x19)x4pcs



Crosshead screw
Y202333
(M4x10)x2pcs



L-2
GS0201017

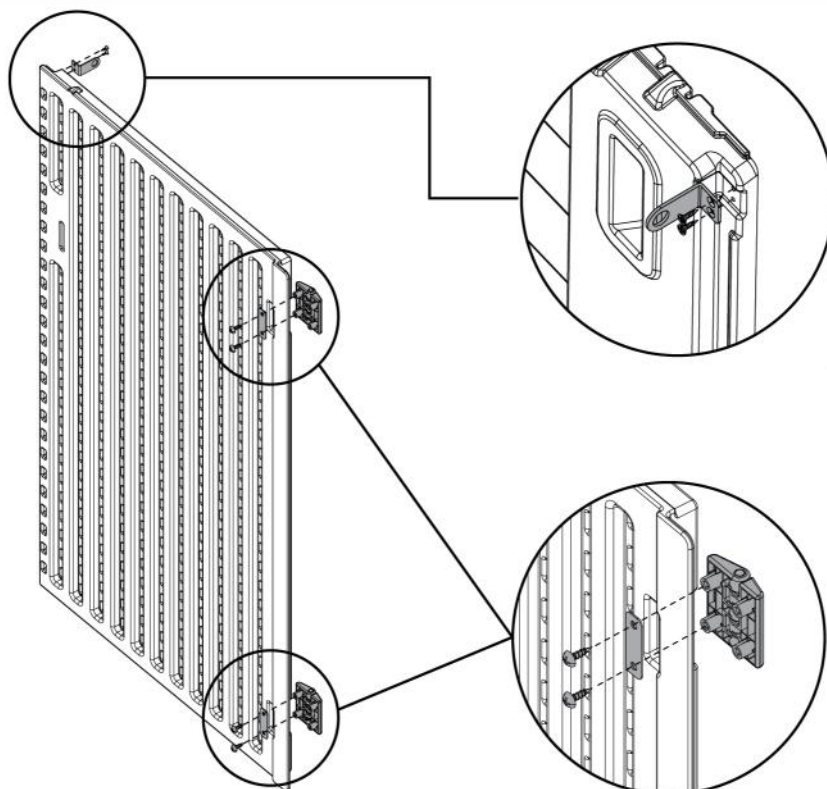

Crosshead screw
Y202333
(M4x10)x2pcs

L-2
GS0201017

Hinge assembly
(GS0201014)
x2pcs
Strengthen the block
(GS0201028)
x2pcs
Large flat head
cross screw
Y202338
(M5.5x19)x4pcs

10

Door to install Install accessories after the left door and right door.



Strengthen the block
(GS0201028)x2pcs



Large flat head
cross screw
Y202338
(M5.5x19)x4pcs

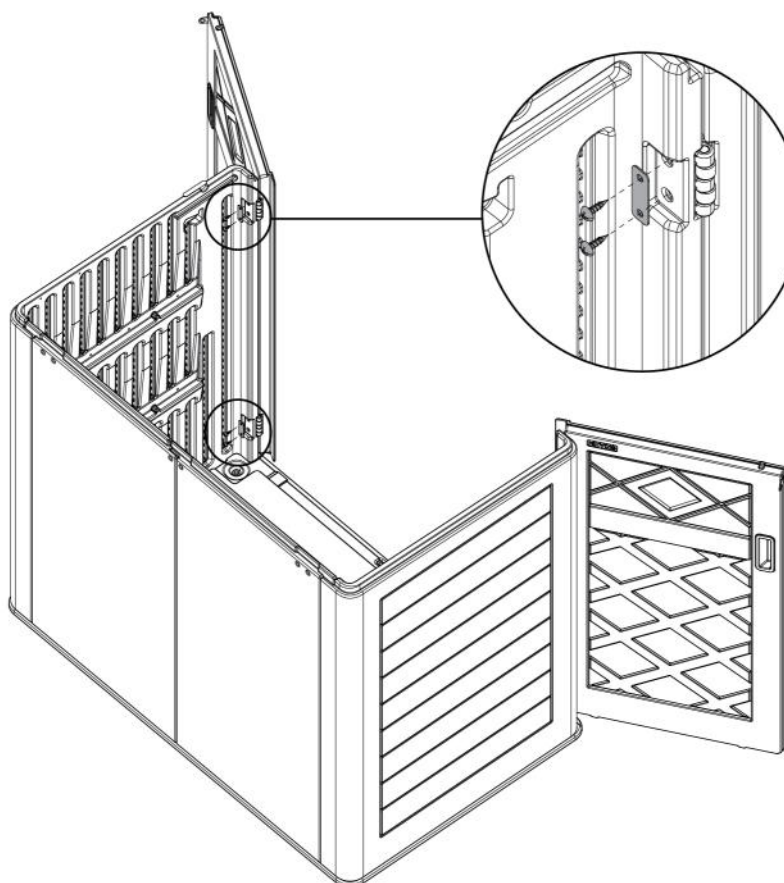

Large flat head
cross screw
Y202338
(M5.5x19)x4pcs

Strengthen the block
(GS0201028)x2pcs

11 Roof accessories to install

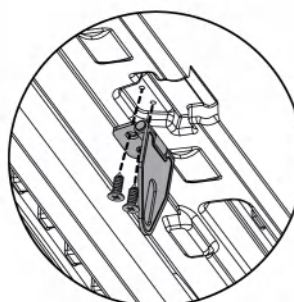
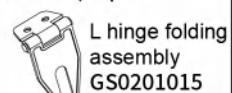
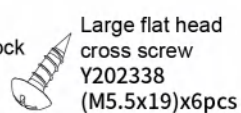
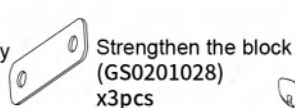

L hinge folding assembly GS0201015
Crosshead screw Y202333 (M4x10)x2pcs

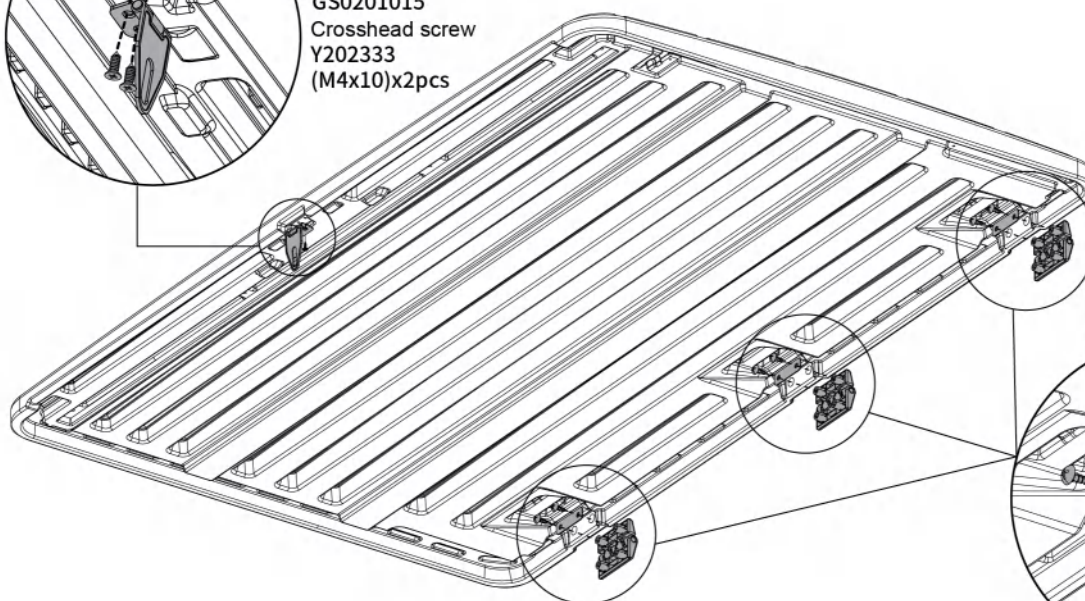

Hinge assembly (GS0201014)x3pcs
Strengthen the block (GS0201028)x3pcs
Large flat head cross screw Y202338 (M5.5x19)x6pcs

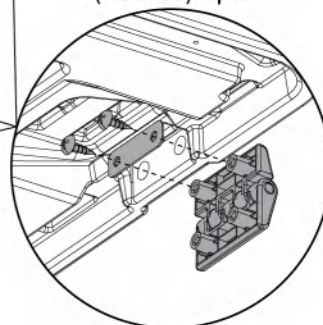

12 Roof to install

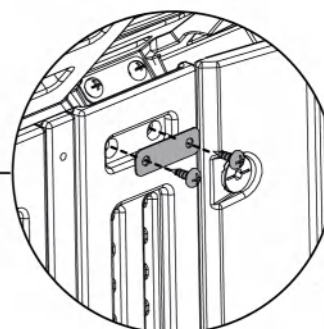
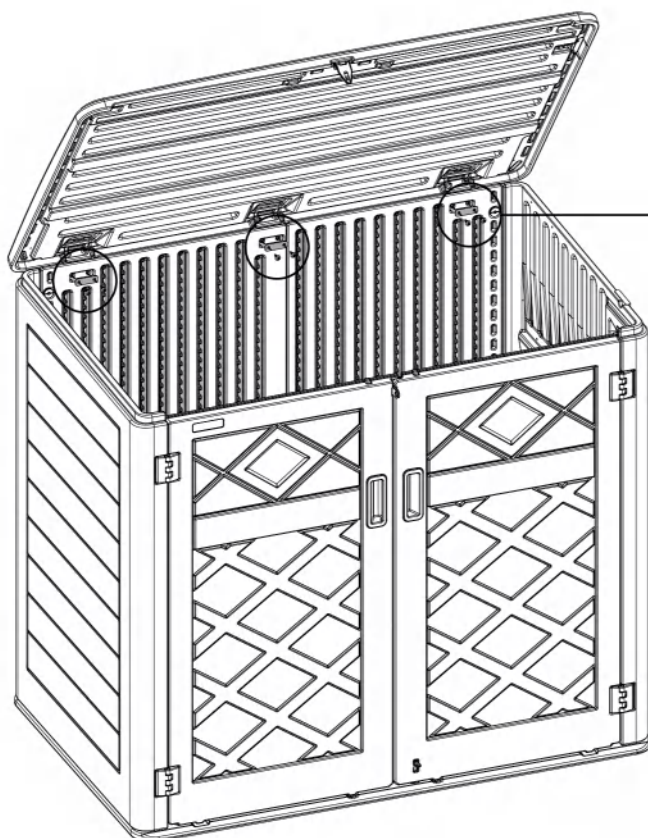
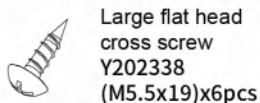
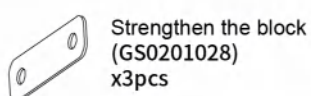

Strengthen the block (GS0201028) x3pcs

Large flat head cross screw Y202338 (M5.5x19)x6pcs

13 Support rod to install

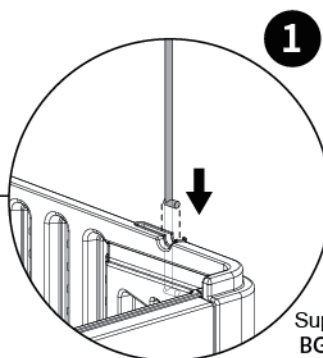
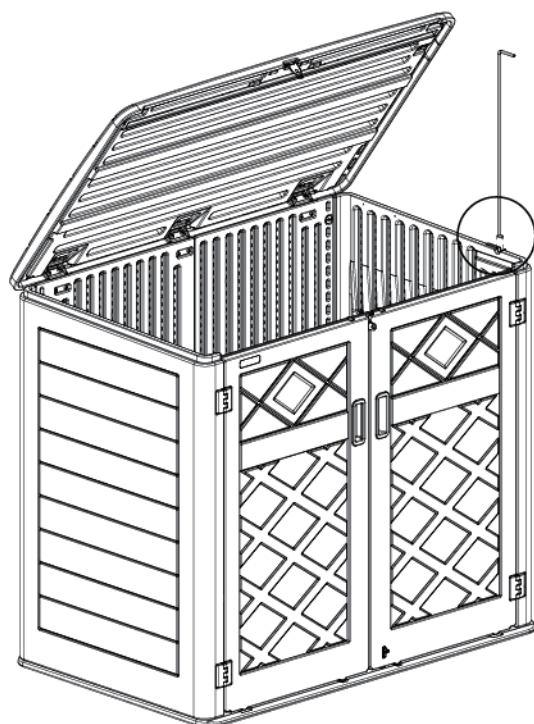

Support rod
BGS08009

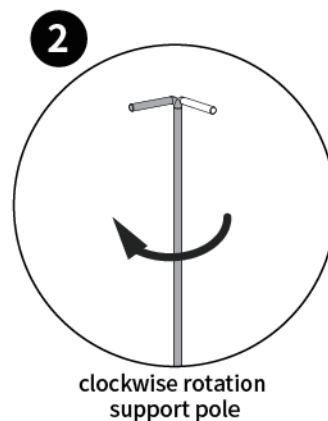

14 Support rod to install



Support rod fixing piece
GS0201021



Crosshead screw
Y202333
(M4x10)x2pcs

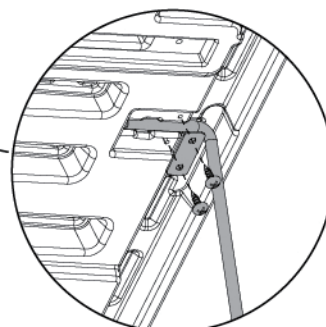
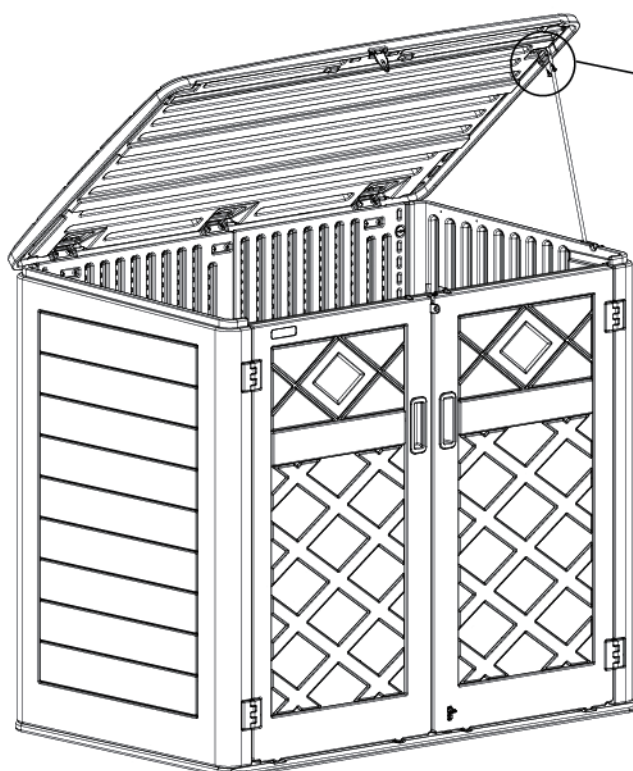

Support rod fixing piece
GS0201021

Crosshead screw
Y202333
(M4x10)x2pcs