



| Product Submittal | |
|-------------------|--|
| Name | |
| Date | |
| Architect/Owner | |
| Contractor | |
| Tag | |
| Notes | |

Compression Angle Stop Specification Sheet

Description

Typically used on stub-outs coming out of the wall. Used to control and shut off water flow to fixtures or appliances for maintenance and repair. 1/2 in. compression inlet connection makes for quick installation, and quarter-turn, full-port brass ball valve makes for easy operation.

Features And Benefits

- Sleek chrome finish for an attractive appearance.
- Quarter-turn full-port brass ball valve.
- Compatible with copper pipe.
- Can be installed in wet lines.

Specification Data

| Materials | |
|----------------|--------------|
| Valve body | DZR LF Brass |
| Knurled Handle | ABS |
| Valve ball | DZR LF Brass |
| Seat | PTFE |

Temperature Performance

- Minimum working temperature 33°F
- Maximum working temperature 160°F
- Maximum working pressure is 125 psi

Flow Rate

- 1/4" Compression 2.2 GPM at 20 psi
- 3/8" Compression 4.0 GPM at 20 psi



Part Listing

| | | |
|--------------------------|--------------|---|
| <input type="checkbox"/> | COMPA1214Z | 1/2 in. Compression (5/8 in. OD) x 1/4 in. OD Compression |
| <input type="checkbox"/> | COMPA1238Z | 1/2 in. Compression (5/8 in. OD) x 3/8 in. OD Compression |
| <input type="checkbox"/> | COMPAC1238Z | 1/2 in. Coarse Thread Compression (5/8 in. OD) x 3/8 in. OD Compression |
| <input type="checkbox"/> | COMPA12716Z | 1/2 in. Compression (5/8 in. OD) x 1/2 in. OD Slip Joint |
| <input type="checkbox"/> | COMPA1212Z | 1/2 in. Compression (5/8 in. OD) x 1/2 in. Compression |
| <input type="checkbox"/> | COMPAC1212SZ | 1/2 in. Coarse Thread (5/8 in. OD) Compression x 1/2 in. OD Slip Joint |

Dimensions

| Part Number | DIM A (MM) | DIM B (MM) |
|--------------|------------|------------|
| COMPA1214Z | 1.02 | 2.13 |
| COMPA1238Z | 1.14 | 2.13 |
| COMPAC1238Z | 1.14 | 2.13 |
| COMPA12716Z | 1.16 | 2.13 |
| COMPA1212Z | 1.26 | 2.13 |
| COMPAC1212SZ | 1.16 | 2.13 |

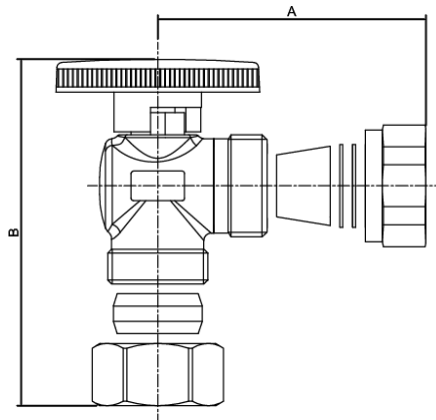
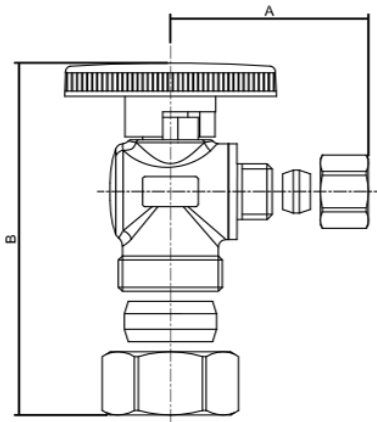

Codes and Listing

cUPC
 ASME A112.18.1
 CSA B125.1
 NSF/ANSI/CAN 61
 NSF/ANSI 372

