

ASSEMBLY INSTRUCTIONS

Components List

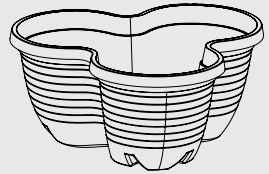

Qty (4) 3 - Pocket Planter

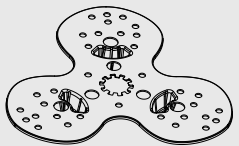

Qty (4) Self - Watering Mesh

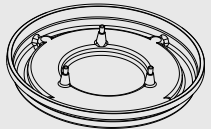

Qty (1) Saucer

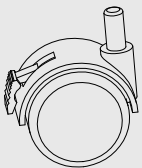

Qty (4) Lockable Caster Wheel

Assembly

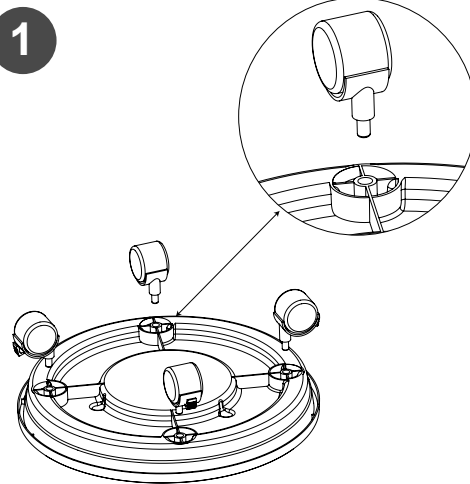

Pop the caster wheels into the holes on the bottom of the saucer.

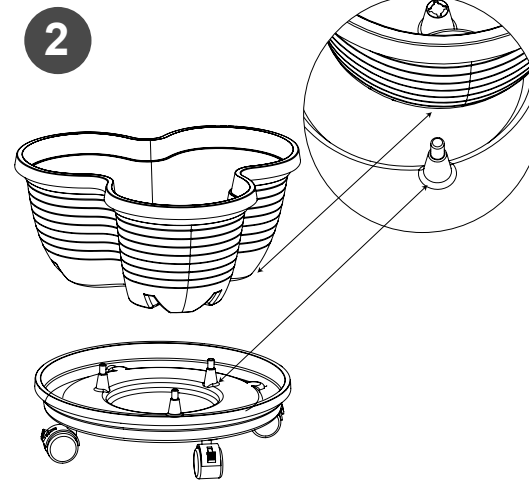

Attach the saucer to one of the planters through the 3 pins

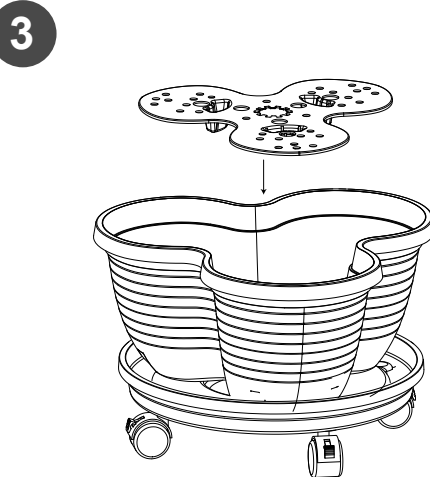

Snap a Self-Watering mesh into each planter

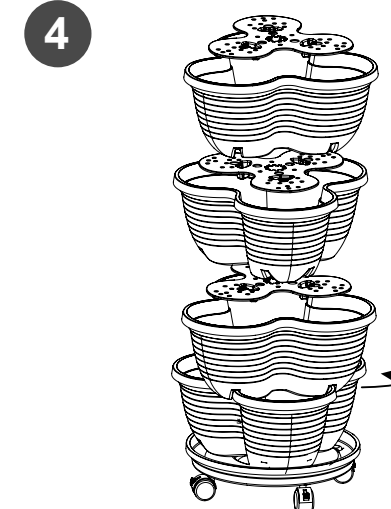

Interlock the 4 planters

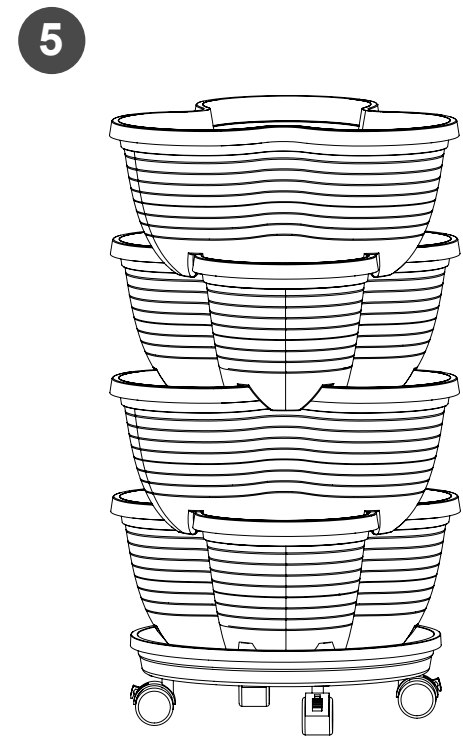

Ready for Planting

(With casters the maximum weight should not exceed 55 lbs)

HELPFUL TIPS:

- Plant with appropriate soil based on your live goods.
- Check soil moisture regularly. Top tiers may need watering more regularly.
- To prevent the possibility of root rot of the bottom tier, drain excess water from saucer.
- For additional stability, place a 1" diameter pole (not included) through the middle hole of the vertical garden before adding soil and planting. Then, place the garden in a secure place to prevent tipping (if this is a concern due to weather conditions).
- Rotate vertical garden as needed (based on live goods sun or light exposure needs).