

Activate Warranty & Join Us

VISIT: <https://calefort.vip/>
or scan the QR code



Email: service@calefort.com

*Activate Product Warranty

*VIP Exclusive Service

*Personalized product care & records



Made in China

Ca'Lefort

Wine Station

MODEL: KCC2-04
SKU NO.: CLF-KCC2-04



EN Thank you for purchasing the Wine Station.

BEFORE USING FOR THE FIRST TIME

To ensure safety and maintain the high quality of the product, we recommend that you read and follow the instructions carefully.

Do not immerse the appliance in water or any other liquid to avoid physical injury or damage to the product.

Keep body parts (e.g. hands) and utensils away from the corkscrew to avoid injury.

Keep this product away from children.

Do not dismantle the product by yourself, otherwise the warranty will be invalid.

Do not force the product onto a bottle or attempt to speed up the mechanism. This product works best when operating at its intended speed.

Do not use this product for any other purpose.

Keep away from flammable, explosive gas.

SPECIFICATIONS

Name: Ca'Lefort Wine Station
Model: KCC2-04
Noise Level: <40dB
Rated voltage: 100-240V

Rated frequency: 50/60Hz
Rated power: 60W
Origin: China

PRODUCT DESCRIPTION



10. Wine glass holder
11. Wine glass
12. Switch button

1. Full automatic electric wine opener + full automatic electric vacuum pump
2. Wine aerator & pourer / WP-008
3. Stopper / KVS-2
4. Foil cutter
5. Charging base of opener set
6. Bottle placement port
7. Temperature display
8. Temperature setting button
9. Control panel

HOW TO USE THE WINE STATION

BOOTING

The power adapter is connected to the mains, plug the 12V 5A power adapter into the DC socket of the product body, turn on the switch, the glass panel logo, the temperature display and the temperature setting button light up, and the refrigeration system of the WINE STATION starts working.

TEMPERATURE CONTROL AND ADJUSTMENT

The temperature of the wine station can be set between 8-18°C/46-64°F via the temperature setting button on the control panel. When the product is turned on for the first time, the display screen shows the ambient temperature. Long press the light key to switch between °F and °C. The default setting temperature is 54°F, and the display screen shows the internal actual temperature afterwards. Temperature is adjusted up or down by 1°C or 1°F within the above temperature range.

RECOMMENDED WINE SERVING TEMPERATURE

Type of wine	Suitable temperature
Red Wine	15-18 °C / 59-64 °F
Dry white wine	10-13 °C / 50-55 °F
Champagne	8-9 °C / 46-48 °F



INSTALLATION OF THE WINE GLASS HOLDER

Align the mounting hole of the wine glass holder with the shackle of the side panel, and press down tightly to complete the installation process.



INSTALLATION OF THE CHARGING BASE OF OPENER SET

Align and insert the DC plug of the charging base into the DC socket of the wine station host. There is a magnet between the host and the charging base, and the two are sucked together to complete the connection with the host.



Precautions:

Ventilation: There shall be no object blocking the air inlet and outlet of the refrigeration system to avoid affecting cooling effect. A distance of 50 mm or more is necessary.

Prevent dampness: Avoid placing the Ca'Lefort Smart Wine Cooler in a damp place.

Prevent overheating: Ensure that the Ca'Lefort Smart Wine Cooler is kept away from heat and avoid direct sunlight.

Stability: The Ca'Lefort Smart Wine Cooler shall be placed on a level and sturdy surface and shall not be placed on a soft surface.

Prevent danger: Keep the Ca'Lefort Smart Wine Cooler away from inflammable and explosive materials.

Notes:

Water drops on the inside of the cabinet and on the surface of the panel. During normal use, the relative humidity of the surrounding environment will cause condensation on the surface of the cabinet and the surface of the glass panel. This is a normal phenomenon and can be wiped with a dry cloth.

Chill wine in advance: The wine chilling process takes a certain amount of time, so please chill in advance. Please put accessories back in place after use.

Energy saving tips:

When not in use, please disconnect power.

When the Ca'Lefort Smart Wine Cooler is not used for display, please turn off the inner light.

Do not block vents of the Ca'Lefort Smart Wine Cooler to ensure a good ventilation environment. Clean dust accumulated in the air inlet and outlet areas regularly.

Place in a cool place, and do not expose to direct sunlight, high temperatures, or extremely high temperatures.

HOW TO USE THE ELECTRIC WINE OPENER

Put the foil cutter onto the bottleneck and hold it firmly with one hand while rotating it left and right. The foil seal will then be cut off.

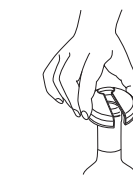

Hold the bottle firmly with one hand and the wine opener with the other. Place the bottom of the wine opener on top of the wine bottle and ensure that the wine opener is aligned as vertically as possible with the bottle.

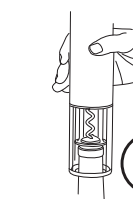

Press the extract button and hold it while slightly pressing the wine opener downward at the same time. The corkscrew will turn in a clockwise direction, enter the cork, and gradually remove it from the bottle in seconds. When the cork is fully removed, the wine opener stops automatically. Release the button and remove the opener from the bottle.

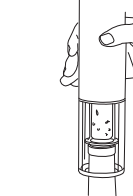

Press and hold the upper release button for a few seconds. The cork will automatically come out of the opener. Release the button, and the opening process is complete.

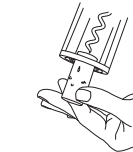

This product is only suitable for corks with a diameter of 20-24 mm and a height of 44 mm. This product is only suitable for wine bottles with an outer diameter of no more than 35 mm and an inner diameter of 17.5-23 mm.

Safety Advice

Hold the wine opener and the wine bottle firmly during use.

The blade of the foil cutter is sharp. Do not touch it with your fingers.

Please store this product out of the reach of children.

Align the wine opener with the wine bottle as much as possible. Otherwise, the cork cannot be easily pulled out.

Troubleshooting

If the opener cannot work or stops during uncorking:

Please charge before use. (Note: It is recommended not to use the product while charging.)

Press the opener again to separate the spiral from the cork by rotating in the opposite direction. Reopen after ensuring the opener body is aligned with the wine bottle.

If the above operations are all correct and the opener still works abnormally, please contact the vendor for maintenance service.

HOW TO USE THE WINE AERATOR & POURER

Insert the wine aerator & pourer into the bottleneck.

Tilt the bottleneck to pour wine out from the wine aerator & pourer.

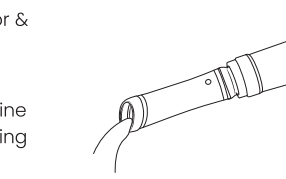

CAUTIONS: Never cover the air inlet hole on the wine aerator & pourer to avoid affecting aerating and pouring functions.

Clean with soft detergents and water after use.

This product is only suitable for wine bottles with an inner diameter of 17.5 - 19.5 mm.

HOW TO USE THE ELECTRIC VACUUM PUMP

Press the stopper into the bottleneck vertically.



Revert the wine opener and place the electric vacuum pump on the stopper firmly.

Keep pressing the pump. The indicator light turns on, and the electric motor automatically starts pumping air. After 15 seconds, the pump beeps and automatically stops.

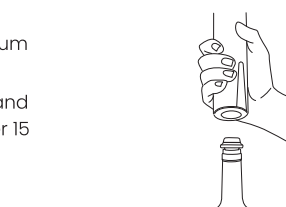

Rotate the date scale ring on the stopper

Rotate the date scale ring on the stopper to mark the sealing date. Store the bottle in a wine cabinet or refrigerator for better preserving effects. It is recommended to finish in 7 days.



To open again, push the valve to break the seal, then take off the stopper.

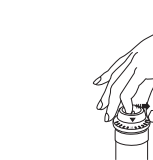

This stopper is only suitable for wine bottles with an inner diameter of 18-19 mm.

When using this stopper to preserve wine, it is not recommended to store the wine bottle horizontally.

CLEAN AND MAINTENANCE

Wipe the exterior surface with a soft, wet cloth.

Do not immerse into water or other liquids.

When not in use, store the product in a clean and dry place.

WARRANTY

Under normal conditions, this product is guaranteed for 2 years from the date of purchase.

The warranty service is only valid if the product is returned to your vendor with proof of purchase (warranty card duly completed or receipt of purchase).

Free maintenance is invalid in the following cases:

Damage caused by natural disasters such as an earthquake, fire, or flood, and power supply failure or chemical erosion, etc.

Damage caused by improper operation and maintenance according to the instructions, or unauthorized disassembly or repair.

Damage caused by the installation of parts for repair or alteration other than those provided by authorized service centers.