

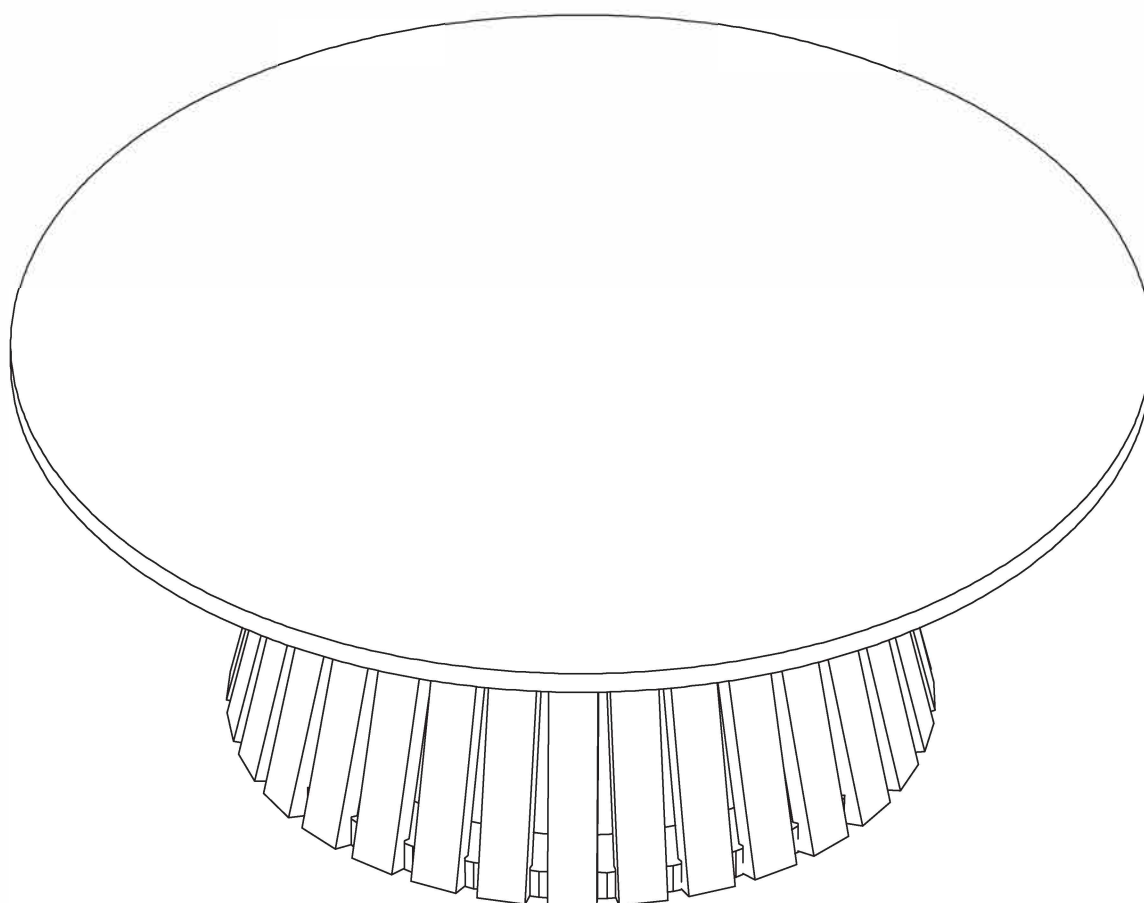

2-CTET1912

CT019





STOP!

Before beginning the assembly process,
ensure all boxes and parts have been delivered.

FOR BEST RESULTS:

- Do not throw away packaging materials until assembly is complete.
- Assemble item on a soft surface, such as cardboard or carpet, to protect finish.
- Proper assembly requires two people.

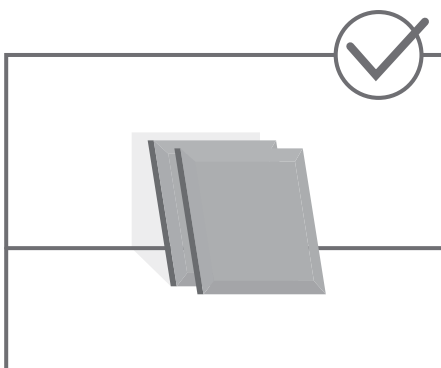
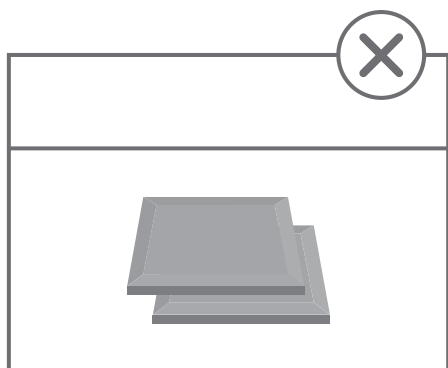
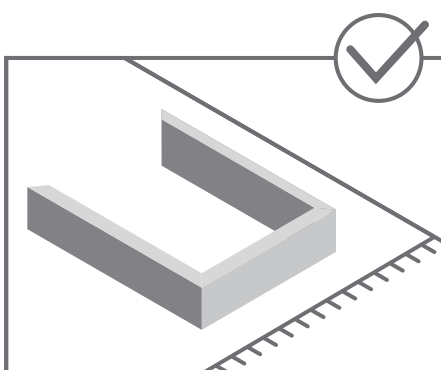
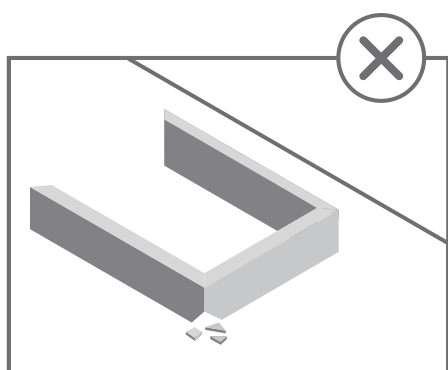

TOOLS REQUIRED

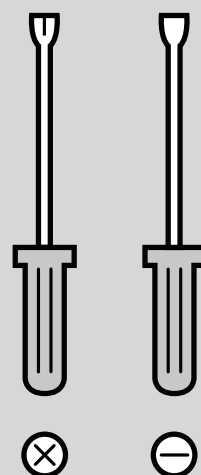

View our assembly video online:
WWW.MANHATTANCOMFORT.COM



Stuck? Question? We are here to help.
tel: 908-888-0818
e-mail: help@manhattancomfort.com

Support Site



Included in this package:

- 1:TOP(1)
- 2:MIDDLE SLATS(31)
- 3:TOP CONNECTING RING (1)
- 4:BASE CONNECTING RING (1)

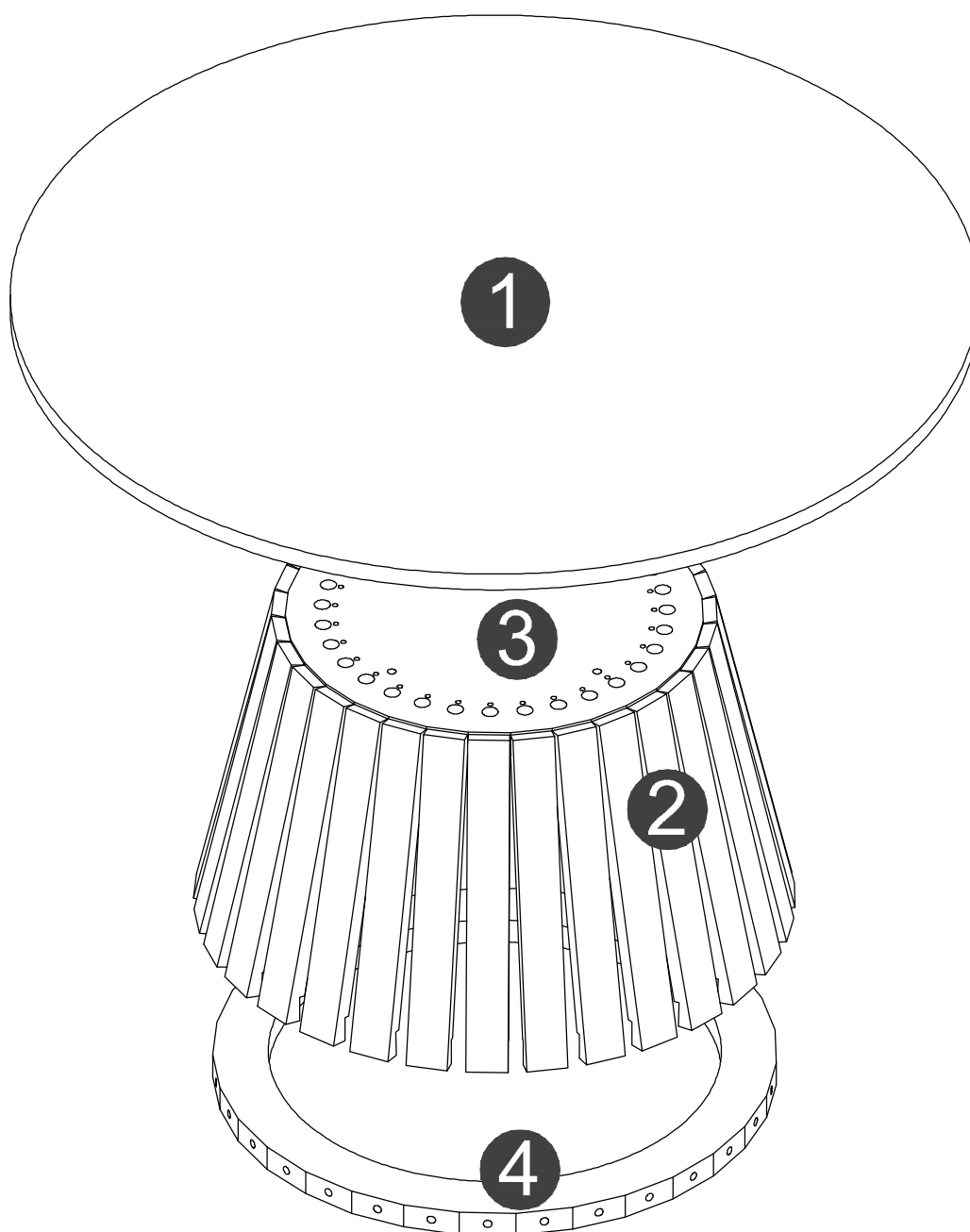

Hardware Identification

A:BOLT-62pcs
M6*40mm

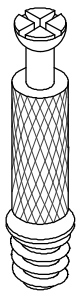

C:GROMMET-62pcs
Ø15*12mm

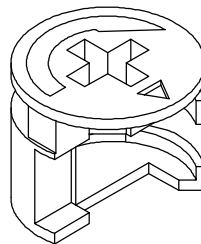

H:SPANNER-1pcs
M4

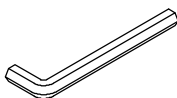

G:BOLT- 4pcs
M6*40mm

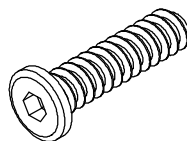

Z2:WASHER-4pcs



Step 1

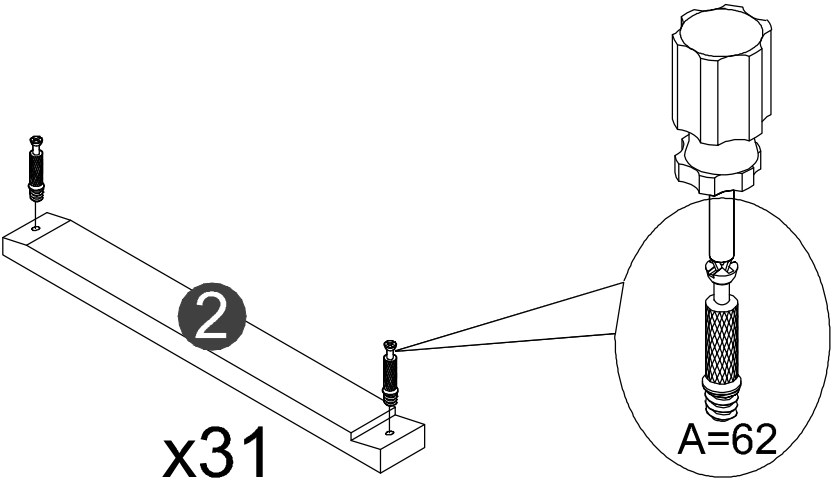

Step 2

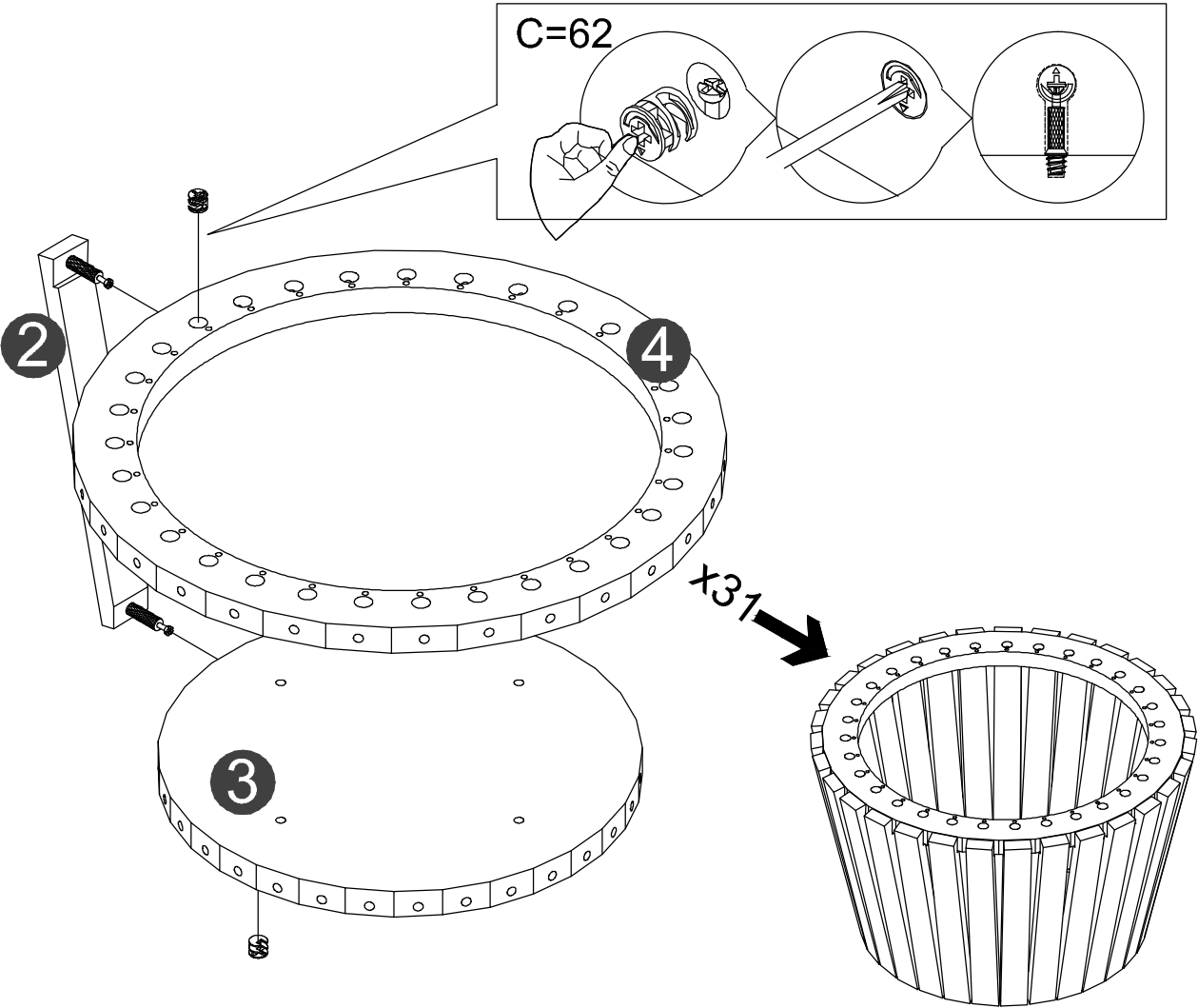

Step 2

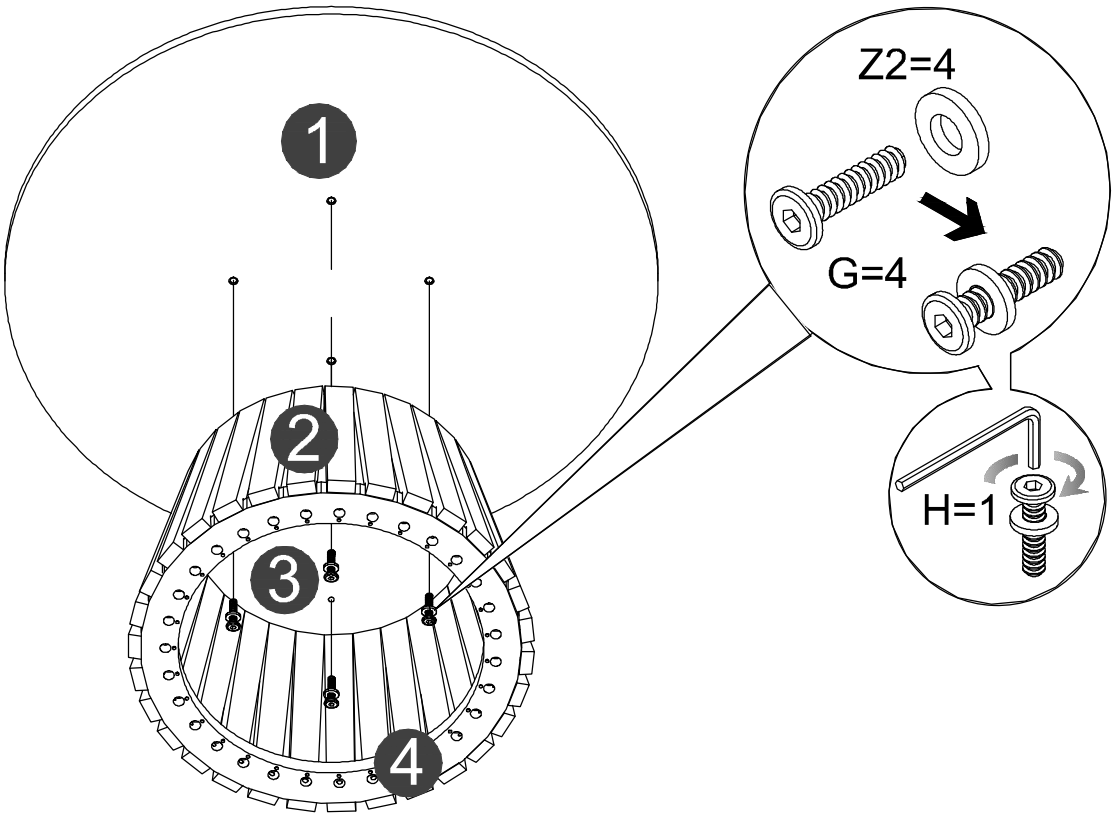

Step 2

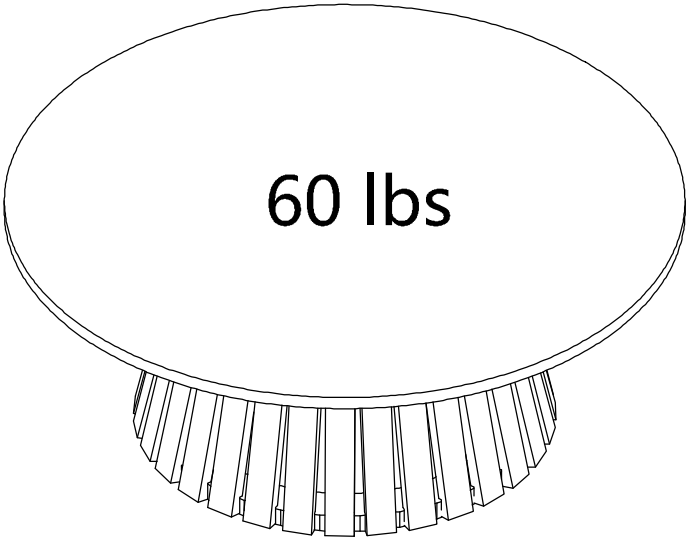



WARRANTY POLICY

All Manhattan Comfort furniture products are warranted, to the original purchaser at the time of purchase and for a period of 30 days thereafter.

Our warranty is limited to new products purchased in factory sealed cartons. This warranty is valid in the United States of America and Canada.

In order to provide you with timely assistance, please thoroughly inspect your furniture for missing or defective parts immediately after opening the carton.

Manhattan Comfort offers a 30-day parts replacement warranty on all items.

Our furniture products are not intended for outdoor use.

THE WARRANTY DOES NOT COVER:

- Defects/damages by improper assembly or disassembly.
- Defects/damages caused by inappropriate use of the furniture.



319 Ridge Rd. Dayton, NJ 08810

908-888-0818

ET012

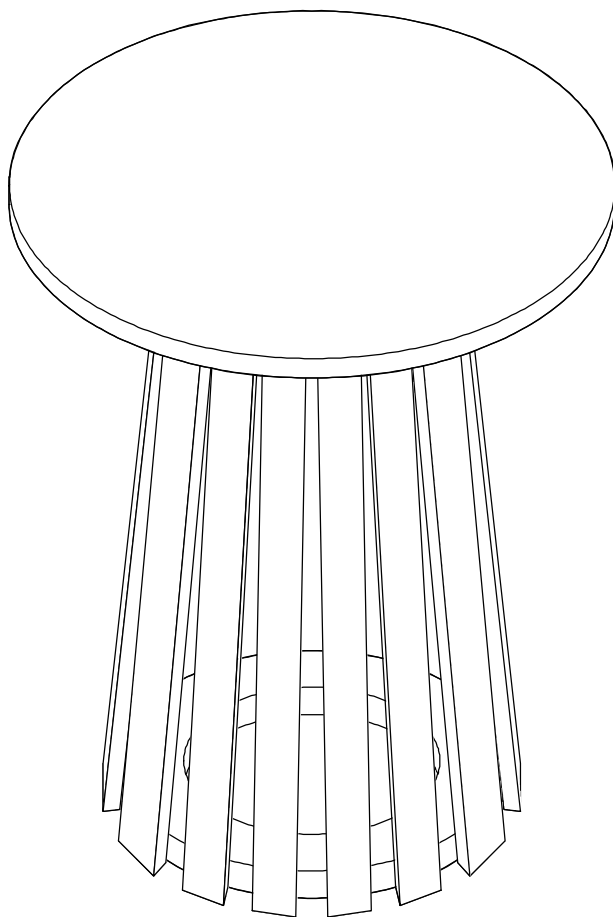



STOP!

Before beginning the assembly process,
ensure all boxes and parts have been delivered.

FOR BEST RESULTS:

- Do not throw away packaging materials until assembly is complete.
- Assemble item on a soft surface, such as cardboard or carpet, to protect finish.
- Proper assembly requires two people.

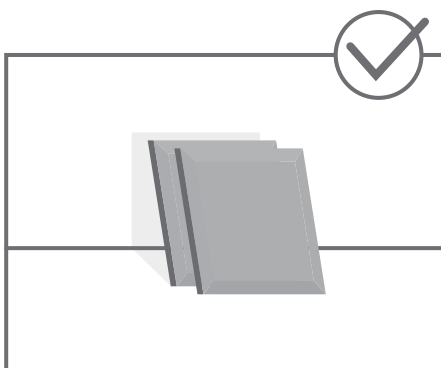
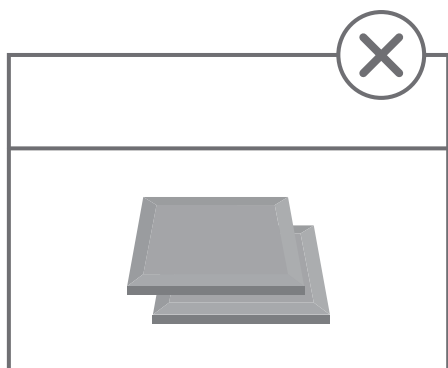
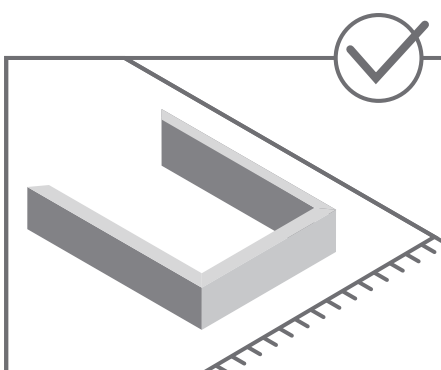
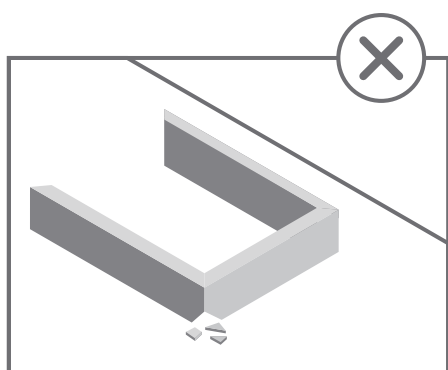

TOOLS REQUIRED

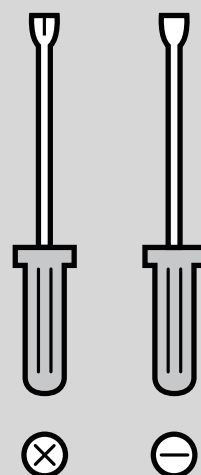

View our assembly video online:
WWW.MANHATTANCOMFORT.COM



Stuck? Question? We are here to help.
tel: 908-888-0818
e-mail: help@manhattancomfort.com

Support Site



Included in this package:

- 1:TOP(1)
- 2:MIDDLE SLATS(14)
- 3:TOP CONNECTING RING (1)
- 4:BASE CONNECTING RING (1)

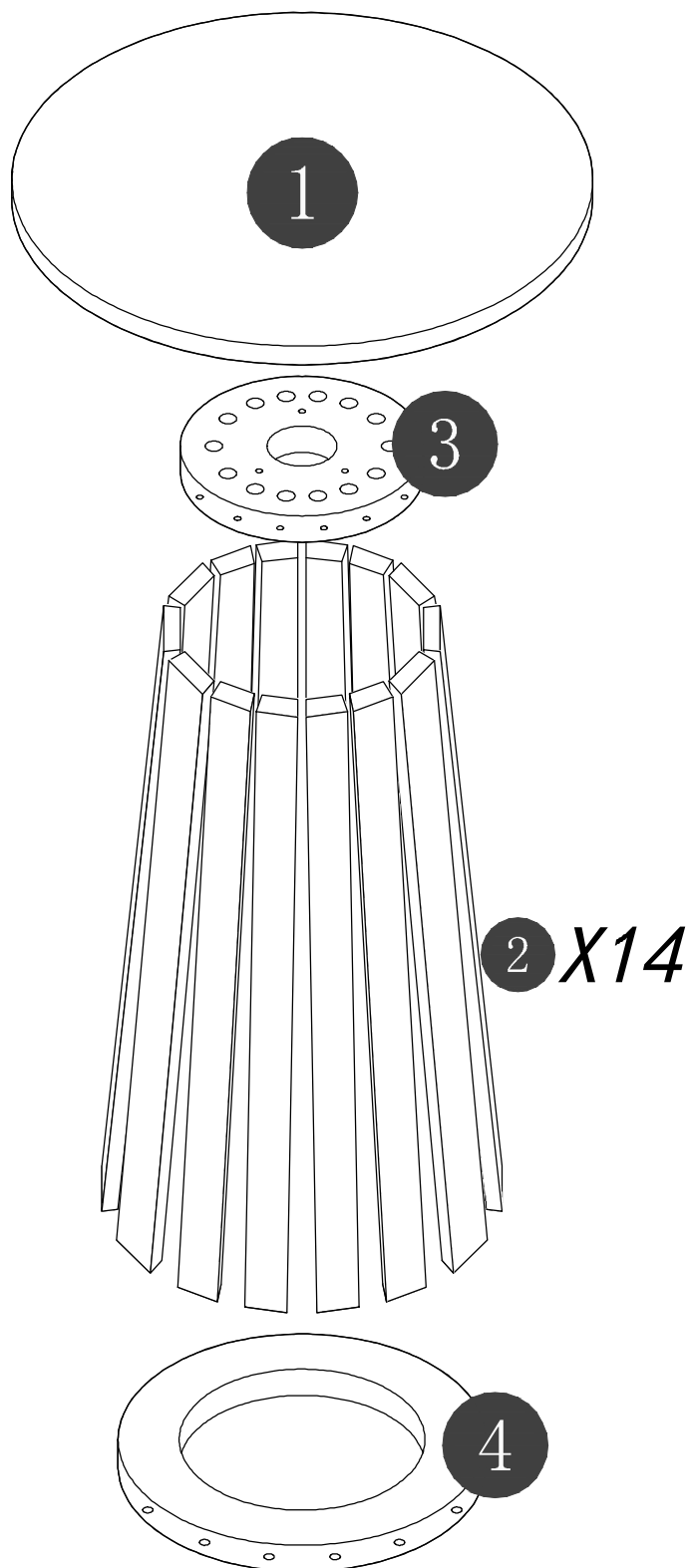

Hardware Identification

A:BOLT-28pcs
M6*40mm

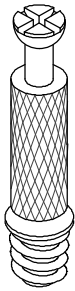

C:GROMMET-28pcs
Ø15*12mm

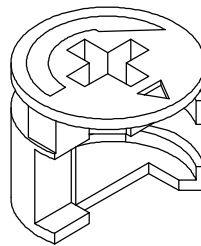

H:SPANNER-1pcs
M4

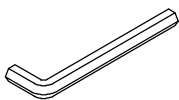

G:BOLT- 3pcs
M6*40mm

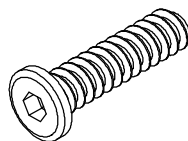

Z2:WASHER-3pcs



Step 1

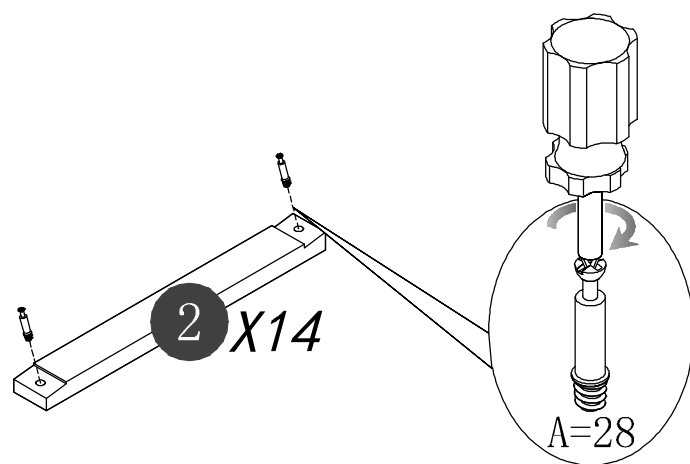

Step 2

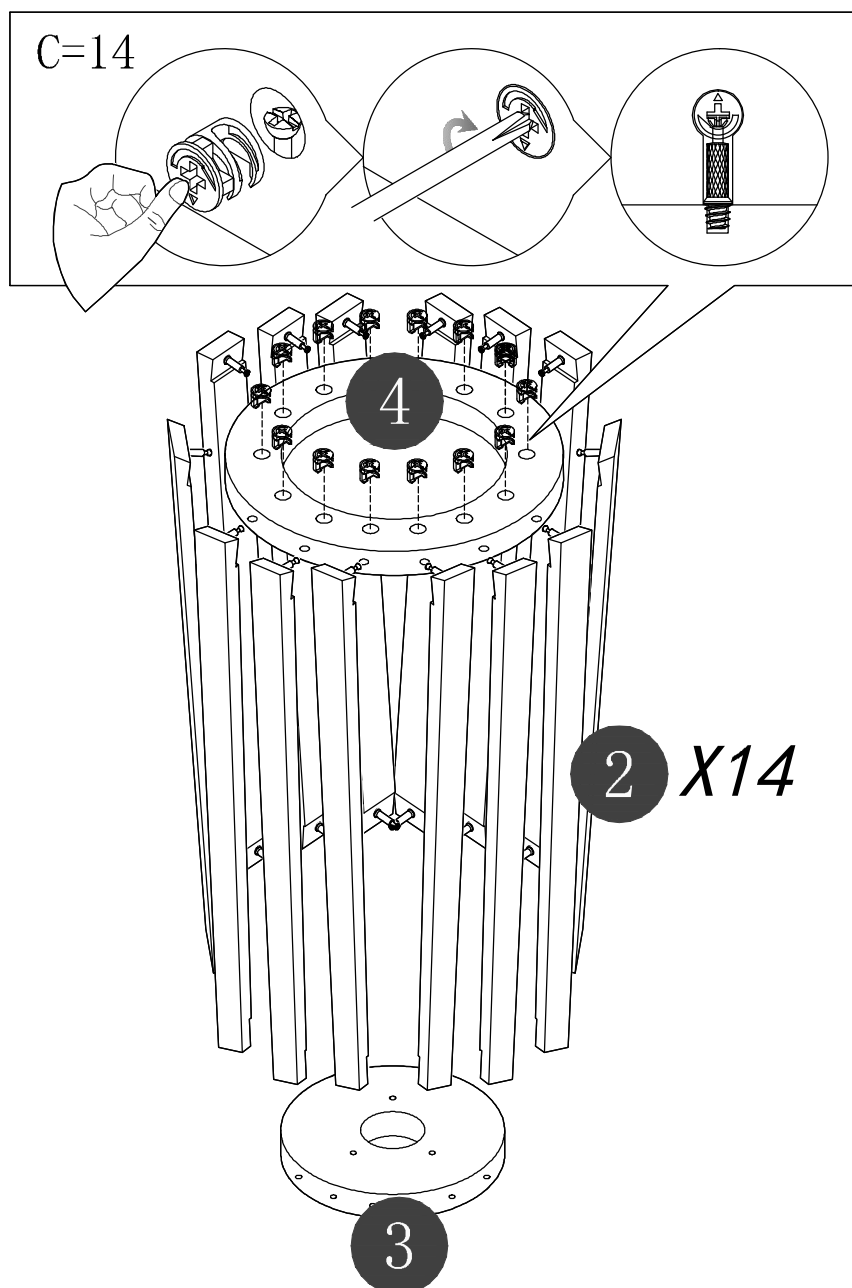

Step 3

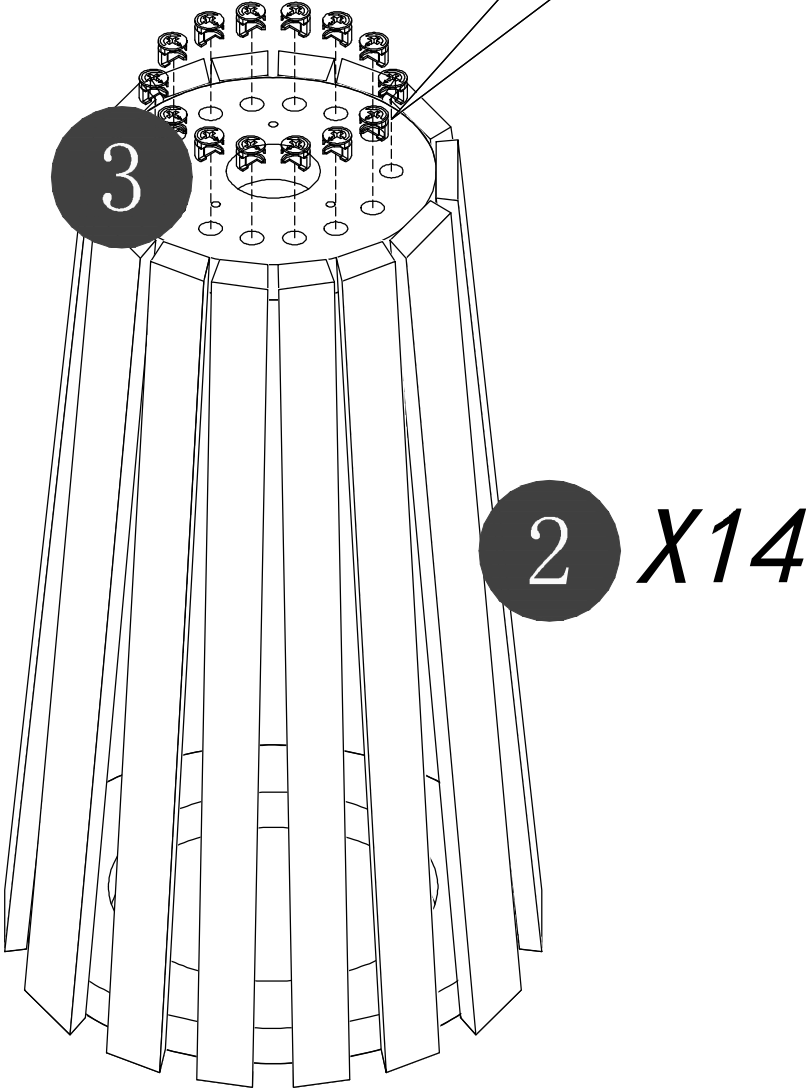
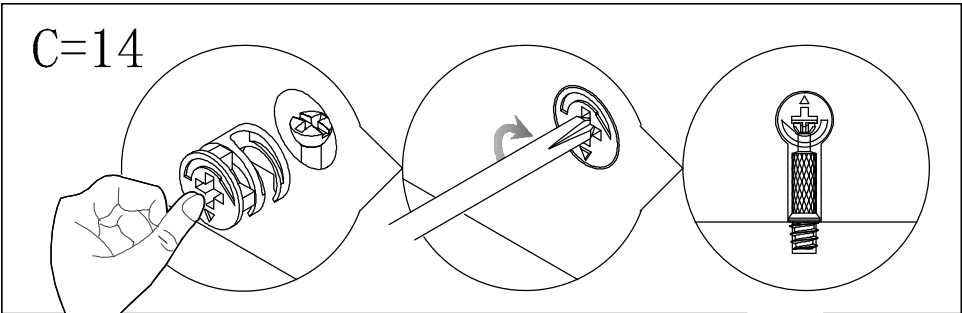

Step 4

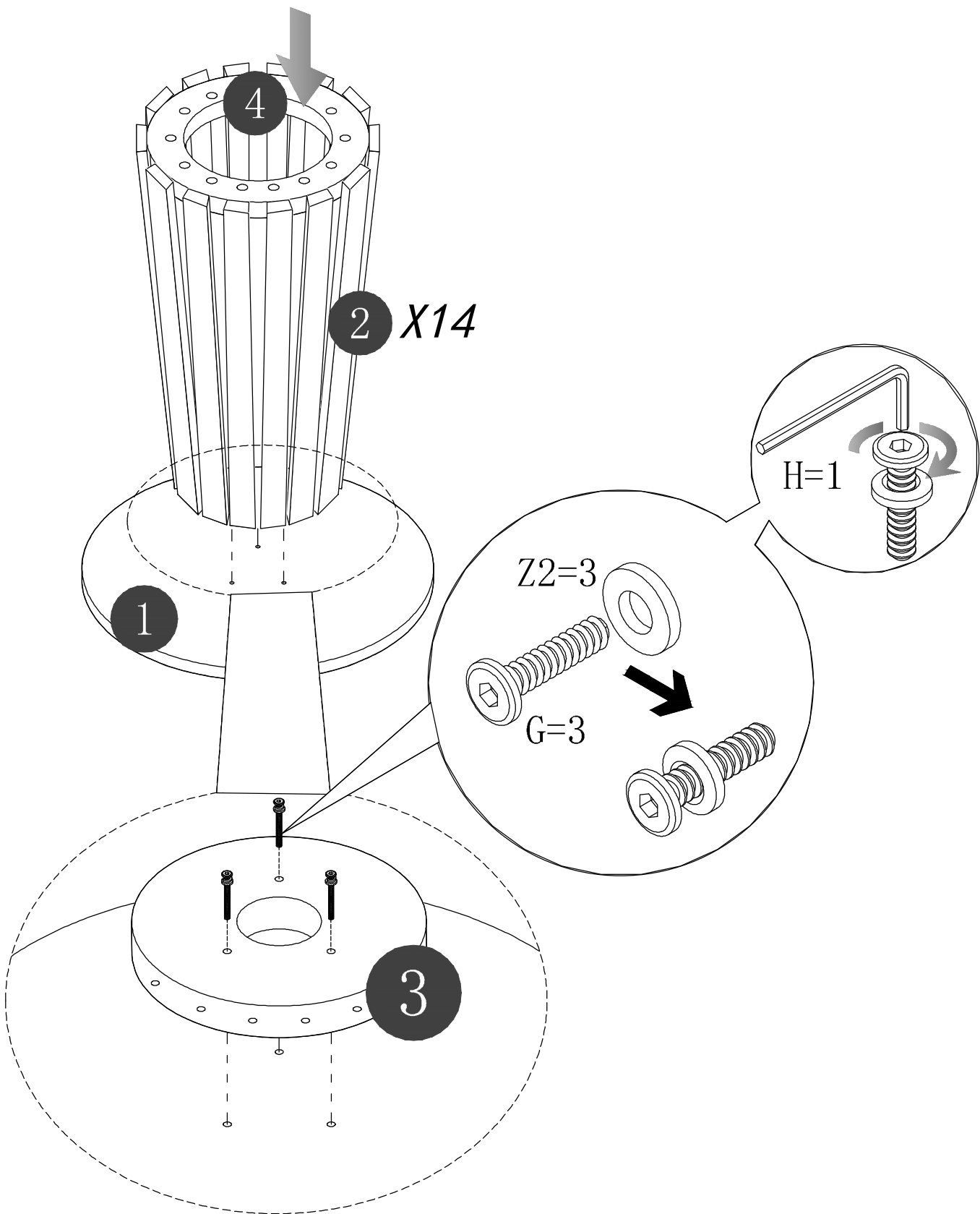

Step 5

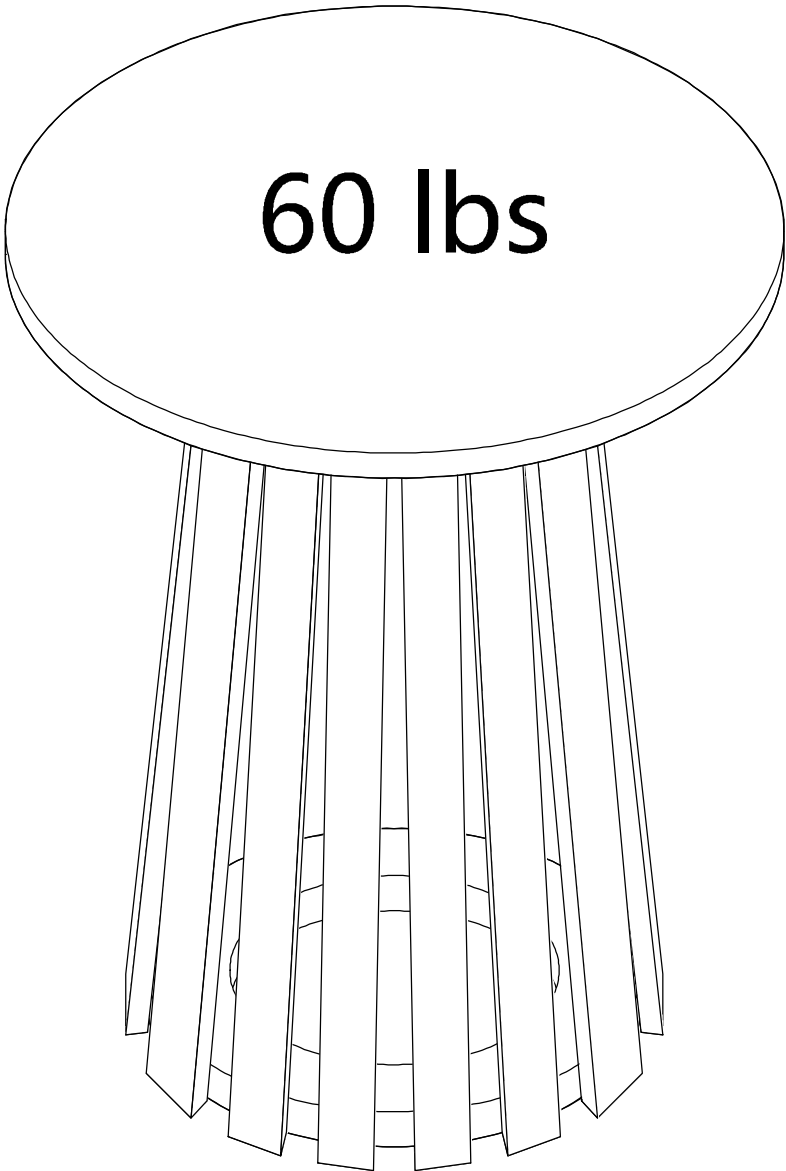



WARRANTY POLICY

All Manhattan Comfort furniture products are warranted, to the original purchaser at the time of purchase and for a period of 30 days thereafter.

Our warranty is limited to new products purchased in factory sealed cartons. This warranty is valid in the United States of America and Canada.

In order to provide you with timely assistance, please thoroughly inspect your furniture for missing or defective parts immediately after opening the carton.

Manhattan Comfort offers a 30-day parts replacement warranty on all items.

Our furniture products are not intended for outdoor use.

THE WARRANTY DOES NOT COVER:

- Defects/damages by improper assembly or disassembly.
- Defects/damages caused by inappropriate use of the furniture.



319 Ridge Rd. Dayton, NJ 08810

908-888-0818