

SPECIFICATIONS

PSI	120 MAX
LED	80 lumen (white light-Red SOS)
Battery	11.1V (3 x 2000mAh)
Charging	approx. 3 hours 5V3A
Accessories	<ul style="list-style-type: none">• 9.8 ft (3m) 12V DC Car Power Cord (with sound and light notification)• 6.3 in (16cm) air hose• 3.28 ft (1m) Type-C charging cable• 3 nozzle adapters, 1 sports needle and 1 spare fuse• storage bag

BATTERIES AND THE ENVIRONMENT

This product uses a Lithium Ion rechargeable battery. The battery pack is recyclable. At the end of the battery pack’s useful life, the unit should be recycled or properly disposed of. Do not discard in a landfill or with household waste material. Do not incinerate. Contact your local city officials for battery disposal information. In accordance with the law, electric tools which have reached the end of their life, must be collected separately and returned to an environmentally compatible recycling facility. Always store in a cool, dry place.



BULLSEYE™

RECHARGEABLE POCKET AIR PRO TIRE INFLATOR

INFLATES TIRES IN
2minutes*
from 28 to 34 PSI



INSTRUCTIONS

Thank you for buying the Bullseye Pocket Air Pro 12V Tire Inflator - the handheld air compressor that makes it quick and easy to inflate car tires and more! Bullseye™ 12V Tire Inflator uses powerful class leading air compressor technology to pull in outside air and compress it before pumping it into the tire.

It also features an auto-stop function that will automatically stop at your desired tire pressure, an independent battery level indicator that informs how much battery capacity is left available before needing a charge, and 4 nozzle attachments for a variety of uses in addition to several battery and power cable options.

PLEASE READ ENTIRE MANUAL BEFORE FIRST USE.

GENERAL SAFETY MEASURES AND PRECAUTIONS THAT APPLY TO THE USE OF THE BULLSEYE™.

Safe operation of the air compressor requires that you read the instructions and safety precautions carefully and follow all the instructions before using the air compressor.

1. The air compressor is designed for occasional use. Inflation over a long period will overheat the air compressor and may cause damage.
2. The air compressor should not operate for more than 15 minutes at a time, after which it must be switched off and set aside to cool for at least 15 minutes before restarting. Allow the unit to cool for 15 minutes after each 15 minutes of use.
3. If the air compressor emits abnormal sounds or overheats, turn it off immediately and let it cool off for a minimum of 30 minutes.
4. Inspect air compressor before use, If cracked, broken or damaged parts are found, qualified technicians should repair damaged parts.
5. Incorrect use of the air compressor may result in personal injury and/or property damage.
6. Never expose the air compressor to frost or to temperatures above 140°F (60°C). Change battery in dry conditions if possible (i.e. inside the car, garage, etc.)
7. Never use the air compressor near flammable fluids or gases. Make sure your working area is well-lit.
8. Protect yourself against electric shock. Avoid physical contact with grounded surfaces such as pipes, radiators, electric stoves, refrigerators, etc.
9. Never allow children to connect/disconnect the air compressor and never allow them to play with accessories.
10. Never allow anyone to pump air into mouth, ears, nose or any personal cavity of people or animals. The air compressor is not a toy.
11. Store air compressor in a secure location. If the air compressor is going to be unused for long periods of time, it should be stored in a dry place inaccessible to children.
12. Regularly check the charger cord. Never carry the charger by the cord and never pull the plug out of the outlet by jerking the cord. Make sure the cord is not exposed to hot objects, oil or sharp edges. Keep air compressor clean to maintain maximum output and safety. Examine the plug, charger, and cable pack on a regular basis and have them repaired by qualified technicians if they are damaged.

13. Unplug the 12V DC Car Power Cord from the cigarette lighter socket in your car when the air compressor is not in use.

14. Stay alert. Always pay attention to what you are doing when working with the air compressor.

15. **WARNING!** For your own safety, only use accessories and parts specified in these instructions or recommended for use by the manufacturer. Use of accessories and other parts that are not mentioned in these instructions may entail an increased risk for the user and the air compressor.

16. To reduce the risk of electric shock, do not immerse in water. Store indoors.

17. Risk of burning - Do not adjust the regulator to result in output greater than marked maximum pressure of attachment.

18. Do allow unit to cool down then do replace or discharge the attachments.

19. **WARNING:** Risk of injury - Do not direct compressor air stream at body.

20. Do not overinflate.

FOR HOUSEHOLD USE ONLY SAVE THESE INSTRUCTIONS

COMPONENTS

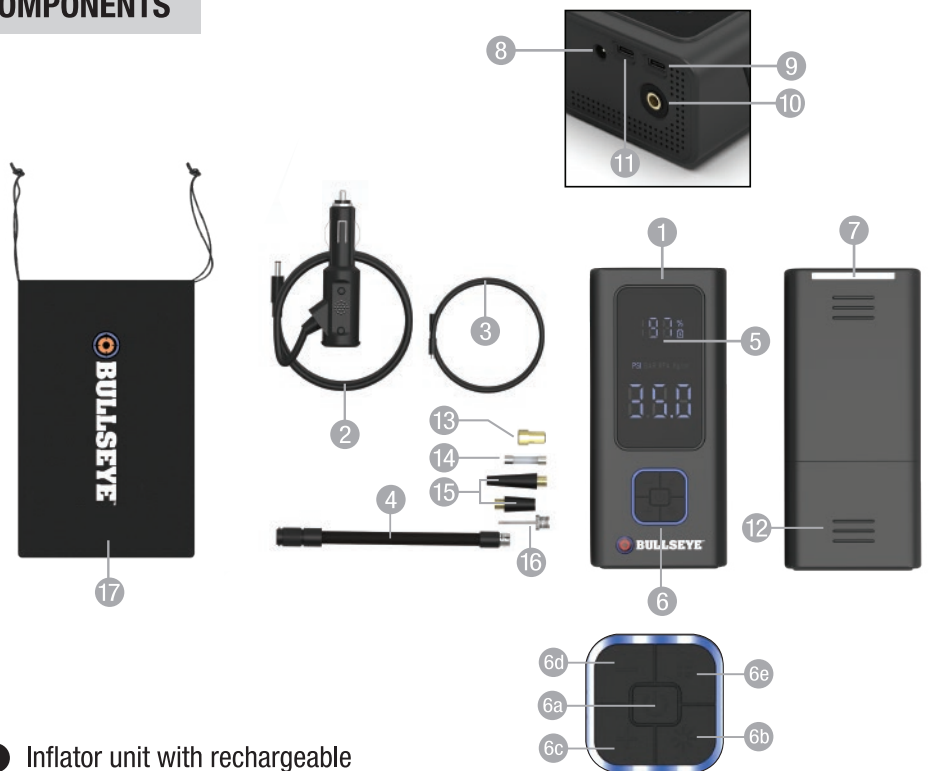

- 1 Inflator unit with rechargeable batteries
- 2 12V DC car power cord (9.8ft / 3M)
- 3 USB-C battery charging cord
- 4 Air hose with Schrader valve connector (6.3 in / 16cm)
- 5 Digital LCD display (Main display / Remaining battery % indicator)
- 6 Inflator Controls:
 - a. Unit/motor ON/OFF button
 - b. LED light ON/OFF button
 - c. Pressure increase (+) button
 - d. Pressure decrease (-) button
 - e. Mode button
- 7 LED light
- 8 12V DC car power cord port
- 9 USB-C battery charging port
- 10 Threaded 6.3" air hose connector port
- 11 USB-C (Output only) power bank
- 12 Nozzle accessory storage (slide cover down to access accessories)
- 13 Presta valve adapter
- 14 Spare fuse (15amp)
- 15 2 plastic nozzle adapters
- 16 Metal sports needle
- 17 Fabric carry bag

Please read and fully understand all of the instructions provided in this manual prior to operation.

POWERING UP YOUR BULLSEYE RECHARGEABLE TIRE INFLATOR

Bullseye Rechargeable Tire Inflator can be used with either 12V DC Car power cord or Inflator's internal battery.

VIA RECHARGEABLE BATTERY (FOR PORTABLE USE)

Important! Fully charge the inflator before first use.
Failure to fully charge the battery will result in shorter life, and worse performance.



IMPORTANT: Use a 5V3A adaptor for fastest charging. Using 5V2A will take longer to charge.

Insert USB-C end into the USB-C port on the top of the inflator (Input charging), then plug into any USB port.

- 2 During charging, the LCD display will show charging progress. Once the charging is complete, 100% will be displayed on the LCD panel. Disconnect the charging cord.



Gently pull the Air Hose with Schrader valve connector to remove it from the storage track located on the side of the unit.



Connect the threaded metal end to the Inflator. Screw it in clockwise.

NOTE:

- Run time will vary depending on the battery level, depending on the pressure load during use, and the operating conditions.
- High-pressure loading, or excessive back pressure will result in a shorter run-time than indicated.
- Cold temperature conditions will reduce battery run-time. We recommend connecting to the 12V DC Car Power Cord during cold temperatures while running the pump.

VIA THE 12V DC CAR POWER CORD



Gently pull the Air Hose with Schrader valve connector to remove it from the storage track located on the side of the unit.



Connect one end of the 12V DC Car Power Cord to the inflator.



Connect the threaded metal end to the Inflator. Screw it in clockwise.



- Connect the 12V DC Car Power Cord into the DC socket in your car.
- When ready to use, power the car on. The light on the end of the 12V DC Car Power Cord will light up green indicating power connection and LCD display will illuminate.
Note: Always operate vehicle outdoors.

WARNING: Use with 12V DC outlets 15 amps or higher. Do not use with 8 amp outlets. If unsure, check your vehicle's owner manual for your DC socket power rating.

INFLATION INSTRUCTIONS - Inflating tires

BEFORE USE: If you are using the internal battery for power, make sure your battery is fully charged. If you are connecting your unit via 12V DC Car Power Cord, make sure everything is connected correctly.

Please note: The Digital LCD Display must turn on before operating the Bullseye Rechargeable Tire Inflator. Please read and fully understand all of the instructions provided in this manual prior to operation.



On the Control Panel, **press and hold down the  button for 2 seconds** to turn the inflator on. The LED light around the controls will turn on blue and LCD display will light-up.
Note: After 1 min of inactivity, the power will turn off automatically to conserve battery energy.

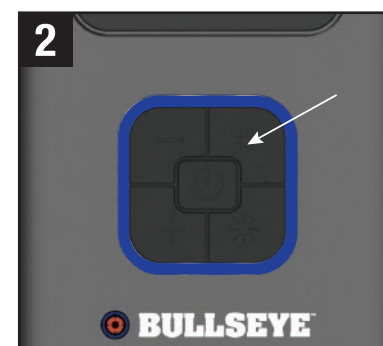

To choose and set the desired pressure format (PSI, BAR, KG/CM², KPA), press the  button continuously until the desired format displays.

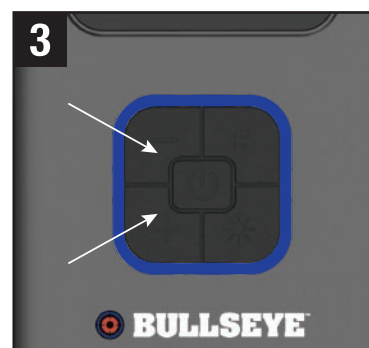

To preset the desired pressure, press the **+** or **-** buttons until the desired pressure level has been reached.

Note: To avoid over inflation of tires, always follow the recommended tire pressure in the vehicle's owner manual or door jamb. For bicycle tires, check markings on tire.





Remove valve cover (if needed). Attach the end of the Schrader valve connector onto the tire's valve stem quickly.



Press the  button to start the pump motor. The inflator will begin to inflate the tire to the set pressure level, the LED light around the controls will flash while inflating. Inflator will shut-off automatically when preset setting is reached.

FOR 12V DC USE: Press the  button to start the pump motor and the light on the end of the 12V DC Car Power Cord will turn red. The Inflator will begin to inflate the tire to the set pressure level. Once it has been reached, the inflator will turn off by itself, the light on the end of the 12V DC Car Power Cord will flash green and a long beep will sound. The beeping sound will remain for up to 5 minutes and will turn off automatically unless the 12V DC Car Power Cord is unplugged from the power source sooner.

Note: To shut-off the pump motor manually, press the  button and the unit will turn off. To turn the motor back on, press the  button again.

6 Once your tire inflation is complete and the motor is off, disconnect the air hose from the tire stem valve quickly and place the valve stem cover back on.

WARNING: Air hose connector may be hot. Use caution when removing.

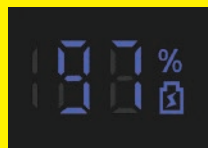

NOTE: Digital Battery Level % will decrease during use and then rebound after a short rest period. This is normal.

INFLATION INSTRUCTIONS – Inflating with additional tips

1



To access the additional adapters, slide the nozzle accessory storage cover down.

Follow steps 1-3 on page 6 to get the inflator ready.

2

Attach the selected nozzle accessory into the Schrader valve connector.

Plastic Narrow and Wide Adapter - Use for inflatables & more.

Sports Needle Adapter - Use for balls, sport equipment & more.

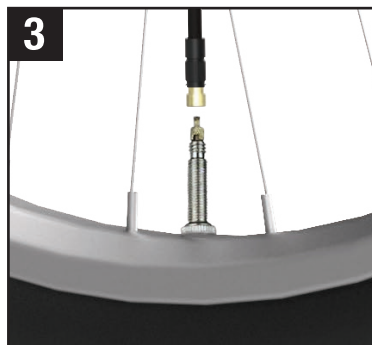
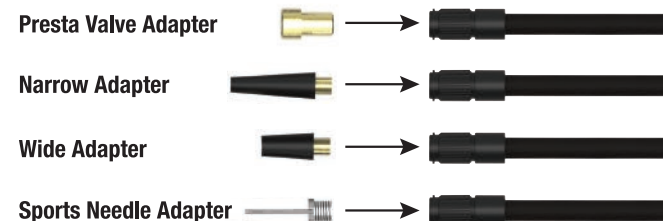

Presta Valve Adapter - Use for bikes with Presta valve.



- Remove valve cover (if needed).
- Unscrew the brass washer and gently depress it a couple of times.
- Attach the end with Presta valve adapter onto the tire's valve stem.



Press the  button to start the pump motor. The inflator will begin to inflate the tire to the set pressure level, and shut-off automatically when reached.

Note: To shut-off the pump motor manually, press the  button and the unit will turn off. To turn the motor back on, press the  button again.

- 5** • Once your tire inflation is complete and the motor is off, remove the Quick Connector with Presta valve adapter from the tire stem valve and screw in the brass washer. Place the cover back on (if needed).

WARNING: Air hose connector may be hot. Use caution when removing.

- Remove the nozzle accessory from the Air Hose Quick Connector and return the accessory nozzle to the original location in the Nozzle accessory storage compartment.

LED LIGHT

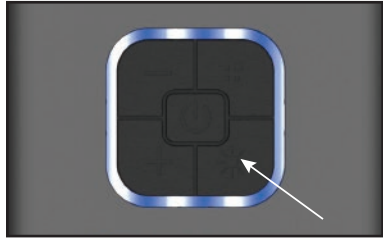

In the case of poor light conditions, press the ☀ button to turn on the built-in LED light.

REPLACING THE FUSE (in case of a blown fuse in the 12V DC car power cord)

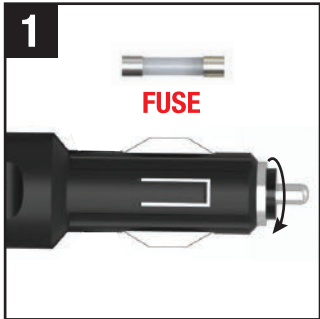

Carefully unscrew the front washer from the 12V DC Car Power Cord (it is spring loaded).

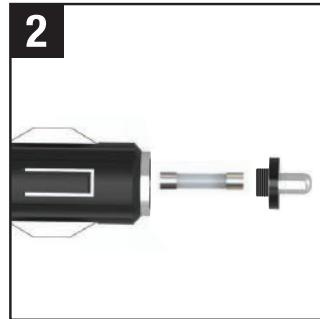

Remove and discard the old fuse. Insert the new fuse (either end).

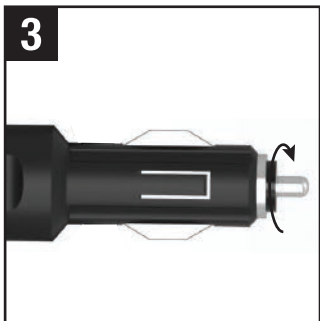

Place the washer back on and tighten it. Do not overtighten. Do not use tools.

POWER BANK (Use any USB-C cable)



You may use the power bank feature to power up your smartphone. This will not fully charge your phone, but will provide some emergency charge if the phone has run out of power.

To charge your phone or other USB-C supported chargeable device, insert a USB-C Cable into the indicated USB-C Output charging port (see diagram on p.3) and the other end into your phone or device. Your phone/device should display the charging process.

PACKING INSIDE STORAGE CASE

NOTE: Make sure the inflator has been turn off and the air hose has been disconnected.



Place the air hose with Schrader valve connector into the storage track located on the side of the unit.

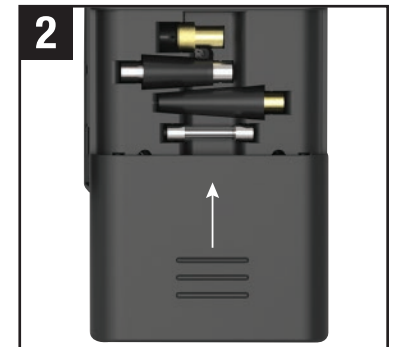

Store nozzle accessories in the nozzle accessory storage compartment. Snap into place and slide the cover to close.



Insert the Bullseye™ Tire Inflator into the storage bag, then pack the rest of the accessories next to the unit.