

**Prerequisites** Previously had set up Smart Lights Wi-Fi for voice control with Alexa and or Google Voice Assistant with the Legrand Smart Lights, Wi-Fi Products

### Alexa

**Disabling** Alexa from the Samsung Artik Connector in preparation for the new Legrand Alexa Connector

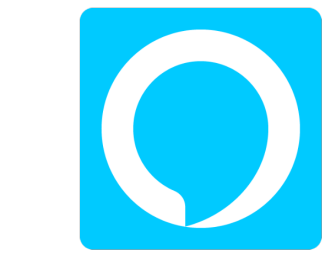

Open the app

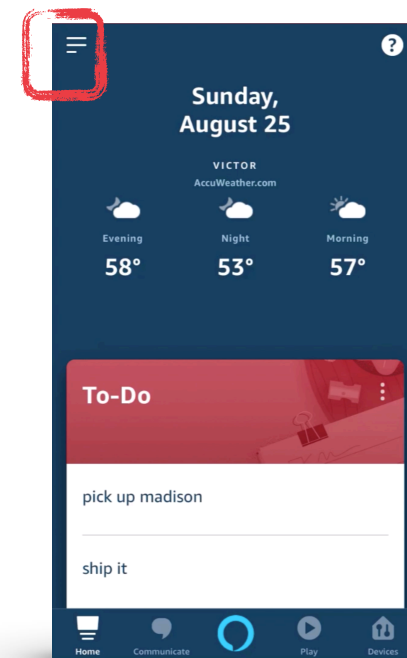

1. Open the Alexa app and click the hamburger in the upper left

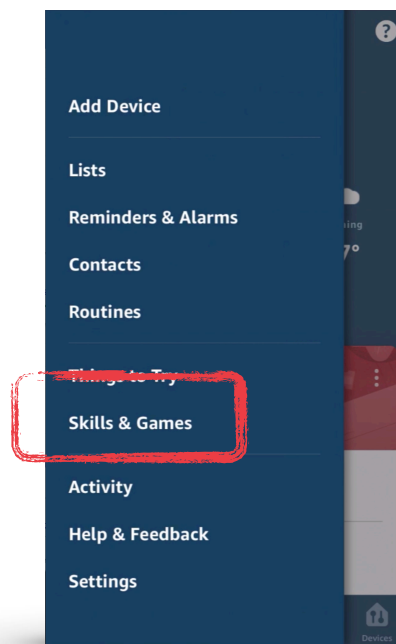

2. Select Skills & Games

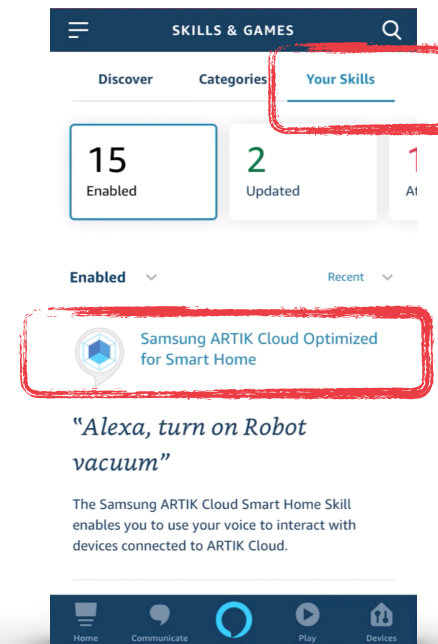

3. Click on your skills and find the Samsung Artik Connector and click it

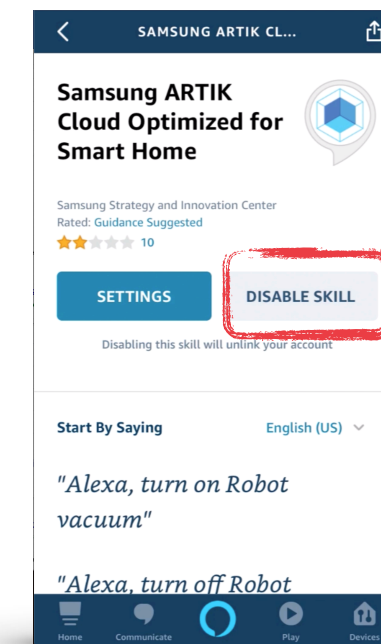

4. Click Disable Skill

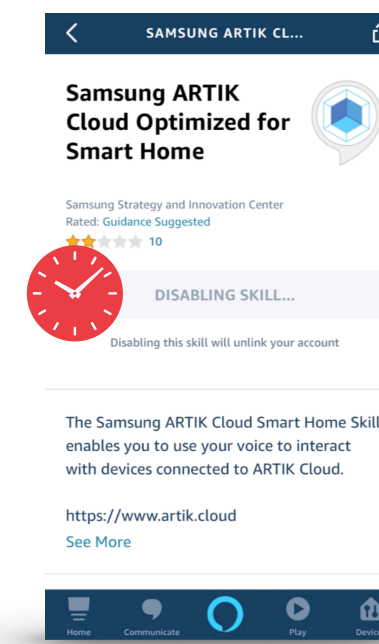

5. Wait a few moments as the skill is disabled

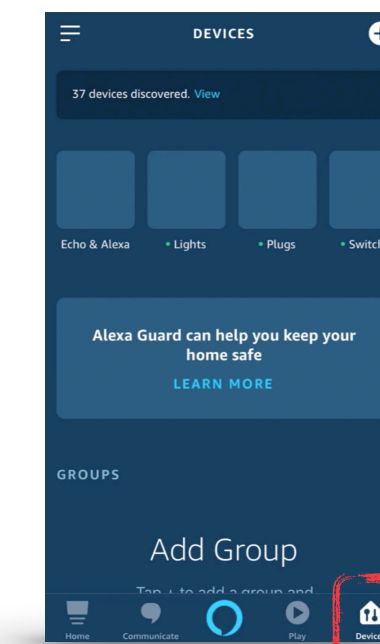

6. Click Devices and find any of the Legrand Smart Lights Wi-Fi devices that were connected via the Artik Connector

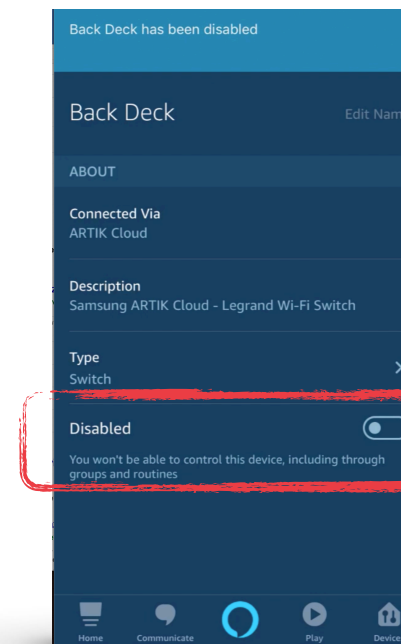

7. Click Disable.

Do this for each Legrand Wi-Fi device you had connected via the Samsung Artik Connector

Go to new Legrand Alexa Instructions

### Google Home

**Disabling** Google Assistant from the Samsung Artik Connector in preparation for the new Legrand Google Assistant Connector



Open the app

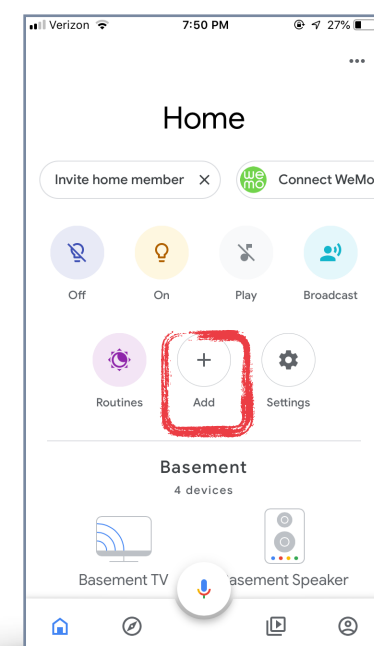

1. Open the Google Home app and click the ADD + sign

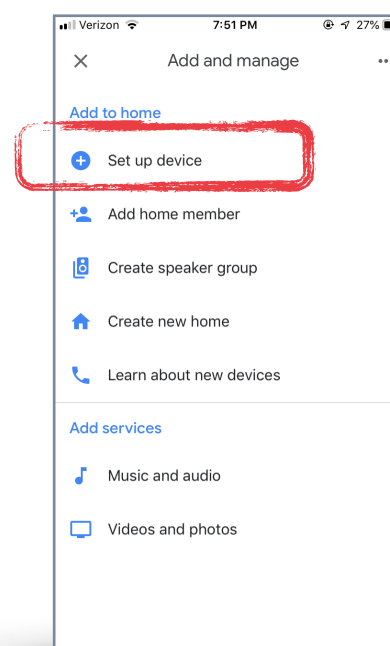

2. Select Set up device

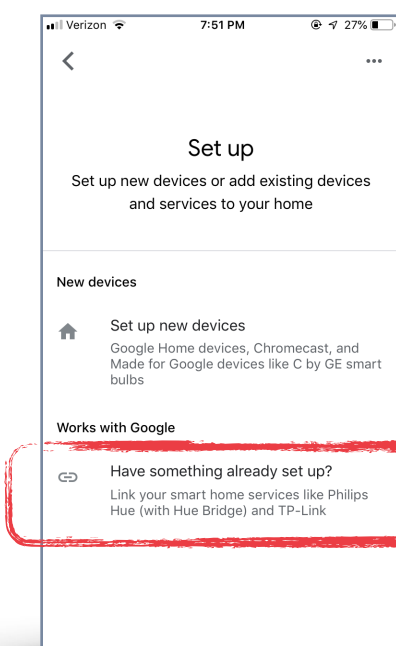

3. Click on "Have something already set up"

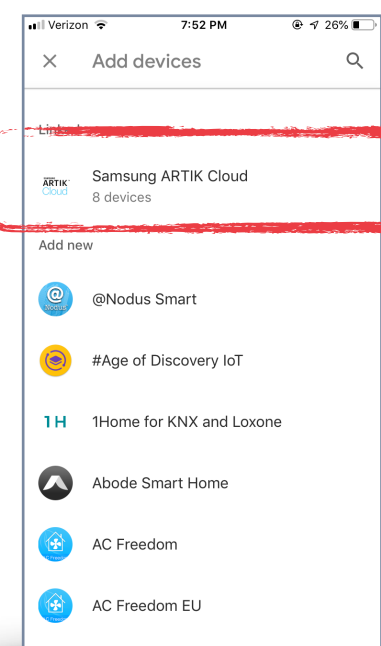

4. Click Samsung Artik Cloud

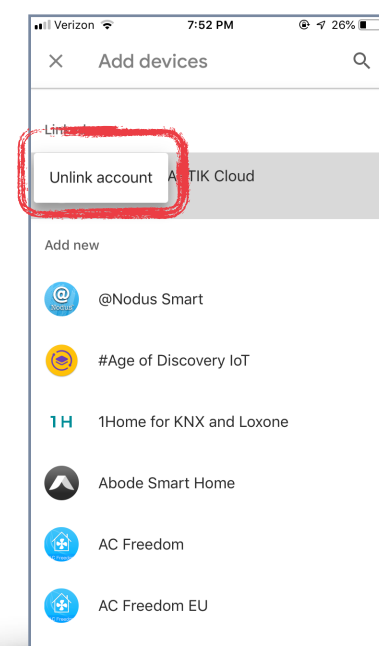

5. Click Unlink Account

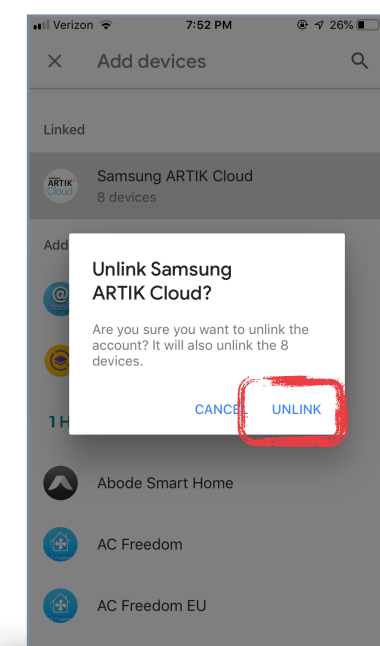

6. Click Unlink to remove the Samsung Artik Cloud Connector

Go to new Legrand Google Instructions

### Prerequisites

Users enabling voice control of the Legrand Wi-Fi Smart Lighting through Amazon Alexa require the following:

- An Alexa device like an Echo. (The Alexa App can now also work like an Alexa physical device)
- A Smartphone or tablet running the latest version of the Amazon Alexa App
- An Internet connection
- The Legrand Smart Lights Wi-Fi app already setup
- Smart Lights Wi-Fi Legrand credentials used with the Wi-Fi Smart Lights App
- *If you forgot the password on the Legrand account you setup you can request a new one here.... <https://myconnectedaccount.legrand.com>*

#### A Connecting Alexa to the Smart Lights, Wi-Fi system

1. Open the Alexa app, click  and select **Skills**
2. Search for **Legrand Lighting Controls**

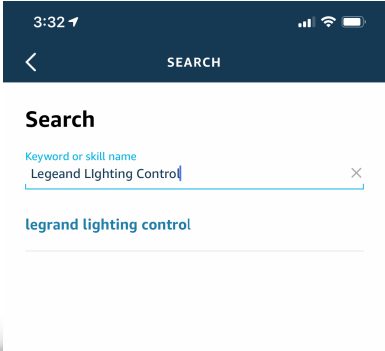
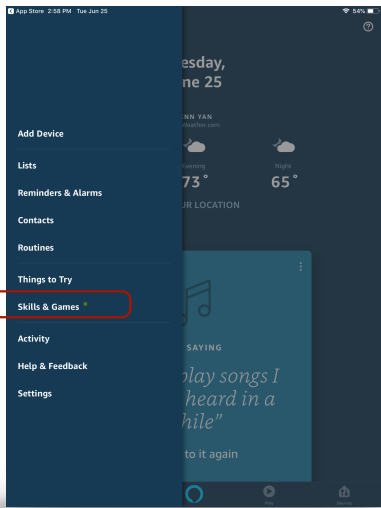

#### B 3. Select the **Legrand Lighting Control** Skill

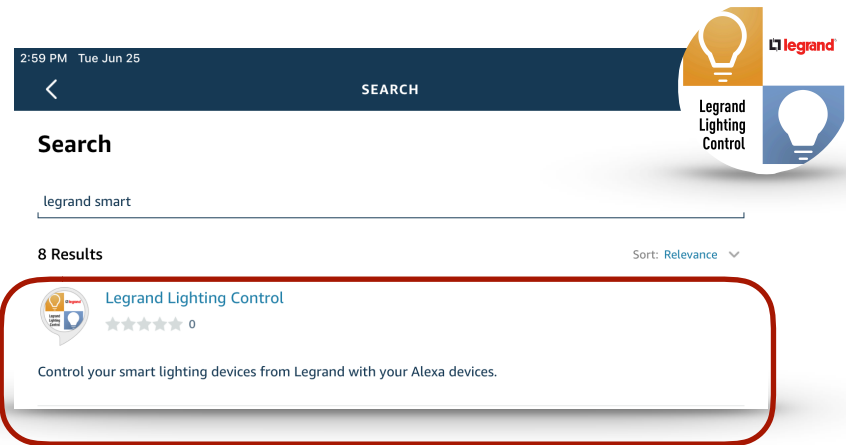

#### 4. Select **Enable To Use**

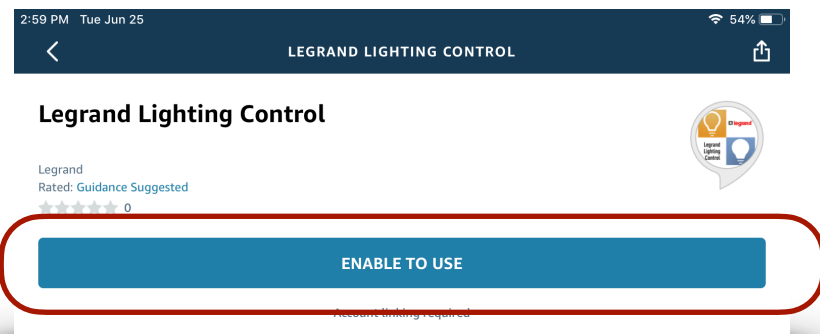

#### C 5. Sign into the same **Legrand Account** you recently created in the Smart Lights Wi-Fi App.

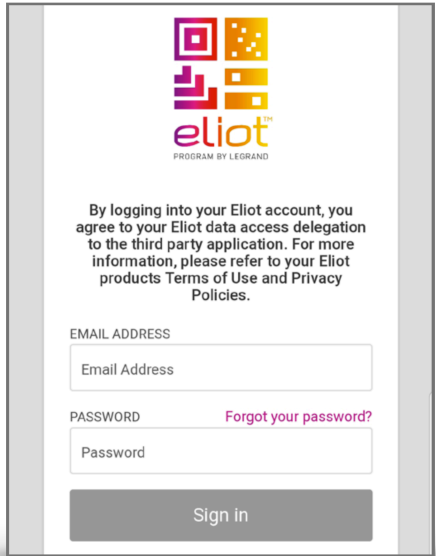
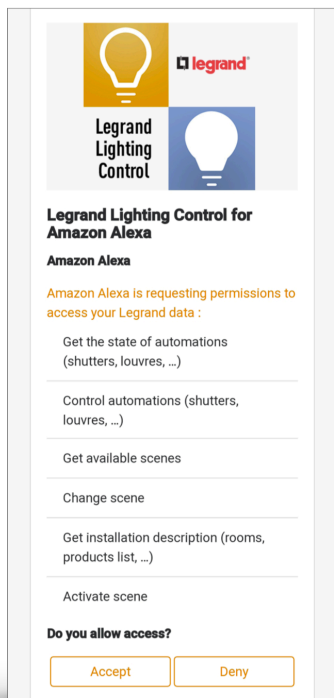

#### 6. Click **Accept** to grant Alexa the ability to communicate and control your Smart Lights Wi-Fi devices.

#### D 7. Choose **Discover Devices** to import your Smart Lights Wi-Fi devices into Alexa

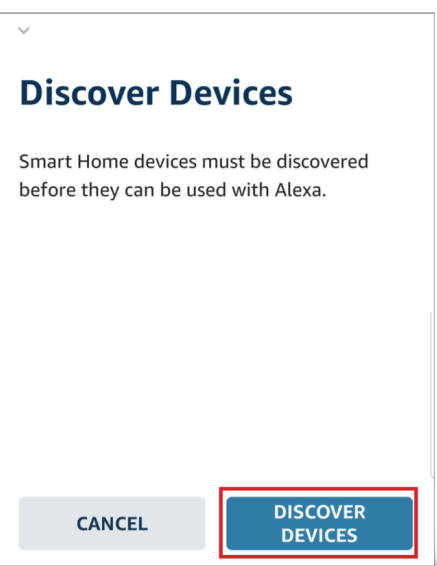

- NOTES:**
- Device Discovery can take up to 45 seconds
  - Any time a new device is added discovery needs to happen
  - Anytime a device name changes device discovery needs to happen. Just say "Alexa discover my devices".

#### E

### Grouping Discovered Devices

Use the Alexa app to designate groups of Legrand Lighting Control System devices. Groups allow control of multiple devices using a single Alexa command.

Alexa supports both switching and dimming commands. Switching commands simply activate and deactivate devices. Dimming commands allow various levels of control to be applied to the devices.

**Example:** A group named "basement" can have multiple devices located in the basement assigned to the group for control at one time.

**NOTE:** Dimming commands only activate dimmable devices. While all dimmable and non-dimmable devices in the same group respond to switching commands, only the dimmable devices can respond to dimming commands.

#### F

### Create a Group

1. Select Devices in lower right of app
2. Select PLUS in upper right and click Add Group
3. Name your Group

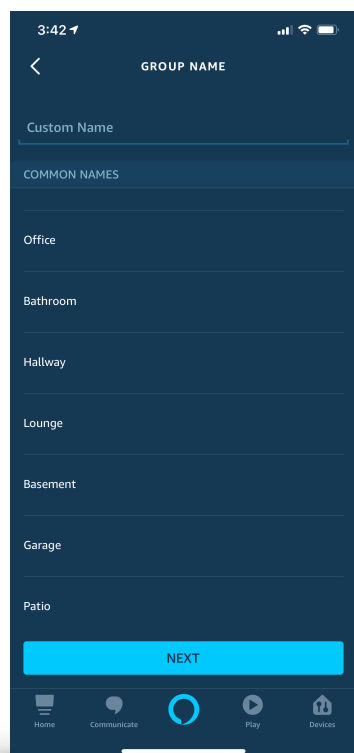
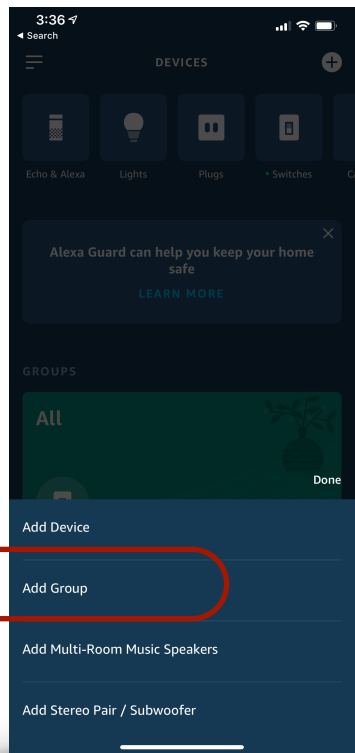
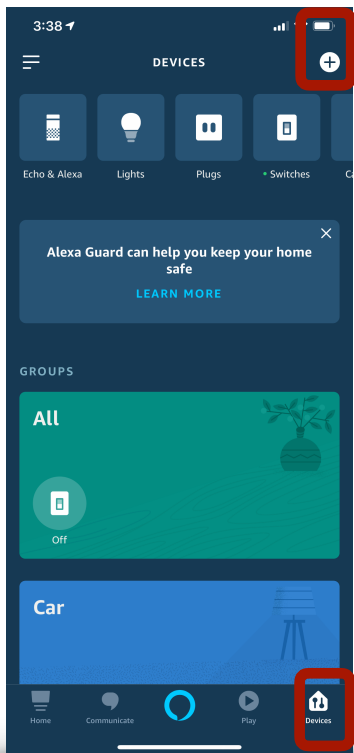

4. Select Devices & Save

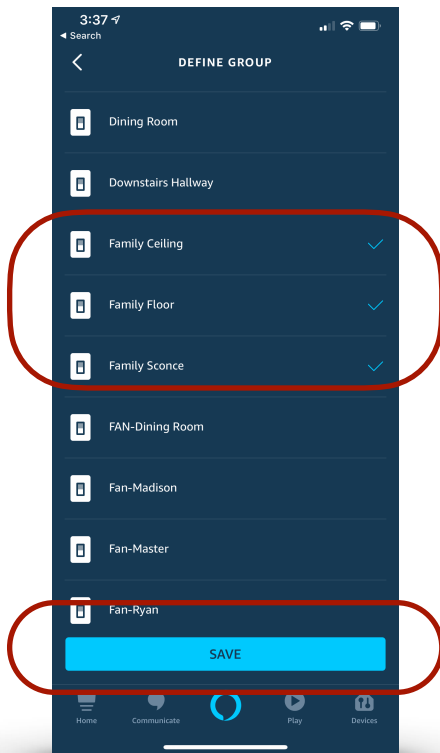

#### G

### Post Setup

**If you ever add a new device or change the name of a device, you need to let Alexa know of the changes**

**Say "Alexa discover my devices"**

*Usually takes about a minute... just sit back and relax. She will find new devices and update the names in her database*



Prerequisites

Users enabling voice control of the Legrand Smart Lights Wi-Fi system through Google Home require the following:

- A Google Home Device
- A smartphone or tablet running the latest version of the Google Home App
- An Internet connection
- The Legrand Smart Lights Wi-Fi app 2.0 or later already setup
- Smart Lights Wi-Fi Legrand credentials used with the Wi-Fi Smart Lights App
  - *If you forgot the password on the Legrand account you setup you can request a new one here....*  
*<https://myconnectedaccount.legrand.com>*

A Connecting Google Home to Smart Lights Wi-Fi *(After Aug 25, 2019)*

1. Open the Google Home App



2. Choose **Add +**

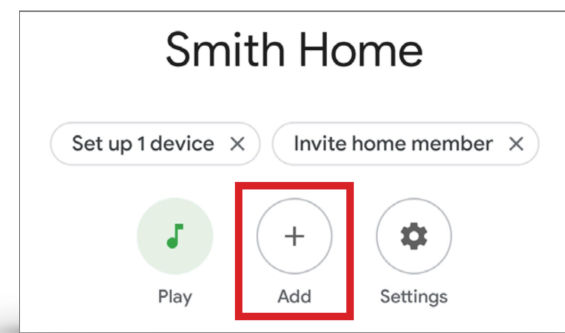

3. Select **Set up device.**

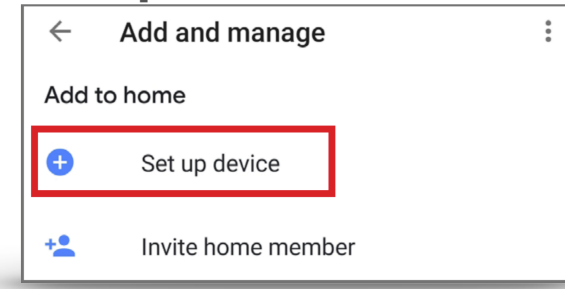

B

4. On the Setup Page select **Works With Google... Have something already set up?**

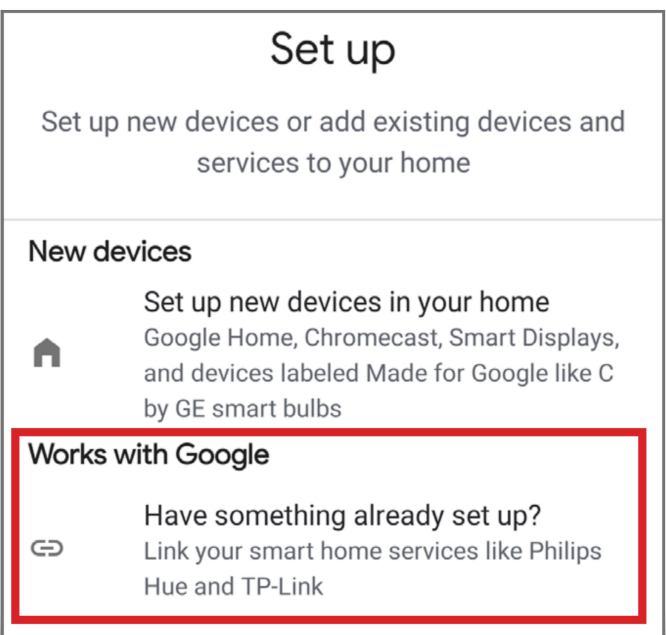

5. On the Manage Accounts page, Search for **Legrand Lighting Control**

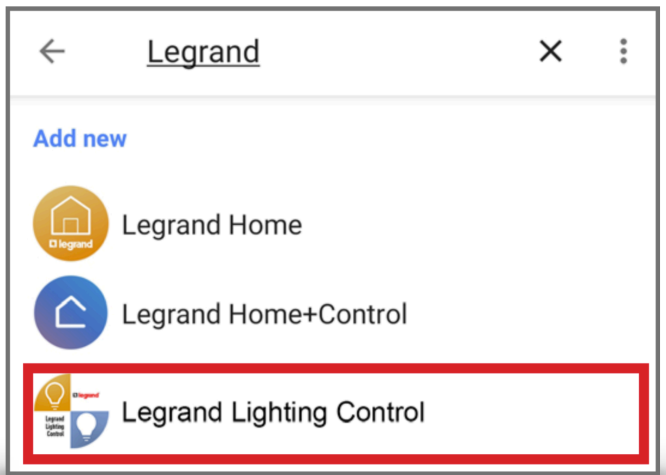

C

6. Sign into the same **Legrand Account** you recently created in the Smart Lights App.

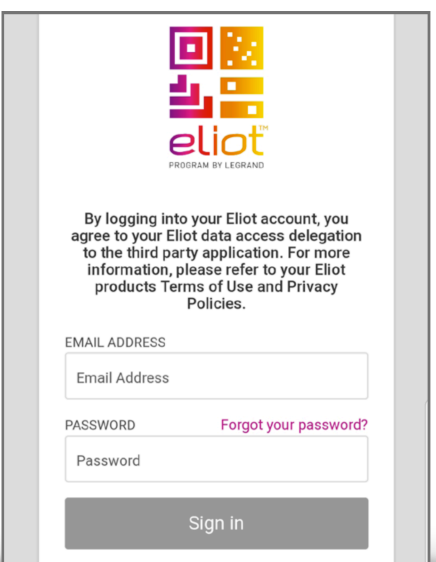

7. Click **Accept** to grant Google the ability to communicate and control your Smart Lights Wi-Fi devices

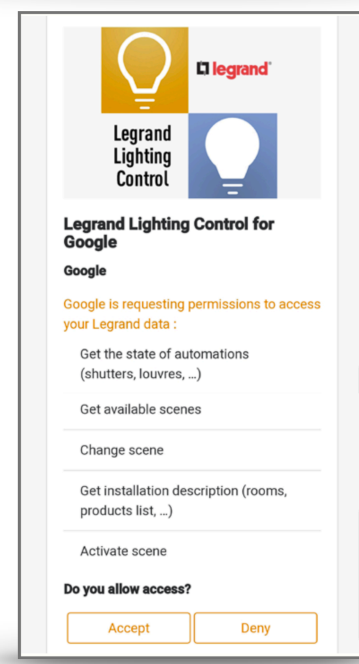

D

7. All Done. Return to the home screen to see your added devices. Google will now prompt you to link devices into rooms in your house

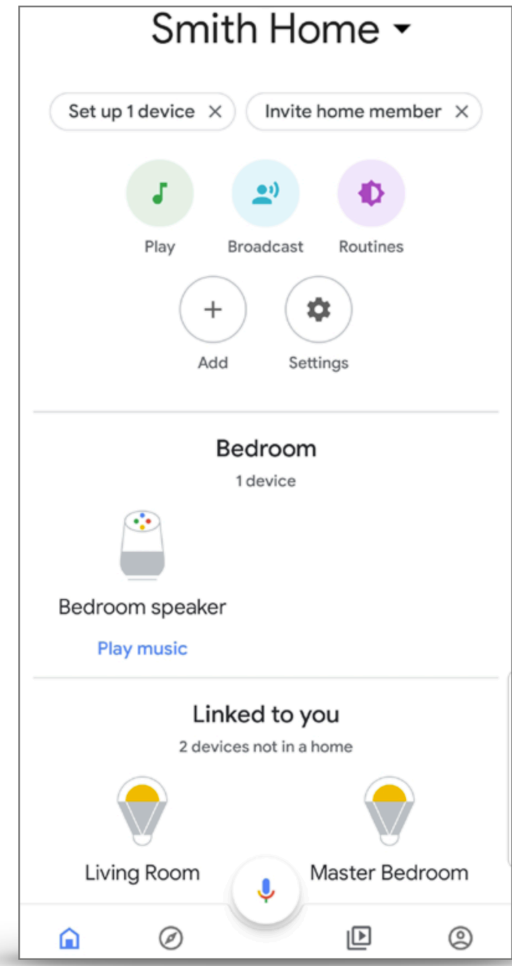

E

Assigning devices

Google Home supports the control of Legrand Lighting Control System devices, and other enabled devices, with a single voice command using the **ROOMS** tab.

For details on setting up rooms, follow Step 4 of the instructions on the Google support site at <https://support.google.com/googlenest/answer/9159862?hl=ent>

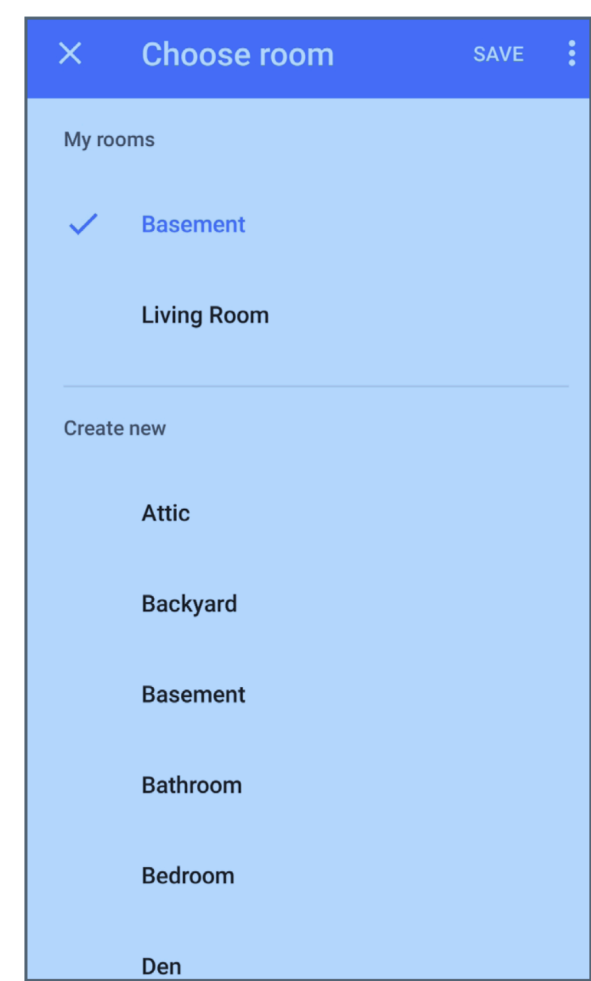
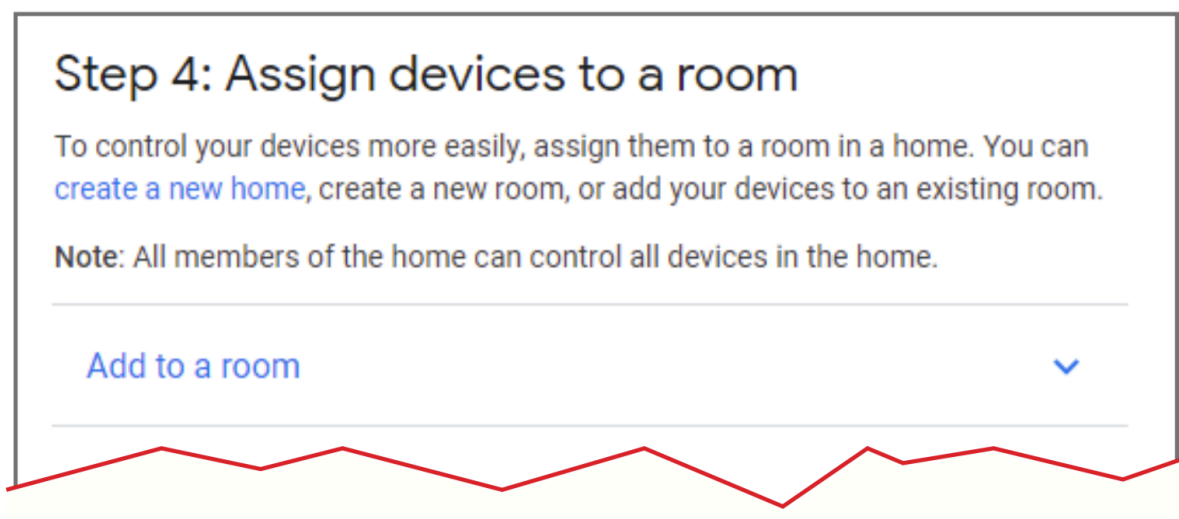

F

Supported Commands

Use the following supported control commands to change the light level for your controlled devices.

To turn a light ON/OFF

Ok Google, turn on < light/room name >

Dim a light  
(Results in an adjustment level of 45% for dimmable devices)

Ok Google, dim the < light/room name >

Brighten a light  
(Results in an adjustment level of 45% for dimmable devices)

Ok Google, brighten the < light/room name >

Set a light brightness to a certain percentage

Ok Google, set < light/room name > to 50%

Dim/Brighten lights to a certain percentage

Ok Google, dim/brighten < light/room name > to 50%

Turn ON/OFF all the lights

Ok Google, turn < on/off > everything

G

Post Setup

If you ever add a new device or change the name of a device, you need to tell Google about it so it can be controlled

Say “Hey Google sync my device”

*Note: Google, Google Home, and all related logos are trademarks of Google, Inc. or its affiliates.*