

# KOBALT™

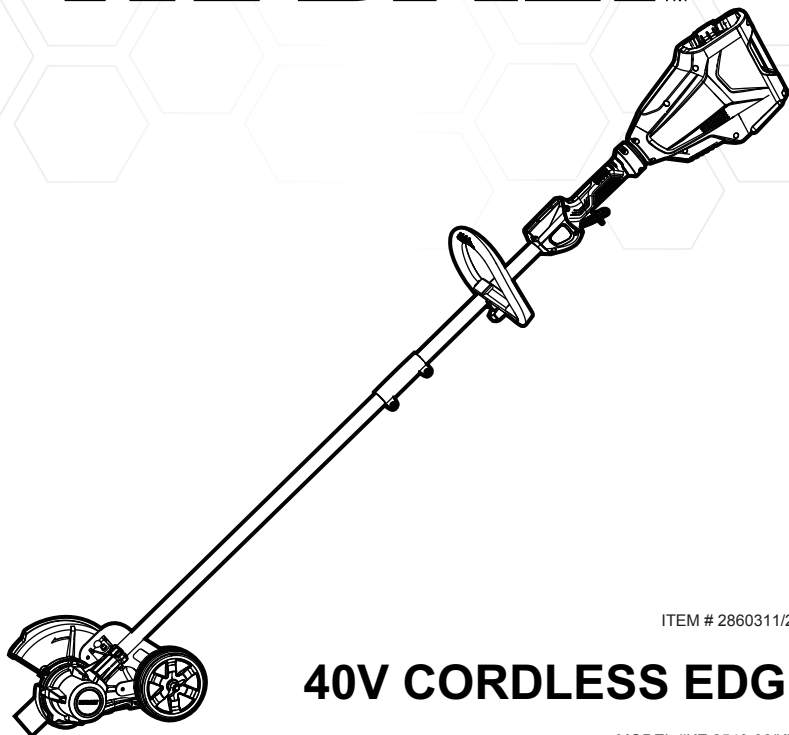

ITEM # 2860311/2624980

## 40V CORDLESS EDGER

MODEL #KE 2540-06/KE 840-06

KOBALT and K & Design are trademarks or registered trademarks of LF, LLC. All rights reserved.

Español p. 18

---

ATTACH YOUR RECEIPT HERE

Serial Number \_\_\_\_\_ Purchase Date \_\_\_\_\_

---



**Questions, problems, missing parts?** Before returning to your retailer, call our customer service department at **1-888-3KOBALT** (1-888-356-2258), 8 a.m. - 8 p.m., EST, Monday - Sunday.

VR20338

**TABLE OF CONTENTS**

---

Product Specifications..... 2

Package Contents..... 3

Hardware Contents..... 4

Symbols..... 5

Safety Information..... 7

Preparation ..... 9

Assembly Instructions ..... 10

Operating Instructions ..... 12

Care and Maintenance ..... 14

Troubleshooting..... 16

Warranty..... 16

Replacement Parts List ..... 17

**PRODUCT SPECIFICATIONS**

---

SPECIFICATIONS	
Type	Cordless, battery-powered
Speed	6500 ±10% RPM
Blade Length	8 in (203 mm)
Weight without battery	10.1 lb (4.6 kg)

**PACKAGE CONTENTS**

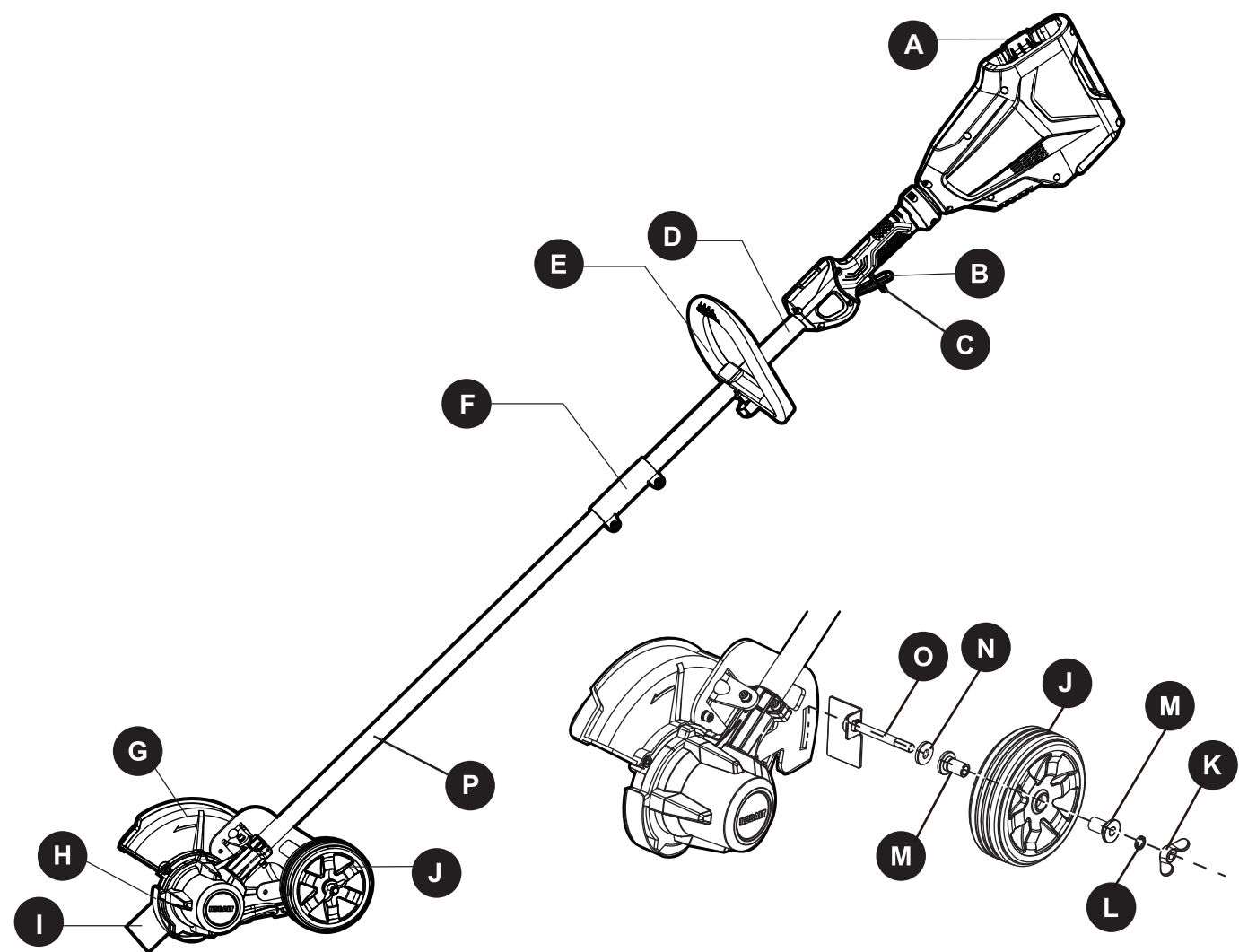

PART	DESCRIPTION	QUANTITY
A	Battery Release Button	1
B	Trigger	1
C	Safety lock-out Lever	1
D	Upper tube	1
E	Front/Auxiliary Handle	1
F	Coupler	1
G	Guard	1
H	Skid Plate	1
I	Blade	1
J	Edger Wheel	1

PART	DESCRIPTION	QUANTITY
K	Wing Nut	1
L	Washer	1
M	Axle sleeve	1
N	Rubber washer	1
O	Wheel axle	1
P	Lower tube	1

**HARDWARE CONTENTS** (not shown actual size)

---

**AA**

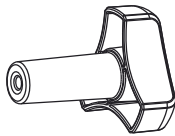

Fastening Knob

Qty. 1

**BB**



Bolt

Qty. 1

**CC**



Bracket

Qty. 1

**DD**



Wrench

Qty. 1

**EE**



Metal rod

Qty. 1

**FF**









Hex Wrench

Qty. 1



## SYMBOLS

Some of the following symbols may be used on this product. Please study them and learn their meaning. Proper interpretation of these symbols will allow you to operate the product better and safer.

SYMBOLS	DESIGNATION	EXPLANATION
V	Volts	Voltage
A	Amperes	Current
Hz	Hertz	Frequency (cycles per second)
W	Watts	Power
min	Minutes	Time
---	Direct Current	Type or a characteristic of current
$n_0$	No Load Speed	Rational speed, at no load
/min	Per Minute	Revolutions, strokes, surface speed, orbits, etc., per minute.
	Wet Conditions Alert	Do not expose to rain or use in damp locations.
	Read the Operator's Manual	To reduce the risk of injury, user must read and understand operator's manual before using this product.
	Eye Protection	Wear eye protection with side shields that are marked to comply with ANSI Z87.1 when operating this equipment.
	Safety Alert	Precautions that involve your safety.
	Ricochet	Thrown objects can ricochet and result in personal injury or property damage.
	Keep Bystanders Away	Keep all bystanders at least 50 ft away.

## SYMBOLS

### Save these Instructions

The following signal words and meanings are intended to explain the levels of risk associated with this product.

SYMBOL	SIGNAL	MEANING
	DANGER	Indicates an imminently hazardous situation, which, if not avoided, will result in death or serious injury.
	WARNING	Indicates a potentially hazardous situation, which, if not avoided, could result in death or serious injury.
	CAUTION	Indicates a potentially hazardous situation, which, if not avoided, may result in minor or moderate injury.
	CAUTION	(Without Safety Alert Symbol) Indicates a situation that may result in property damage.

## WARNING

- To avoid serious personal injury, do not attempt to use this product until you have read this Owner's Manual thoroughly and understand it completely. If you do not understand the warnings and instructions in this Owner's Manual, do not use this product. Call 1-888-356-2258 for assistance.
-  The operation of any power tool can result in foreign objects being thrown into your eyes, which can result in severe eye damage. Before beginning power tool operation, always wear safety goggles or safety glasses with side shields and, when needed, a full face shield. We recommend a wide vision safety mask for use over eyeglasses or standard safety glasses with side shields. Always use eye protection which is marked to comply with ANSI Z87.1.



## SAFETY INFORMATION

---



### WARNING

Read and understand all instructions before using this product. Failure to follow all instructions listed below may result in electric shock, fire, and/or serious personal injury.

- Do not operate power tools in explosive atmospheres, such as in the presence of flammable liquids, gases, or dust. Power tools create sparks that may ignite the dust or fumes.
- Do not allow children or untrained individuals to use this unit.
- Don't expose power tools to rain or wet conditions. Water entering a power tool will increase the risk of electric shock.
- Do not handle battery or tool with wet hands.
- Never allow children to operate the equipment. Never allow adults to operate the equipment without proper instruction.
- Always wear safety glasses with side shields that are marked to comply with ANSI Z87.1. Everyday glasses have only impact resistant lenses. They are NOT safety glasses. Following this rule will reduce the risk of eye injury. Use face mask if operation is dusty.
- Don't use in the rain. Store indoors.
- Do not operate in poor lighting.
- Keep all parts of your body away from any moving part.
- Prevent unintentional starting. Ensure the switch is in the off-position before connecting to battery pack, picking up or carrying the appliance. Carrying the appliance with your finger on the switch or energizing appliance that have the switch on invites accidents.
- Do not force tool. Use the correct tool for your application. The correct tool will do the job better and safer at the rate for which it is designed.
- Do not operate the equipment while bare foot or when wearing sandals or similar lightweight footwear. Wear protective footwear that will protect your feet and improve your footing on slippery surfaces.
- Keep firm footing and balance. Do not overreach. Overreaching can result in loss of balance.
- Check Damaged Parts – Before further use of the appliance, a guard or other part that is damaged should be carefully checked to determine that it will operate properly and perform its intended function. Check for alignment of moving parts, binding of moving parts, breakage of parts, mounting and any other condition that may affect its operation. A guard or other part that is damaged should be properly repaired or replaced by an authorized service center unless indicated elsewhere in this manual.
- Keep guards in place and in working order.
- Keep hands and feet away from cutting area.
- Do not allow to be used as a toy. Close attention is necessary when used by or near children.
- Do not use tool if switch does not turn it on or off. Any tool that cannot be controlled with the switch is dangerous and must be repaired.
- Keep all bystanders, children, and pets at least 50 ft. away.
- Do not operate this unit when you are tired, ill, or under the influence of alcohol, drugs, or medication.
- Do not put any object into openings. Do not use with any opening blocked; keep openings free.
- Check the work area before each use. Remove all objects such as rocks, broken glass, nails, wire, or string which can be thrown or become entangled in the machine.
- Use only identical manufacturer's replacement parts and accessories. Use of any other parts may create a hazard or cause product damage.



## SAFETY INFORMATION

---

- Do not charge battery in the rain, or damp or wet locations. Following this rule will reduce the risk of electric shock.
- For household use only.
- Battery tools do not have to be plugged into an electrical outlet; therefore, they are always in operating condition. Be aware of possible hazards when not using your battery tool or when changing accessories. Following this rule will reduce the risk of electric shock, fire, or serious personal injury.
- Remove or disconnect battery before servicing, cleaning or removing material from the gardening appliance.
- Use only Kobalt 40-volt batteries. (KB 2540C-06, KB 240C-06, KB 340C-06, KB 440C-06, KB 540C-06, KB 640C-06).
- Use only Kobalt 40-volt charger. (KRC 40-06, KRC 60-06).
- Use appliances only with specifically designated battery packs. Use of any other battery packs may create a risk of injury and fire.
- Store idle appliances - When not in use, the edger should be stored indoors in a dry, locked place out of the reach of children.
- Do not dispose of the batteries in a fire. The cell may explode. Check with local codes for possible special disposal instructions.
- Do not open or mutilate the batteries. Released electrolyte is corrosive and may cause damage to the eyes or skin. It may be toxic if swallowed.
- Do not place battery tools or their batteries near fire or heat. This will reduce the risk of explosion and possibly injury.
- Batteries can explode in the presence of a source of ignition, such as a pilot light. To reduce the risk of serious personal injury, never use any cordless product in the presence of an open flame. An exploded battery can propel debris and chemicals. If exposed, flush with water immediately.
- Do not crush, drop or damage battery. Do not use a battery or charger that has been dropped or received a sharp blow. A damaged battery is subject to explosion. Properly dispose of a dropped or damaged battery immediately.
- Exercise care in handling batteries in order not to short the battery with conducting materials such as rings, bracelets, and keys. The battery or conductor may overheat and cause burns.
- Under extreme usage or temperature conditions, battery leakage may occur. If liquid comes in contact with your skin, wash immediately with soap and water, then neutralize with lemon juice or vinegar. If liquid gets into your eyes, flush them with clean water for at least 10 minutes, then seek immediate medical attention. Following this rule will reduce the risk of serious personal injury.
- If the charger power supply cord is damaged, it must be replaced only by the manufacturer or by an authorized service center to avoid risk.
- Maintain tool with care. Keep all vents and openings clean and clear of debris. Follow instructions for proper maintenance. Do not attempt to clear clogs from tool without first switching it off and removing the battery.



## SAFETY INFORMATION

---

- Dress Properly – Do not wear loose clothing or jewelry. They can be caught in moving parts. Use of rubber gloves and substantial footwear is recommended when working outdoors. Wear protective hair covering to contain long hair.
- Use the Correct Appliance – Do not use appliance for any job except that for which it is intended.
- When battery pack is not in use, keep it away from other metal objects like paper clips, coins, keys, nails, screws or other small metal objects that can make a connection from one terminal to another. Shorting the battery terminal together may cause burns or a fire.
- Do not expose a battery pack or appliance to fire or excessive temperature. Exposure to fire or temperature above 265°F may cause explosion.
- Follow all charging instructions and do not charge the battery pack or appliance outside of the temperature range specified in the instructions. Charging improperly or at temperatures outside of the specified range may damage the battery and increase the risk of fire.
- Have servicing performed by a qualified repair person using only identical replacement parts. This will ensure that the safety of the product is maintained.
- Do not modify or attempt to repair the appliance or the battery pack (as applicable) except as indicated in the instructions for use and care.
- Don't grasp the exposed cutting blades or cutting edges when picking up or holding the appliance.
- Ambient temperature range:
  - Edger storage temperature range: 32°F (0°C) - 113°F (45°C)
  - Edger operation temperature range: 32°F (0°C) - 113°F (45°C)
  - Battery charging temperature range: 39°F (4°C) - 104°F (40°C)
  - Charger operation temperature range: 39°F (4°C) - 104°F (40°C)
  - Battery storage temperature range: 32°F (0°C) - 113°F (45°C)
  - Battery discharging temperature range: 32°F (0°C) - 113°F (45°C)

### Child safety

Tragic accidents can occur if the operator is not aware of the presence of children.

- Keep children out of the working area and under the watchful care of a responsible adult.
- Do not allow children under the age of 14 to operate this Edger. Children who are 14 years of age or older must read and understand the operating instructions and safety rules in this manual and must be trained and supervised by a parent.
- Stay alert and turn the device off if a child or any other person enters the working area.
- Look behind and down for small children before and while cutting backwards.
- Use extreme care when approaching blind corners, doorways, shrubs, trees, or other objects that may obscure your view of a child who may run into the path of the Edger.

## SAVE THESE INSTRUCTIONS

### PREPARATION

---

Before beginning assembly of product, make sure all parts are present. Compare parts with package contents list and hardware contents list. If any part is missing or damaged, do not attempt to assemble the product.

**Estimated Assembly Time:** 5-10 minutes

## ASSEMBLY INSTRUCTIONS

### WARNING

To avoid injury and to reduce the risk of electrical shock or fire:

- Replace the battery or charger immediately if the battery case or charger cord is damaged.
- Always make sure the safety lock-out switch is OFF before inserting or removing the battery.
- Always make sure the battery is removed and the switch turned OFF before inspecting, adjusting, or maintaining any other part of the edger.
- Read, understand, and follow the Battery Charger instructions.



### WARNING

To avoid injury, adjust the auxiliary handle for optimum control and balance. Do not overreach when operating grass edger. Keep proper balance at all times for better control of the tool in unexpected situations.

#### 1. Connect upper/lower trimmer tubes

- a. Push in the release button located on the lower tube (P). Align the release button with the positioning hole on the upper tube (Q) and slide the two tubes together. Rotate the lower tube until the release button locks into the positioning hole.
- b. Tighten the screw with the hex wrench (FF).

#### Hardware Used

	Hex Wrench		x 1
---	------------	---	-----

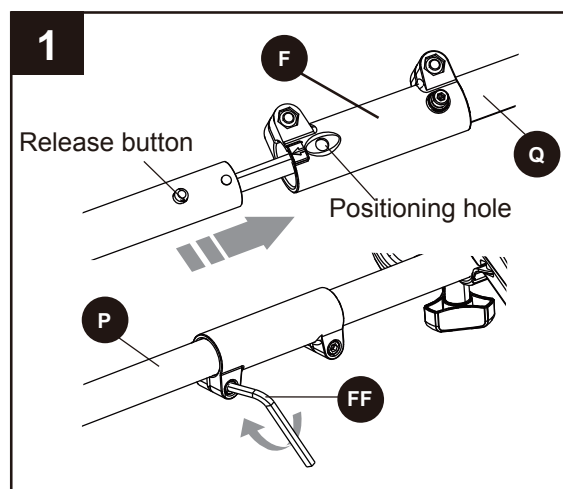





#### 2. Front handle

- a. Position the front/auxiliary handle (E) onto the edger by sliding over the tube (Q).
- b. Once the front handle is in the desired position, align the hole on the handle with the hole on the bracket (CC), then slide the bolt (BB) through the top of the handle and secure with the fastening knob (AA). Tighten until there is no movement in the handle.
- c. The front handle can be adjusted to a suitable position.

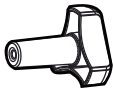
**Note:** Do not overtighten the fastening knob. It could cause the fastening clamp to break.

#### Hardware Used

	Fastening knob		x 1
	Bolt		x 1
	Bracket		x 1

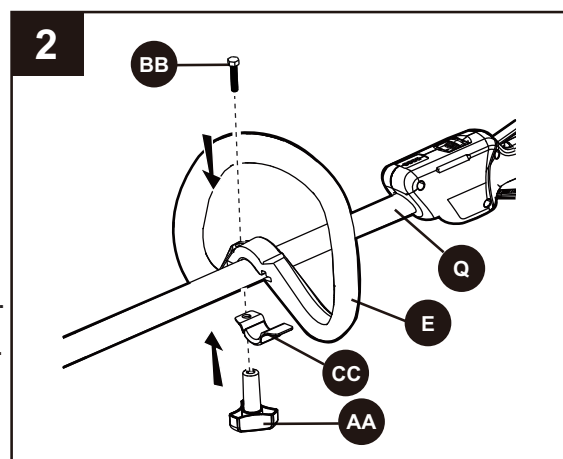

## ASSEMBLY INSTRUCTIONS

### BATTERY

**! IMPORTANT:** The battery is not charged when it is purchased. Before using the edger for the first time, place the battery in the battery charger and charge.

#### 3. To install:

- Align the battery with the cavity in the battery housing.
- Insert the battery into the handle until the battery release button (A) locks into place. Push down on the battery until it locks into place. You should hear a “click” once it is installed.

**Note:** The battery can only be installed one way.

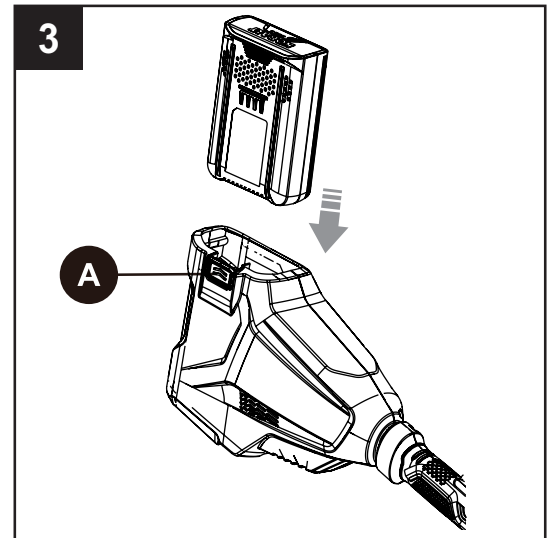

#### 4. To remove:

- Press the battery release button (A) on the edger. This will cause the battery to raise out of the tool slightly.
- Grasp the edger firmly and pull the battery out of the handle.

**Note:** The battery fits into the handle snugly in order to prevent accidental dislodging.

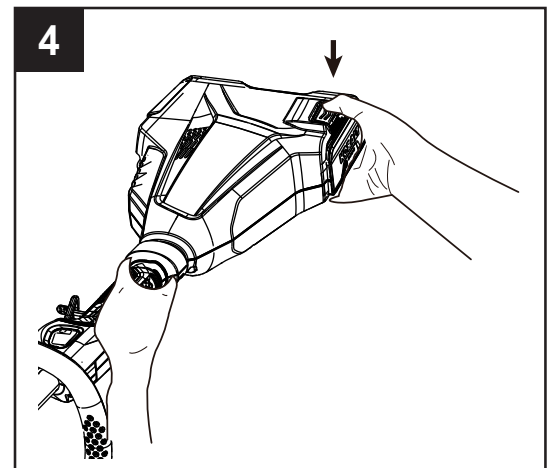

**! WARNING:** Follow these instructions in order to avoid injury and to reduce the risk of electric shock or fire:

- Replace the battery immediately if the battery case is damaged.
- Verify that the switch is in the OFF position before inserting or removing the battery
- Verify that the battery is removed and the switch is in the OFF position before inspecting, adjusting, or performing maintenance on any part of the edger.



## OPERATING INSTRUCTIONS

### **WARNING**

To avoid injury:

- Do not squeeze the trigger while the edger is inverted.
- Do not carry the edger with your finger on the switch. Avoid unintentional starting.

#### 1. To turn on:

- a. Push forward the lock-out lever (C) and pull the trigger (B).

#### To turn off:

- a. Release the trigger (B) and the lock-out lever.

 **CAUTION:** Always allow 5 seconds or more for the blade to stop rotating after releasing the trigger. Do not invert the edger or place your hands under the protective guard until the edger blade has come to a complete stop.

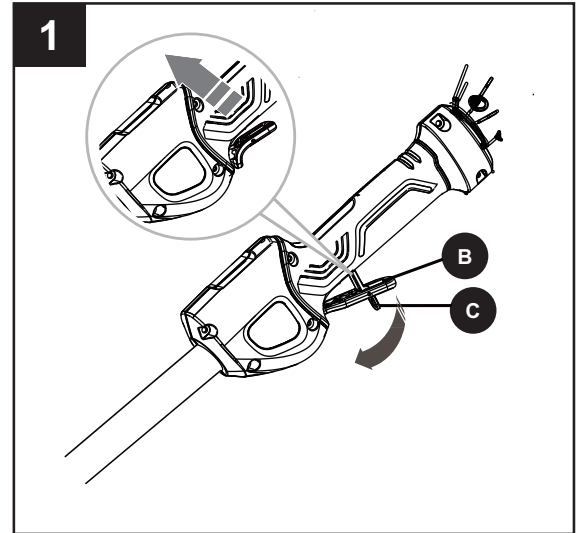

#### 2. To adjust the depth of cut:

- a. Remove the battery pack.
- b. Loosen the depth adjustment knob to increase or decrease the depth.
- c. Adjust the depth so that the blade barely touches the ground when the machine is held in a normal operating posture.
- d. Tighten the depth adjustment knob.
- e. Standing in a normal working position, check the depth of cut again and correct if necessary.
- f. Replace the battery pack once all adjustments are complete.

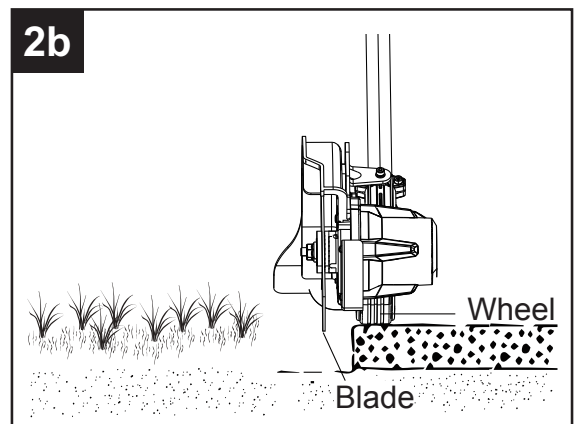
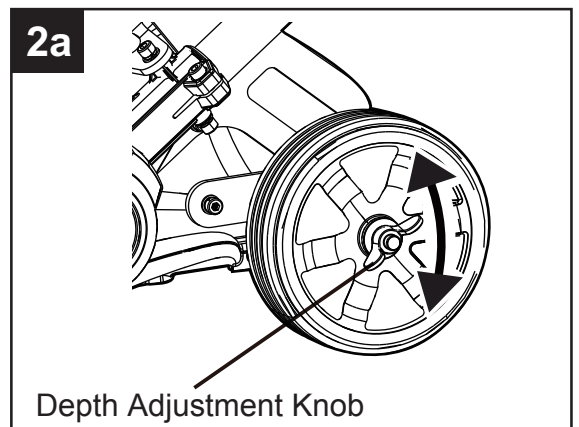



## OPERATING INSTRUCTIONS

### 3. To replace the blade

If the blade worn out, replace it with a new one (not provided) produced by Kobalt (Model# 2911203).

- Remove the battery pack.
- Use a metal rod (EE) to fix the blade.
- Remove the nut by turning it counterclockwise with the wrench (DD) provided.
- Remove the washer.
- Remove the old blade and replace it with a new one.
- Place the washer on the blade.
- Place the screw on the washer and tighten it counterclockwise with the wrench provided.

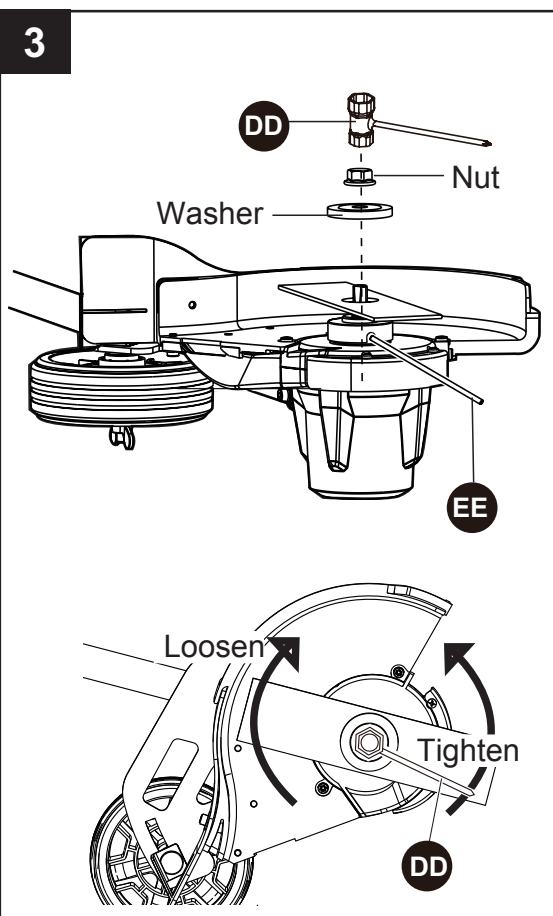

#### Hardware Used

DD	Wrench		x 1
EE	Metal rod		x 1

#### Edger Tips

#### WARNING

Always hold the edger away from the body keeping clearance between your body and the edger. Any contact with the edger cutting head while operating can result in serious personal injury.

- Hold the edger with your right hand on the rear handle and your left hand on the front handle.
- Keep a firm grip with both hands while in operation.
- Edger should be held at a comfortable position with the rear handle about hip height.
- The edger will edge along sidewalks, driveways, flower beds, curbs, and similar areas.
- Cut at a steady pace. If the blade begins to bog down, you are edging too fast; slow your pace. Do not force the blade into ground.
- Light contact of the blade against the sidewalk edge, curb, etc., is acceptable and will not damage the edger.
- Best appearance is obtained when grass is dry. Avoid edging in wet soil or wet grass areas or the blade guard might clog and result in an uneven edge. If the blade guard becomes clogged, stop the edger, remove the battery, and remove debris from the blade guard.

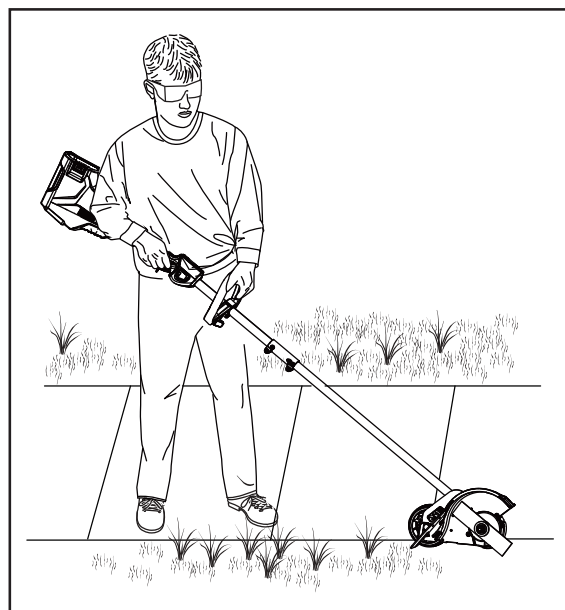

## CARE AND MAINTENANCE

### 1. Replacing the skid plate

- Remove the screws with a Phillips Head screwdriver (not included).
- Replace with the new skid plate.
- Tighten the screws.

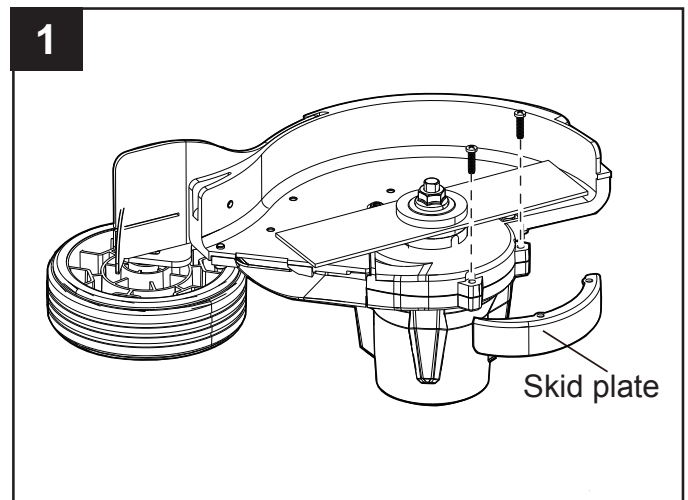

### 2. Replacing the wheel

- Remove the battery.
- Remove the wing nut (K), washer (L), axle sleeve (M), wheel (J), axle sleeve (M), rubber washer (N) and wheel axle (O) orderly from the wheel assembly.
- Replace with the new wheel.
- Insert the wheel axle (O) through the slot downward, then put the rubber washer (N), axle sleeve (M), wheel (J), axle sleeve (M), washer (L) and wing nut (K) orderly through the wheel axle (O).
- Tighten the wing nut (K).

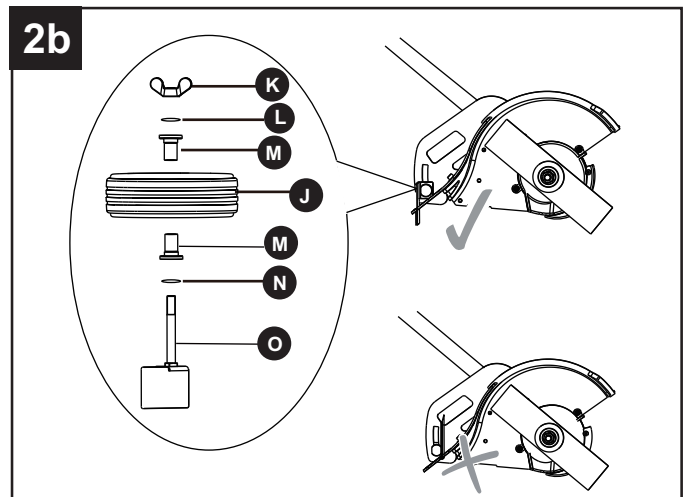
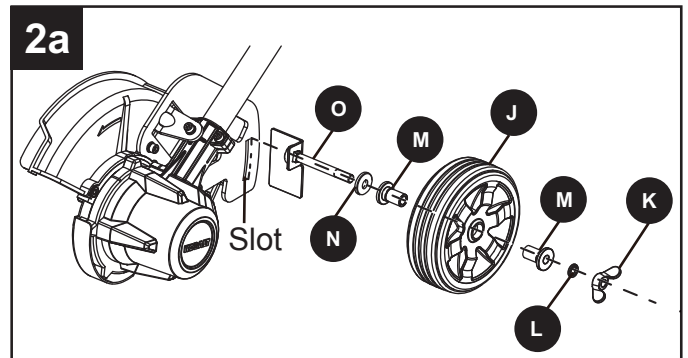

## CARE AND MAINTENANCE

---

### 3. Edger Guard and Motor Maintenance

**Note:** Before performing maintenance, remove battery from the tool.

- a. Remove dirt and debris from guard using a paint brush (not included).

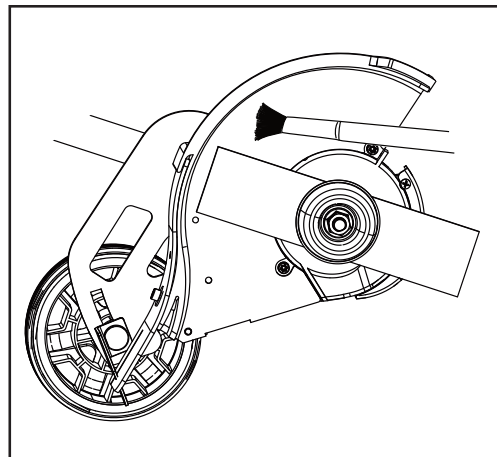

- b. Clean dirt and debris off of motor cover and connection joints.

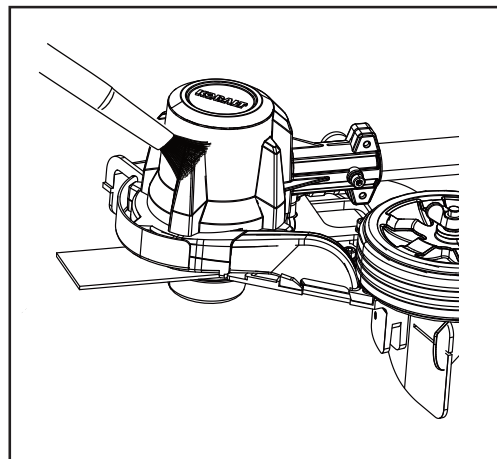

- c. Clean the blade by using a wire brush and spraying with an appropriate degreaser.

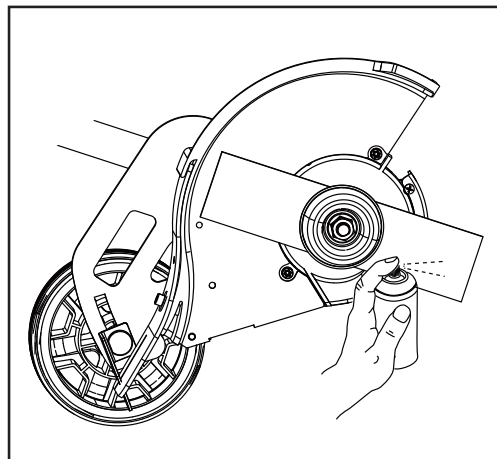

## TROUBLESHOOTING

---

If you still have questions or an unresolved issue after going through this troubleshooting guide, or just want to speak to a Kobalt product expert, please call our customer service department at 1-888-3KOBALT (1-888-356-2258), 8 a.m. - 8 p.m., EST, Monday – Sunday.

PROBLEM	POSSIBLE CAUSE	CORRECTIVE ACTION
Motor fails to start when switch trigger is depressed.	<ol style="list-style-type: none"><li>1. Battery is not secure.</li><li>2. Battery is not charged.</li><li>3. Possible wiring or electrical contact problem.</li></ol>	<ol style="list-style-type: none"><li>1. To secure the battery, make sure the latches on the battery compartment snaps into place.</li><li>2. Charge the battery according to the instructions included with your model.</li><li>3. Call 1-888-3KOBALT (1-888-356-2258) for technical service.</li></ol>

## WARRANTY

---

### 5-YEAR LIMITED WARRANTY

This Kobalt 80V Edger is warranted to the original purchaser from the original purchase date for five (5) years subject to the warranty coverage described herein.

This Kobalt 80V Edger is warranted for the original user to be free from defects in material and workmanship.

If you believe that the Kobalt 80V Edger is defective at any time during the specified warranty period, simply return the 80V Edger along with proof of purchase to the place of purchase for a free replacement or refund, or call 1-888-3KOBALT (1-888-356-2258) for warranty service.

This warranty is void if: defects in materials or workmanship or damages result from repairs or alterations which have been made or attempted by others or the unauthorized use of nonconforming parts; the damage is due to normal wear, damage is due to abuse (including overloading of the tool beyond capacity), improper maintenance, neglect or accident; or the damage is due to the use of the tool after partial failure or use with improper accessories or unauthorized repair or alteration.

This warranty gives you specific legal rights, and you may also have other rights that vary from state to state.

## REPLACEMENT PARTS LIST

For replacement parts, call our customer service department at 1-888-3KOBALT (1-888-356-2258), 8 a.m. - 8 p.m., EST, Monday - Sunday.

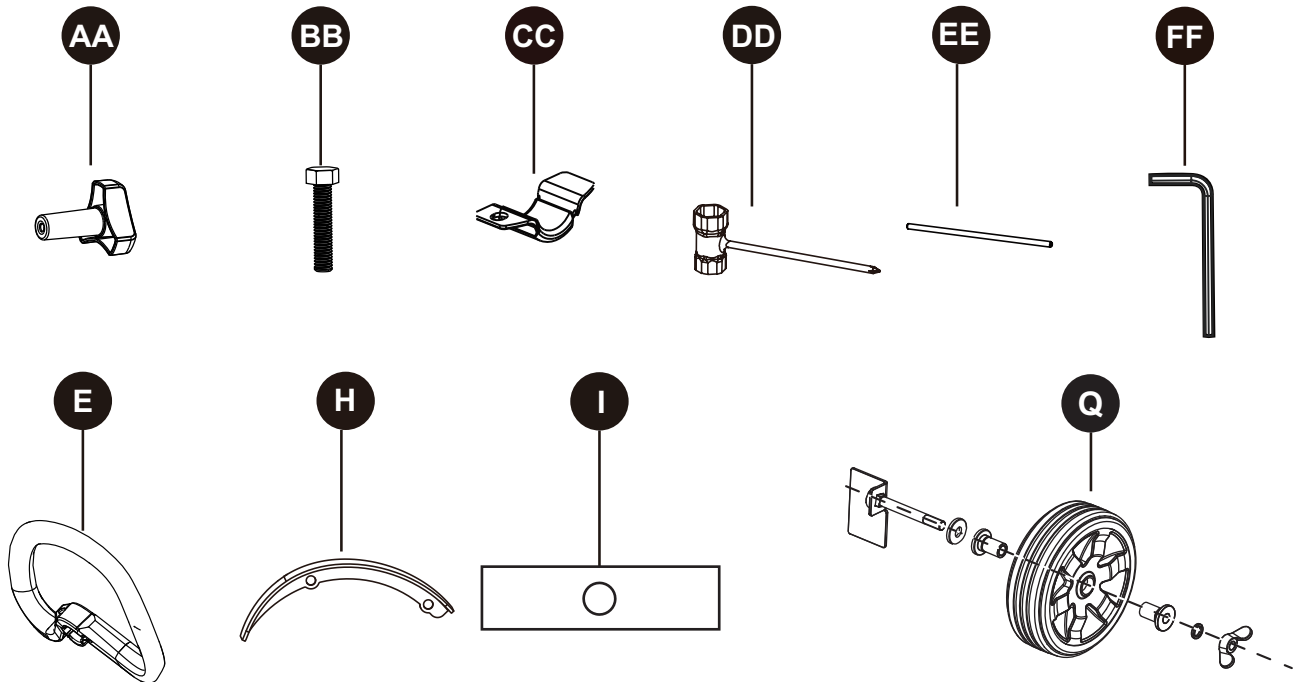

PART	DESCRIPTION	PART #
AA	Fastening knob	341201444
BB	Bolt	322051444
CC	Bracket	33304877B/ 34201877
DD	Wrench	333101048B
EE	Metal rod	33207836
FF	Hex wrench	329011444
E	Front/auxiliary handle	341191444A
H	Skid plate	333021782
I	Blade	333031782
Q	Wheel assembly	C1103002-00