

# Aluminum Fence Gate Installation Instructions

English Instructions.....1

**FREEDOM**<sup>®</sup>  
OUTDOOR LIVING



Read all instructions prior to installing product.

Refer to manufacturers safety instructions when operating any tools.

To register your product, please visit: **[freedomproduct.com](https://freedomproduct.com)**

## **▲ WARNING:**

- Improper installation of this product can result in personal injury. Always wear safety goggles when cutting, drilling and assembling the product.
- Incorrect installation may cause harm to the product or individual.

## **NOTICE:**

- DO NOT attempt to assemble the kit if parts are missing or damaged.
- DO NOT return the product to the store. For assistance or replacement parts call: 1-800-336-2383.

## **BEFORE YOU BEGIN:**

Check your local zoning laws.

- Local zoning laws and Home Owners Associations may regulate the location, style and height of your fence and gate or even require a permit signoff beforehand.
- Check local codes for frost line depth and regulations.
- Additional products and assembly may be required to meet wind code requirements. Notice of acceptance (NOA) can be found at [www.miamidade.gov/building/pc-search\\_app.asp](http://www.miamidade.gov/building/pc-search_app.asp)

Contact your local utilities companies.

- You must have the utility companies clearly mark your property for electrical, gas or water lines to avoid puncturing any unseen underground utilities.

## **TOOLS NEEDED:**

Boerboel® Hardware
Safety Glasses
Level
Tape Measure
Drill
3/32" Drill Bit
Pencil
2" Spacer Blocks (2)

## **INSTALLATION TIPS:**

- When installing gate hardware onto gate, it needs to be on level ground
- Review enclosed Boerboel® butterfly hinge instructions before installation
- For measuring, note that gates 6' or larger come with 2" U-frame construction

## **HOW TO MEASURE:**

When measuring for your drive gate, make sure to leave enough space for all gate hardware, including hinges, gate latch and drop rod. When using Boerboel® hardware, leave 1" clearance for all hinges and 1" clearance for a drop rod. Refer to specific hardware instructions for space requirements.

Walk Gate

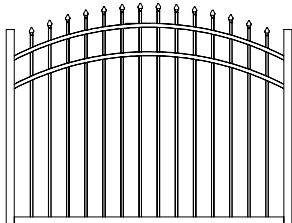

Drive Gate

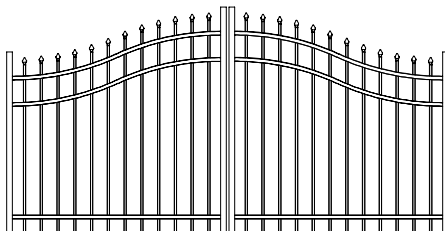

# 1

## Determine Gate Opening:

Refer back to "How to Measure"

Gate opening is determined by width of gate plus clearance for hinge, latch, and drop rod (latch and drop rod sold separately); refer to latch and drop rod installation instructions for specific space requirements (Fig. 1).

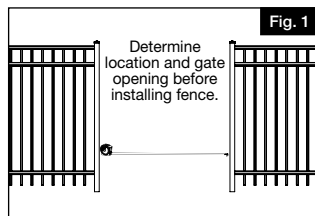

# 2

## Mount Hinges on Gates:

For best results, work on a clean, flat, stable surface when mounting hinges to gates.

- Place hinges at desired position on each gate. For equal spacing, we recommend the bottom hinge be placed 6" from the bottom gate upright, and the top hinge be placed 6" from the top upright. Tabs on hinges must rest firmly against gate upright or U-frame (Fig. 2)
- Mark pilot holes through screw holes on hinge then pre-drill using  $\frac{3}{32}$ " bit (Fig. 3).
- Secure hinges to each gate with included 1" screws (Fig. 3).

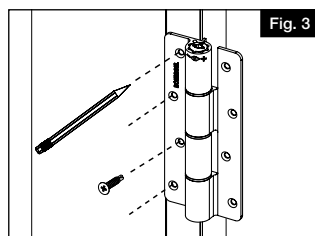
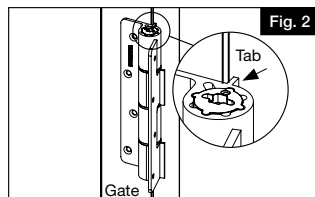

# 3

## Mount Gate to Post:

**NOTE:**

- Gate posts must be plumb prior to gate installation. Posts must also have set for at least 24 hours in concrete prior to any gate installation.
  - Cut two (2) 2" spacer blocks to help support each gate during installation.
- Set gate on spacer blocks and hold it up to the gate post. Tabs on hinges must rest firmly against gate post (Fig. 4)
  - Mark pilot holes on the post, through the screw holes in the hinges.
  - Remove gate and pre-drill  $\frac{3}{32}$ " pilot holes.
  - Re-position gate on post and secure hinges with 1" included screws (Fig. 5).
  - Repeat for additional gate(s).

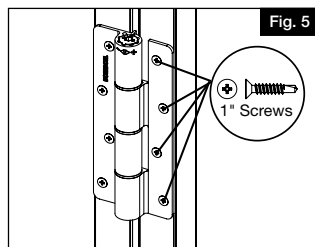
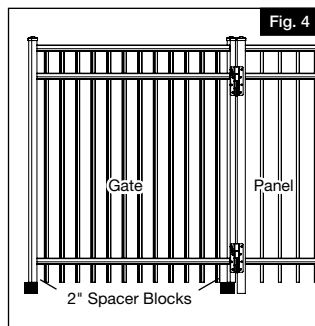

## Hinge Tension Adjustment

### NOTE:

HINGE TENSION IS PRE-SET AT THE FACTORY AND USUALLY DOES NOT REQUIRE ADJUSTMENT.

If you wish to change tension setting/gate swing speed, or completely disable the self-closing feature, please see the following:

- Place included Allen wrench into head of tension adjustment pin in hinge. The head is at the end closest to the + or - symbol on the hinge barrel (Fig. 6).
- While holding the tension adjustment pin with Allen wrench, press the opposite end of the pin into the hinge barrel. This will cause the head of the tension adjustment pin to extend beyond the hinge barrel (Fig. 6).

### NOTE:

DO NOT remove the Allen wrench or release the tension on the tension adjustment pin at any time during the adjustment.

- Following the indicators on the + or - symbol on the hinge barrel, turn the tension adjustment pin toward + to tighten, or toward - to loosen. DO NOT adjust by more than 1/4 turn, unless you want to disable the self-closing feature (Fig. 6).
- Self-closing feature can be disabled by loosening the tension adjustment pin one full turn.
- Do not over-tighten or over-loosen the tension adjustment pin, as this may damage the tension spring.
- When you have set the desired tension, press down on the head of the tension adjustment pin to lock it back into the hinge barrel. Tabs on pin head will fit into notches in hinge barrel when pin is in fully locked position (Fig. 7).

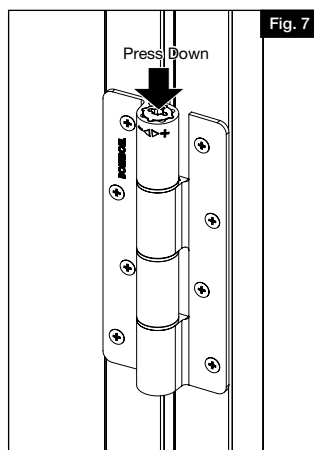
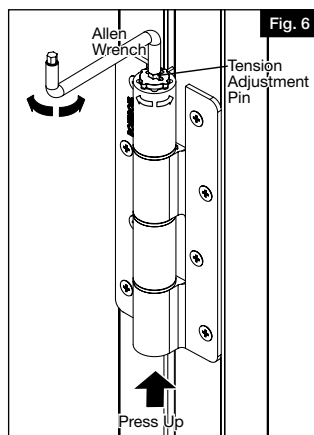

Where applicable, install gate latch or drop rod according to instructions provided with those products.

**FREEDOM**<sup>®</sup>  
OUTDOOR LIVING

Barrette Outdoor Living  
7830 Freeway Circle, Middleburg Heights, OH 44130  
freedomproduct.com • (888) 418-4400

BY **Barrette**  
OUTDOOR LIVING 