

# P trap

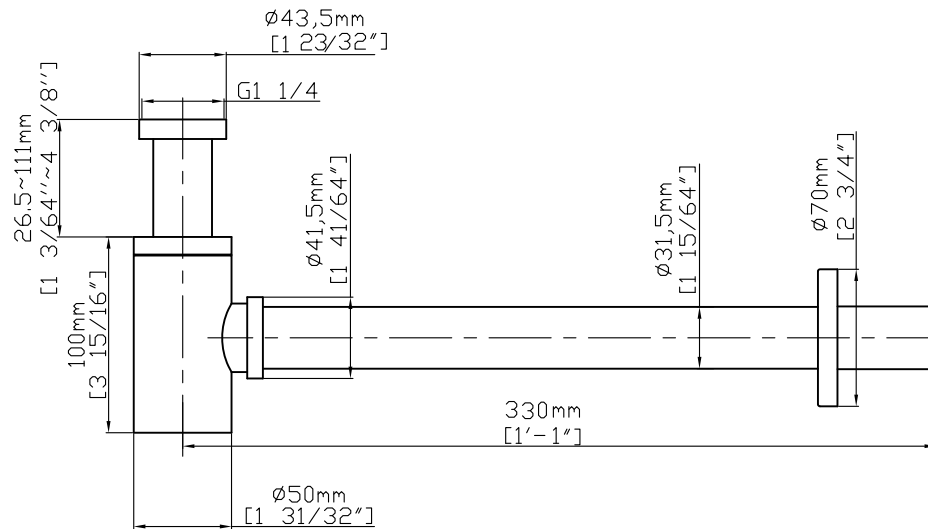

- Clean the contact surface before installation.
- This item is not supposed to be twisted with any wrench.
- Do not use polishing powder or other detergent with powders to clean the surface.

## Features

Material : Brass+ Stainless steel

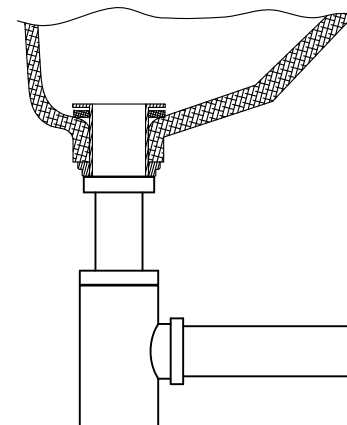

- 1.Align bottom gasket as well as the lock nut onto the tailpiece.
- 2.Place the drain body at the proper position, and then tighten up the lock nut.