

Installation Manual
Guide d'installation
Manual de instalación

Warming Drawer



Models:
HWD27, HWD30



Table of Contents

Safety1

Important Safety Instructions 1

Installation3

Before you Begin 3

Tools and Parts Needed 3

Parts Included 3

General Information 3

Installation Procedure 5

Service7

Data Plate 7

This Bosch Appliance is made by
BSH Home Appliances Corporation
5551 McFadden Ave.
Huntington Beach, CA 92649

Questions?

1-800-944-2904

www.boschappliances.com

We look forward to hearing from you!

Safety



Important Safety Instructions

READ AND SAVE THESE INSTRUCTIONS

WARNING:

If the information in this manual is not followed exactly, fire or shock may result causing property damage or personal injury.

WARNING:

Do not repair or replace any part of the appliance unless specifically recommended in the manuals. Improper installation, service or maintenance can cause injury or property damage. Refer to this manual for guidance. All other servicing should be done by a qualified technician.

Appliance Handling Safety

Hidden surfaces may have sharp edges. Use caution when reaching behind or under appliance.

Safety Codes and Standards

This appliance complies with one or more of the following Standards:

- UL 858, The Standard for the Safety of Household Electric Ranges
- UL 923, The Standard for the Safety of Microwave Cooking Appliances
- UL 507, The Standard for the Safety of Electric Fans
- ANSI Z21.1, The American National Standard for Household Cooking Gas Appliances
- CAN/CSA-C22.2 No. 113-M1984 Fans and Ventilators
- CAN/CSA-C22.2 No. 61-M89 Household Cooking Ranges

It is the responsibility of the owner and the installer to determine if additional requirements and/or standards apply to specific installations.

Electric Safety

Before you plug in the electrical cord, be sure all controls are in the OFF position.

For appliances equipped with a cord and plug, do not cut or remove the ground prong. It must be plugged into a matching grounding type receptacle to avoid electrical shock. If there is any doubt as to whether the wall receptacle is properly grounded, the customer should have it checked by a qualified electrician.

If required by the National Electrical Code (or Canadian Electrical Code), this appliance must be installed on a separate branch circuit.

Installer - show the owner the location of the circuit breaker or fuse. Mark it for easy reference.

Important - Save these instructions for the local electrical inspector's use.

Before installing, turn power OFF at the service panel. Lock service panel to prevent power from being turned ON accidentally.

Refer to data plate for more information. See "Data Plate" under "Service" for data plate location.



Important Safety Instructions

READ AND SAVE THESE INSTRUCTIONS

Be sure your appliance is properly installed and grounded by a qualified technician. Installation, electrical connections and grounding must comply with all applicable codes.

Related Equipment Safety

Remove all tape and packaging before using the appliance. Destroy the packaging after unpacking the appliance. Never allow children to play with packaging material.

Never modify or alter the construction of the appliance. For example, do not remove leveling legs, panels, wire covers or anti-tip brackets/screws.

CAUTION:

For units with glass panels, use care when handling glass to avoid breaking. Broken glass could cause injury.

Installation

Before you Begin

- Tools and Parts Needed
- T-20 6-lobe screwdriver
 - Measuring tape
 - Drill with bit (1/8")
- Parts Included
- T-20 6-lobe screws, #8x1/2" (8)

General Information

Power Requirements and Grounding

Circuit Specifications: 120V, 15A, 60Hz

The outlet must be properly grounded in accordance with all applicable codes.

Overall Dimensions

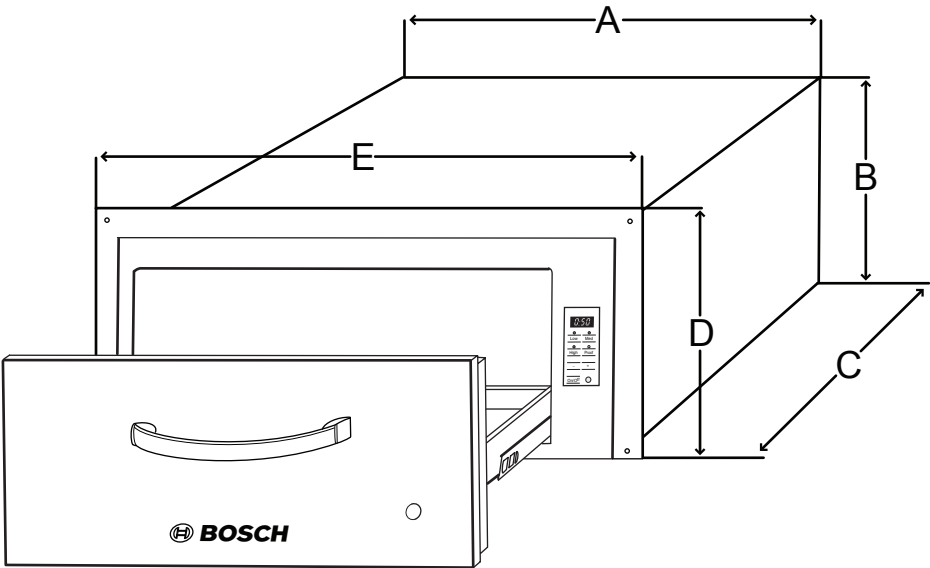

Dimension	Model	
	27" (685 mm)	30" (762 mm)
A	25" (634 mm)	28" (710 mm)
B	10 3/4" (274 mm)	10 3/4" (274 mm)
C	22 1/4" (565 mm)	22 1/4" (565 mm)
D	11 7/16" (289 mm)	11 7/16" (289 mm)
E	26 5/8" (676 mm)	29 5/8" (752 mm)

Cabinet Cutout Dimensions

Instructions are based on standard American cabinets 36" (914 mm) high and 24" (609 mm) deep with a 25" (635 mm) countertop. If using non-standard cabinets, alter dimensions accordingly.

Cabinet opening bottom must be able to support 110 pounds (50 kg).

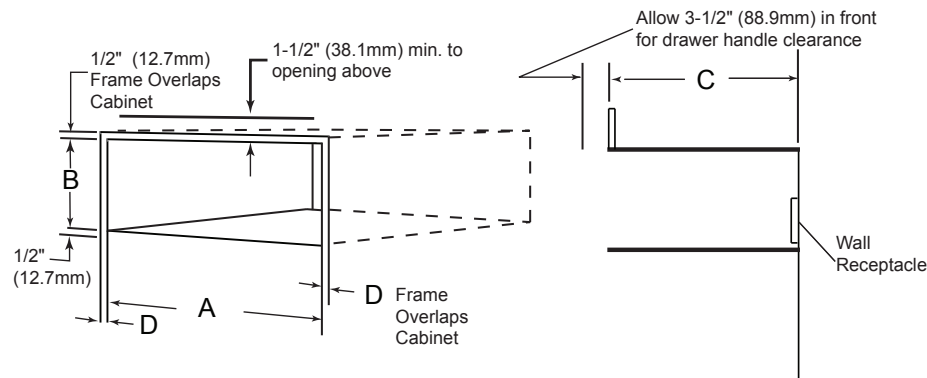

Dimension	Model	
	27" (685 mm)	30" (762 mm)
A	25 3/8" (645 mm)	28 3/8" (721 mm)
B	10 7/8" (276 mm)	10 7/8" (276 mm)
C	24" (610 mm)	24" (610 mm)
D	5/8" (16 mm)	5/8" (16 mm)

Custom Drawer Front Dimensions (Optional)

Build custom drawer front to the dimensions specified in the following table. All four edges must be finished. If using wood, the back must be sealed to prevent moisture damage.

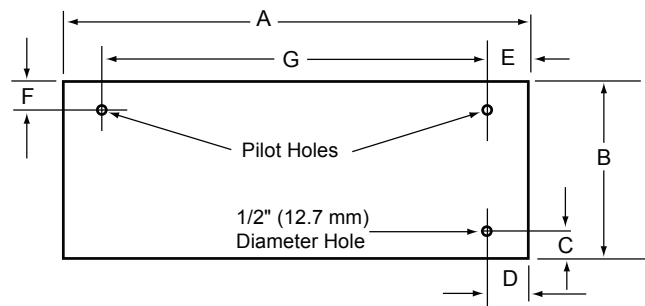

Dimension	Model	
	27" (685 mm)	30" (762 mm)
A	26 3/4" (679 mm)	29 3/4" (755 mm)
B	11 1/4" (286 mm)	11 1/4" (286 mm)
C	3 5/8" (93 mm)	3 5/8" (93 mm)
D	2 3/16" (55 mm)	2 3/16" (55 mm)
E	2 5/8" (66 mm)	2 3/4" (69 mm)
F	1 5/8" (40 mm)	1 5/8" (40 mm)
G	21 1/2" (547 mm)	24 3/8" (618 mm)

Installation Procedure



CAUTION:

Before installing, turn power OFF at the service panel. Lock service panel to prevent power from being turned ON accidentally.

1. Prepare cabinet cutout.

Prepare cabinet cutout and install electrical connection according to the dimensions in "General Information".

2. Remove drawer.

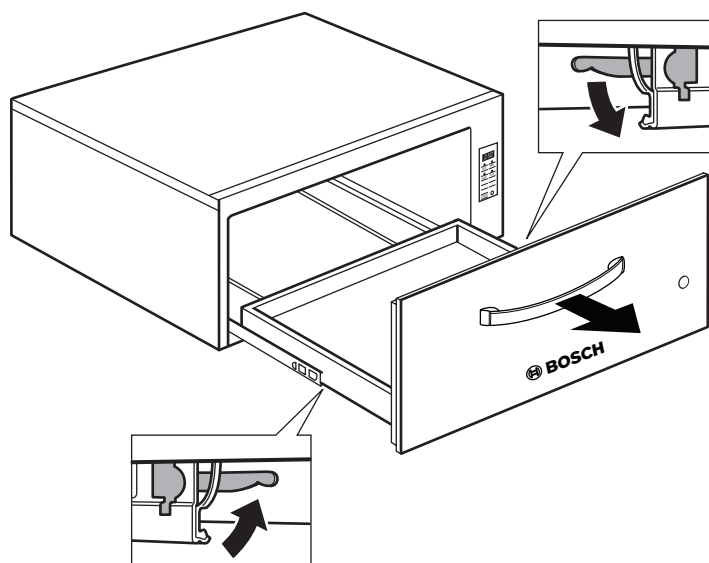

- 1) Pull drawer to fully open position.
 - 2) Press down right drawer clip.
 - 3) Lift up left drawer clip.
 - 4) Firmly pull the drawer straight out. Retract cabinet rails while drawer is removed.
3. Connect power cord.
Insert plug into three-prong, grounded outlet. See "Power Requirements and Grounding" above for electrical specifications.

4. Install warming drawer.



CAUTION:

It is recommended to have 2 installers to install warming drawer. Failure to do so may result in property damage or personal injury.

Slide warming drawer assembly into cutout until it is flush with cabinet. Secure through four screw holes in front frame (drill pilot holes in cabinet first if necessary).

5. Attach custom drawer front (optional).



CAUTION:

Use care when handling glass panel to avoid breaking. Broken glass could cause injury.

- 1) Prepare custom drawer front as explained above.
 - 2) Remove drawer from warming drawer frame (See Use and Care Manual for instructions).
 - 3) Remove six screws from backside of drawer front. Set handle and screws aside.
 - 4) Remove signal light lens from glass panel and set aside. Discard glass panel (Note: stainless steel models do not have a glass panel).
 - 5) Install the signal light lens in the custom drawer front.
 - 6) Attach drawer front with six screws. Attach handle as well if desired.
6. Replace drawer.
- 1) Be sure cabinet rails are pushed inside cabinet.
 - 2) Align the drawer rails with the cabinet rails.
 - 3) Firmly push the drawer straight into the cabinet until drawer clicks into place.
 - 4) Open and close drawer to test operation. Note: if the drawer will not close, verify that the rail clips are properly positioned.
7. Turn power on at the service panel.
8. Test the installation.
- Turn the warming drawer on. Signal light and timer should turn on immediately. Check for warmth.

Service

If the warming drawer elements or signal light do not turn on, check the power source to see if the circuit breaker is tripped.

See Use and Care Manual for troubleshooting information. Refer to the Warranty in the Use and Care Manual.

To reach a service representative, see the contact information at the front of the manual. Please be prepared with the information printed on your product data plate when calling.

Data Plate

The data plate shows the model and serial number. Refer to the data plate on the appliance when requesting service. The data plate is visible on the left side of the drawer casing. It may be necessary to remove the drawer to view it.

