

Automatic Sanitizer Dispenser Installation

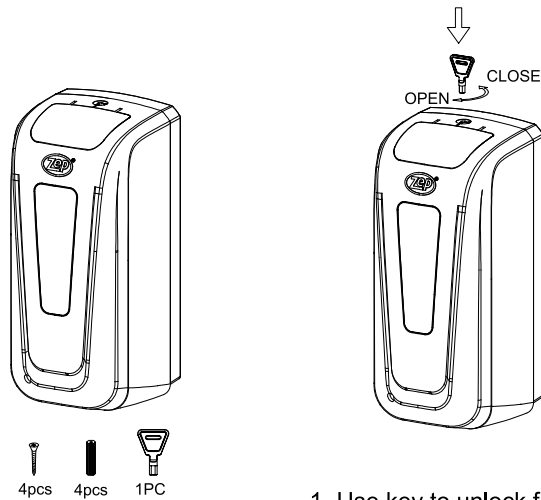

SIZE:15X14.6X32.4cm

1. Use key to unlock front cover

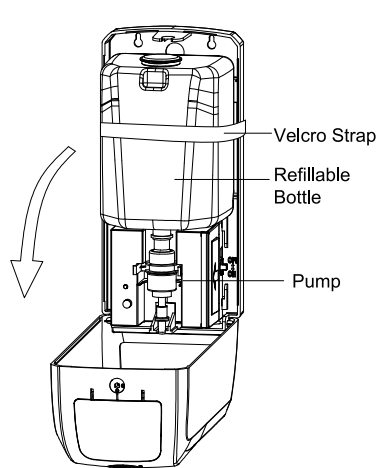

2. Open front cover

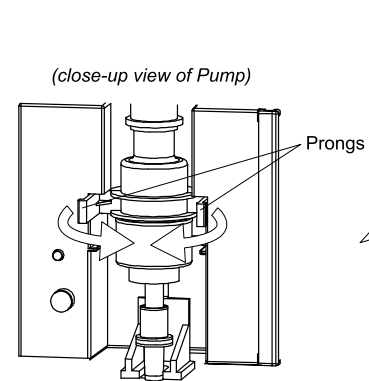

3. To remove bottle, squeeze "prongs" together to release from dispenser

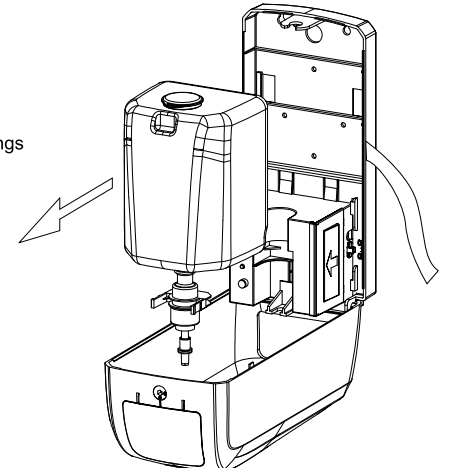

4. Remove refillable bottle and pump

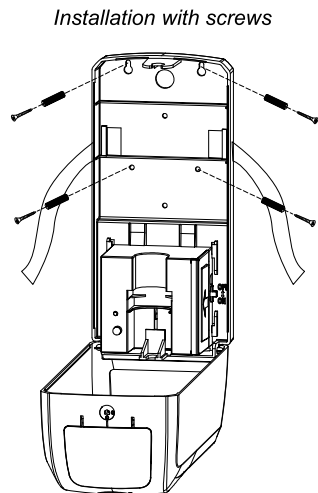

5. Install the dispenser on the wall

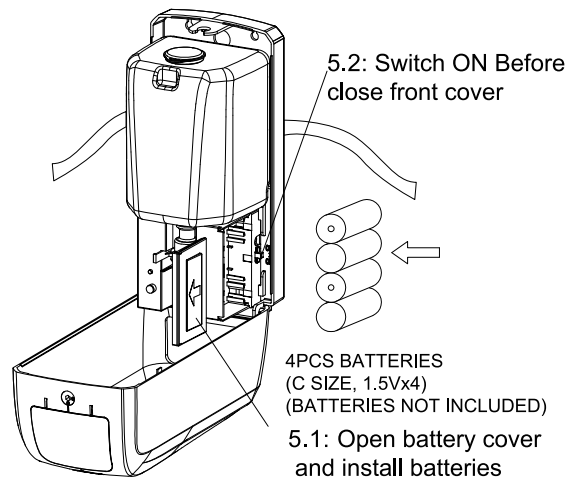

6. Install Batteries (not included)

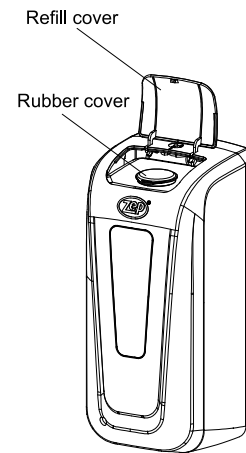

7. Fill gel sanitizer/liquid soap (to refill gel sanitizer/liquid soap, please repeat step 1 and step 2 to reset the spray count)

Use key lock front cover after fill liquid

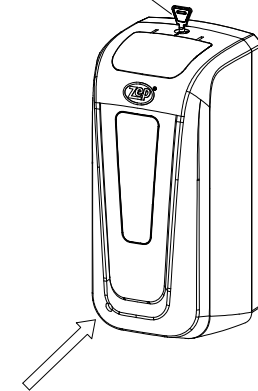

- Dual color LED:
1.Green is working and stand-by
2.Red slow flicker indicate sensor problem
3.Red fast flicker indicates time to refill liquid (repeat step 1 and step 2 after refill liquid)
- Sensing Distance:8-12cm

1. Please reference dispenser installation instructions.

Installation for Floor Model Components

PART LIST:

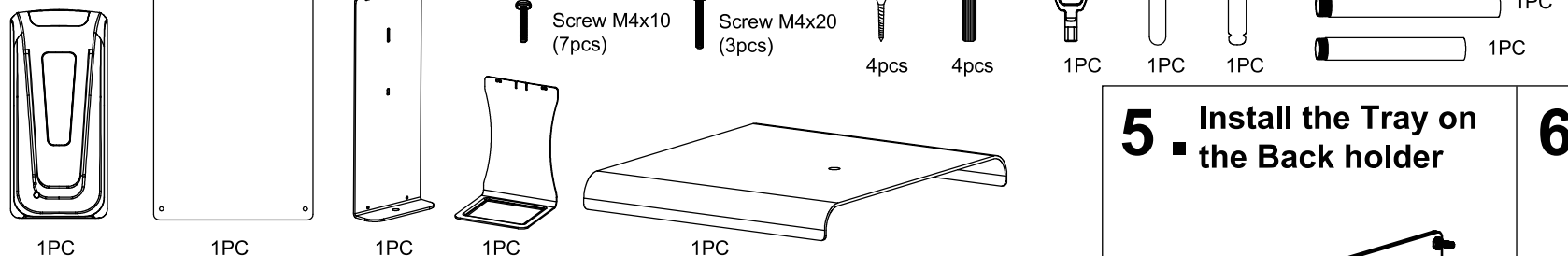

2. Open Front Cover

1. Open Front cover with Key and take out the bottle and pump

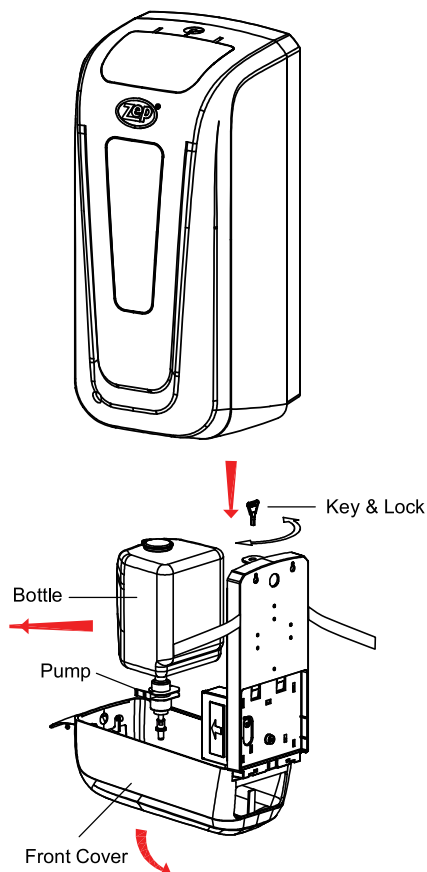

3. Put Advertising Photo inside of 2pcs AD Board

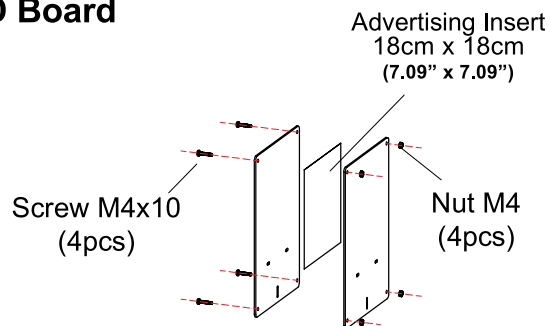

4. Mount the Dispenser and AD Board to the Back Holder

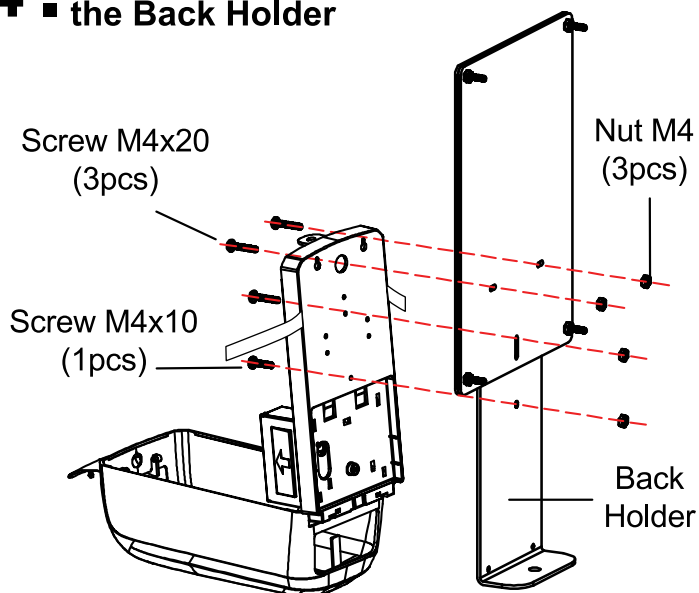

5. Install the Tray on the Back holder

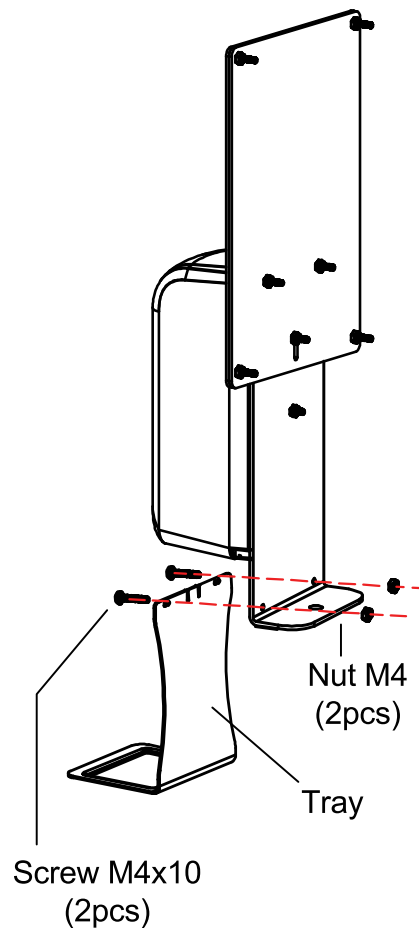

6. Install Pole and Base

