

# CHARLIZE

## STUDIO COLLECTION

# H | S

### As SHOWN:

- Tub only

### FEATURES SHOWN:

- Acrylic Tub
- Linear Integral Drain (included)
- Polished Chrome Drain
- Adjustable Legs
- Built in Faucet Deck

### ALSO AVAILABLE:

- Thermal Air

### STANDARD COLORS AVAILABLE:

- WHITE, BISCUIT, BONE

### SIZE:

- 70.36.22

### WATER CAPACITY:

- 75 Gallons

### WEIGHT:

- 195 Pounds

### ELECTRICAL REQUIREMENT FOR THERMAL AIR:

- Requires 15 Amp Dedicated GFCI



Inspired by the fleur-de-lis, the flared-out shape of the Charlize is a versatile transitional design that can fit any decor. Equipped with a built-in faucet deck, the Charlize's trumpeted, fountain-like form is perfectly scaled to provide optimal lumbar comfort at each end with just the right dose of indulgence. But don't forget the integral linear overflow making for a cleaner look and easier install. Visit <http://www.hydrosystem.com/bath-tub-options/> for more details on our options and accessories.

### OPTIONS:

- Hydro Coat
- Hydro Express Quick Ship
- HydrOzone System
- Island Tub Drain
- Thermal Air System
  - With Variable Speed Blower Air Switch
  - Activated with Pulse and Wave Mode

### CODES AND COMPLIANCES

Massachusetts code File no: P1-0614-491



**HYDRO SYSTEMS**  
Family Owned And Operated Since 1978

29132 Avenue Paine, Valencia, CA, 91355  
661.775.0686 | [hydrosystem.com](http://hydrosystem.com)



\* Indicates options that are shown (listed in order from top to bottom/ left to right)

# CHARLIZE

STUDIO COLLECTION

H | S

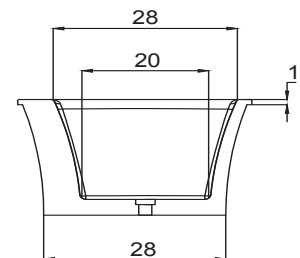
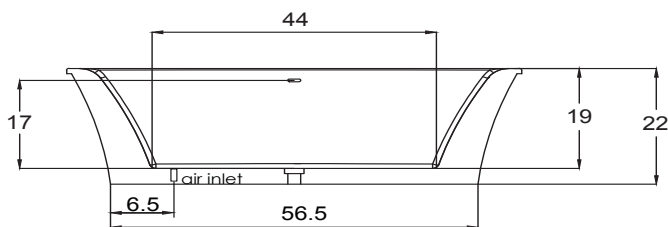
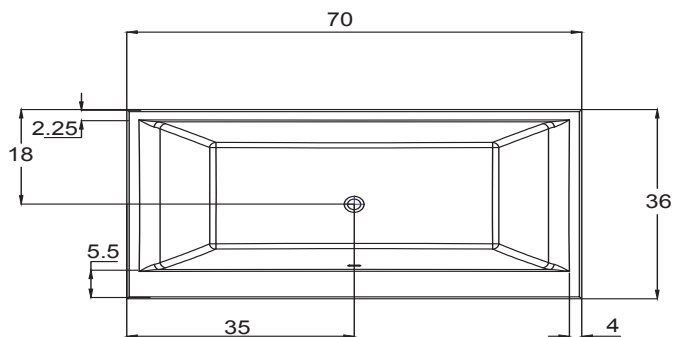

HYDRO SYSTEMS  
Family Owned And Operated Since 1978

29132 Avenue Paine, Valencia, CA, 91355  
661.775.0686 | [hydrosystem.com](http://hydrosystem.com)



Page 2 of 2 **MADE IN AMERICA**

All specifications and options subject to change without notice please contact a Hydro Systems representative for more information. Certain options or altering the pump/blower location may cause the pump/blower to extend beyond the tub decking. For cutout dimensions wait for unit to arrive. All specifications subject to change without notice.