

ASSEMBLY INSTRUCTIONS



CAUTION

◆ Inspect the wire insulation for any cuts, abrasions, or exposed copper that may have resulted during shipping. If there is a defect in the wire, do not attempt installation.

◆ Before starting installation of this fixture or removal of a previous fixture, disconnect the power by turning off the circuit breaker or by removing the fuse at the fuse box.

✉ If you need further assistance, please contact us by Email: customersupport@superiordecorinc.com

TOOLS REQUIRED



Ladder



Safety glasses



Electrical tape



Phillips screwdriver



Flat blade screwdriver



Pliers

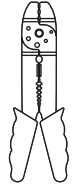

Wire strippers

* PARTS SHOWN MAY DIFFER SLIGHTLY PER LIGHT FIXTURE

HARDWARE INCLUDED



Fixture



Stem



Fixture Finial

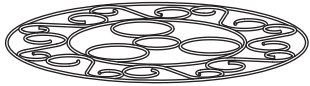

Decorative Net



Iron Ring

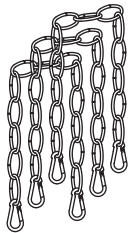

Chain A

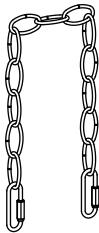

Chain B



Canopy

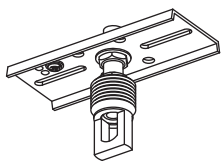

Mounting Unit



Screw Collar Ring

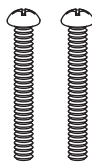

Mounting Screws

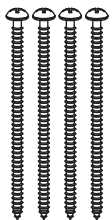

Wood Screws

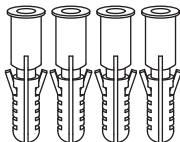

Plastic Anchors



Wire Nuts

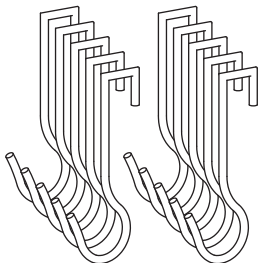

Hook

EXPLODED PARTS

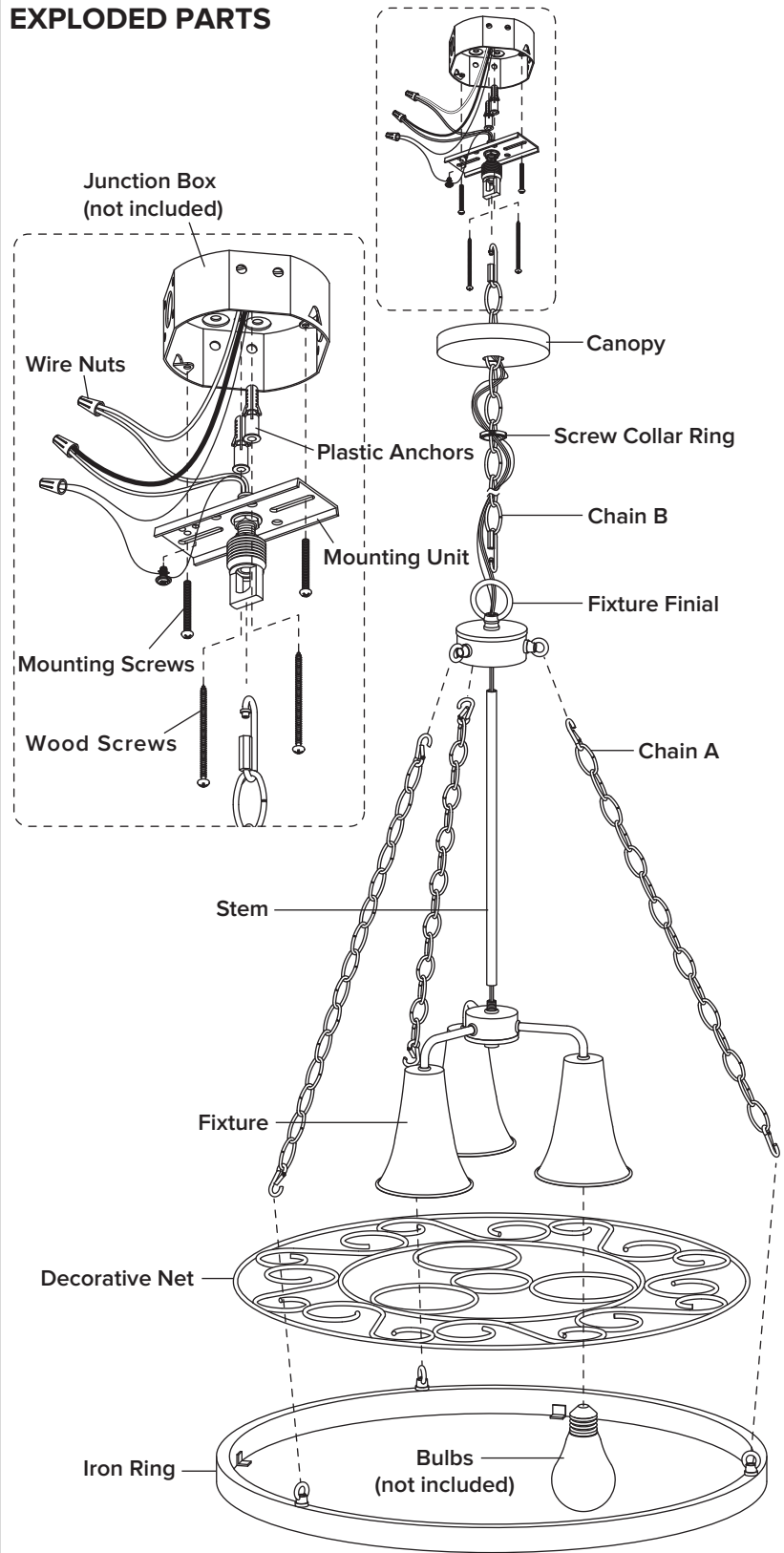

STEP 1

1. Screw the **stem** onto the **fixture**.
2. Screw the **fixture finial** onto the **stem**.

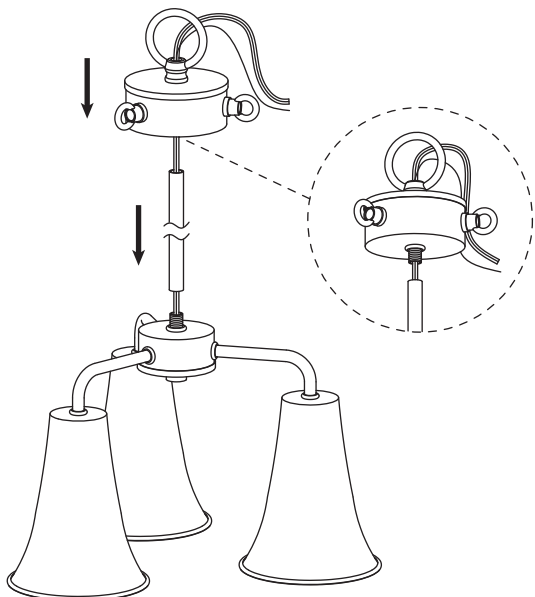

STEP 2

- Place the **decorative net** onto the **iron ring**.

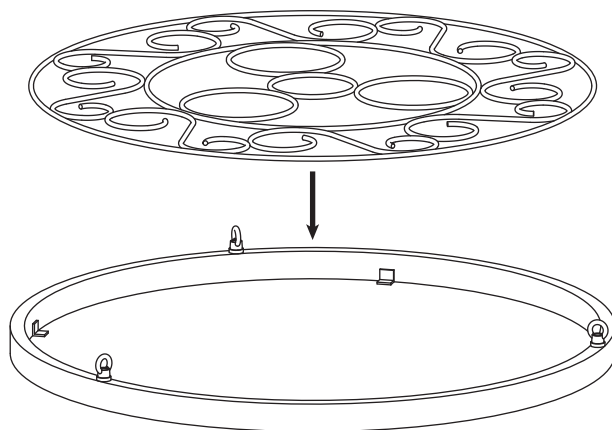

STEP 3

- Attach the **chain A** to the **fixture finial** and the **iron ring**.

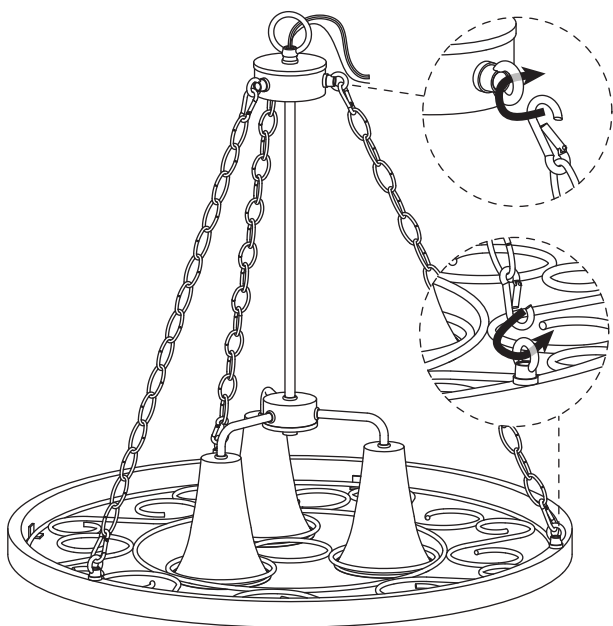

STEP 4

1. Using a 3/8" (10mm) drill bit (not included) to drill holes in the marked areas.
 2. Insert the **plastic anchors** into the drilled holes.
- CAUTION:** To hang fixtures weighing over 50 lbs. the mounting unit must be supported independently of the ceiling junction box (not included). Recommend minimum of two plastic anchors (rated for 200 lbs. or greater).

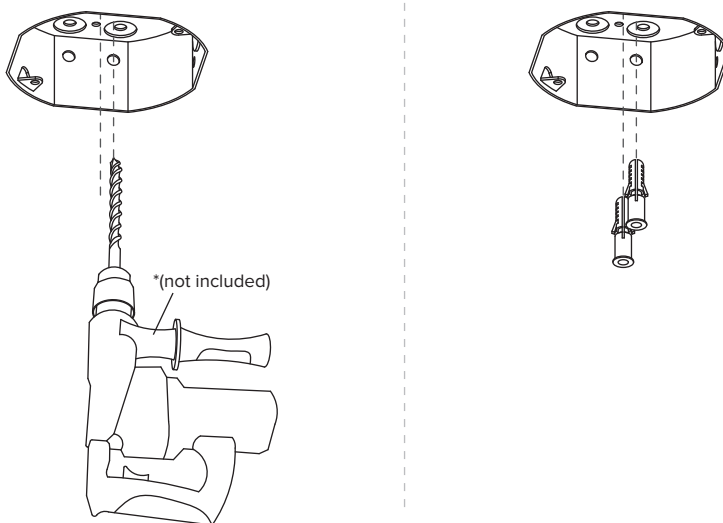

STEP 5

1. Use the **mounting screws** and **wood screws** to attach the **mounting unit** to the **junction box** (not included).
2. Unscrew the **screw collar ring** from the **mounting unit**.

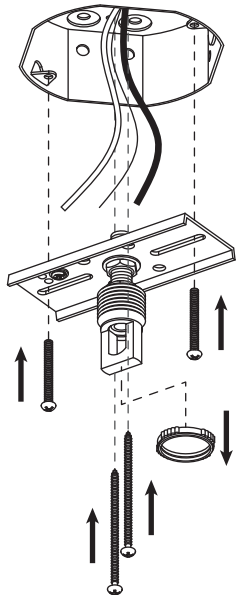

STEP 6

1. Choose the length of the **chain** you need (Open the chain using a phillips screwdriver (not included) and pliers (not included)).
2. Attach the end of the **chain B** to the **fixture finial**.

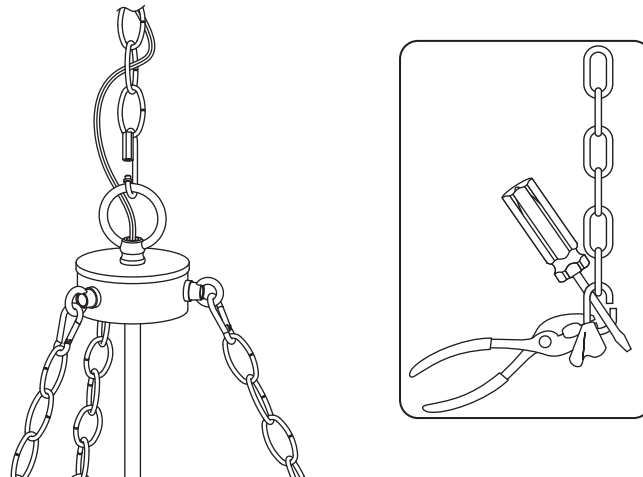

STEP 7

1. Pass the **chain B** and the branch wires through the **screw collar ring** and **canopy**.
2. Attach the end of the **chain** to the **mounting unit**.
3. Feed the branch wires through the pipe nipple on the **mounting unit**.

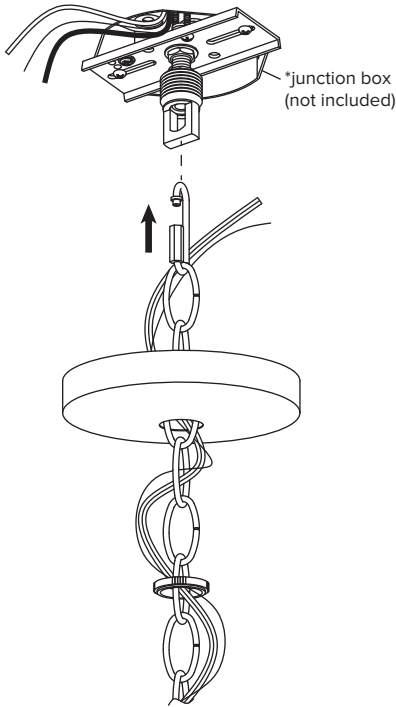

STEP 8

1. Make the electrical connection from the junction box (not included) to the **fixture**. Connect the ground wire to the **mounting unit** by using the preinstalled green ground screw.
2. Connect the live wire, neutral wire and ground wires with the supplied **wire nuts**.
3. Secure with electrical tape (not included).

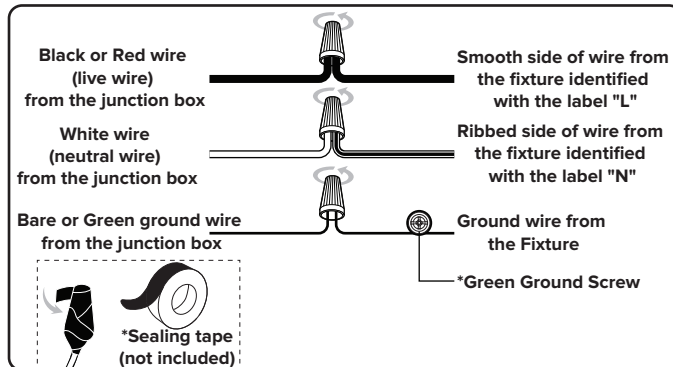
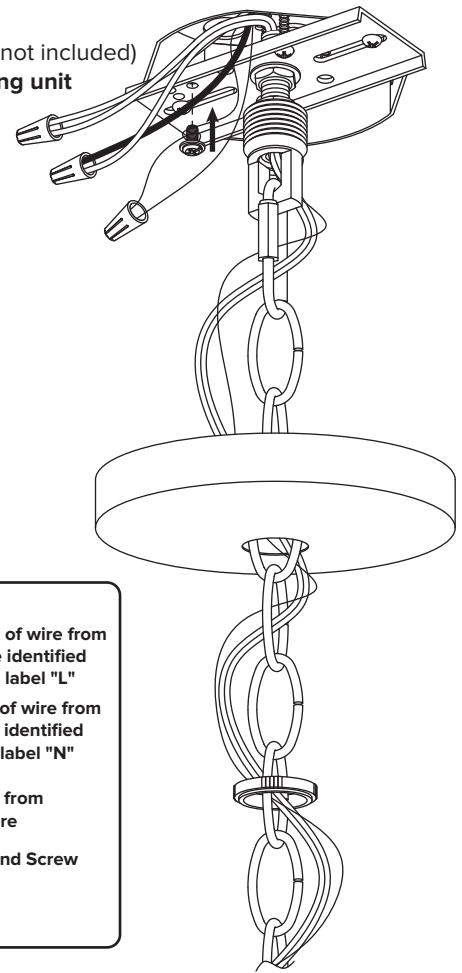

STEP 9

Secure the **canopy** to the **mounting unit** with the **screw collar ring**.

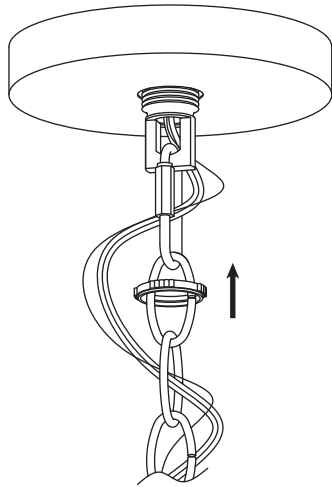

STEP 10

Install bulbs (not included)

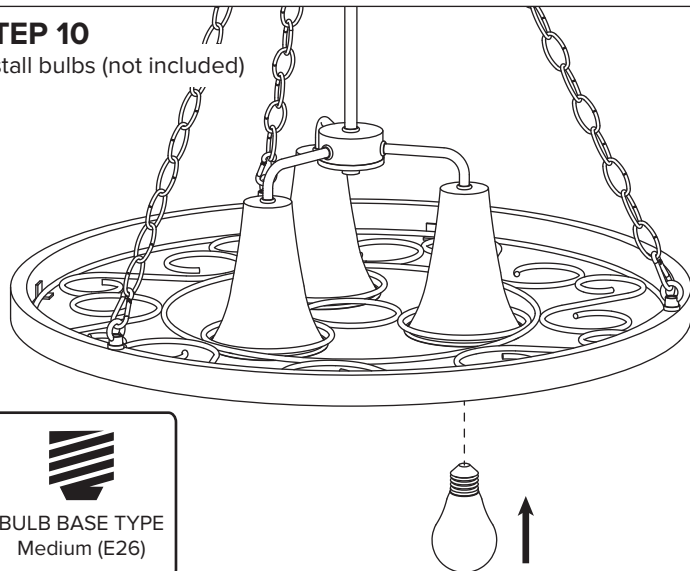

BULB BASE TYPE
Medium (E26)

STEP 11

Place the **hooks** onto the **iron ring**.

