

PRODUCT INSTRUCTION

KF150167-01

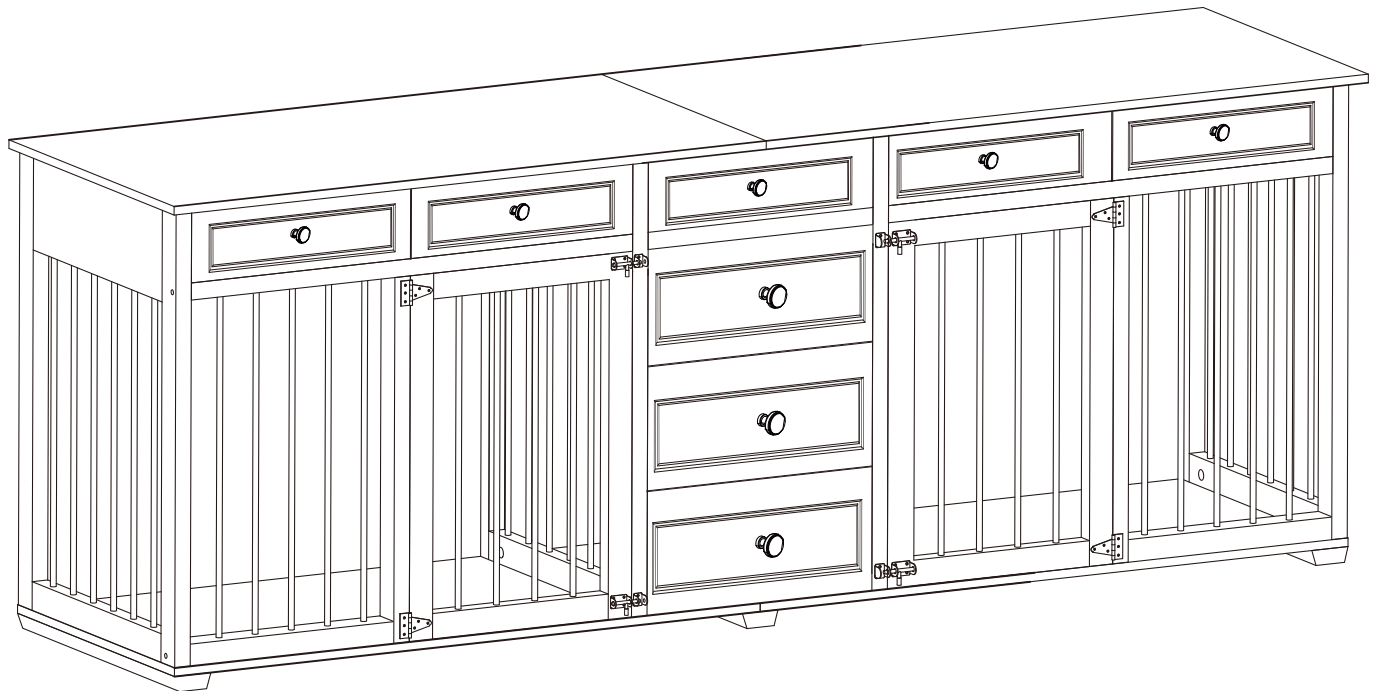

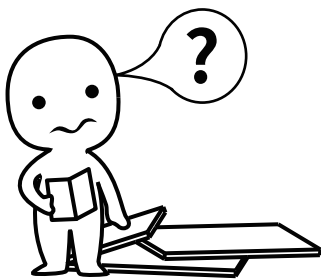

IMPORTANT INFORMATION!

please read the entire manual before starting to assemble and/or using this product. follow the manual thoroughly and keep it for further reference.

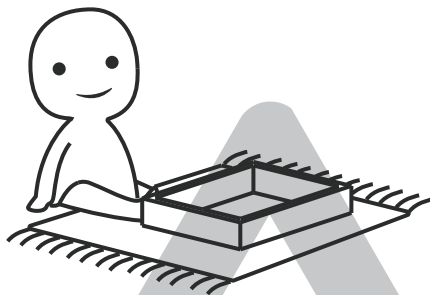
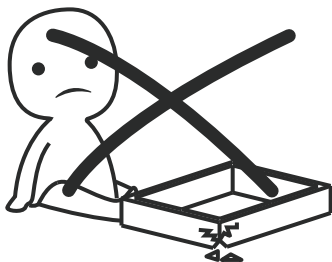

AVOID SCRATCHES!

In order to avoid scratching this furniture should be assembled on a soft layer-could be a rug.

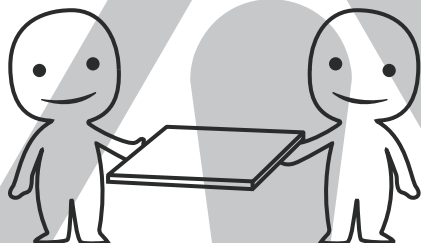

IMPROVE EFFICIENCY !

Try to find a partner to install with you, which can speed up the installation efficiency and shorten the time.

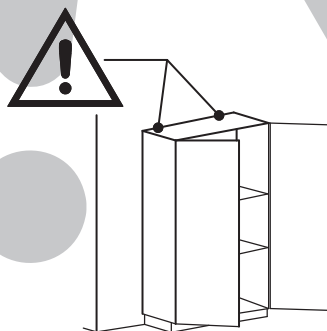
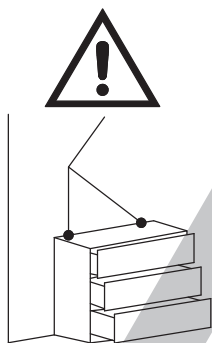

ANTI-TOPPLE WARNING !

Overturned furniture can cause serious or fatal crush injuries. To prevent tipping over, be sure to use the wall attachment, if not included with this product. Please purchase the wall attachment that fit your wall. If unsure, seek professional advice. Please read and follow each step of the instructions carefully.

IMPORTANT !

It is important that any product which is assembled using any kind of screw is re-tightened 2 weeks after assembly, and once every 3 months - in order to assure stability through-out the lifespan of the product.

For regular maintenance and cleaning of the product, for the frame, please use a rag dipped in neutral detergent to fully wipe it, and then dry it with a clean rag. For glass materials, wipe with a rag dampened with water glass cleaner, and then dry with a dry rag.

Do not use an electric screwdriver, and do not use too much force when installing, because the board is easy to break.

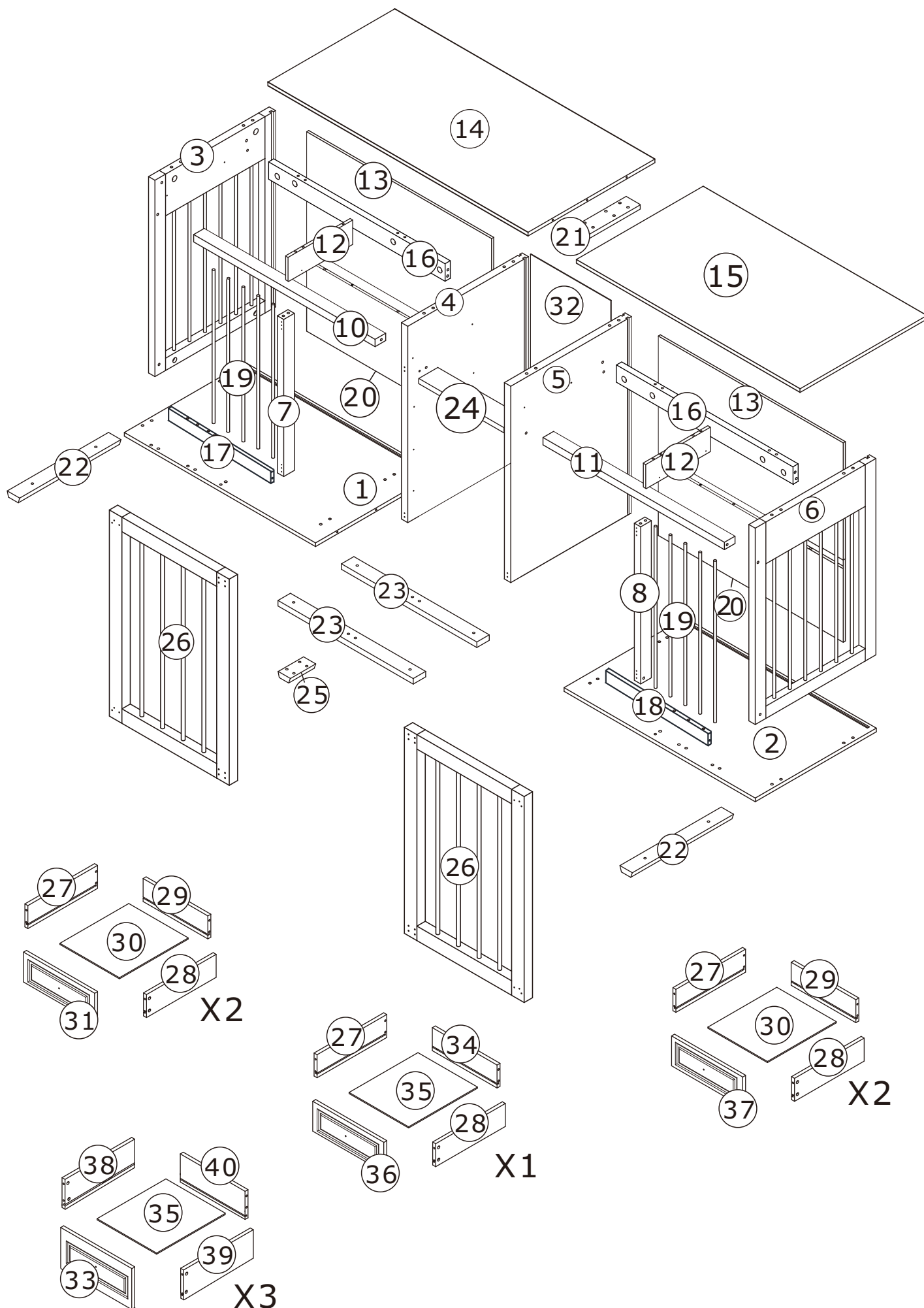

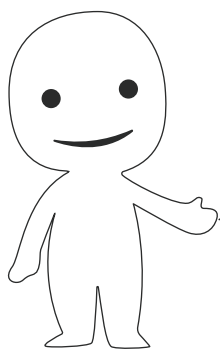

Please prepare the following tools

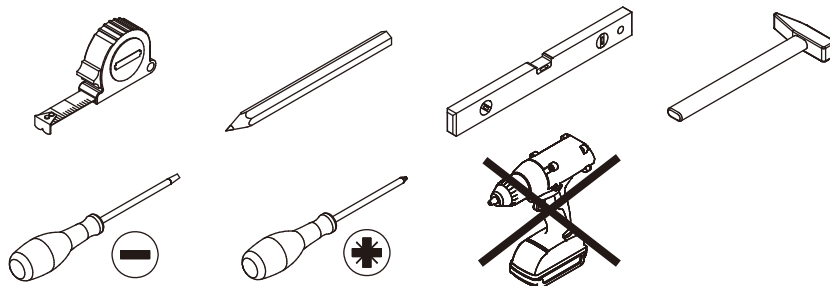

When installing, please carefully confirm whether each screw corresponds to the manual, accessories with similar shapes can be distinguished by size

A x 106+5 $\phi 5 \times 31 \text{ mm}$	B x 106+5 $\phi 15 \times 11 \text{ mm}$	C x 44+3 $\phi 8 \times 30 \text{ mm}$	D x 8 $L=350\text{mm}$	E x 64+6 $\phi 3 \times 12 \text{ mm}$
F x 2 $\phi 3 \times 12 \text{ mm}$	G x 2 $\phi 6 \times 25 \text{ mm}$	H x 18+1 $\phi 6 \times 35 \text{ mm}$	J x 4 $\phi 3.5 \times 14 \text{ mm}$	K x 4 $\phi 3 \times 12 \text{ mm}$
L x 18 $\phi 3 \times 12 \text{ mm}$	M x 6 	N x 106+5 	P x 8 $\phi 4 \times 18 \text{ mm}$	Q x 6 $\phi 6 \times 30 \text{ mm}$
R x 6 $\phi 6 \times 40 \text{ mm}$	S x 3 $\phi 8 \times 30 \text{ mm}$	T x 6 $\phi 6 \times 20 \text{ mm}$	Z x 1 	White nut X3

1

Dx1
L=350mm

Ex4
Ø 3x12mm

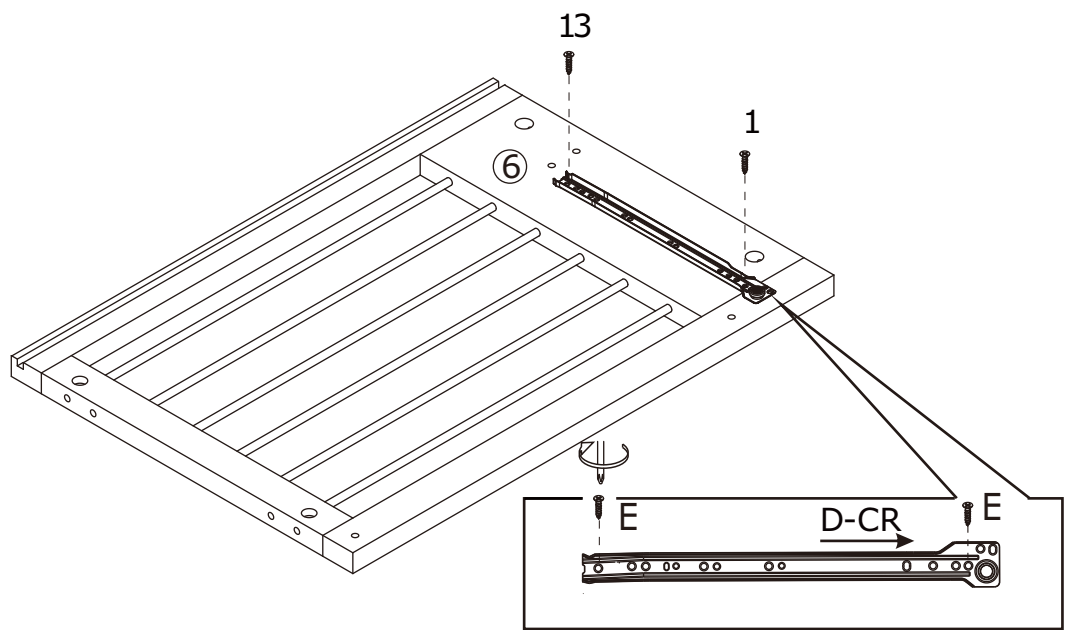
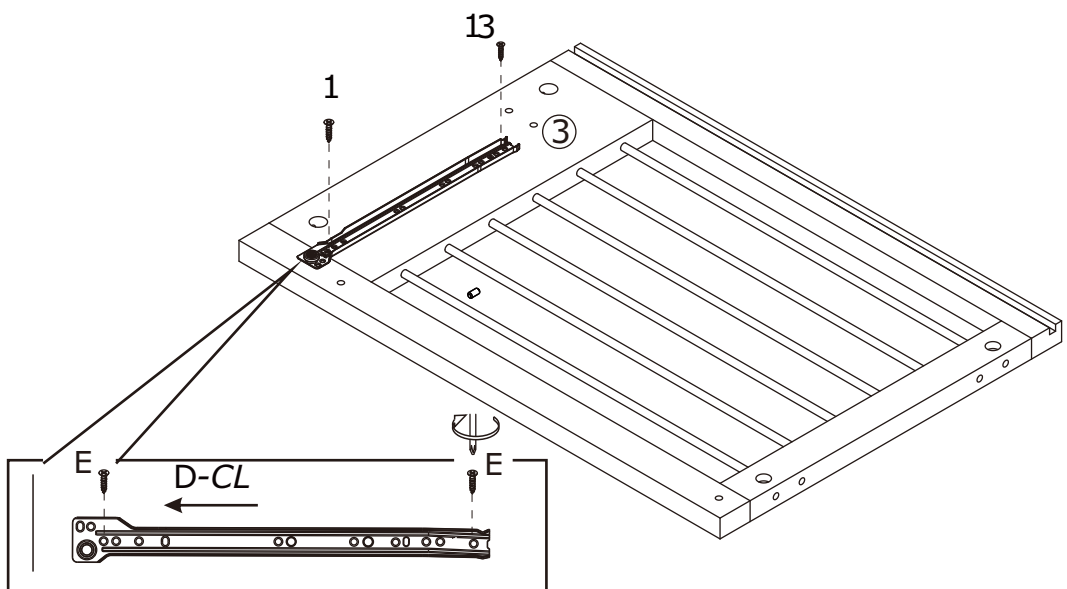
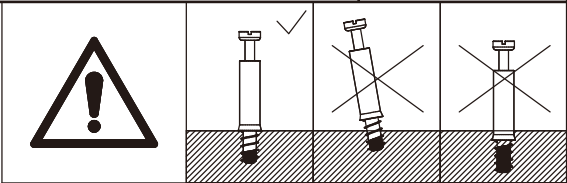
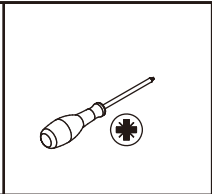

2

Dx4



L=350mm

Ex8



Ø 3x12mm

A x 3



Ø 5x31mm

Cx2



Ø 8x30mm

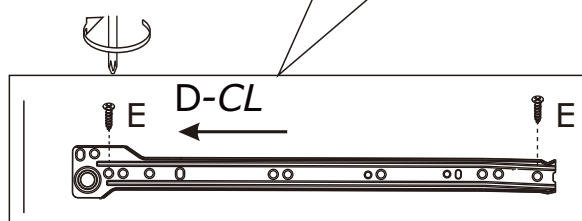
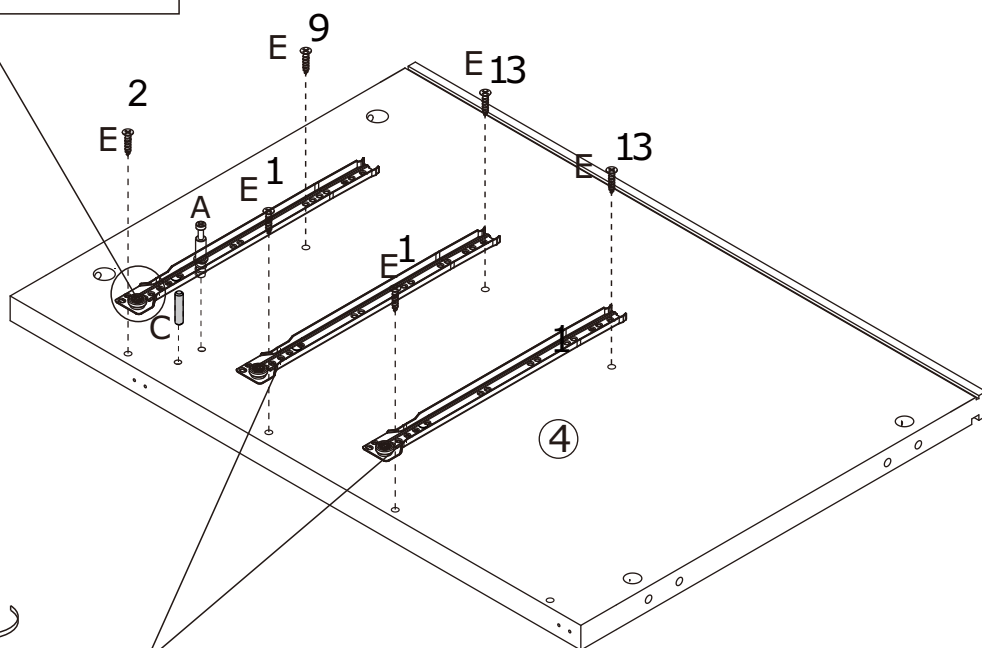
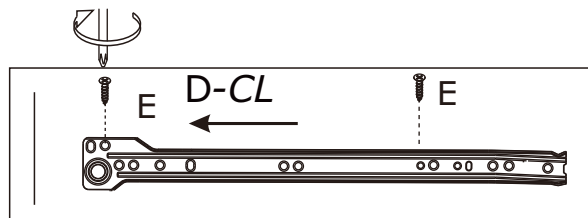
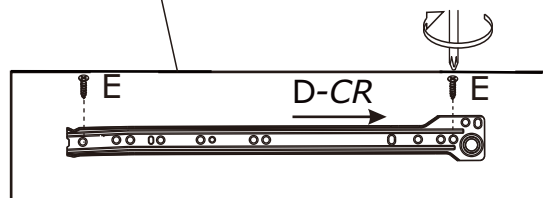
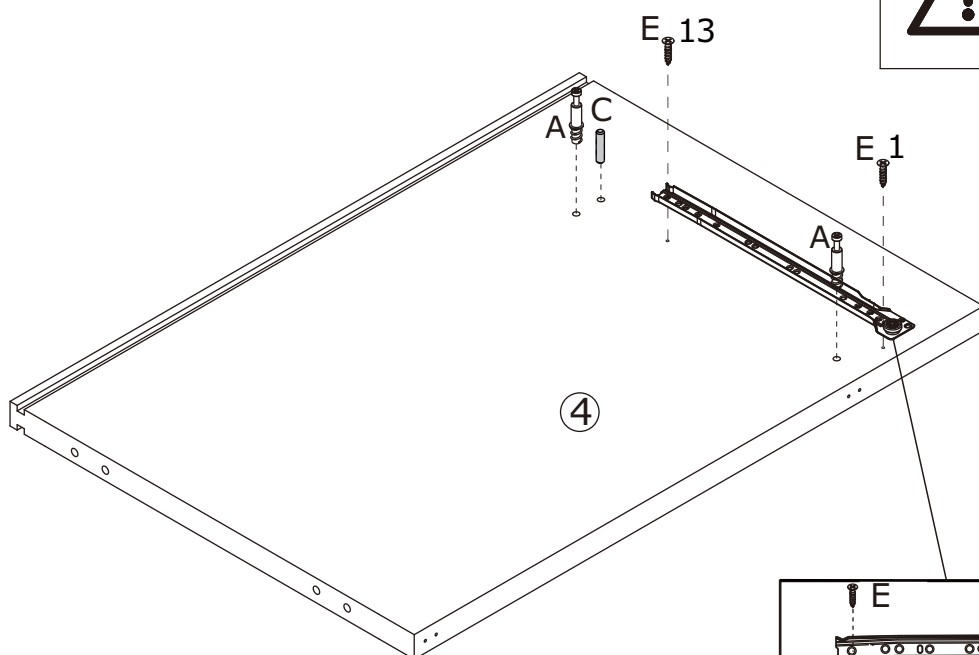
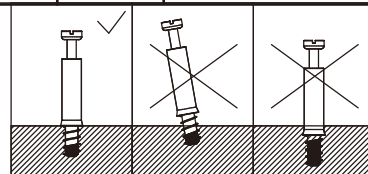

3

Dx4



L=350mm

Ex8



Ø 3x12mm

A x 3



Ø 5x31mm

Cx2



Ø 8x30mm

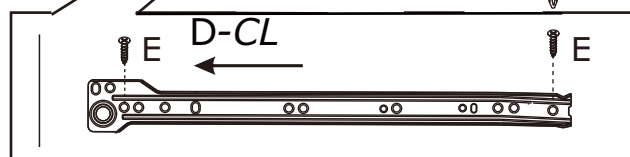
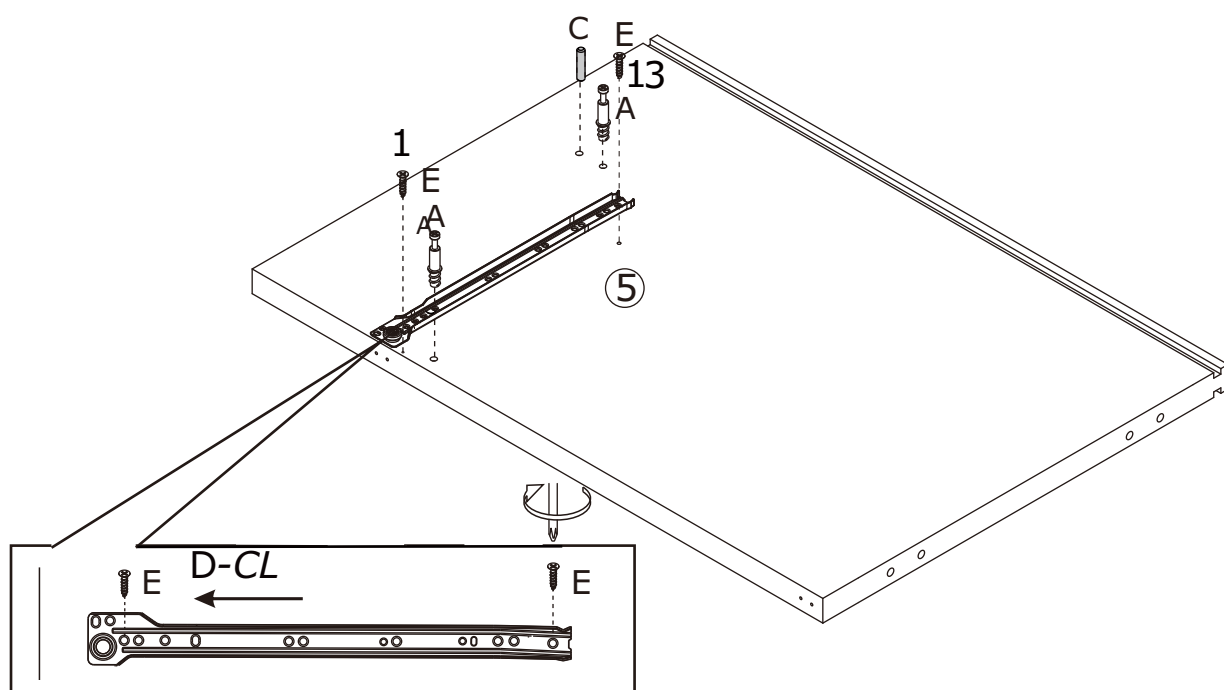
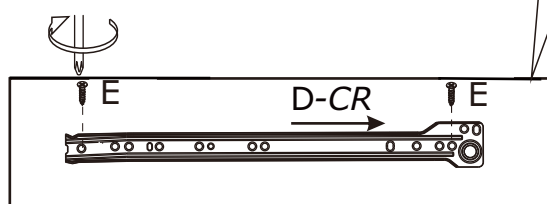
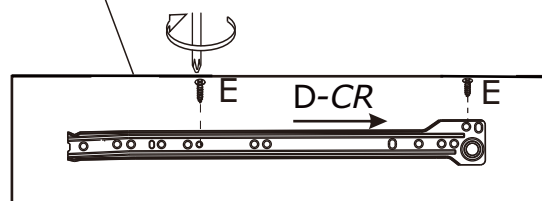
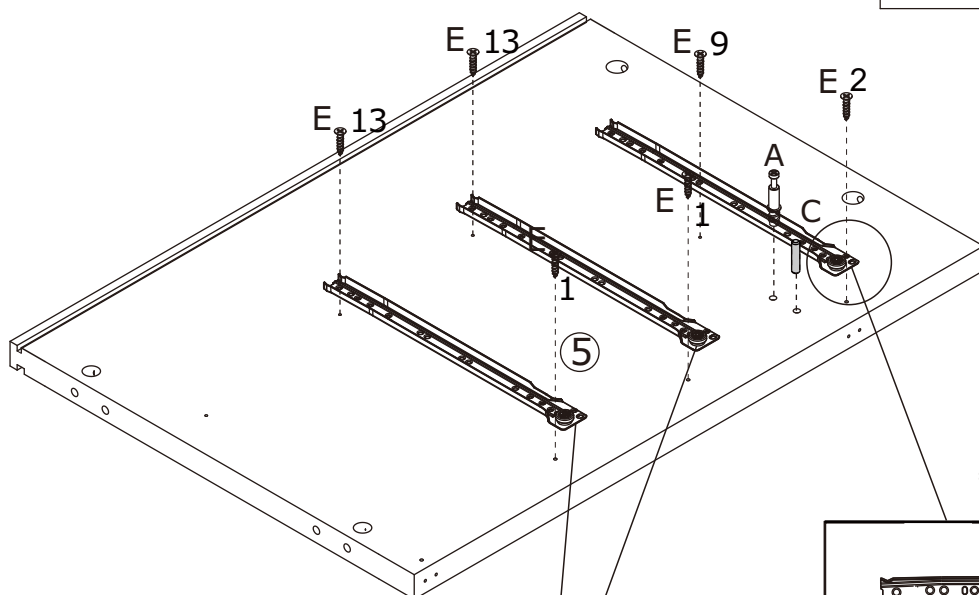
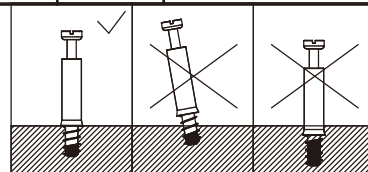

4

Cx3  Ø8 x 30mm	Hx18  Ø6 x 35mm		
---	--	--	---

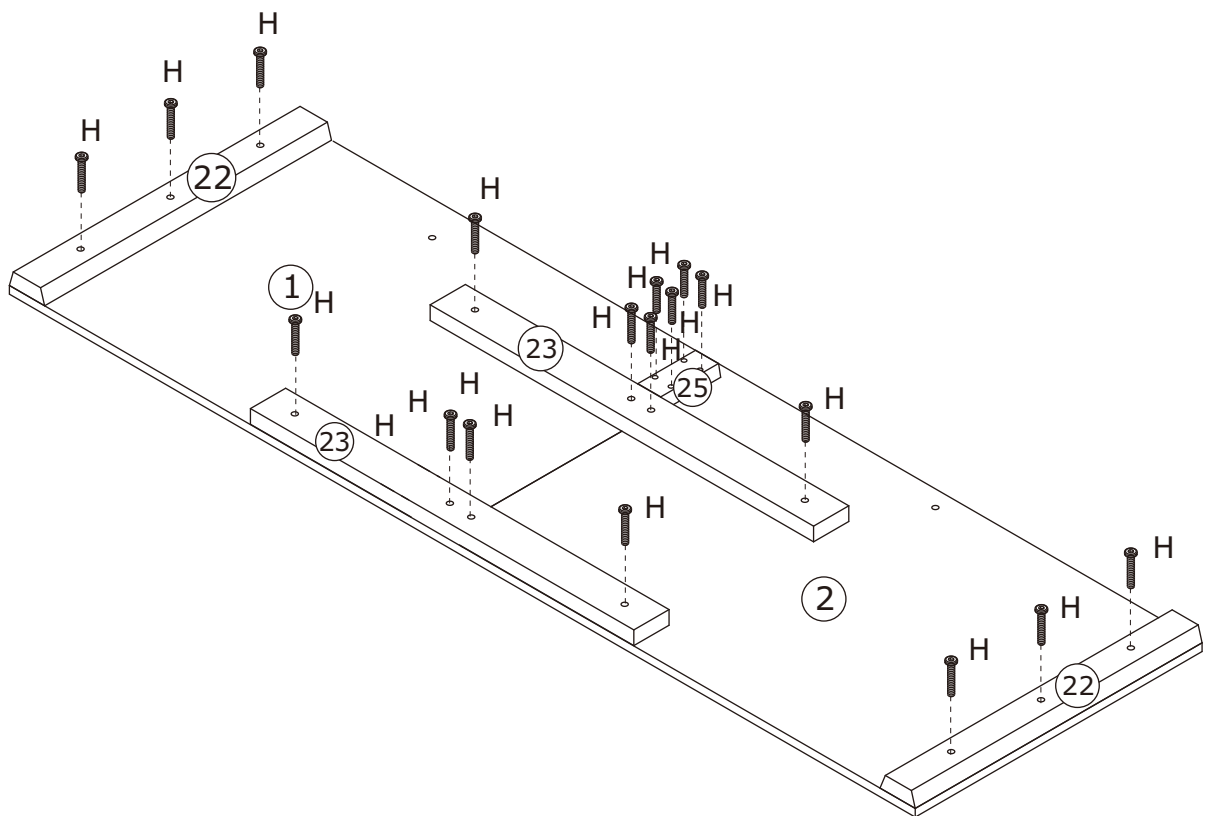
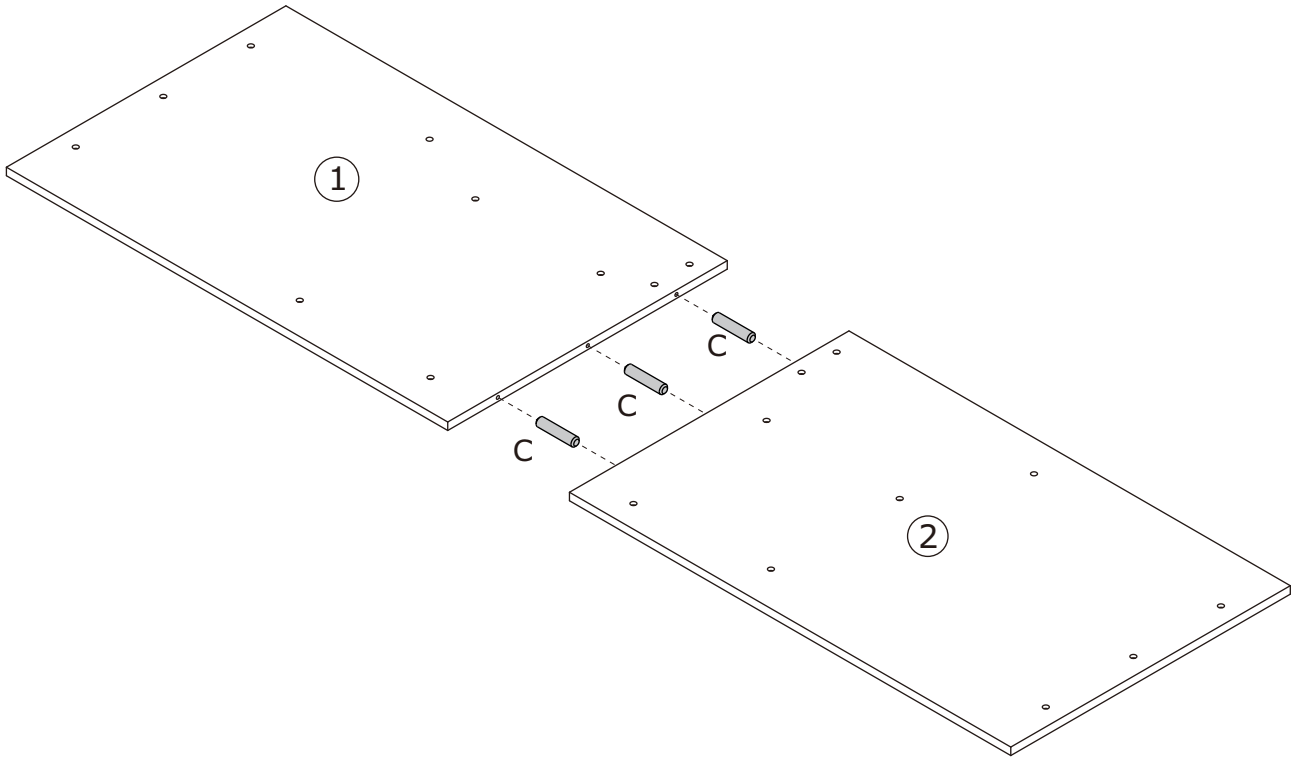

5

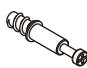
Ax12

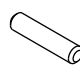
 $\phi 5 \times 31 \text{ mm}$

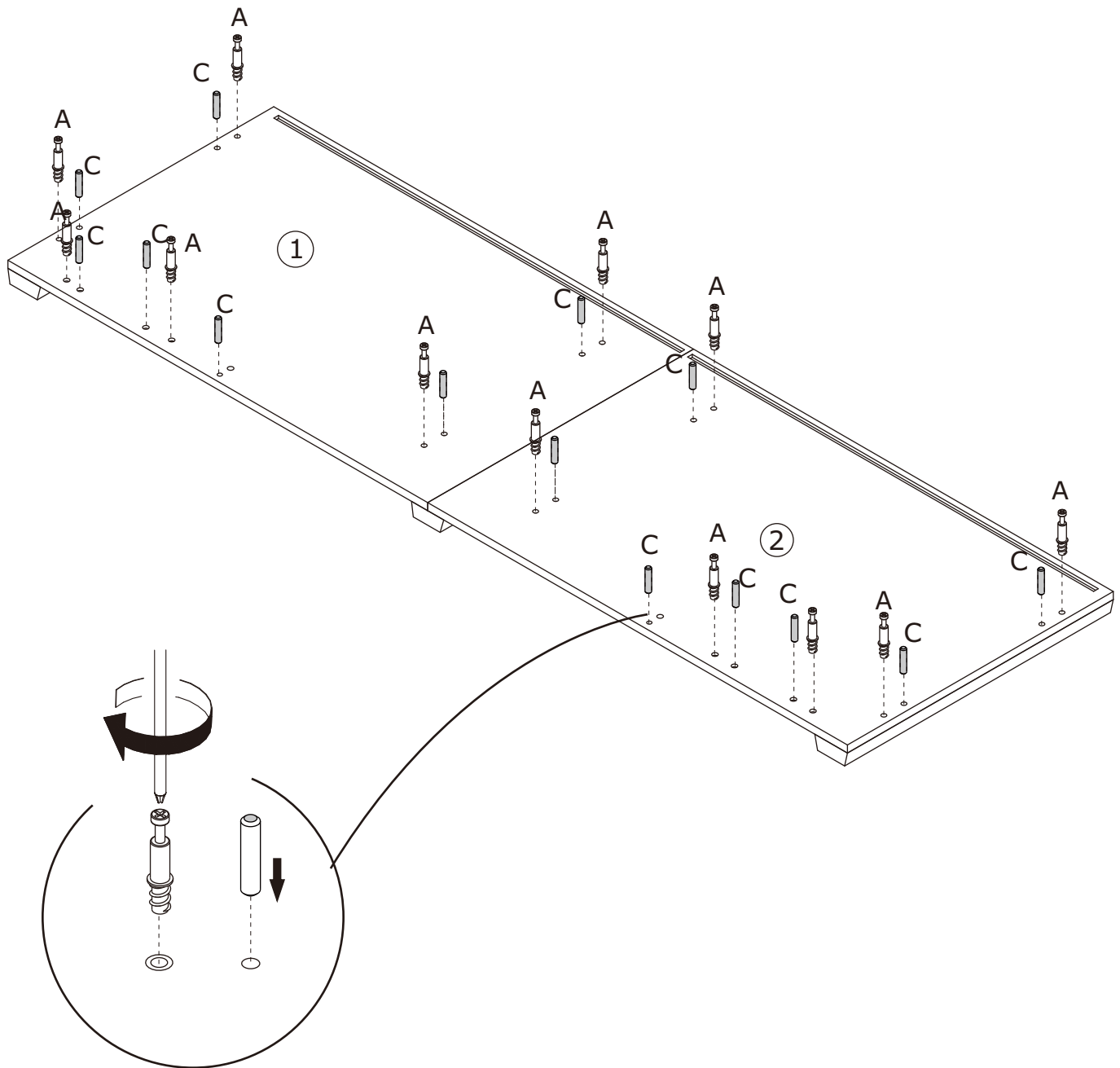
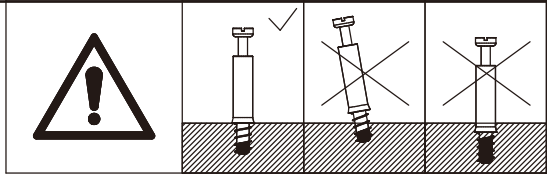
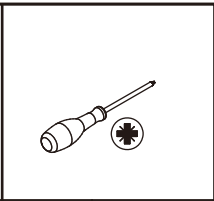
Cx14

 $\phi 8 \times 30 \text{ mm}$



6

Bx2



Ø15x11mm

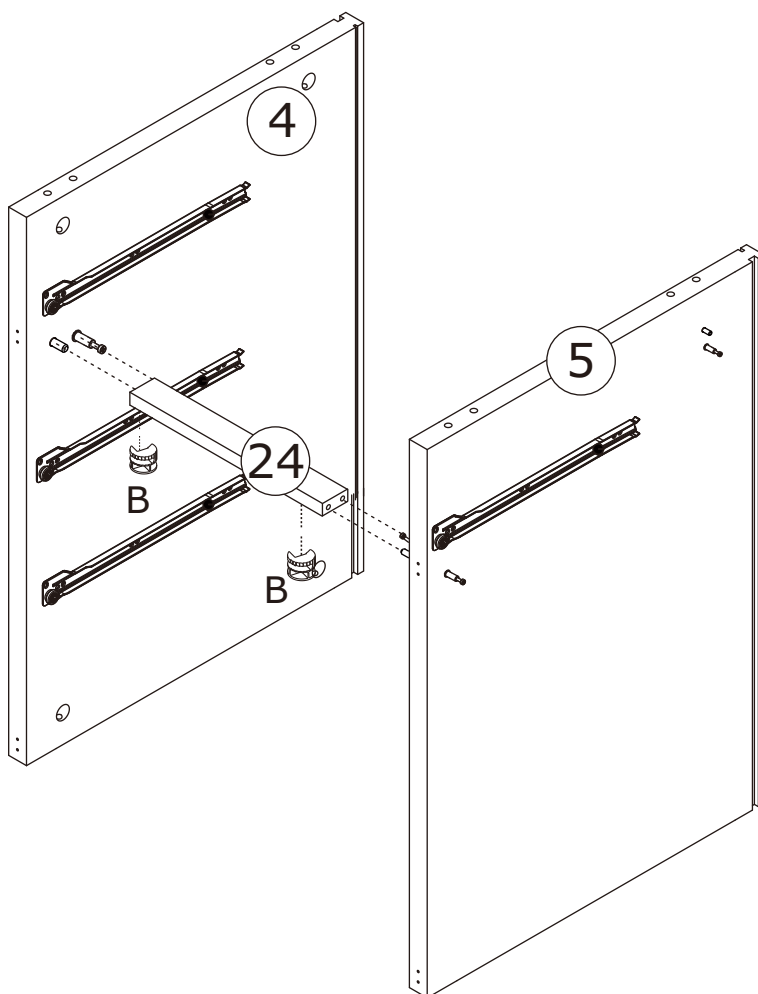
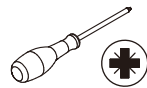

7

Bx4



Ø15x11mm

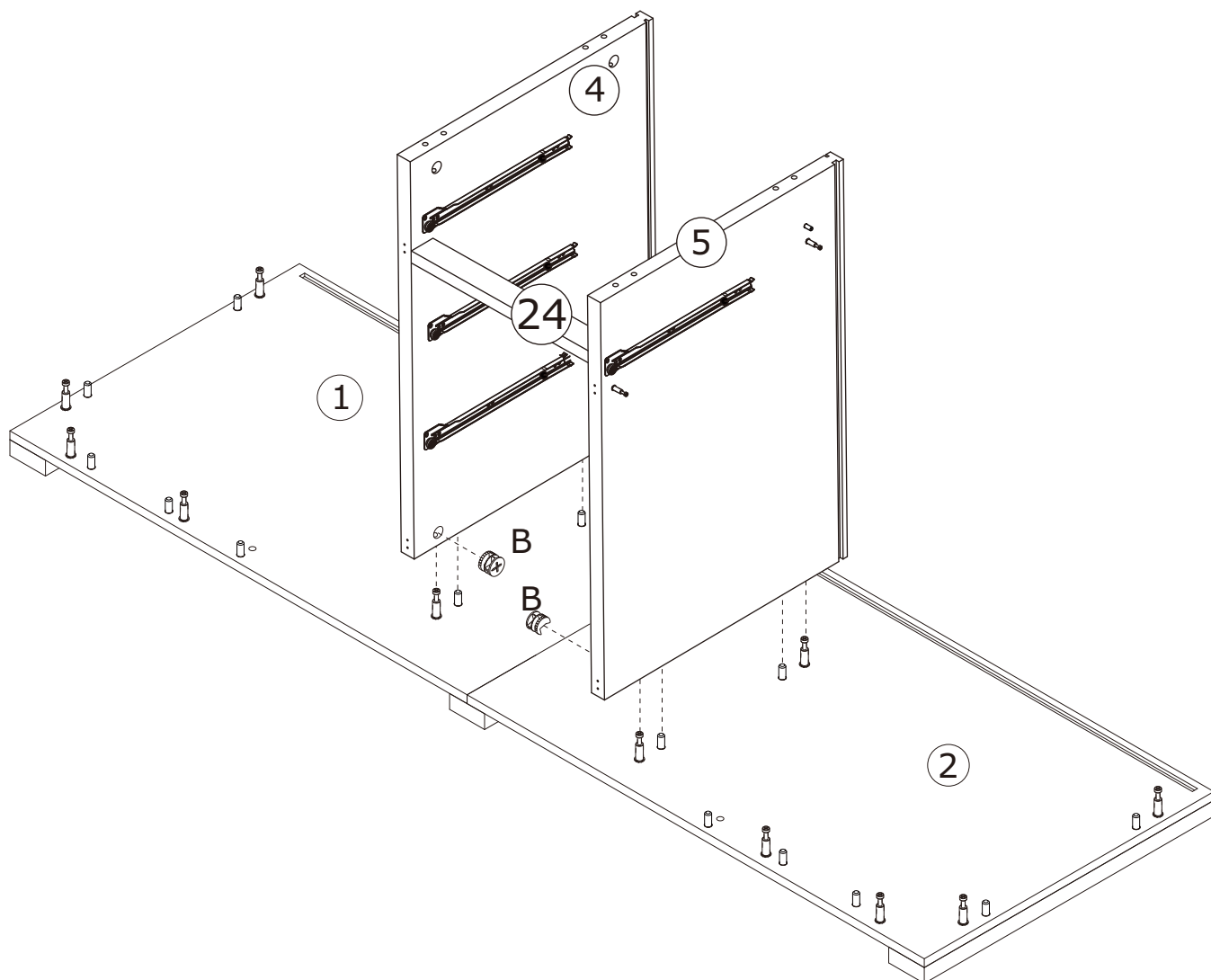
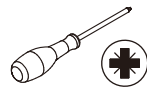

8

A x 2



Ø5x31mm

R x 2



Ø6x40mm

F x 2

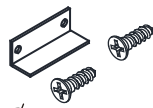

Ø3x12 mm

C x 2



Ø8x30mm

B x 2



Ø15x11 mm

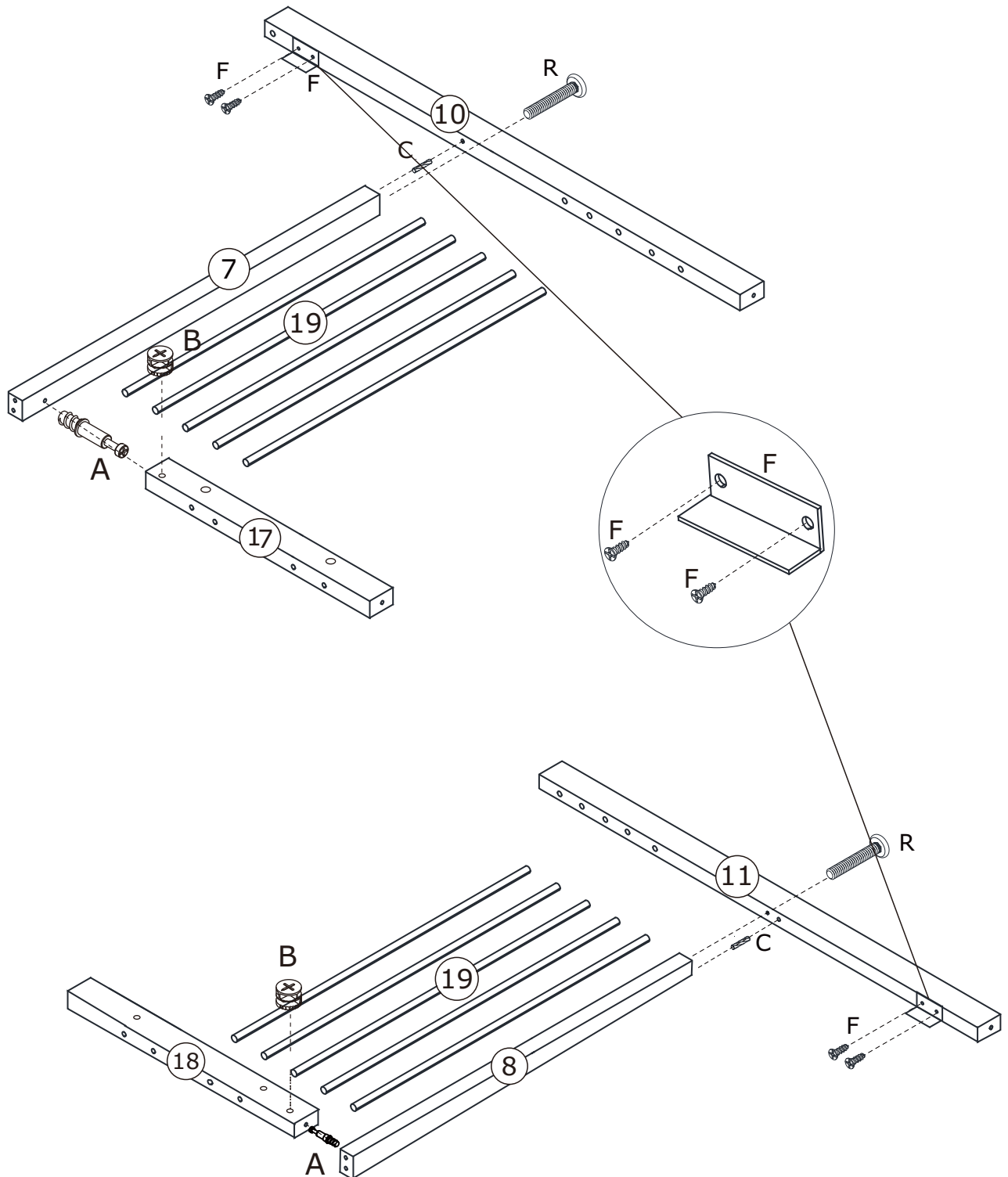
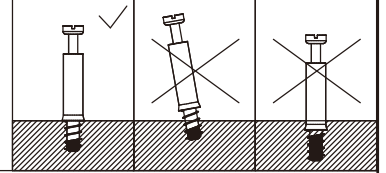
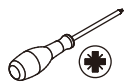

9

Bx6



Ø 15x11mm

Gx2



Ø 6x25mm

Ax2



Ø 5x31mm

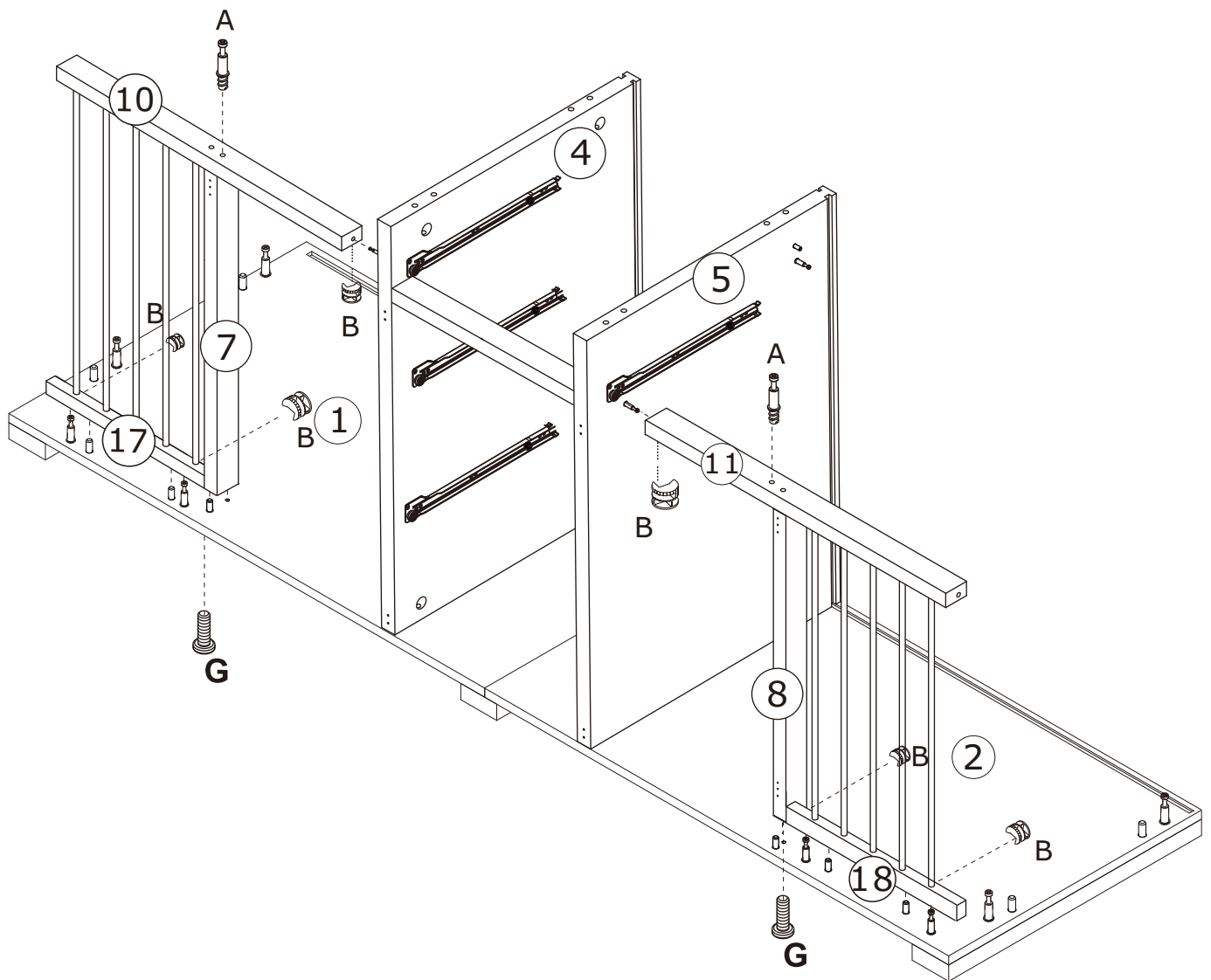
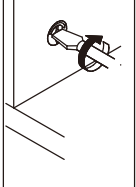
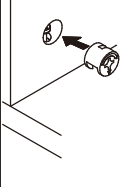
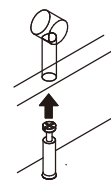
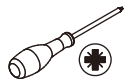

10

Bx8



Ø15x11mm

Cx4



Ø8x30mm

Ax4



Ø5x31mm

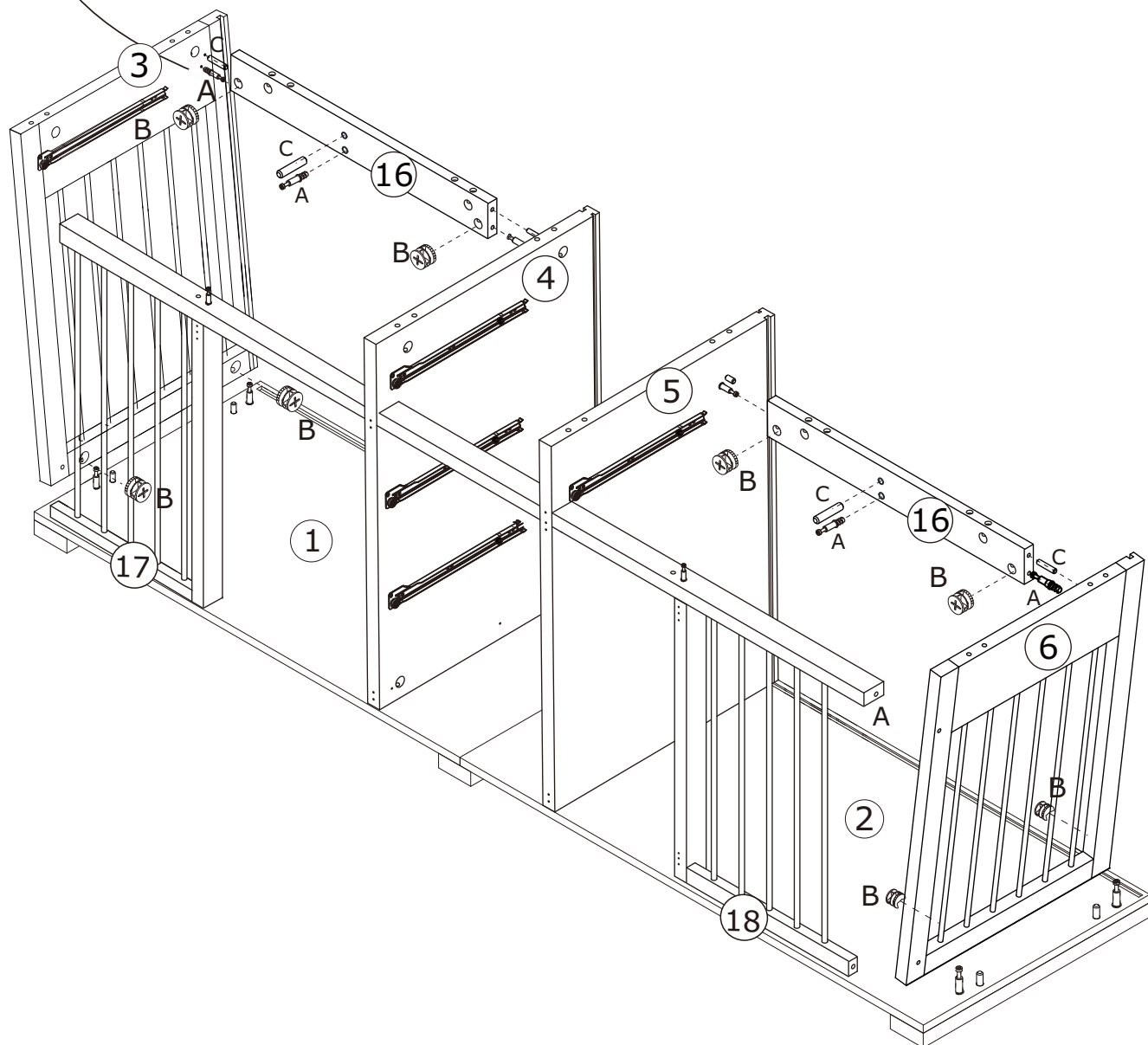
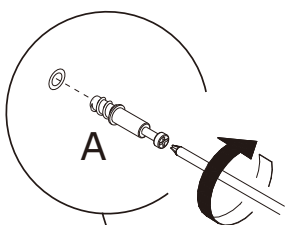

11

Rx4



Ø 6x40mm

Dx1



L=350mm

Ex4



Ø 3x12mm

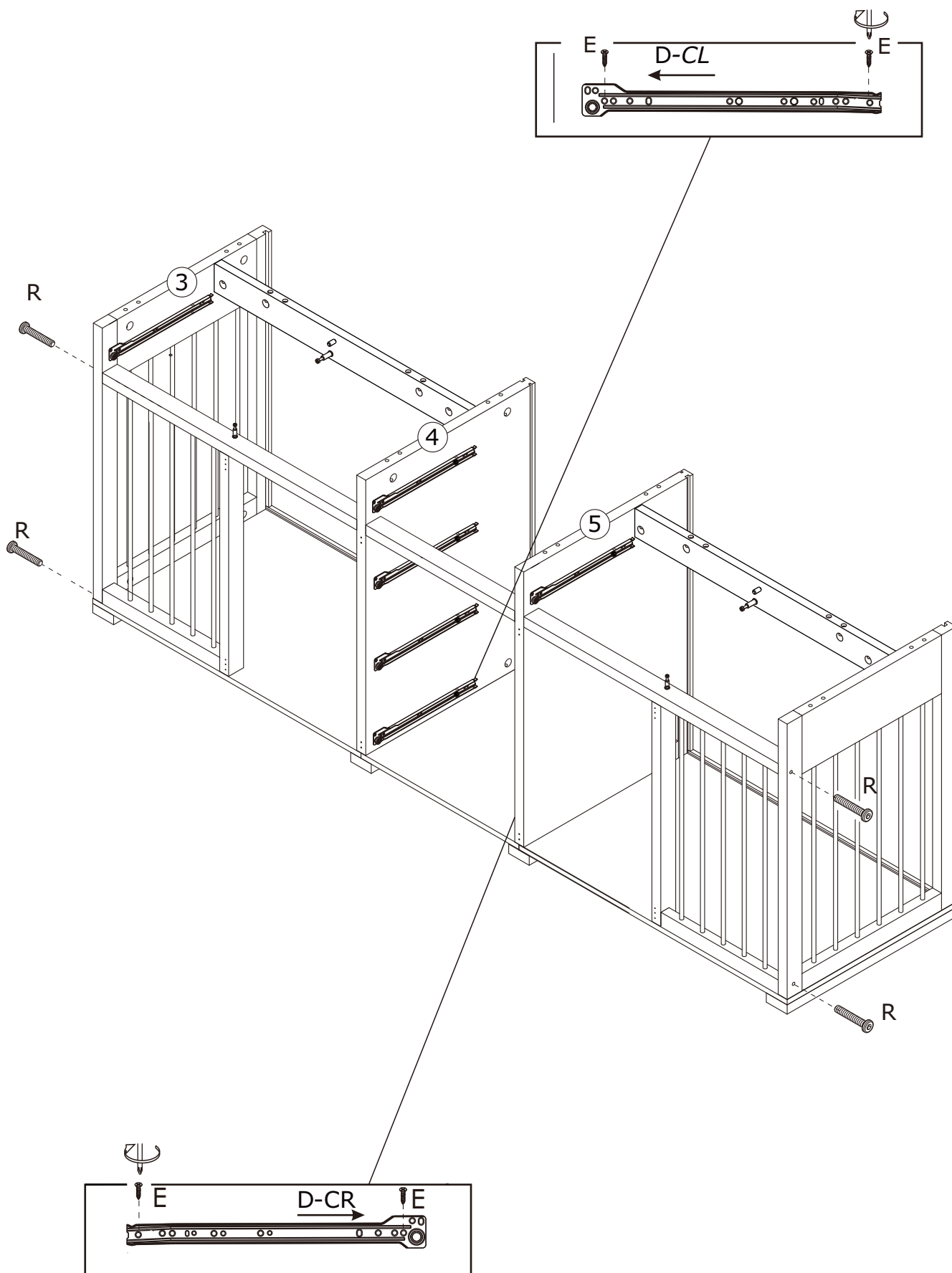

12

Bx4



Ø15x11mm

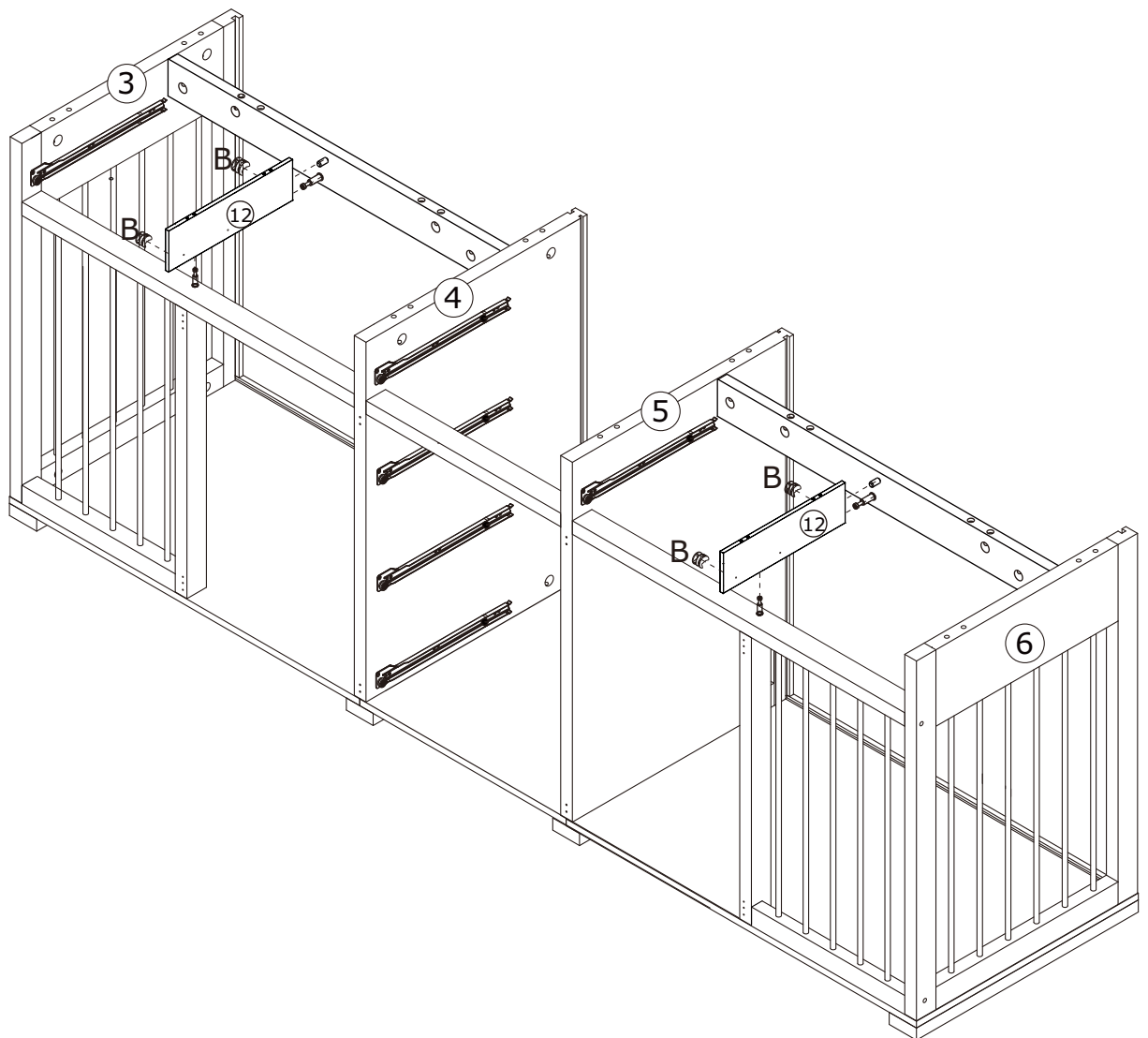

13

Dx2



L=350mm

Ex8



Ø3x12 mm

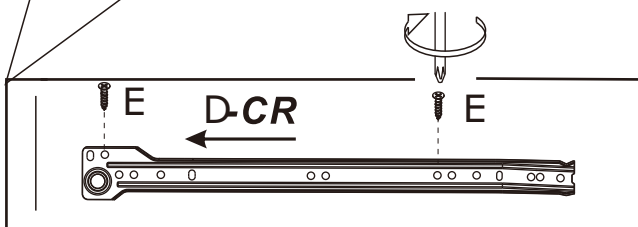
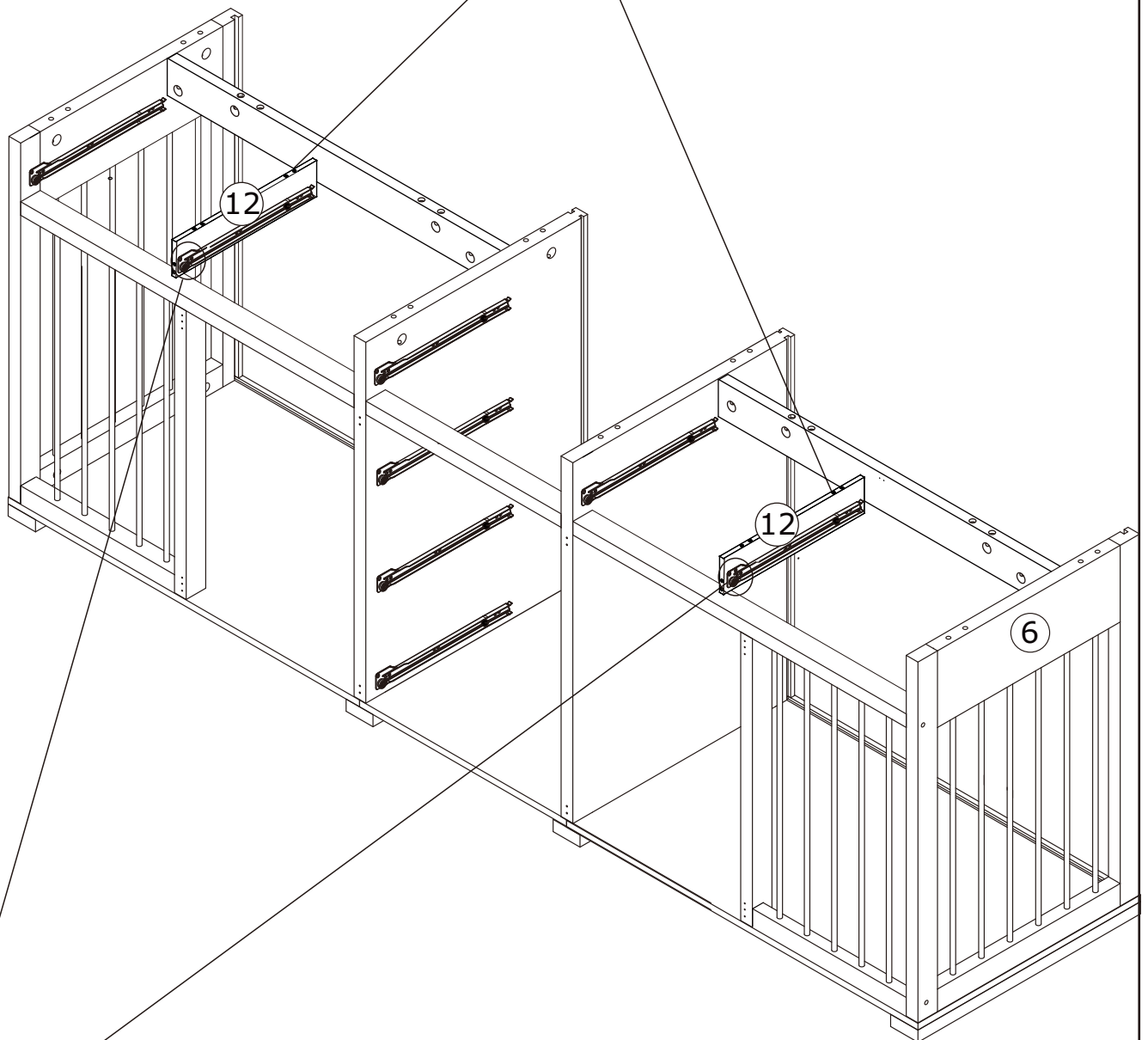
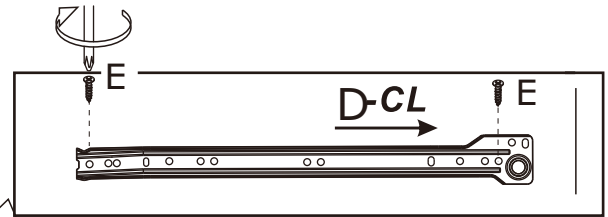
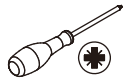

14

Q x 6

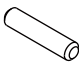
Ø6 x 30mm

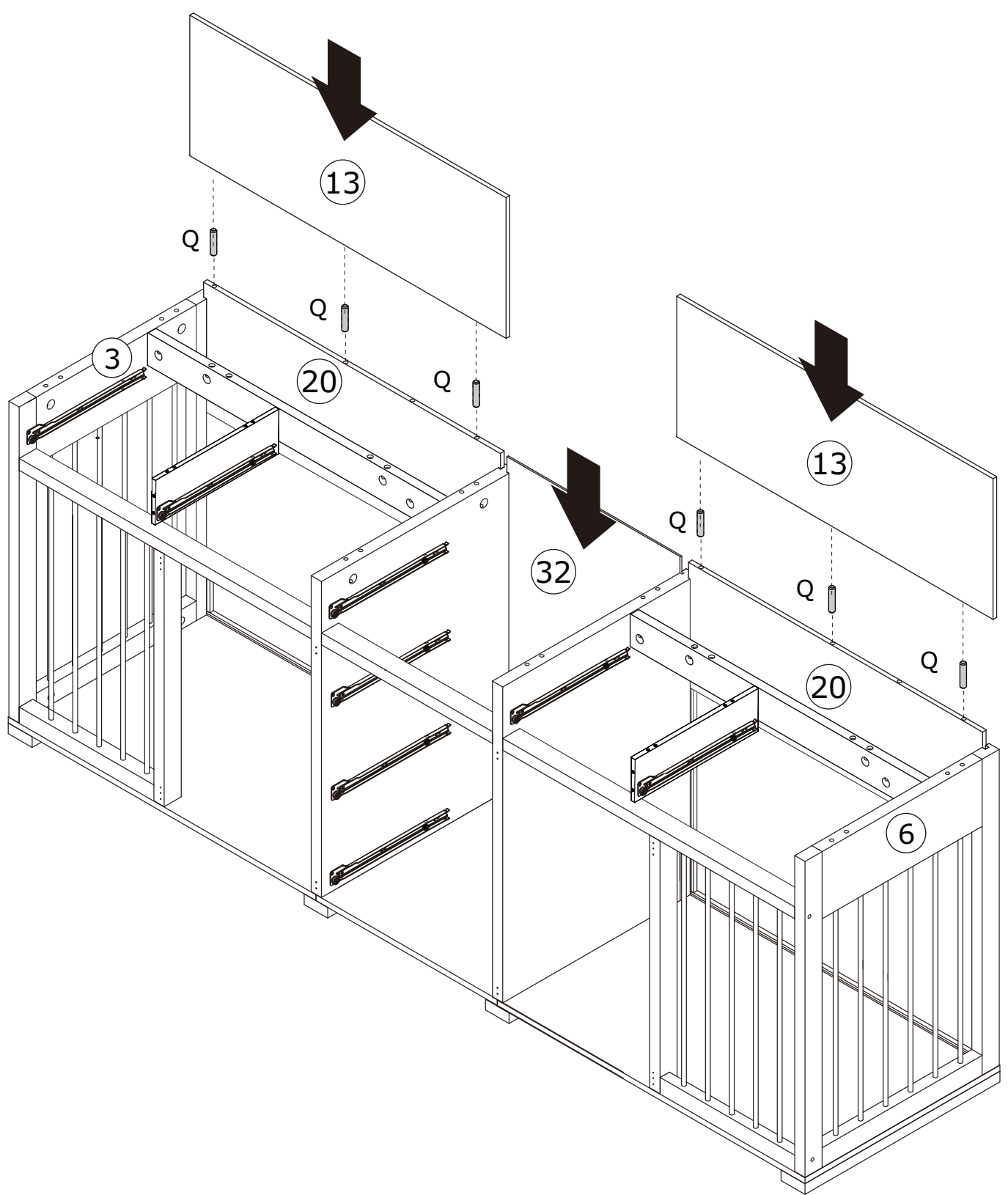
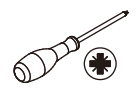

15

Ax16



Ø5x31mm

Sx3



Ø8x30mm

T x 6



Ø 6x20 mm

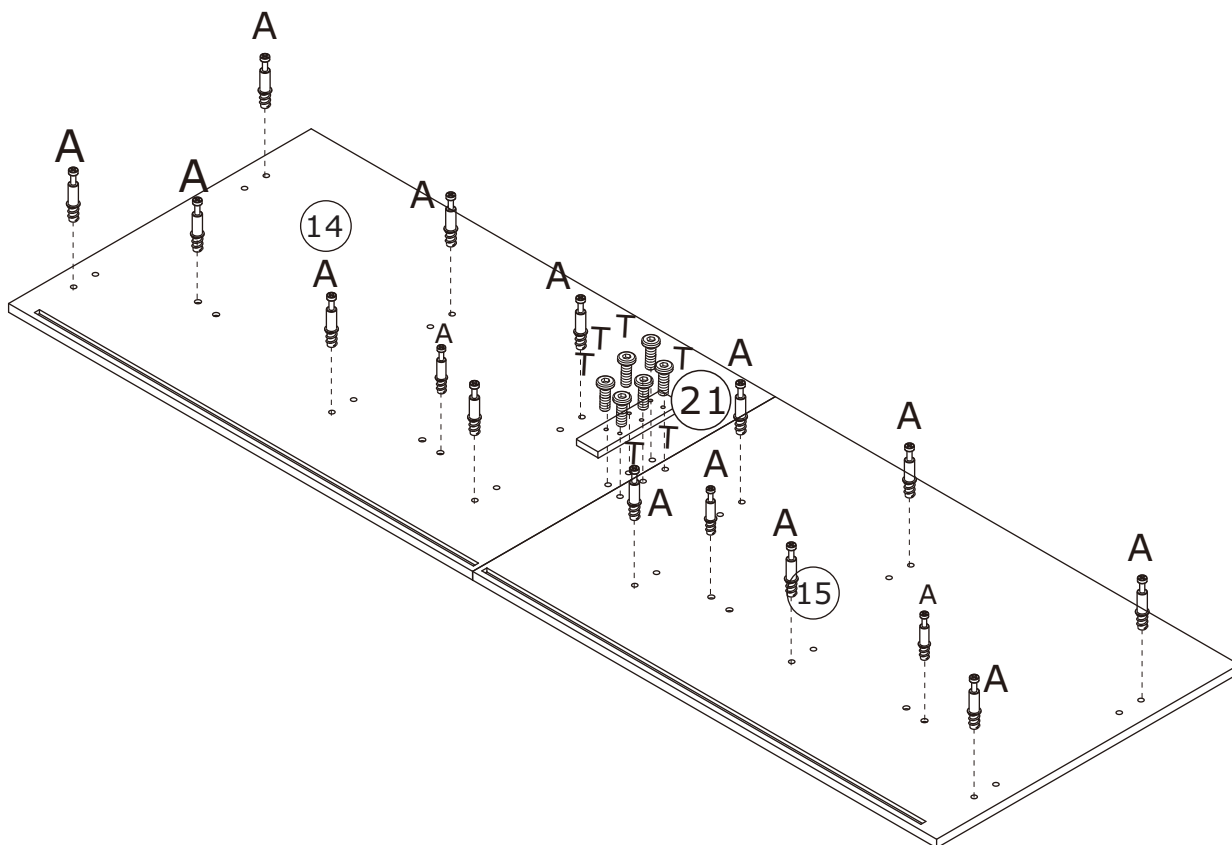
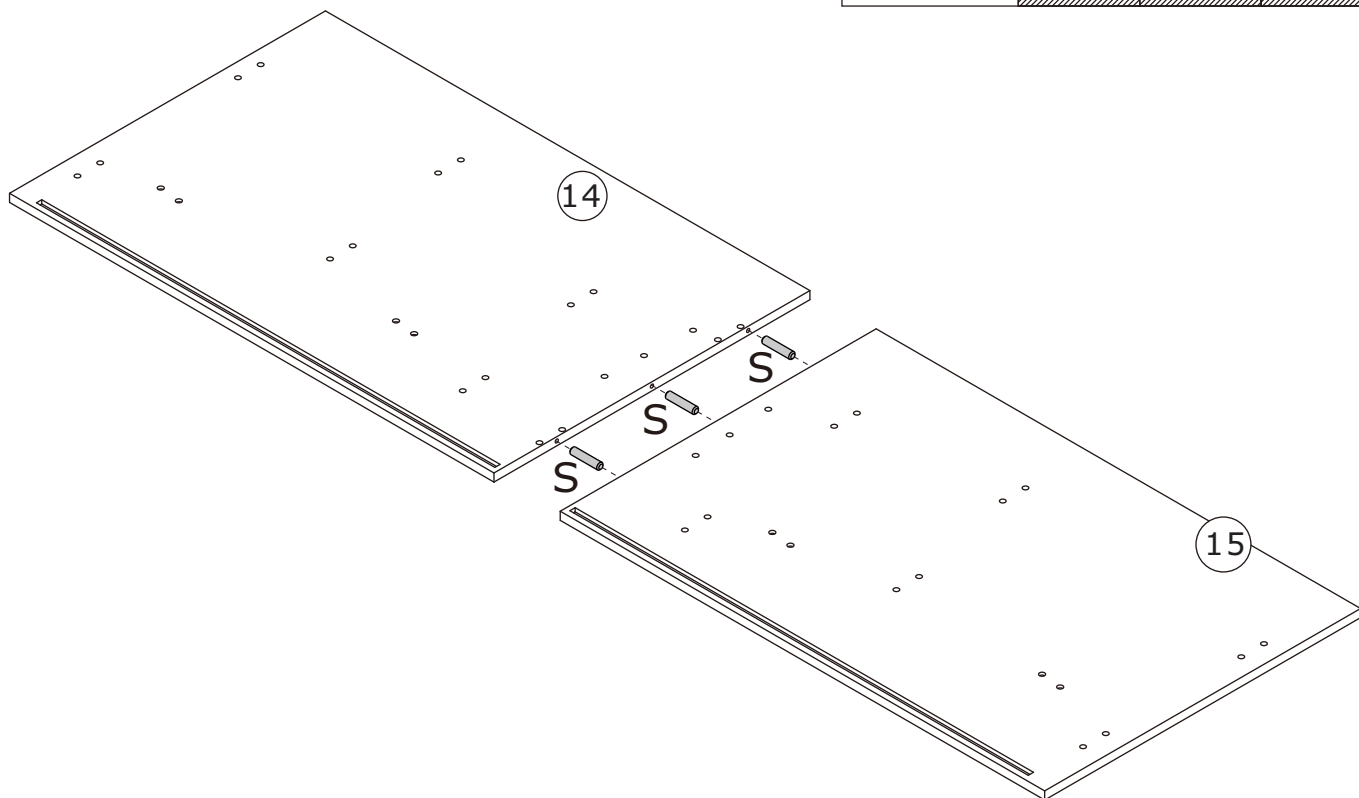
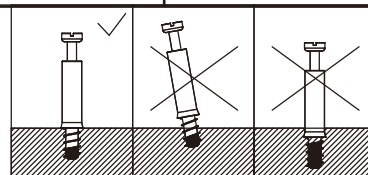

16

Bx16



Ø15x11mm

Cx16



Ø8x30mm

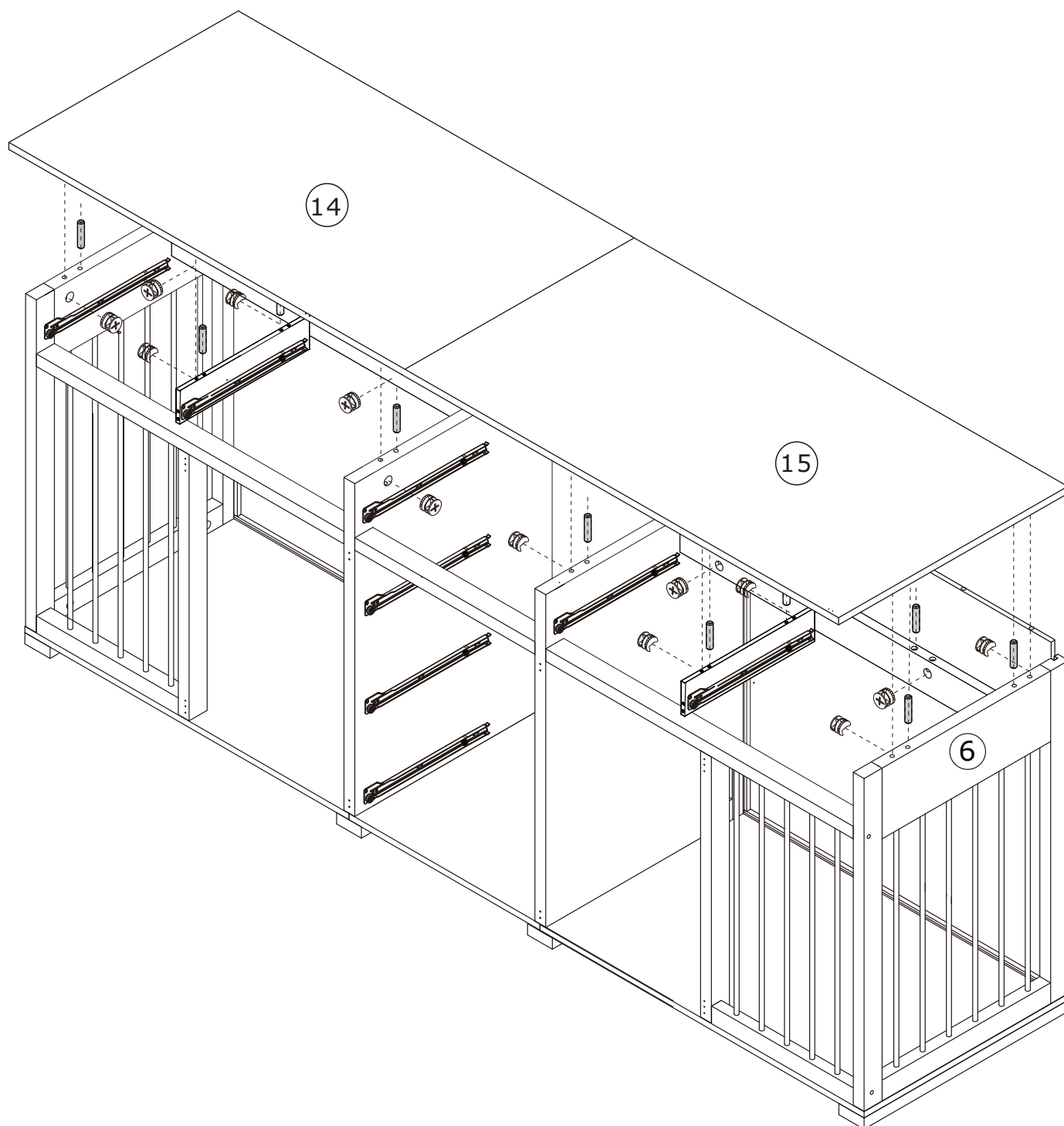
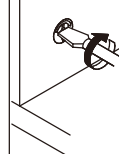

17

Lx18

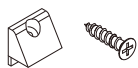

Ø 3x12mm

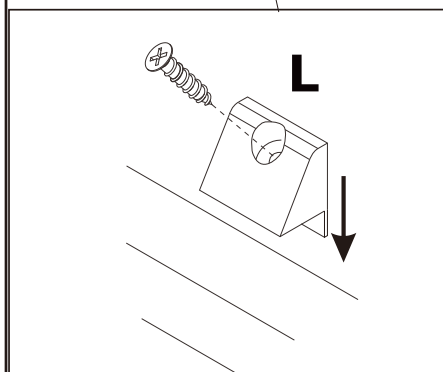
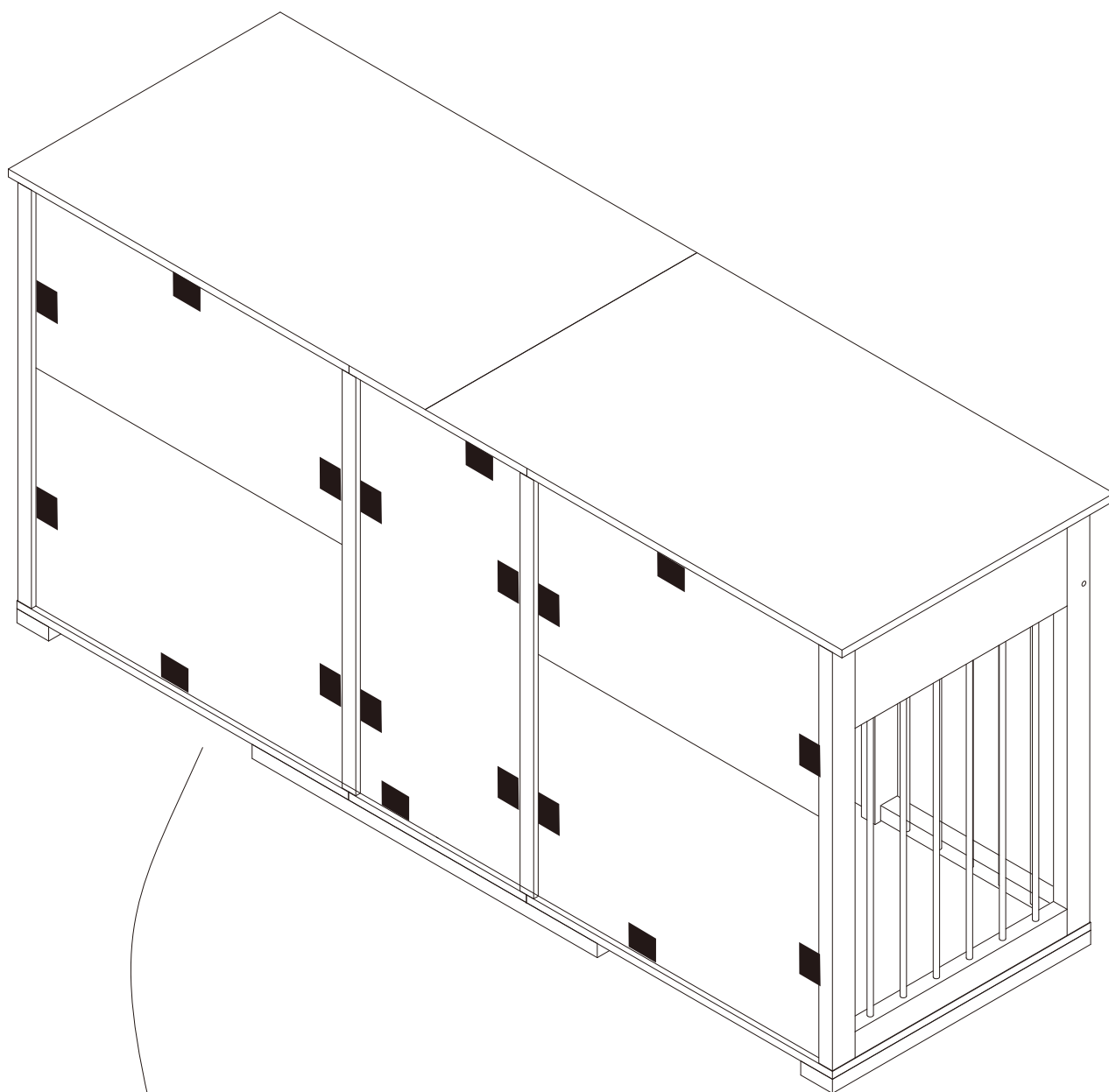

18

Kx4



Kx12



Ø 3x12mm

Jx4



Jx16



Ø 3.5x14mm

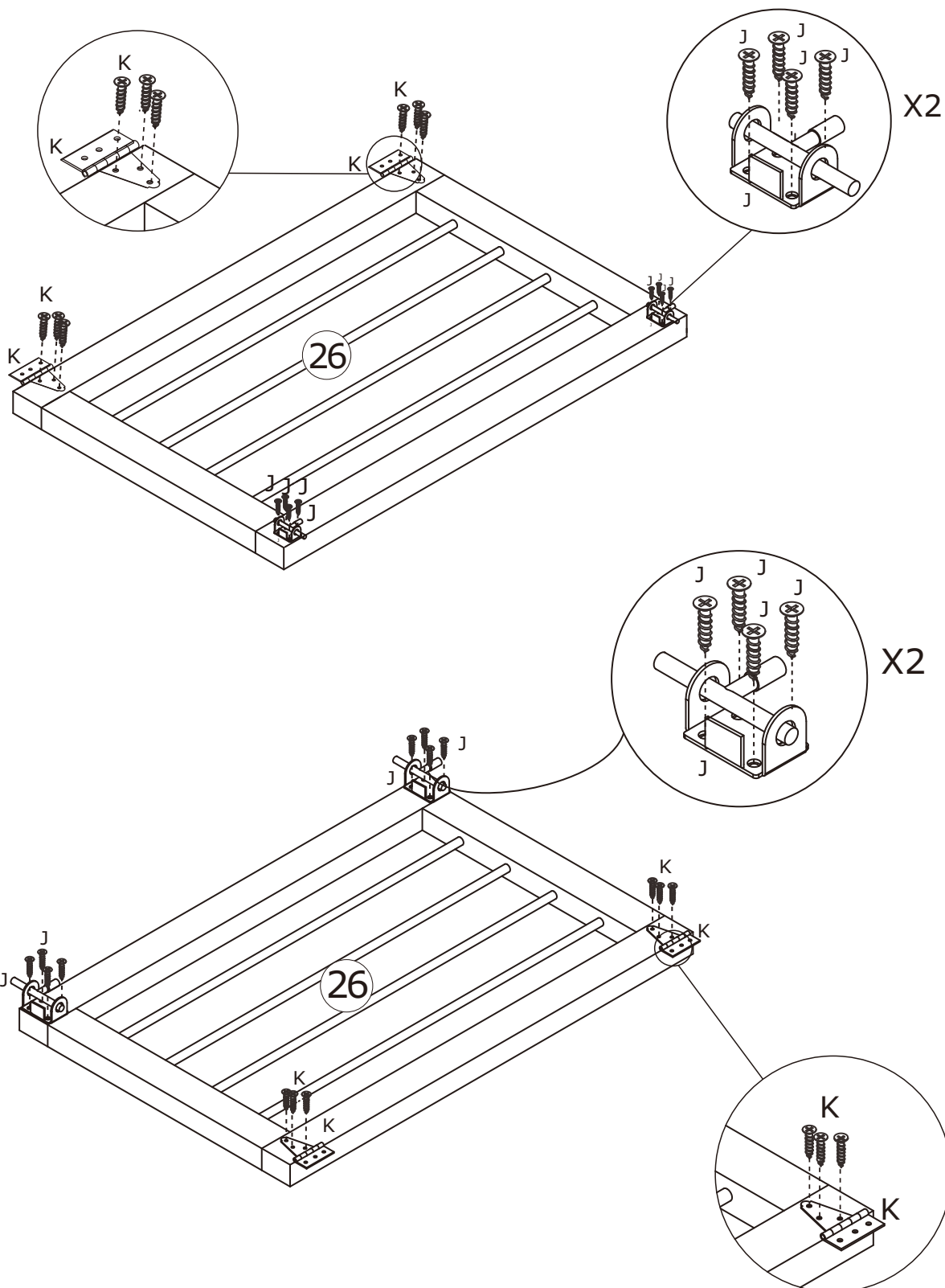

19

Kx12



Ø3x12mm

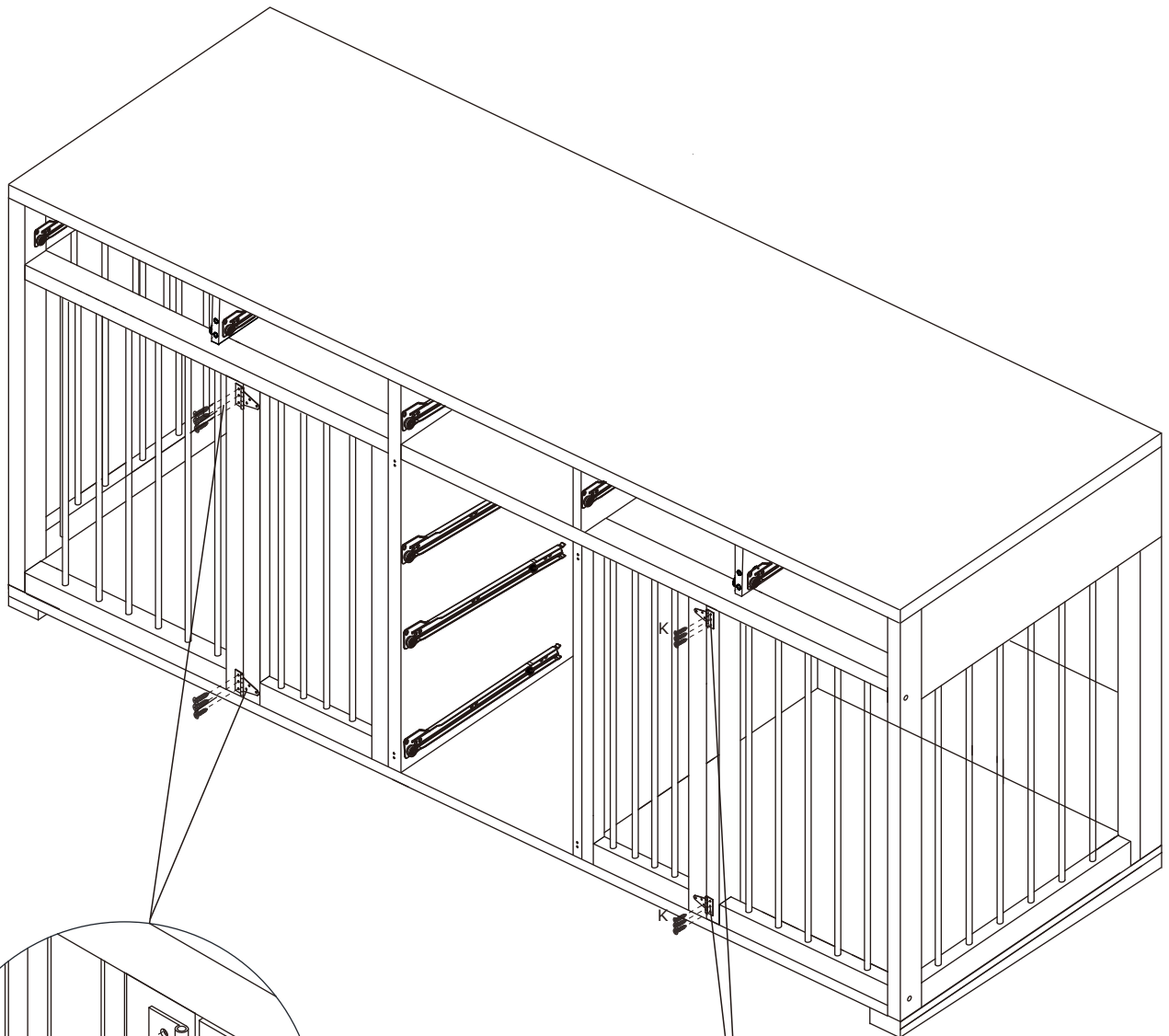
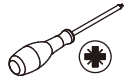

20

Jx2



Jx4



Ø 3.5x14mm

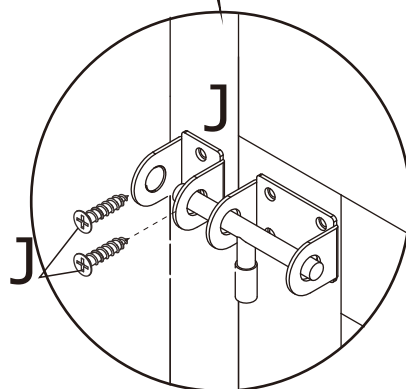
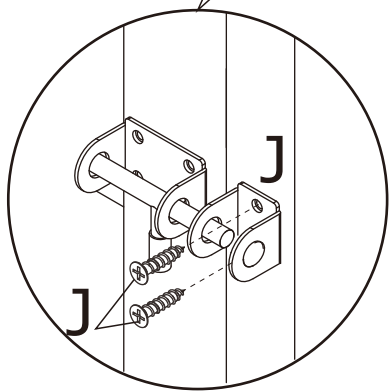
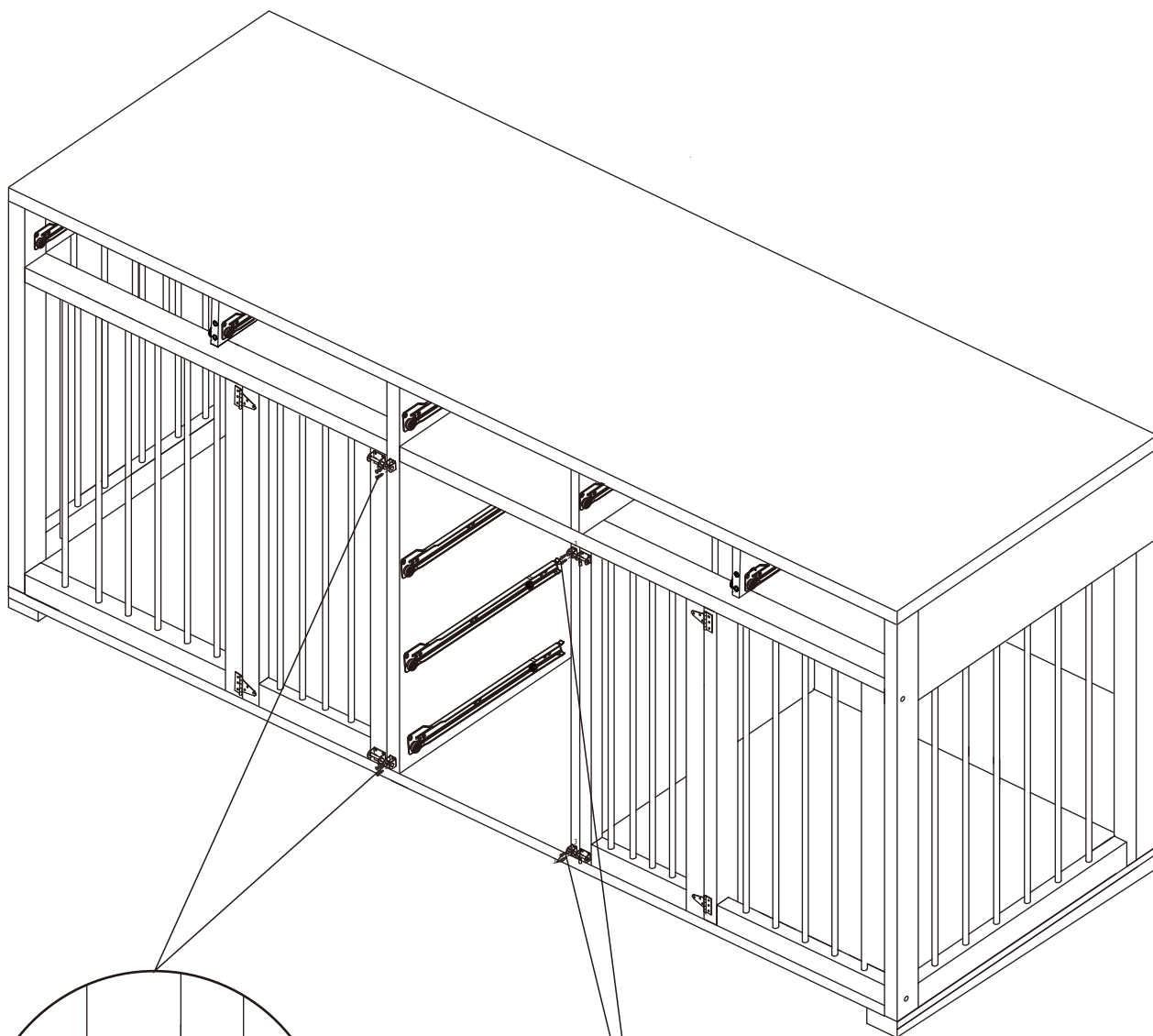

21

Ax16



Ø5x31mm

Bx16





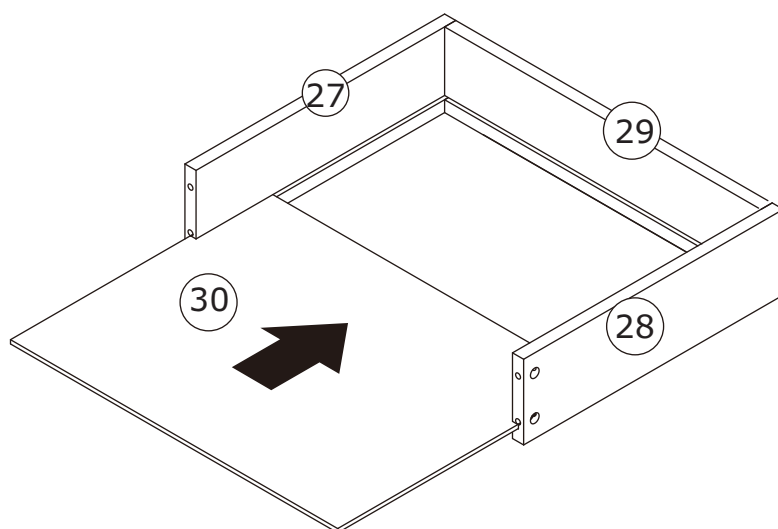
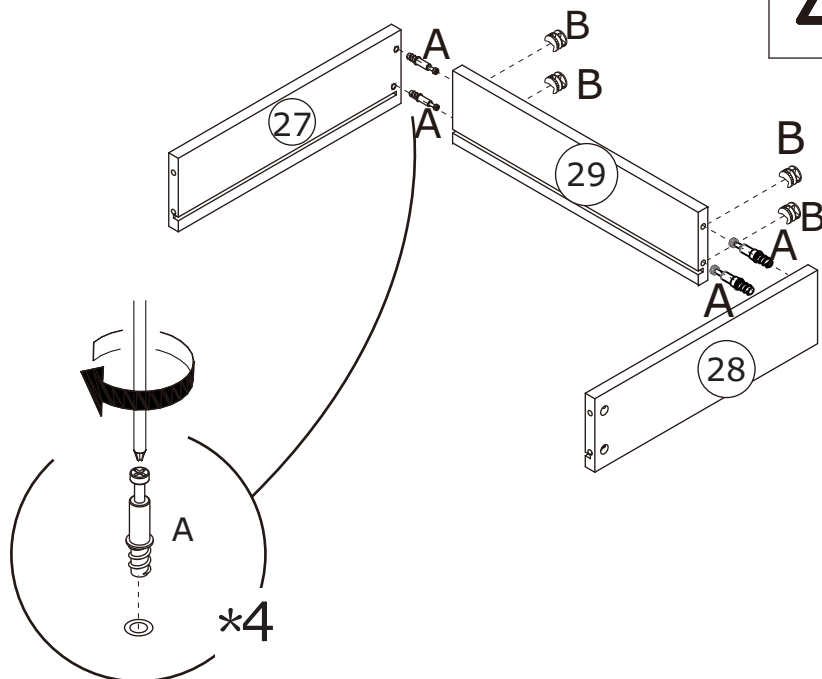
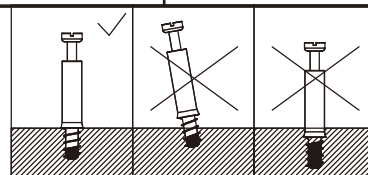



Ø15x11mm

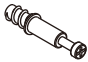

X4



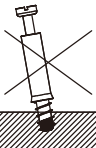
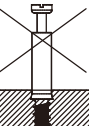

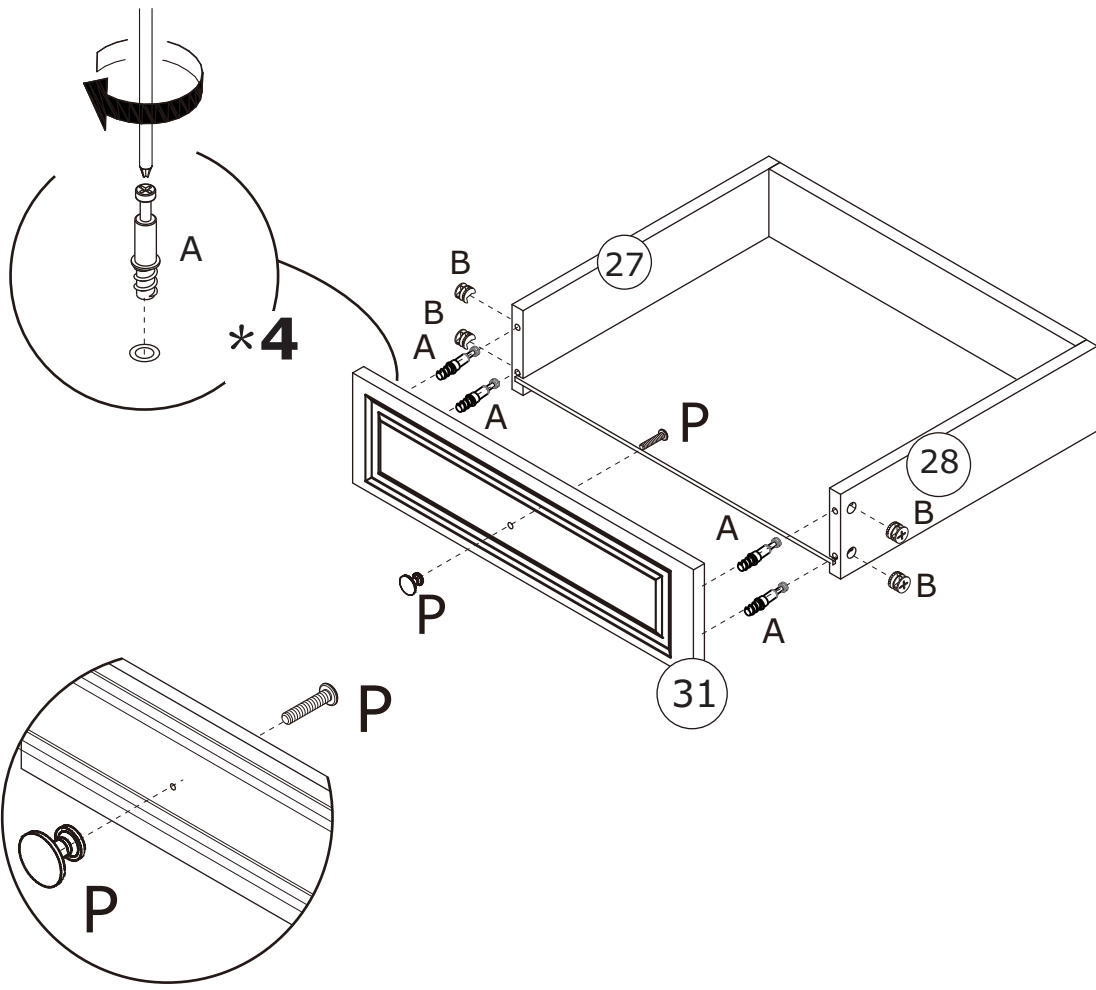
22

Ax8  Ø5x31mm	Bx8  Ø15x11mm	Px2  Ø4x18mm			
					

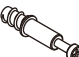

X2

23

Ax8  Ø5x31mm	Bx8  Ø15x11mm	Px2  Ø4x18mm			
---	--	---	--	--	---

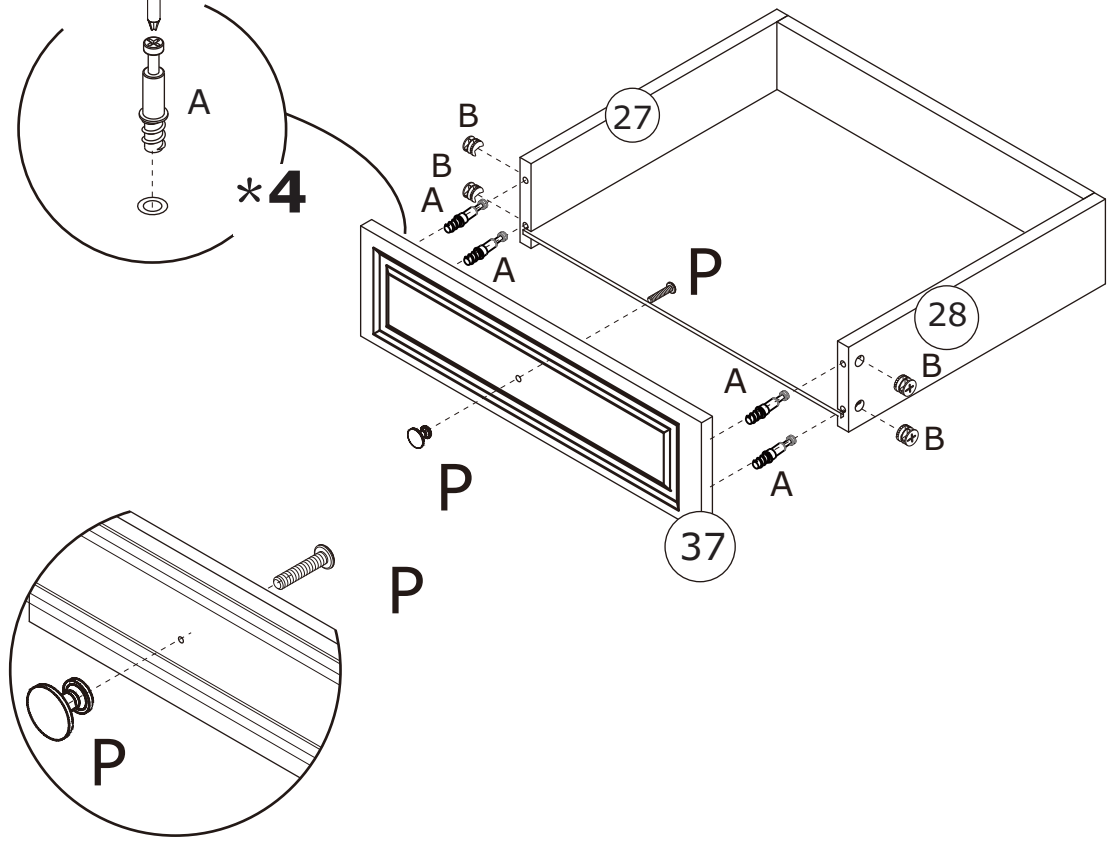
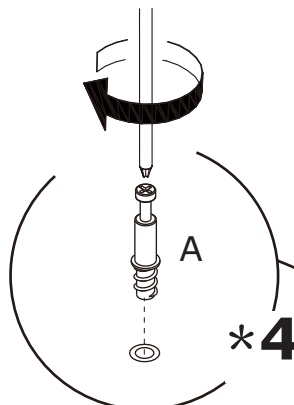
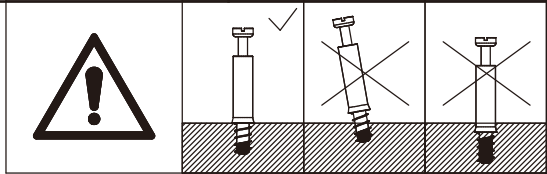

X2

24

Dx4

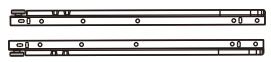

Ex16



Ø 3x12mm

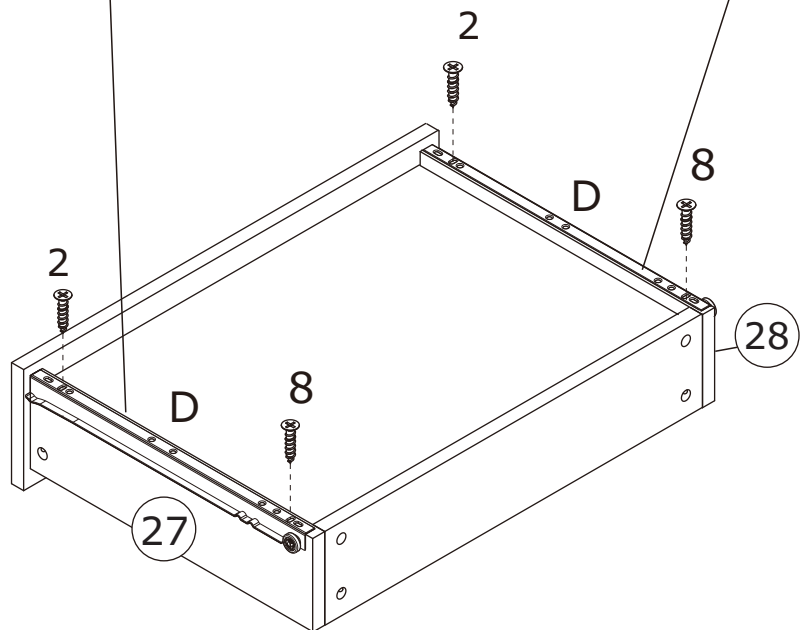
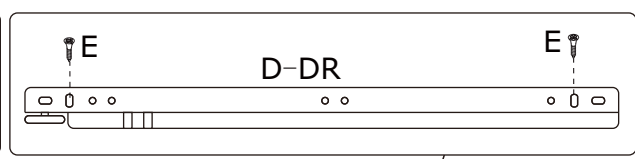
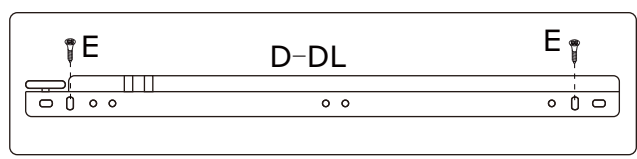
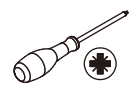

x4

25





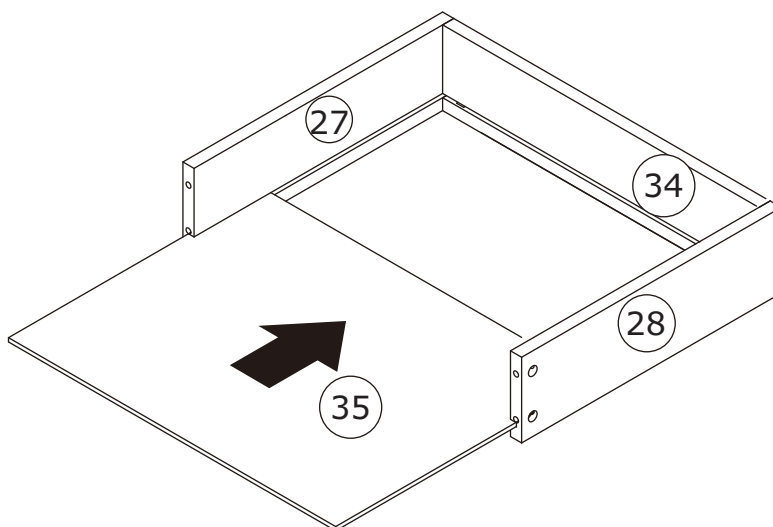
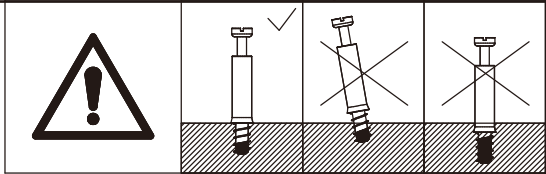

Ø5x31mm

 $\varnothing 15 \times 11 \text{ mm}$

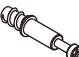

26

<p>Ax4</p>  <p>∅5x31mm</p>	<p>Bx4</p>  <p>∅15x11mm</p>	<p>Px1</p>  <p>∅4x18mm</p>		
---	--	---	--	---

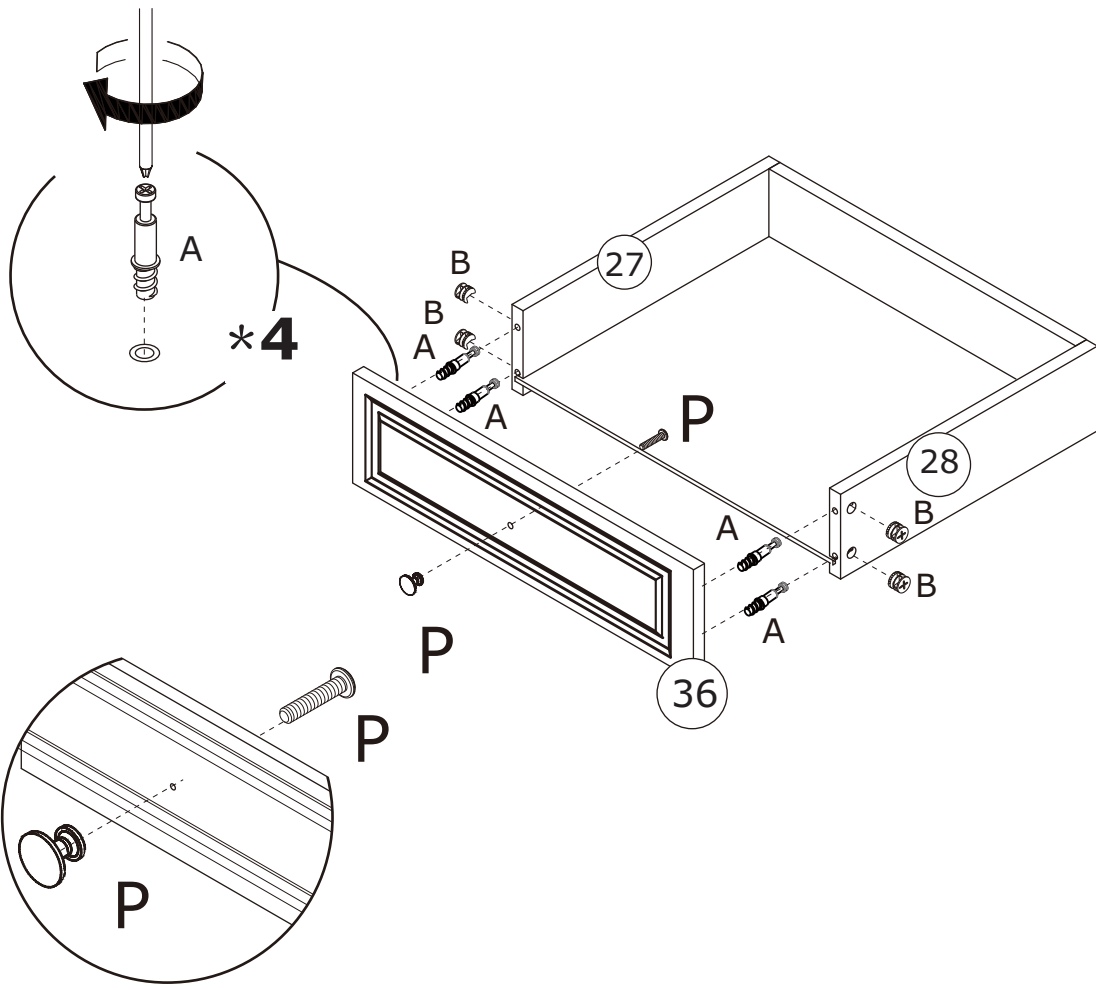
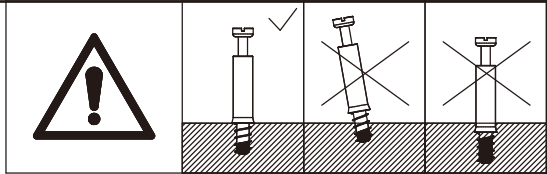

27

Dx1

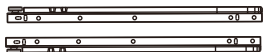

Ex4



Ø 3x12mm

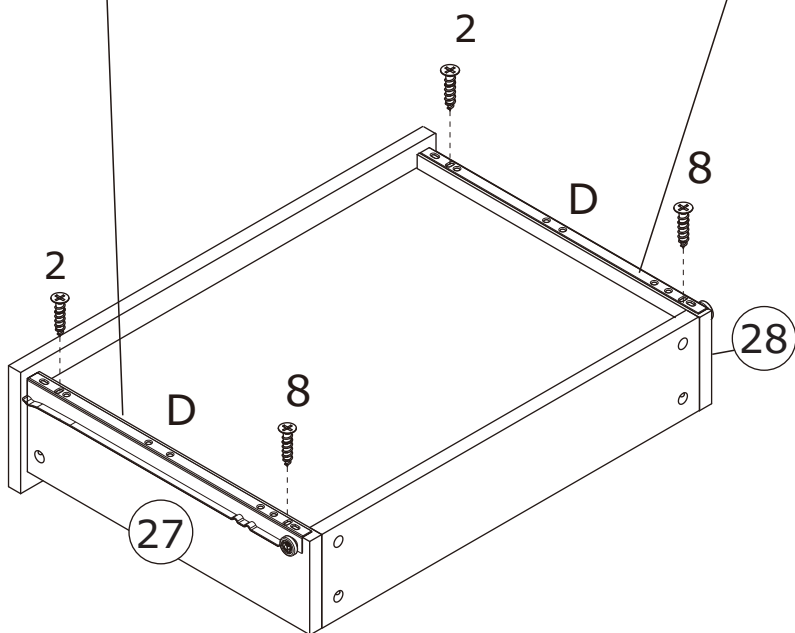
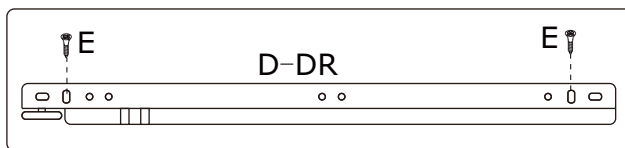
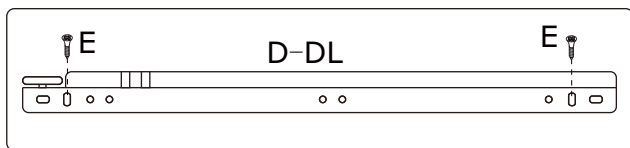

28

Ax12



Ø5x31mm

Bx12





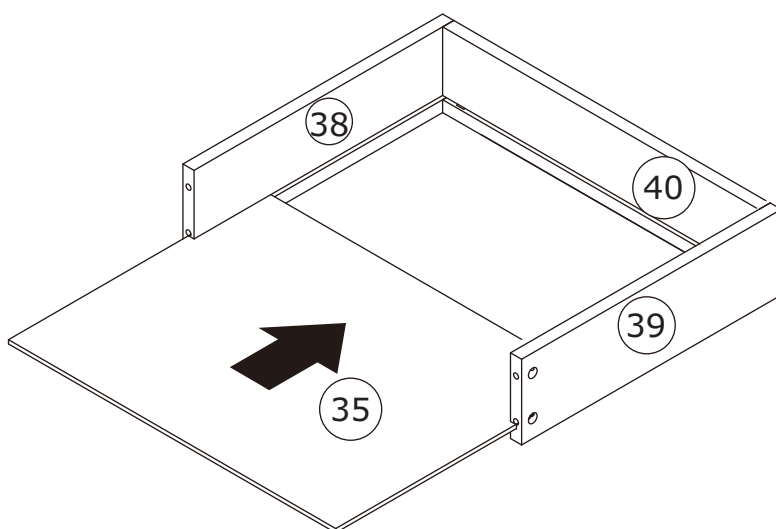
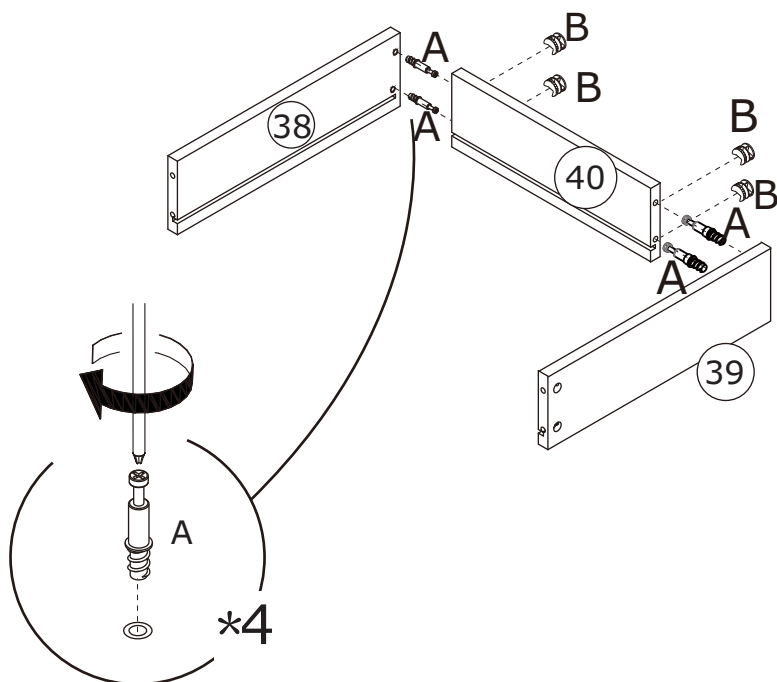
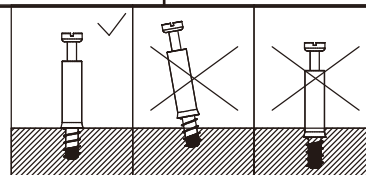

Ø15x11mm

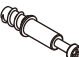

x3

29

Ax12  Ø5x31mm	Bx12  Ø15x11mm	Px3  Ø4x18mm		
--	---	---	--	---

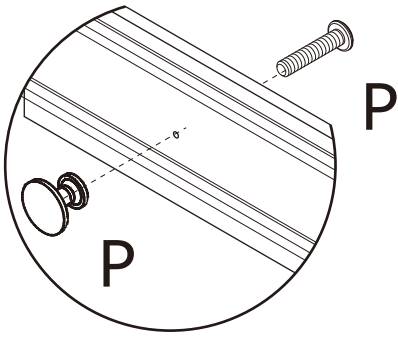
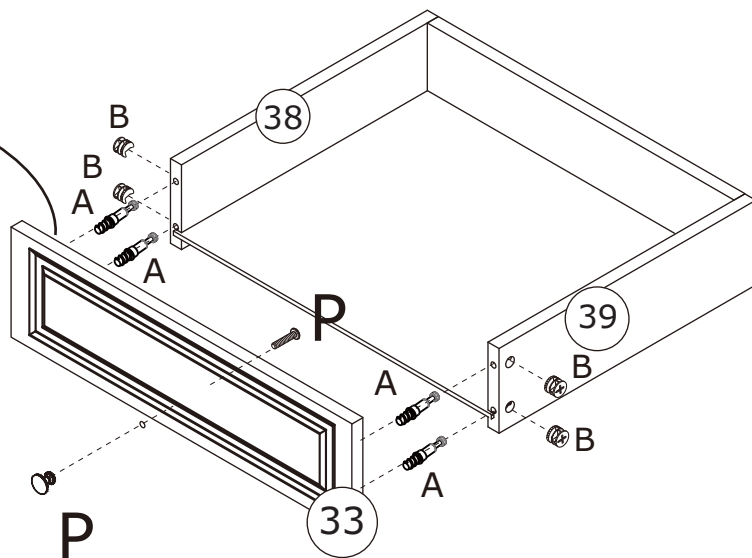
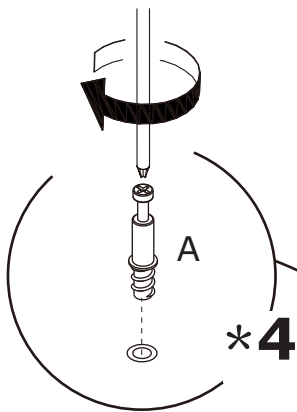
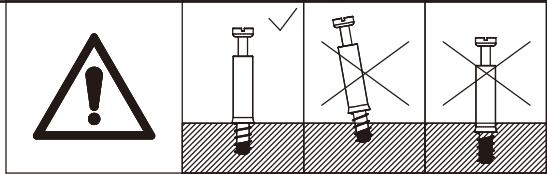

X3

30

Dx3

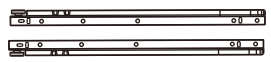

Ex12



Ø 3x12mm

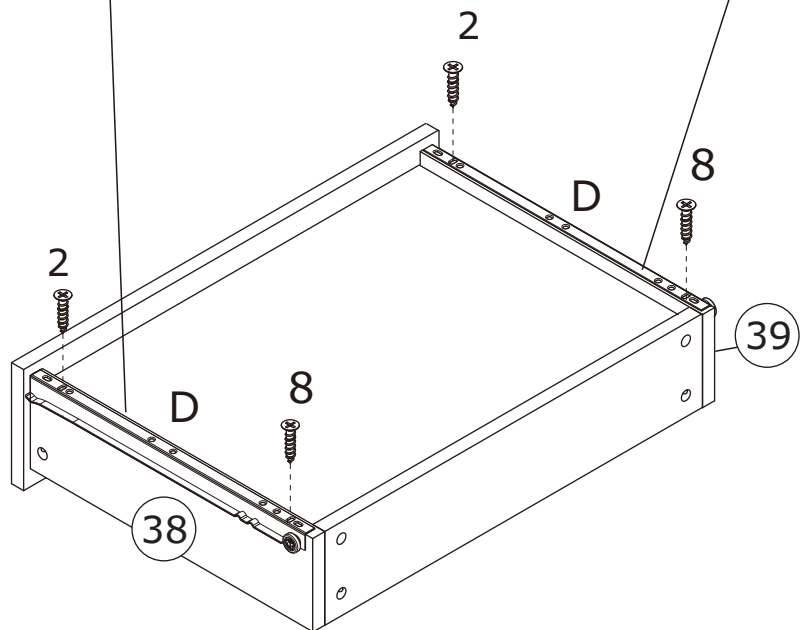
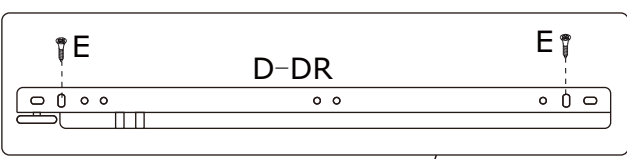
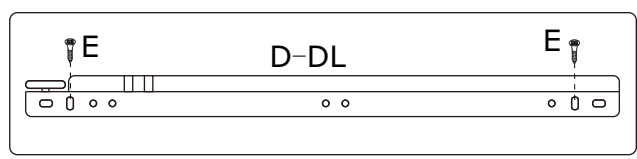

x3

31

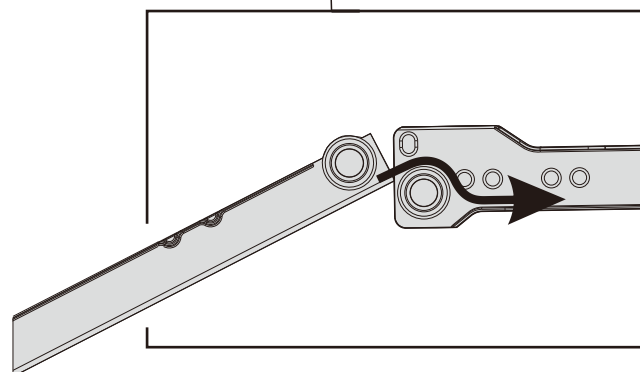
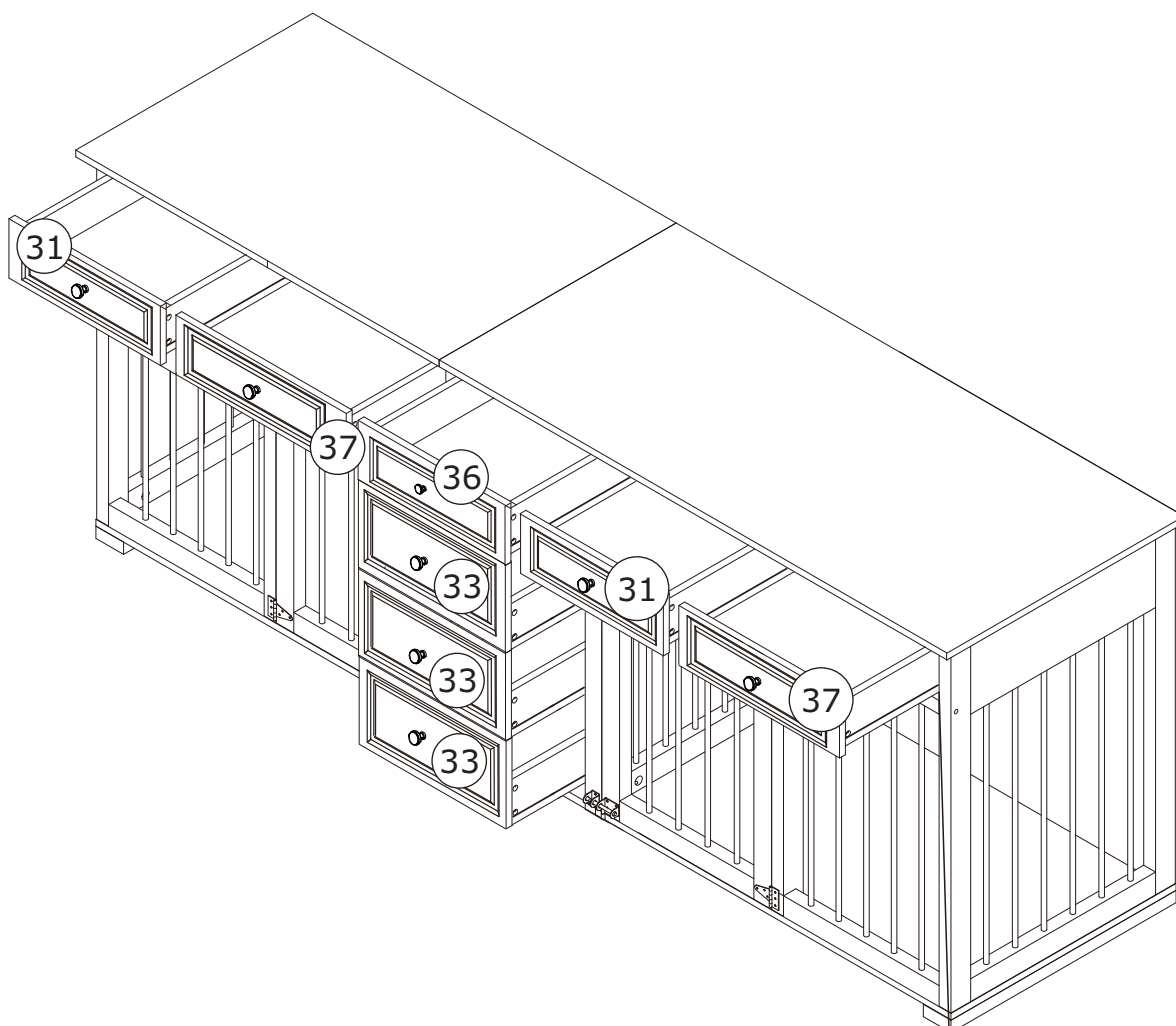

32

Mx6



NX106



Zx1

lovinöuse

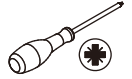

lovinöuse

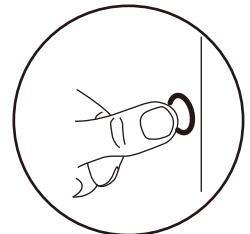
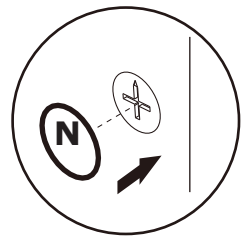
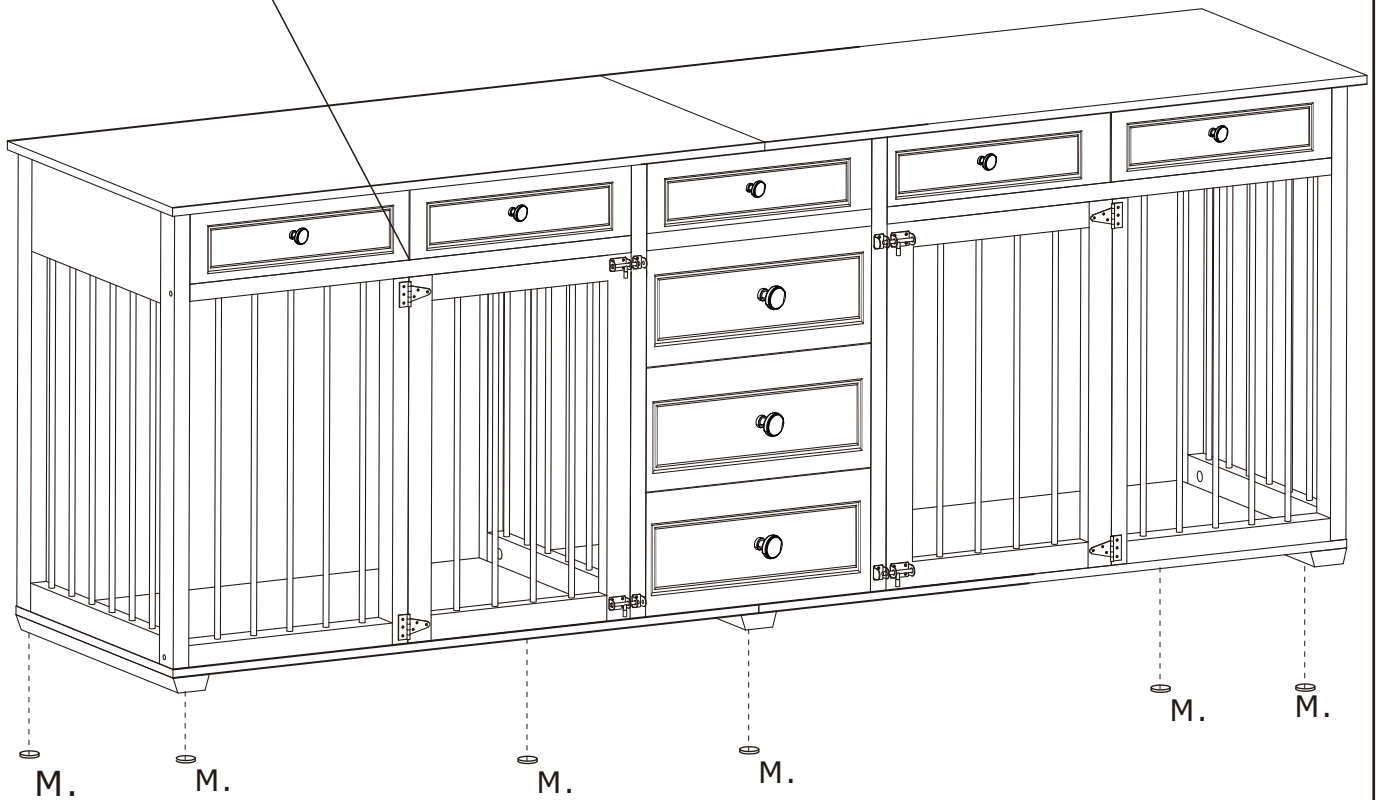

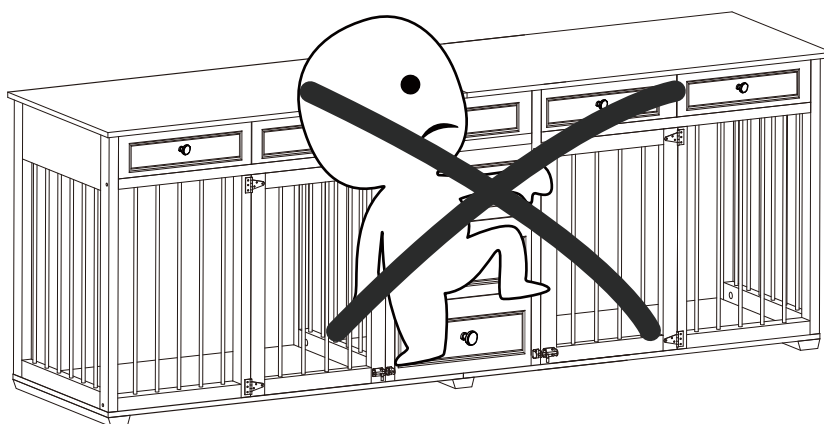
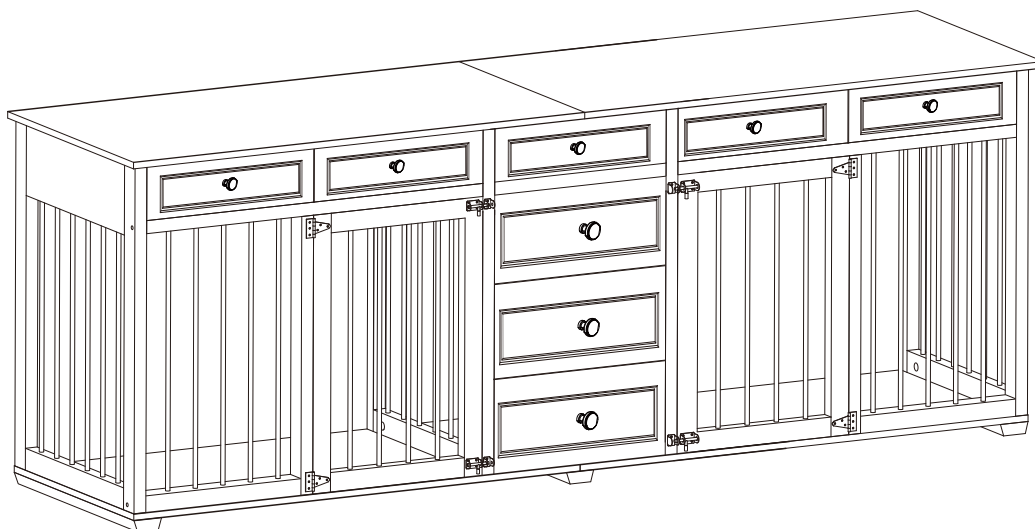

Serious or fatal crushing injuries can occur from furniture tip-over.
To further reduce the risk of serious injury and death from tip-overs:

Schwere oder tödliche Quetschverletzungen können durch Umkippen von
Möbeln auftreten.
Um das Risiko schwerer Verletzungen und Todesfälle durch Umkippungen
weiter zu reduzieren.

WARRANTY

WARRANTY CLAIMS

- There is a 30-day warranty for broken furniture or any other problems that do not work properly. The warranty will start from the date of purchase which must be verified by proof of purchase.
- Before making a claim, we may be able to answer your query, simply call us. Please leave your purchase order number, along with some details of the problem, if you want a replacement part. We will arrange within 48 hours. If there is out of stock, we will reply with a shipping date.
- The product must be used in accordance with the instructions provided. For health reasons.
- For other reasons, if the furniture needs to be returned, it must be cleaned and dried and operated within 30 days of receipt.

Type of Warranty Claim

- Failure to follow the furniture instructions will invalidate the warranty. Attention please.
- Does not include damage during installation, but includes damage during transportation.

Scope of responsibility

- Shall not bear any responsibility for misuse or user damage and / or loss of parts during the installation of furniture.
- After using, the damage and scratches of the furniture are not covered by the warranty.

The Warranty Relates to All Bought in The Us and Covers The Following Areas

- Sheet parts: 1 month from the date of purchase.
- Electrical parts: 1 month from the date of purchase.

RETURNS

CHANGED YOUR MIND AND NEED TO RETURN YOUR ITEM?

PLEASE FOLLOW THE BELOW INSTRUCTIONS:

- If you have purchased and have simply changed your mind, follow the retailer's instructions for returns.

DEFECTIVE ITEMS

- If your item is defective in any way, i.e. it doesn't work but you can't identify why, in the first instance, please call us.

DAMAGED ITEMS

- If you receive an order with obvious shipping damage from the retailer, then we suggest the delivery is refused. If the delivery has been accepted and then shipping damage is found, please follow the specific instructions advised by the retailer.
In all circumstances please save all packaging material and paperwork for the order. Please be aware that if you dispose of packaging material or attempt to return the merchandise without contacting the fulfiller, you jeopardise your chances of making a claim, and you may not receive a credit for the return.