

JOHN LOUIS HOME

Solid Wood Home Storage Solutions



Installation Instructions

12in. & 16in. Deep Closet Organizer

JLH-528, 529, 528W, 587CH, 588, 525, 525W, 526, 585CH, 586

PARTS LIST:



Quantity: 1 72 in. Shelf

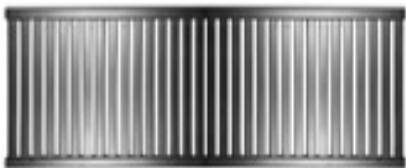

Quantity: 2 48 in. Shelf



Quantity: 2 24 in. Adjustable Shelf



Quantity: 1 24 in. Tower Bottom Cam Shelf with Nameplate



Quantity: 2 72 in. Tower Side

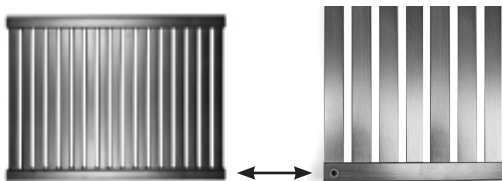

Quantity: 1 26.25 in. Tower Top Shelf



Quantity: 1 72 in. Garment Bar



Quantity: 2 48 in. Garment Bar



Quantity: 6
J-Hook



Quantity: 6
Tower Bracket



Quantity: 7
Shelf End



Quantity: 14
Shelf mounting L- Clip



Quantity: 6
Bar End



Quantity: 6
Angle Bracket Mushroom
Cap



Quantity: 6 Angle Bracket



Quantity: 16
Adjustable Shelf Pin



Quantity: 4
Tower Mushroom Cap



Quantity: 56 Wall Anchor



Quantity: 64 #8 1 1/2 in.



Quantity: 6 #8 3 in.

PARTS LIST CONTINUED:



Quantity: 12
#8 1 in. (J-Hook)



Quantity: 14
#8 3/4 in.



Quantity: 4
#8 1/2 in.



Quantity: 24
#4 3/4 in.



Quantity: 8 #6 1 1/4 Self Tapping Screw



Quantity: 2
#8 1 in. (Flat)



Quantity: 4
Cam Bolt



Quantity: 4
Cam Lock Nut



Quantity: 1
Touch Up Stain Pen



Quantity: 4
Barrel Bolt



Quantity: 4
Barrel Nut



Quantity: 1
Allen wrench

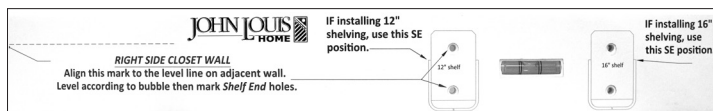

Quantity: 1
Shelf End Template



Quantity: 1
Tower Stabilizer Bar

REQUIRED TOOLS FOR INSTALLATION:

The following tools will be needed to assemble and install your John Louis Home Solid Wood Closet Organizer:

- Pencil
- Tape Measure
- Level
- Stud Finder
- Phillips Screwdriver
- Powered Drill with Phillips Bit
- 1/8 in. Drill Bit
- 1/4 in. Drill Bit
- Saw*

*John Louis Home recommends using a powered table saw or chop saw with a fine tooth blade to cut the wood shelving down to your required measurements. To cut the metal garment bars, a hack saw or reciprocating saw with a fine tooth blade can be used.

CONTACT US:

For questions concerning missing or damaged parts, technical specs and / or assembly help, please contact John Louis Home Customer Service at:

Email: service@johnlouishome.com

Web: www.johnlouishome.com

Phone: 1.800.480.6985 (Mon-Fri, 8am-4pm, Central)

JOHN LOUIS HOME

Solid Wood Home Storage Solutions

IMPORTANT! - Read Through Instructions Before Assembly

Both the 12 in. deep and 16 in. deep Organizer use the same assembly instruction process **EXCEPT DURING THE J-HOOK PLACEMENT ON THE ANGLE BRACKET**.

Assembly instructions are written for 8 ft. configuration A. All assembly processes are the same for each configuration **EXCEPT** for the order or locations of the assembly process. Use selected configuration for shelf locations.

This Closet Organizer is a CUT-TO-FIT installation.

Shelf lengths and Garment bars may need to be cut depending upon configuration desired.

All cut shelf lengths are used in closet configurations supplied. Depending upon your closet dimensions, some cut lengths may not be usable.

EXAMPLE: If you choose an 8 ft. closet configuration and the width of your closet is 8 ft. 4 in., the cut shelf length will be short 4 in. for use. It is recommended that if your closet is over the selected dimension (8 ft.), then choose a configuration from the next dimension higher (10 ft.).

EXAMPLE: If you choose an 8 ft. closet configuration and the width of your closet is 7 ft. 6 in., some shelf lengths may need to be cut 6 in. shorter in length to fit closet dimensions.

This Organizer provides 2 pre-cut 24 in. wide adjustable shelves for use within the storage tower. Up to 2 additional adjustable shelves can be created depending on the configuration you choose. See Step 8 for details. -Please note that a 12 ft. configuration in which no cuts are made leaves no excess material for additional shelves.-

Chosen configuration may not require use of all hardware or components supplied. It is recommended to secure hardware into wall studs for overall strength and stability of closet system.

If choosing a custom designed configuration, modifications to the instructions provided will be necessary. All configurations provided may be reversed.

STEP 1: Determine Your Dimensions

1. Locate your desired configuration (**Instructions are written for 8 ft. configuration A**).
2. Double hang is created with 2 - 4 ft. shelf length.
3. Long hang is created by cutting a 6 ft. shelf to 21.75 in. wide. (**If your closet is greater or less than 8 ft. wide you will cut your shelf greater or less that distance.**)

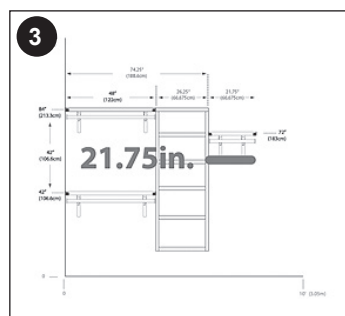
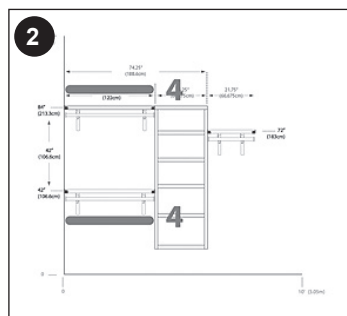

STEP 2: Marking Measurements On Wall

1. Locate the 3 main shelf height locations for your configuration.
2. Measure up from the floor & mark the 84 in. location.
3. Measure up from the floor & mark the 42 in. location.
4. Measure up from the floor & mark the 72 in. location.

84 in. - top shelf

42 in. - lower hang shelf

72 in. - long hang shelf

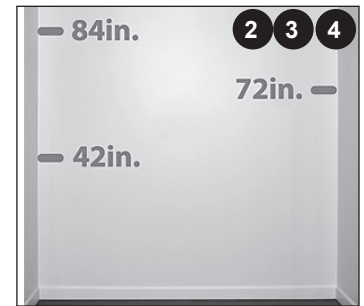
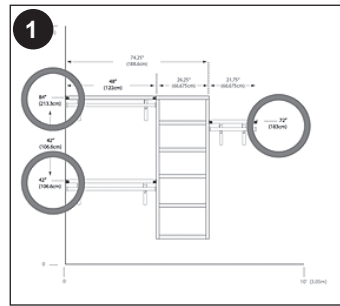

5. Draw a 6 ft. long level line out from wall end at 84 in. location.
6. Draw a 4 ft. long level line out from wall end at 42 in. location.
7. Draw a 22 in. long level line out from wall end at 72 in. location.
8. Locate stud locations at level lines.

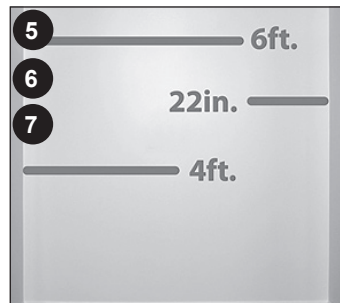

VERIFY SHELF MEASUREMENTS MEASURE - MARK - MEASURE AGAIN

STEP 3: Tower Assembly

1. Place tower sides down with grooves facing up.
2. Insert cam bolts at tower bottom hole locations (Do not over tighten).
3. Insert tower sides into tower bottom (24in. shelf with nameplate).
4. Insert cam nuts into tower bottom shelf with arrow facing bolt hole.
5. Secure by turning cam nuts clockwise to tighten.
6. Repeat for opposite tower side.

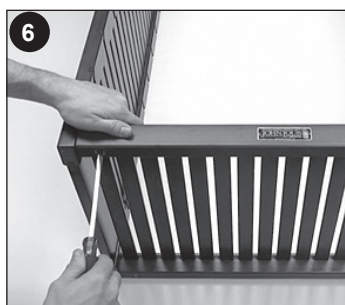
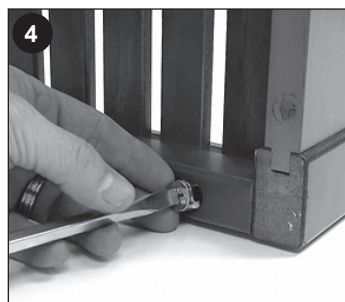
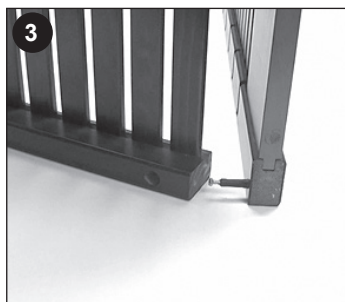
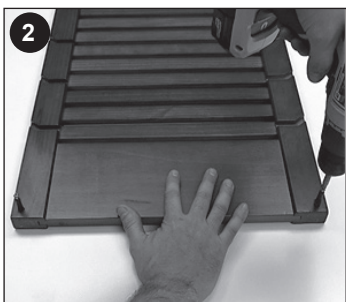
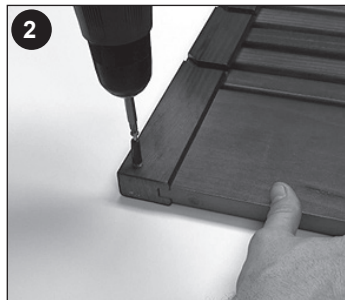

7. Place tower top (26.25 in. shelf) into notches at top of tower.
8. Insert barrel nuts into tower sides with slot in a vertical position.
9. Insert barrel bolts into tower top.
10. Flush tower top with tower side & tighten with allen wrench provided (nut position may need adjustment).



11. Place tower face down (nameplate typically designates tower front).
12. Place top tower bracket between 1st & 2nd groove.
13. Place middle tower bracket between 8th & 9th groove.
14. Place bottom tower bracket between last groove & tower bottom.
15. Repeat for opposite side.
16. Secure top and bottom brackets to tower using #8 3/4 in. screws.

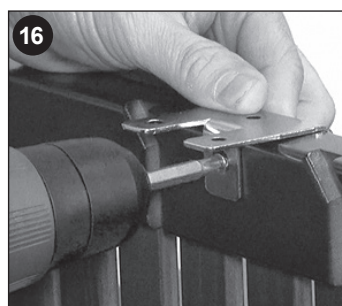
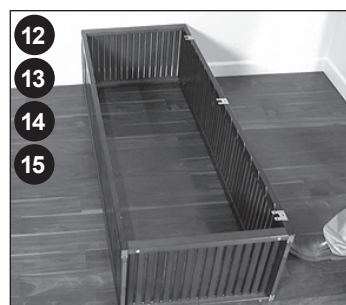

Note: The purpose of the Tower Stabilizer Bar is to hold the tower sides parallel prior to securing against back wall. It is installed in conjunction with the 2 middle tower brackets.

17. Align the Tower Stabilizer Bar with the middle pair of tower brackets.
18. With Tower Stabilizer ends properly nested between the pair of tower brackets, secure using #8 - 1in. screws.
19. The Tower Stabilizer provides proper distance alignment during installation. It can be left in permanently or removed after installation is completed. If removed, replace the #8 - 1in. screws with remaining #8 - 3/4in. screws.

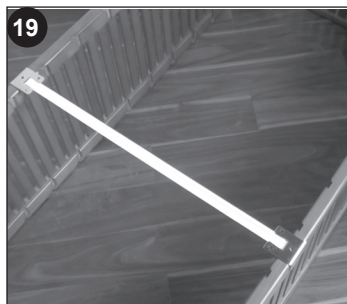
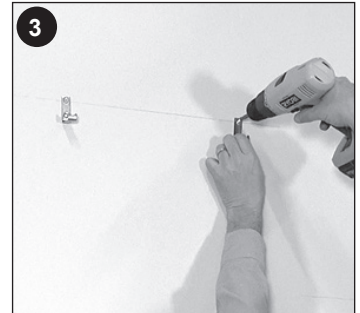
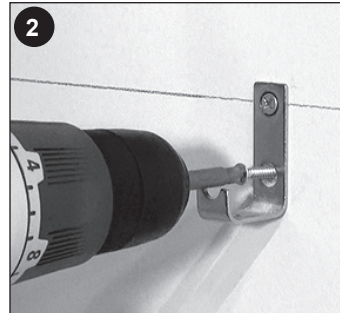
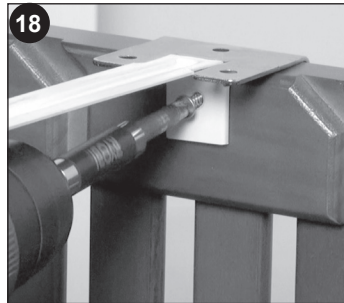
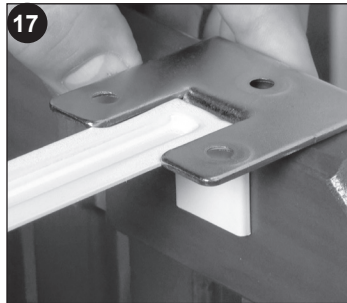
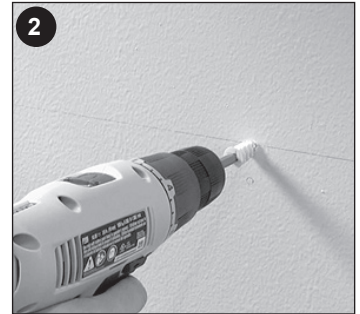
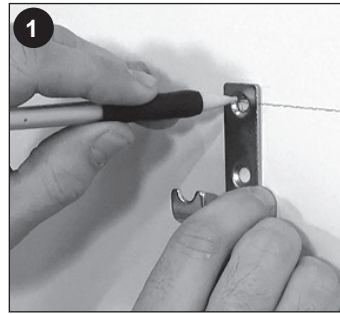

IMPORTANT!

DO NOT use Tower Stabilizer as a means for lifting or positioning the Tower into place!

4. Position shelf end template onto side wall.
5. Align template line with adjacent wall line.
6. Level template.
7. Mark required shelf end position for required depth (12in. or 16in. depth).
8. Secure shelf end using #8 - 1 1/2in. screws (use wall anchor if no stud is present).

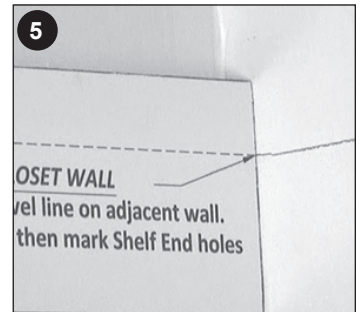

STEP 4: Installing Top Shelf & Tower

It is recommended to install hardware into wall studs. Typically 16 in. on center. Use 50 lb. wall anchors provided if no stud is present.

On the top level line space shelf mounting L-clip hardware equidistant in the following manner:

- 3 L-clip hardware within the 48in. shelf location
- 2 L-clip hardware within the tower top location

Shelf End hardware provides front support to the shelf by securing it to a side wall or tower and should only be installed on the front ends of the shelf.

NOTE: AT LEAST 1 L-CLIP HARDWARE MUST BE INSTALLED INTO A WALL STUD AT TOWER TOP LOCATION

1. Center the top screw hole of the shelf mounting L-clip hardware with the level line & mark all hole locations.
2. Secure L-clip to wall using #8 1 1/2 in. screws at hole locations (Use wall anchors provided if no stud is present).
3. Repeat for remaining L-clip locations.

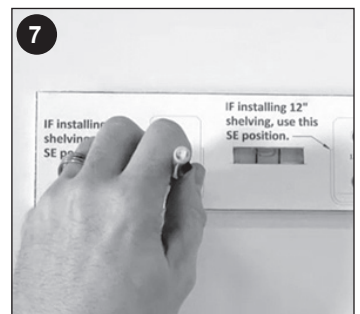
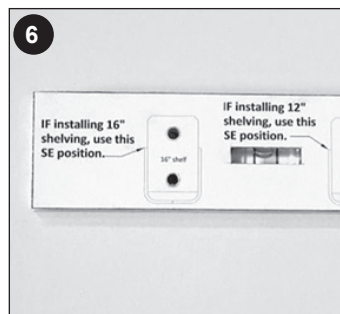

9. Place shelf onto hardware.
10. Place tower onto hardware.
11. Place a shelf end onto the shelf at tower end.
12. Flush tower with top shelf by moving tower left or right.
13. Level shelf front to back & mark shelf end hardware location on tower.

19. Install wall anchors at tower bracket locations if no stud is present.
20. Place tower onto wall and align with hole locations.
21. Place shelf onto wall hardware.
22. Secure tower to wall using #8 1 1/2 in. screws at all bracket locations.
23. Secure shelf to hardware using #4 3/4 in. screws at all hardware locations.

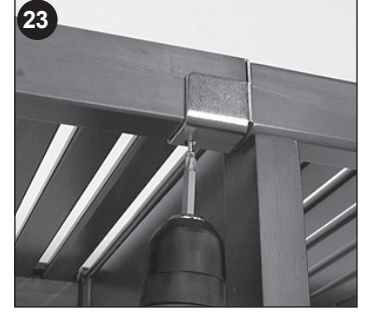
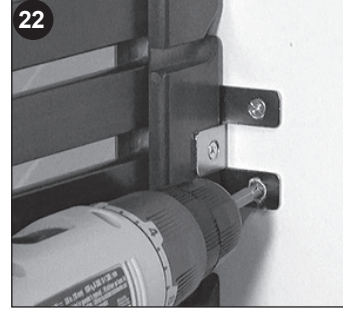
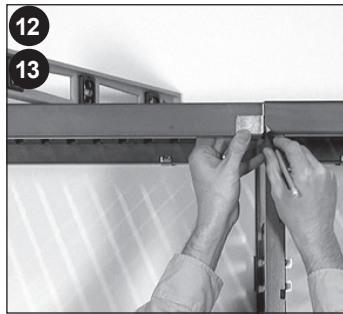
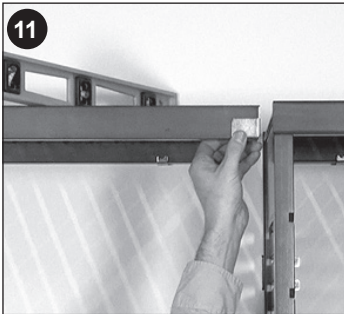
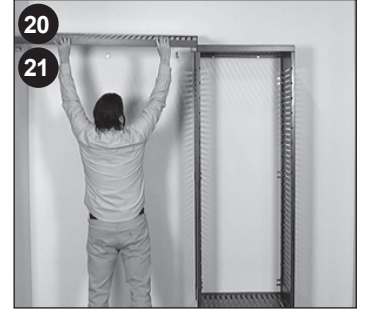
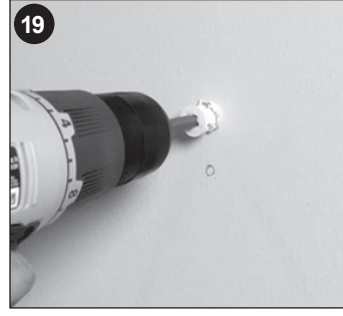
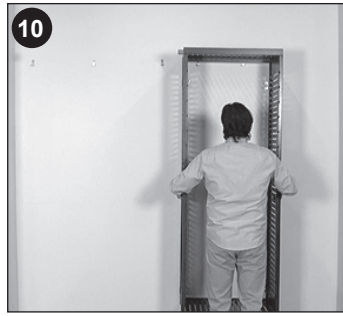
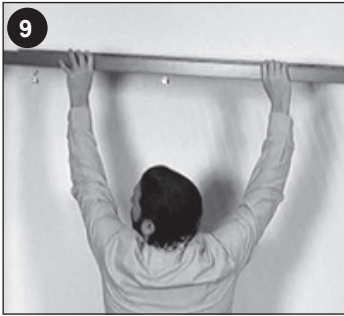

14. Plumb level tower side.
15. Mark tower bracket hole locations on wall.
16. Remove shelf and tower.
17. Align shelf end hardware with the mark on the tower & mark screw hole locations.
18. Secure shelf end to tower top using #8 1/2 in. screws at hole location.
NOTE: If shelf is mounted level with the tower top, the shelf end hardware should be "centered" on the end of the front rail of the tower top.

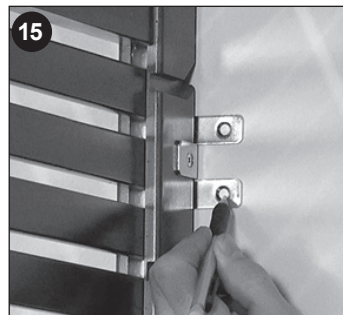
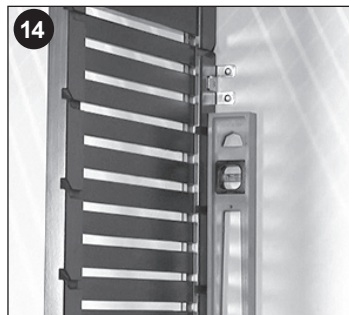
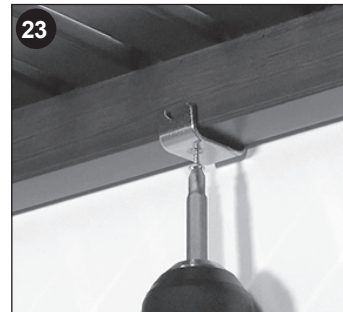

STEP 5: Installing Secondary Shelves

1. Lower hang shelf is created using a 4 ft. shelf at the 42 in. mark.

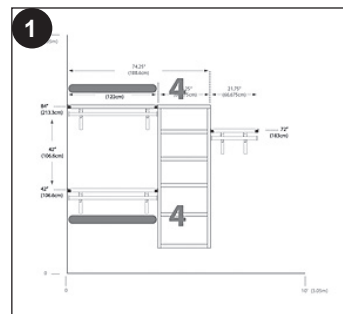

2. Mark L-clip hardware locations for secondary shelves.
 - It is recommended to install hardware into wall studs. Typically 16 in. on center. Use 50 lb. wall anchors provided if no stud is present.
 - Space L-clip hardware equidistant in the following manner:
 - 4-5 L-clip hardware per 6 ft. shelf span
 - 3-4 L-clip hardware per 4 ft. shelf span
 - 2 L-clip hardware per 2 ft. shelf span
3. Center the top screw hole of the shelf mounting L-clip hardware with the level line & mark all hole locations.
4. Secure L-clip to wall using #8 1 1/2 in. screws at hole locations (Use wall anchors provided if no stud is present).
5. Repeat for all L-clips at shelf height location.

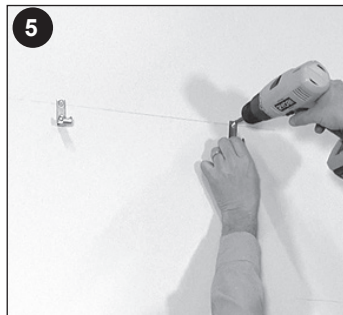
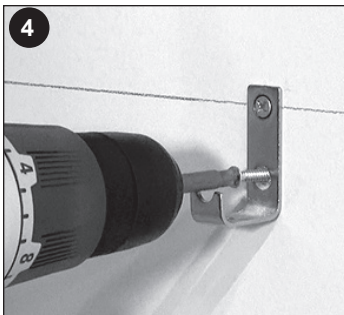
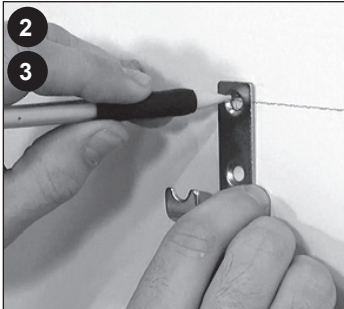

6. Position shelf end template onto side wall.
7. Align template line with adjacent wall line.
8. Level template.
9. Mark required shelf end position for required depth (12in. or 16in. depth).
10. Secure shelf end using #8 - 1 1/2in. screws (use wall anchor if no stud is present).

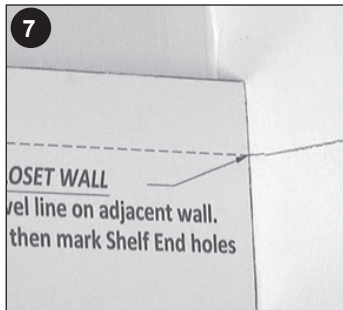

11. Position shelf end template onto tower side and align with adjacent wall line.
12. Level template.
13. Mark required shelf end position for required depth (12in. or 16in. depth).
14. Secure shelf end using #8 - 3/4in. screws.



15. Double check required shelf measurement. Cut shelf if necessary.
16. Place shelf into shelf end hardware & onto L-clip hardware.
17. Secure shelf to hardware using #4 3/4 in. screws at all hardware locations.

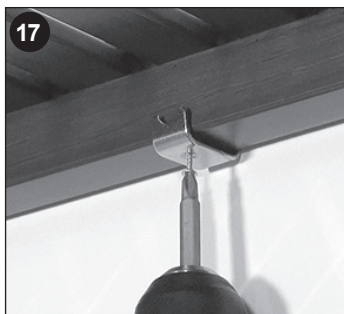

STEP 6: Installing Angle Brackets

NOTE - When installing J-hooks to the angle brackets it is highly recommended to pre-pilot the screw hole locations with a 1/8 in. drill bit prior to securing the J-hook to the angle bracket.

12 in. Angle Bracket J-Hook Installation

1. Place J-hook snug with underside of bracket & align the front edge of the J-hook flush with the front of the angle bracket.
2. Secure using #8 1 in. screws.
3. Repeat for each angle bracket & J-hook.

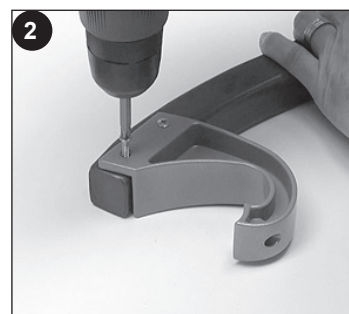
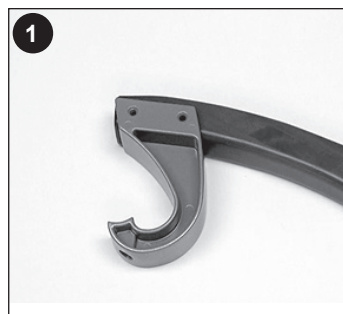

16 in. Angle Bracket J-Hook Installation

1. Measure 3 in. back from front of angle bracket & mark location
2. Place J-hook snug with underside of bracket & align the front edge of the J-hook with the mark.
3. Secure using #8 1 in. screws.
4. Repeat for each angle bracket & J-hook.

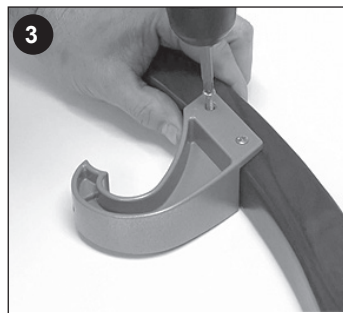

18. Long hang shelf is created by cutting a 6 ft. shelf to 21.75 in. wide and mounted at the 72 in. mark. (If your closet is greater or less than 8 ft. wide you will cut your shelf greater or less that distance.)

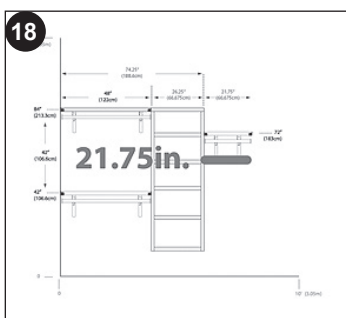

19. Repeat hardware mounting steps 2 - 16 for long hang shelf.
20. Double check required shelf measurement. Cut Shelf to required width.
21. Place shelf into shelf end hardware & onto L-clip hardware.



22. Secure shelf to hardware using #4 3/4 in. screws at all hardware locations.



5. Insert #8 3 in. screw into angle bracket.
6. Position angle bracket 6 in. or 4 slats in from shelf end (bracket may be positioned in your desired location).
7. Ensure bracket is square with shelf underside & back wall.
8. If no stud is present, mark hole location by driving screw into drywall.
9. Install anchor if no stud is present.
10. Secure angle bracket using #8 3 in. screw.

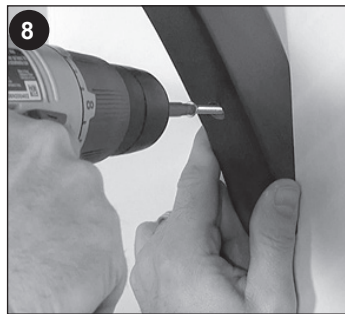

11. Repeat for 2nd angle bracket.
12. Repeat for all shelf locations.

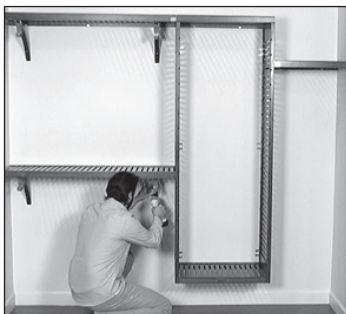

STEP 7: Installing Garment Bars

1. Locate the bar dimensions in your configuration guide.
2. The double hang garment bars are created by using 2 - 4ft. bars.
3. The long hang garment bar is created by cutting the 6ft. bar to 21 in. wide (The required distance may vary based on actual closet dimensions)

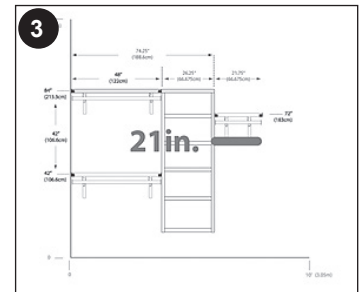
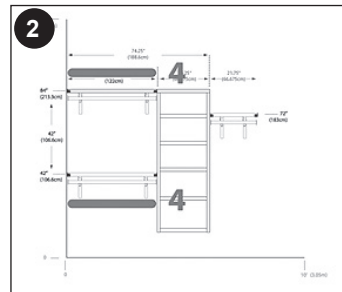

4. **DOUBLE CHECK MEASUREMENTS PRIOR TO CUTTING BARS**
5. Measure required dimension, mark & cut bar (if necessary).
6. Repeat for all bars.



7. Insert bar end into end of garment bar.
8. Turn clockwise to tighten & repeat for each bar end.

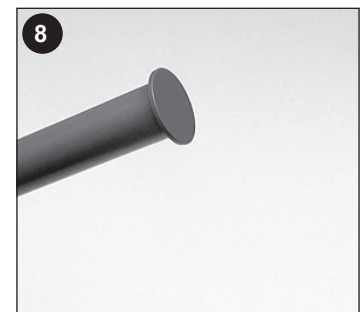
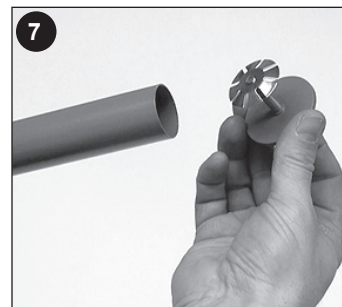

9. Place garment bar onto J-hooks.
10. Secure garment bar to J-hooks using #6 1 1/4 in. self tapping screws.
11. Repeat for all garment bar locations.



5. Create a shoe shelf by inserting the shelf upside down with the back one groove higher than the front.

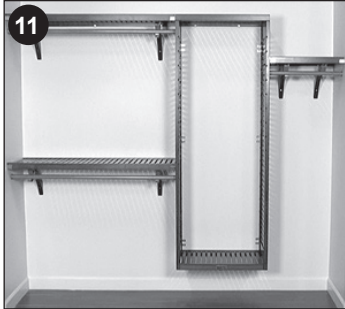

Creating Adjustable Shelves

Put your excess cuts back into your closet. Any material greater than 24 in. wide can be used as an additional shelf.

Cut excess lengths to 24 in. wide to use as adjustable tower shelves & place wherever you choose.

In an 8 ft. closet configuration your 4 ft. of excess shelving can create 2 additional adjustable shelves.

STEP 8: Installing Adjustable Shelves

1. Select a 24 in. adjustable shelf.
2. Insert shelf pin into shelf at hole location.
3. Repeat at each hole location.

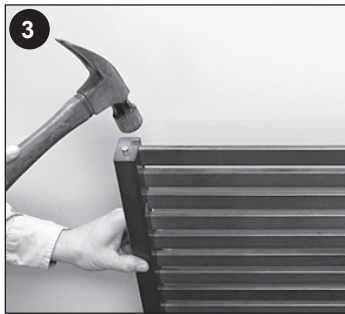
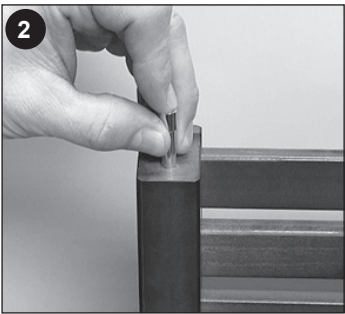

4. Place the shelf into the tower by inserting the pins into the tower grooves.



1. Measure required dimension, mark & cut shelf (if necessary).
2. Place shelf end bracket onto shelf.

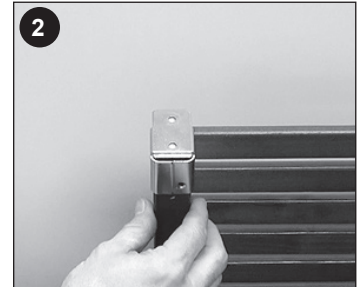
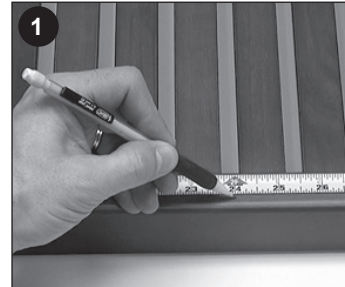

3. Using the lower hole location on the bracket, drill a pilot hole using a 1/8 in. drill bit.
4. Remove the shelf end bracket.

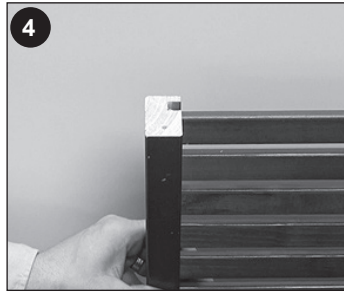
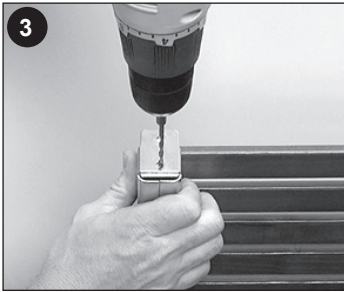

5. Re-drill hole 1 - 1 1/4 in. deep using a 1/4 in. drill bit.
6. Repeat steps for each shelf end.
7. Insert shelf pin into holes at each end.

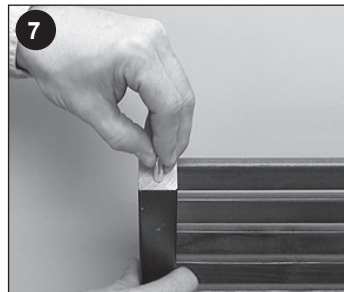
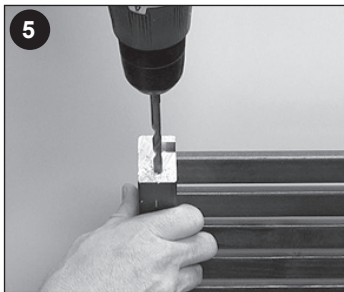

JOHN LOUIS HOME

Solid Wood Home Storage Solutions

STEP 9: Final Touches

1. Insert mushroom caps into all angle brackets.
2. Insert mushroom caps into barrel nut holes on tower sides.

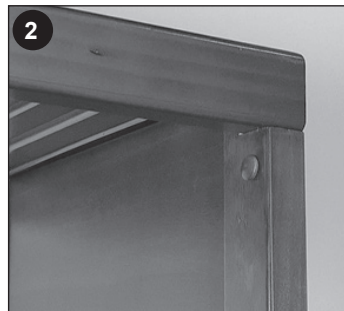

3. Touch up scratches & cut ends with stain pen provided.

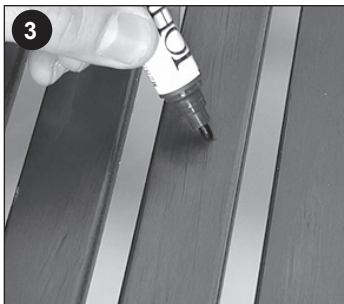

For additional product information including step-by-step Installation Videos, Frequently Asked Questions, Storage Tips and more, please visit: johnlouishome.com/resources

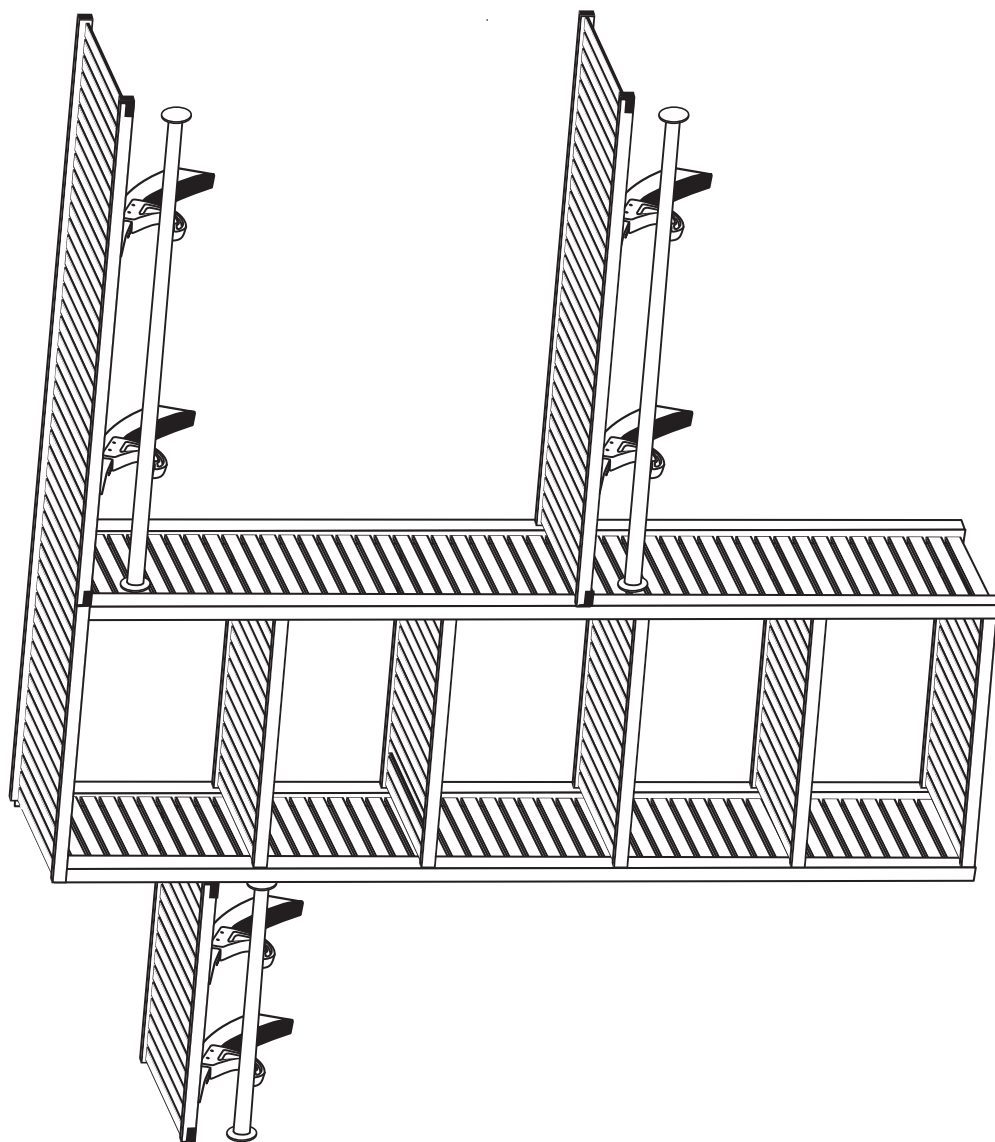

8' CONFIGURATION A A CONFIGURACIÓN DE 2.5 M A CONFIGURATION DE 2.44 M

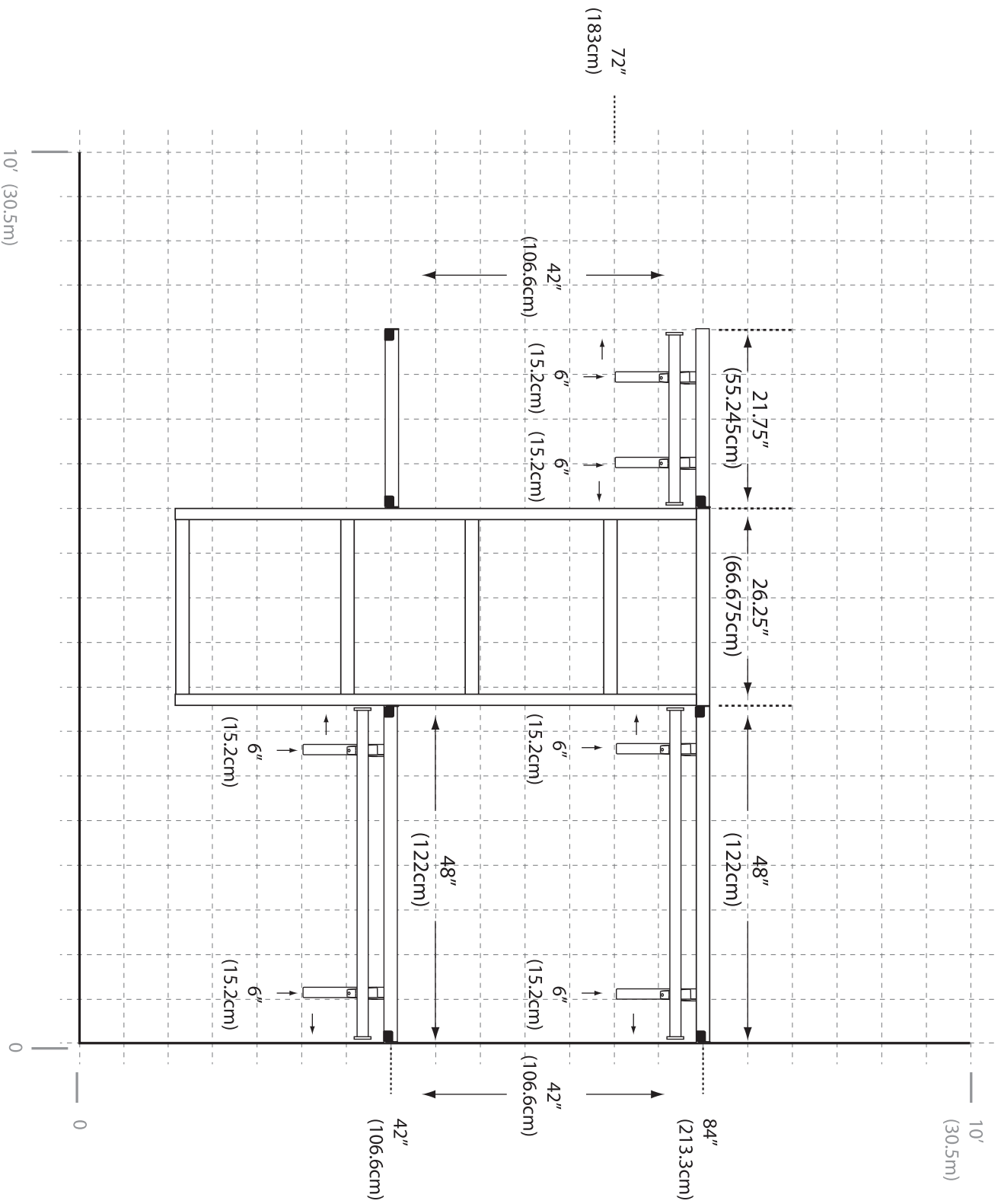

8' CONFIGURATION B

B CONFIGURACIÓN DE 2.5 M

B CONFIGURATION DE 2.44 M

6" = 6" (15.2cm)

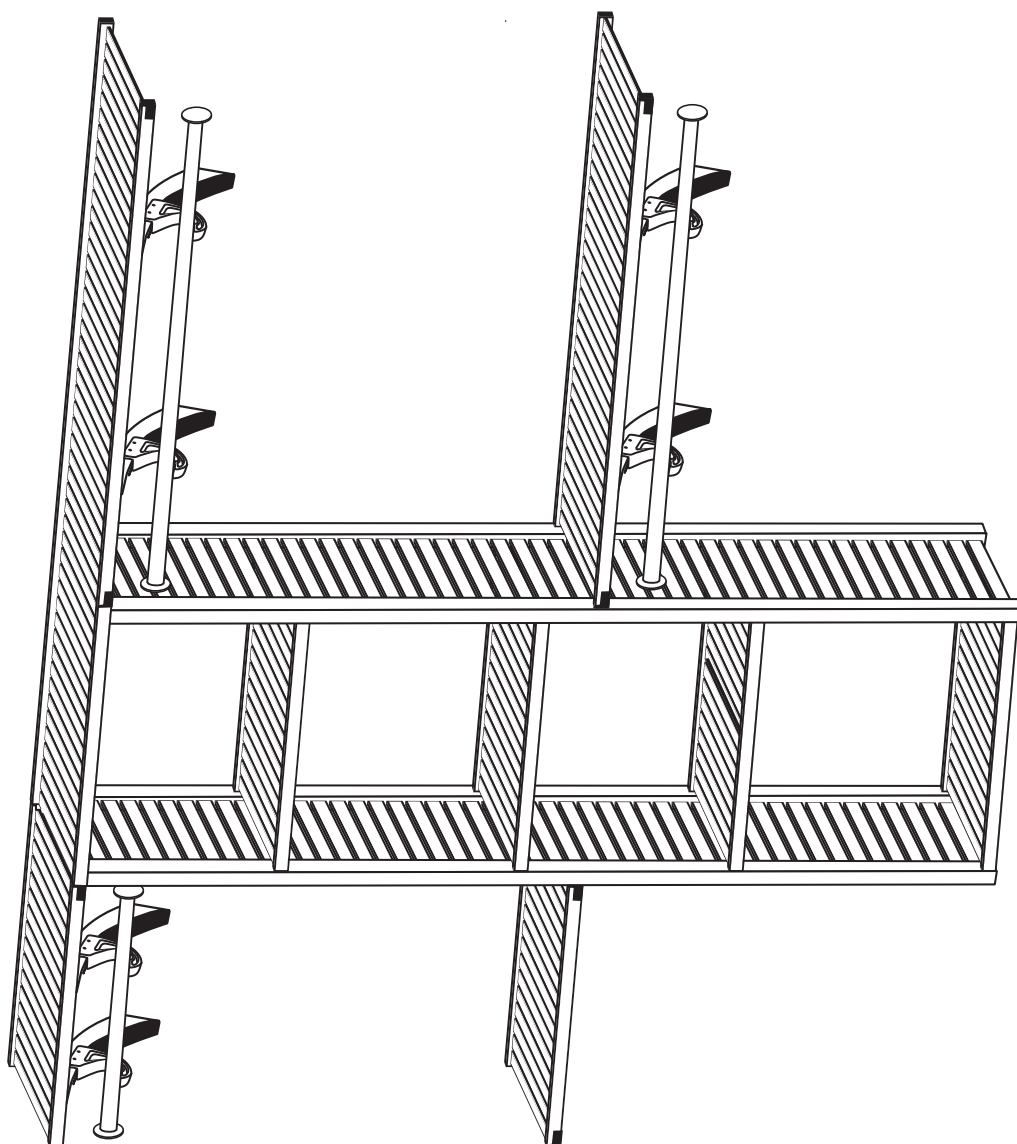

8' CONFIGURATION B B CONFIGURACIÓN DE 2.5 M B CONFIGURATION DE 2.44 M



C CONFIGURATION DE 2.44 M

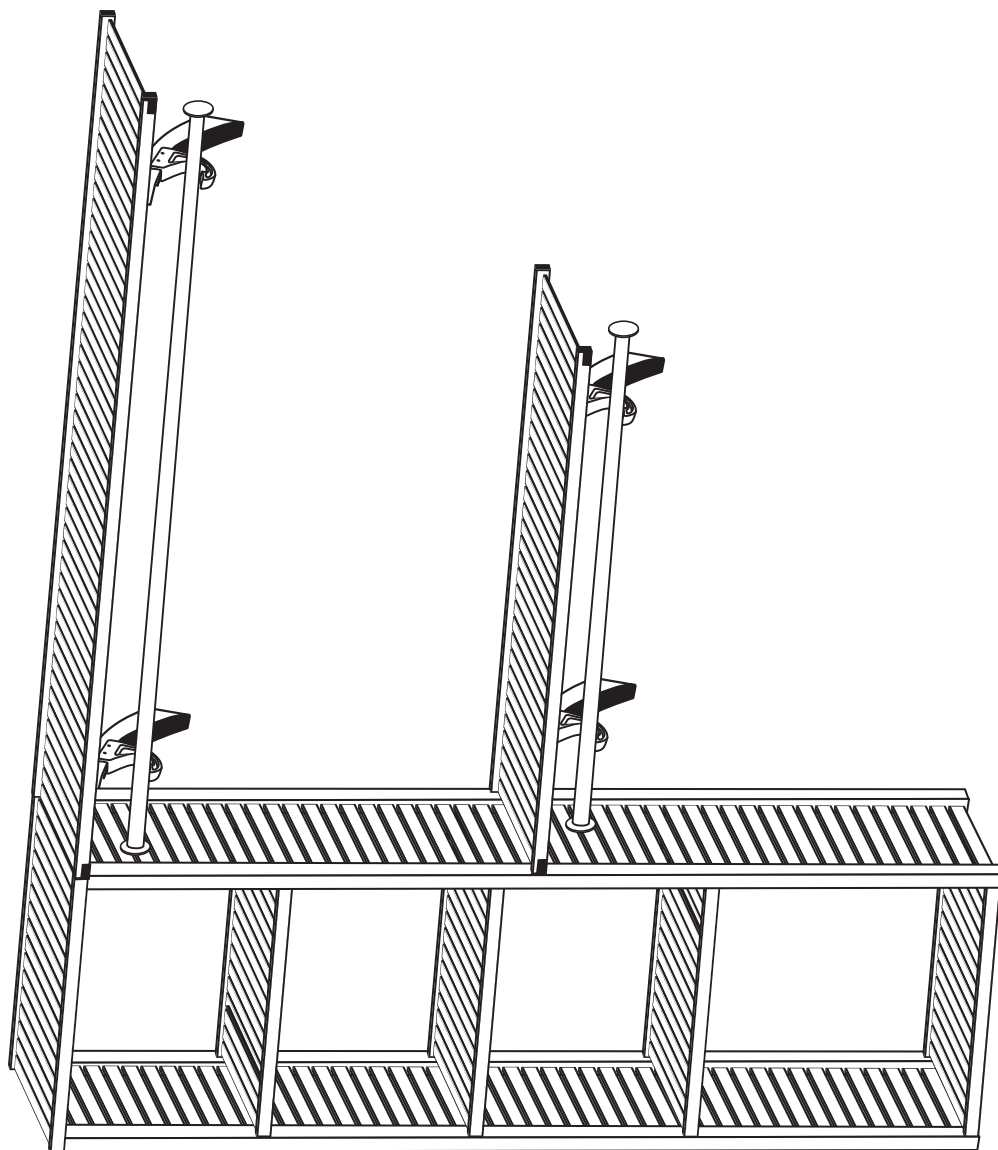

8' CONFIGURATION C C CONFIGURACIÓN DE 2.5 M C CONFIGURATION DE 2.44 M

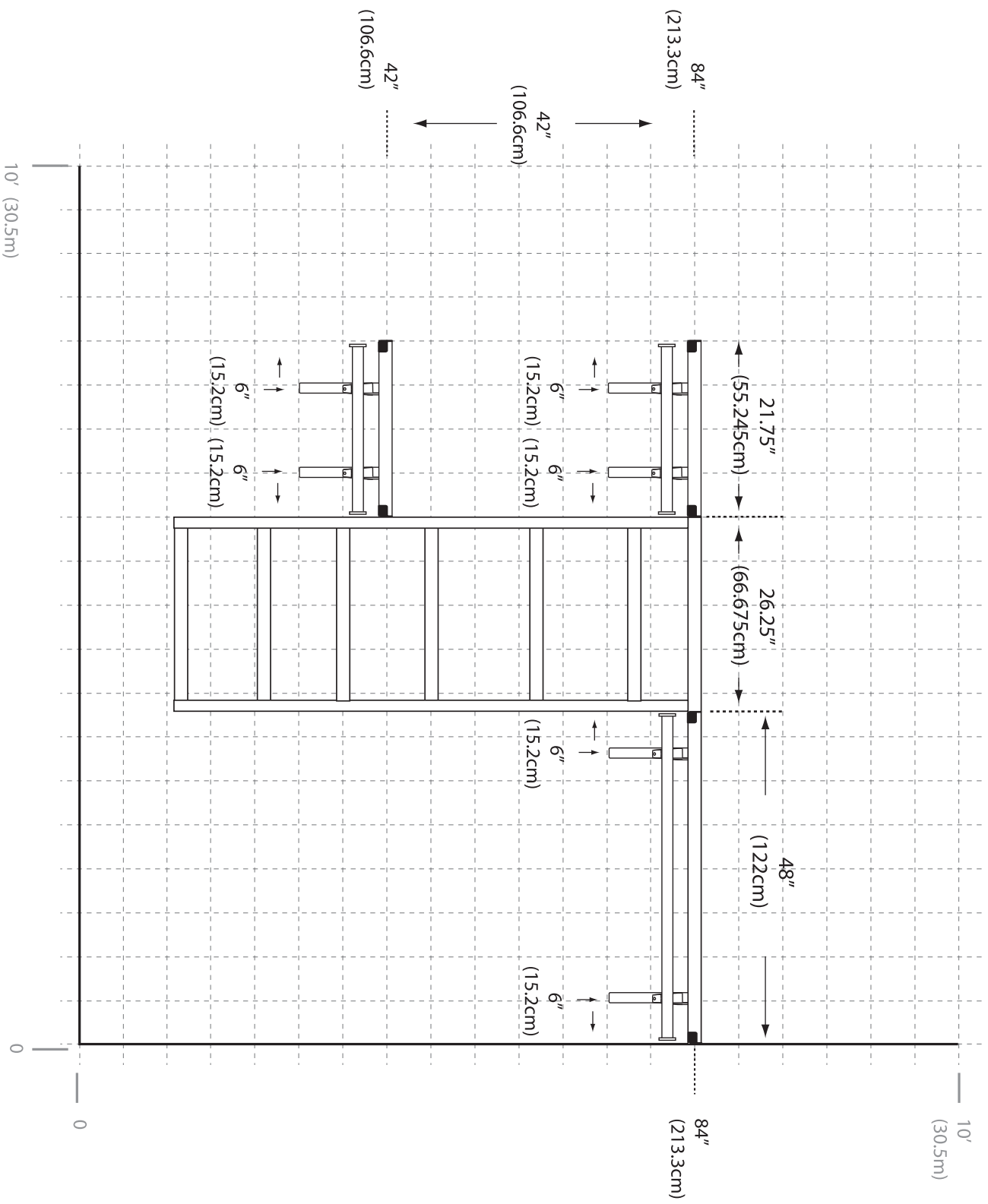

8' CONFIGURATION D

D CONFIGURACIÓN DE 2.5 M

D CONFIGURATION DE 2.44 M

6" = 15.2cm

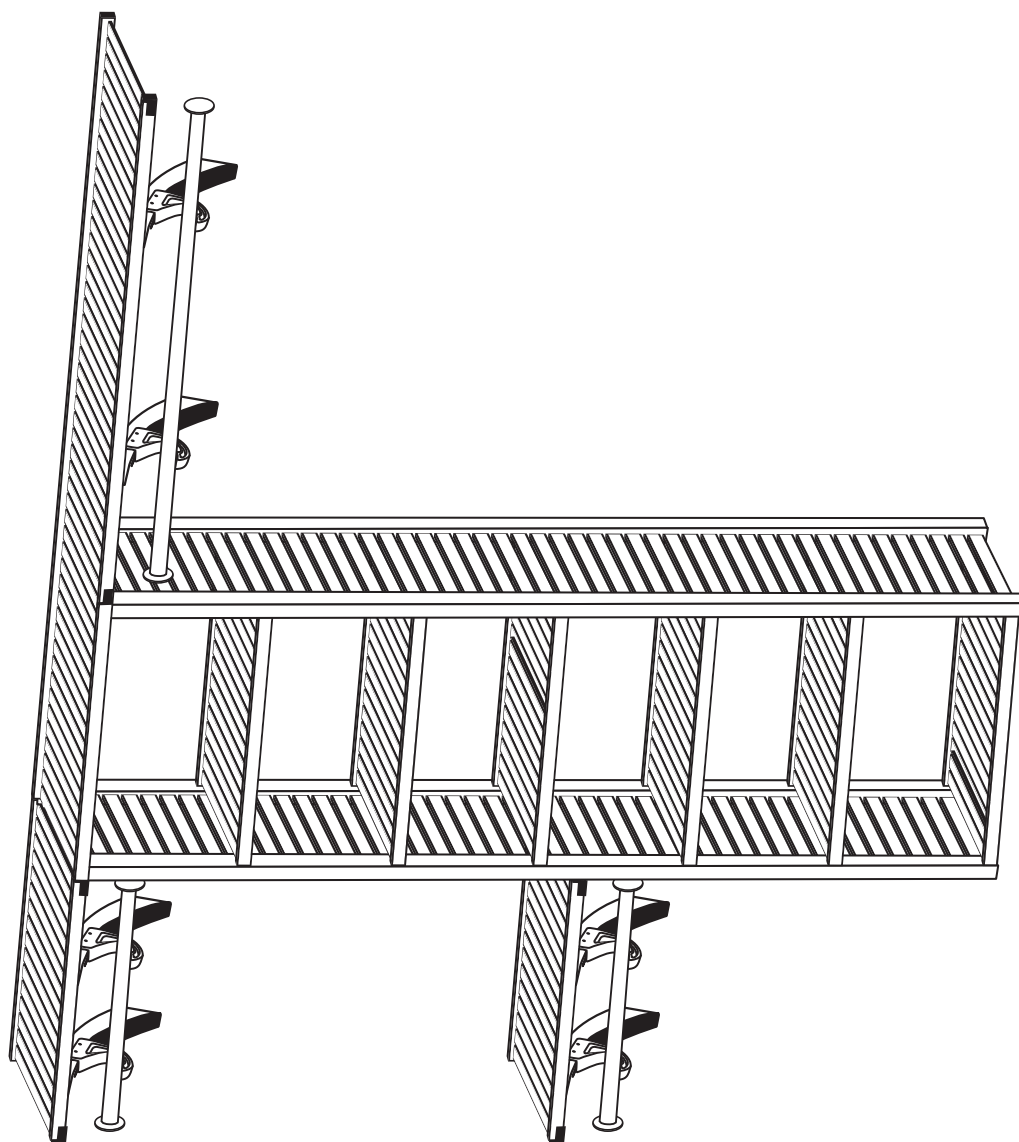

8' CONFIGURATION D D CONFIGURACIÓN DE 2.5 M D CONFIGURATION DE 2.44 M

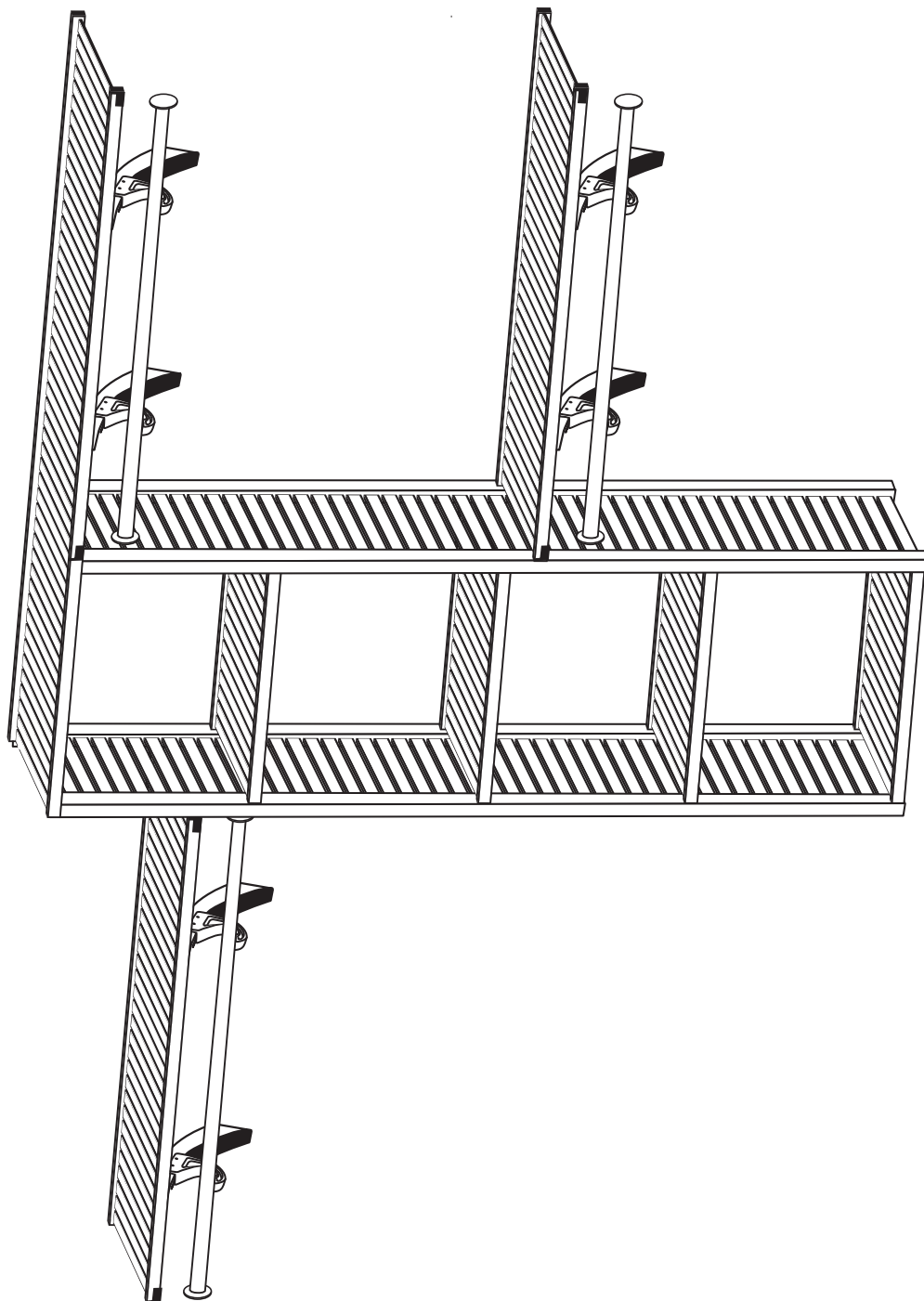

10' CONFIGURATION A A CONFIGURACIÓN DE 3.05 M A CONFIGURATION DE 3 M

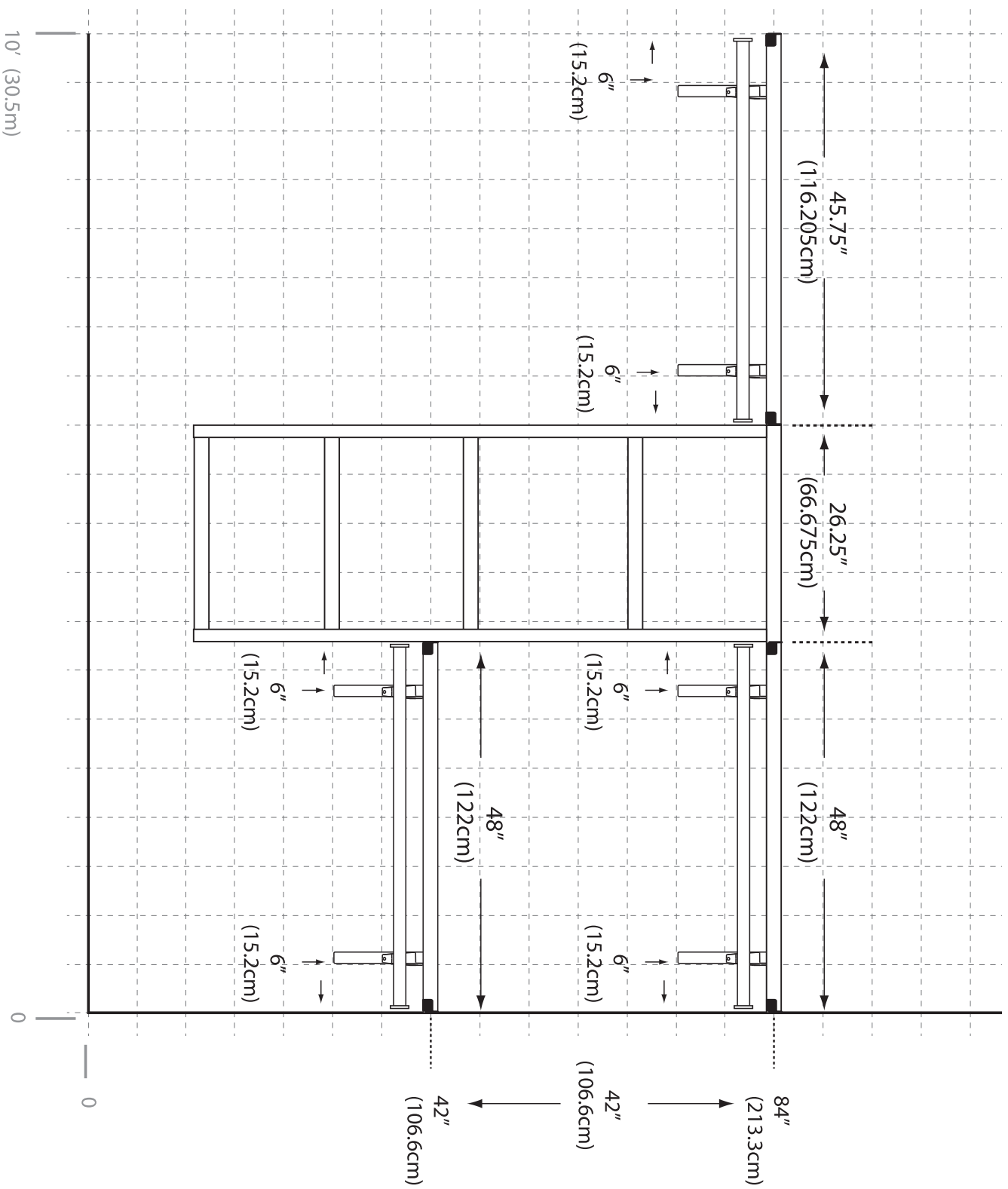

10' CONFIGURATION B

B CONFIGURACIÓN DE 3.05 M

B CONFIGURATION DE 3 M

6" = 15.2cm

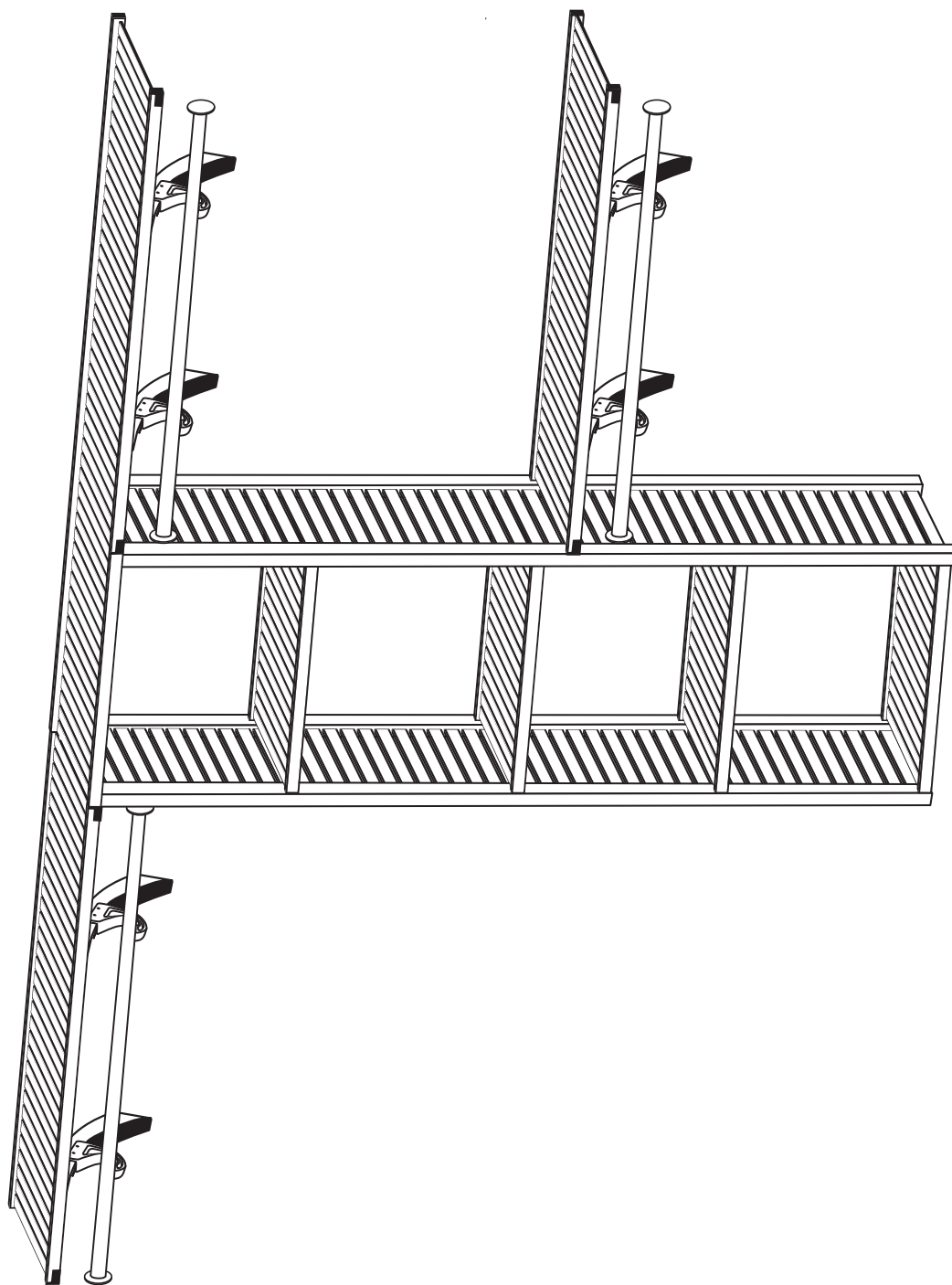

10' CONFIGURATION B B CONFIGURACIÓN DE 3.05 M B CONFIGURATION DE 3 M

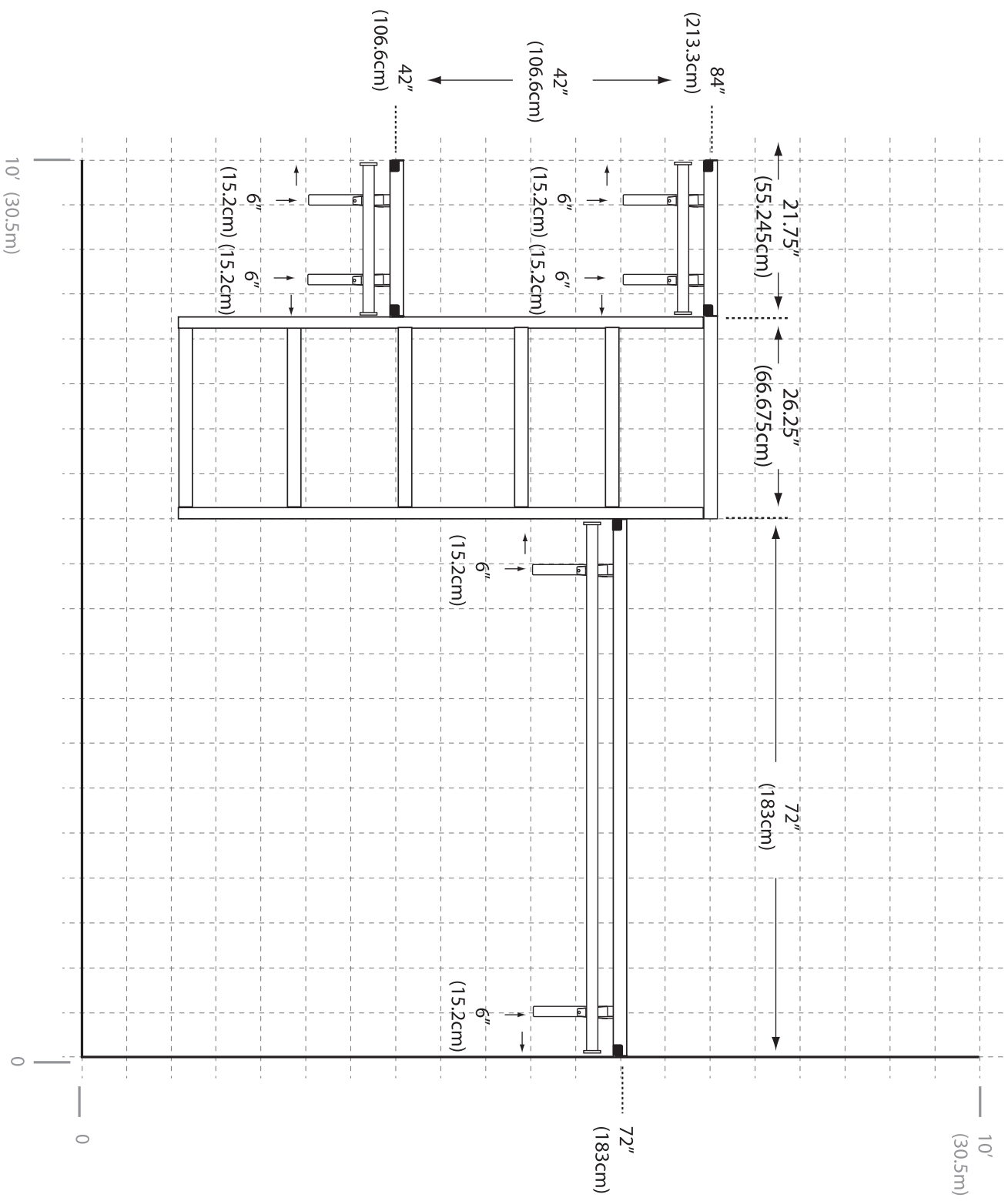

10' CONFIGURATION C

C CONFIGURACIÓN DE 3.05 M

C CONFIGURATION DE 3 M

6" = 15.2cm

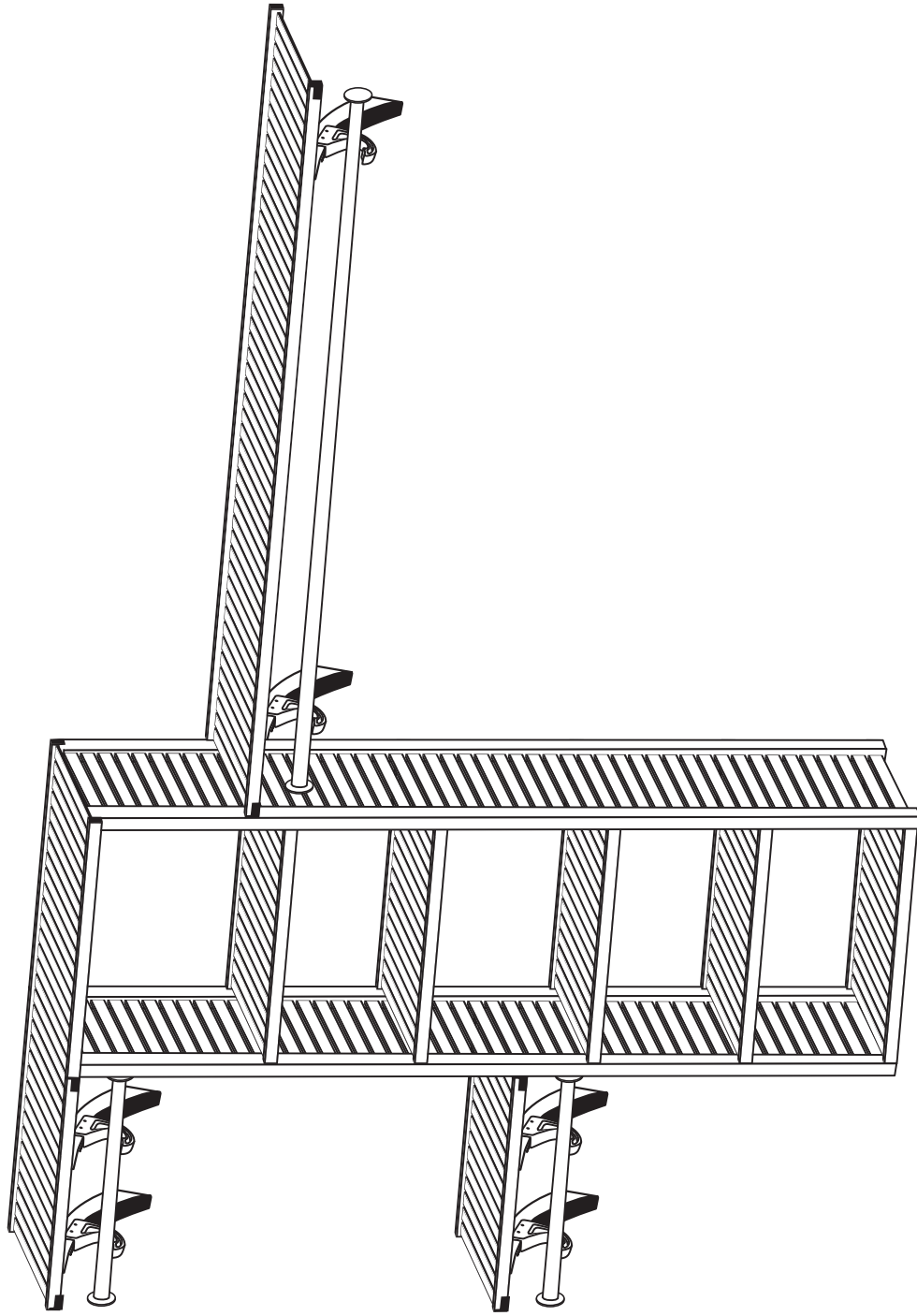

10' CONFIGURATION C C CONFIGURACIÓN DE 3.05 M C CONFIGURATION DE 3 M

JOHN LOUIS HOME

Solid Wood Home Storage Solutions



Installation Instructions

12in. & 16in. - 6, 8 & 10in. Deep Drawer

JLH-536, 536W, 536WC, 537, 537W, 537WC, 538, 538WC, 539, 539WC,
555CH, 556, 557CH, 558, 559CH, 560CH, 561, 562, 804W, 805, 805WC, 806,
806WC, 807, 807WC, 808, 809W, 850, 855

PARTS LIST:



Quantity: 1
Drawer face



Quantity: 1
Drawer back



Quantity: 1
Drawer left side



Quantity: 8
Quantity: 10 for 10in. Drawer
CAM Bolt



Quantity: 8
Quantity: 10 for 10in. Drawer
CAM nut



Quantity: 8
#6 1/2 in. Drawer screw



Quantity: 1
Drawer right side



Quantity: 1
Drawer bottom



Quantity: 2
Drawer glide



Quantity: 6
#6 1 in. Drawer screw



Quantity: 1
Drawer handle



Quantity: 2
Drawer machine screw



Quantity: 1
Rubber Bumper 4 pack

REQUIRED TOOLS FOR INSTALLATION:

The following tools will be needed to assemble and install your John Louis Home Solid Wood product:

- Pencil
- Phillips Screwdriver
- Powered Drill with Phillips Bit

CONTACT US:

For questions concerning missing or damaged parts, technical specs and / or assembly help, please contact John Louis Home Customer Service at:

Email: service@johnlouishome.com

Web: www.johnlouishome.com

Phone: 1.800.480.6985 (Mon-Fri, 8am-4pm, Central)

JOHN LOUIS HOME

Solid Wood Home Storage Solutions

STEP 1: Assembling Drawer

1. Select drawer side (right or left).
2. Insert cam bolt at hole location.
3. Repeat for 2nd location & other drawer side.
4. Select drawer face & insert cam bolts at all hole locations.
5. Select drawer back & insert cam nut into hole location with arrow facing bolt hole.
6. Repeat for all hole locations.

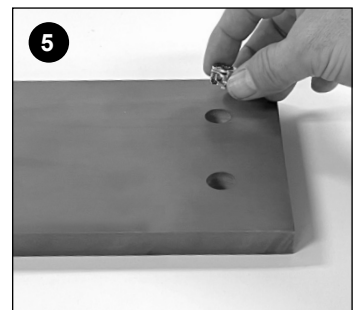
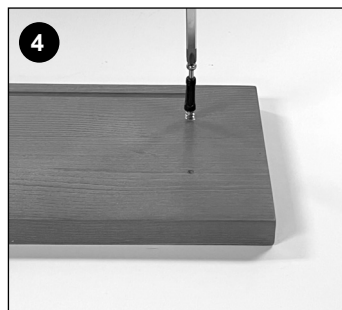
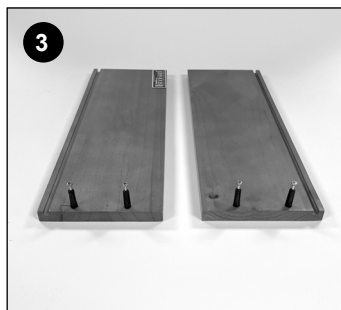
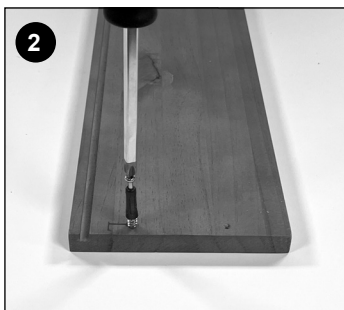

7. Select drawer back & side (right or left).
8. Align the bottom grooves on drawer parts.
9. Insert cam bolts into holes on side of drawer back.
10. Secure by turning cam nuts in clockwise direction until snug.
11. Repeat for remaining drawer side.

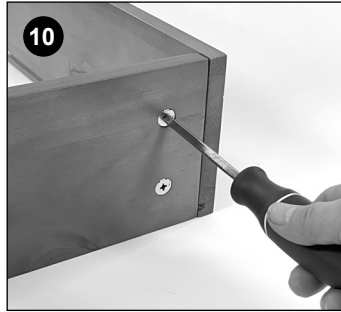
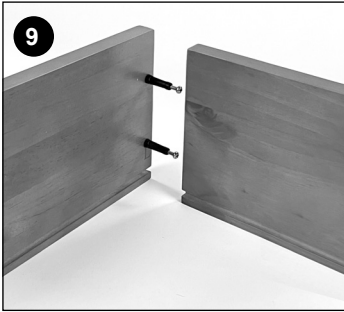

12. Insert drawer bottom into sides making sure bottom is within the grooves.

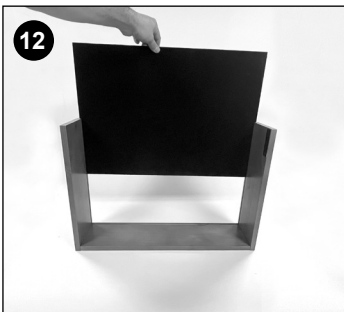

13. Insert drawer face cam bolts into drawer sides at hole locations.
14. Insert cam nuts into sides with the arrow facing the bolt hole.

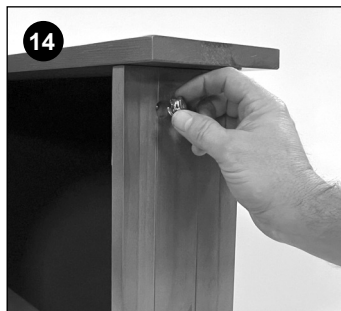

15. Secure by turning cam nuts in clockwise direction until snug.
16. Attach drawer handle to drawer face using machine screws.

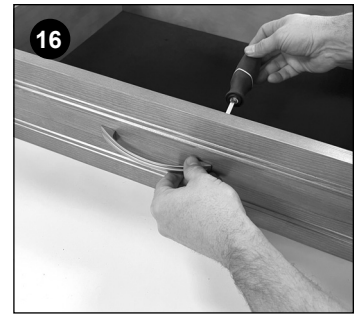
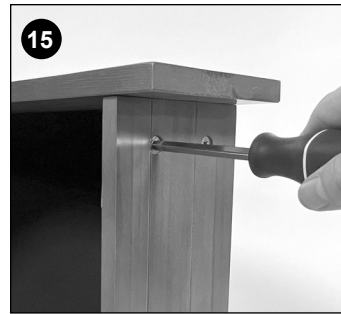

STEP 2: Attaching Drawer Glides

When installing multiple drawers, always start with the bottom placed drawer first. Then continue installing in order to the final top drawer.

1. Expand drawer glide to full extension.
2. Move lever & pull out glide to separate.

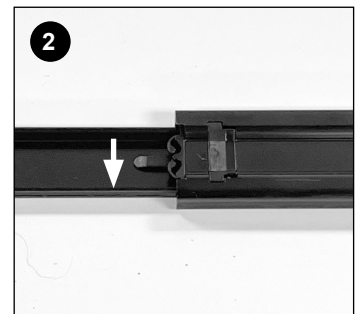
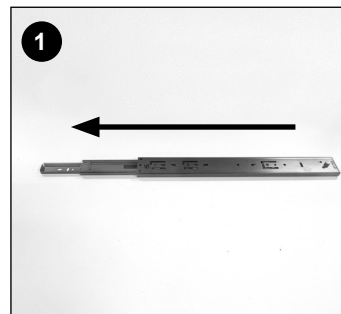

3. Position drawer at desired location to determine glide placement. Glide position is determined by which score mark aligns with tower groove.
4. Place glide at the determined score mark. The open end should face the drawer back.

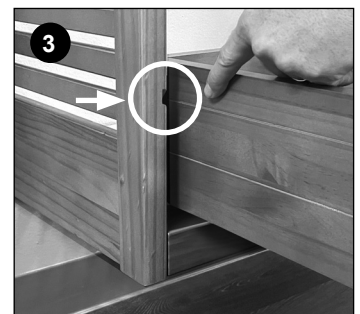

5. Center the screw holes with the score mark.
6. Secure the slide with 1/2 in. screws at the vertical oval locations.
7. Repeat for the 2nd slide.

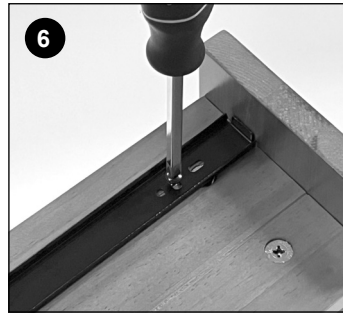
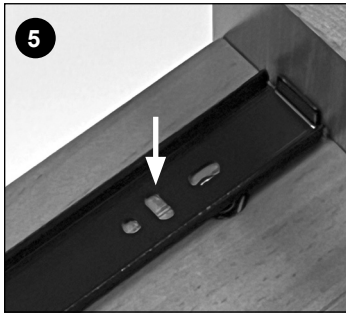

8. Place the slide into grooves at desired locations. Slide flanges should slot into the tower grooves.
9. Slow close mechanism should be positioned at the back wall and the front of the glide should be flush with the front of the tower rail.

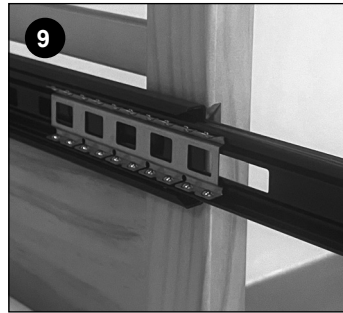

10. Secure the slide with 1 in. screws at back and front location.
11. Repeat for 2nd glide.

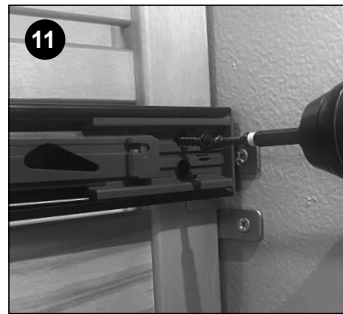
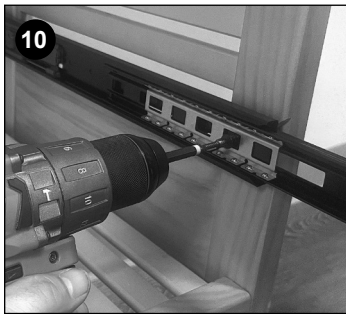

STEP 3: Installing Drawer

When installing multiple drawers, always start with the bottom placed drawer first. Then continue installing in order to the final top drawer.

1. Insert drawer into glides.
2. Open & close drawer to lock glides.

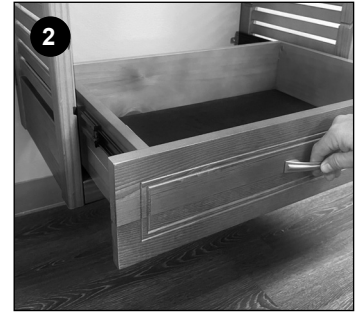

3. Loosen front screw to adjust drawer face up & down position.
4. Use 1/2 in. screw at round hole location to secure drawer face position.
5. Repeat steps for remaining drawer stack.

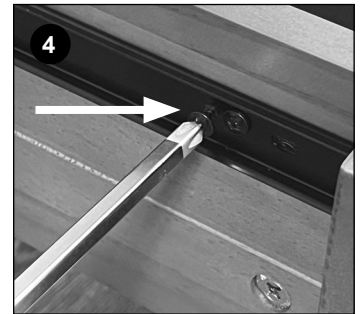
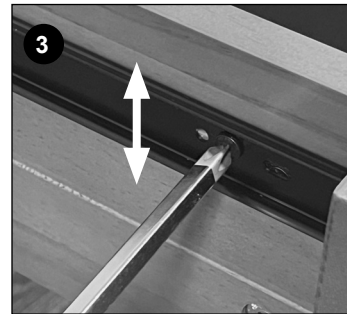

JOHN LOUIS HOME

Solid Wood Home Storage Solutions

For additional product information including step-by-step Installation Videos, Frequently Asked Questions, Storage Tips and more, please visit: johnlouishome.com/resources

JOHN LOUIS HOME

Solid Wood Home Storage Solutions



Installation Instructions

Tower Door Kit

JLH-534, 534S, 534W, 534WS, 535, 535S, 602CH, 602CHS, 603, 603S

PARTS LIST:

Note - Installation instructions are compatible with Glass, Solid, and Shaker models.



Quantity: 2
Glass Door

or



Quantity: 2
Solid Wood Door

or



Quantity: 2
Solid Shaker Door



Quantity: 4
Soft Close Door Hinge



Quantity: 4
Hinge Cover A



Quantity: 4
Hinge Cover B



Quantity: 2
Door Handle



Quantity: 2
Door Handle Machine screw



Quantity: 24
#6 1/2 in. screw



Quantity: 4
Door Bumper

Required Tools For Installation:

The following tools will be needed to assemble and install your John Louis Home Tower Doors:

- Pencil
- Phillips Screwdriver
- Powered Drill with Phillips Bit (optional)

Contact Us:

For questions concerning missing or damaged parts, technical specs and / or assembly help, please contact John Louis Home Customer Service at:

Email: service@johnlouishome.com

Web: www.johnlouishome.com

Phone: 1.800.480.6985 (Mon-Fri, 8am-4pm, Central)

STEP 1: Installing Doors

1. Attach hinge to doors using #6 1/2 in. screws.

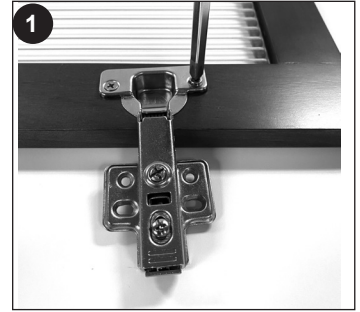
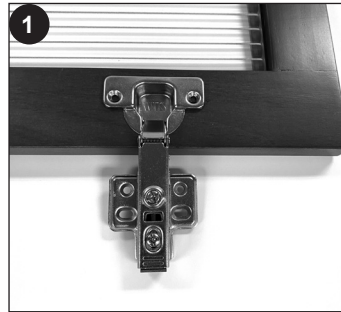

2. Attach handles to doors using 1 1/2 in. machine screw

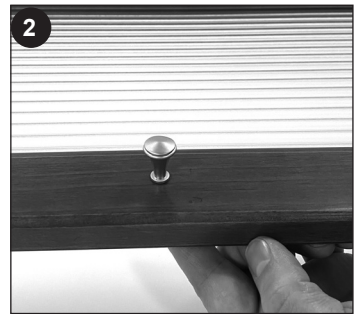
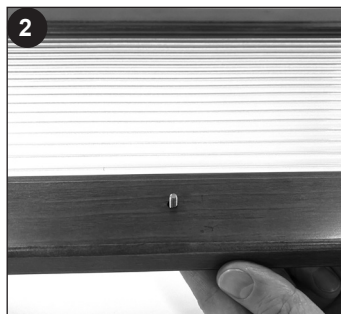

3. Position the door at tower to determine shelf placement for the bottom of the door.
4. Align door into position & flush door with top of tower.



5. With door in closed position, mark the top oval hole location.
6. Secure with 1/2 in. screw.
7. Repeat for 2nd hinge & 2nd door.



STEP 2: Adjusting Doors

1. Close doors to find areas needing adjustment (Uneven top - Too much or too little gap).

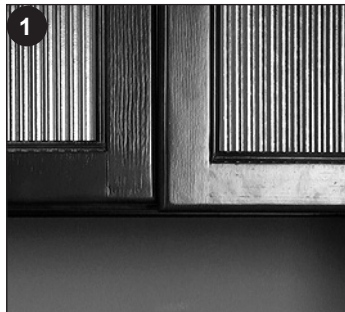

2. Door adjustment may take a combination of the following:
 - Loosen oval hole hinge screws to move doors up & down.
 - Use front hinge screw to move doors in & out.
 - Use back screw to move door forward or back.
3. After adjusting doors, finish securing hinges to tower using 1/2 in. screws at the remaining hole locations.

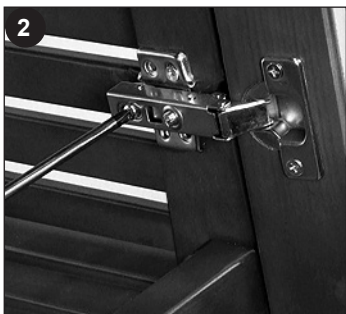
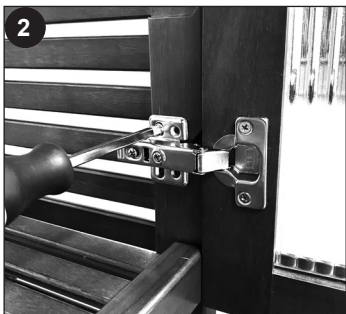

4. Snap screw covers onto hinges.
5. Place bumpers.



STEP 3: Quick Release Hinge

Remove doors by quick release to add or adjust shelves

1. Pull on back lever to remove hinge.
2. Snap back into place to secure hinge.

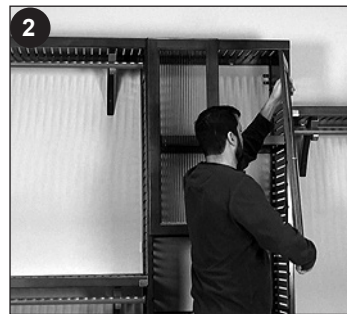
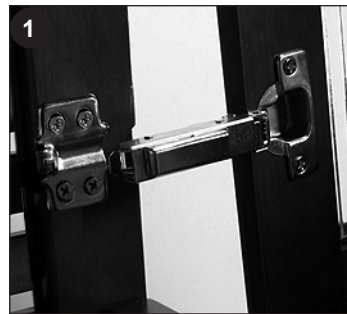
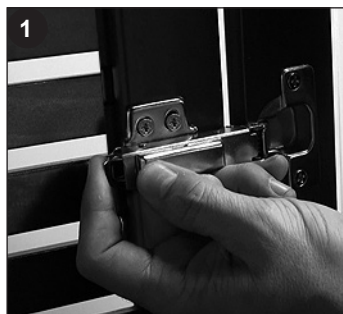

JOHN LOUIS HOME

Solid Wood Home Storage Solutions

For additional product information including step-by-step Installation Videos, Frequently Asked Questions, Storage Tips and more, please visit: johnlouishome.com/resources