

ASSEMBLY INSTRUCTIONS



CAUTION

◆ Inspect the wire insulation for any cuts, abrasions, or exposed copper that may have resulted during shipping. If there is a defect in the wire, do not attempt installation.

◆ Before starting installation of this fixture or removal of a previous fixture, disconnect the power by turning off the circuit breaker or by removing the fuse at the fuse box.



If you need further assistance, please contact us by Email: customersupport@superiordecorinc.com

TOOLS REQUIRED



Ladder



Safety glasses



Electrical tape



Phillips screwdriver



Flat blade screwdriver



Pliers

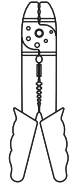

Wire strippers

HARDWARE INCLUDED

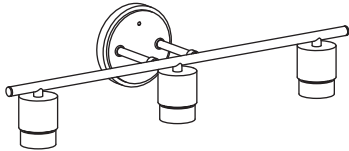

Fixture

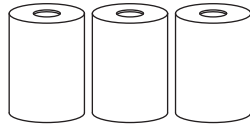

Glass shade

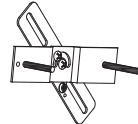

Mounting Unit



Ball Nuts



Mounting Screws



Wire Nuts

***PARTS SHOWN MAY DIFFER SLIGHTLY PER LIGHT FIXTURE**

EXPLODED PARTS

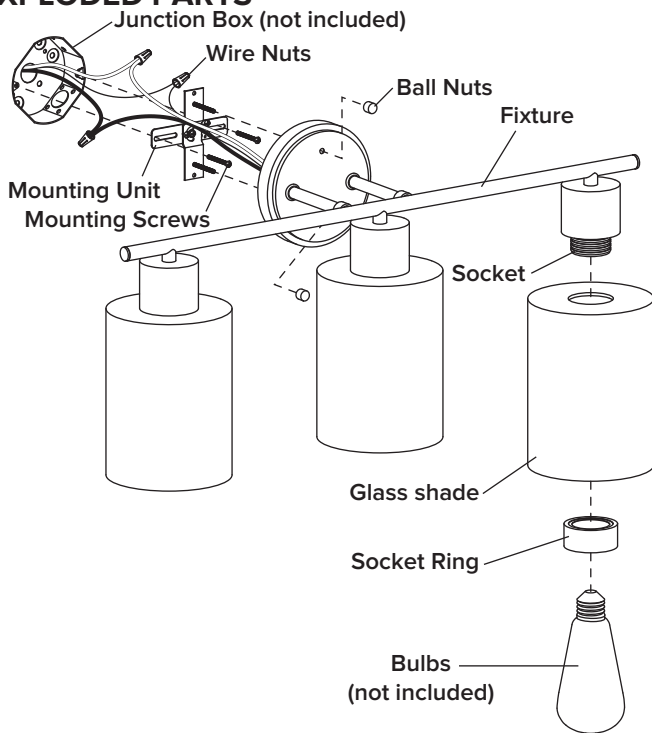

INSTALLATION

STEP 1

Unscrew the **ball nuts** from the **mounting unit**. Use the **mounting screws** to attach the **mounting unit** to the junction box (not included).

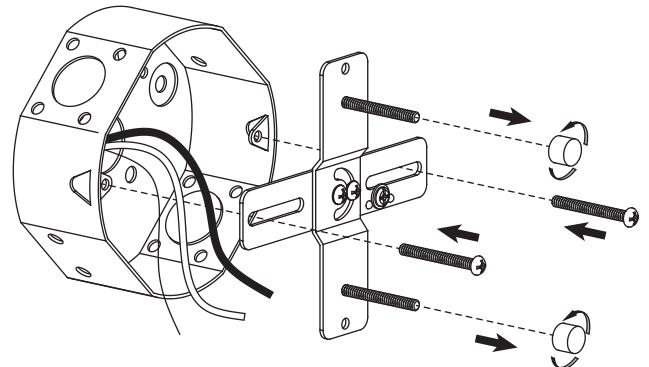

STEP 2

Make the electrical connection from the junction box (not included) to the **fixture**. Connect the ground wire to the **mounting unit** using the preinstalled green ground screw. Next, connect the live wire, neutral wire and ground wires with the supplied **wire nuts**. Secure with electrical tape.

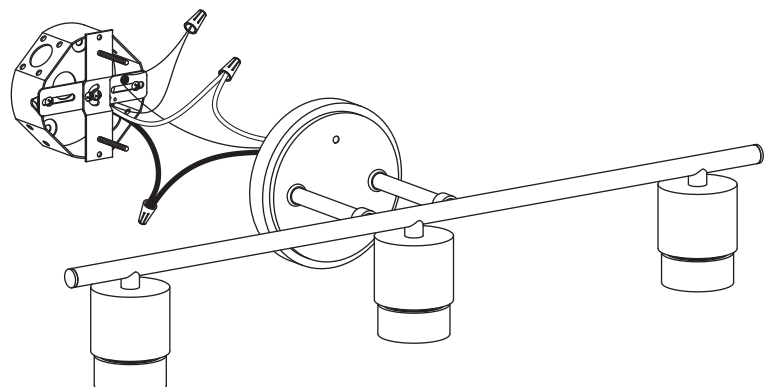
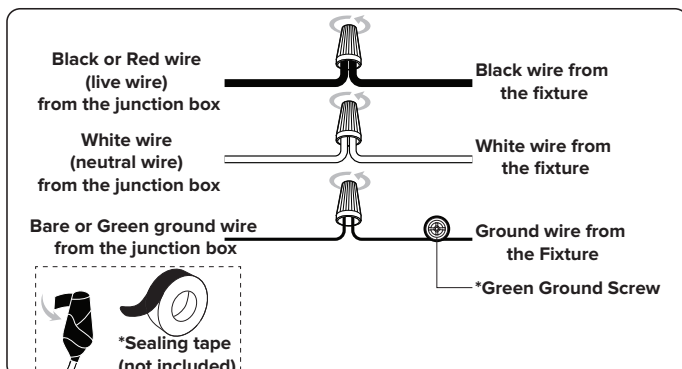

ASSEMBLY INSTRUCTIONS (INSTALLATION)

STEP 3

Attach the **fixture** to the **mounting unit** through **screw holes** as shown, and secure it with **ball nuts**.

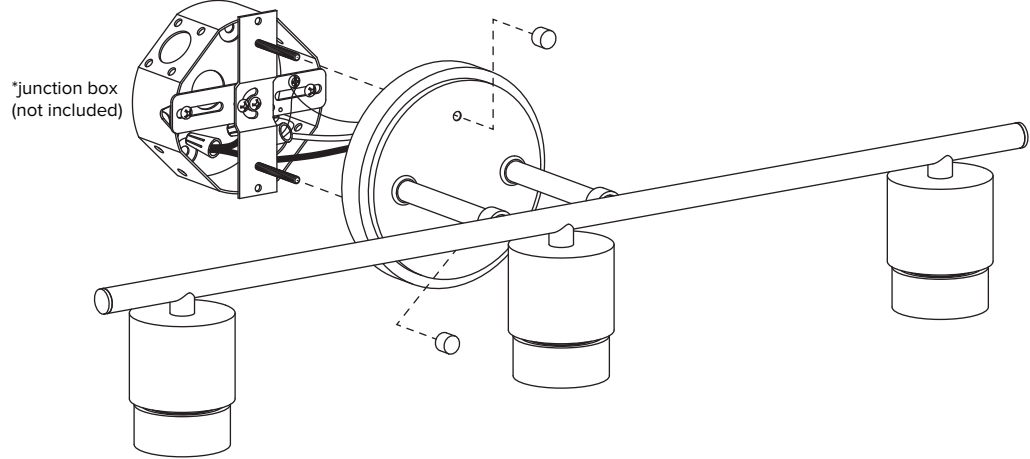

STEP 4

Remove the **socket ring** from the **socket**.
Attach the **glass shade** onto **fixture** using **socket ring**.

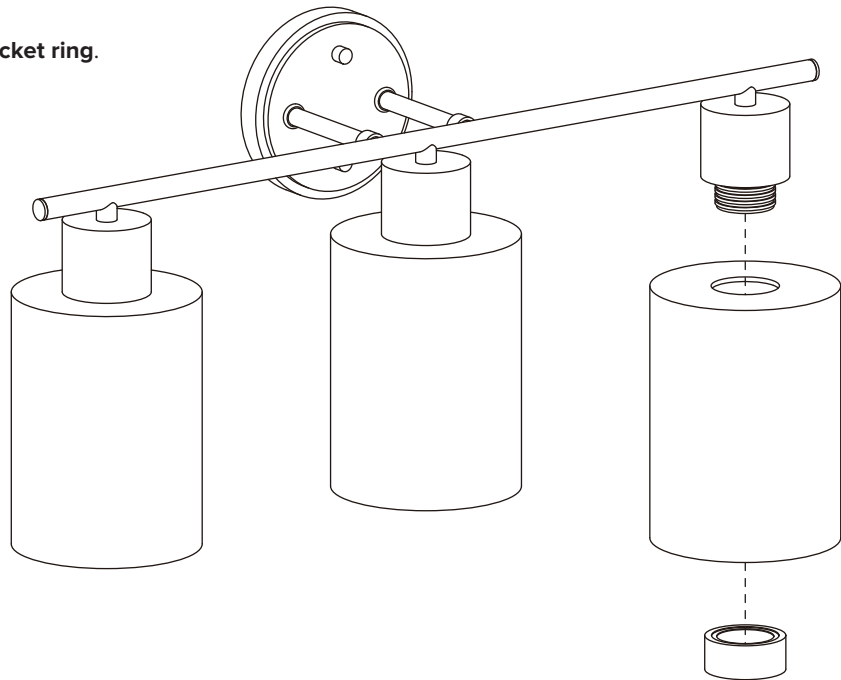

STEP 5

Install bulbs (not included).

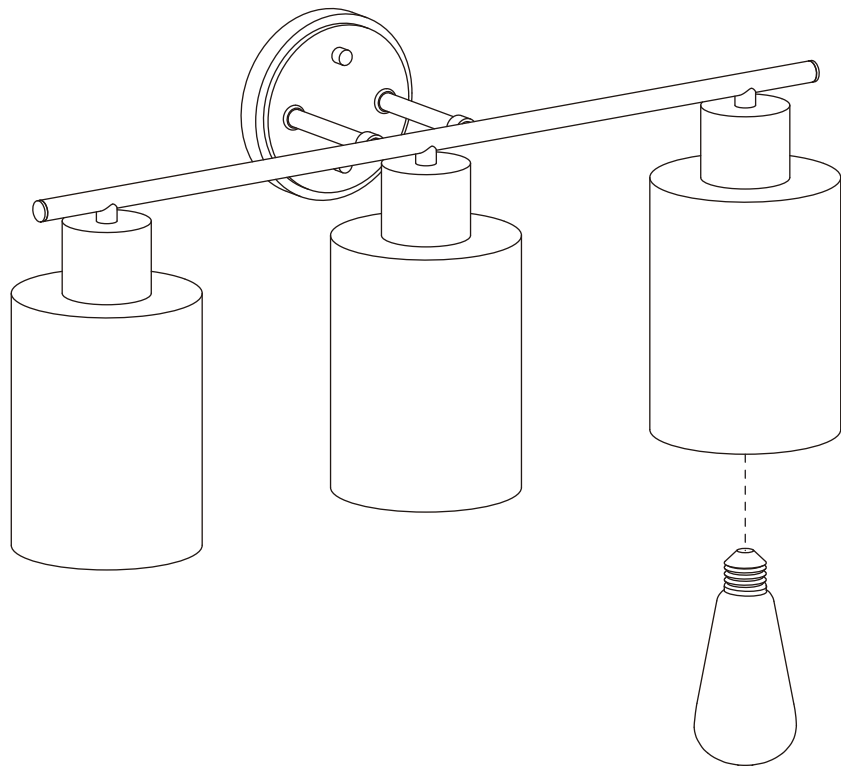

ASSEMBLY AND INSTALLATION

1. Place the MOUNTING PLATE on the wall in the desired location, and mark the center of the top and bottom MOUNTING PLATE holes with a pencil. Remove the MOUNTING PLATE from the wall.
2. Determine if there is a stud behind the marked hole locations.
 - 2a. If there is a stud behind the marked hole locations, skip to step 5.
 - 2b. If there is NOT a stud behind the marked hole locations, proceed to step 3.
3. Using a 5/16" DRILL BIT, drill holes at the marked hole locations.
4. Insert the screw ANCHORS into the holes. The ANCHORS should sit fully within the hole, flush with the wall.
5. Line up the holes in the MOUNTING PLATE with the hole locations, and attach the MOUNTING PLATE to the wall with the SCREWS provided.
6. Attach the ROBE HOOK to the MOUNTING PLATE by hooking the SLOT onto the top edge of the MOUNTING PLATE and holding it flush against the wall.
7. Finish attaching by inserting and tightening the SET SCREW as shown.

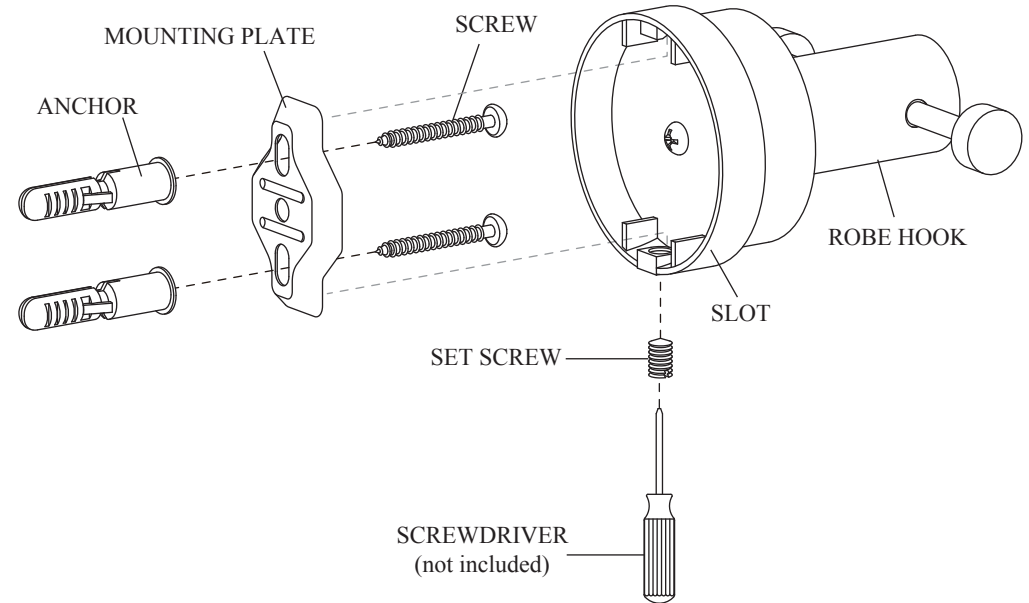

ASSEMBLY AND INSTALLATION (CONT.)

ASSEMBLY AND INSTALLATION

1. Place the MOUNTING PLATE on the wall in the desired location, and mark the center of the top and bottom MOUNTING PLATE holes with a pencil. Remove the MOUNTING PLATE from the wall.
2. Determine if there is a stud behind the marked hole locations.
 - 2a. If there is a stud behind the marked hole locations, skip to step 5.
 - 2b. If there is NOT a stud behind the marked hole locations, proceed to step 3.
3. Using a 5/16" DRILL BIT, drill holes at the marked hole locations.
4. Insert the screw ANCHORS into the holes. The ANCHORS should sit fully within the hole, flush with the wall.
5. Line up the holes in the MOUNTING PLATE with the hole locations, and attach the MOUNTING PLATE to the wall with the SCREWS provided.
6. Attach the TISSUE HOLDER to the MOUNTING PLATE by hooking the SLOT onto the top edge of the MOUNTING PLATE and holding it flush against the wall.
7. Finish attaching by inserting and tightening the SET SCREW A as shown.
8. Orient the TISSUE HOLDER hook in the desired position, and tighten SET SCREW B.

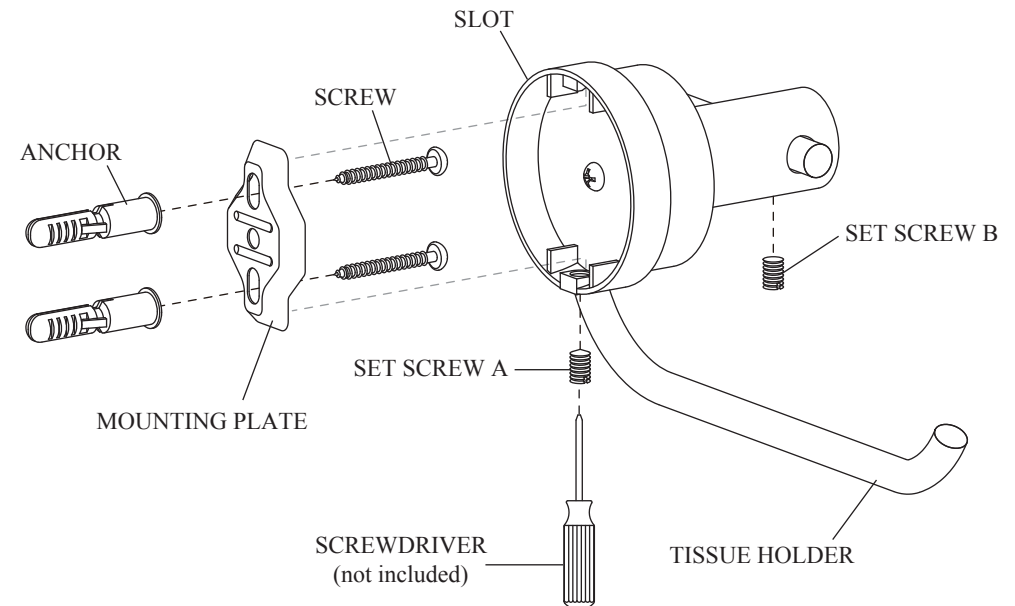

ASSEMBLY AND INSTALLATION

1. Place the MOUNTING PLATE on the wall in the desired location, and mark the center of the top and bottom MOUNTING PLATE holes with a pencil. Remove the MOUNTING PLATE from the wall.
2. Determine if there is a stud behind the marked hole locations.
 - 2a. If there is a stud behind the marked hole locations, skip to step 5.
 - 2b. If there is NOT a stud behind the marked hole locations, proceed to step 3.
3. Using a 5/16" DRILL BIT, drill holes at the marked hole locations.
4. Insert the screw ANCHORS into the holes. The ANCHORS should sit fully within the hole, flush with the wall.
5. Line up the holes in the MOUNTING PLATE with the hole locations, and attach the MOUNTING PLATE to the wall with the SCREWS provided.
6. Attach the TOWEL RING to the MOUNTING PLATE by hooking the SLOT onto the top edge of the MOUNTING PLATE and holding it flush against the wall.
7. Finish attaching by inserting and tightening the SET SCREW as shown.

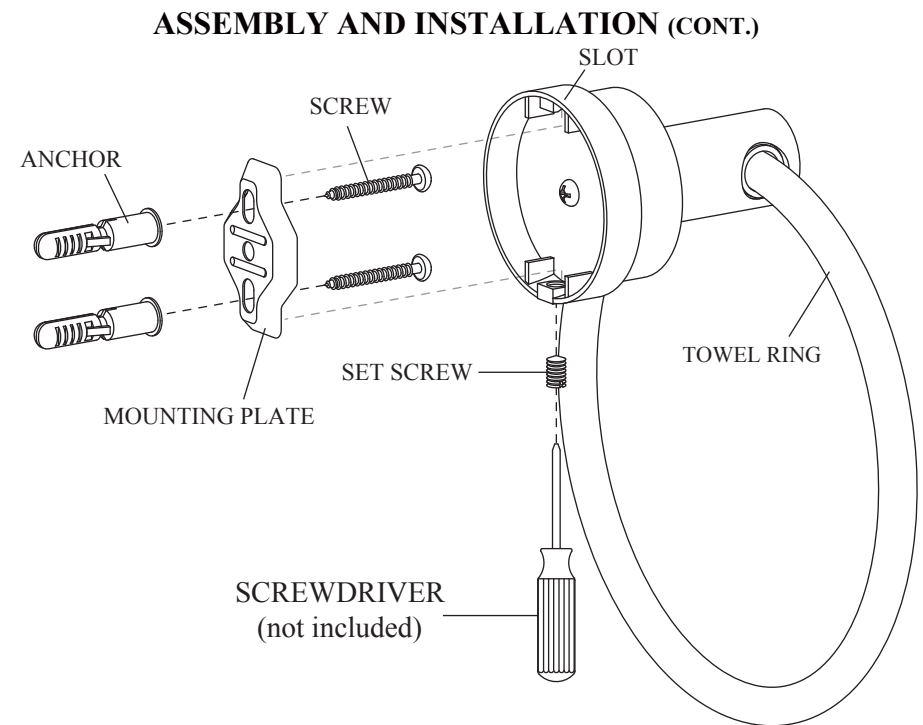

ASSEMBLY AND INSTALLATION

1. Place a MOUNTING PLATE on the wall in the desired location, and mark the center of the top and bottom MOUNTING PLATE holes with a pencil. Remove the MOUNTING PLATE from the wall.
2. Using a TAPE MEASURE and a LEVEL, measure 20.79" to the center of the second MOUNTING PLATE and mark. Place the MOUNTING PLATE on the wall, lining up the center mark, and mark the centers for the top and bottom holes. Repeat for the other MOUNTING PLATE.
3. Determine if there is a stud behind the marked hole locations.
 - 2a. If there is a stud behind the marked hole locations, skip to step 6.
 - 2b. If there is NOT a stud behind the marked hole locations, proceed to step 4.
4. Using a 5/16" DRILL BIT, drill holes at the top and bottom marked hole locations.
5. Insert the screw ANCHORS into the holes. The ANCHORS should sit fully within the hole, flush with the wall.
6. Line up the holes in the MOUNTING PLATE with the hole locations, and attach the MOUNTING PLATE to the wall with the SCREWS provided.
7. Attach the TOWEL BAR to the MOUNTING PLATES by hooking the SLOT onto the top edge of the MOUNTING PLATES and holding it flush against the wall.
8. Finish attaching by inserting and tightening the SET SCREWS as shown.

