

CLAWFOOT BATHTUB SERIES

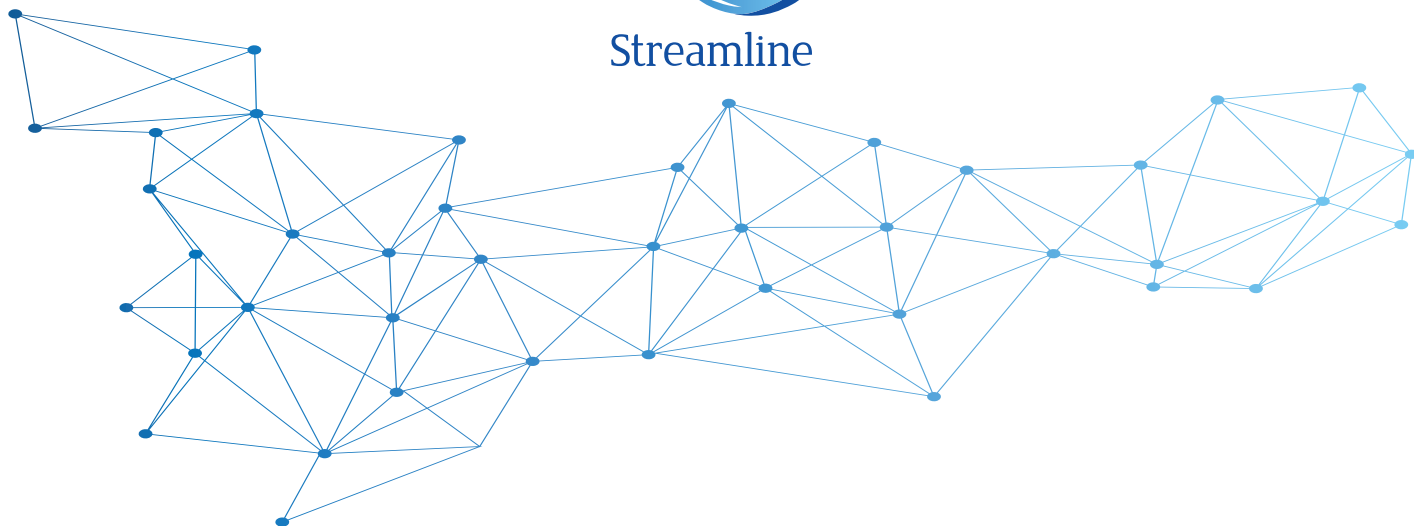

Streamline



OWNER'S MANUAL & INSTALLATION GUIDE



READ ENTIRE INSTALLATION GUIDE
PRIOR TO INSTALLING THE BATHTUB
THIS BATHTUB SHOULD ONLY BE
INSTALLED BY A CERTIFIED PLUMBER

CAUTION!



TWO PEOPLE ARE REQUIRED
TO LIFT THE BATHTUB

QUESTIONS ON PRODUCT, INSTALLATION, RETURNS? PLEASE CONTACT

streamlinebath.com

support@streamlinebath.com

1 (310)-935-0028

PRIOR TO INSTALLING

These products must be installed by a fully insured and licensed plumber only.

Installation of any product by anyone other than fully insured and licensed plumber shall void limited warranty.

We are not responsible for any local code compliance for this product.
Building and plumbing codes may vary state-to-state.
Streamline shall not be held liable for any and all incidental damages or flood caused due to use of this product.

Streamline shall not be held liable for any and all fees stemming from cost of installation, re-installation, removal, subsequent damage, or transportation in a case of a product defect.

TOOLS REQUIRED

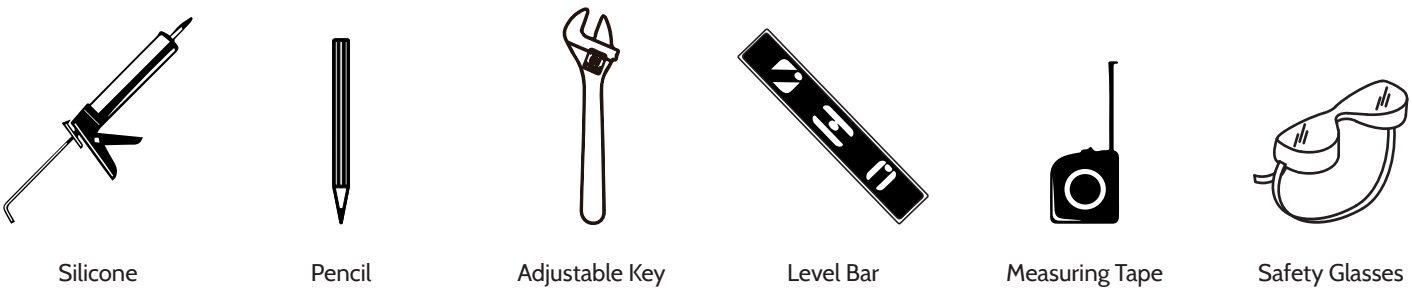

WHAT'S IN THE BOX

Please note:
Different bathtub models have different drain & clawfeet models. Please see the next page to determine which drain or clawfoot model applies to the bathtub model that you have purchased.

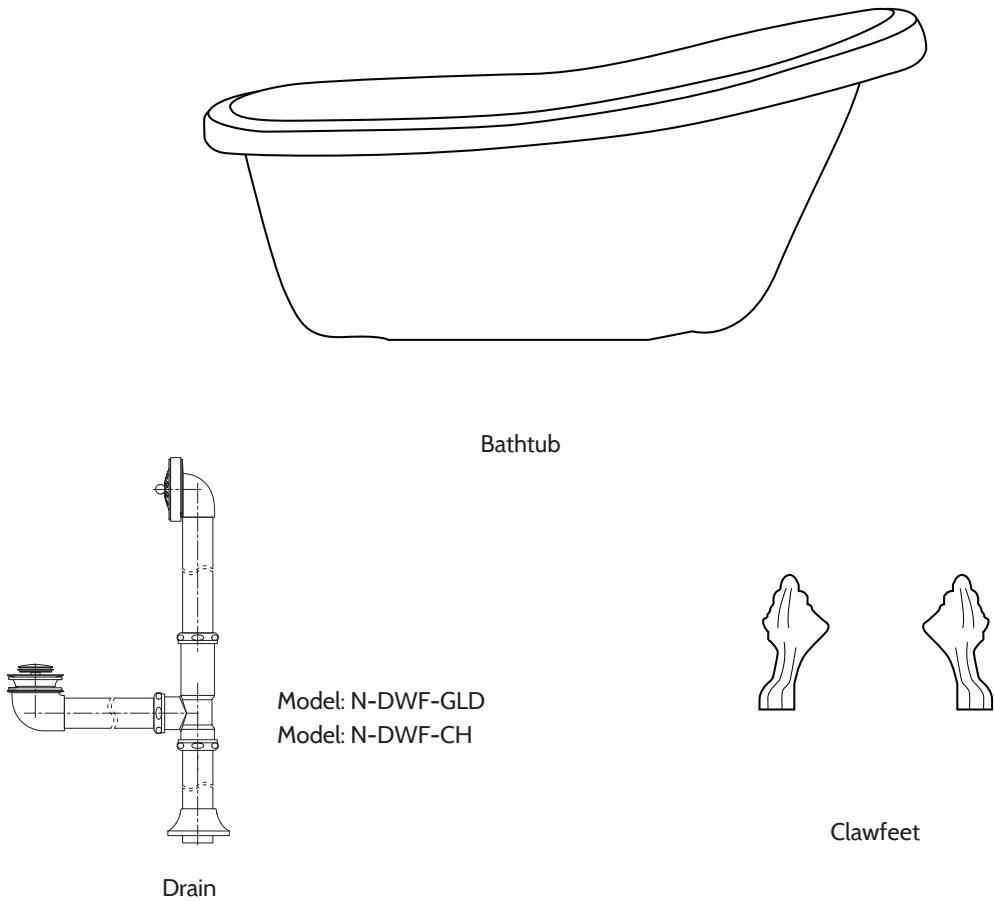

DRAIN MODEL COMPATIBILITY

FREESTANDING BATHTUB

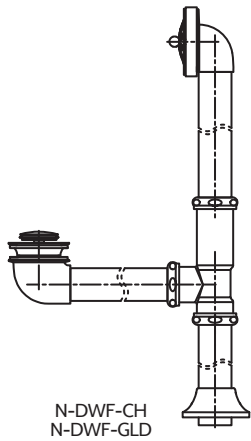

R-5000-69CICFRD-FM



R-5001-69CICFWH-FM



R-5020-72CICFWH-FM



R-5060-67CICFPR-FM



R-5061-67CICFWH-FM



R-5100-66CICFWH-FM



R-5101-48CICFWH-FM



R-5160-72CICFRD-FM



R-5161-61CICFRD-FM



R-5162-72CICFWH-FM



R-5163-61CICFWH-FM



R-5220-67CICFWH-FM



R-5221-61CICFWH-FM



R-5240-71CICFWH-FM



R-5280-66CICFRD-FM



R-5281-66CICFWH-FM



R-5420-67CICFWH-FM



R-5440-65CICFGR-FM



R-5441-65CICFRD-FM



R-5442-65CICFWH-FM



R-5460-53CICFWH-FM



R-5500-60CICFWH-FM



R-5501-66CICFWH-FM

DRAIN DIAGRAMS

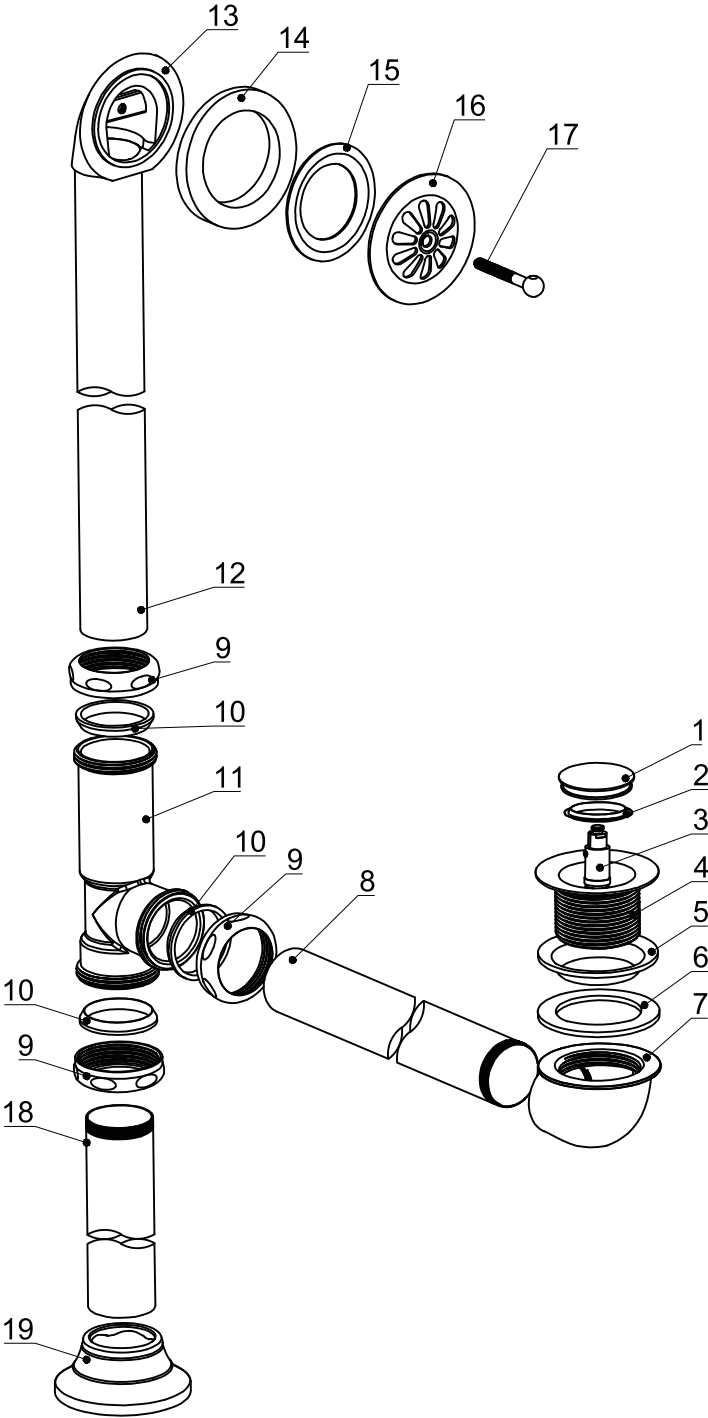

Model: N-DWF-GLD
Model: N-DWF-CH

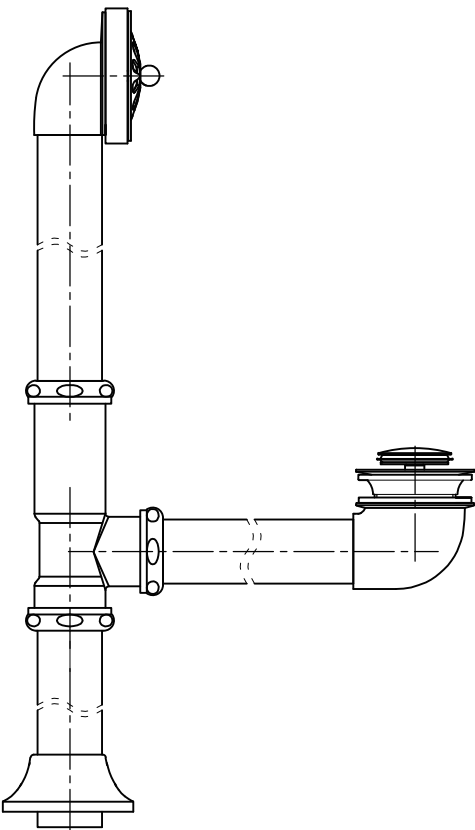

No	ITEM	Qty
1	Cover	1
2	Cover gasket	1
3	Cartridge	1
4	Strainer	1
5	Waste upper gasket	1
6	Waste lower gasket	1
7	Connector	1
8	Coupling nut	1
9	Nut	1
10	Washer	3
11	Tee	3
12	Pipe	1
13	Overflow body	1
14	Tapered rubber gasket	1
15	Overflow upper gasket	1
16	Overflow plate	1
17	Pin Bolt	1
16	Taic piece	1
17	Flange	1

CLAWFOOT CONFIGURATION

Clawfeet: R-CFLO3, R-CFLO4, R-CFLO6, R-CFL-20 have specific foot placement. Each foot in the set is unique. Inside each foot is labeled with a letter to help you find the proper location on the tub for installation. Match up the letters on the clawfeet with the letters on the underside of the tub. The letters on the tub will be the same as what are on the clawfeet and will match accordingly.

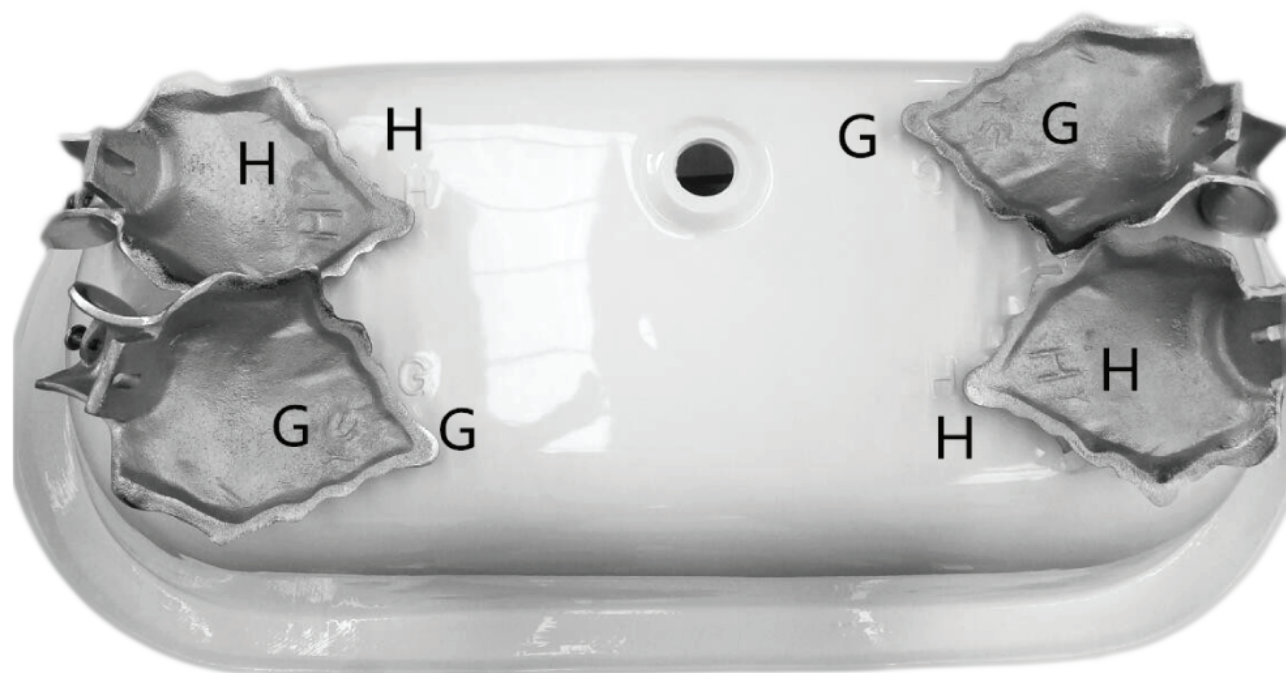

APPLICABLE MODELS

- R-CFL01-CH

R-CFL01-WH

R-CFL01-GLD

R-CFL02-CH

R-CFL02-WH

R-CFL02-GLD

R-CFL03-CH

R-CFL03-WH

R-CFL03-GLD

R-CFL04-CH

R-CFL04-WH

R-CFL04-GLD

R-CFL06-CH
- R-CFL06-WH

R-CFL06-GLD

R-CFL08-CH

R-CFL08-WH

R-CFL08-GLD

R-CFL10-CH

R-CFL10-WH

R-CFL10-GLD

R-CFL16-CH

R-CFL-20-CHR

R-CFL-20-GLD

R-CFL-20-WH

CLAWFOOT DIAGRAM

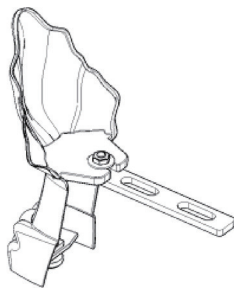
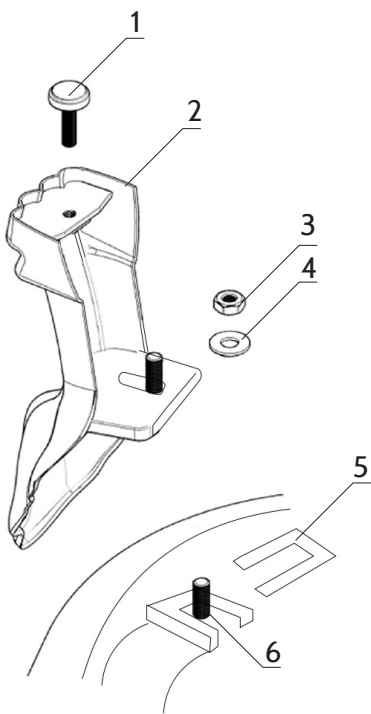

No.	ITEM	Qty
1	Adjustable Feet	4
2	Claw Feet	4
3	Nut	4
4	Washer	4
5	Rubber Washer	4
6	Bolt	4

BATHTUB INSTALLATION

1. Ensure that the floor at the installation site has sufficient floor support and is level.

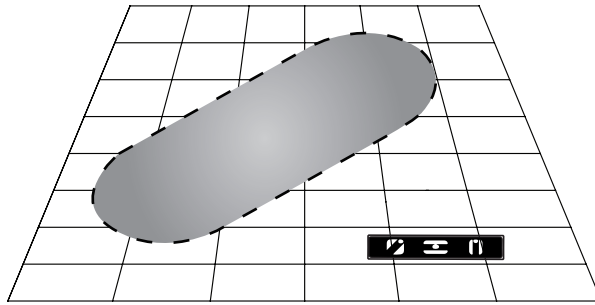

2. Waterproofing the floor is highly recommended.

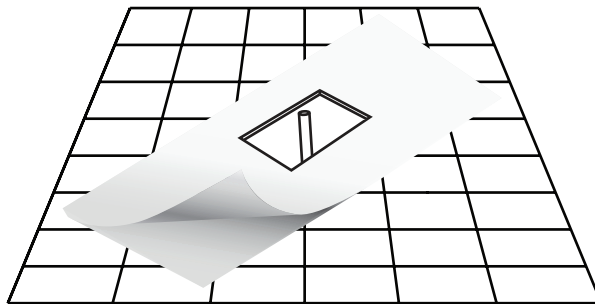

3. Determine the location of the drainpipe on the floor by taking measurements of the drain and waste location underneath the unit. Clean the drain hole area in preparation of setting the drain. The area should be dry & free from any debris.

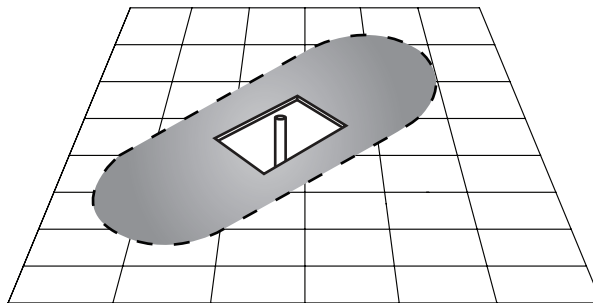

4. Remove the bathtub from its box. It is recommended that the bathtub is carried by a minimum of two people. Ensure to carry and set down the bathtub only in the upside-down position.

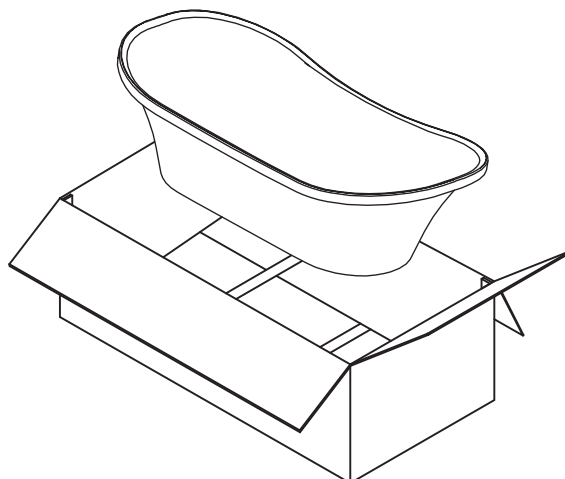

5. Gently place the bathtub in the upside-down position on a tarp or cardboard sheet in order to avoid contact with any rough surface.

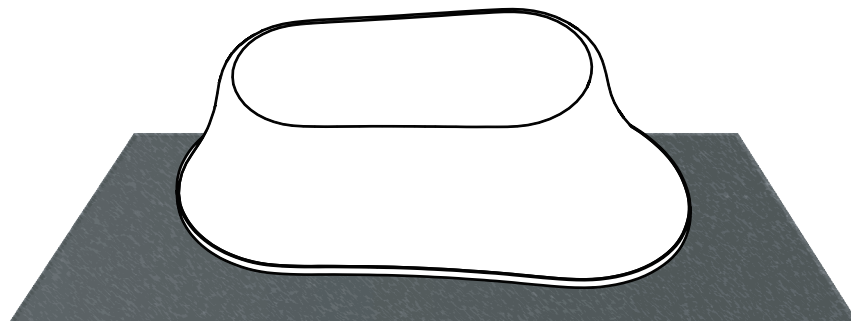

6. Take (1) adjustable foot [#1], place it through the hole in the clawfoot [#2],

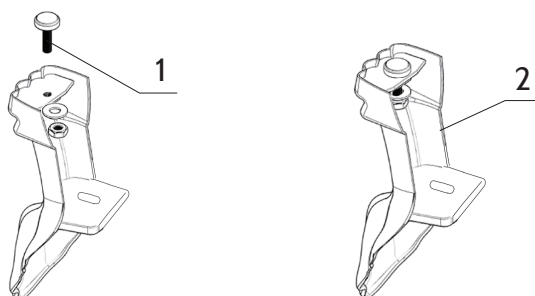

7. Place (1) rubber washer [#5] and place it over the bolt [#6]

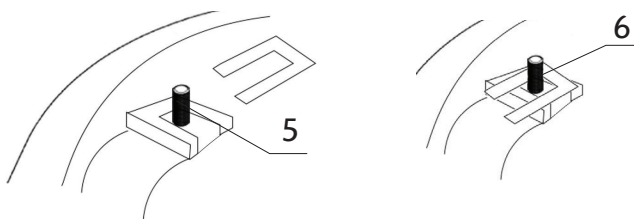

8. Take the clawfoot [#2] and place it over over the rubber washer [#5] and bolt [#6].

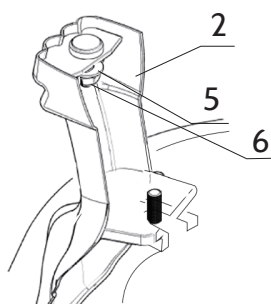

9. Take one washer [#4] and place it over the clawfoot [#2] and bolt [#6].

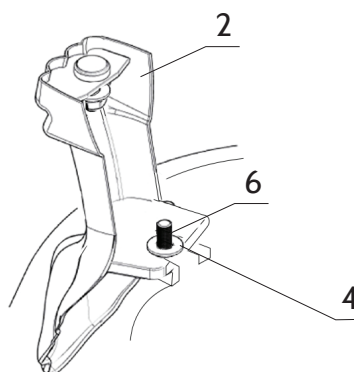

9. Take (1) nut [#3] and place it over the the washer [#4].

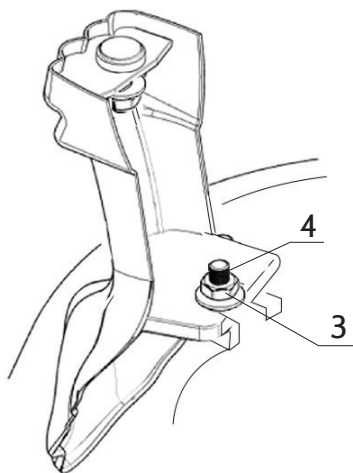

10. Make sure to adjust the clawfoot so that it fits snug with the bolts on the bathtub. This will help to ensure that the clawfeet are placed correctly and are functioning properly.

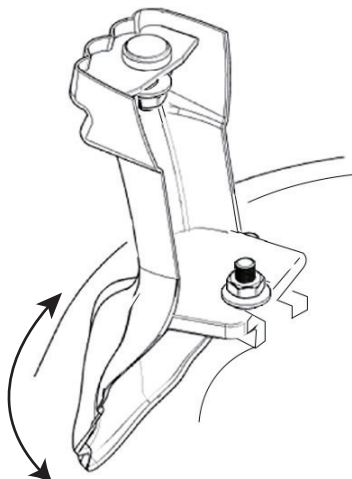

10. Tighten the nut [#3] with a wrench and adjust the clawfoot as needed. Repeat for the other 3 clawfeet.

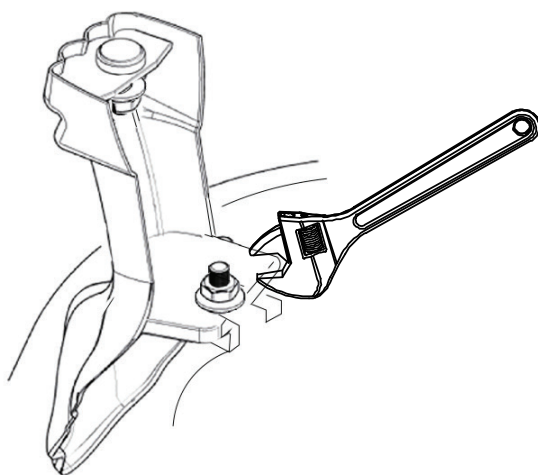

11. Take the strainer, place silicone sealant around it, and then place it into the drain hole ensuring a tight connection with the drain ell & gasket. Use silicone sealant. DO NOT use plumbers putty to seal.

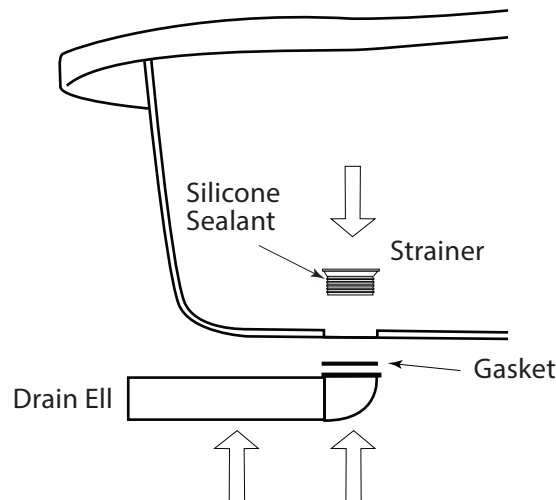

12. Insert the tailpiece into the trap inlet using the O-ring, coupling nut, & flange. The tailpiece may need to be cut for proper fit. 1"-2" of the tail piece should fit inside the trap. Slip the flange over the tailpiece and slide down to the floor.

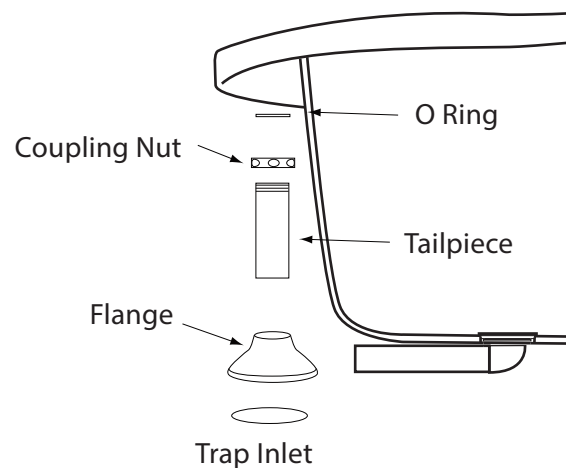

13. Assemble the tee section to the tailpiece, overflow, & drain ell using the coupling nuts and O-rings that are provided.

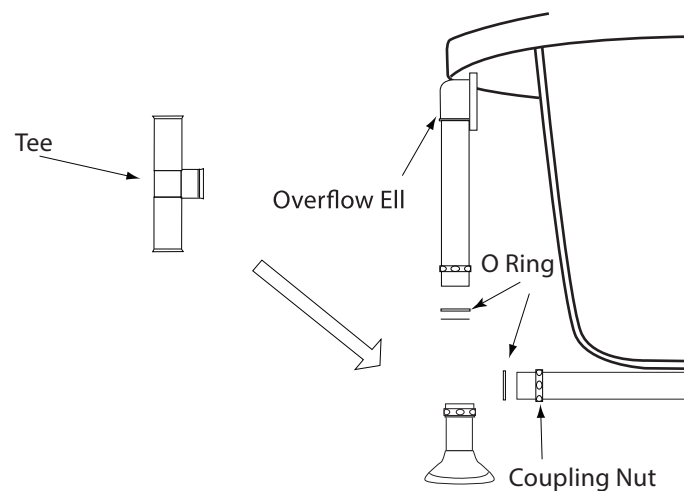

- 14 . Attach the tapered rubber gasket to the overflow ell. Align the overflow ell with the overflow hole & secure the drain to the tub with overflow plate and screw provided.

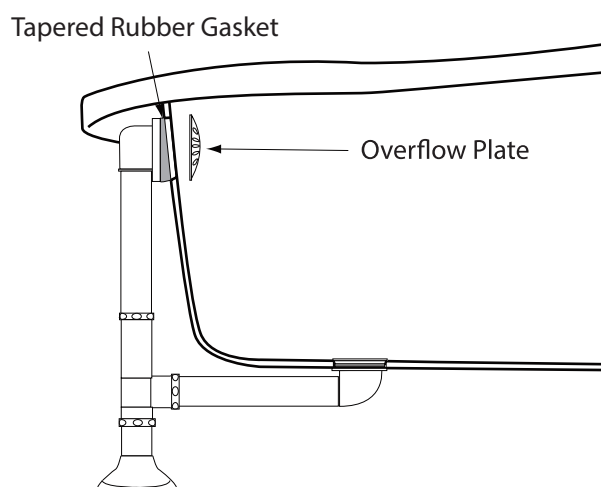

- 15 . Make sure a watertight seal exists on all bath drain connections.

