



PROGRASS®
SYNTHETIC GRASS

INSTALLATION GUIDELINES

FOR ARTIFICIAL GRASS



PROGRASS®
SYNTHETIC GRASS

prograssturf.com
866-268-6100
service@prograssturf.com
#45036

BEFORE
YOU BUY

CONSIDERATIONS BEFORE YOU BUY AND INSTALL ARTIFICIAL GRASS

Before you purchase artificial grass for your project you should carefully examine the areawhere you would like to install the artificial grass. There are some areas where installing artificial grass may not be appropriate:

- ▶ Areas where there are a large number of trees with exposed roots
- ▶ Areas where an adjoining property owner's lawn is eroding onto your property
- ▶ Areas with poor drainage or areas that lack a natural drainage outlet may require extensive subsurface work before artificial grass can be installed.
- ▶ Artificial grass can melt if it is struck by concentrated refracted light. While this problem is most common in areas that have high daily temperatures, it can occur almost anywhere in the Southern USA. Windows, fences, and other shiny surfaces, especially curved surfaces, can concentrate light and create temperatures over 300 degrees Fahrenheit. ProGrass and Lowe's will not be responsible for damages caused by refracted light. Painting surfaces or applying films to windows can mitigate refracted light issues.
- ▶ Read the guidelines in its entirety before you begin.

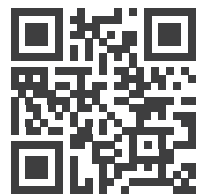

For installations over 200 sq.ft. we strongly recommend using an Installation Professional. Large installations can be very labor-intensive and are not recommended for everyone. Let us do the heavy lifting for you. **Visit https://www.lowes.com/l/install/artificial-grass?utm_source=synlawn&utm_medium=lowes&utm_campaign=installation**

MEASURING THE AREA

MISTAKES CAN COST MONEY.

This is the start to a detailed, but simple instructional guide to correctly installing Prograss. Be sure to carefully survey the area and begin measuring always keeping the grain direction of the artificial grass the same. Face it toward the direction it will be seen most.

- ▶ Measure the job carefully. If you have many curves and irregular shapes, we recommend adding 10-20% more artificial grass than your area's actual square footage. When designing, try to install the artificial grass in 15' wide sections. Artificial grass is sold in 15' widths (example 15' x 20'). Use graph paper, a sketchpad or iPad to record all measurements and note grain direction.

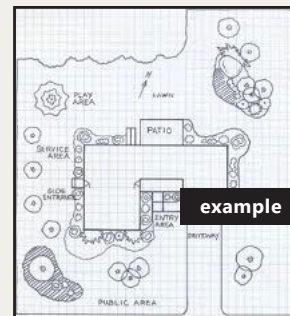

We suggest you measure as close to exact numbers as possible rather than estimating by total square footage.

- ▶ In high traffic paths, we recommend installing a pathway of stepping stone or pavers. This will help prevent the artificial grass from matting down and the need for more frequent maintenance.

CALCULATIONS (measure in 15' wide sections when possible)

Area 1

length (at longest point) x width = _____ Area 2 & 3: length x width = _____

Area 1+Area 2+ Area 3 = _____ total sq.ft.

Total sq.ft. / 15 = _____ total linear feet needed

Order artificial grass as 15' x _____ (total linear feet calculated)





PROGRASS®
SYNTHETIC GRASS

prograssturf.com
866-268-6100
service@prograssturf.com
#45036

PROJECT CHECKLIST

✓ Base material

✓ Double checked measurements for accuracy to ensure no material shortages

✓ Artificial grass

✓ Accessories

ProGrass Infill

ProGrass Weed Barrier

ProGrass Adhesive

ProGrass Rake

ProGrass Seam Cloth

Irrigation items (if needed)

Landscape Spikes

✓ Have all required tools (below is a list of tools you may or may not need, depending on the size of the project)

Measuring Wheel

Hand Tamp

Trowel

Tape Measure

Vibratory Plate Compactor

Power Broom

Marking Paint

Grading Rake

Drop Seed Spreader

Sketchpad or iPad

Wheelbarrow

Leaf Blower

Sod Cutter

Carpet Knife

Hammer

Flat Shovel

Loop File Cutter

Water Hose

✓ Care & Maintenance Instructions

✓ Cleaned area of all debris



PROGRASS®
SYNTHETIC GRASS

prograssturf.com
866-268-6100
service@prograssturf.com
#45036

ACCESSORY RATIOS



INFILL 50LB BAGS

1.5 - 2.5lbs
needed per sq ft



ADHESIVE 29OZ

Each tube covers
up to 7'

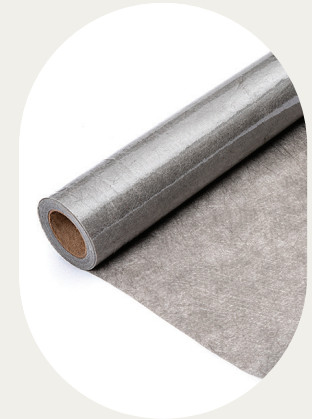

SEAM CLOTH 1' x 100'

Each roll covers
up to 100 sq ft

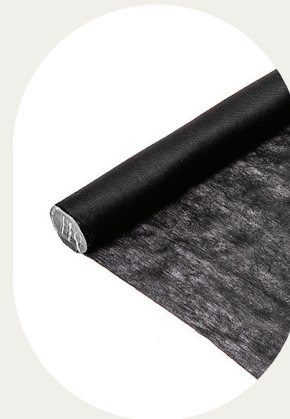

WEED BARRIER 3' x 50'

Each roll covers
up to 150 sq ft



RAKE



LANDSCAPE SPIKES

Needed for edges and
seams every 8" - 12"

ESTIMATING MATERIALS

The drawing to the right indicates a sketch for a typical yard. In this case, there are areas with mulch and shrubs (all four corners) that will not require artificial grass. As you can see, there is a 15' x 44' area, a 10' x 30' area, and a 4' x 9' area. This project would require seams, indicated by the dashed line between the sections.

NOTE

- Always measure to the longest point.
- You will need about 1 ton of aggregate or base material for every 100 sq.ft. at a 3" depth. This project would require approximately 10 tons of aggregate. For each ton of aggregate, you will need approximately 13-16 **wheelbarrows** full that will need to be hauled to the project area from the staged dumping site.
- If artificial grass is being installed over concrete, a glue-down method may be used and no base is required.

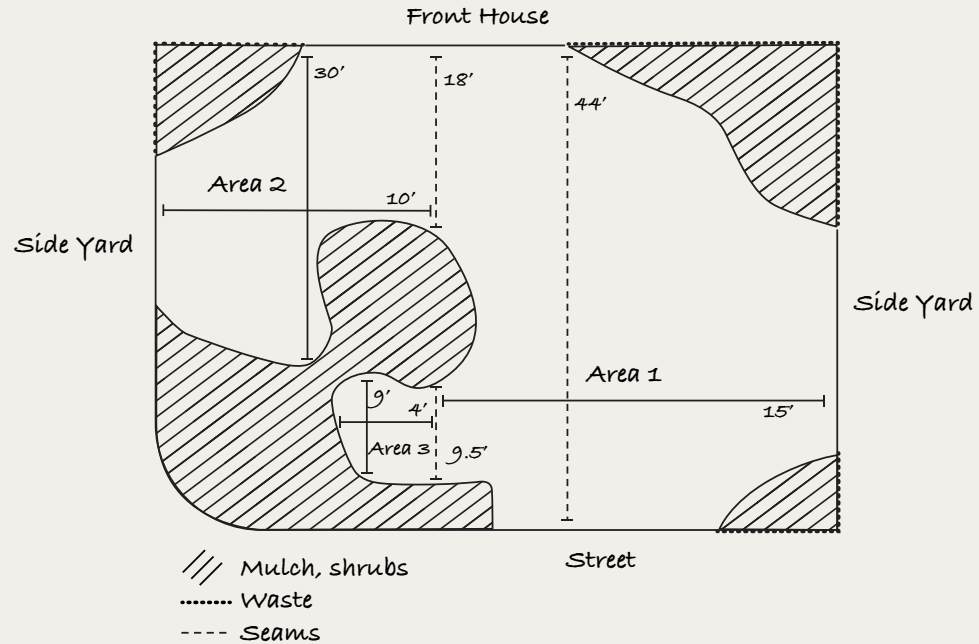

TO ESTIMATE ARTIFICIAL GRASS NEEDED

AREA 1

15' x 44' = 660 sq.ft. It is encouraged to purchase 10-20% extra to account for curves and errors. You will need a 15' x 49' piece of artificial grass accounting for extra.

AREA 2

10' x 30' = 300 sq.ft. You will need a 15' x 33' piece of artificial grass accounting for extra. Note for Area 2: Even though this area is only 10' wide, you must purchase in 15' widths. You will have 5' x 33' piece of artificial grass leftover to use for Area 3.

AREA 3

4' x 9' = 36 sq.ft. You will need the leftover piece from Area 2: 5' x 33' with artificial grass waste leftover. No additional artificial grass purchase necessary to install Area 3.

TOTAL ARTIFICIAL GRASS NEEDED

15' x 49' + 15' x 33' = 15' x 82' or 1,230 sq.ft. of artificial grass.

TO ESTIMATE BASE MATERIAL

Figure out the total square feet for the area requiring artificial grass.

Area 1: 660 sq.ft. + Area 2: 300 sq.ft. = 960 sq.ft.

(Area 3 is not needed in calculation as it is smaller than the mulch/shrub area in Area 2)

Total sq.ft. / 100 = # of tons of aggregate at 3" depth

TO ESTIMATE OTHER MATERIALS

SEAM CLOTH | Measure full length of area to be seamed. Each roll covers 100 ft. (Drawing shows 27.5' of seaming, about 1 roll needed).

ADHESIVE | Measure full length of area to be seamed. Each tube covers up to 7 ft. on seam cloth (about 4 tubes needed).

WEED BARRIER | Measure full length of area to be installed. Each roll covers up to 150 sq.ft. (about 7 rolls needed).

LANDSCAPE SPIKES | Measure full length of edges and seams to be installed. A spike is required every 8"-12" (about 2 bags needed).



prograssturf.com
866-268-6100
service@prograssturf.com
#45036

SITE PREPARATION

NOTE

Don't forget to run drip lines to trees or plants that were receiving water from this source.

- ▶ Treat any weed or rodent problem prior to the installation. Gopher wire (hardware cloth) can be installed under the artificial grass's base. Weed barrier can also be used to help prevent further growth.
- ▶ Determine the proper amount of base material (decomposed granite or recommended base material for your area).
- ▶ Remove the grass, dirt, rock or whatever is in the area the artificial grass will be installed. Depending on your area, remove between 3" - 4" to create an adequate drainage base.
- ▶ Use a **sod cutter** or **flat shovel** and haul away material.
- ▶ Grade sub grade level and compact if needed.
- ▶ If there is no grass and the yard consists of dirt, pay close attention to the depth in all areas to determine the amount of base material needed.
- ▶ Have the project site's water turned off a few days before starting the artificial grass installation.
- ▶ Be sure all of the project site's sprinklers are removed and capped off or cut the irrigation valves.



<https://youtu.be/OX4EmkrOVa4> watch the Base Preparation video!

CALCULATIONS (measure in 15' wide sections when possible)

(3" in depth – Total sq.ft. of area) / 100 = _____

(4" in depth – Total sq.ft. of area) / 80 = _____

This calculation will provide you with the total TONS of base material needed.



TOOLS &
MATERIALS

Sod Cutter
Flat Shovel



prograssturf.com
866-268-6100
service@prograssturf.com
#45036

INSTALLING THE BASE

NOTE

When installing next to a concrete slab or walkway the compacted base should be 1" to 1.5" below the surrounding grade level.

- ▶ Rock yards use different materials to create Road Base. Please inquire with your dealer or local rock company to determine the best option for your area and which product is best suited for your compacted drainage bed.
- ▶ Install weed barrier on top of prepared sub grade if needed for tough weed problems.
- ▶ Haul base material from street using **wheelbarrows** and dump in desired area until you create a 3" - 4" base.
- ▶ Using a **grading rake**, prepare the base level for proper drainage.
- ▶ Use a **water hose** to water down graded base area to help with base compaction.
- ▶ Use a **vibratory compactor** to compact base until you reach an 80% compaction rate. A **hand tamper** should be used to reach small or tight areas. Improper or incomplete compaction could result in improper drainage. Repeat as needed to acquire desired base.
- ▶ If you need a small amount of fines, DG (decomposed granite) or stone dust can be used to fill in any large pits in the compacted base.
- ▶ All great lawns have a solid base, be sure to go over the area several times and remove any large rocks or objects from the soil.



Hand Tamp
Vibratory Plate Compactor
Grading Rake
Wheelbarrow
Base Material
Water Hose
Weed Barrier



prograssturf.com
866-268-6100
service@prograssturf.com
#45036

SPECIAL CONSIDERATIONS



PET PROJECTS

When installing artificial grass in pet areas, take special precautions in regard to odors. It is highly recommended to use zeolite product for this purpose. Depending on which brand of products you are using, follow the recommended guidelines for installation. Some products need to be applied on top of the base, others are better as infill, and sometimes it is suggested to do both. It is also recommended to use spikes every 4" – 6" instead of 8" – 12" apart on all pet projects. Installing a perimeter board around the area to secure the artificial grass is ideal, but not required. Pet projects will require additional maintenance. Be sure to read our Care & Maintenance Instructions.

PLAYGROUND PROJECTS

Fall zones under playground equipment using an underlayment foam pad can be created for your playground projects. Installation training can also be available as there are many important things to know when installing the additional materials needed such as increasing the grade and underlayment foam products.

PUTTING GREEN

Putting green installations require special instructions for a quality putting green. Training can be available for the proper procedures, as well as, ensuring you know which products and accessories are best suited for your project.



PROGRASS®
SYNTHETIC GRASS

prograssturf.com
866-268-6100
service@prograssturf.com
#45036

ARTIFICIAL GRASS INSTALLATION

NOTE

Before laying the artificial grass, be sure the grain direction aligns with the original design.

- ▶ Unroll and cut artificial grass in the driveway or large open area away from installation site. Slightly overmeasure being cautious to not cut too short.
- ▶ If artificial grass is being installed over concrete, a glue-down method may be used and no base is required.
- ▶ Place cut artificial grass on the completed base in install location before you make any other cuts.
- ▶ The final detail cuts are made after artificial grass is nailed in place. Always cut artificial grass from the back side.
- ▶ Using landscape spikes, nail one end of the artificial grass section, tightly pulling other end in place. If artificial grass section is large, you can kick the artificial grass forward using your feet, this helps tighten the artificial grass into place. Nail the other end into base. All artificial grass edges should be secured with spikes every 8" to 12", nailing through the artificial grass and into the base. Be careful not to crimp the artificial grass fibers under the spike heads.
- ▶ Perform final detail cuts and nail into base.

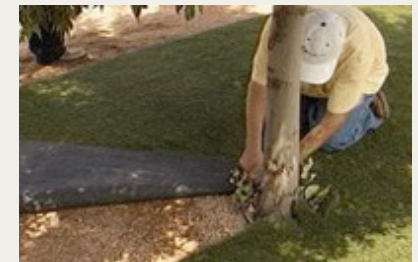

Carpet Knife
Loop Pile Cutter
Hammer
Artificial Grass
Landscape Spikes



TOOLS &
MATERIALS



PROGRASS®
SYNTHETIC GRASS

prograssturf.com
866-268-6100
service@prograssturf.com
#45036

ARTIFICIAL GRASS SEAMING



TOOLS &
MATERIALS

Trowel
Seam Cloth
Adhesive
Landscape Spikes

NOTE

Be sure to smooth out the rolls of artificial grass before seaming.

- ▶ With the artificial grass sections side by side, make sure all of the rows are aligned in the same direction.
- ▶ Try to maintain equal spacing between the fiber rows.
- ▶ Nail each side of the artificial grass into the base, staggering the landscape spikes every 8"- 12" apart.
- ▶ Use seam cloth to connect the artificial grass sections together. Use adhesive and spread with a **trowel** onto the seam cloth and carefully lay the artificial grass over onto the seam cloth. The seam will need time to dry or cure based on recommended curing times located on the adhesive label. Adding weight like bags of sand on the seams helps create a better bond.
- ▶ Take your time on the seams. The more time and attention you give to details on the seams, the better they will turn out.



<https://youtu.be/iLVslCH07W8> watch the Artificial Grass Prep & Seaming video!





prograssturf.com
866-268-6100
service@prograssturf.com
#45036

FINAL STEPS



TOOLS & MATERIALS

Power Broom
Drop Seed Spreader
Water Hose
Rake
Infill

NOTE

Be sure your levels of sand are consistent throughout.

- ▶ After your artificial grass is installed and secured to the base, we recommend adding a layer of infill onto the artificial grass fibers. Use a **drop seed spreader** to evenly disperse sand. Be sure to use a **power broom** or rake to disperse the sand into the artificial grass so it migrates to the primary backing. We recommend about 1 ½ - 2 ½ lbs. of sand per sq.ft., depending on the application and the product. The sand acts as ballast and helps protect from UV rays.
- ▶ With each layer of sand, the artificial grass needs to be vigorously brushed using a **power broom** or rake. The sand will help support the fibers to stand upright. The artificial grass should be brushed across the fibers.
- ▶ The artificial grass seams should be cross-brushed in both directions. This will make the seams less visible.
- ▶ After installation is complete, the entire area needs to be cleaned. All excess sand or debris should be removed and hauled away. Artificial grass and surrounding concrete should be sprayed down with **water hose**. Your artificial grass is ready to enjoy!



<https://youtu.be/e6MEaklg47g> watch the Trim & Secure video!





PROGRASS
SYNTHETIC GRASS

PROGRASSTURF.COM

866-268-6100

service@prograssturf.com

#45036