

SLIDING SHOWER AND TUB DOOR WITH FIXED PANEL

INSTALLATION INSTRUCTIONS

PLEASE REVIEW THIS ENTIRE MANUAL PRIOR TO INSTALLATION

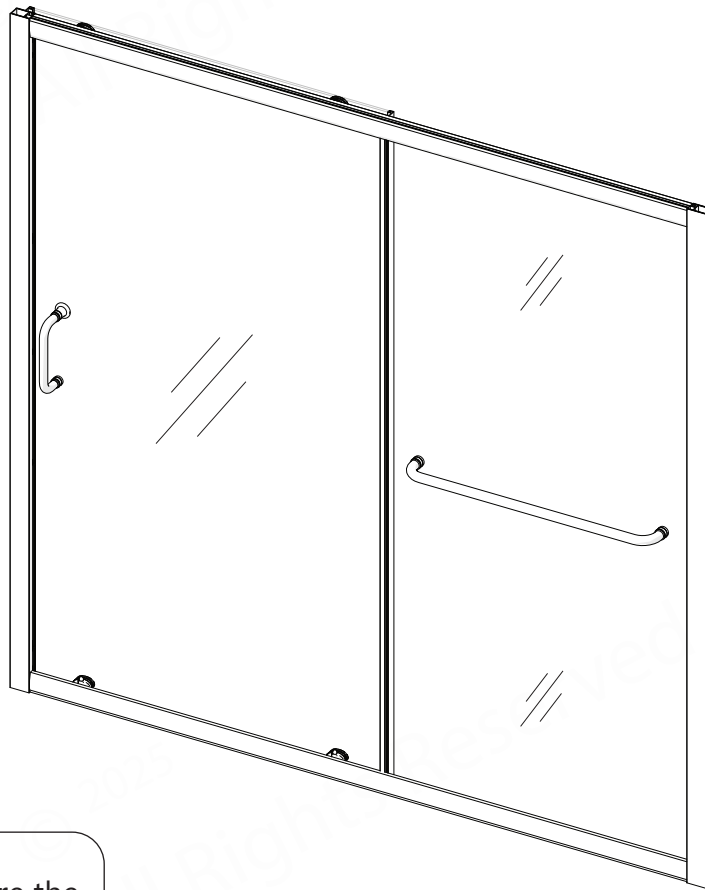

This door is reversible.
Installation instructions are the
same for Tub or Shower height.

Available in:
01 - Chrome
04 - Brushed Nickel
06 - Oil Rubbed Bronze
09 - Matte Black

IMPORTANT!

The manufacturer reserves the right to alter, modify or redesign products at any time without prior notice for the purpose of product improvement and customer experience. Please refer to the manufacturer's web page for the latest technical drawings, installation manuals, warranty information or additional product details.

NOTES

© 2025
All Rights Reserved

© 2025
All Rights Reserved

Record the following purchase information for your records or in the event you need to contact the manufacturer.

Purchase Order
Number _____

Store/Vendor
Purchased From _____

Installation Date _____

OD Number
(optional) _____
*found on the shipping box or label
if available.

Installed By: _____

SKU Number _____

Table of Contents

Section Title	Page #
General Preparations and Warnings	2
Model Specific Preparation	3
Adjustable Wall Profile System	4
Tools	5
Detailed Diagram of Shower Door Components	6
Parts List	7-8
Installation Steps	9-24
Top and Bottom Roller Assembly Installation	16
Decorative Cover with Washer Installation	22
Handle and Vinyl(s) Installation	23
Product Maintenance	25
Troubleshooting	26
Factory Parts Information	27-30

Symbol Legend



TIP - for ease of installation.



CORRECT - recommended.



NOTE - take note of special feature; additional information.



INCORRECT - not recommended.



REQUIRED - requires special attention; signifies a warning.

Average Installation Time

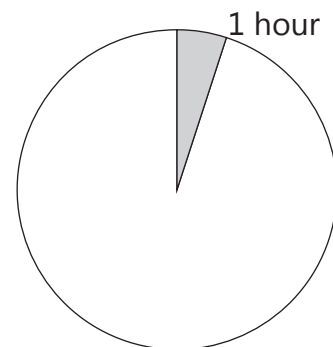

Important Product Information

IMPORTANT

- The manufacturer reserves the right to alter, modify or redesign products any time without prior notice for product improvement and customer experience. Please refer to the manufacturer's web page for the latest technical drawings, installation manuals, warranty information or additional product details.
- This product should be installed by someone familiar with the construction requirements for this type of project and the care necessary for the safe installation and operation of the product.
- The safety of any installation is the responsibility of the installer.
- Professional installation recommended. *(All Models)*
- To prevent damage or serious injury, Do Not lean against the installed panel/door/glass.
- To prevent damage or serious injury: Do Not attempt to lift or move a heavy lite of glass alone. Use an assistant and/or a professional grade glass suction cup.
- The installation of some models may require drilling down into the threshold. Contact the manufacturer of the base, tub, or threshold material with any questions regarding the drilling of holes into their product.
- All drawings in this installation manual are for illustrative purposes only and are not drawn to scale.

TEMPERED GLASS WARNING

- Your Shower Door Glass Could Shatter Without Warning if Improperly Installed or Mishandled
- Do Not install or operate a shower door if the glass has chipped corners, slivered edges or is otherwise damaged and/or has been dropped or banged into a hard surface such as tile, marble or glass.
- The main causes of tempered glass breakage are:**
 - ☐ Improper handling, storage or installation
 - ☐ Misuse/abuse
 - ☐ Lack of maintenance
 - ☐ Failure to replace damaged glass
 - ☐ Improper handling during storage, unpacking and installation:
 - ☐ Corners and edges are the most susceptible area to damage on a lite of tempered glass and should be protected and handled with care during storage, unpacking, installation and operation. A concentrated point of pressure or impact with a surface harder than itself may cause the tempered glass to shatter. The tempered glass may release immediately, within several hours or even days later.
 - ☐ Incorrect installation of door hardware, rollers, hinges, channels, stopper or glass:
 - ☐ Improper installation may include: loose hardware and/or lack of proper gaskets between the hardware and glass. Additionally, improper alignment of guide rails, wall profiles or other hardware during installation or operation may place stress on the glass edges and cause it to break.
 - ☐ This product must be installed by a professional and experienced installer familiar with the safe handling of tempered glass.
 - ☐ Improper use of this product:
 - ☐ Aggressively opening or closing the door may cause trauma to the glass, which can lead to breakage. This may occur immediately or hours or even days later.
 - ☐ **The shower door hardware and glass should be inspected periodically:**
 - ☐ Instruct the homeowner how to perform a periodic inspection of the shower hardware and glass - some minor adjustments may be necessary based upon the use (or misuse) of the shower door. Ensure that the hardware remains tight and that the door alignment and operation are correct. Any adjustments should be made upon discovery to prevent damage to the product.
 - ☐ Additional considerations should be given to the installation of frameless tempered glass products in households with young children or an elderly person due to an increased chance of improper handling. In such cases, alternatives such as shower curtains or grab bars should be considered.

GENERAL PREPARATION

- After opening all boxes and packages, read this introduction carefully. Check that all the items are included in the package by marking off the components on the **"Detailed Diagram of Product Components"** page. Examine all boxes and packages for shipping damage. If the unit has been damaged, has a finishing defect, or is missing parts; please contact our Customer Support department within 3 business days of the delivery date. **Please note that the manufacturer will not replace any damaged products or missing parts free of charge after 3 business days or if the product has been installed.** Please contact the manufacturer if you have any questions.
- Please note that you should refer to your local building codes with questions on installation compliance standards. Building and plumbing codes may vary by location, and the manufacturer is not responsible for code compliance standards project and will not accept any returns.
- If this unit is going to be installed in a new construction, install all the required plumbing and drainage before installing the shower. Use a competent and licensed (if required by local code) plumber for all plumbing installation.
- Make sure that prior to beginning the installation, the surfaces are leveled and solid and will be able to support the total weight of the unit. Also make sure the walls are at right angles. Irregular installation surface level, radius corners or improper angle of side walls will result in serious problems for your installation. Please note that some adjustments and drilling will be necessary during the installation process.
- Protect all primary surfaces of the product during installation. Never set your glass down directly onto a tile floor. Leave corner protectors in place until it is necessary to remove them. Always use a piece of wood or cardboard to protect the bottom edge and corners of the glass prior to and during installation.
- This unit must be installed upon a finished threshold and against finished walls.
- These shower doors are not designed to be installed into a fiberglass surround due to the radius corners and lack of a solid surface to mount the hardware.*

WARNING: TO AVOID THE RISK OF DAMAGE OR INJURY:

- Follow all recommendations and requirements as shown in the installation instructions.
- Perform a thorough inspection of the glass and all parts for any damage prior to installation. Any damage to tempered glass can cause breakage. **Do Not install damaged glass!**
- Do Not install or operate a shower or tub door if the glass has chipped corners, slivered edges or is otherwise damaged. Do Not install or operate a shower or tub door that has been dropped or banged into a hard surface such as tile, marble or glass.
- CAUTION: Contact with any hard surface can damage tempered glass and cause it to shatter.
- This product uses tempered glass. Glass cannot be cut after it has been tempered. Do Not attempt to cut tempered glass.
- Glass Shower doors, Tub doors, Inline panels, and Return panels can shatter due to improper handling or lack of maintenance. Conduct periodic inspections of glass and all parts for possible damage, missing or loose parts.
- Always wear proper safety equipment such as: safety goggles, work gloves and appropriate footwear during the installation process.
- WARNING: Risk of leakage and/or damage: follow all instructions regarding the application of silicone sealant or caulk. Allow 24 hours for the sealant to cure before the initial use of the shower or tub product. Follow the silicone manufacturer's recommendations regarding the use of their product.
- Thoroughly read these instructions before installing or using this product.
- Leave this manual for the enduser of the product.



This product should be installed by someone familiar with the construction requirements for this type of project and the care necessary for the safe installation and operation of the product.



Model Specific Preparation



REQUIRED:

1" Out-of-Plumb Adjustment; Verify threshold and walls with a level



Threshold must be level

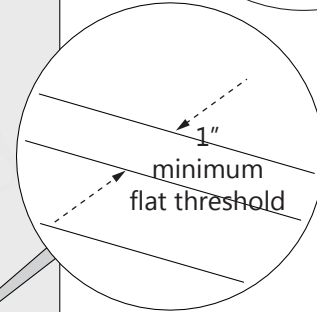
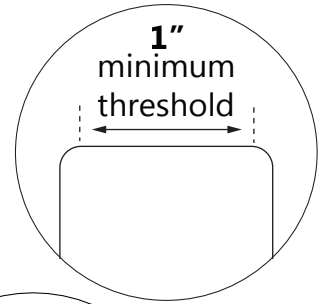
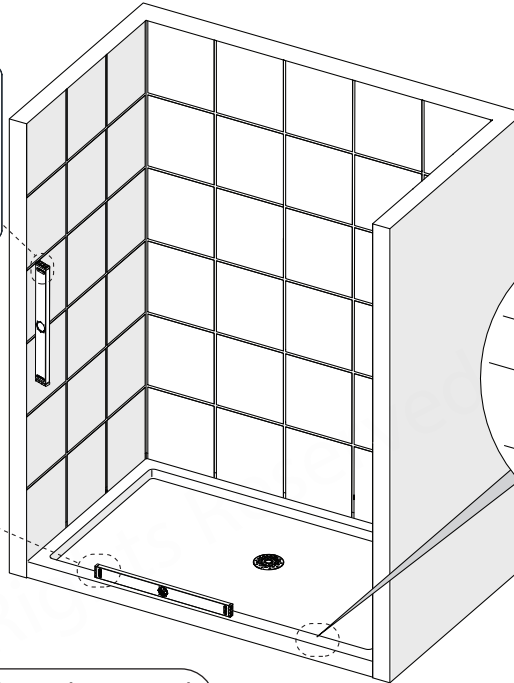
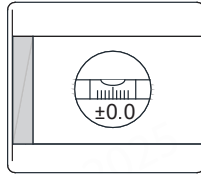
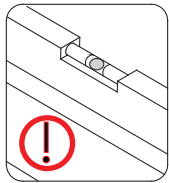

DO NOT attach the handle and/or towel bar to the glass until instructed to do so. **DO NOT** attempt to use the handle/towel bar to lift the glass during installation. This may result in damage to the glass and/or serious injury. Always use a professional grade glass suction cup and an assistant.

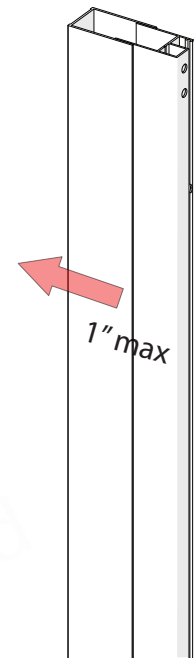

NOTE

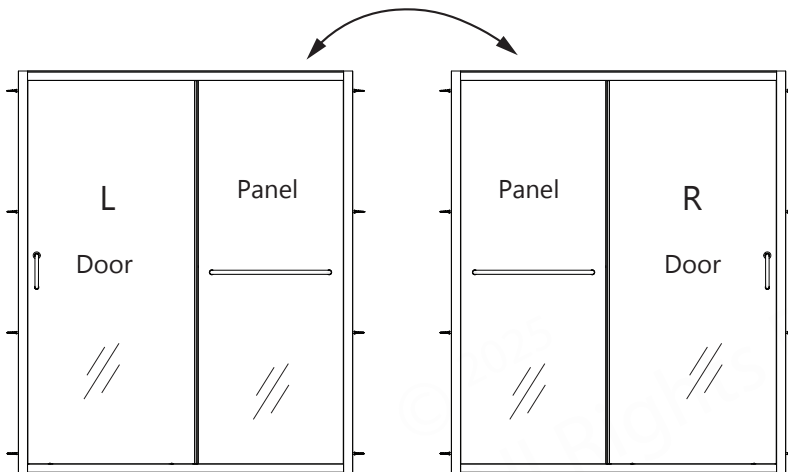

This door is reversible for right or left-hand door installation. The left-hand door installation is shown as an example throughout this manual. For the right-hand door installation, flip the assembly from top to bottom so that the panel is on the right side.

This model's wall profile system allows for up to 1" of adjustment for Out-of-Plumb wall conditions and overall width within the model size when placed into the finished opening. For more information, see the Adjustment Wall Profile System on page 4.

Adjustable Wall Profile System



The Glass Profiles can be adjusted up to 1" within the Wall Profiles for overall width or to correct for out-of-plumb conditions within the model size. Screw them together after making final adjustments.

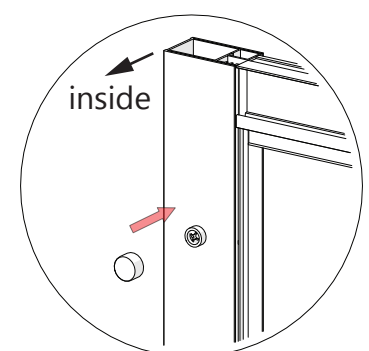
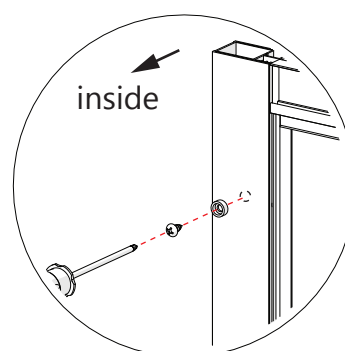
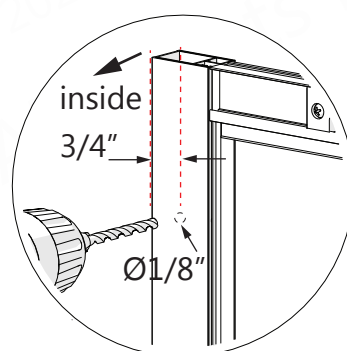
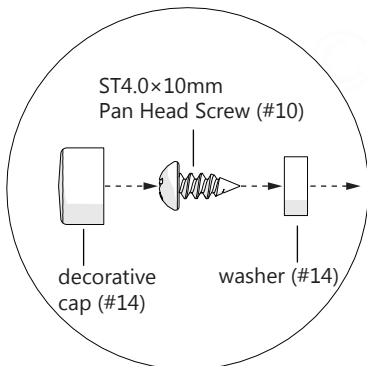
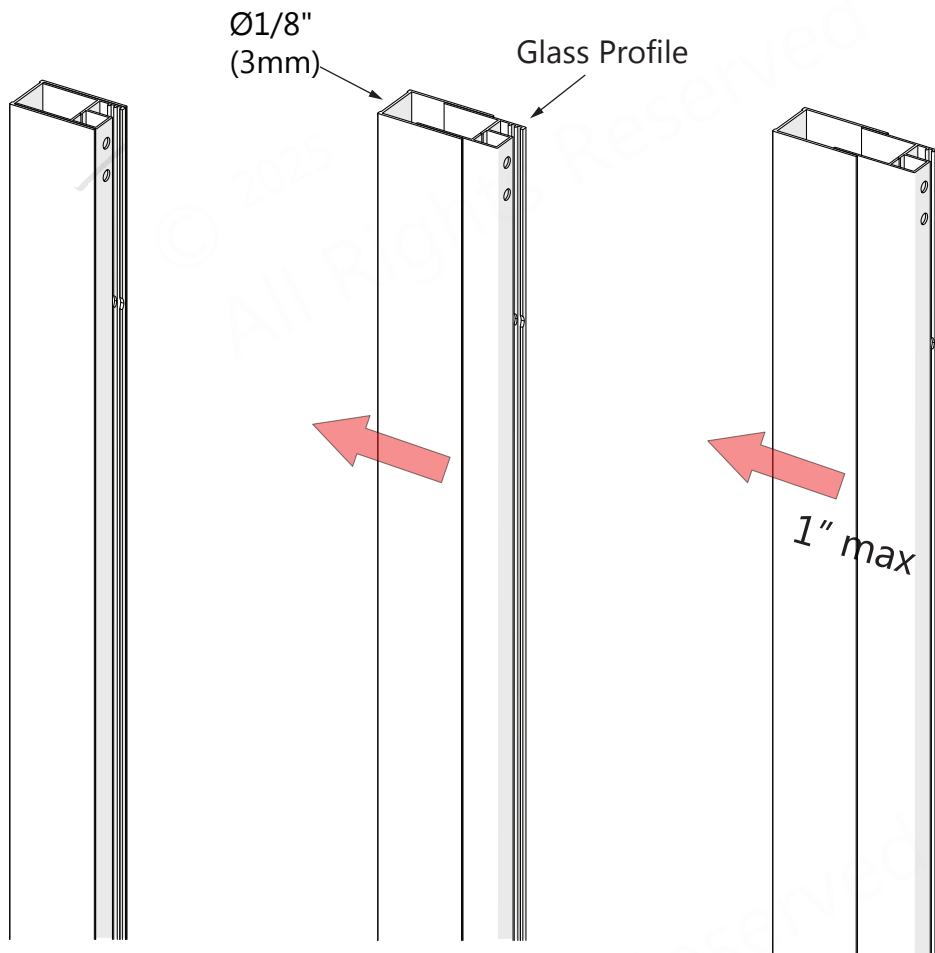
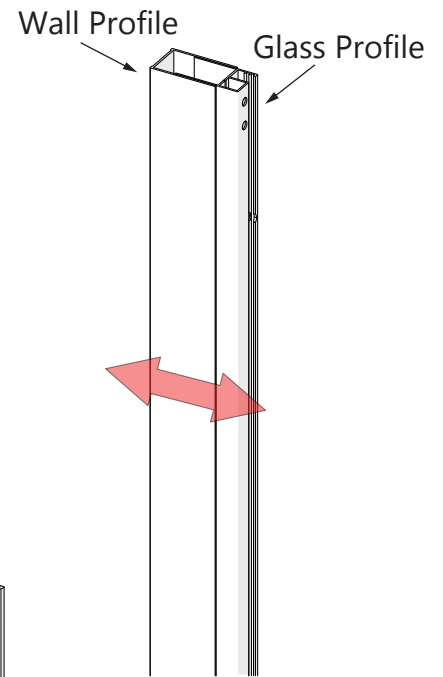

Tools



Level

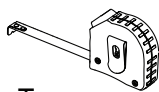

Tape Measure

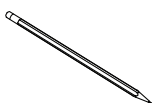

Pencil

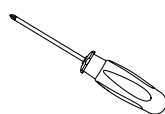

Phillips Screwdriver

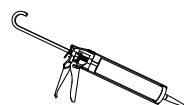

Silicone

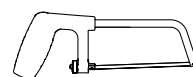

Hacksaw



Drill Bit
Ø5/16"
(8mm)



Drill Bit
Ø3/16"
(4mm)



Drill Bit
Ø1/8"
(3mm)



Screw Gun
or Impact Driver
w/ #2 Phillips bit



Power Drill



Extender
Driver Bit

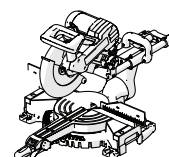

Mitre Saw



Metal File



Soft Head
Hammer



Safety Glasses



Work Gloves

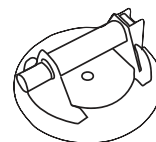

Professional-grade
Glass suction cup



Verify that the correct model size has been ordered; measure the finished opening before proceeding with the installation.

Confirm that the finished walls are plumb and the tub deck is level.

Use a good quality waterproof, mildew-resistant 100% silicone caulk.

Cover the tub drain with tape prior to installation to prevent the loss of screws or small parts.



Unpack your unit carefully and inspect it. Lay it out and identify all parts using the Detailed Diagram on page 6; and packing list in this manual as a reference. Before discarding the carton, check for small hardware bags that may have fallen to the bottom of the box. If any parts are damaged or missing, please contact the manufacturer for replacement. The shipping boxes may contain extra parts not used in your model configuration. Retain these installation instructions for future reference.

Detailed Diagram of Components

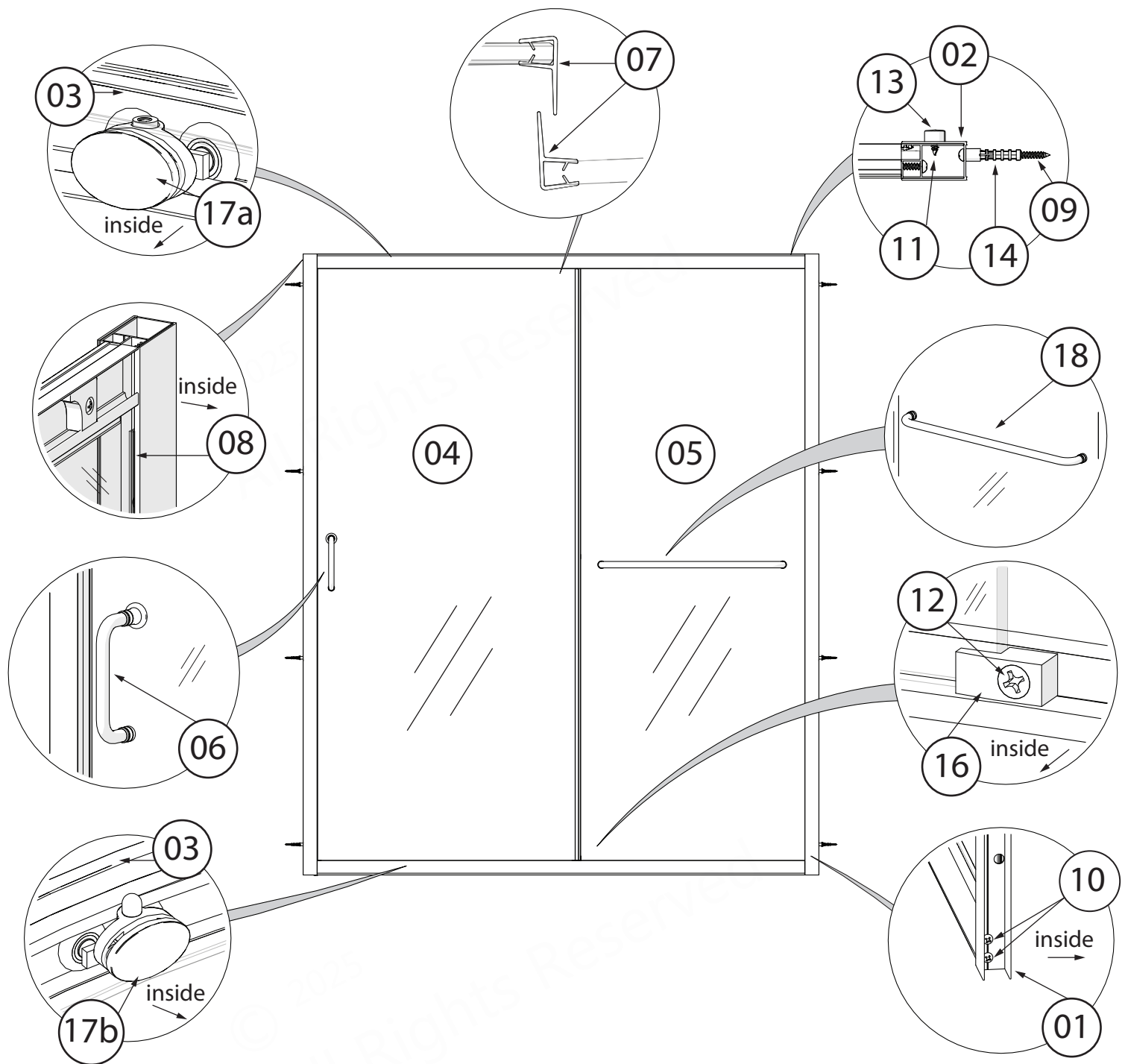

Parts List

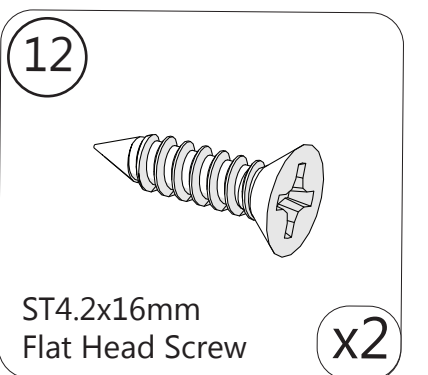
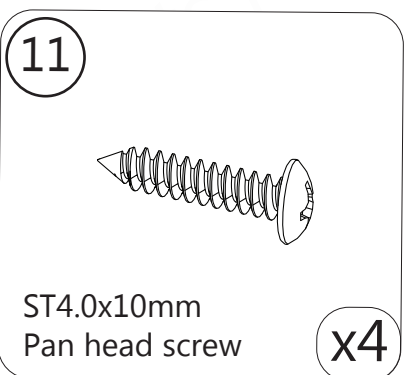
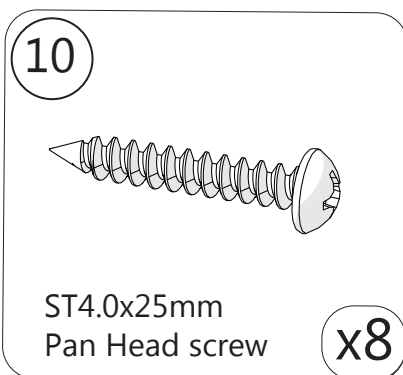
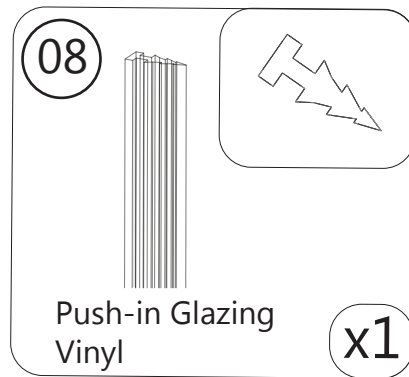
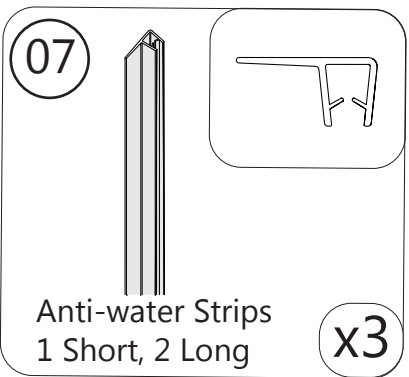
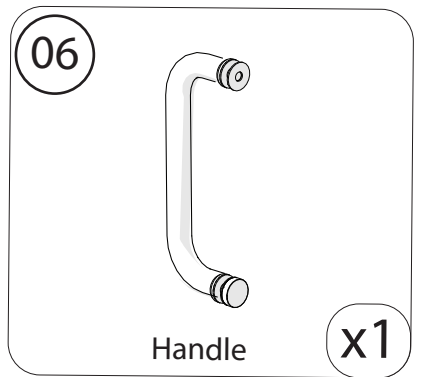
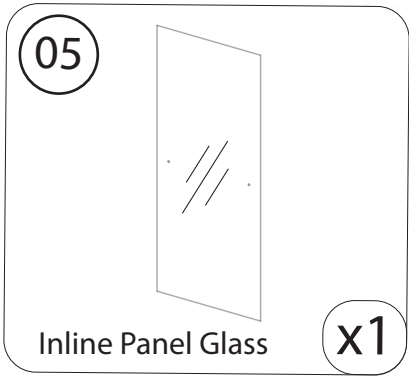
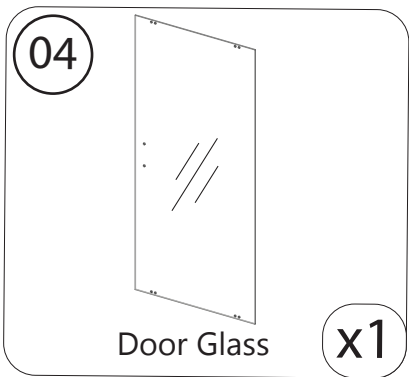
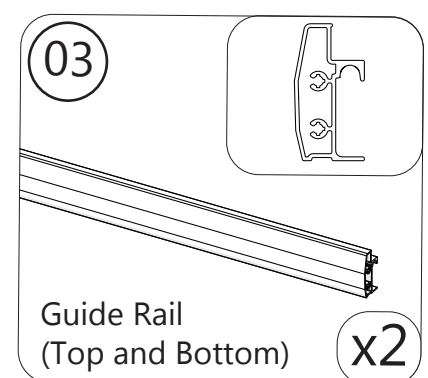
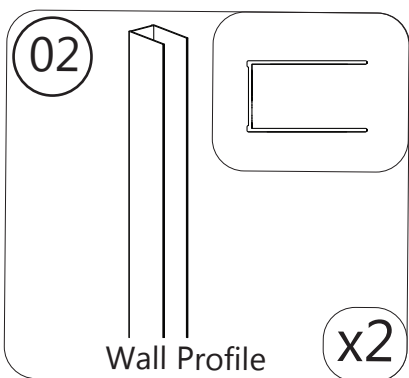
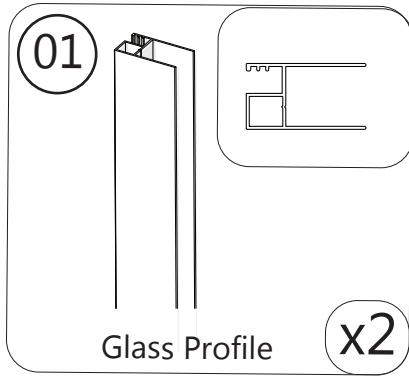

Parts List

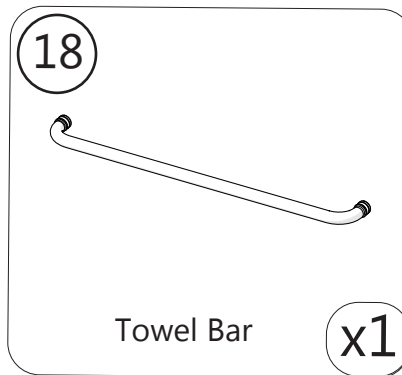
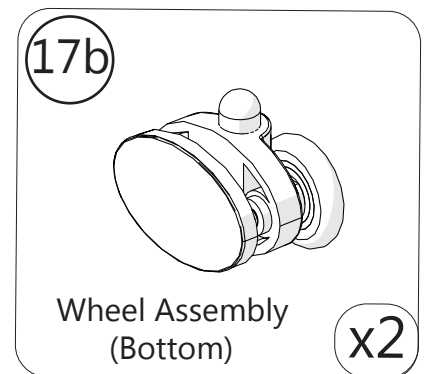
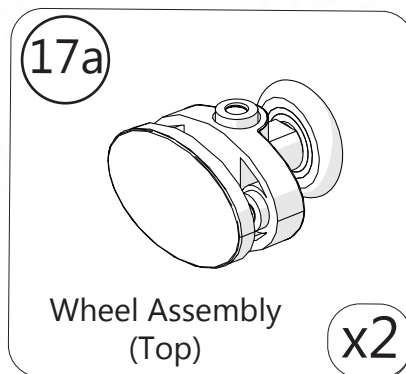
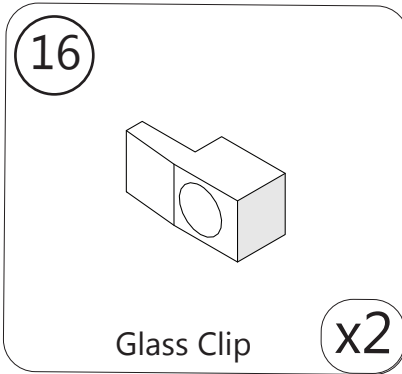
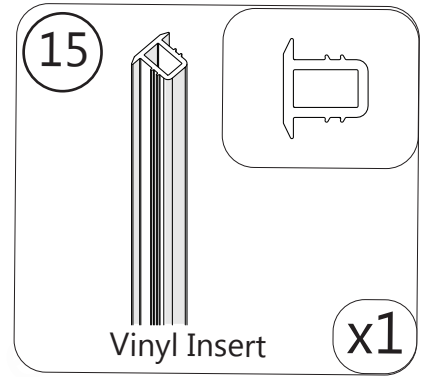
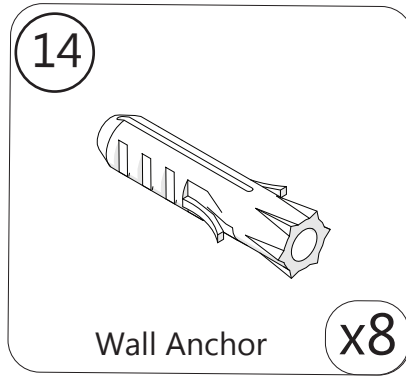
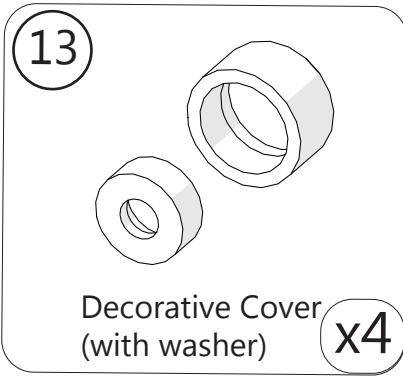

1

Installation Steps

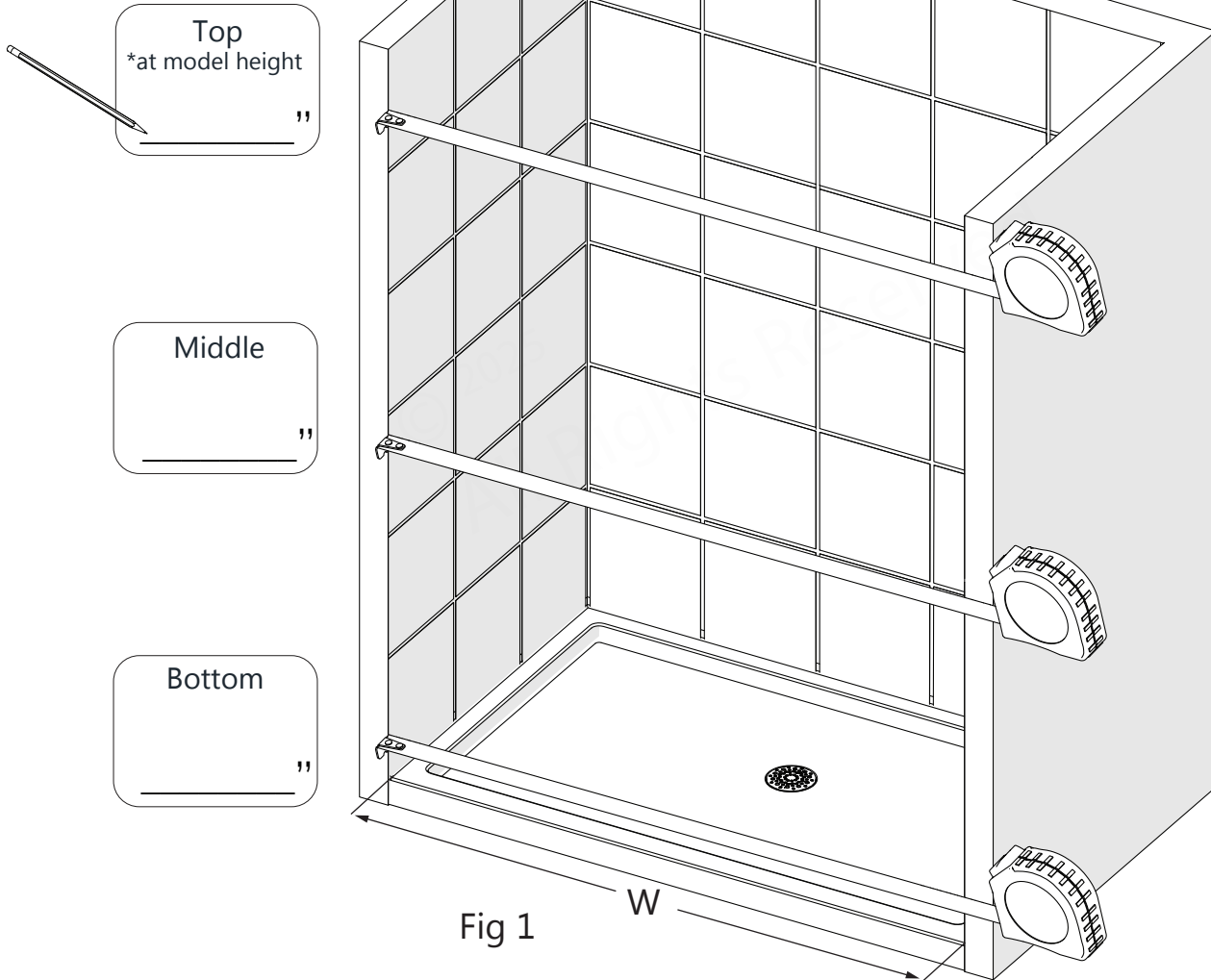

Use the smallest measurement from Fig 1 to determine the finished cut length of the **Guide Rails (#03)**.



The Top and Bottom **Guide Rails (#03)** are shorter than the model size by design. They have been precut for the model width and are designed to fit between the wall profiles, (not wall-to-wall). See Table A below.

Table A

Model Size	Precut Rail Length
48" (for shower)	44-5/8"
54" (for shower)	50-5/8"
60" (for shower)	56-5/8"
60" (for tub)	56-5/8"

Tools Needed

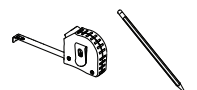

2

$$\text{MODEL SIZE} - \text{Finished Opening Width (W)} = \text{Cut-off Length (C)}$$

*from Table A

*from Door End only



Cut the Top and Bottom **Guide Rails (#03)** from the **Door End only**, (which is the end farthest from the Glass Clip hole) and cut each rail to the same length (D) from the same end.

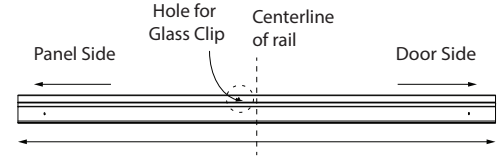

Table B	Distance from the Glass Bracket Hole to the:	
	Panel Side	Door Side
48" model	21-3/8"	23-1/4"
54" model	23-7/8"	26-5/8"
60" model	26-7/8"	29-3/4"

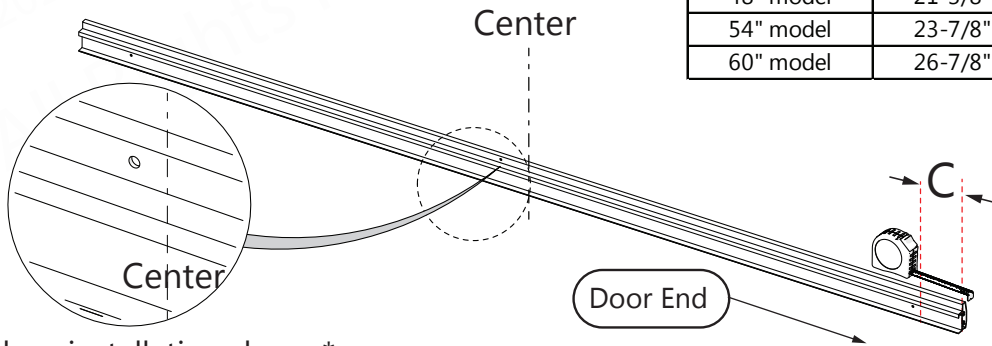

Fig 2a

Left-hand door installation shown*

CUTTING FORMULA: FINISHED OPENING - 3-3/8" = FINISHED CUT LENGTH "D"



DO NOT Cut from the panel end!

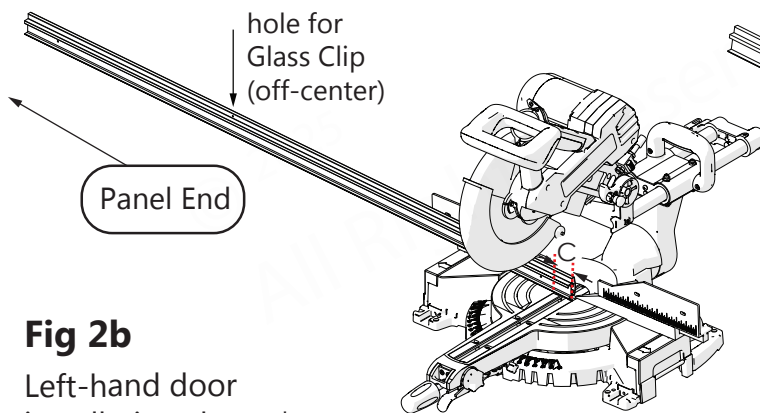

Fig 2b

Left-hand door installation shown*

OR

Glass Bracket Hole (off-center)



Cut From the Door End Only!

Door End

C

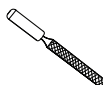
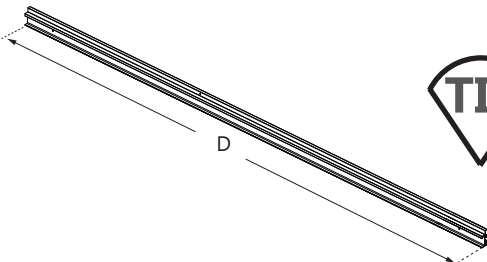

Use a metal file to deburr the cut end

Parts Needed

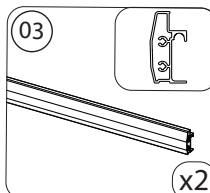

Tools Needed

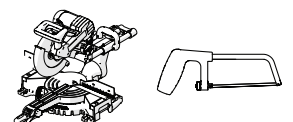

3

Reinstalling the Door-side Bumper

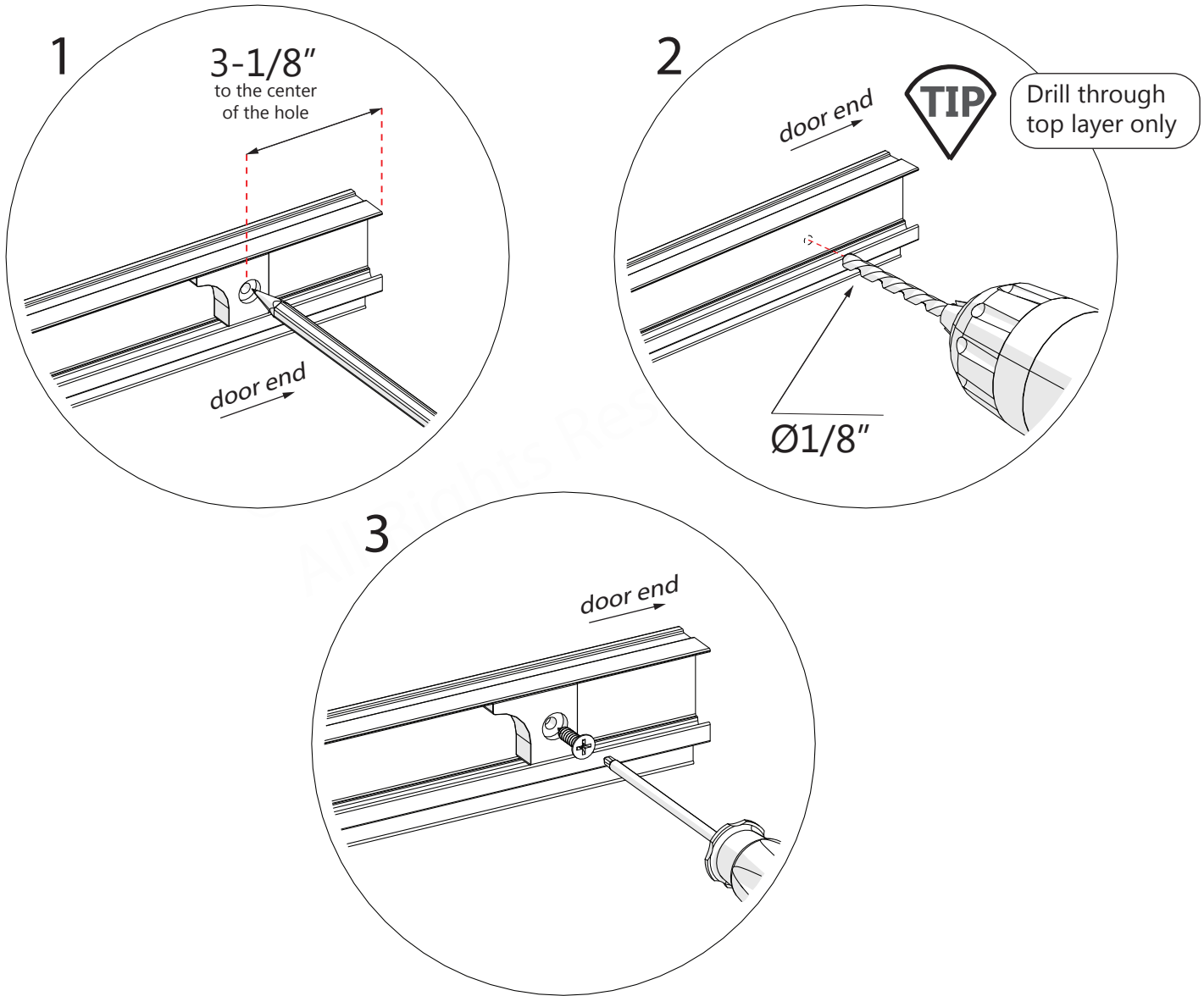
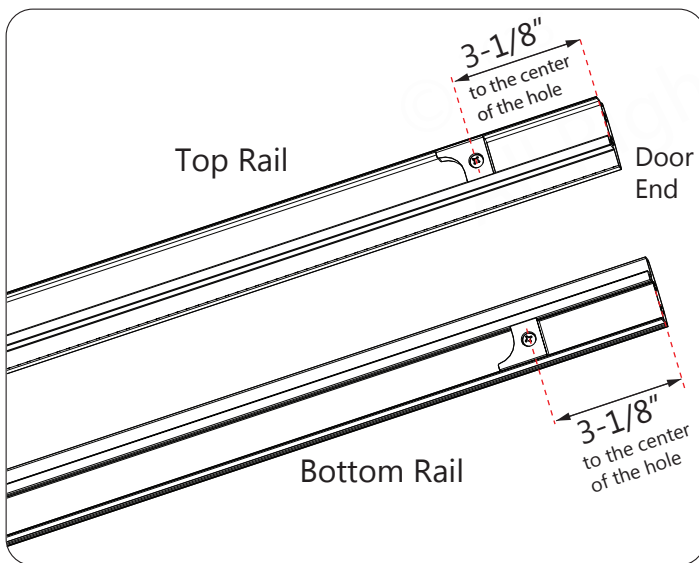
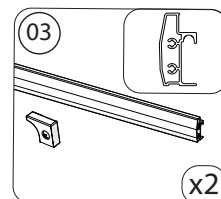

Fig 3



It's necessary to reposition the door-side stoppers in both the Top and Bottom Rails once the door end of the rails have been cut.

Parts Needed



Tools Needed

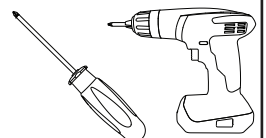

4

Assembling the Frame

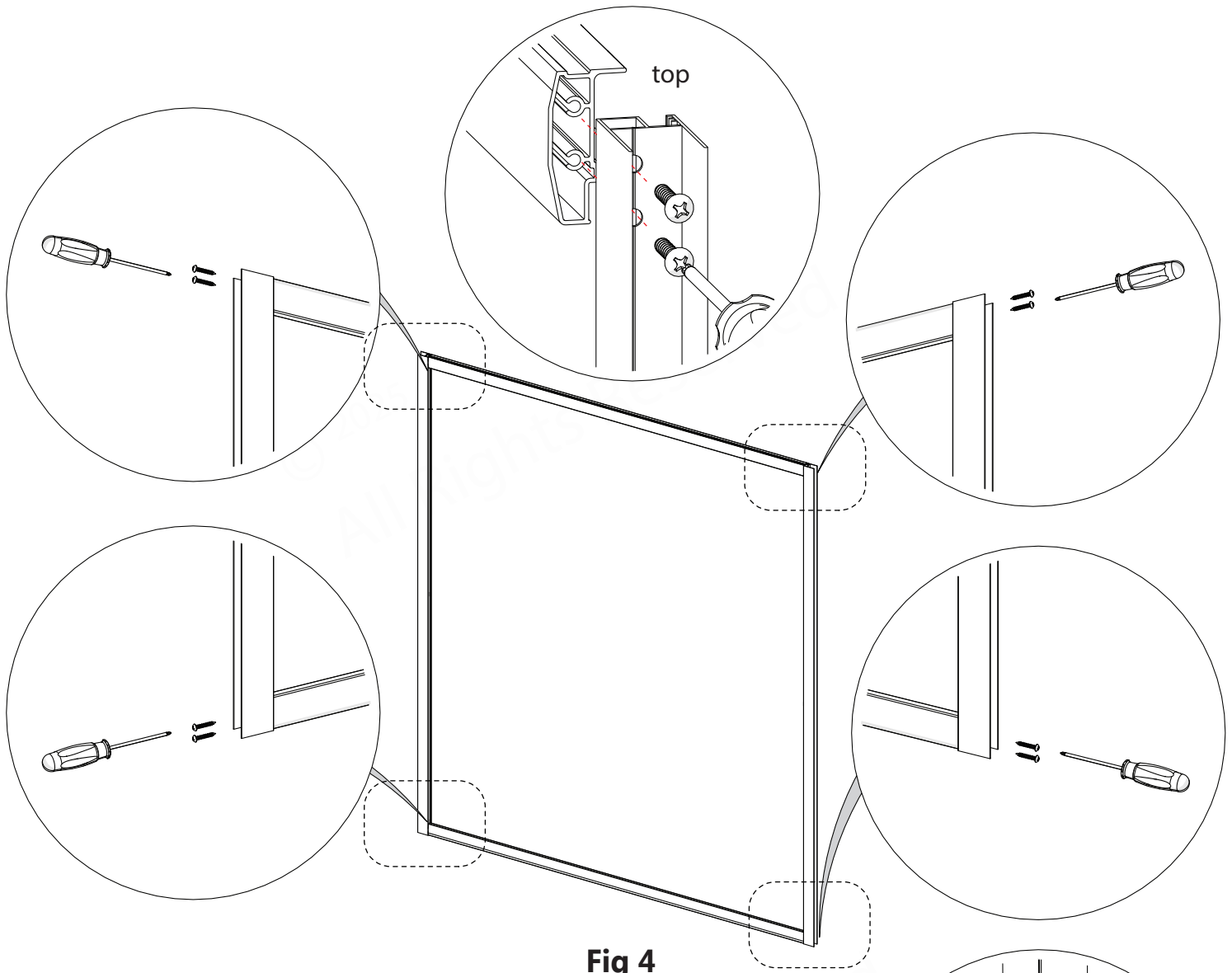
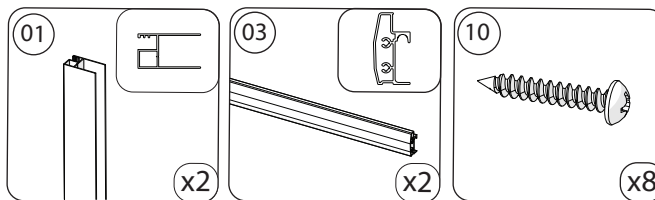

Fig 4



For ease of installation: Add liquid soap, wax, or lubricant to the screws prior to attaching the **Glass Profiles (#01)** to the **Guide Rails (#03)**. Use a low setting on a screw gun to prevent stripping the screws, or use a Phillips screwdriver as shown.

Parts Needed



Tools Needed

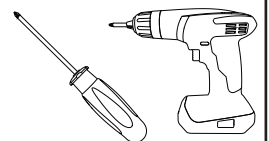

5

Adding the Wall Profiles

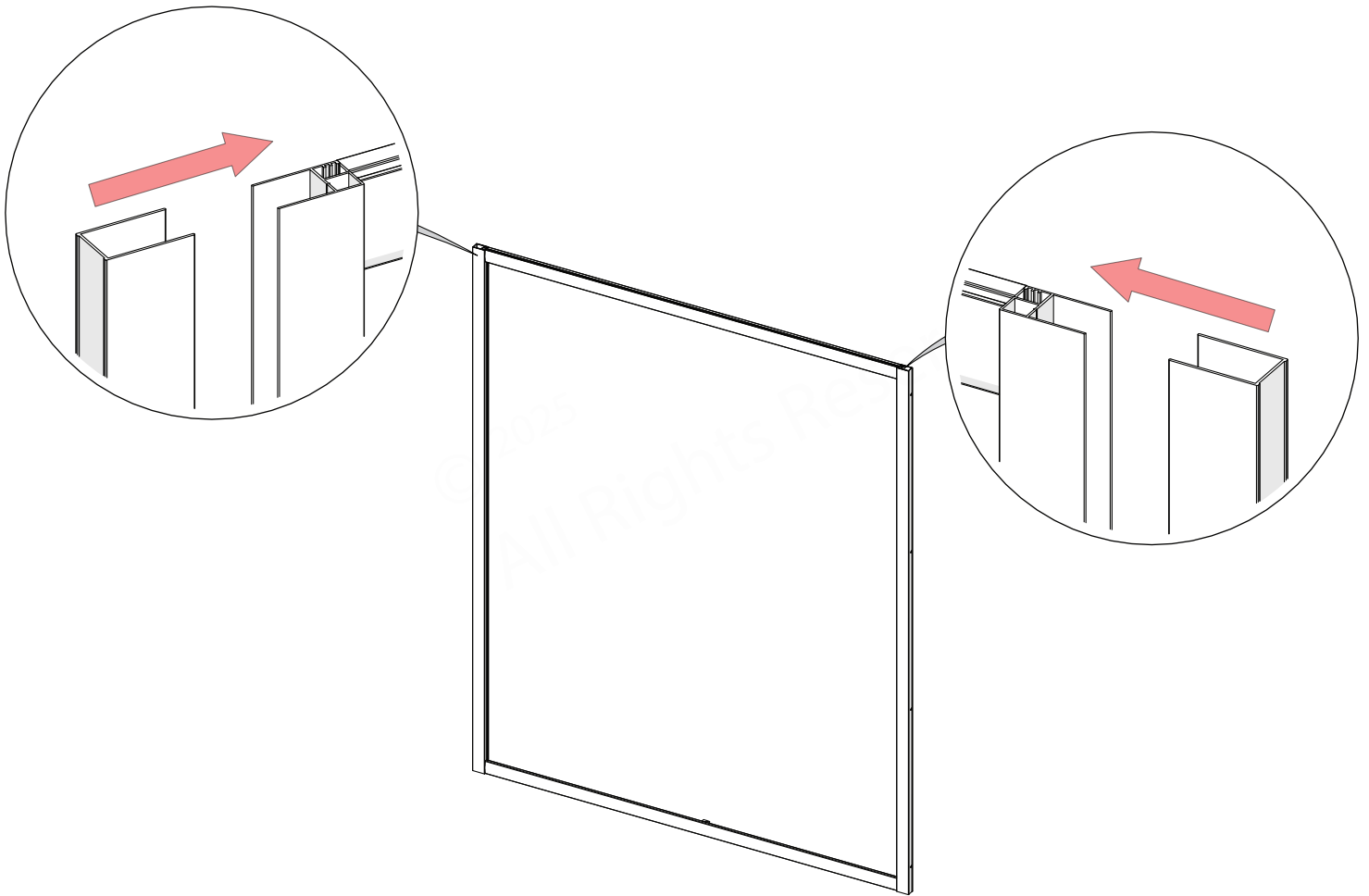
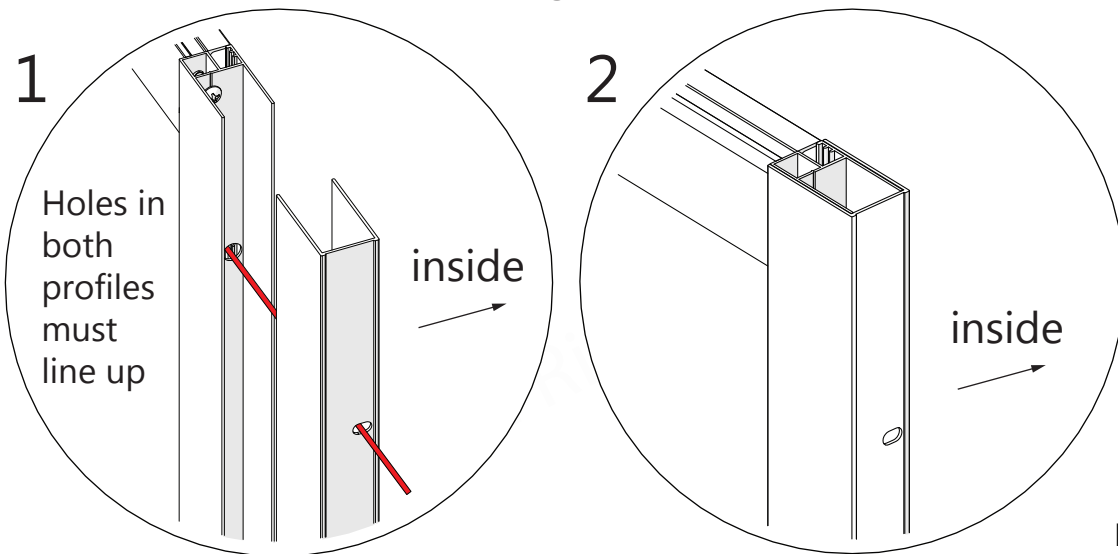
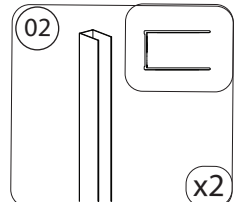

Fig 5



The holes in the **Wall Profiles (#02)** are off-center, and must line up with the corresponding holes in the **Glass Profiles (#01)**.

Parts Needed



6

Positioning the Frame in the Opening

NOTE

Decide on the handing of the door and panel prior to placing the assembly into the opening to mark the holes for drilling. Position the frame assembly so that the **Inline Panel Glass (#06)** as well as the **Door Glass (#04)** will be installed on the desired side of the opening. If needed, refer to Step 2 on Page 10 to identify each side. If the Top and Bottom Rails were cut, that end is the door side. **Fig 6**

1

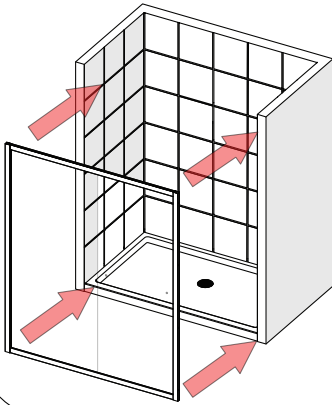

2

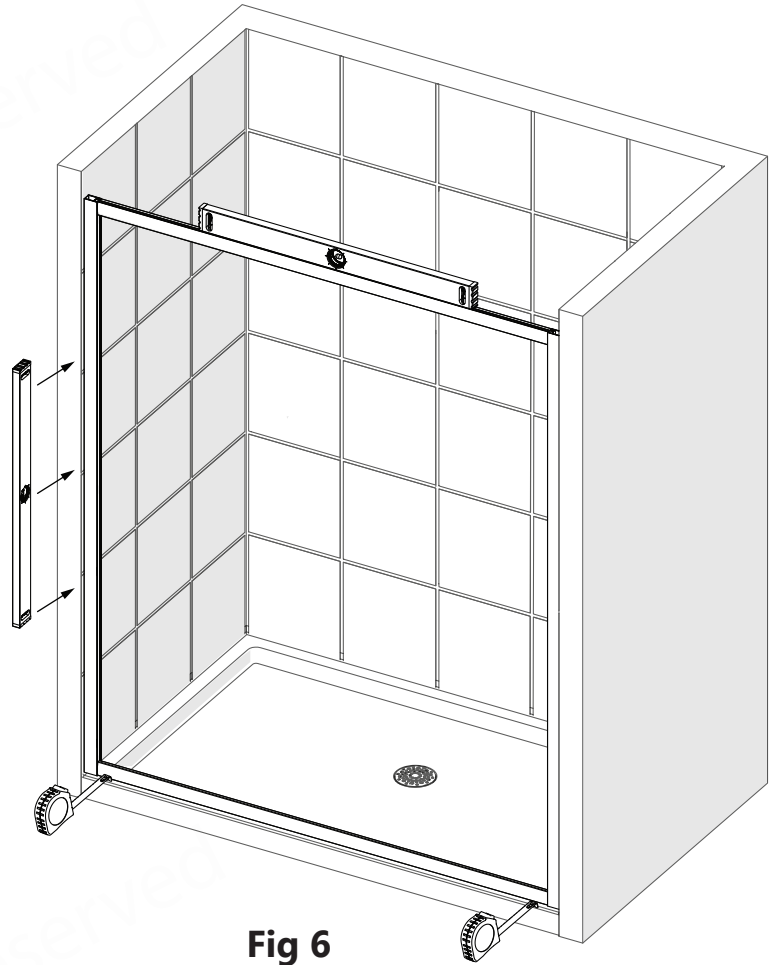
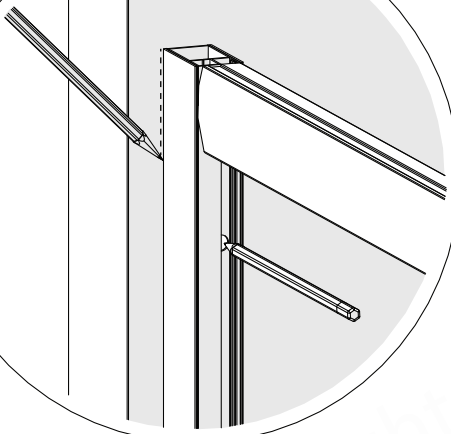
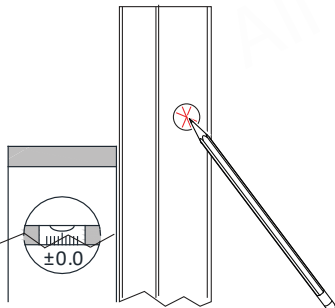

Fig 6

NOTE

Before marking the holes for drilling, confirm the assembled frame is tight to the tub deck, the **Wall Profiles (#02)** are tight to the walls and the frame is level and plumb. Be sure the frame is completely motionless when marking for drilling.



Tools Needed

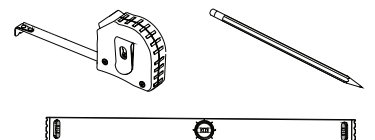

7

Drilling for Frame Installation

1

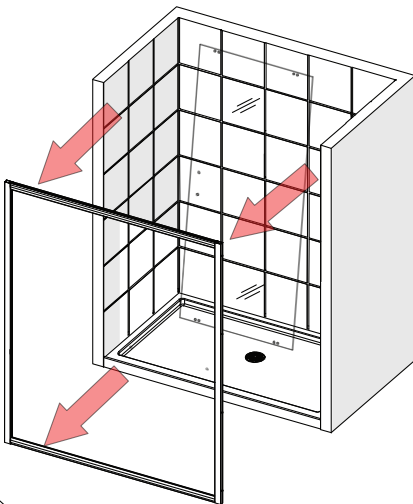

2

Ø3/16"
Drill Bit

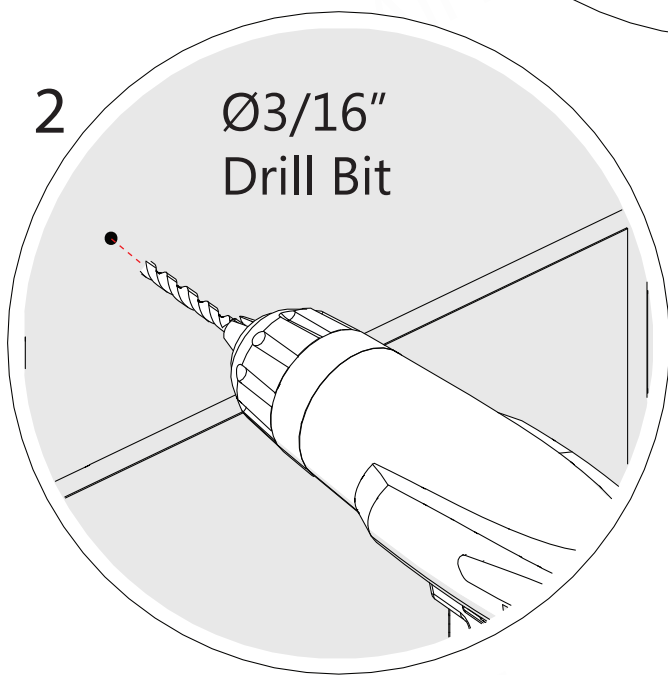

3

*see NOTE

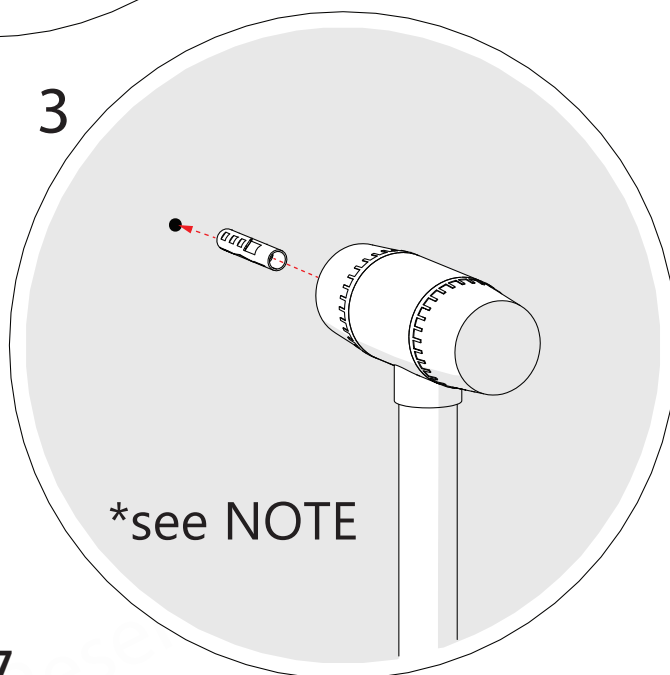
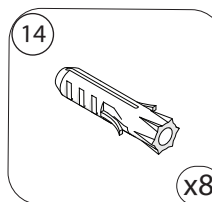

Fig 7

NOTE

If a stud is present behind the wall, drill a hole using a Ø3/16" drill bit and pilot the stud using a Ø1/8" bit. Do not use wall anchors. If no stud is present, drill the hole using a Ø5/16" drill bit and insert **Wall Anchors (#14)** as shown in **Fig 7.3**. Be sure to drill deep enough for the **ST4.0 x 55mm Pan Head Screws (#09)** (See Step 10)

Parts Needed



Tools Needed

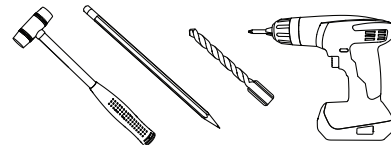

8

Installing the Roller Wheels on the Door Glass

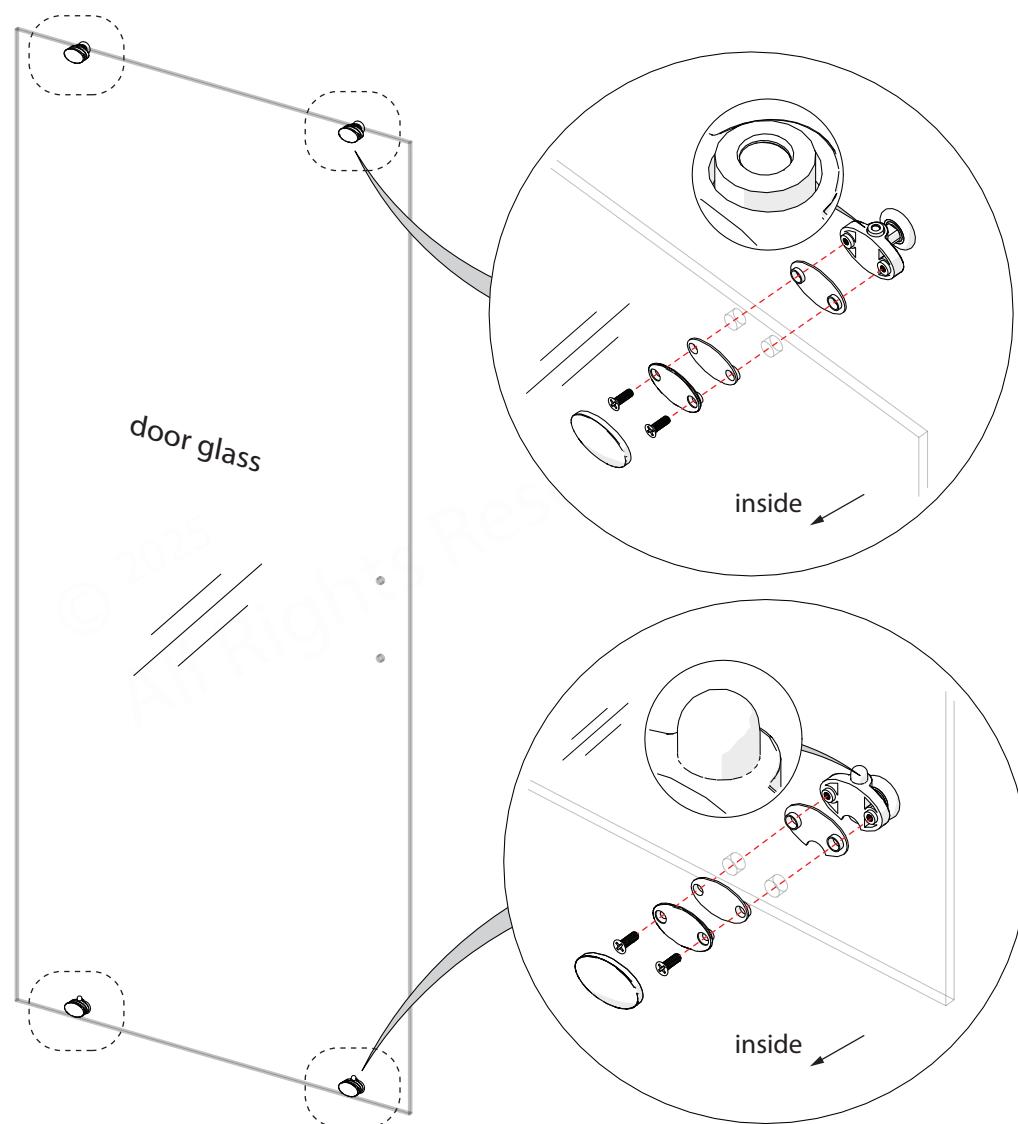

Fig 8

NOTE

*Left-hand door installation shown

The lock nut on the **Top Roller Assembly (#17a)** and the push-button on the **Bottom Roller Assembly (#17b)** should both be installed pointing up. **DO NOT** overtighten the **Roller Assemblies (#17a/17b)**.

Top Wheels

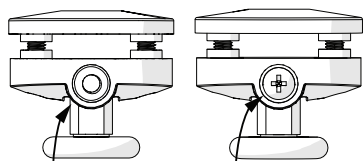

Faces Up

Faces Down

Bottom Wheels

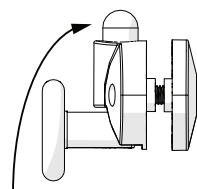

Button faces up

Parts Needed

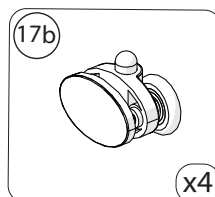
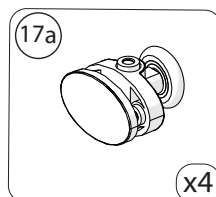
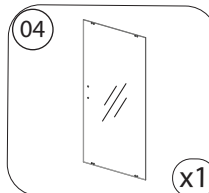

Tools Needed

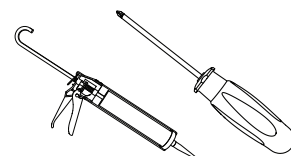

9

Placing the Door Glass in the Opening



Before securing the frame assembly, bring the **Door Glass (#04)** into the tub area and lean it safely against the wall, using padding to protect the glass, walls, and tub surface. Make sure the handle holes on the **Door Glass (#04)** are on the correct side for installation. **Fig 9**

Handle holes on correct side for installation

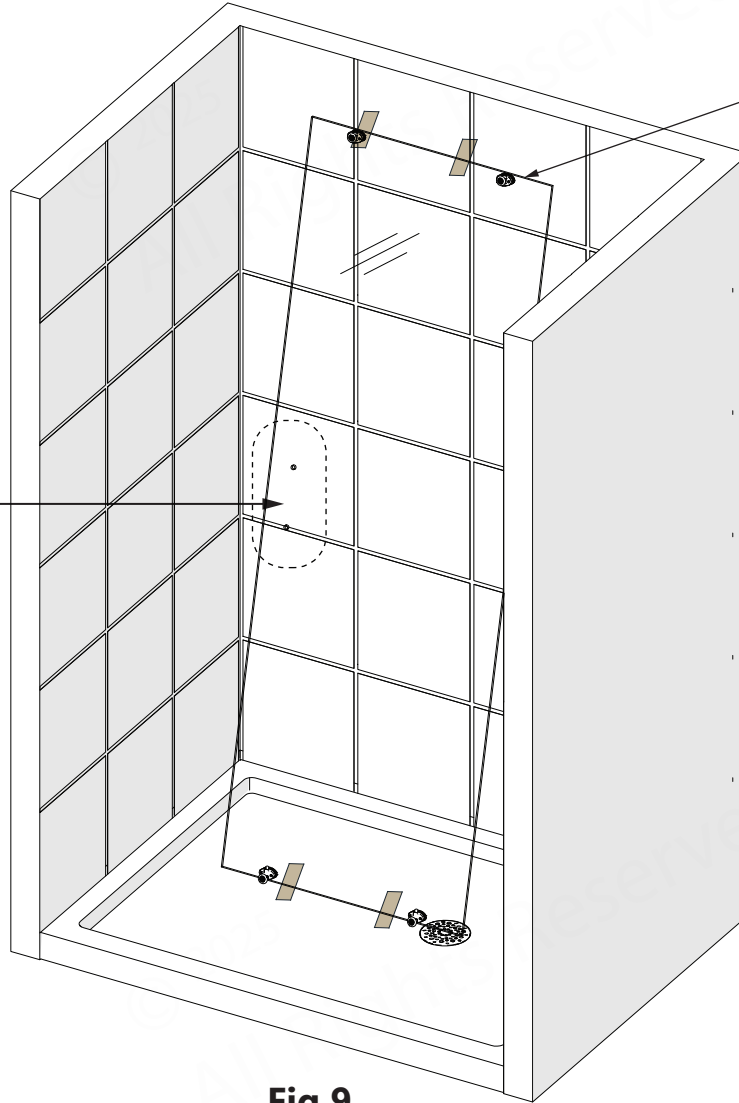

All 4 Roller wheels face forward, toward the outside of the shower

Fig 9



DO NOT install the towel bar or handle onto the glass until instructed to do so. **DO NOT** attempt to lift the glass using the towel bar or handle. This could result in damage to the glass and/or serious personal injury. Always use an assistant or a professional grade suction cup when handling heavy glass.

Parts Needed

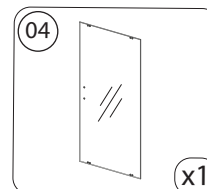

Tools Needed

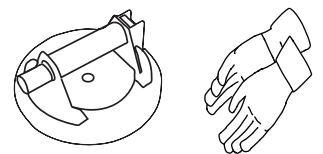

10

Installing the Frame in the Opening

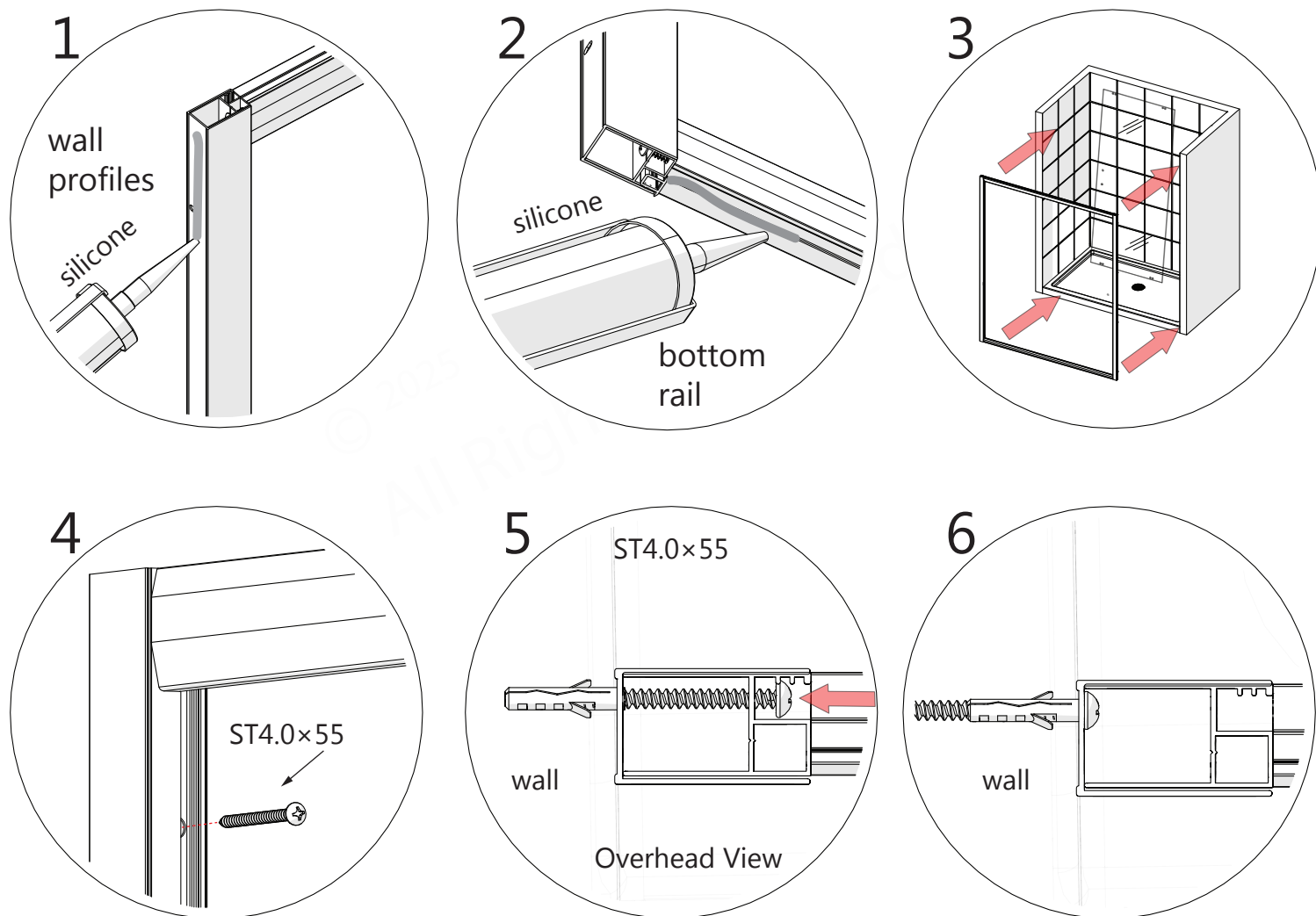
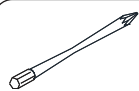

Fig 10

NOTE

The screwheads on the **ST4.0x55 Pan Head Screws (#09)** will pass through the larger holes in the **Glass Profiles (#01)** and then secure the **Wall Profiles (#02)** to each wall.



Extender Driver Bit recommended for the installation of these screws.

Parts Needed

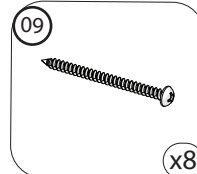

Tools Needed

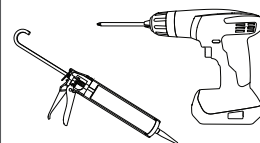

11

Installing the Inline Panel Glass & Towel Bar

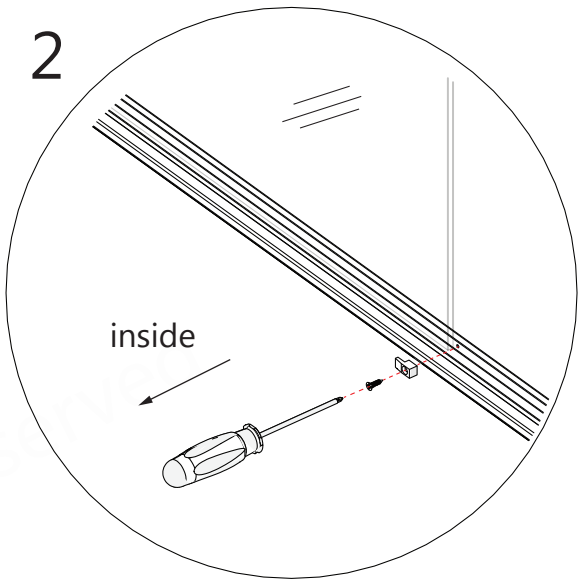
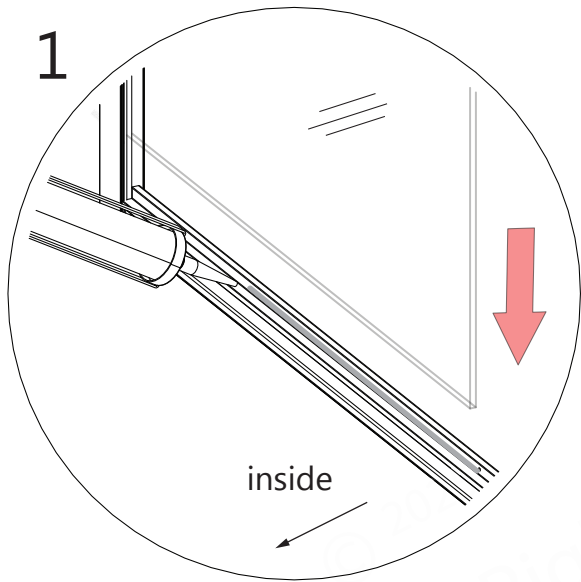

Fig 11a



Use caution when installing the Inline **Panel Glass (#05)** into the frame to prevent damage to the edges of the glass.

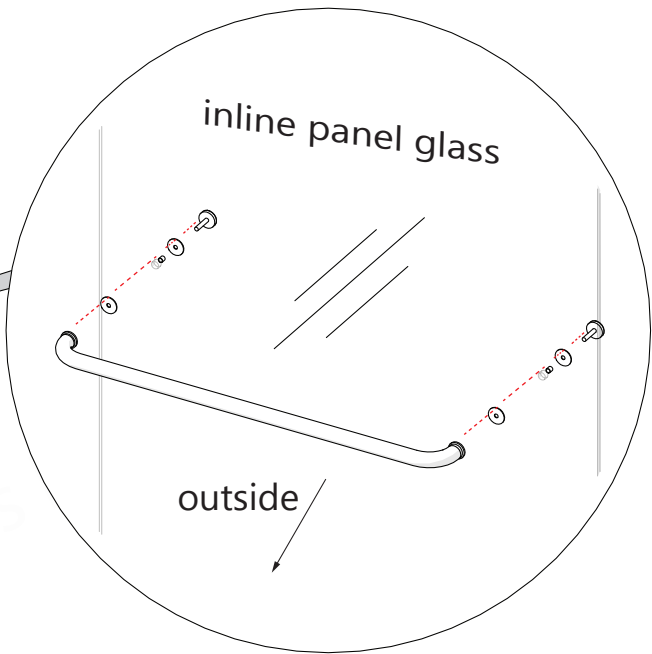
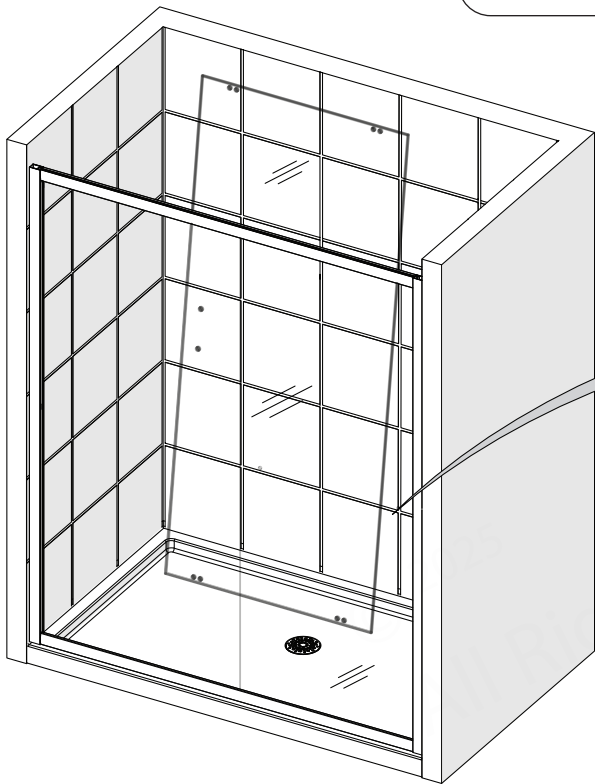
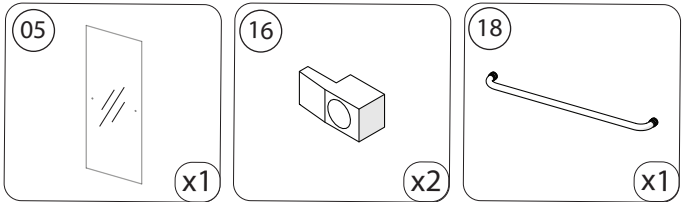
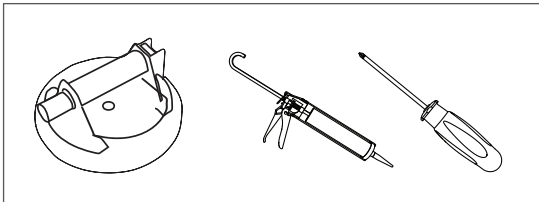

Fig 11b

Parts Needed



Tools Needed



Installing the Push-In Glazing Vinyl

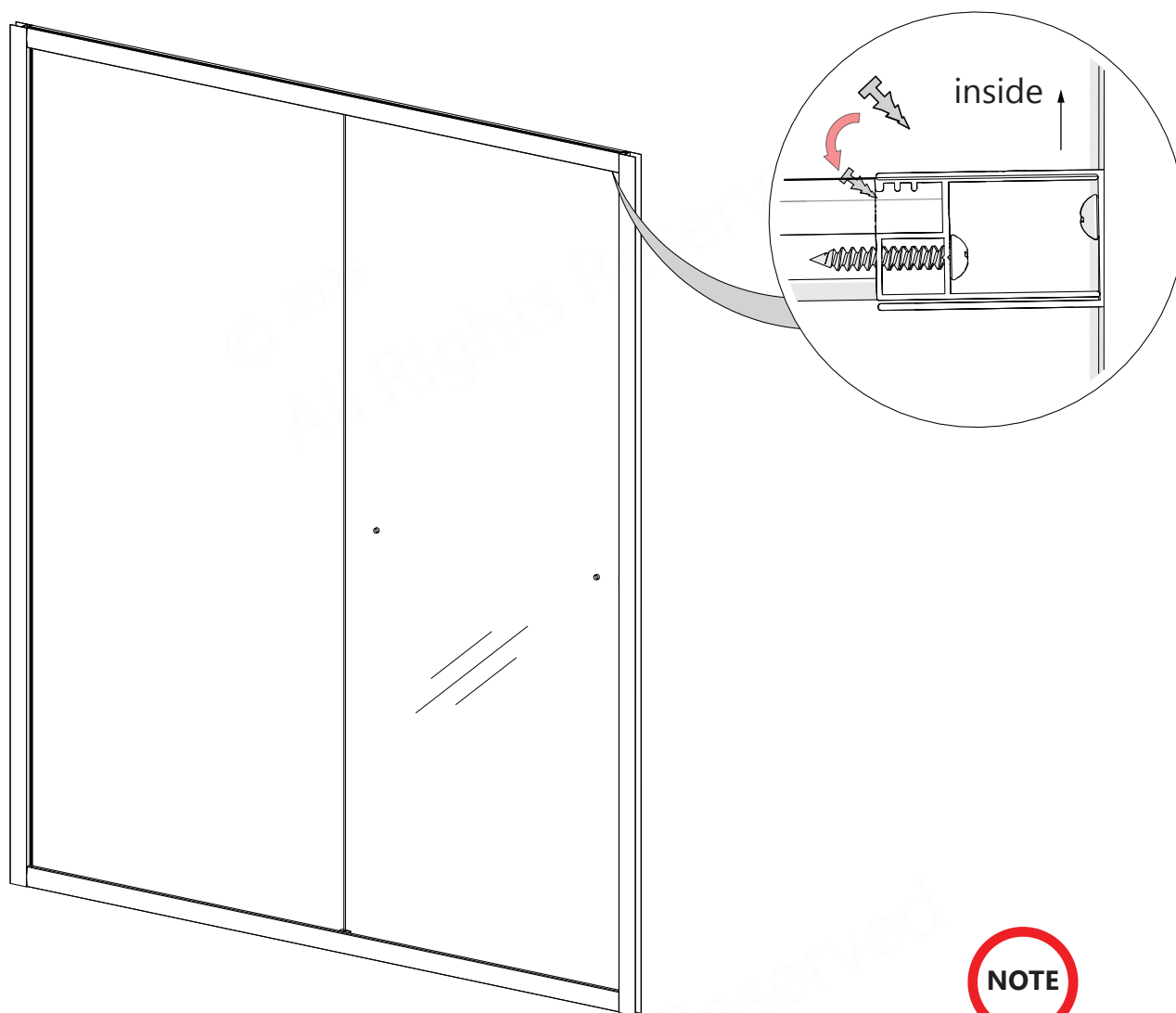

Fig 12

NOTE

A right-hand panel installation is shown as an example. The door is reversible.



To prevent scratching or damaging the glass and aluminum, **DO NOT** use a screwdriver or other metal tool to install the **Push-in Glazing Vinyl (#08)**. Snap it in by hand, or use a plastic putty knife or similar if necessary.

Parts Needed

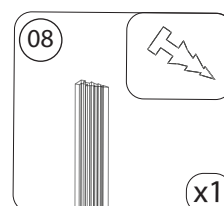

13

Installing the Door Glass

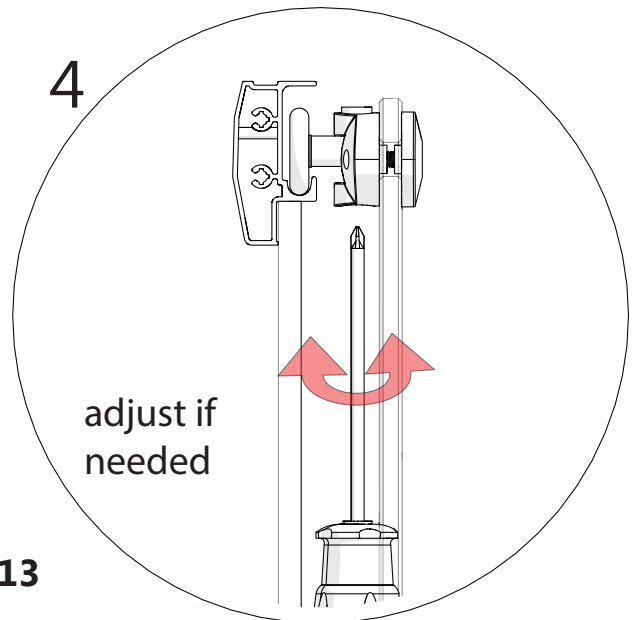
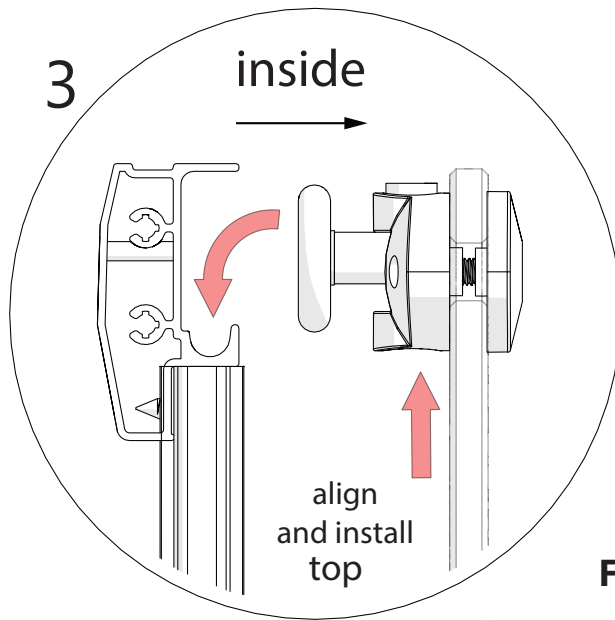
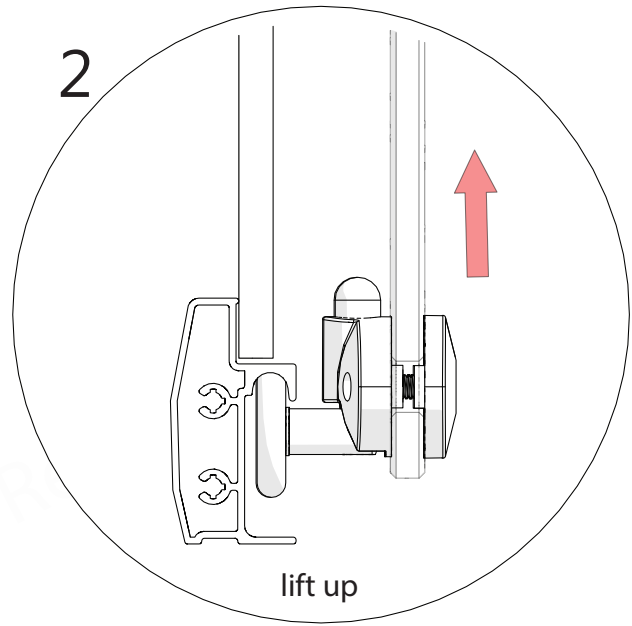
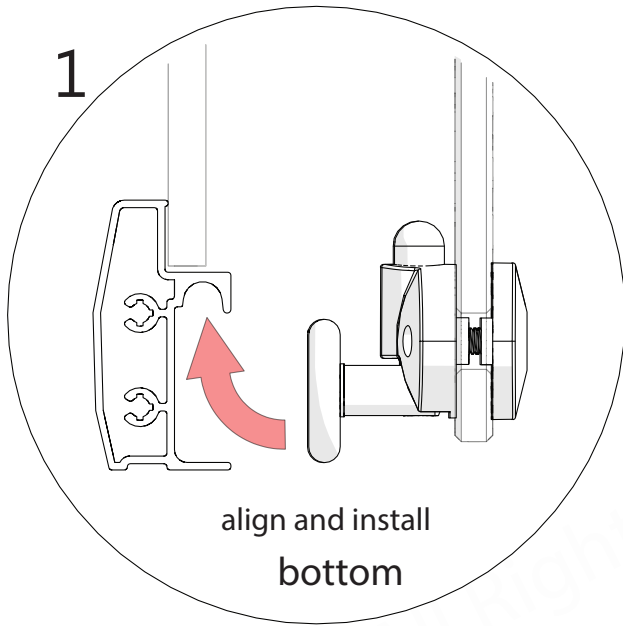

Fig 13

NOTE

If necessary: Adjust the **Top Roller Assemblies (#17a)** for smoother operation.

NOTE

Be sure to center the frame within the Wall Profiles before the next step.

Tools Needed

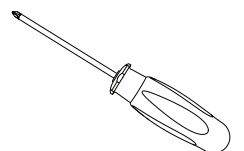

Connecting the Profiles



DO NOT drill the profiles throughout, **ONLY** through the first layer of the **Wall Profile (#02)** and **Glass Profile (#01)**.

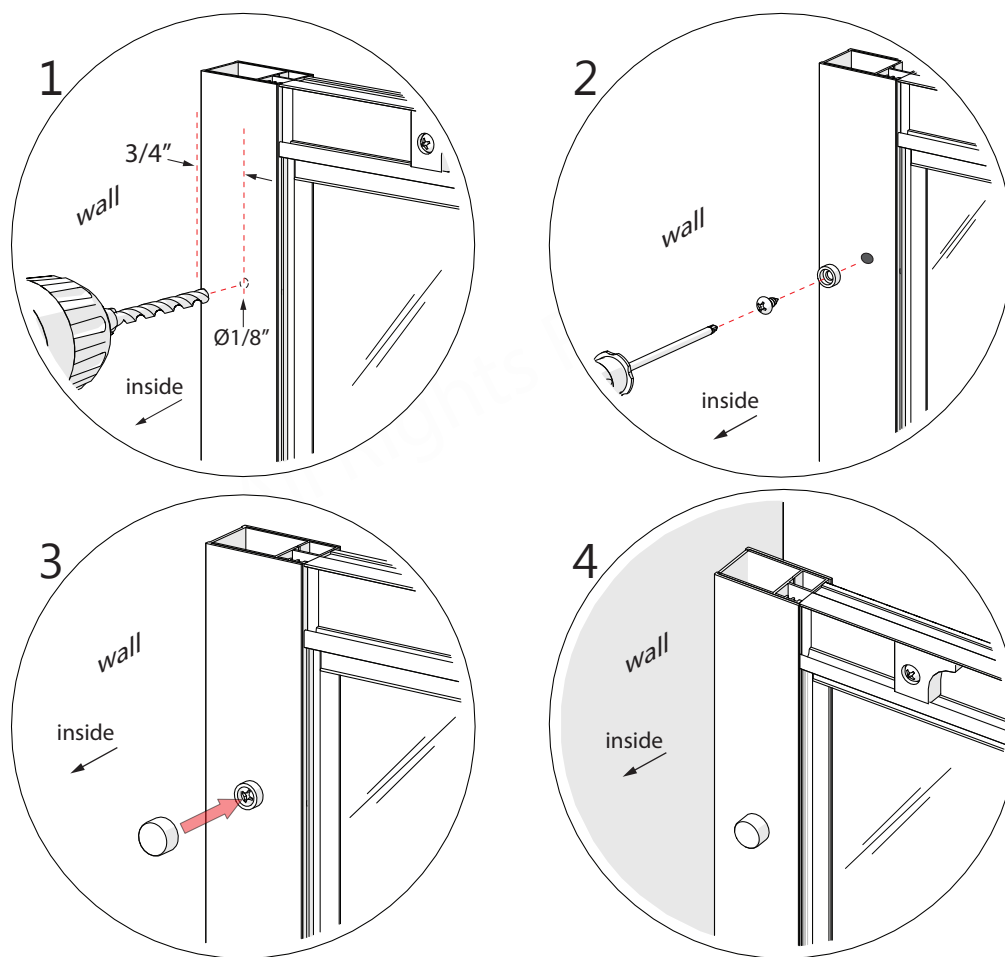

Fig 14

NOTE

Make sure the frame is centered within the Wall Profiles, and that the Bottom Rail is tight to the tub deck before screwing the Wall Profiles and Glass Profiles together.

NOTE

The ST4.0×10mm Pan Head Screws (#11) and Decorative Covers (#13) should be installed in the top and bottom of each profile.

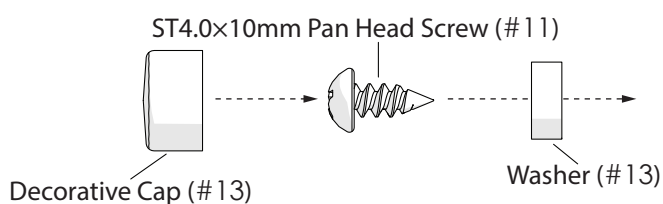

Parts Needed

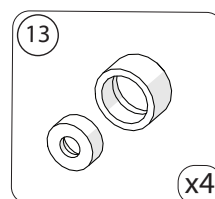
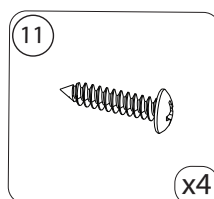

Tools Needed

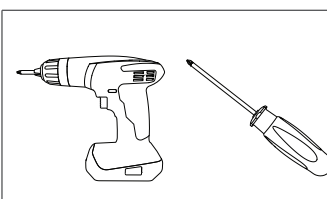

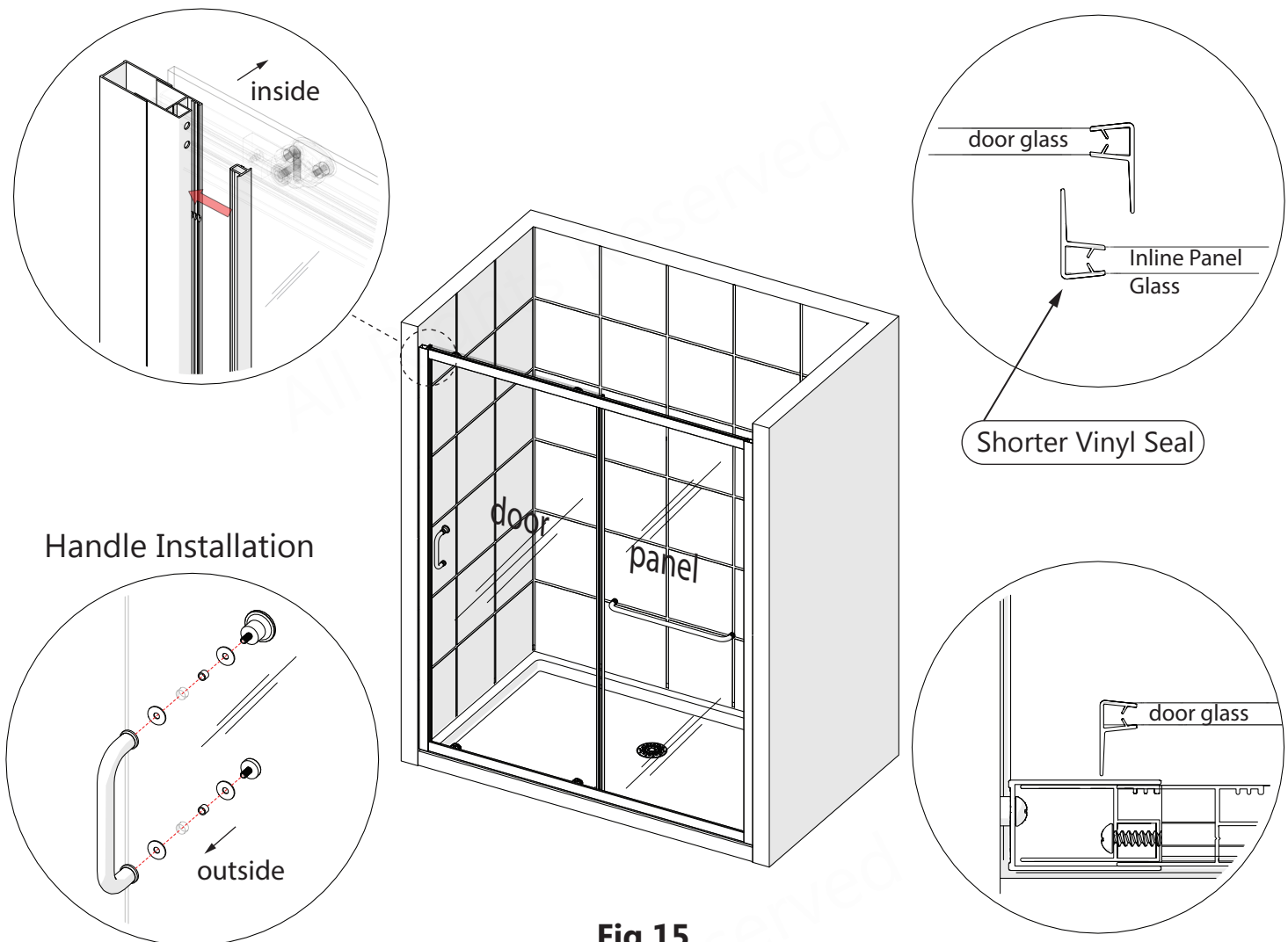

Fig 15

NOTE

The two longer **Vertical Vinyl Seals (#07)** attach to both edges of the **Door Glass (#04)** with the soft fins facing the outside of the shower.

The shorter **Vertical Vinyl Seal (#07)** attaches to the edge of the **Inline Panel Glass (#05)** in the middle of the shower with the soft fin facing inside the shower.

*Left-hand door installation shown as an example. The door is reversible.

Parts Needed

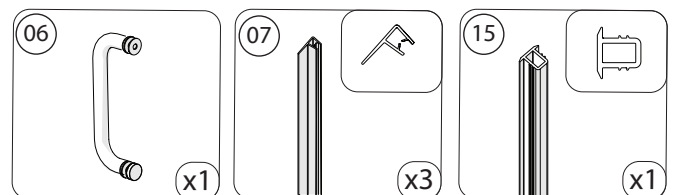

NOTE

The surfaces need to be clean and free of debris before applying silicone.

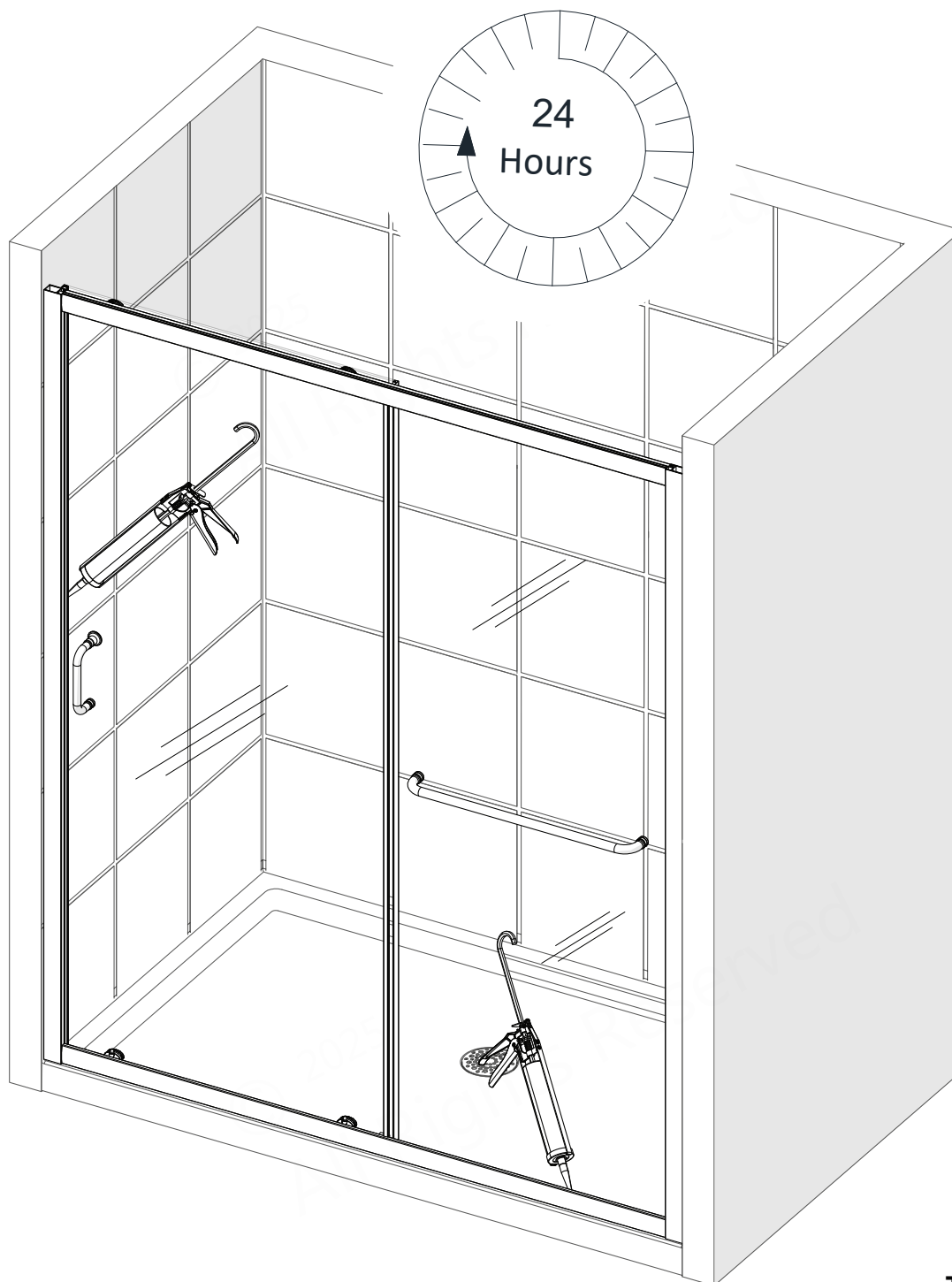
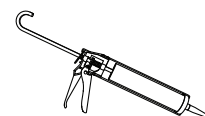
**Fig 16****Tools Needed**

Allow 24 hours for the silicone caulk to cure before using the shower.

Product Maintenance

BASES and BACKWALLS: To ensure long lasting life for your acrylic back walls: wipe them off after each use with a soft cloth. To clean the acrylic back walls use non-abrasive sprays or cream based cleaners. Avoid the use of aerosol spray cleaners. Never use abrasive cleansers, metal brushes or scrapers that could permanently scratch or dull the surface.

GLASS: To ensure long lasting life for your glass shower products: wipe them off after each use with a soft cloth. Rinse and wipe off the glass using either a soft cloth or a squeegee to prevent soap buildup and water spots (Hard water can etch the surface of the glass over time if left to dry). To prevent scratching the surface: never use abrasive cleaners or cleaning products that contain scouring agents. Never use bristle brushes or abrasive sponges that may scratch the surface of the glass.

HARDWARE: To ensure a long lasting finish: wipe off all metal parts after each use with a soft cloth. Do not use abrasive cleaners or cleaning products containing ammonia, bleach or acid. If accidentally used, rinse the surface as soon as possible to prevent damage to the finish (peeling or corrosion). After cleaning the polished finishes, rinse thoroughly and wipe dry with a soft clean-cloth. Clean stainless steel surfaces at least once a week. When applying stainless steel cleaner or polish to stainless steel hardware, work with the grain (not across the grain). Never use an abrasive sponge or cloth, steel wool or wired brush as these may permanently scratch the surfaces.



To maximize the life of your tub door, it is important to regularly inspect the glass and other hardware for misalignment, proper attachment, and/or damage. Contact the manufacturer with any questions or concerns.

FIXED PANEL SLIDING TUB DOOR Maintenance Checklist

- ☐ Inspect the Roller Assemblies; tighten if necessary
- ☐ Inspect Handle and towel bar; tighten if necessary
- ☐ Inspect glass clips; tighten if necessary
- ☐ Inspect and replace damaged or missing Vinyl Seals.
- ☐ Remove Vinyl Seals to inspect the edges of the glass for concealed damage.
Damaged glass must be replaced!
- ☐ Inspect silicone application. Replace as necessary to prevent leakage.
(refer to the manufacturer's recommendations on the proper application of their product).

Troubleshooting

Problem/Symptom	Suggested Solution
Missing Parts	<ul style="list-style-type: none"> • Check all shipping/packaging material for missing parts/components. • If not found, contact the manufacturer to order factory part replacement.
Water leakage underneath Bottom Guide Rail (#03)	<ul style="list-style-type: none"> • Make certain that the Bottom Rail (#03) is tight to the threshold and that the silicone is creating a seal along the entire length of the Bottom Rail. • If the Bottom Rail is not making contact with the threshold, it may be necessary to repeat Steps 6-7 to create a better seal.
Water leakage: Panel/Door Glass (#05/04)	<ul style="list-style-type: none"> • Starting from the bottom, confirm that the Push-in Glazing Vinyl (#08) is correctly inserted into the Glass Profile (#01) (See Step 12). • If possible, direct the flow of water away from the area.
Door Glass (#04) is not rolling smoothly/closing tightly	<ul style="list-style-type: none"> • Use a #2 Phillips screwdriver to evenly adjust the Top Wheel Assemblies (#17a) until the Door Glass (#04) rolls smoothly and closes tightly (See Step 13).
Panel Glass (#05) shakes/rattles during operation	<ul style="list-style-type: none"> • Starting from the bottom, confirm that the Push-in Glazing Vinyl (#08) is installed tightly between the Inline Panel Glass (#05) and the Glass Profile (#01) • Inspect the Glass Clips (#16) for correct installation and tighten if necessary (See Step 11).

NOTE

Prior to contacting the manufacturer, please have the following information readily available:

- Purchase Order Information
- Name, PO Number, Dealer/Vendor Name, etc.
- Factory Part Information (see Page 27)

Factory Parts Information

SLIDING TUB DOOR WITH FIXED PANEL (58X60) - FACTORY PARTS INFORMATION			
ITEM #	FACTORY PART NUMBER	ITEM DESCRIPTION	QTY
01	040020 11 -1474 / 040020 41 -1474 / 040020 61 -1474 / 040020 91 -1474	Left or Right Glass Profile for 6mm (1/4in) Glass	2 pcs
02	041830 11 -1474 / 041830 41 -1474 / 041830 61 -1474 / 041830 91 -1474	Left or Right Wall Profile	2 pcs
03	040010 11 -1437 / 0400 40 11-1437 / 0400 60 11-1437 / 0400 90 11-1437	Top or Bottom Guide Rail	2 pcs
04	010021007	Door Glass	1 pc
05	010022001	Inline Panel Glass	1 pc
06	0722 10 06 / 0722 40 06 / 0722 60 06 / 0722 90 06	Single Sided Curved Handle with Knob for 6mm (1/4in) Glass	1 pc
07a	063001060-1387	Vinyl Seal with a Flexible Fin for 6mm (1/4in) Glass (for panel)	1 pc
07b	063001060-1458	Vinyl Seal with a Flexible Fin for 6mm (1/4in) Glass (for door)	2 pcs
08	060001000-1410	Push-in Glazing Vinyl for 6mm (1/4in) Glass	1 pc
09	091131	ST4.0 × 55mm Pan Head Screw	8 pcs
10	091104	ST4.0 x 25mm Pan Head Screw	8 pcs
11	091101	ST4.0 x 10mm Pan Head Screw	4 pcs
12	092102	ST4.2 x 16mm Countersunk Screw (pre-attached to #03)	4 pcs
12	092102	ST4.2 x 16mm Countersunk Screw	2 pcs
13	0755 10 11 / 0755 40 11 / 0755 60 11 / 0755 90 11	Decorative Cover and Washer	4 pcs
14	07552148	Wall Anchor 8mm (5/16in)	8 pcs
15	060007060-1411	Vinyl Insert for Glass Profile	1 pc
16	0755 10 14 / 0755 40 14 / 0755 60 14 / 0755 90 14	Glass Clip for 6mm (1/4in) Glass	2 pcs
17a	0734 10 08 / 0734 40 08 / 0734 60 08 / 0734 90 08	Single Roller Assembly (top) for 6mm (1/4in) Glass	2 pcs
17b	0734 10 09 / 0734 40 09 / 0734 60 09 / 0734 90 09	Single Roller Assembly (bottom) for 6mm (1/4in) Glass	2 pcs
18	0722 10 23 / 0722 40 23 / 0722 60 23 / 0722 90 23	Towel Bar Assembly for 6mm (1/4in) Glass	1 pc
---	07550009	Roller Stopper (pre-attached to #03)	4 pcs

BOLD digit indicates finish:

- 1 = Chrome
- 4 = Brushed Nickel
- 6 = Oil Rubbed Bronze
- 9 = Matte Black

Contact the manufacturer for Part replacement, installation assistance or additional information.

Factory Parts Information

SLIDING SHOWER DOOR WITH FIXED PANEL (48X72) - FACTORY PARTS INFORMATION			
ITEM #	FACTORY PART NUMBER	ITEM DESCRIPTION	QTY
01	04002 0 11-1830 / 04002 0 41-1830 / 04002 0 61-1830 / 04002 0 91-1830	Left or Right Glass Profile for 6mm (1/4in) Glass	2 pcs
02	04183 0 11-1830 / 04183 0 41-1830 / 04183 0 61-1830 / 04183 0 91-1830	Left or Right Wall Profile	2 pcs
03	04001 0 11-1134 / 04001 0 411-1134 / 04001 0 611-1134 / 04001 0 911-1134	Top or Bottom Guide Rail	2 pcs
04	010021014 (Clear Glass) / 010021016 (Frosted Glass)	Door Glass	1 pc
05	010022007 (Clear Glass) / 010022008 (Frosted Glass)	Inline Panel Glass	1 pc
06	0722 1 006 / 0722 4 006 / 0722 6 006 / 0722 9 006	Single Sided Curved Handle with Knob for 6mm (1/4in) Glass	1 pc
07a	063001060-1743	Vinyl Seal with a Flexible Fin for 6mm (1/4in) Glass (for panel)	1 pc
07b	063001060-1814	Vinyl Seal with a Flexible Fin for 6mm (1/4in) Glass (for door)	2 pcs
08	060001000-1765	Push-in Glazing Vinyl for 6mm (1/4in) Glass	1 pc
09	091131	ST4.0 x 55mm Pan Head Screw	8 pcs
10	091104	ST4.0 x 25mm Pan Head Screw	8 pcs
11	091101	ST4.0 x 10mm Pan Head Screw	4 pcs
12	092102	ST4.2 x 16mm Countersunk Screw (pre-attached to #03)	4 pcs
12	092102	ST4.2 x 16mm Countersunk Screw	2 pcs
13	0755 1 011 / 0755 4 011 / 0755 6 011 / 0755 9 011	Decorative Cover and Washer	4 pcs
14	07552148	Wall Anchor 8mm (5/16in)	8 pcs
15	060007060-1800	Vinyl Insert for Glass Profile	1 pc
16	0755 1 014 / 0755 4 014 / 0755 6 014 / 0755 9 014	Glass Clip for 6mm (1/4in) Glass	2 pcs
17a	0734 1 008 / 0734 4 008 / 0734 6 008 / 0734 9 008	Single Roller Assembly (top) for 6mm (1/4in) Glass	2 pcs
17b	0734 1 009 / 0734 4 009 / 0734 6 009 / 0734 9 009	Single Roller Assembly (bottom) for 6mm (1/4in) Glass	2 pcs
18	0722 1 024 / 0722 4 024 / 0722 6 024 / 0722 9 024	Towel Bar Assembly for 6mm (1/4in) Glass	1 pc
---	07550009	Roller Stopper (pre-attached to #03)	4 pcs

BOLD digit indicates finish:

- 1 = Chrome
- 4 = Brushed Nickel
- 6 = Oil Rubbed Bronze
- 9 = Matte Black

Factory Parts Information

SLIDING SHOWER DOOR WITH FIXED PANEL (54X72) - FACTORY PARTS INFORMATION			
ITEM #	FACTORY PART NUMBER	ITEM DESCRIPTION	QTY
01	040020 1 1-1830 / 040020 4 1-1830 / 040020 6 1-1830 / 040020 9 1-1830	Left or Right Glass Profile for 6mm (1/4in) Glass	2 pcs
02	041830 1 1-1830 / 041830 4 1-1830 / 041830 6 1-1830 / 041830 9 1-1830	Left or Right Wall Profile	2 pcs
03	040010 1 1-1283 / 0400 4 011-1283 / 0400 6 011-1283 / 0400 9 011-1283	Top or Bottom Guide Rail	2 pcs
04	010022011 (Clear Glass) / 010022013 (Frosted Glass)	Door Glass	1 pc
05	010022010 (Clear Glass) / 010022012 (Frosted Glass)	Inline Panel Glass	1 pc
06	0722 1 006 / 0722 4 006 / 0722 6 006 / 0722 9 006	Single Sided Curved Handle with Knob for 6mm (1/4in) Glass	1 pc
07a	063001060-1743	Vinyl Seal with a Flexible Fin for 6mm (1/4in) Glass (for panel)	1 pc
07b	063001060-1814	Vinyl Seal with a Flexible Fin for 6mm (1/4in) Glass (for door)	2 pcs
08	060001000-1765	Push-in Glazing Vinyl for 6mm (1/4in) Glass	1 pc
09	091131	ST4.0 x 55mm Pan Head Screw	8 pcs
10	091104	ST4.0 x 25mm Pan Head Screw	8 pcs
11	091101	ST4.0 x 10mm Pan Head Screw	4 pcs
12	092102	ST4.2 x 16mm Countersunk Screw (pre-attached to #03)	4 pcs
12	092102	ST4.2 x 16mm Countersunk Screw	2 pcs
13	0755 1 011 / 0755 4 011 / 0755 6 011 / 0755 9 011	Decorative Cover and Washer	4 pcs
14	07552148	Wall Anchor 8mm (5/16in)	8 pcs
15	060007060-1800	Vinyl Insert for Glass Profile	1 pc
16	0755 1 014 / 0755 4 014 / 0755 6 014 / 0755 9 014	Glass Clip for 6mm (1/4in) Glass	2 pcs
17a	0734 1 008 / 0734 4 008 / 0734 6 008 / 0734 9 008	Single Roller Assembly (top) for 6mm (1/4in) Glass	2 pcs
17b	0734 1 009 / 0734 4 009 / 0734 6 009 / 0734 9 009	Single Roller Assembly (bottom) for 6mm (1/4in) Glass	2 pcs
18	0722 1 051 / 0722 4 051 / 0722 6 051 / 0722 9 051	Towel Bar Assembly for 6mm (1/4in) Glass	1 pc
---	07550009	Roller Stopper (pre-attached to #03)	4 pcs

BOLD digit indicates finish:

- 1 = Chrome
- 4 = Brushed Nickel
- 6 = Oil Rubbed Bronze
- 9 = Matte Black

Factory Parts Information

SLIDING SHOWER DOOR WITH FIXED PANEL (60X72) - FACTORY PARTS INFORMATION			
ITEM #	FACTORY PART NUMBER	ITEM DESCRIPTION	QTY
01	040020 11 -1830 / 040020 41 -1830 / 040020 61 -1830 / 040020 91 -1830	Left or Right Glass Profile for 6mm (1/4in) Glass	2 pcs
02	041830 11 -1830 / 041830 41 -1830 / 041830 61 -1830 / 041830 91 -1830	Left or Right Wall Profile	2 pcs
03	040010 11 -1437 / 0400 40 11-1437 / 0400 60 11-1437 / 0400 90 11-1437	Top or Bottom Guide Rail	2 pcs
04	010021010 (Clear Glass) / 010021011 (Frosted Glass)	Door Glass	1 pc
05	010022004 (Clear Glass) / 010022005 (Frosted Glass)	Inline Panel Glass	1 pc
06	0722 10 06 / 0722 40 06 / 0722 60 06 / 0722 90 06	Single Sided Curved Handle with Knob for 6mm (1/4in) Glass	1 pc
07a	063001060-1743	Vinyl Seal with a Flexible Fin for 6mm (1/4in) Glass (for panel)	1 pc
07b	063001060-1814	Vinyl Seal with a Flexible Fin for 6mm (1/4in) Glass (for door)	2 pcs
08	060001000-1765	Push-in Glazing Vinyl for 6mm (1/4in) Glass	1 pc
09	091131	ST4.0 × 55mm Pan Head Screw	8 pcs
10	091104	ST4.0 x 25mm Pan Head Screw	8 pcs
11	091101	ST4.0 x 10mm Pan Head Screw	4 pcs
12	092102	ST4.2 x 16mm Countersunk Screw (pre-attached to #03)	4 pcs
12	092102	ST4.2 x 16mm Countersunk Screw	2 pcs
13	0755 10 11 / 0755 40 11 / 0755 60 11 / 0755 90 11	Decorative Cover and Washer	4 pcs
14	7552148	Wall Anchor 8mm (5/16in)	8 pcs
15	060007060-1800	Vinyl Insert for Glass Profile	1 pc
16	0755 10 14 / 0755 40 14 / 0755 60 14 / 0755 90 14	Glass Clip for 6mm (1/4in) Glass	2 pcs
17a	0734 10 08 / 0734 40 08 / 0734 60 08 / 0734 90 08	Single Roller Assembly (top) for 6mm (1/4in) Glass	2 pcs
17b	0734 10 09 / 0734 40 09 / 0734 60 09 / 0734 90 09	Single Roller Assembly (bottom) for 6mm (1/4in) Glass	2 pcs
18	0722 10 23 / 0722 40 23 / 0722 60 23 / 0722 90 23	Towel Bar Assembly for 6mm (1/4in) Glass	1 pc
---	07550009	Roller Stopper (pre-attached to #03)	4 pcs

BOLD digit indicates finish:

- 1 = Chrome
- 4 = Brushed Nickel
- 6 = Oil Rubbed Bronze
- 9 = Matte Black

NOTES

SLIDING SHOWER AND TUB DOOR WITH FIXED PANEL

INSTALLATION INSTRUCTIONS

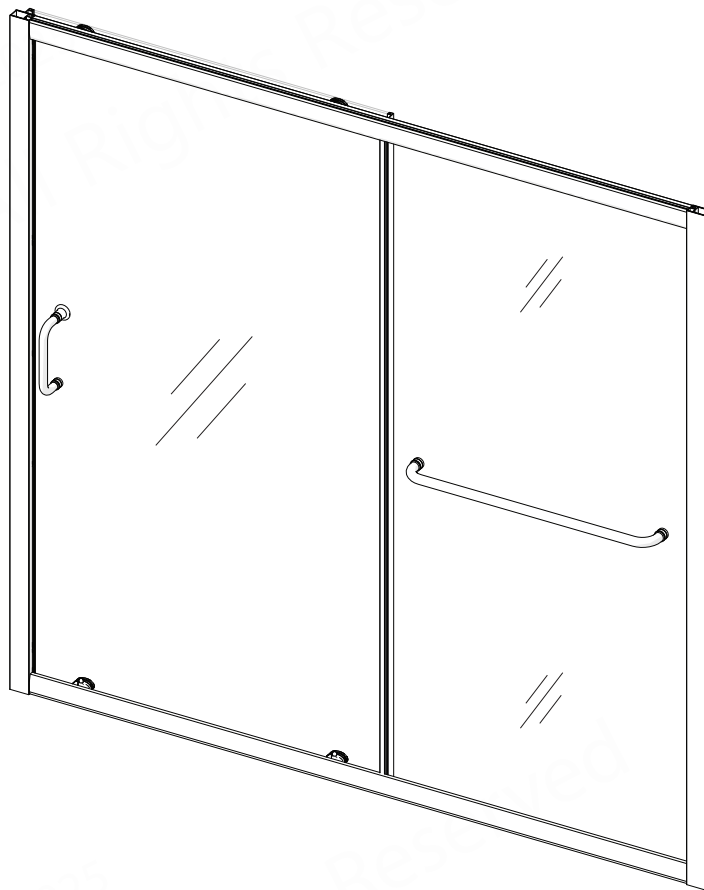

IMPORTANT!

The manufacturer reserves the right to alter, modify or redesign products at any time without prior notice for the purpose of product improvement and customer experience. Please refer to the manufacturer's web page for the latest technical drawings, installation manuals, warranty information or additional product details.