



Instruction Manual

Item# BB3387GN



Having Trouble?

Chat with us on your phone

Simply point your phone camera towards
the QR code or see our website



xbrand.us

or email at

customerservice@ecintel.com

Monday - Friday 7:00AM - 3:30PM PST

BirdBath Twisted Fonatin



Purchased your product online?

We would really appreciate it if you can share your experience
with others by reviewing our product on the website from
which you purchased.



Have Questions or Issues? Need help with assembly?

Contact us and we will resolve immediately.

Simply point your phone camera towards the QR code or see our website

Support Hours M-F 7:00AM - 3:30PM (U.S Pacific Time)



Chat with us:
xbrand.us



Email:
customerservice@ecintel.com



Call:
951-319-4433

Limited 1-Year Manufacturer Warranty on xbrand.us

Manufacturer warranty covers:

- Parts that are deemed defective within 30 day will be shipped free of charge.
- Any warranty claim after 30 days, will require shipping to be paid by the customer.

Any visible damage due to the neglect, misuse, or abuse will void the limited warranty of the product.

For further information, please contact us:

Chat with us: xbrand.us



Simply point your phone camera towards the QR code or see our website

Email: customerservice@ecintel.com

Purchased your product online?

We would really appreciate it if you can share your experience with others by reviewing our product on the website from which you purchased.



Please use your smart phone camera to scan the QR code.
Simply point your camera and let the camera scan the
code below, and click on the link that opens up.



<https://xbrand.us/product/bb3387gn/>

Contents	2
What is included	3
Assembly instructions	4
YouTube video instruction	5
Warranty	6

What is included

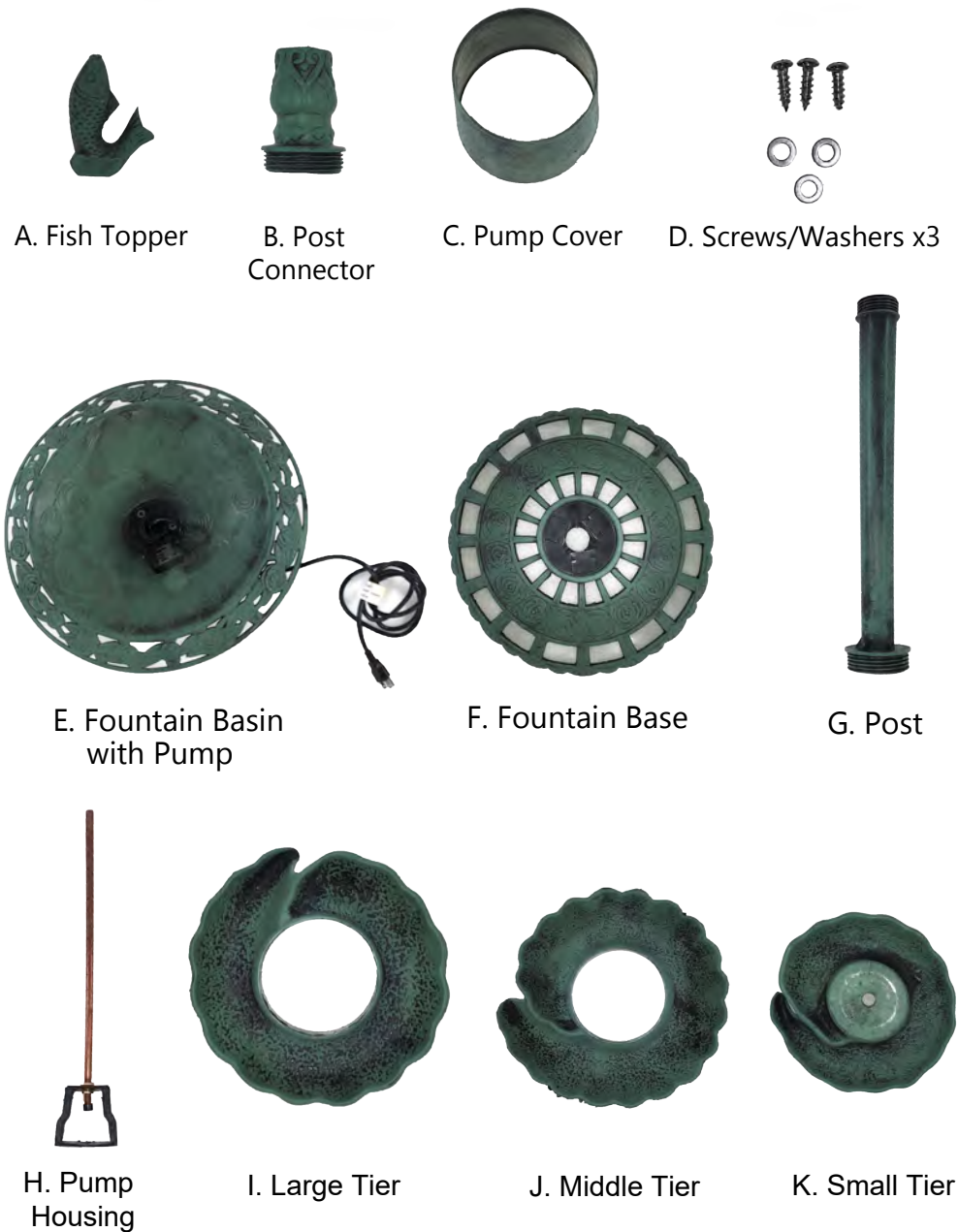

Assembly instructions

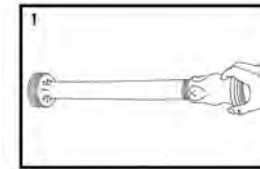

1
Connect Post to Post Connector in a twist motion



2
Insert water pump cable through the Post



3
Attach the post to the fountain basin by twisting until secured



4
Connect fountain Post to the fountain Base



5
Connect Pump Housing to the water pump and turn on the pump



6
Screw Pump Housing to secure in place

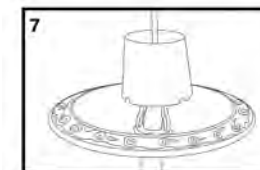

7
Add Pump Cover onto the Pump Housing



8
Place the Large Tier on the Pump Cover and secure it in place



9
Place Middle Tier to the Large Tier and secure in place



10
Place Small Tier on the Middle Tier and secure in place



11
Attach the Fish Topper onto the top of the Pump Housing to secure it in place