

4" LED Retrofit-Kit Installation Instructions

The units covered in these instructions are intended to retrofit Type IC or Type Non-IC luminaires.

WARNING / ATTENTION

1. Risk of fire or electric shock. LED Retrofit Kit installation requires knowledge of luminaires electrical systems. If not qualified, do not attempt installation. Contact a qualified electrician.
2. Risk of fire or electric shock. Install this kit only in luminaires that have the construction features and dimensions shown in the photographs and/or drawings and where the input rating of the retrofit kit does not exceed the input rating of the luminaire.
3. To prevent wiring damage or abrasion, do not expose wiring to edges of sheet metal or other sharp objects.
4. Do not make or alter any open holes in an enclosure of wiring or electrical components during kit installation.
5. THE RETROFIT KIT IS ACCEPTED AS A COMPONENT OF A LUMINAIRE WHERE THE SUITABILITY OF THE COMBINATION SHALL BE DETERMINED BY CSA OR AUTHORITIES HAVING JURISDICTION.

CAUTIONS

1. For your safety, read and understand instructions completely before starting installation.
2. Before attempting Installation, check your local electric code, as it sets wiring standards for your locality.

NOTES

1. If luminaire (fixture) is to be switched from a wall switch, make sure black power supply wire is connected to the switch. DO NOT connect the white supply wire to the switch.
2. Make sure no bare wires are exposed outside the wire nut connectors.
3. Do not make or alter any open holes in an enclosure of wiring or electrical components during kits installation.
4. These fixtures are suitable for Damp locations.

Electrical parameters:

Model	Input Voltage (V)	Input Frequency (Hz)	Input Watts (W)
MRL-410205	120	60	10

Three Year Warranty:

Maxxima extends a 3 year limited warranty to the original purchase that the products listed are free from defects in material and/or workmanship only. Maxxima will replace any warranted product to the original consumer/purchaser if the product fails because of defects due to workmanship and/or materials within the limited warranty period. Limited warranty is not transferable and applies to the original installation of the Maxxima product. This offer does not constitute in any way a product guarantee and Maxxima does not hereby assume any obligation whatsoever beyond sending a free replacement product.

Housing Dimensions

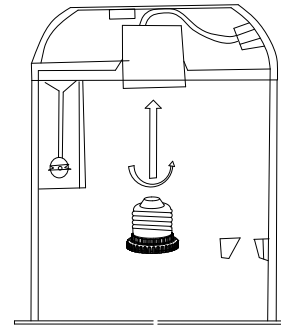
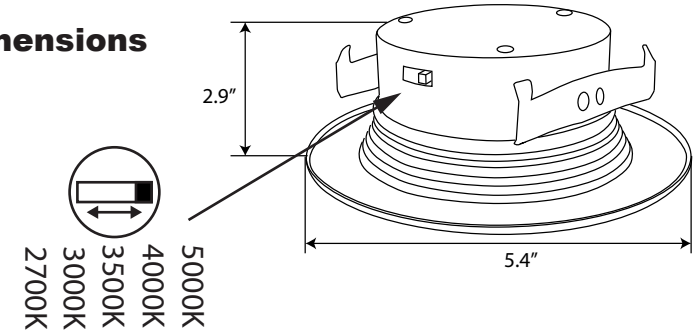

Figure 1

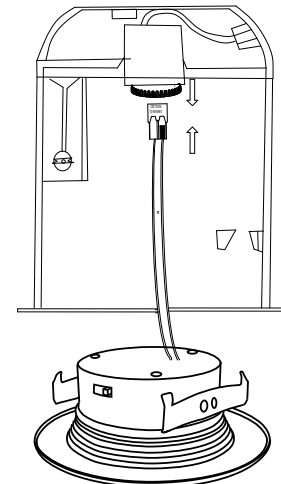

Figure 2

Installation Into Recessed Housing:

- STEP1:** Turn off the power before installation. Remove the existing diffuser, bulb and trim as applicable.
- STEP2:** Screw E26 socket adapter provided into socket in housing. (Figure 1)
- STEP3:** Plug the connector of the retrofit kit into the connector of the socket adapter assembly. (Figure 2)
- STEP4:** Use the CCT Selector Switch on the back of the fixture to select the desired color of the light.
- STEP5:** Tuck all wires into the housing and carefully push the LED trim until its outer edge is flush against the ceiling surface. (Figure 3)

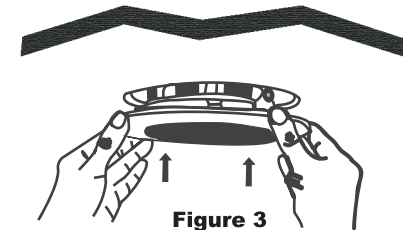

Figure 3