

DLS Surface Mount LED Downlight

INSTALLATION INSTRUCTIONS

Model(s): DLS56-30##-120-#K-WH



WARNING:



- Risk of electric shock. Disconnect power at fuse or circuit breaker before installing or servicing.
- To prevent early lamp failure, lamp should only be installed in operating environments between -20°C and + 40°C (104°F and -4°F)
- No user serviceable parts inside. To avoid electric shock do not disassemble product.
- This product is not intended for use in emergency light fixtures or exit signs.

ATTENTION:

Turn power off before inspection, installation, or removal.
Suitable for use in wet locations. Use only on 120VAC, 60Hz circuits.

NOTE: This luminaire has been modified and can no longer operate the originally intended lamp. The provided label must be applied to the retrofitted luminaire where visible during re-lamping.

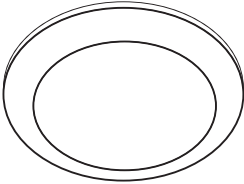
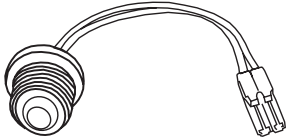
What's In The Box

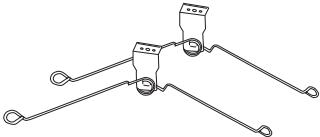
			
One (1) DLS56	One (1) Screw-in Edison Base	Three (3) Wire Nuts	One (1) Pair of Torsion Springs

Tools Needed

This LED Surface Mount LED Downlight requires very few tools for installation. A screwdriver and a pair of wirecutters will help to install the downlight to a JBox or housing.



Standard 4" J-Box Installation

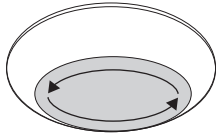
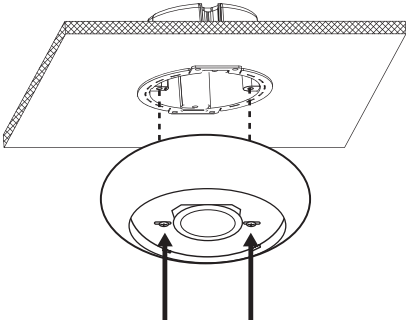
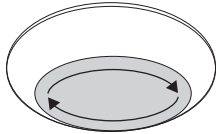

Make sure all power is turned off before beginning installation

1 Cut off fixture connector and strip back wires minimum 3/8".	2 Make sure building wires are accessible from the JBox and splice the fixture wires to the building wires with wire nuts (included): black to live (black), white to neutral (white), and green to ground.
2a Carefully tuck the wires into the J-Box.	3 Twist off DLS lens by twisting lens counterclockwise. 
3a Align screws (2) to JBox, mount DLS to Jbox by tightening screws. 	4 Twist DLS lens back on by twisting lens clockwise. 
	5 Power on the fixtures to enjoy your new surface mount LED downlight.

4", 5" and 6" Housing Installation



Make sure all power is turned off before beginning installation

- 1 Remove any existing trim, lamp and mounting bracket (if any) and remove the socket from the plate.

- 2 Install the (2) torsion springs on the back of the fixture using provided screws.

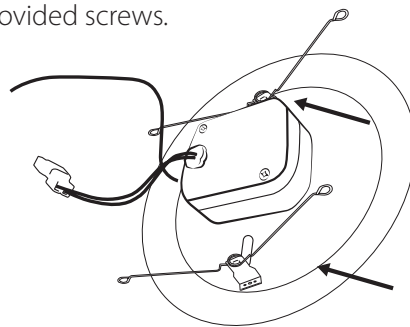

- 3 Disconnect Edison base from downlight and screw into socket inside recessed housing. (GU24 base option available). (Base not needed if using NICOR 17014A-LED-ID)

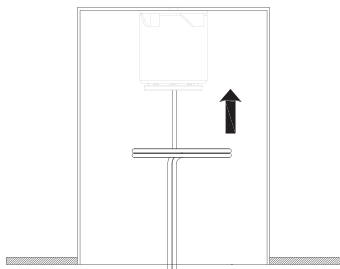

- 4 Plug the downlight connector into the Edison (or GU24) base or LED housing connector.

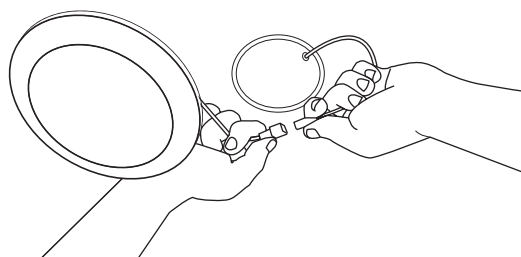

- 2a Align the torsion springs to the housing and press the fixture flush to the ceiling. Squeeze torsion springs together and install into torsion spring brackets inside recessed housings and press the fixture flush to the ceiling.

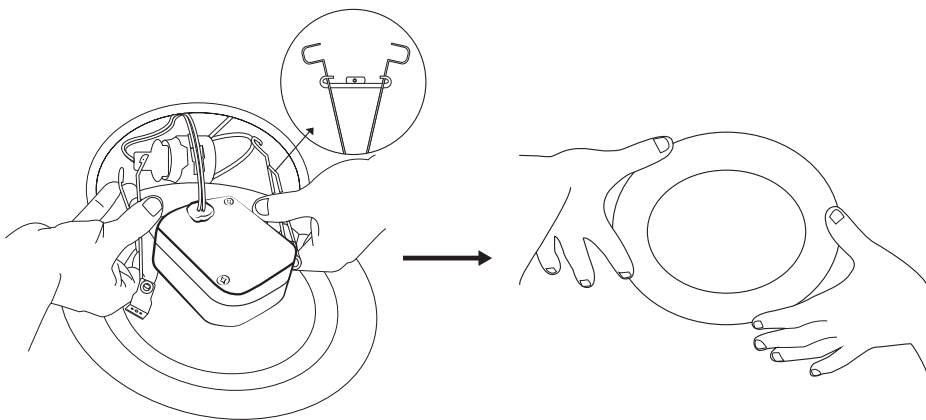

EXPRESS LIMITED WARRANTY

Subject to the exclusions contained below, NICOR Inc. (NICOR) warrants that all NICOR LED branded Solid State Lighting products made by NICOR to be free from defects in materials and workmanship, under normal consumer usage for a period of 5 years from date of purchase. This limited warranty is a consumer's exclusive remedy, and applies only to new products purchased and used by consumers in the United States or Canada, which are accompanied by this written warranty.

This limited warranty extends only to the first consumer purchaser, and is not transferable. A consumer wishing to invoke the terms of this warranty must first obtain a RGA number within 30 days of discovery of the defect, and return the product to NICOR for inspection. Once verified to be covered by this limited warranty, NICOR will, at its discretion, repair, replace or refund the purchase price of any product that does not conform to this limited warranty.

This limited warranty covers only defects in material and workmanship associated with normal installation and intended use of the product.

THIS LIMITED WARRANTY DOES NOT COVER THE FOLLOWING:

- Defects or damages resulting from improper operation, storage, misuse or abuse, accident or neglect;
- Defects or damages resulting from improper service, testing, adjustment, installation, maintenance, alteration, connection to out-of-specification electrical service, corrosive or damp environments, or connection to incompatible equipment or devices (e.g., connecting non-dimmable lighting products to dimmers);
- Damage which occurs in transit; and
- Labor or other charges or expenses associated with the removal, repair, or re-installation of defective or replacement products.

ANY IMPLIED WARRANTIES, INCLUDING WITHOUT LIMITATION, THE IMPLIED WARRANTIES OF MERCHANTABILITY AND FITNESS FOR A PARTICULAR PURPOSE SHALL BE LIMITED TO THE DURATION OF THIS LIMITED WARRANTY, OTHERWISE THE REPAIR, REPLACEMENT OR REFUND AS PROVIDED UNDER THIS EXPRESS LIMITED WARRANTY IS THE EXCLUSIVE REMEDY OF THE CONSUMER, AND IS PROVIDED IN LIEU OF ALL OTHER WARRANTIES, EXPRESS OR IMPLIED. IN NO EVENT SHALL NICOR BE LIABLE, WHETHER IN CONTRACT OR IN TORT (INCLUDING NEGLIGENCE) FOR DAMAGES IN EXCESS OF THE PURCHASE PRICE OF THE PRODUCT, OR FOR ANY INDIRECT, INCIDENTAL, SPECIAL OR CONSEQUENTIAL DAMAGES OF ANY KIND, OR LOSS OF REVENUE OR PROFITS, LOSS OF BUSINESS OR OTHER FINANCIAL LOSS ARISING OUT OF OR IN CONNECTION WITH THE ABILITY OR INABILITY TO USE THE PRODUCT TO THE FULL EXTENT THESE DAMAGES MAY BE DISCLAIMED BY LAW.