



SteamMachine™ 053

Instruction Manual

⚠ WARNING

TO REDUCE THE RISK OF INJURY,
USER MUST READ INSTRUCTION MANUAL.

FOR HOUSEHOLD USE ONLY.

KEEP CHILDREN AWAY
FROM WORK AREA.

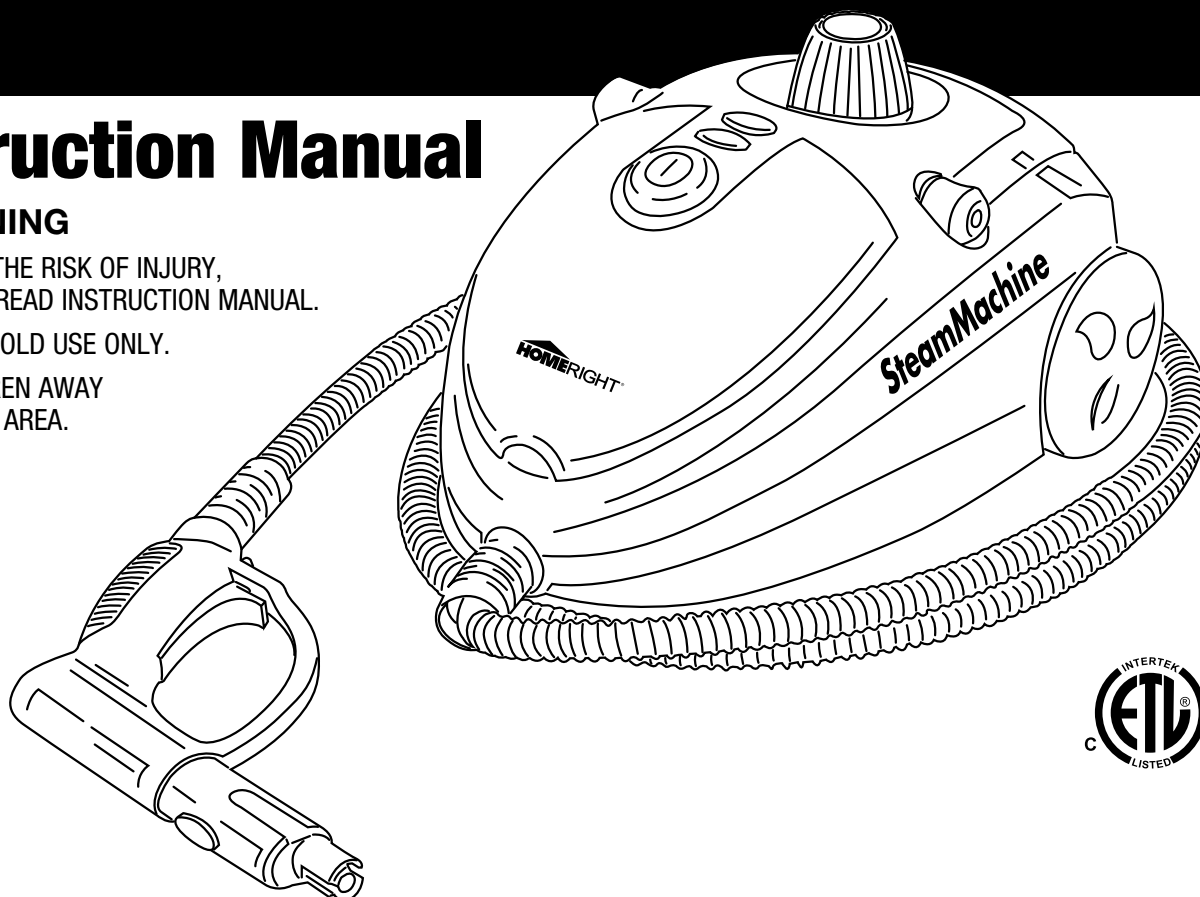

Contents

Important Safeguards	2
Quick Start Quick Reference Guide	4
Filling the Water Tank	5
Steam Gun Operation	6
Assembling and Attaching Accessories	7
Cleaning and Storage	9
Troubleshooting	10
Parts List	11

Customer Service

1-800-264-5442 or 763-780-5115,
8 a.m. to 5 p.m. CST.

English (page 1)

Français (page 13)

Español (página 25)

Made in China



**Register Online Today
To Activate Your Two-Year Warranty**

Go online at www.homeright.com or scan the QR Code to the left. See back page for warranty details.

Safeguards and Warnings

HomeRight will not be responsible for losses or damage resulting from use of this product in any manner not specifically stated in this manual. User assumes all risks associated with such non-specific use.

Before using this product, user must evaluate it and determine if it is suitable for intended application. User assumes all risks and liability associated with such use.

Read and Follow All Safeguards

The SteamMachine is safe when properly used but can be dangerous if misused. It is the responsibility of the user to read and understand all instructions, IMPORTANT SAFEGUARDS, and safety precautions before operating the unit and to use the unit properly. Failure to do so may result in product damage, personal injury or loss of life. User assumes all risks associated with improper use.

DO NOT try to repair (or disassemble) the unit yourself. Repairs should be performed by a qualified technician familiar with this unit or returned to HomeRight™ (see warranty). This unit is to be used with authorized parts only. **The user assumes all risks and liabilities when operating the unit with parts that do not comply with the manufacturers specifications.**

Warnings

- **DO NOT** operate the unit without water in the tank.
- **DO NOT** overfill the water tank. The unit can hold a maximum of 40 oz. of water. Over filling the water tank may cause damage to the machine and injury to the operator.
- **DO NOT** fill the water tank with any fluid other than water. Other cleaning agents could damage unit or cause injury. Distilled or de-mineralized water is HIGHLY RECOMMENDED in order to minimize build-up of mineral deposits.
- **DO NOT** run the unit for more than 1 hour at a time.
- **DO NOT** allow machine to run unattended at any time.
- **DO NOT** direct steam at people, animals or electrical devices.
- **DO NOT** touch main nozzle or attempt to connect attachments while unit is in use.
- **DO NOT** touch bottom of brush head or attempt to attach a cleaning pad while unit is in use.
- **DO NOT** turn the machine over or tilt more than 45° when it is switched on or if it is still producing steam.
- **DO NOT** operate with a damaged cord, if the power cord is damaged it should be repaired by a qualified electrician.
- **DO NOT** pull or carry the SteamMachine by its cord.
- **DO NOT** unplug by pulling on cord. Always grasp the plug, not the cord.

- **DO NOT** expose machine to freezing temperatures.
- **DO NOT** place steam unit on a wet surface or operate near a water source.
- **DO NOT** place unit on towel, blanket or other insulating pad.
- **NEVER** operate without the safety cap screwed tightly in place.
- **NEVER** unscrew or attempt to remove the tank/pressure safety cap while the unit is in use.
- **NEVER** use this machine to clean electronic devices.
- **NEVER** leave brush in one spot on any surface for more than a few seconds – prolonged exposure to heat and moisture may damage surfaces.
- **ALWAYS** unplug unit when not in use.
- **ALWAYS** turn unit off before unplugging from outlets.
- **ALWAYS** turn unit off and unplug power cord before filling water tank.
- **ALWAYS** allow 30 minutes for the unit to cool before removing the tank cap to refill the unit.
- **ALWAYS** allow the unit to completely cool before storing.

Caution

If there is a lot of steam emission from the fill cap handle, please switch off and unplug the unit at once. The SteamMachine should be checked and repaired by service agent.

Hazard



HOT STEAM AND PARTS.
May cause injury, including skin burns or property damage. Temperatures exceed 212° F (100° C).



FIRE.
May cause severe injury and/or property damage.

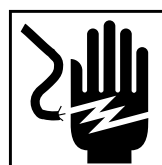

ELECTRICAL SHOCK.
May cause severe injury.

Safeguards and Warnings

Cleaning Fabrics:

A number of materials and fabrics are NOT suitable to be cleaned by steam:

DO NOT use on leather, wax polished furniture or floors, synthetic fabrics, velvet, Dralon® or other delicate, steam sensitive materials.

When steaming any surface for the first time, it is recommended that you consult the manufacture's guidelines for cleaning.

Cleaning Glass/Mirrors:

Thermal shock can also shatter glass. Do not apply steam to glass surfaces that are cooler than 32°F.

Electrical Connections

- DO use a three-pronged extension cord that is at least 18 gauge.
- DO only plug the cord or extension cord into a three-pronged grounded power supply.
- To prevent electrical shock, NEVER immerse the SteamMachine into water or other liquids

Prop 65 Warning

Handling the coated electrical wires of this product exposes you to lead, a chemical known to the State of California to cause birth defects or other reproductive harm. Wash hands after use.

Grounding Instructions

The product must be grounded. In the event of an electrical short circuit, grounding reduces the risk of electrical shock by providing an escape wire for the electric current. This product is equipped with a cord having a grounding wire with an appropriate grounding plug. The plug must be plugged into an appropriate outlet that is properly installed and grounded in accordance with all local codes and ordinances.

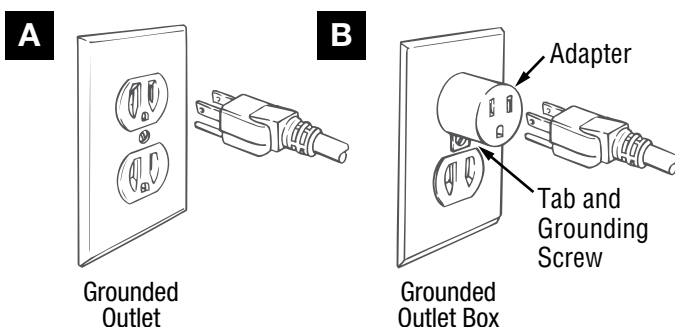

⚠ Warning

DANGER - Improper use of the grounding plug can result in a risk of electric shock.

If repair or replacement of the cord or plug is necessary, do not connect the grounding wire to either flat blade terminal. The grounding wire has green insulation, with or without yellow stripes. Check with a qualified electrician or serviceman if the grounding instructions are not completely understood, or if in doubt as to whether the product is properly grounded. Do not modify the plug provided; if it will not fit the outlet, have the proper outlet installed by a qualified electrician. This product is for use on a nominal 120 volt circuit and has a grounding plug that looks like the plug illustrated in Figure A.

Make sure the product is connected to an outlet having the same configuration as the plug. A temporary adaptor, which looks like the adaptor illustrated in Figure B, may be used to connect the plug to a two-pole receptacle as shown in Figure B if a properly grounded outlet is not available. The temporary adaptor should only be used until a properly grounded outlet (Figure A) can be installed by a qualified electrician. The green colored rigid ear plug or the like extending from the adaptor must be connected to a permanent ground such as a properly grounded outlet box cover. Whenever the adaptor is used, it must be held in place by a metal screw.

Extension Cords

Use only a three-pronged extension cord that has a three-blade grounding plug and a three-slot receptacle that will accept the plug on the product. Make sure your extension cord is UL/ETL/CSA listed and is in good condition. When using an extension cord, be sure to use one heavy enough for the current. For lengths less than 18 feet, use a No. 16 AWG or heavier; for lengths more than 18 feet but less than 25 feet, use No. 14 AWG; for lengths more than 25 feet, use No. 12 AWG or heavier. If in doubt, use a heavier gauge. An undersized cord will cause a drop in line voltage resulting in loss of power and overheating which can damage the unit or extension cord.

Storage

Make sure unit is clean and dry before storing and always follow cool down instructions. Store in a dry location. To prevent damage, the electrical cord should not be crimped during storage.

Quick Start Reference Guide

This is only a quick reference. Read the entire instruction manual prior to using the product.

⚠ **Read all warnings and safety instructions in the instruction manual before use.**

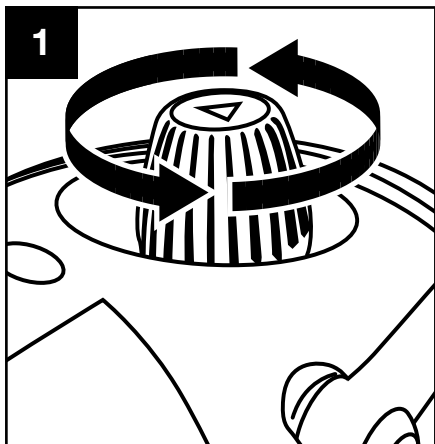

Unscrew the safety cap by turning counter clockwise.

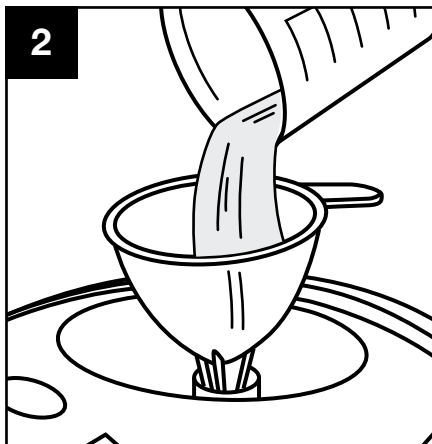

Fill the tank using the funnel and measuring cup provided. The tank holds up to 40 oz. /1200ml of water. DO NOT overfill the water tank or damage to the product may occur.

NOTE: Only use distilled water, mineral build-up from tap water can shorten the life of the steamer.

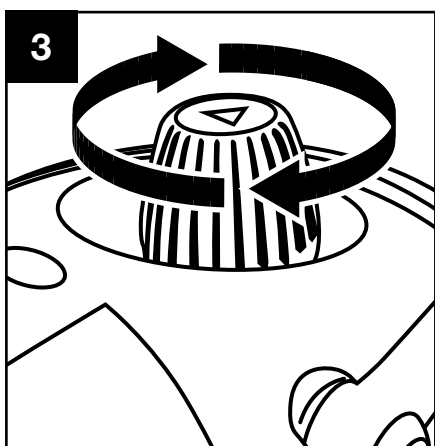

Once full replace the safety cap by turning clockwise, fasten tightly.

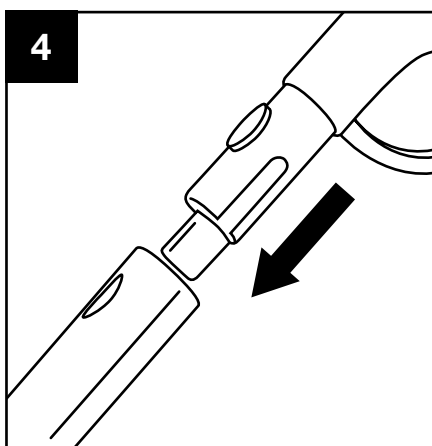

Attach the necessary cleaning adaptor and accessory to the steam gun nozzle.

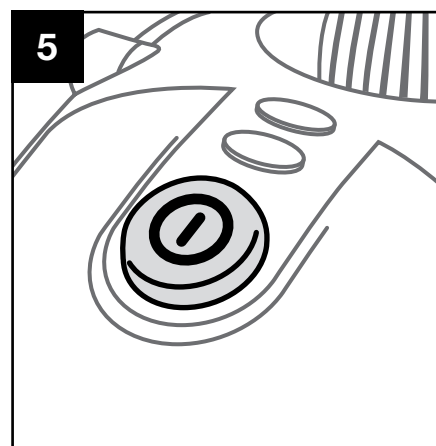

Plug the machine into the outlet and press the ON/OFF button to ON.

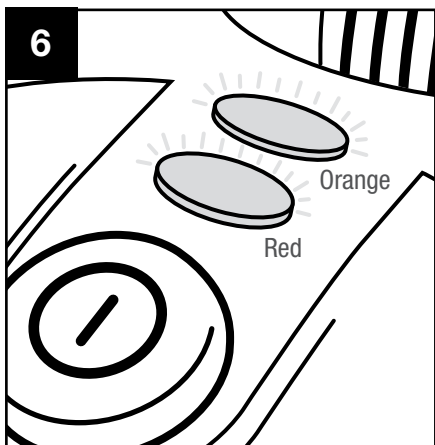

The Red power light and Orange steam light, indicating that the machine is building steam, should both illuminate.

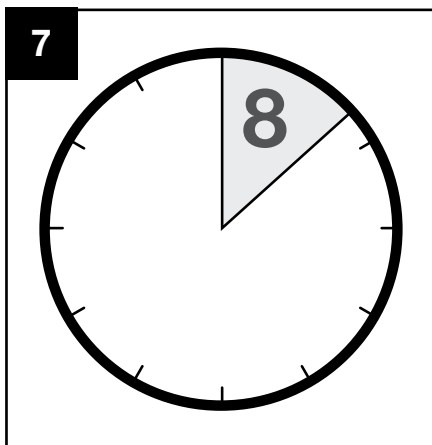

Allow approximately 8 minutes for the machine to build up steam pressure.

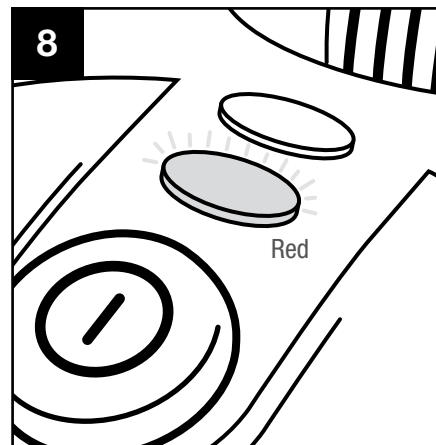

Once the orange steam pressure light turns off, the machine is ready to use.

Filling the Water Tank

⚠ **NEVER** fill the tank while the machine is plugged in.

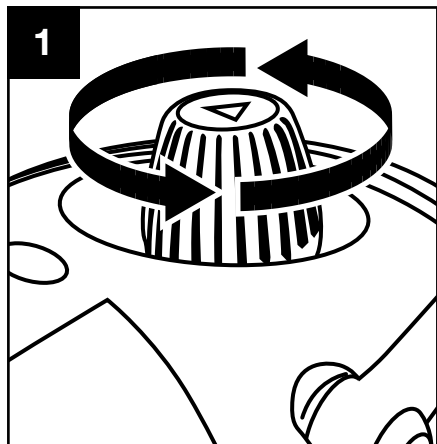

Unscrew the safety cap.

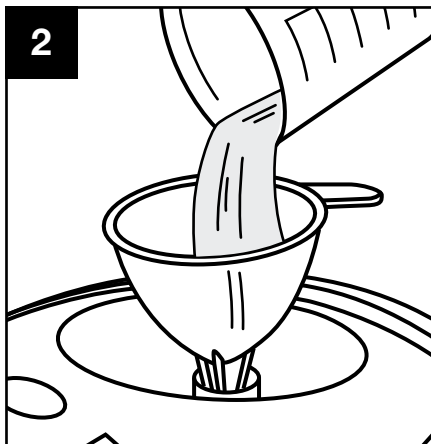

Fill the tank using the funnel and measuring cup provided. The tank holds up to 40 oz. /1200ml of water **DO NOT** overfill the water tank.

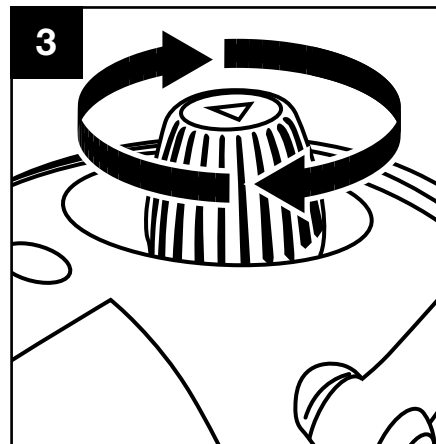

Fasten the safety cap tightly into place.

Water Usage and Steam Time Guidelines

Amount of Water	Duration of Steam
13 oz. / 400ml	Approximately 15 min.
26 oz. / 800ml	Approximately 30 min.
40 oz. / 1200ml	Approximately 45 min.

Refilling the Water Tank

If the unit has been in use, **ALWAYS** follow these safety precautions before removing the water tank safety cap:

- Switch the unit to the OFF position and unplug the unit. Allow at least 30 minutes for the unit to cool.
- Release all the steam pressure in the unit by pressing the steam nozzle flow trigger (the red safety switch must be in the ON position).

⚠ **WARNING:** Failure to follow these precautions may result in burns from escaping steam when the water tank safety cap is removed.

NOTE: Safety Cap will rotate but will not unscrew until unit is cool and pressure is released.

⚠ **CAUTION:** For household use only. Do not overfill reservoir as it may cause damage to the unit. Allow a 30 minute cool down period before refilling the reservoir.

Steam Gun Operation

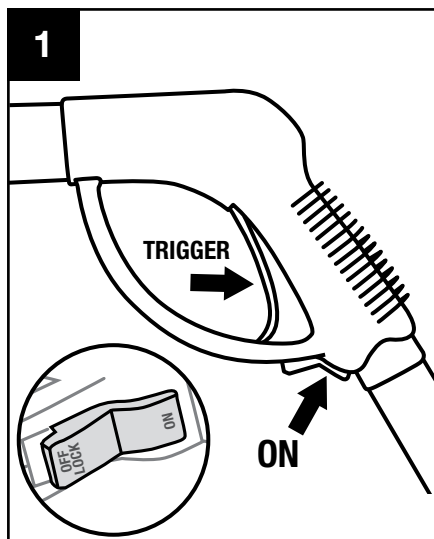

The steam output is controlled through the steam gun. The gun has both a steam trigger and red safety switch.

For intermittent steam generation press the red safety switch to the ON position. Pull the trigger to release steam.

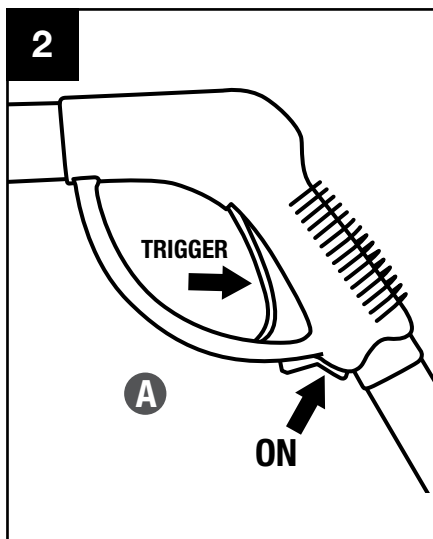

For continuous steam generation:

(A) Start by pressing the red safety switch to the ON position, pull the trigger and then press the safety switch to LOCK. The trigger is now locked into continuous steam mode.

(B) To unlock from continuous steam mode, release the trigger and press the red safety switch back to the ON position.

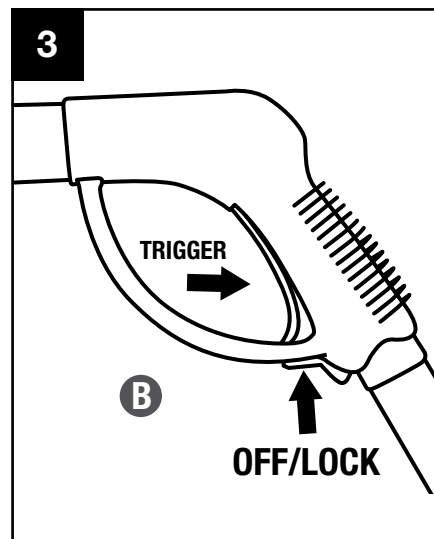

Rebuilding Steam Pressure While in Use

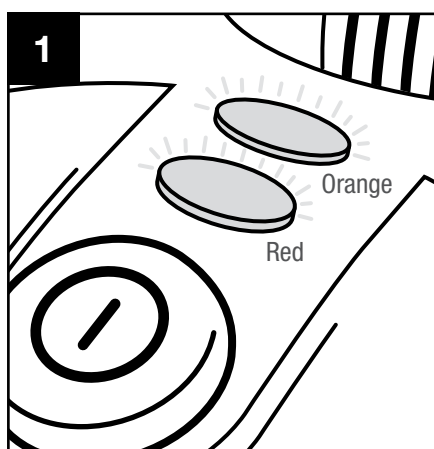

The SteamMachine is designed to run continuously. The orange light indicates when the heating element is functioning; the unit may still be used simultaneously without affecting performance.

⚠ WARNING:

Burns can occur from hot water or steam. **DO NOT** touch the steam nozzle or attempt to connect accessories while unit is in use. **NEVER** direct the steam at a person, pet or electrical device.



⚠ HAZARD:

HOT STEAM AND PARTS. May cause injury, including skin burns or property damage. Temperatures exceed 212° F (100° C).

Assembling and Attaching Accessories

Attaching the Squeegee, Jet Nozzle and Utility Brushes to the Steam Nozzle

NOTE: The straight adaptor is used to attach all accessories to the steam gun with the exception of the Large Brush.

ALWAYS attach accessories before turning the unit on.

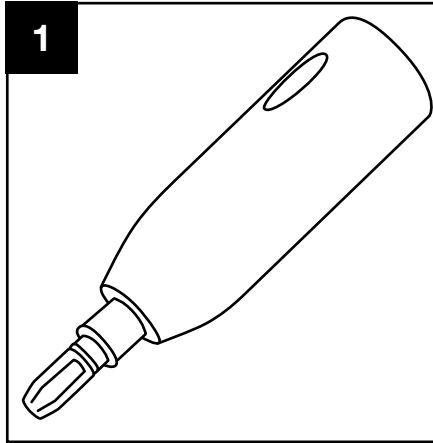

Use the straight adaptor to attach accessories to the steam gun nozzle.

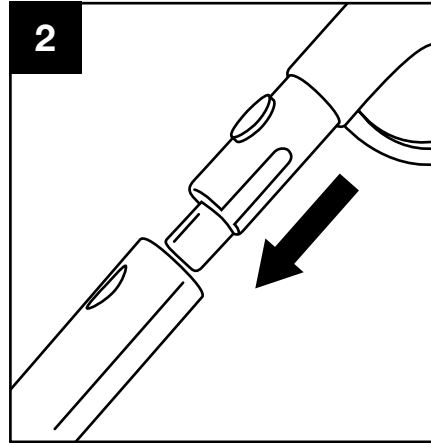

Slide the straight adaptor over the steam gun nozzle, align the oval hole with the lock/release button and push the button to allow the attachment to slide into place.

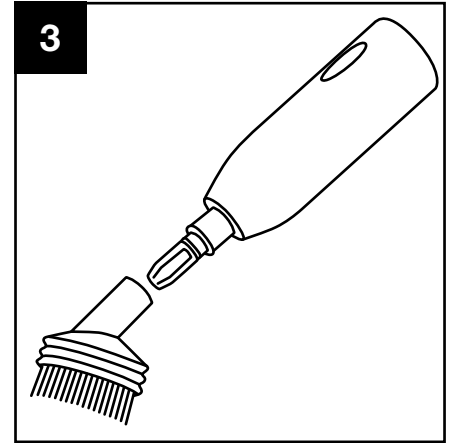

Slide the accessory onto the straight adaptor.

Cleaning with the Attachments

Squeegee

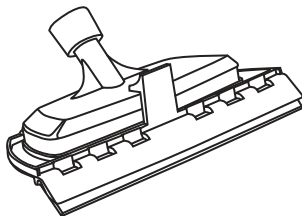

The **squeegee** is an excellent tool for cleaning bathroom shower doors and walls, fireplace doors and windows. Do not use on glass when temperature is below 32° F (0° C). Glass may crack in cold temperatures.

Fabric Steamer

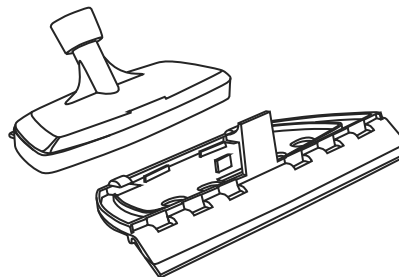

Remove the rubber lip and use for garment steaming and for killing dust mites in mattresses.

Jet Nozzle



The **jet nozzle** can be used to disinfect bathroom and kitchen fixtures and hard to reach places.

Nylon Brush

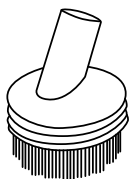

The **nylon brush** can be used in hard to reach areas around sink and bathroom faucets.

Brass Brush



The **brass brush** can be used to remove grease and grime found on grills and ovens.

Large Cleaning Brush

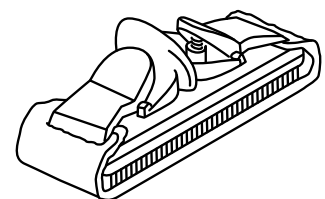

The **large cleaning brush** and cleaning cloth can be used to clean marble and granite countertops and ceramic tile, vinyl and linoleum floors.

Assembling and Attaching Accessories

Attaching Large Brush, Angled Adaptor, Extension Wands and Cleaning Cloth

ALWAYS attach accessories before turning the unit on.

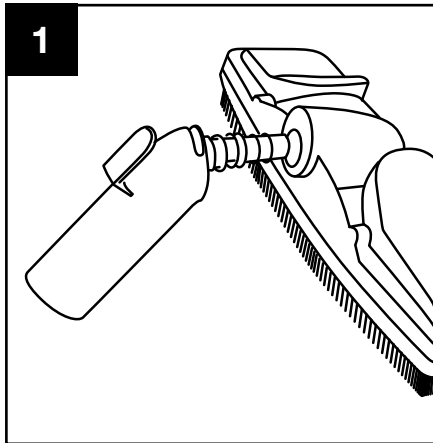

Slide the angled adaptor into the large brush receptacle. The adaptor must be angled down.

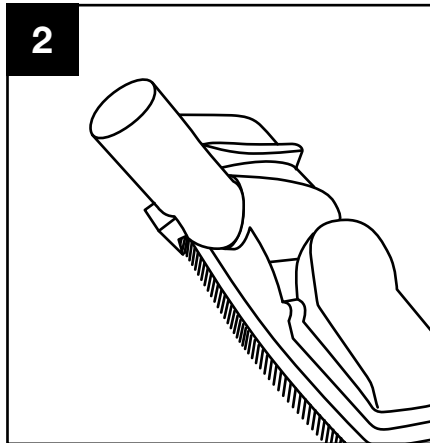

Rotate the adaptor 90° to set into place. Align the brush adaptor with the end of the extension wand so that the oval hole on the adaptor aligns with the lock/release button on the wand.

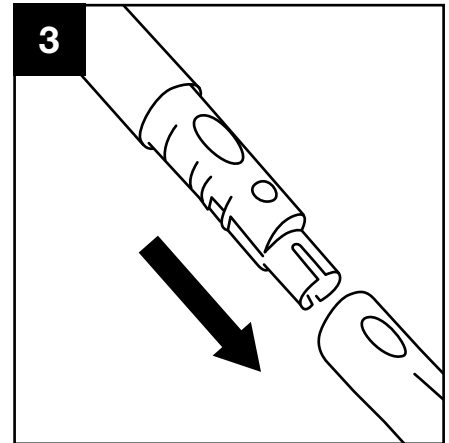

Press down on the lock/release button. While continuing to hold button down, slide brush head adaptor onto extension wand. Press firmly until button snaps into hole.

Cleaning Cloth

Never remove the cleaning cloth while the machine is in operation or warm to the touch.

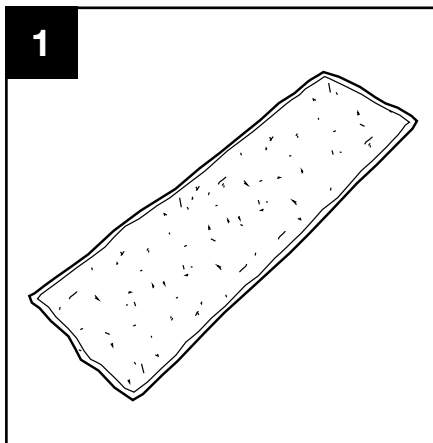

Lay one cleaning cloth on a flat surface.

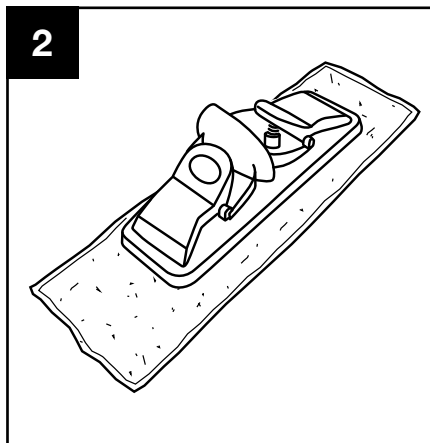

Place the large brush over the cleaning cloth.

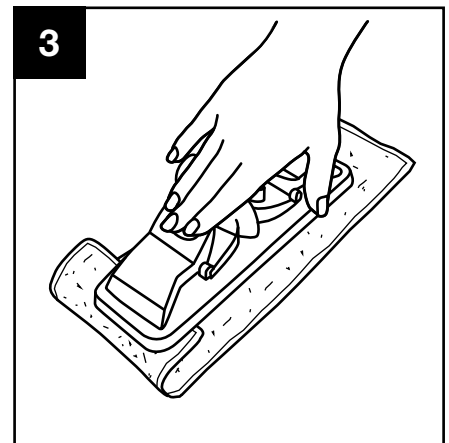

Press down on a clip on the brush and fold the end of the cloth beneath the clip. Release the clip to fasten the cloth into place. Repeat for the opposite side.

The large brush and cleaning cloth are perfect for use on these hard floor surfaces:

- Stained Concrete
- Granite
- Linoleum
- Ceramic Tile
- Marble
- Vinyl

WARNING: Do not use on unsealed hard wood, laminate flooring or unglazed ceramic surfaces. Surfaces that are not properly sealed may be warped or damaged by exposure to heat and moisture. Always test a small area before beginning.

Cleaning and Storage

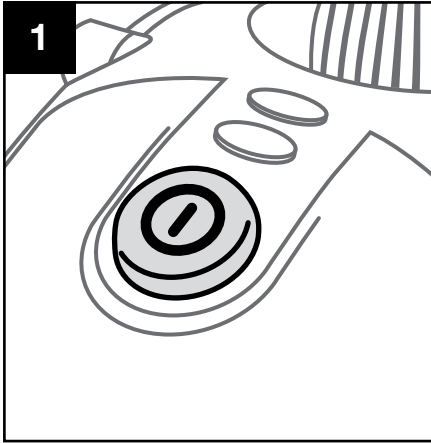

Set the ON/OFF switch to off and unplug the power cord from the electrical outlet.

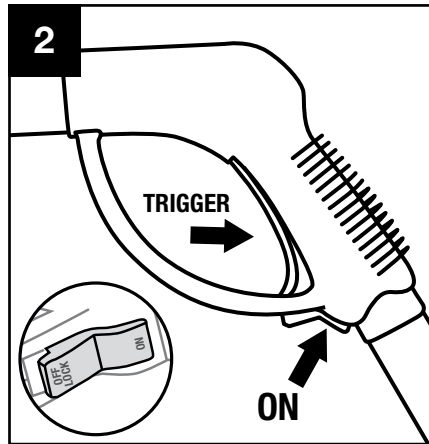

Release all remaining steam from tank by pressing the steam nozzle flow trigger (the Red safety switch must be in the ON position).

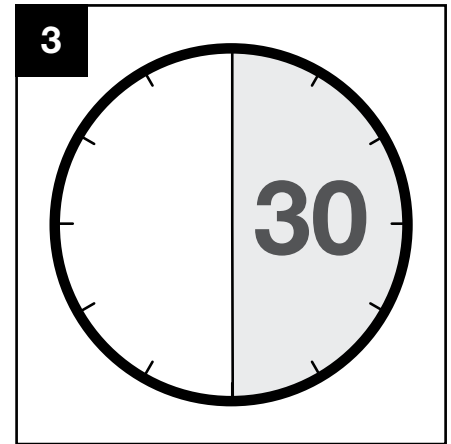

Allow the unit to completely cool (at least 30 minutes).

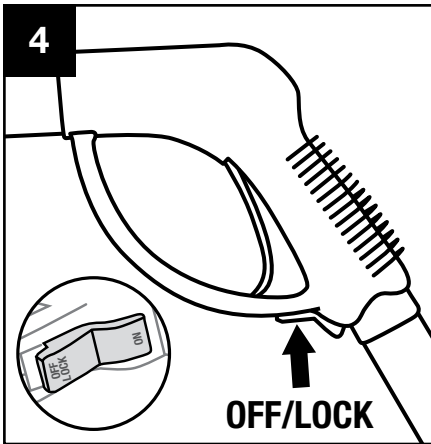

Lock the steam nozzle flow trigger into the off position and remove all accessories from the trigger.

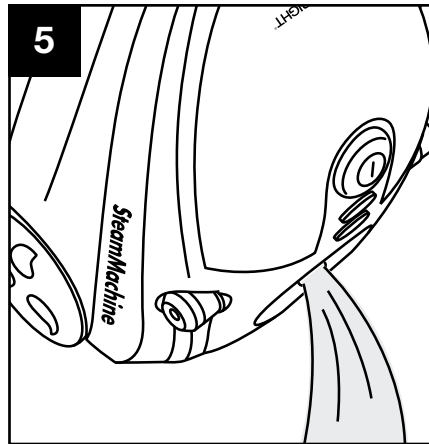

Drain any remaining water from the tank. NEVER store the unit with water in the tank.

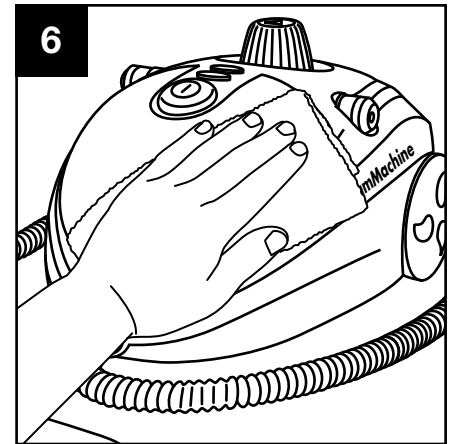

Wipe the unit with a cloth and store in a cool, dry location.

Mineral Build-Up

If your municipal water supply contains high mineral content it is **HIGHLY RECOMMENDED** to use distilled or de-mineralized water when using your SteamMachine. If you are unable to use distilled water it is recommended to employ the following cleaning procedure prior to storing the unit.

WARNING: NEVER clean the water tank while the unit is plugged into an outlet.

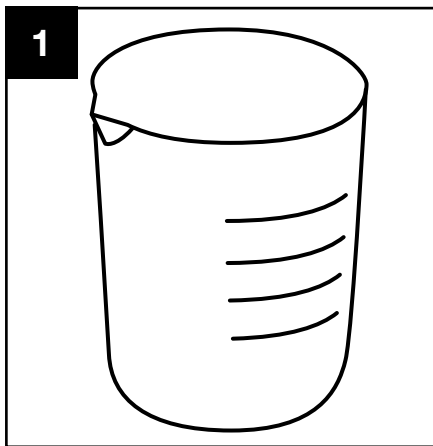

Use a measuring cup to mix 8 oz. of vinegar and 8 oz of water.

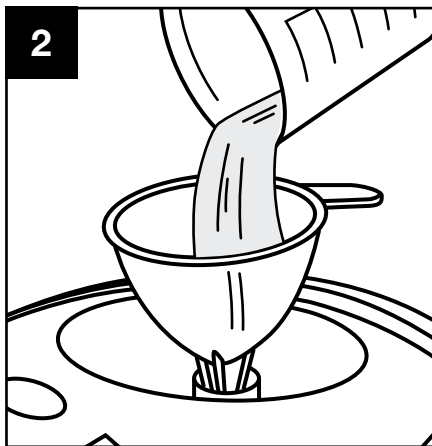

Use the funnel to pour the solution into the water tank.

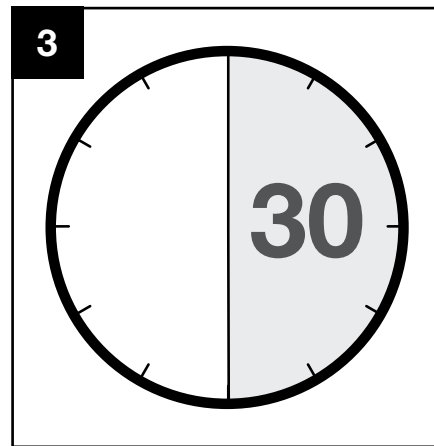

Allow to stand for 30 minutes.

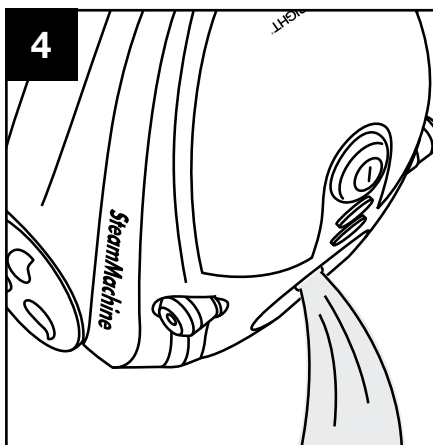

Drain the water-vinegar solution from the tank.

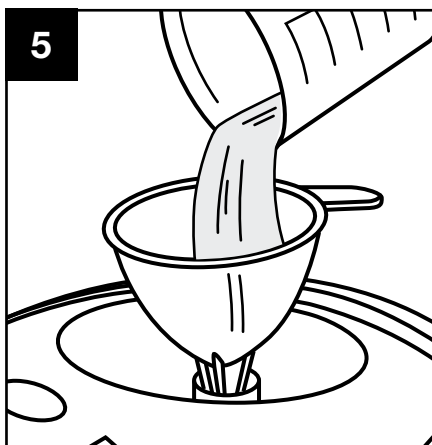

Rinse water tank with fresh water and repeat steps 1 through 5 until vinegar odor dissipates.

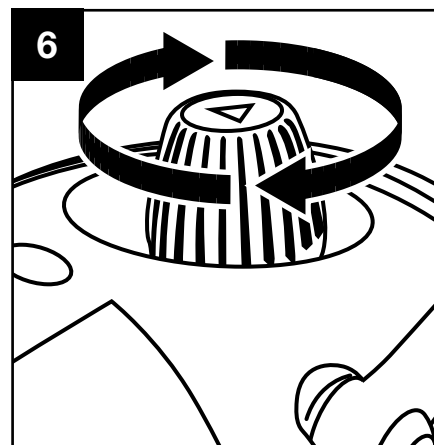

Replace the water tank safety cap and store in a cool, dry location.

Troubleshooting

PROBLEM	CAUSE	REMEDY
1. Unit fails to heat up. Red Power light DOES NOT illuminate when ON/OFF switch is set to ON.	A. Unit is not plugged in. B. Loose electrical connection. C. Unit is damaged or in need of repair.	A. Check wall outlet. B. Discontinue use and call Customer Service. C. Discontinue use and call Customer Service.
2. Unit fails to heat up. Red Power light DOES illuminate when ON/OFF switch is on.	A. Water tank is empty. B. Mineral build-up in unit. C. Unit is damaged or in need of repair.	A. Refer to Filling Water Tank procedure on Page 5. B. Refer to Mineral Build-up section on page 9 for cleaning procedure. C. Discontinue use and call Customer Service.
3. Steam output is weak or intermittent	A. Water level in tank is running low. B. Steam hose may be kinked internally. C. Mineral build-up in unit.	A. Refer to Filling Water Tank procedure on Page 5. B. Remove kinks from steam hose. Rotating the steam gun around may help remove kinks. C. Refer to Mineral Build-up section on page 9 for cleaning procedure.
4. Excessive amounts of water in steam NOTE: The SteamMachine produces a great deal of steam. The steam may condense as water or water droplets in the steam hose and tools and nozzle, which are then expelled when used after a period of cooling. This is normal and not a cause for concern.	A. Water condensation in steam hose. B. Water tank has been over filled. C. Unit has not heated to full operating temperature.	A. Point nozzle towards sink, and shake while pressing steam trigger. B. Filling the water tank with more than 40 oz/ 1200 ml of water interferes with steam production resulting in water condensation. Turn unit off, let it cool and drain some water out of tank. C. Wait until Orange steam pressure indication light has turned off.
5. Accessories do not stay firmly connected to main nozzle	A. Accessories are not properly installed.	A. Refer to accessory installation on page 7.
6. Floor surfaces appear to have streaks after cleaning	A. Cleaning pad is dirty. B. Hard water residue on the floor.	A. Replace the cleaning pad with a clean one. B. Switch to distilled or de-mineralized water.

Parts List

Included in Package

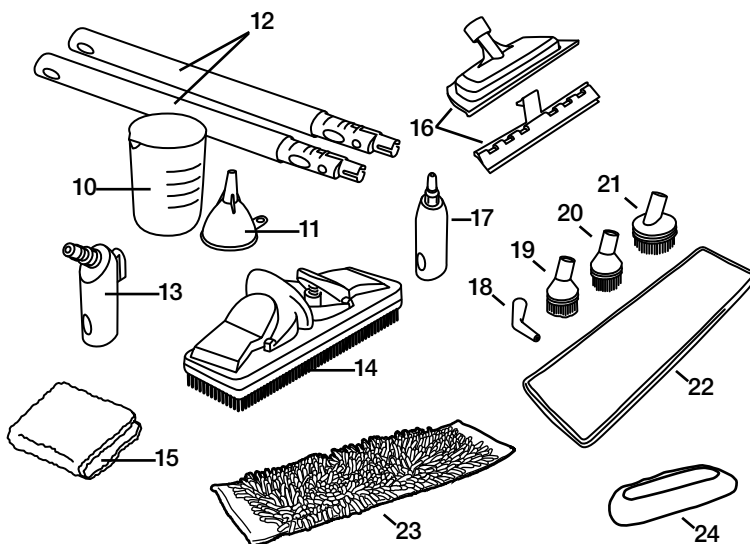
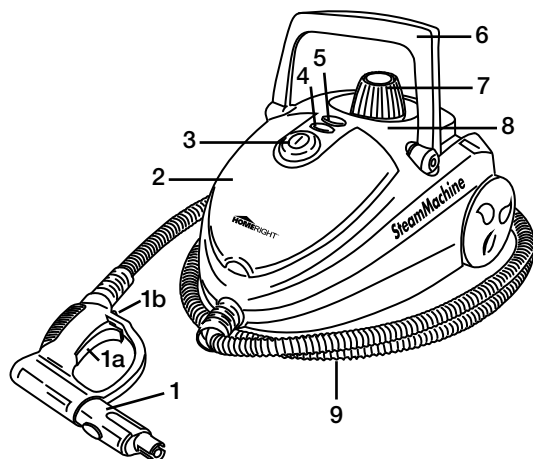

Item	Customer Service Part No.	Description
1	—	Steam Gun
1a	—	Steam Flow Trigger
1b	—	Steam Lock Switch
2	—	Accessory storage area (internal)
3	—	ON/OFF Button
4	—	Red Operating Light
5	—	Orange Steam Generation Light
6	—	Carrying Handle
7	C900061.M	Water Tank Cap
8	—	Water Tank (internal)
9	—	Steam Hose
10	C817558	Measuring Cup
11	C817557	Funnel

Item	Customer Service Part No.	Description
12	C900068.M	Extension Wands (2)
13	C900063.M	Angled Adaptor for Large Brush
14	C900066.M	Large Cleaning Brush
15	C817556	Microfiber Cleaning Towel
16	C900065.M	Squeegee and Fabric Steamer*
17	C900062.M	Straight Adaptor
18	C900067.M	Jet Nozzle*
19	—	Small Brass Utility Brush*
20	—	Small Nylon Utility Brush*
21	—	Large Nylon Utility Brush*
22	C800937.M	Microfiber Pad for Large Cleaning Brush – Pack
23	C800938.M	Chenille Mop Pad – 1 Pack
24	C817755	Fabric Bonnet for Fabric Steamer – 1 Pack

Optional Accessories Available (Not Included)

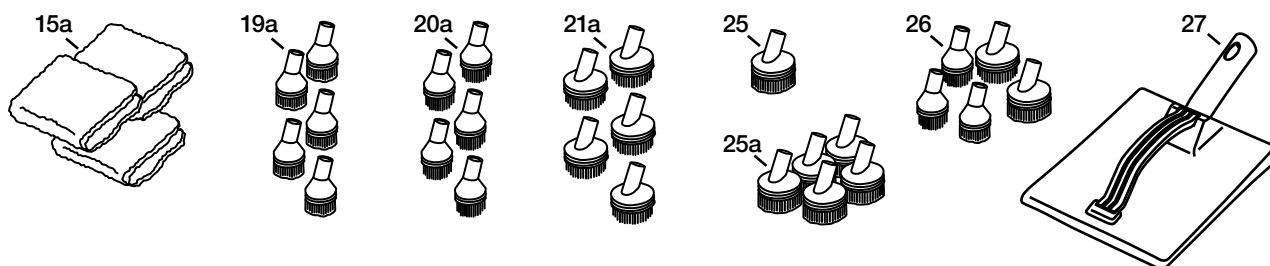

Item	Customer Service Part No.	Description
15a	C800944.M	Microfiber Cleaning Towel – 3 Pack
19a	C800945.M	Small Brass Utility Brush – 5 Pack*
20a	C800947.M	Small Nylon Utility Brush – 5 Pack*
21a	C800948.M	Large Nylon Utility Brush – 5 Pack*
24a	C900069.M	Fabric Bonnet – 3 Pack

Item	Customer Service Part No.	Description
25	—	Large Brass Utility Brush*
25a	C800946.M	Large Brass Utility Brush – 5 Pack*
26	C900050.M	Nylon and Brass Utility Brush Pack – 5 Pieces* Includes: 2 small nylon, 1 large nylon, 1 small brass and 1 large brass
27	C800893	Wallpaper Steam Plate Assembled

For a full listing of available accessories or if you cannot obtain parts and accessories at your local retail dealer, call or visit homeright.com

*Requires Straight Adaptor (17) to use.

HomeRight
1661 94th Lane N.E.
Minneapolis, Minnesota 55449-4324
Phone: 763-780-5115 • 1-800-264-5442
8:00 a.m. to 5:00 p.m. CST.

Two Year Limited Warranty

HomeRight® warrants this product from any defects in material or workmanship for two years from the date of purchase, when it is maintained and operated according to the instructions in the Instruction Manual. HomeRight will repair or replace defective product at no charge and return postage-paid to you. This warranty does not cover accessories or damage resulting from improper use, negligence, accidents, or normal wear and tear. This warranty is void if used for commercial or rental purposes.

Any implied warranty or merchantability or fitness for a particular purpose is limited to two years following date of purchase.

Responsibility is limited to the repair or replacement for defects in material or workmanship. HomeRight shall not in any event be liable for any incidental or consequential damages of any kind, whether for breach of this warranty or any other reason.

Some states do not allow a limitation on how long implied warranties last or the exclusion of incidental or consequential damages, so the above limitation and exclusion may not apply to you.

This warranty gives you specific legal rights, and you may also have other rights which vary from state to state.

For warranty service, send your product postage-paid along with a description of the problem to: HomeRight, Warranty Dept., 1661 94th Lane N.E., Minneapolis, MN 55449 or call customer service at 1-800-264-5442, 763-780-5115 for further assistance.

Garantía limitada por dos años

HomeRight garantiza ce produit contre tout défaut de matériaux et de main-d'œuvre pendant une période de deux ans à partir de la date d'achat s'il est entretenu et utilisé selon les directives contenues dans le manuel d'instruction. HomeRight procédera aux réparations nécessaires ou au remplacement sans frais et vous renverra l'outil port payé. Cette garantie ne couvre pas les accessoires, ni les dommages découlant d'une utilisation inadéquate, d'une négligence, d'un accident ou de l'usure et de la détérioration normales. Cette garantie est nulle si l'appareil est utilisé à des fins commerciales ou de location.

Toute garantie implicite quant à la qualité marchande ou à l'adaptation à un usage particulier est limitée à deux ans suivant la date d'achat.

La responsabilité de la société se limite aux réparations ou au remplacement suite à des défauts éventuelles de matériaux ou de main-d'œuvre. HomeRight décline toute responsabilité pour tout dommage accessoire ou indirect de quelque nature que ce soit, y compris pour violation de cette garantie ou tout autre motif.

Certaines provinces interdisant de limiter la durée des garanties implicites et d'exclure les dommages directs ou indirects, il se peut que les limitations et exclusions ci-dessus ne vous concernent pas.

La présente garantie vous accorde des recours juridiques particuliers et il se peut que vous jouissiez d'autres recours, qui peuvent varier d'une province à l'autre.

Pour le service de garantie, faites parvenir le produit dûment affranchi, accompagné d'une description du problème à : HomeRight, Warranty Dept., 1661 94th Lane N.E., Minneapolis, MN 55449, États-Unis, ou appelez le service à la clientèle au 1 800 264-5442, (763) 780-5115 pour obtenir une assistance supplémentaire.

Garantie limitée de deux ans

HomeRight garantiza este producto contra todo defecto de material o mano de obra, por dos años a partir de la fecha de compra, siempre que se mantenga y maneje de acuerdo con las indicaciones del manual de instrucciones. HomeRight reparará o cambiará el producto defectuoso sin costo para usted y se lo enviará con el franqueo prepago. Esta garantía no cubre accesorios ni daños resultantes del uso indebido, negligencia, accidentes o desgaste normal. La garantía es nula si se la utiliza con fines comerciales o de alquiler.

Cualquier garantía implícita o de comercialización o de idoneidad para un propósito específico se limita a dos años a partir de la fecha de la compra.

La responsabilidad de la compañía se limita a la reparación o al reemplazo de los defectos de material o mano de obra. Bajo ninguna circunstancia, HomeRight se hará responsable por daños accidentales o derivados de ningún tipo que se originen por la violación de esta garantía o por cualquier otro motivo.

Algunos estados no permiten limitar la duración de las garantías implícitas ni excluir los daños accidentales o derivados, de modo que los límites y las exclusiones anteriores podrían no corresponder en su caso.

Esta garantía le otorga derechos legales específicos, a los cuales se pueden agregar otros que varían de estado en estado.

Para obtener servicio cubierto por la garantía, envíe su producto con franqueo pagado y una descripción del problema a la siguiente dirección: HomeRight, Warranty Dept., 1661 94th Lane N.E., Minneapolis, MN 55449; o llame al departamento de servicio al cliente al 1-800-264-5442, 763-780-5115 si requiere más ayuda.

HomeRight®

1661 94th Lane N.E.
Minneapolis, Minnesota 55449-4324
Phone 763-780-5115
Customer Service Line 1-800-264-5442
8:00 a.m. to 5:00 p.m. CST
www.homeright.com
Printed in China

HomeRight®

1661 94th Lane N. E.
Minneapolis, MN 55449-4324
Tel: 763-780-5115
Servicio al cliente: 1-800-264-5442
8:00 a.m. a 5:00 p.m.
(hora del Centro de EE. UU.)
www.homeright.com
Hecho en China

HomeRight®

1661 94th Lane N. E.
Minneapolis, MN 55449-4324
Tél. : 763-780-5115
Service à la clientèle : 1-800-264-5442
8 h à 17 h, heure normale du Centre
www.homeright.com
Fabriqué en Chine

Register Online Today To Activate Your Two-Year Warranty
Enregistrez en ligne aujourd'hui Pour lancer votre garantie de deux ans
Regístrese en línea hoy Para activar su garantía de dos años

<http://www.homeright.com/product-registration>