

Details of accessories

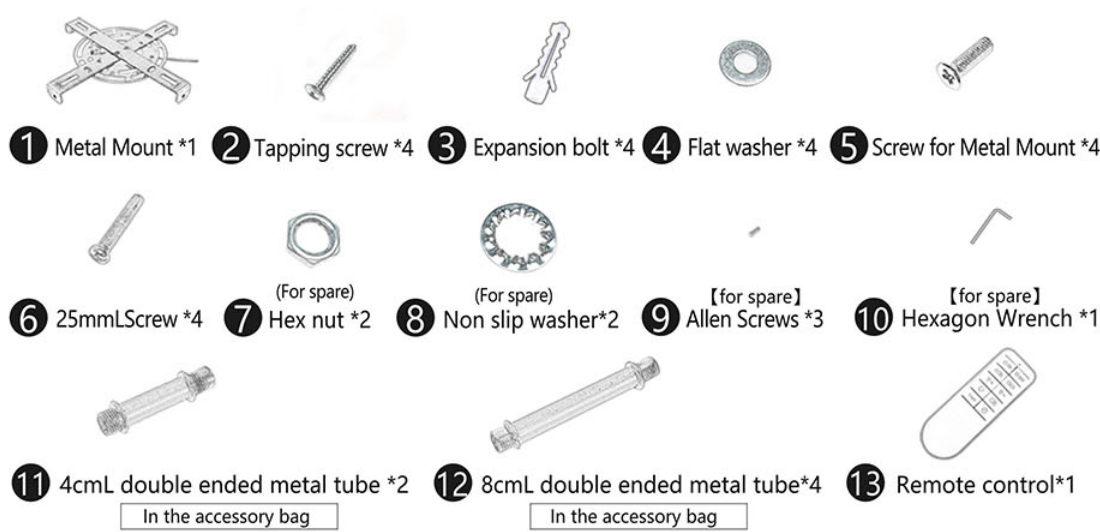

Installation instructions for Metal mount

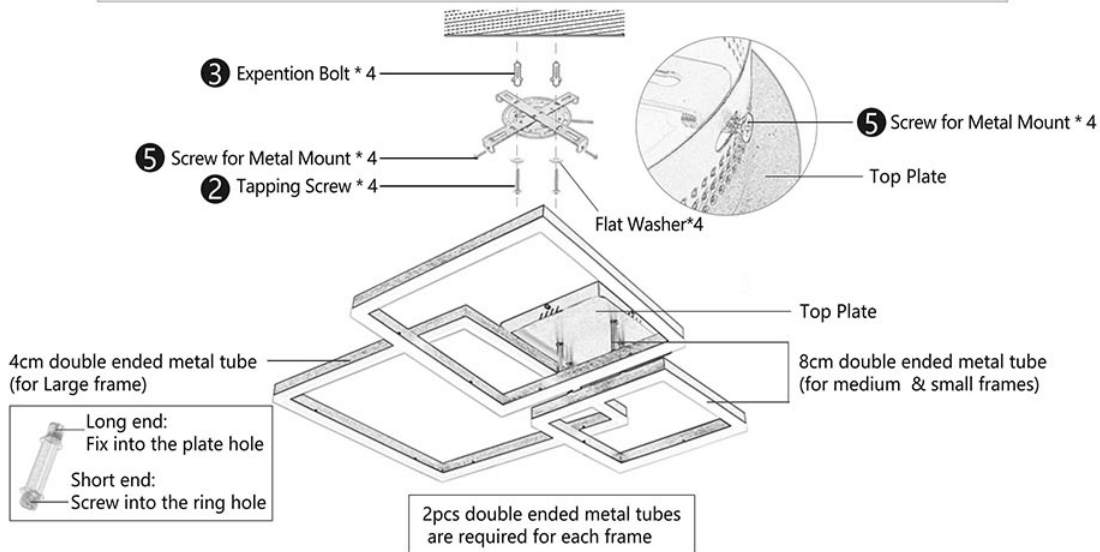

Steps to install the mount:

- Step 1: Take the mount to check the lighting location on the ceiling, and mark the screw hole with a marking pen.
- Step 2: Drill holes at marked locations with electric drills, and then use a hammer to drive the expansion bolts into the holes.
- Step 3: Fix the mount into the expansion bolts with tapping screws 【Each tapping screw should be set with one flat washer】
- Step 4: Assemble the lighting frame with double ended metal tubes, test the electricity before installation to ceiling
- Step 5: Connect the driver of the lamp with the power cord of the ceiling, and then fix the lamp to the metal mount with screws.