

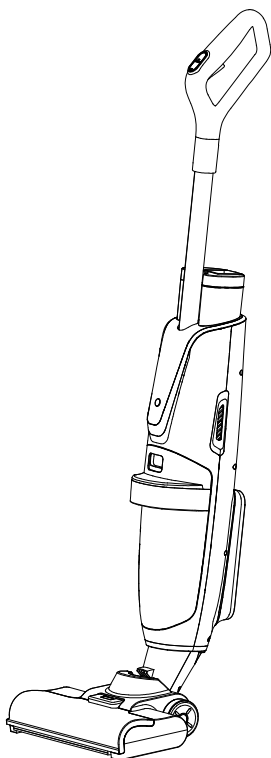

Vacuum Sweep ⊕ Mop

Model - VSM 6000



OWNER'S MANUAL

Read the instructions carefully and keep for future reference

Warranty

Equator Appliances undertakes to the consumer-owner to repair or, at our option, to replace any part of this product which proves to be defective in workmanship or material under normal personal, family or household use, in USA and Canada, for a period of one year from the date of original purchase. During this period, we will provide all labor and parts necessary to correct such defect, free of charge, if the appliance has been assembled and operated in accordance with the written instructions with the appliance.

Exclusions

In no event shall Equator Appliances be liable for incidental or consequential damages or for damages resulting from external causes such as abuse, misuse, incorrect voltage or acts of God. This warranty does not cover service calls which do not involve defective workmanship or materials covered by this warranty. Accordingly, diagnosis and repair costs for a service call which does not involve defective workmanship or materials will be the responsibility of the consumer-owner.

Specifically, the following work is not covered under warranty and does not constitute warranty work:

Installation – e.g. Charging Station not correctly connected

Maintenance – e.g. Failure to clean roller brush, HEPA filter, and other parts

Mishandling – e.g. Connecting parts incorrectly

Most work is covered. The defining factor is, has the machine malfunctioned (Equator Appliances is responsible) or has the customer omitted or done something to cause the appliance to malfunction (customer is responsible). Some States do not allow the exclusion or limitation of incidental or consequential damages, so the above limitation or exclusion may not apply to you.

WARRANTY SERVICE

This warranty is given by:

Equator Appliances

10222 Georgibelle Drive, Suite 200,
Houston, Texas 77043-5249

For Customer Service:

Appliance Desk

Phone/Text: 1-800-776-3538

Email: Service@ApplianceDesk.com

Web: www.ApplianceDesk.com

Business hours: 9:00 am to 5:00 pm weekdays

You can register your Warranty by either of the following methods:

1. Scan the QR Code



1. Open Smart Phone
2. Open Photo
3. Scan QR Code
4. Click the Link

2. Register online at ApplianceDesk.com/Warranty

GENERAL

Since it is a responsibility of the consumer-owner to establish the warranty period by verifying the original purchase date, Equator Appliances recommends that a receipt, delivery slip or some other appropriate payment record be kept for that purpose.

This warranty gives you specific legal rights, and you may also have other rights which vary from State to State.

All rights reserved. Manual subject to change without notice.

Safety

Please follow the safety precautions listed below:

This Vacuum Sweep Mop is not intended for use by children or persons with reduced physical, sensory, or mental capabilities, or lack of experience and knowledge. Children should be supervised to ensure that they do not play with the appliance.

Use only the power adaptor that is included with this appliance.

Stop using the Vacuum Sweep Mop immediately and unplug it if there is an abnormality or malfunction, including the following:

- The power Adapter Plug or power adapter cord is abnormally hot.
- The machine emits a burnt smell.
- Part of the machine is broken, loose, or emits abnormal sounds.

Insert the power Adapter Plug into the socket firmly. If the power adapter is loose after being plugged into a power outlet, please do not use the power outlet.

Before cleaning the Docking Station, please unplug the power adapter to prevent electric shock. Use a dry cloth periodically to remove dust from the power adapter. Do not plug or unplug the power adapter with wet hands.

When opening the Window Cover to replace or clean the Carpet or Roller Brush, please pay attention to the sharp blade to prevent injuries.

Do Not:

- Immerse the Docking Station or any electrical component in water.
- Disassemble, repair, or modify the product.
- Put fingers or toes into the machine rotation shaft.
- Touch the Roller while the machine is running.
- Modify, damage, forcibly bend, twist, or clamp the power adapter cord.
- Use a damaged power adapter or power cord.
- Use any third-party battery or power adapter.
- Use to clean flammable, volatile liquids or chemical spills.
- Use to clean sharp items such as glass, nails, etc.

Please dispose off this appliance in accordance with local regulations.

Parts and Accessories

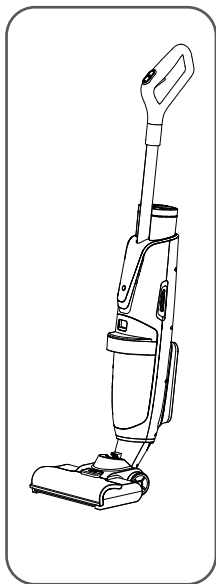

Main body

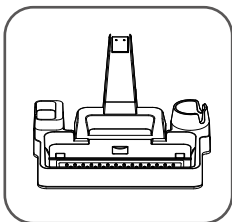

Charging station

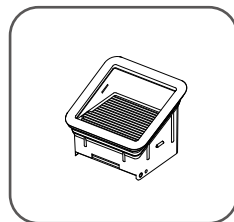

HEPA Filter

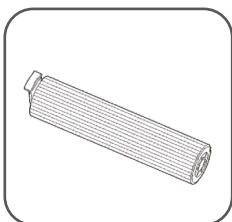

Roller brush

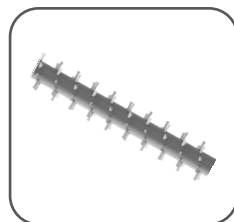

Carpet brush

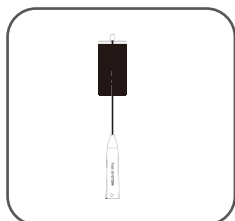

Cleaning Brush

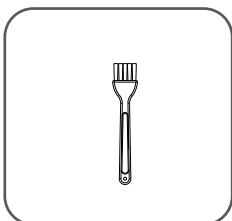

HEPA Cleaning Brush

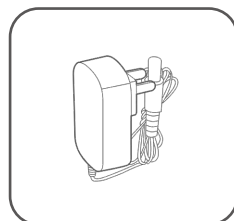

Adapter

Product Description

This appliance is intended for household use.

The Vacuum Sweep Mop is a multiple function appliance, which can sweep, vacuum and mop many types of floor surfaces and carpets.

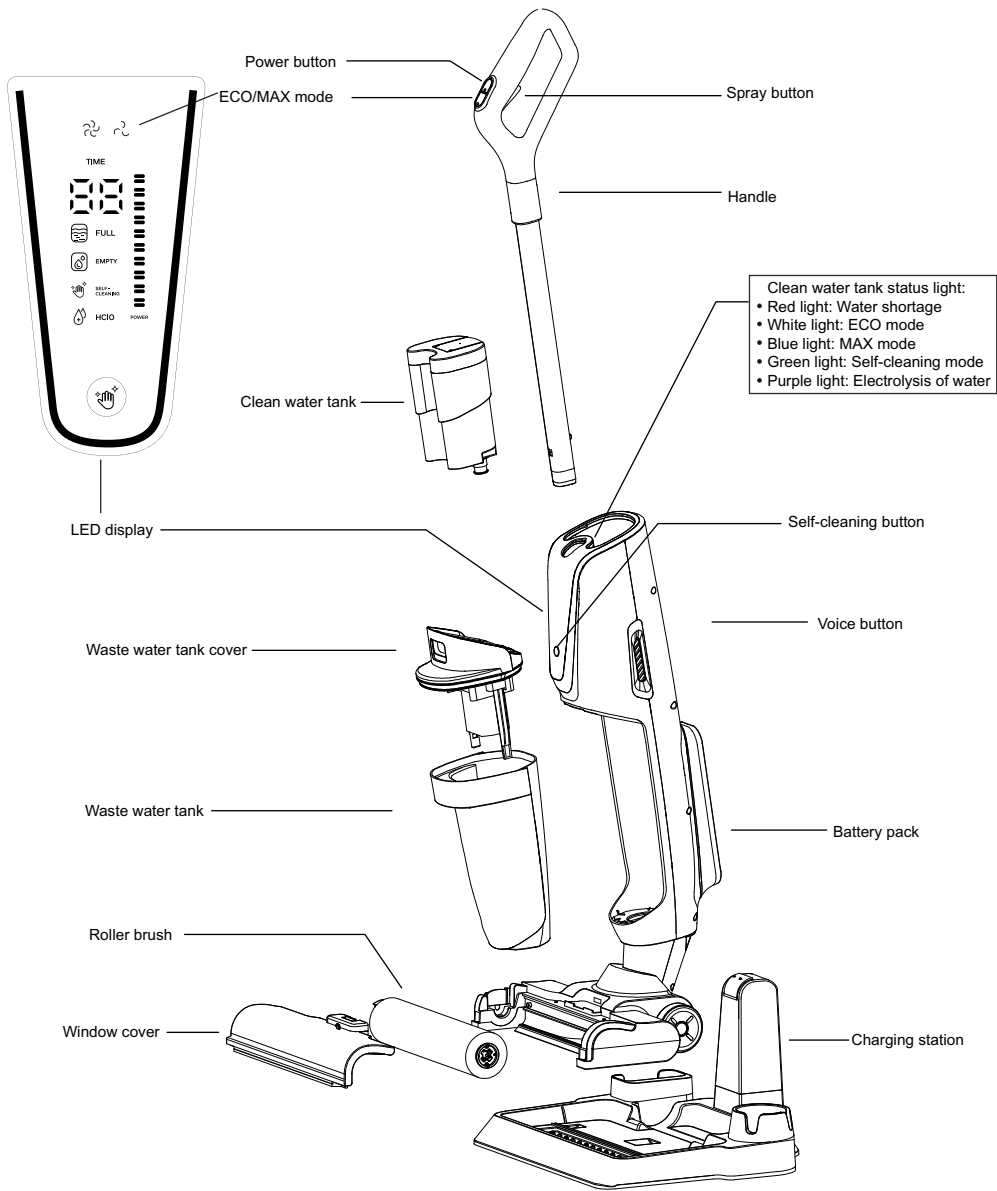

Digital Display

		The indicator will light up when the cleaner is in Eco Mode
		The indicator will light up when the cleaner is in Max Mode.
		The Digital Display shows the time or the fault code The fault code is displayed to help identify the problem
		The indicator will flash RED when Waste Water Tank is full.
		The indicator will flash RED when Clean Water Tank needs clean water.
		The indicator will light up WHITE when the cleaner is in Self-cleaning Mode.
		Battery Indicator will flash white when charging, and will stop when fully charged.
		The indicator light will light up in purple when spraying water manually

Specification Table

Model	VSM 6000 W/B
Water Tank Capacity	Clean - 600 ml / Waste - 550 ml
Adaptor Input / Output	100V ~ 60Hz 0.8A / DC 27V 0.8A
Rated Power	150W
Battery Capacity / Charging Time	2600 mAh / 3Hrs
Net Weight	8.4 lbs
Product Dimensions (HxWxD)	46" x 9.44" x 11"

Product Assembly

To assemble, insert the Handle into the Main Body until you hear a click that will confirm the Handle is in place. To remove the Handle, insert a screwdriver or Allen key into the small hole located at the back of the Main Body and press while lifting the Handle up.

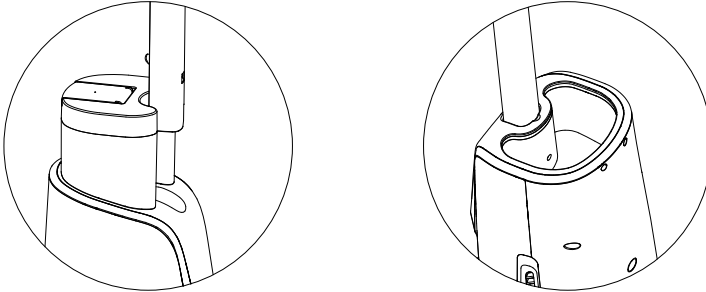

Pull out the Clean Water Tank from the Main Body. Lift open the top cover of the tank, fill with tap water, close cover firmly and replace in the Main Body so it clicks into place.

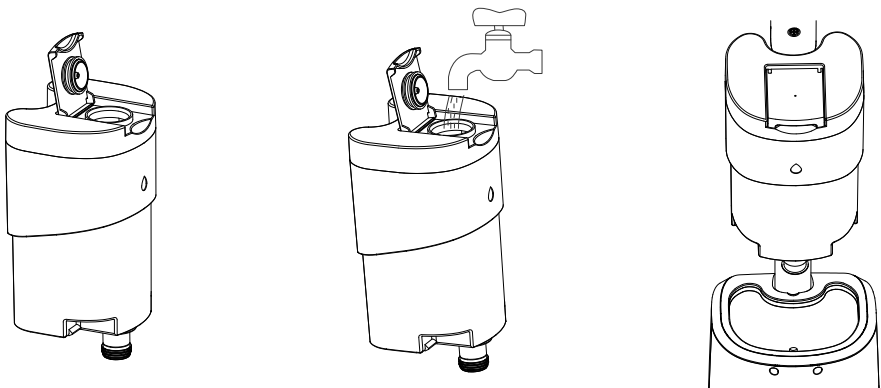

Place the Waste Water Tank at an angle at the base of the Main Body and then push into place, ensuring that you hear a click confirming that it has been correctly installed.

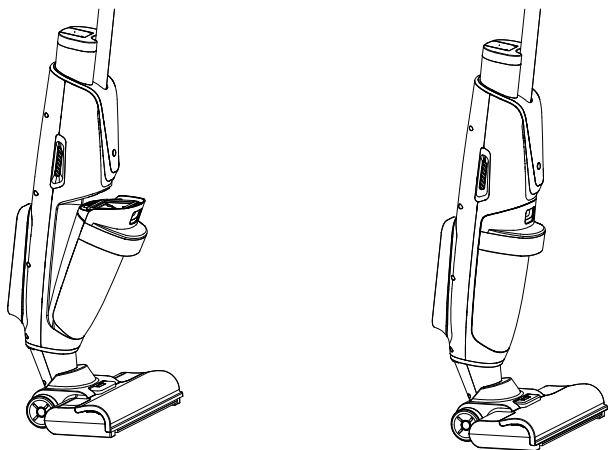

Install the Roller Brush or Carpet Brush by aligning the groove on the right side of the brush with the drive shaft and then press down on the Roller or Carpet Brush. Then attach the Window Cover by snapping on the side buckles and latch, ensuring you hear a click confirming correct installation.

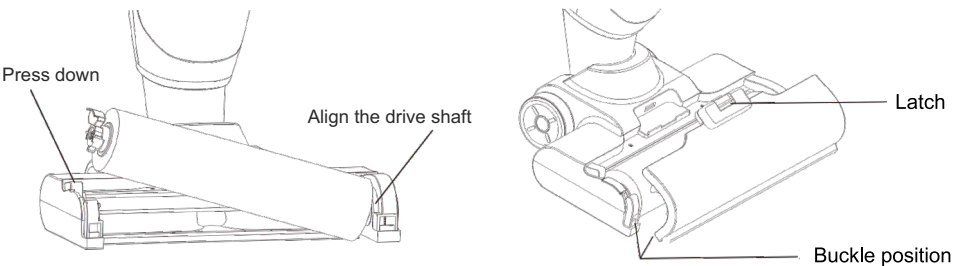

Charging

Insert the Adapter into the Charging Station port and plug the other end into the power outlet. Ensure that the Power button is off. Place the Vacuum Sweeper Mop Main Body onto the Charging Station ensuring that there is a battery connection and the unit can start charging.

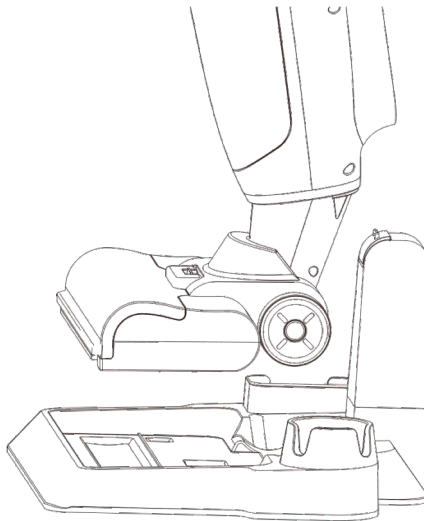
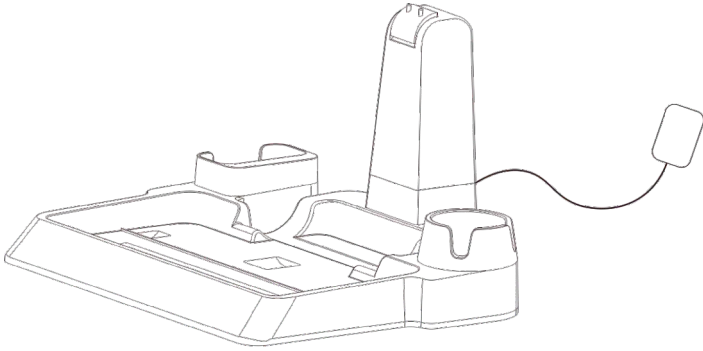

Operation

Operate the Vacuum Sweep Mop by following these steps:

- Remove the Vacuum Sweep Mop from the Charging Station.
- Place on the floor and press the Power button.
- Press the Mode button to select either Eco or Max.
- Press the Voice on or off setting at the back of the unit. Voice on will direct you on how to operate, clean, etc.

Ensure that the Clean Water Tank is full and the Waste Water Tank is empty before starting to use the appliance.

This appliance has the dual action of vacuuming and sweeping as you push it forward and moping when you pull it back.

- Tilt the handle of the appliance and push forward, but do not press the Spray button. This will sweep and vacuum the area.
- Then, while pulling it back, press the Spray button, which will wet the floor and allow the unit to mop the area.
- For carpet cleaning do not press the water spray button, and use it only as a vacuum cleaner.

In this single step on push & pull, the unit will both vacuum and mop the floor.

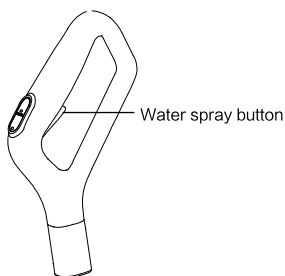

Push to sweep
and vacuum



Pull to mop

Cleaning and Maintenance

Routine Cleaning

After each use, the appliance needs to be cleaned. Place the Main Body onto the Charging Station. Ensure the Clean Water Tank is full and press the Self-Clean button. During the cleaning process the display time on the display will count down from 59 to 0 seconds.

After self-clean is complete, unplug the appliance and remove the Waste Water Tank. Empty the waste water and debris, rinse the container, and replace it in the Main Body.

Remove the Roller Brush periodically to clean. Frequency of cleaning will depend on usage. Open the Window Cover. Release the Clip, lift and pull out the Roller Brush. Wash with mild soap and detergent and let dry completely before placing it back in the unit. Clean the Carpet Brush in the same way. The Roller Brush and Carpet Brush are sold separately and can be replaced every 3 - 6 months.

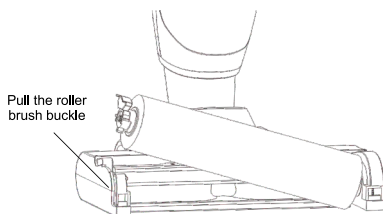

After each use, remove the HEPA Filter and clean with the small HEPA Cleaning Brush. Allow the HEPA Filter to dry completely before replacing it. The HEPA Filter is sold separately and can be replaced every 3 - 6 months



Troubleshooting

Does not charge

- Check if the Adapter Plug is connected to the power source.
- Check if there is water or foreign object on the magnetic connector of the Adapter. Please wipe it dry and clean.
- Check if the Main Body and the Charging Station are properly connected.

Appliance does not start

- The battery is low. Please charge it.
- The Roller or Roller Brush is stuck. Please open the Window Cover to clean the parts.

The Controls don't work

- The handle is not correctly connected
- The battery is low

No water or very little water comes out

- Check if the Main Body is placed on the Charging Station properly.
- Check if the clean water tank is empty or the waste water tank is full.
- Check if the clean water tank is installed correctly.
- Check if the charging connector and the Charging Station have water residue or are covered by a foreign object.

Clean water tank is leaking

- The tank is not installed correctly
- The cap is not closed completely

Trash not picked up

- Check if the Roller is broken or dry. If the roller is dry, please immerse it in water till it is completely soft.
- Check if the Roller Brush is broken.
- The HEPA Filter is blocked or wet

Water stain on the floor

- Check if the Roller is broken or dry. If the roller is dry, please immerse it in water till it is completely soft.

Appliance doesn't move smoothly

- The Roller Brush or Carpet Brush are not installed correctly

Self-clean doesn't work

- Wastewater tank is full
- No water in clean water tank

Wastewater overflows

- Check if the wastewater tank is full.

Error Code Table

The error code is displayed on the LED Display, which helps to identify the problem. The causes and the possible solutions are provided below.

Error Code	Causes	Solutions
E 1	Battery disconnect	Replace the battery
E2	Rechargeable battery voltage is too low	Replace the battery
E3	Rechargeable battery voltage difference is too large	Replace the battery
E4	Temperature control of battery is abnormal	Replace the battery
E5	High discharging temperature	Battery pack over temperature,do not use until the battery temperature is restored
E6	High charging temperature	Battery pack over temperature, do not charge until the battery temperature is restored
E7	Low charging temperature	Ensure the ambient temperature is above 5°C
F 1	Charging over-current	Please confirm whether the charger is original
F2	short-circuit protection	Please contact customer service
F3	Discharge Over-current	Please contact customer service
F4	Roller brush Discharge Over-current	Check whether there is any foreign body to be cleaned at the roller brush. If the fault still exists, please contact customer service
F6	Waste water tank not installed	Install waste water tank

Name and Content of Hazardous Substances

Component	Content of Hazardous Substances					
	Lead (Pb)	Mercury (Hg)	Cadmium (Cd)	Chromium VI (CrVI)	Polybrominated biphenyls (PBB)	Polybrominated diphenyl ethers (PBDE)
plastic	O	O	O	X	O	O
metal	O	O	O	O	O	O
Mercury(Hg)	O	O	O	O	O	O
Printed circuit board assembly	O	O	O	O	O	O
Other metal structural parts	O	O	O	X	O	O
Standard parts (screws, washers, etc.)	O	O	O	X	O	O

This form is prepared in accordance with SJ/T 11364-2014.

O Means that the content of hazardous substance in all materials of the part is below the limit requirements specified in GB/T 26572-2011.

X Means that the content of the hazardous substance in the last one homogeneous material of the part. Exceeds the limit requirements specified in GB/T. 26572-2011.

X Parts shows that due to the current technical and technological level restrictions. It is impossible to realise the complete replacement of non-environmental Protection substances or elements, and it will be gradually improved with the subsequent technical improvement.

* means that only part of the model contains the component.

We reserve the right to changes in text,design,and technical specifications which are subject to change without prior notice.

