

SHOWER DOOR

AMETRINE HEAVY HINGE 60" SHOWER DOOR

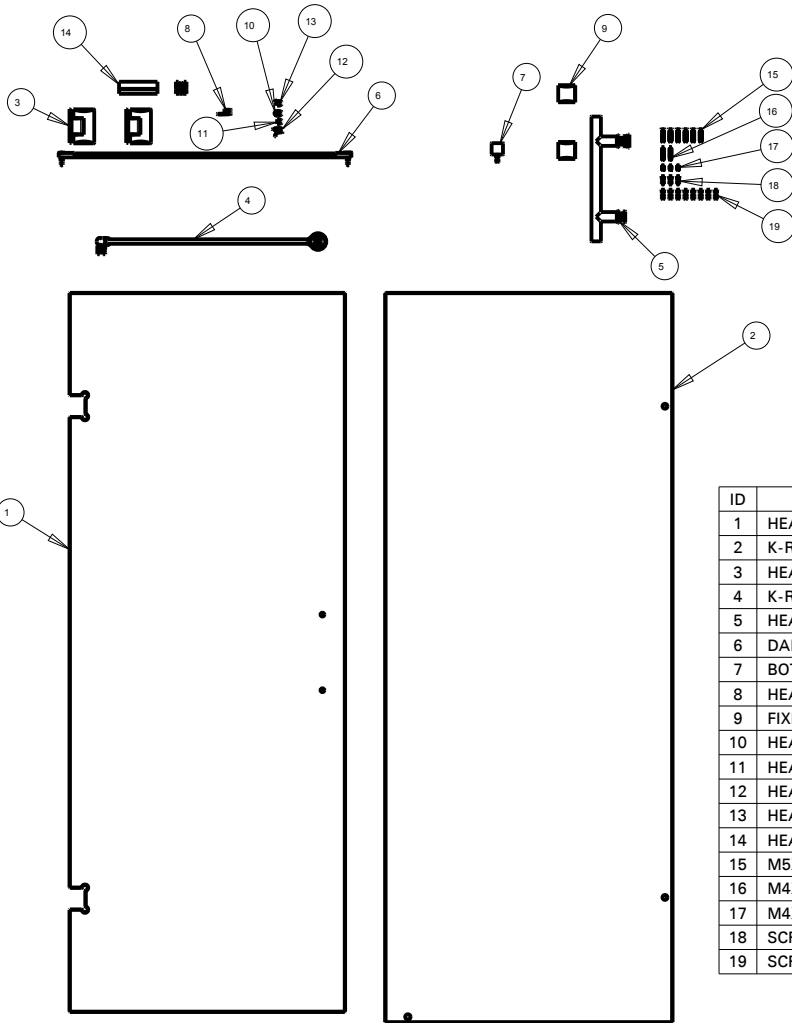

ID	DESCRIPTION	QTY	MATERIAL
1	HEAVY HINGE - GLASS DOOR	1	GLASS
2	K-R12 60" HEAVY HINGE - 60" FIXED GLASS PANEL	1	GLASS
3	HEAVY HINGE - HINGE ASSEMBLY	2	MULTIPLE MATERIALS
4	K-R12 60" HEAVY HINGE - SUPPORT BAR FULL ASSEMBLY	1	MULTIPLE MATERIALS
5	HEAVY HINGE - HANDLE FULL ASSEMBLY	1	MULTIPLE MATERIALS
6	DAM STRIP ASSEMBLY	1	MULTIPLE MATERIALS
7	BOTTOM FIXED SUPPORT PANEL	1	MULTIPLE MATERIALS
8	HEAVY HINGE - STRIKE SEAL	1	PVC
9	FIXED PANEL SPPRT BRCKT ASSEMBLY	2	MULTIPLE MATERIALS
10	HEAVY HINGE - FIXED PANEL SIDE SEAL	1	PVC
11	HEAVY HINGE - BOTTOM SEAL	1	PVC
12	HEAVY HINGE - BOTTOM WATER RETENTION SEAL	1	PVC
13	HEAVY HINGE - LEFT SIDE SEAL WITH WING	1	PVC
14	HEAVY HINGE DOOR INSTALL BLOCK	2	PVC
15	M5X35 WOOD SCREW	6	SS304
16	M4X35 WOOD SCREW	2	SS304
17	M4X16 WOOD SCREW	3	SS304
18	SCREW ANCHOR 6 MM	3	PVC
19	SCREW ANCHOR 8 MM	8	PVC

MATERIAL: Stainless Steel for all support hinges and brackets. Aluminum for Handle and Dam Strip. Finishes to include Brushed Nickel, Chrome and Matte Black.

INSTALLATION: Detailed Instructions, Door Shims and Hardware included for Easy Installation.

UNIQUE FEATURE: Constructed from 304 Stainless Steel.
60" Shower Door fits with an opening of 59- 3/8" – 59- 7/8" (150.8-152.1 cm)

NOTE: Height of 78" (198cm) Required for installation

WARRANTY: 5 Year Limited Warranty.



see what Delta can do