

# HHM7SRWW

## Hotpoint® 6.9 Cu. Ft. Manual Defrost Chest Freezer

### DIMENSIONS AND INSTALLATION INFORMATION

AIR CLEARANCE	
Back Air Clearances (in.)	2
Side Air Clearances (in.)	2

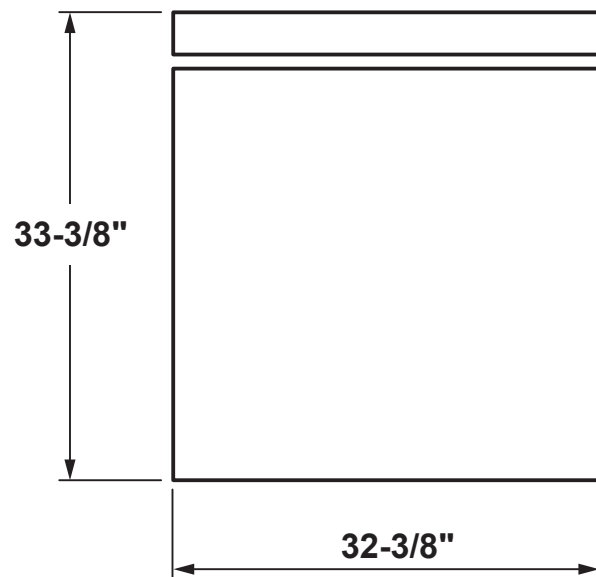

FRONT VIEW

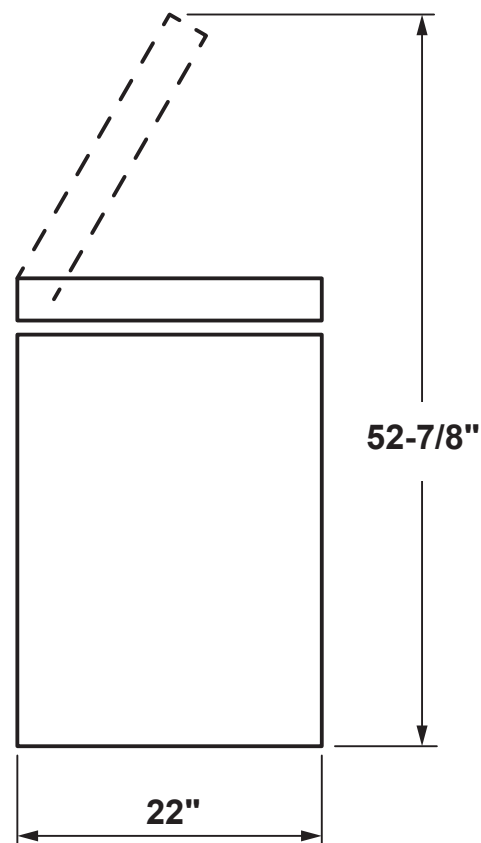

SIDE VIEW

**Hotpoint®**

For answers to your Monogram, GE Café™, GE Profile™, GE Appliances or Hotpoint product questions, visit our website at [geappliances.com](http://geappliances.com) or call GE Answer Center® Service, 800.626.2000.



Specification Created 5/21

# HHM7SRWW

## *Hotpoint® 6.9 Cu. Ft. Manual Defrost Chest Freezer*

### **FEATURES AND BENEFITS**

Total Capacity: 6.9 Cu Ft

ADA Compliant: No

Energy Star: No

Chest or Upright: Chest

Garage Ready: No

Defrost Type: Manual

Defrost Water Drain: Yes

Temperature Alarm: No

Power On Light: Yes

Lock w Key: No

Storage Drawer Material: Wire

Shelf Type: Wire

Control Type: Adjustable Temperature Control

Internal Lighting: No

Power/Ratings: Volts/Hertz/Amps, 115V; 60Hz; 1.7A

Model HHM7SRWW – White

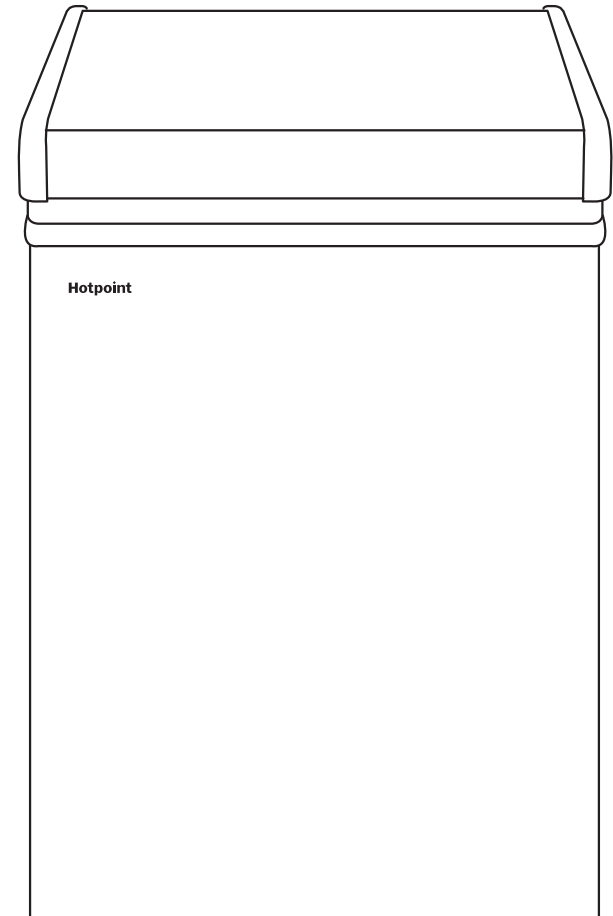

# Hotpoint®