

Accessories Display

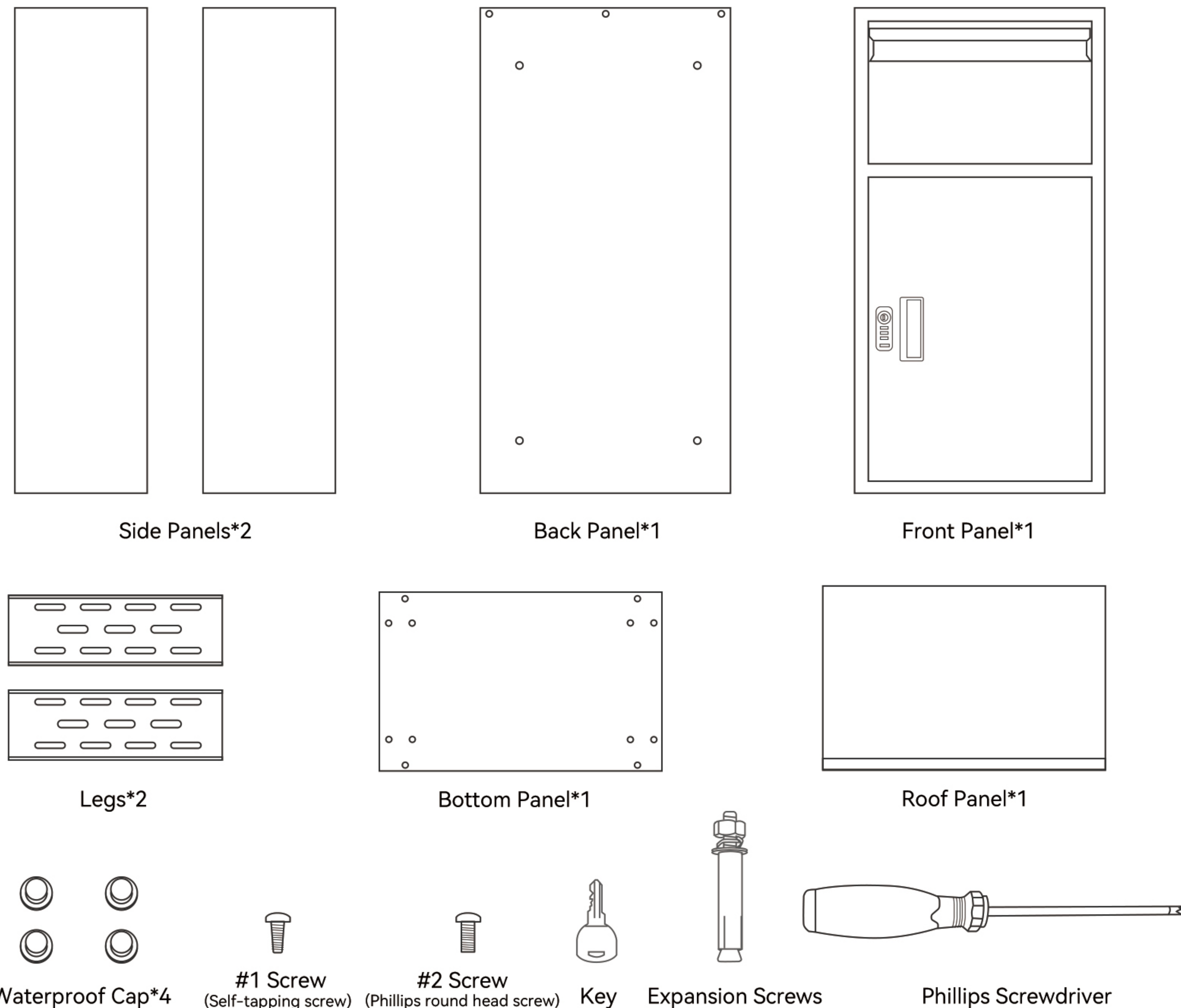

NOTE:

Please contact us if any accessories are missing.

Please refer to the installation video on our product page to help you complete the installation process. If you have any questions, feel free to contact customer service.

Amazon Contact: Log in to your Amazon account > select "Your Orders" > find the order ID > click "Contact Seller"

Installation Guide

Step 1: Install the Side Panels and Front Panel

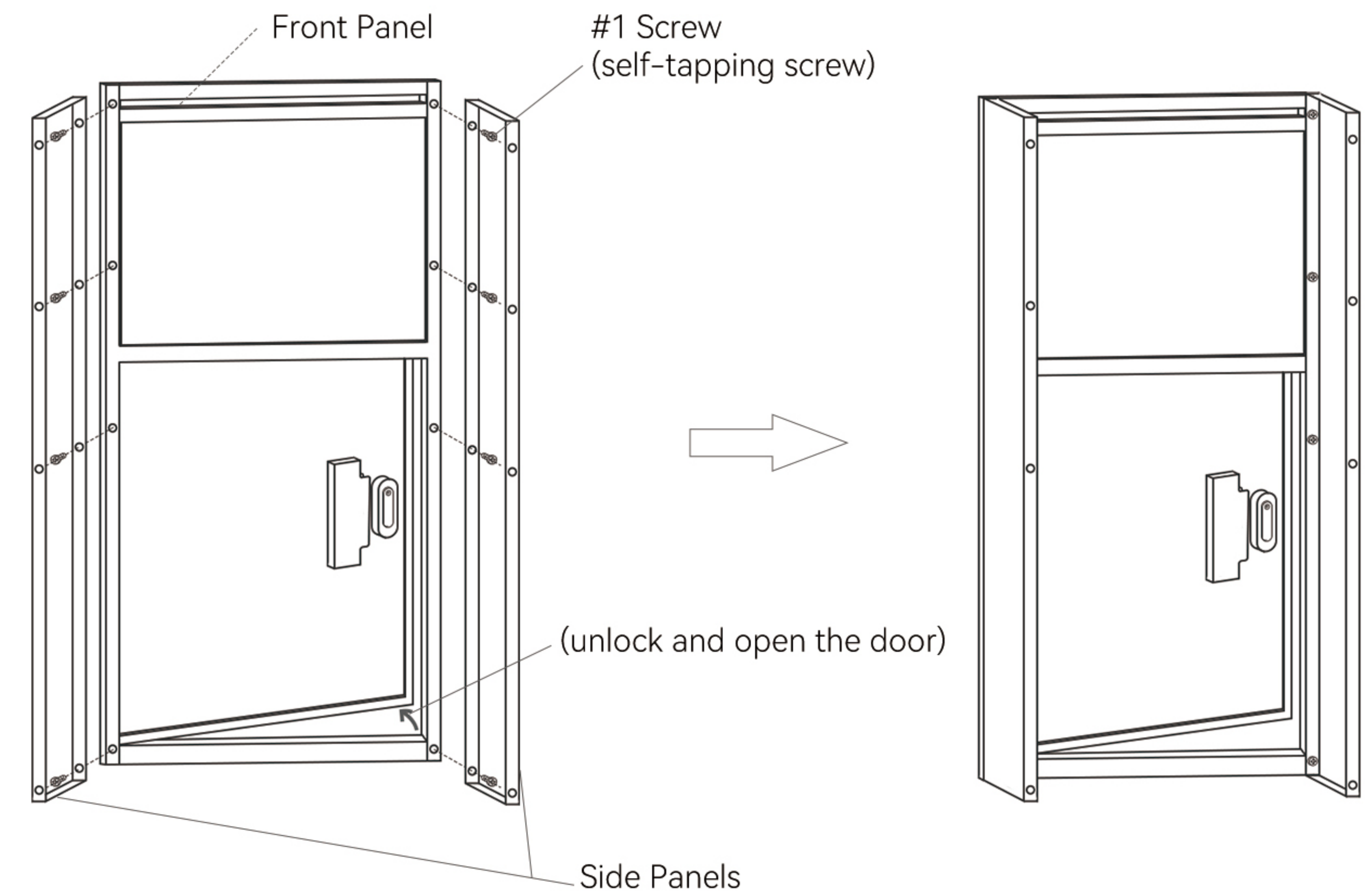

Align the two side panels with the front panel, matching the holes, and tighten with #1 screws. (When installing the side panel near the door lock, unlock and open the door first to allow the screws to align with the corresponding holes.)

Step 2: Install the Back Panel

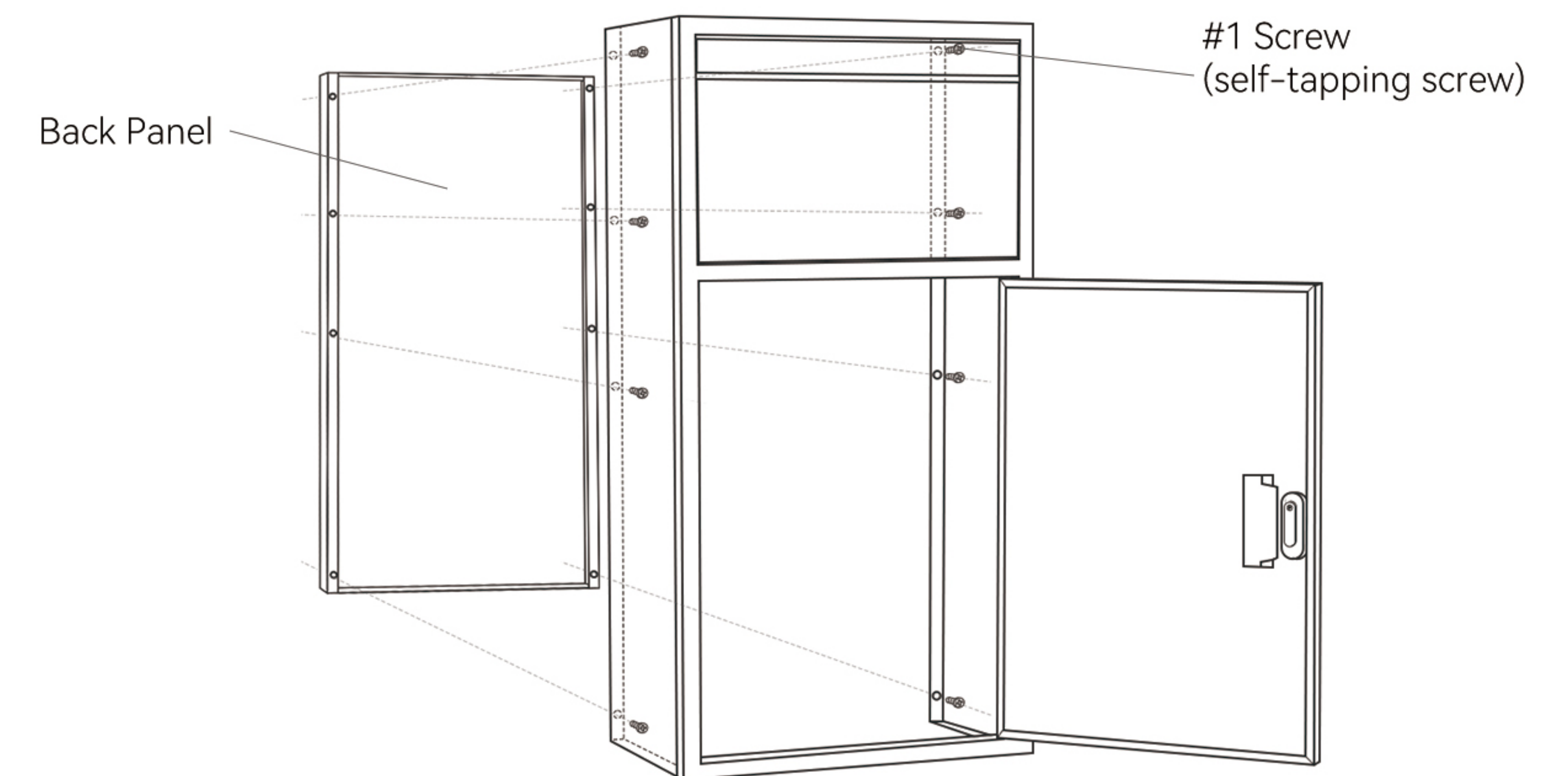

Align the back panel with the two side panels and tighten with #1 screws. (It is recommended to open the front door for easier access to the screw holes.)

Step 3: Install the Bottom Panel

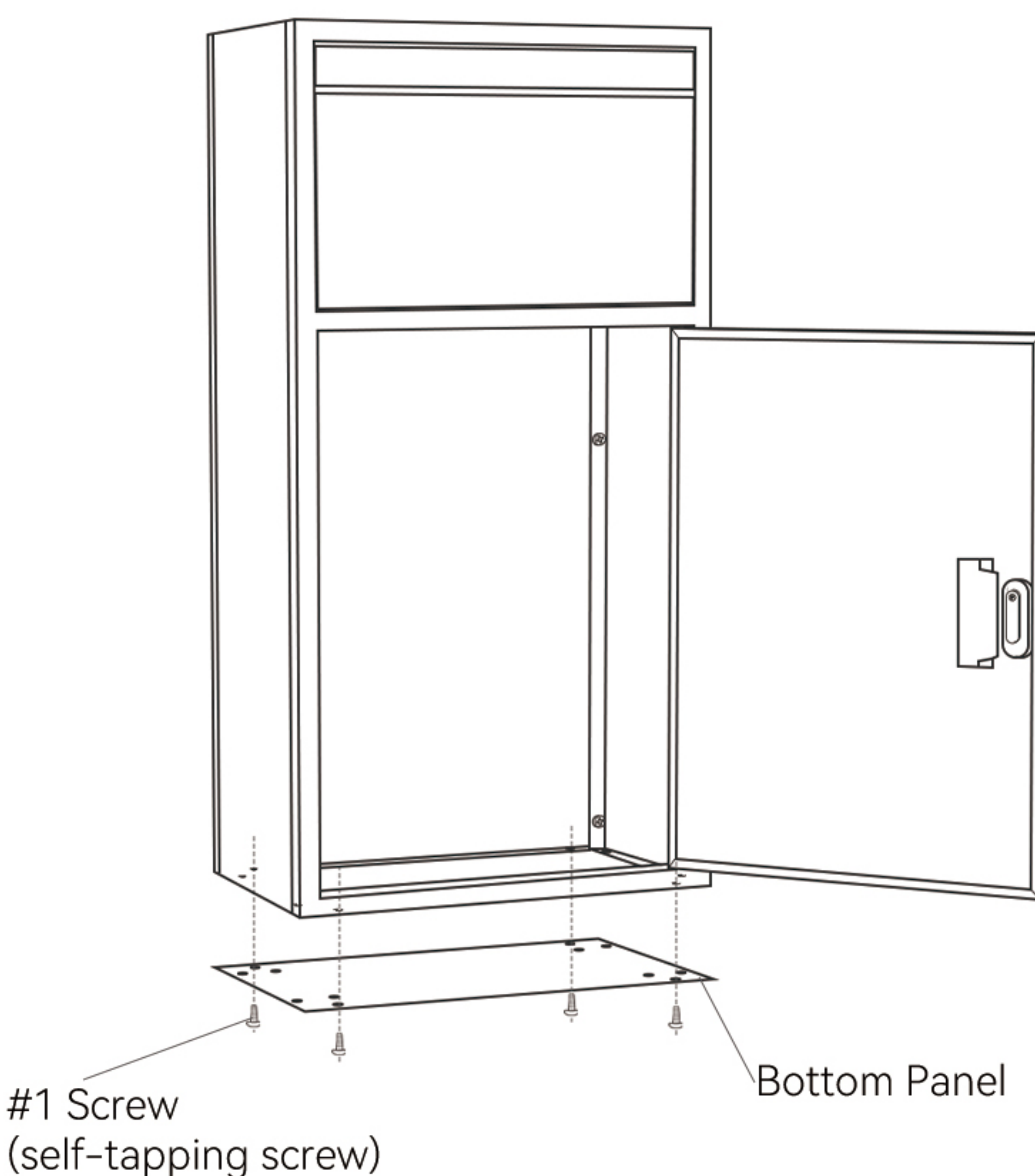

Step 4: Install the Legs

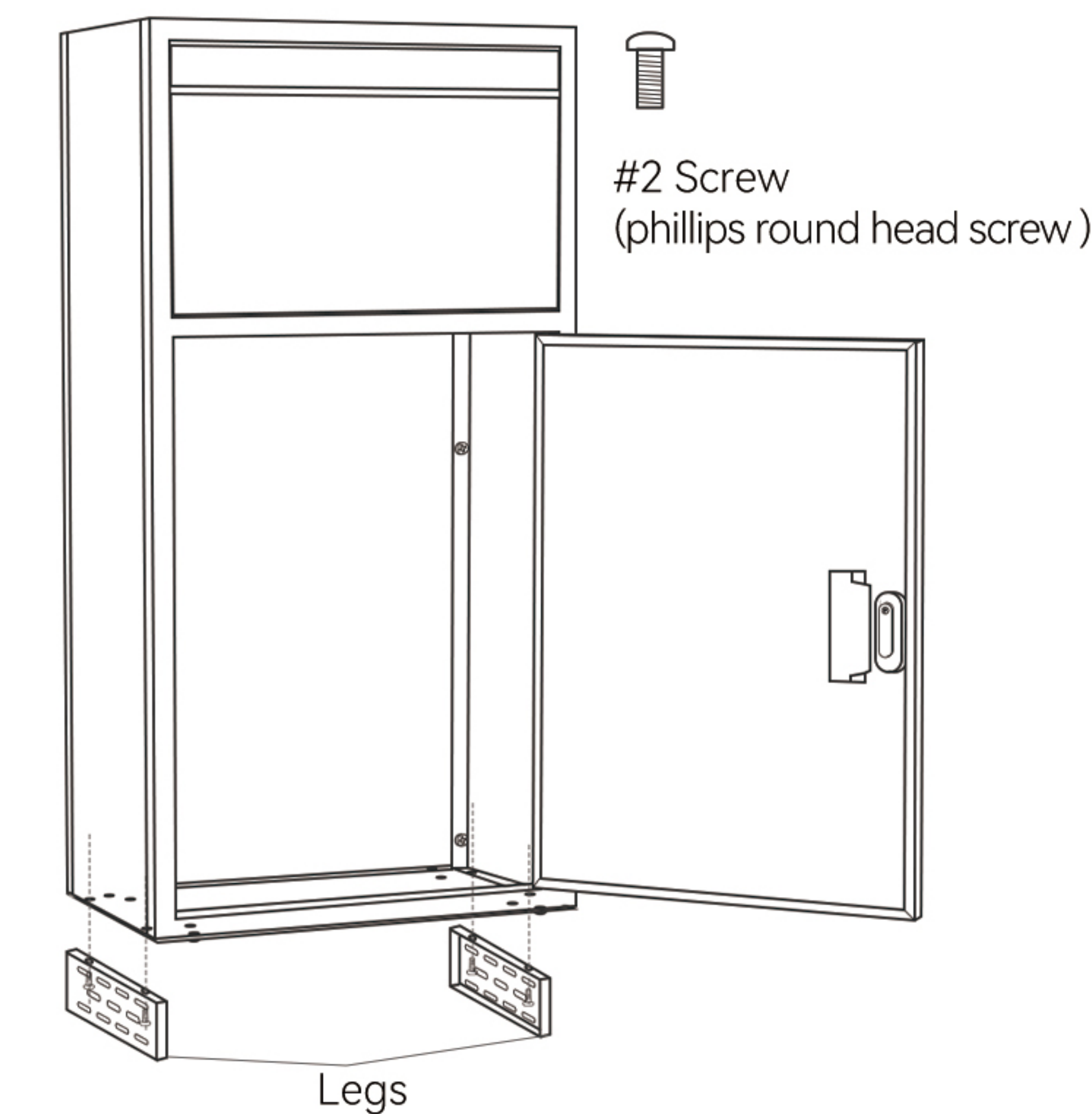

Attach the two legs to the left and right sides of the bottom panel. Tighten the connection holes using #2 screws.

Step 5: Install Roof Panel

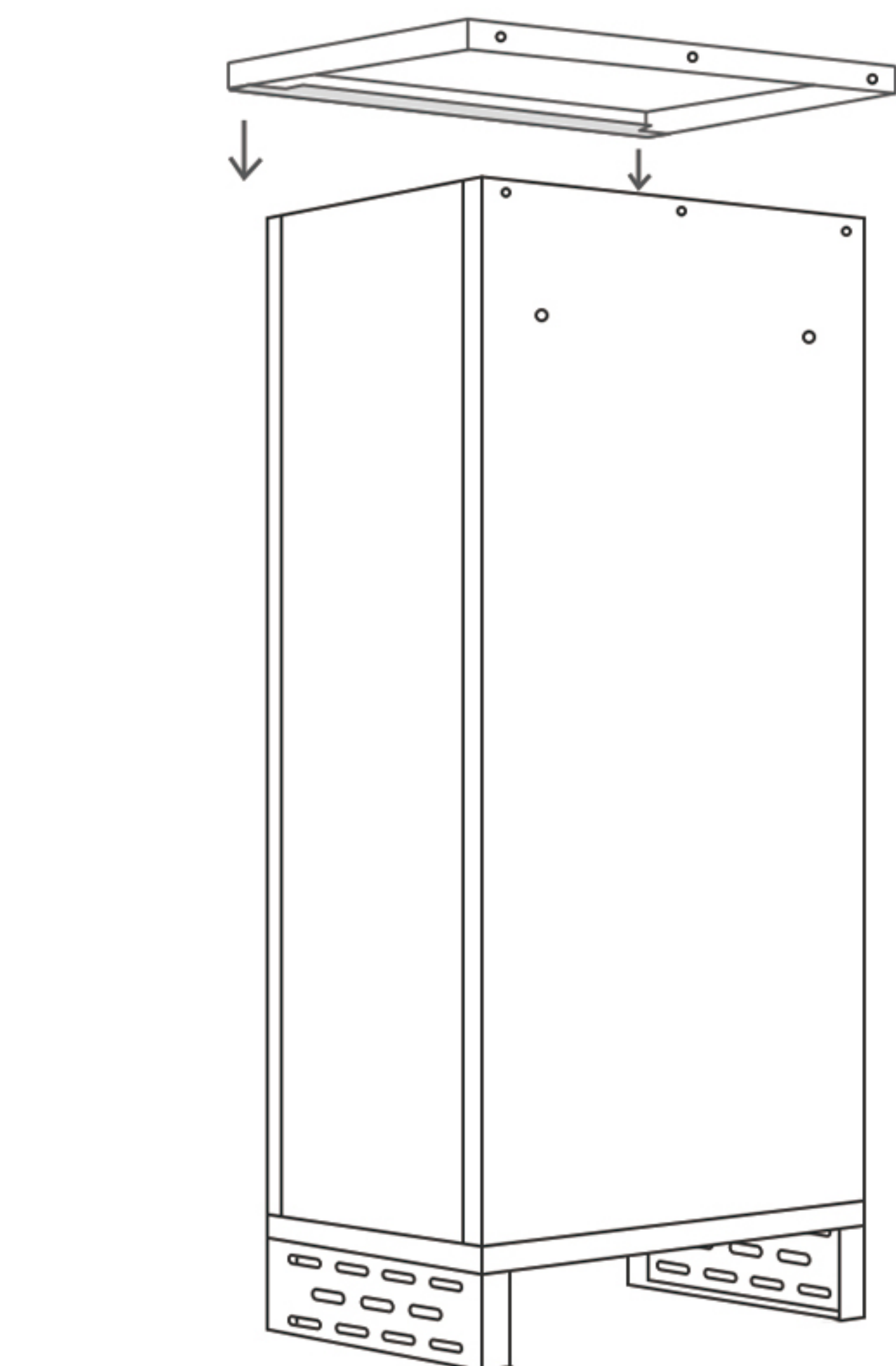

Align the roof panel's eaves with the front of the delivery box, then press firmly from the front to the back to ensure the roof panel fits onto the box's main body.

Step 6: Secure the Screws

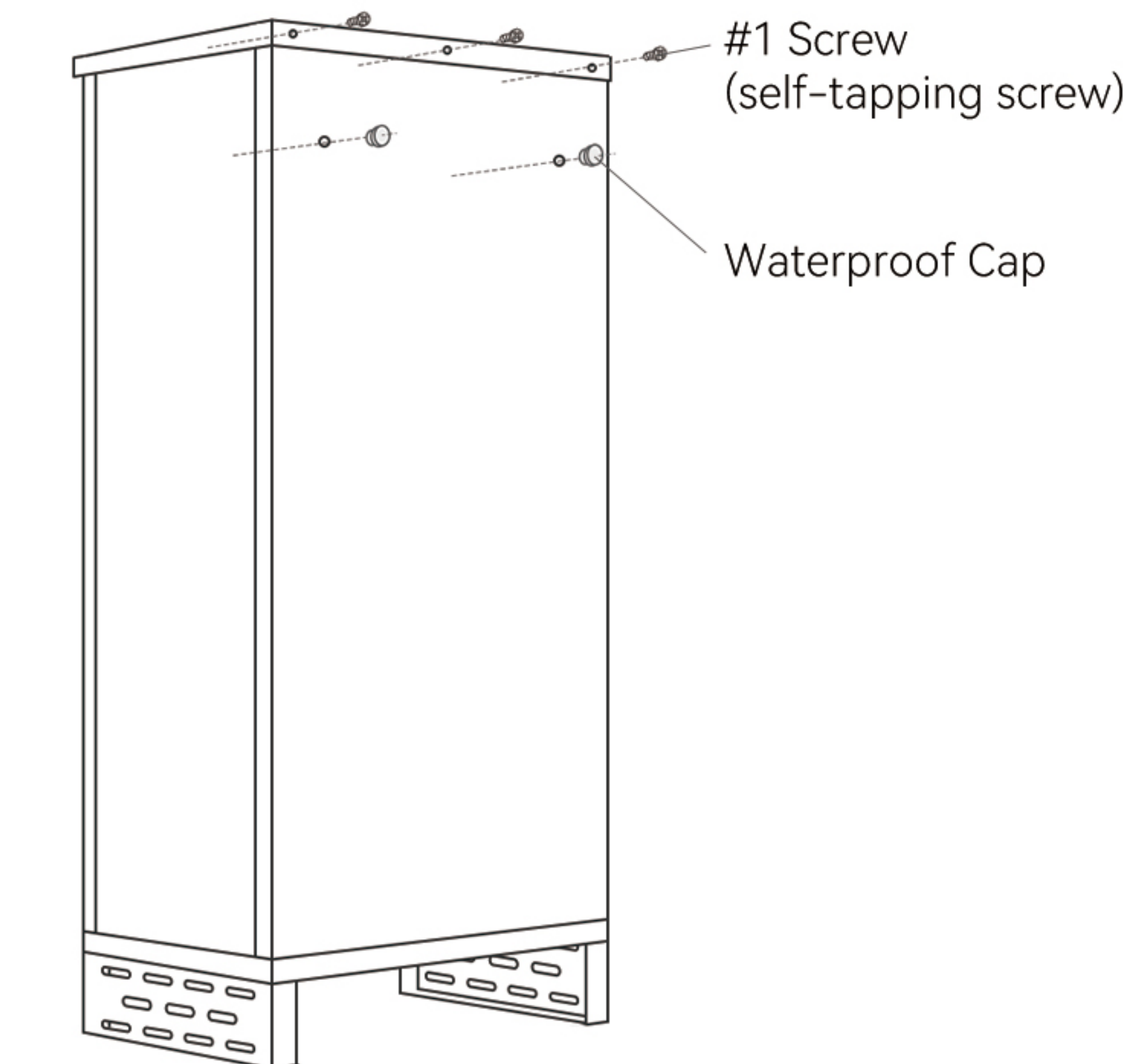

Secure the screws at the back of the roof panel and attach the waterproof cap.

How to Reset the Combination Code

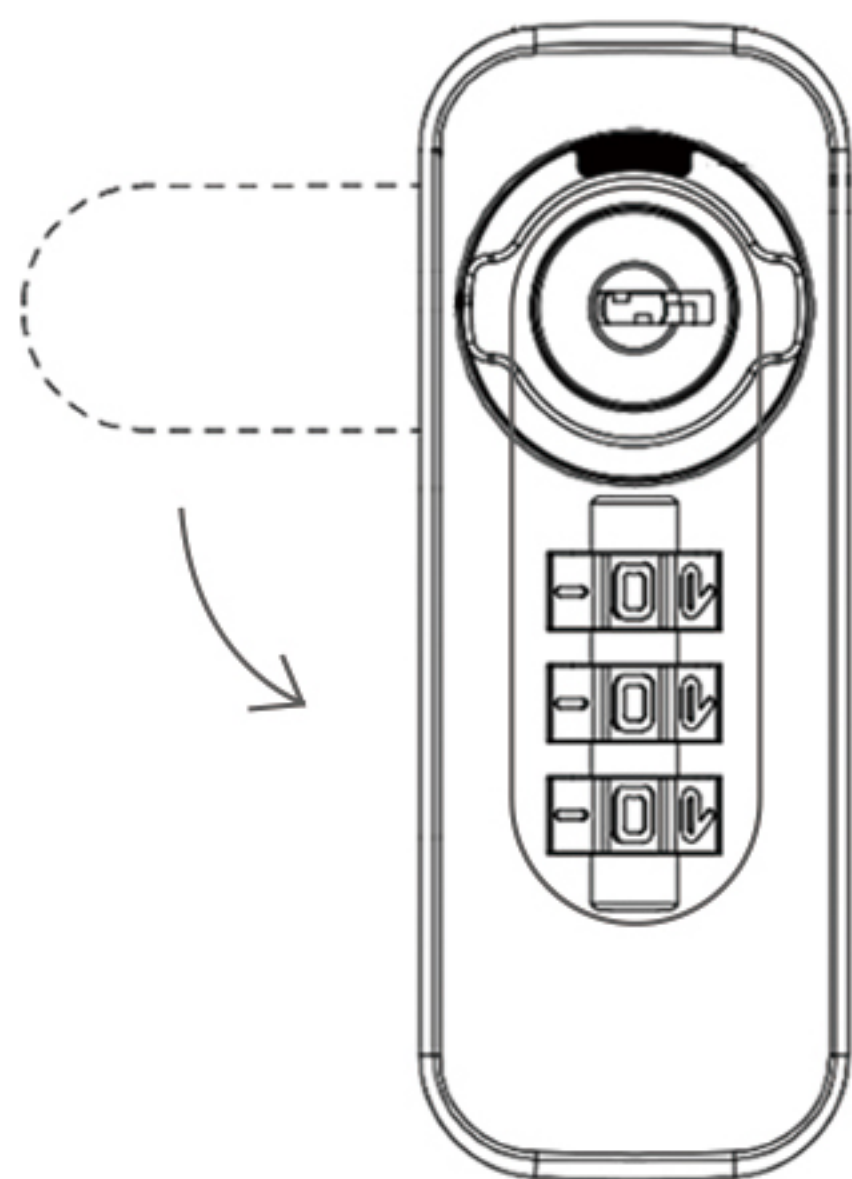

Step 1: Open the lock: First, you need to open the lock using the current combination (000).

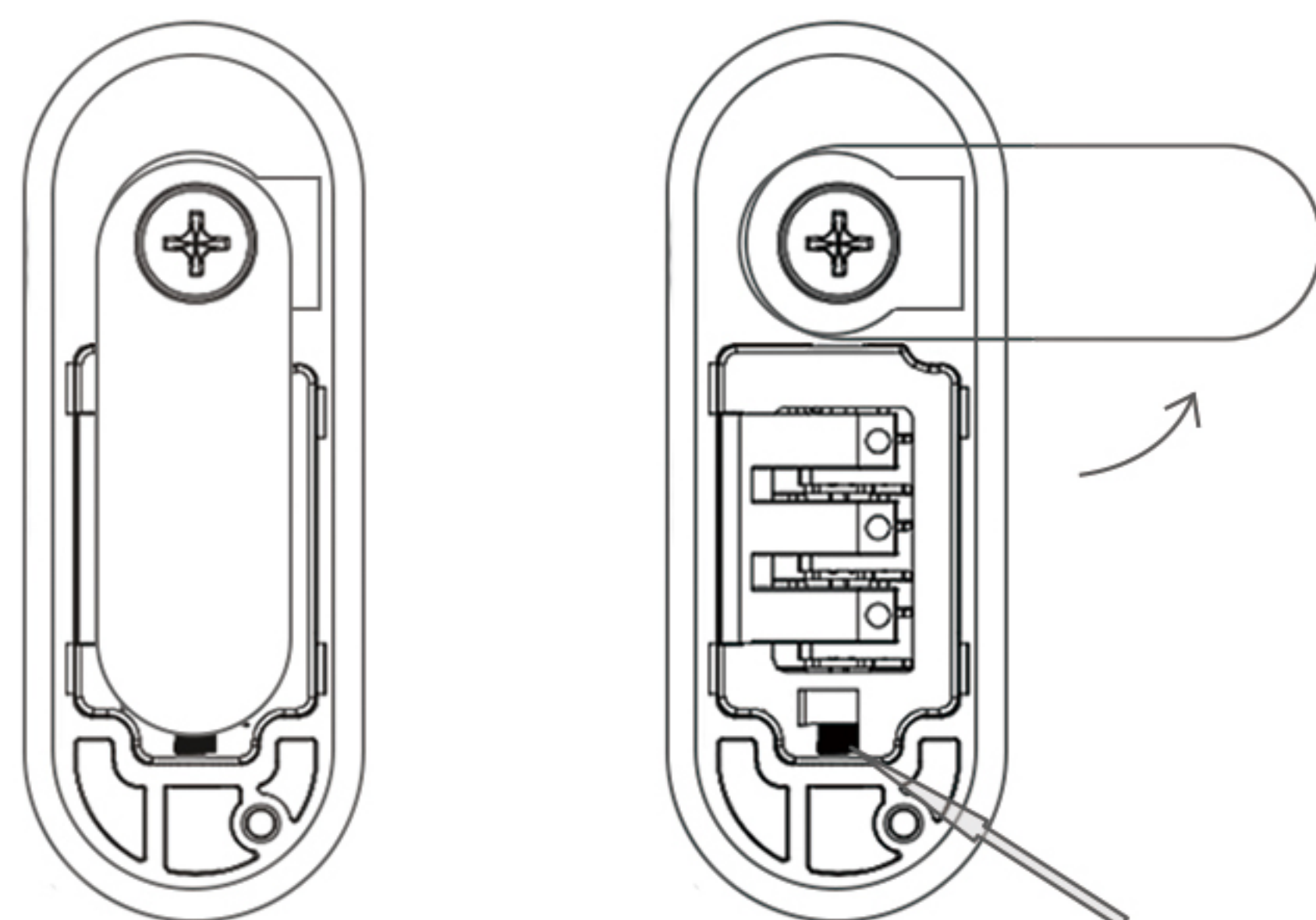

Step 2: Locate the reset mechanism: There is a small reset button, which is located on the back (inside the door) of the lock.

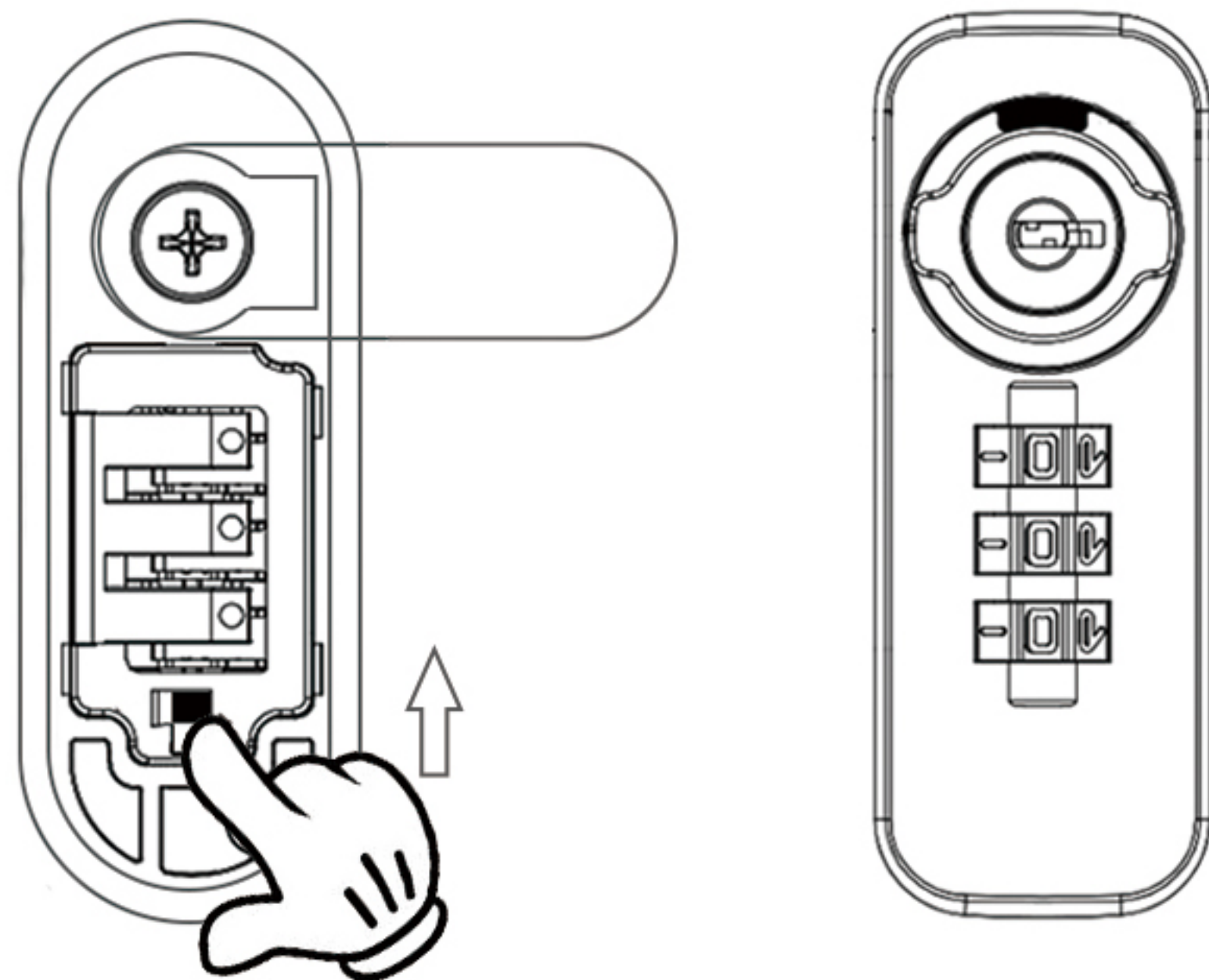

Step 3: Lift the reset mechanism while turning the dials to set your desired new combination.

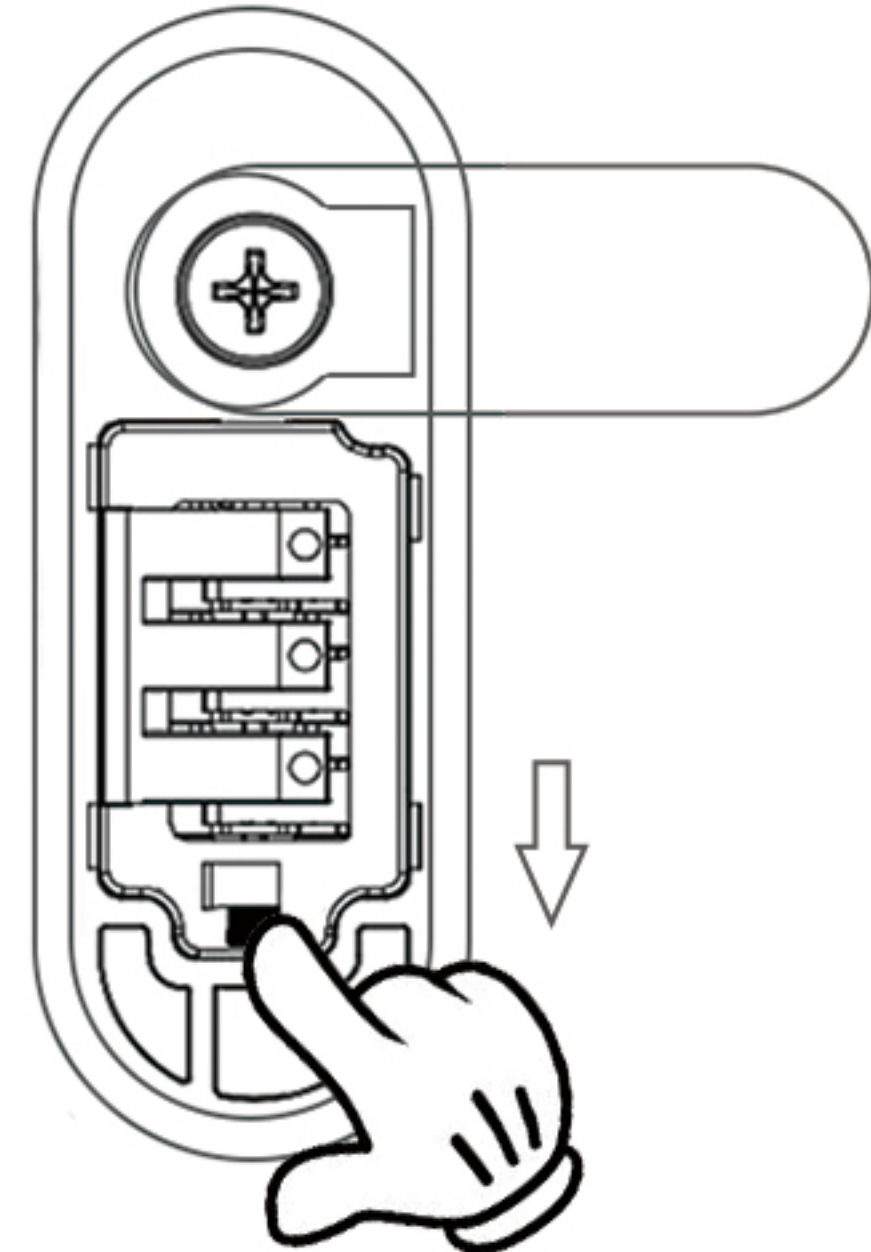

Step 4: Confirm the new combination: Release the reset button, and then test the new combination to make sure it works.

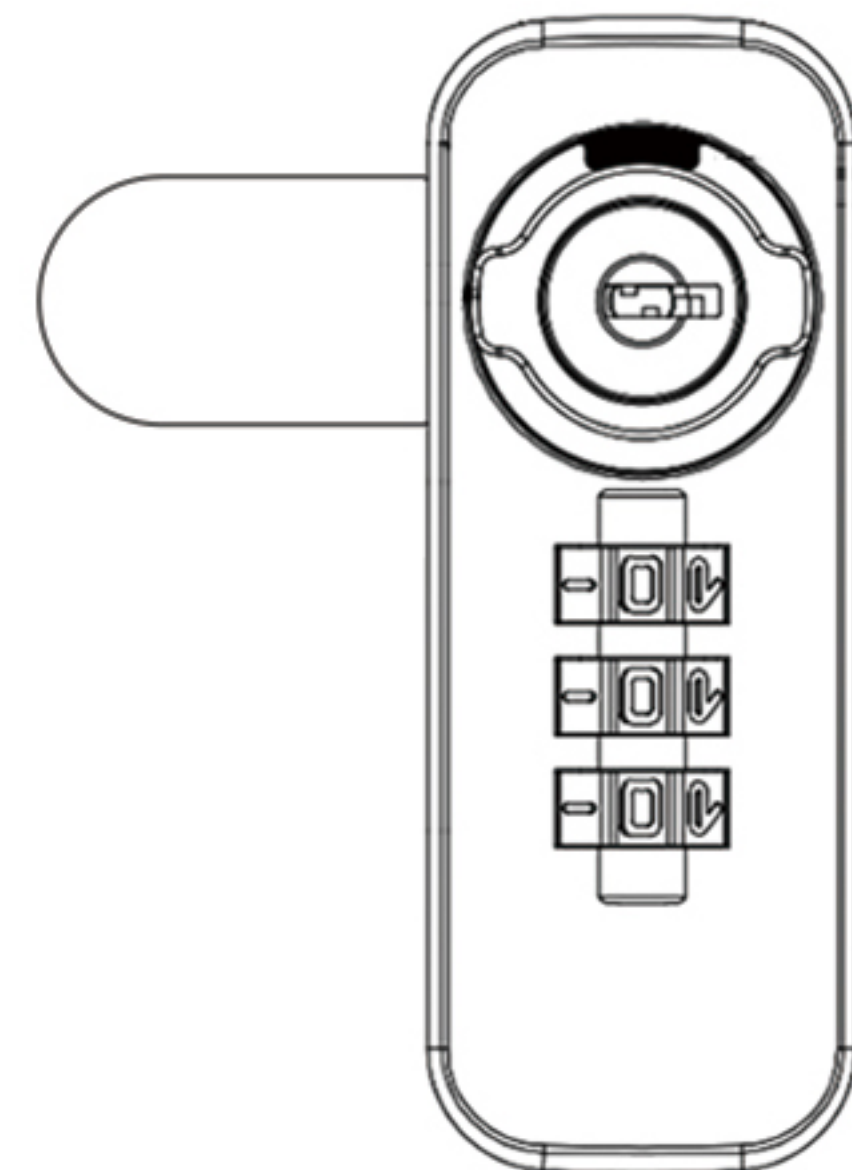

Step 5: Secure the lock: After confirming the new password, close the lock, and you're all set.

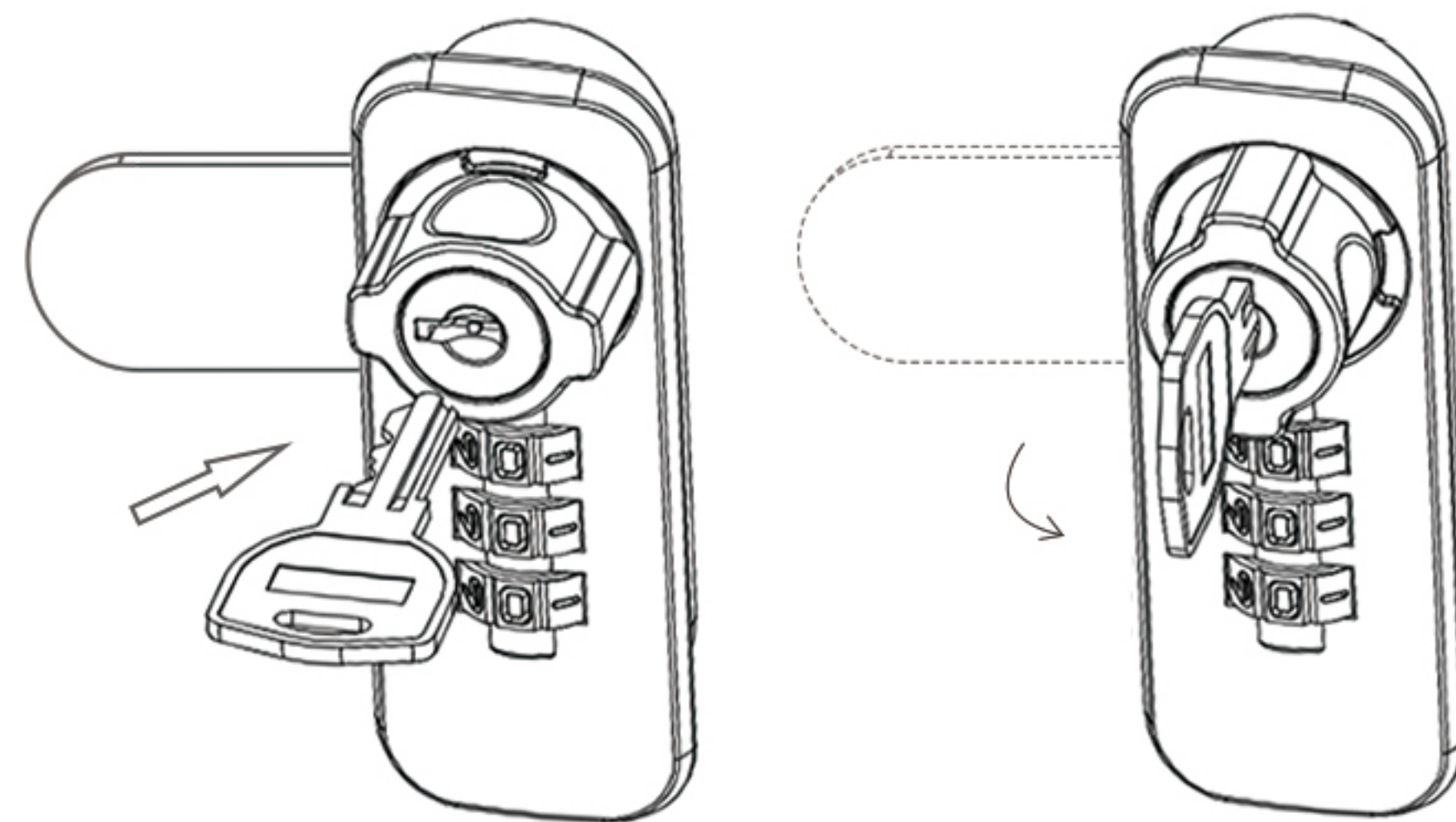

NOTE: If you forget the password, please use the key to open the lock, then reset the password (follow steps 2 to 5).