

# 1 Light Industrial Farmhouse Outdoor Wall Sconce

# AMBIATE

Installation Instructions for item AL10015WS

**CAUTION:** To prevent electrical shock, ensure electricity has been turned off at the circuit breaker before beginning.

- Read all instructions before installing.
- Ensure all electrical connections must be made in accordance with the National Electric Code and local codes and ordinances. If you are uncertain of the methods of installing electrical wiring and lighting fixtures, secure the services of a qualified licensed electrician.
- Retain installation instructions for future maintenance reference.

**MAINTENANCE NOTE:** Coastal conditions may cause mineral and residue build-up on the fixture. We recommend that customers in coastal areas clean all external surfaces of the fixture once every two weeks with a wet cloth.

## INCLUDED HARDWARE

**A**



Wire Connector  
Qty: 3pcs

**B**



Mounting Screw  
Qty: 2pcs

**C**



Green Ground Screw  
Qty: 1 pcs

**D**



Screw Cap  
Qty: 2 pcs

**E**

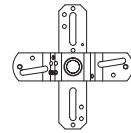

Mounting Bracket  
Qty: 1 pcs

## STEP 1

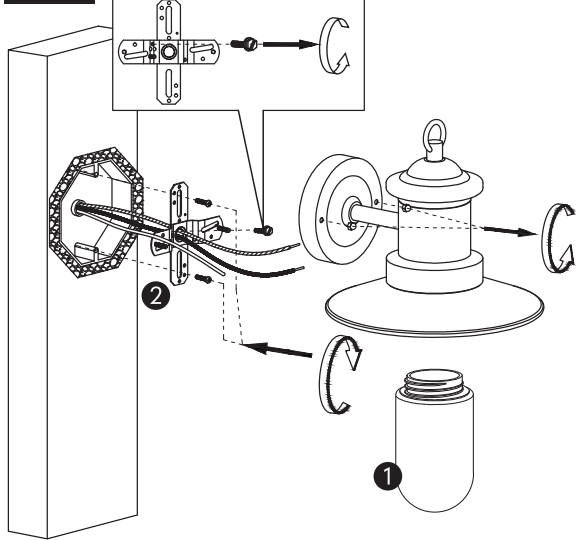

## STEP 2

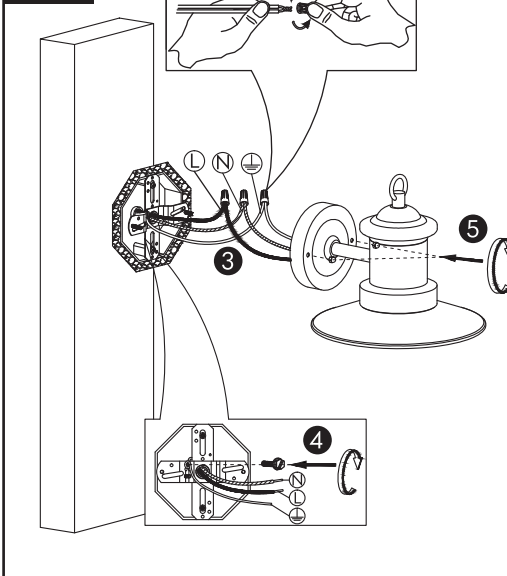

## STEP 3

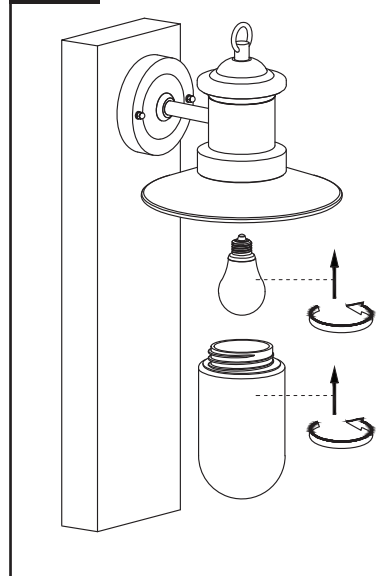

## PREPARATION

- Shut off the power at the circuit breaker and remove existing fixture, including the crossbar.
- Carefully unpack your new fixture and lay out all the parts on a clear area. Be careful not to lose any small parts necessary for installation.

## MOUNTING THE FIXTURE

**Step 1.** Remove the glass cover (Fig 1) and mounting bracket (E) from the fixture canopy. Pull the supply wires (Line, Neutral and Ground) out from the junction box and push through the large center hole in the mounting bracket (Fig 2) and then attach the bracket to the junction box using the mounting screws (B).

**Step 2a.** Connect the fixture wires to supply wires using wire nuts (A) as shown (Fig 3). Black to Black, White to White, and ground Bare/Green to Bare/Green. If supply ground wire does not exist, attach the fixture ground wire to the green screw (C) on the mounting bracket (Fig 4). Make sure that all wire connectors are secure. After wires are connected, tuck them carefully inside the junction box.

**Step 2b.** Attach canopy to mounting bracket by placing over the screws protruding from the mounting bracket and pushing through the holes on the canopy. Secure using the screw caps (D) (Fig 5).

**Step 3.** Install bulb, not to exceed max rated wattage. Install glass cover and ensure it is tightly secured. Turn on power at the circuit breaker.

## NOTE

It is recommended to apply silicon caulk around edge of wall canopy to weatherproof.