

A

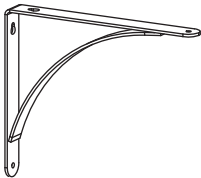

Fasteners:

AA



P/H Screw, #8 x 1-3/4"  
2 PCS

BB

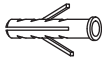

Anchor, M6 x 30 mm  
2 PCS

1

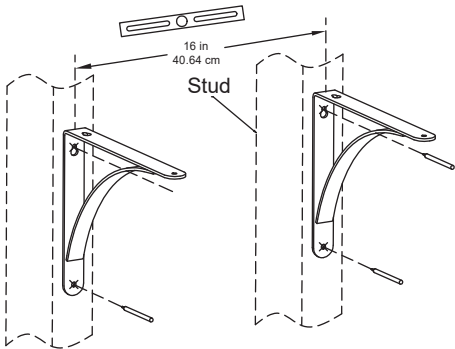

2

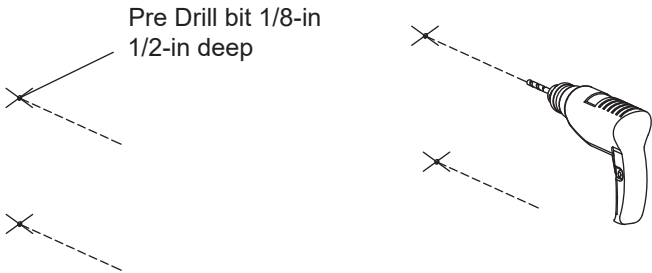

If using anchor, the hole size not less than drill bit 3/16-in 1-3/4" deep

3-1

For drywall or wood

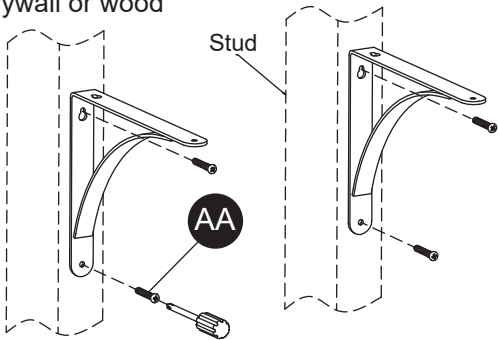

3-2

For Concrete Wall

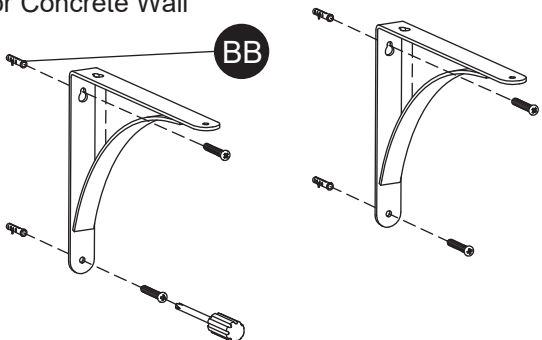

4

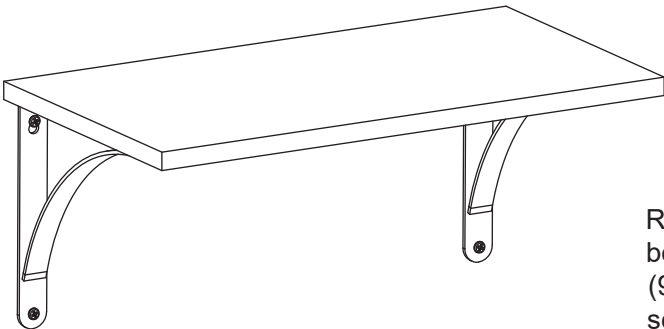

Recommended :  
board size: 250 x 15 x 458 mm  
(9.85" x 0.59" x 18")  
screw size: P/H #8 x 5/8" x 2