

Using #2 Phillips screwdriver, press anchor tip slightly into drywall. Applying pressure, turn anchor until flush with drywall. Do not overtighten.

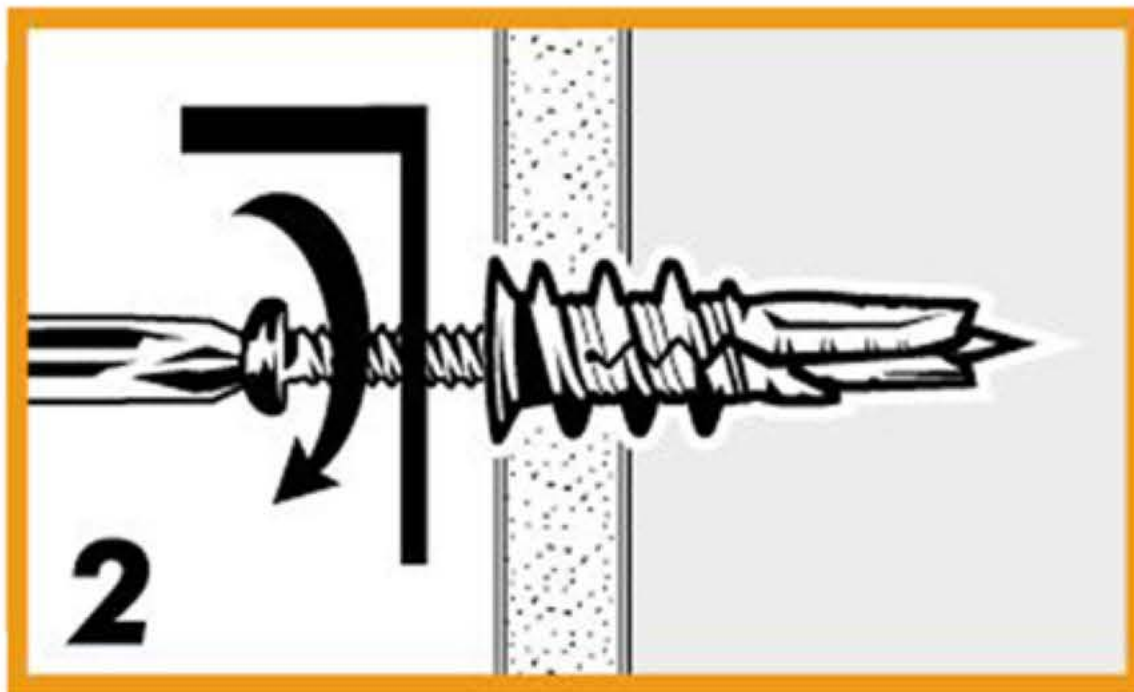

Insert screw through item to be hung and turn into anchor.

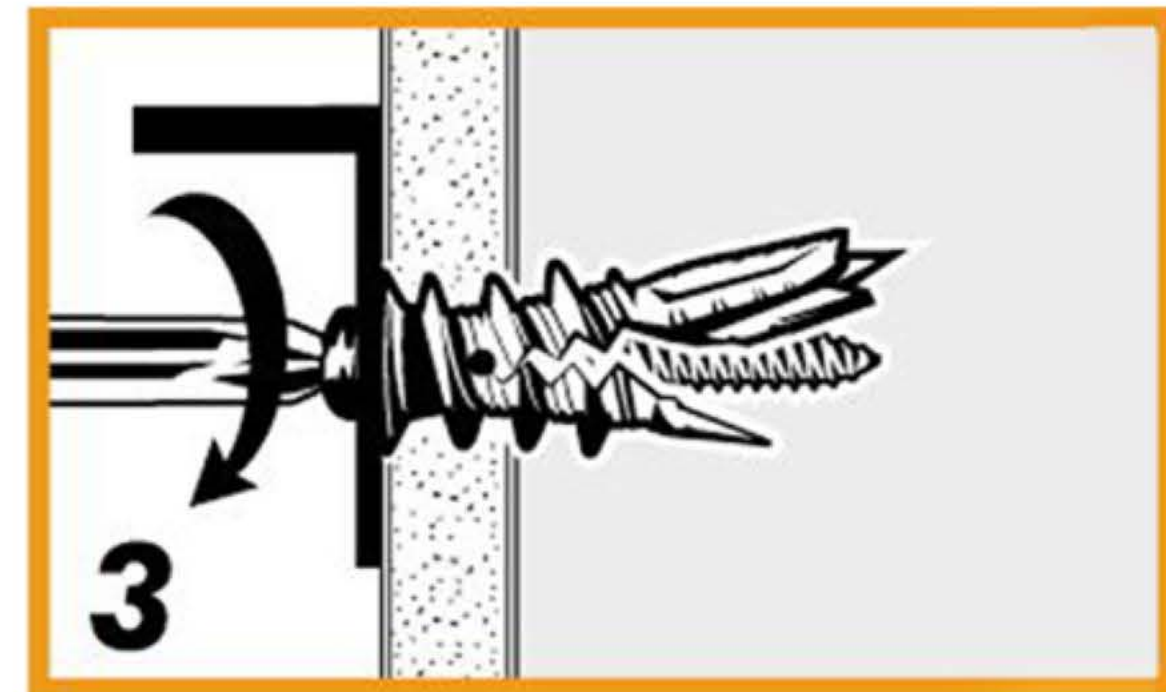

Anchor will “click” once when the screw is halfway in to indicate that the anchor is secure. Continue tightening until flush. Item thickness 1/4" or less with screw provided.