



| Product Submittal | |
|-------------------|--|
| Name | |
| Date | |
| Architect/Owner | |
| Contractor | |
| Tag | |
| Notes | |

Sweat Straight Stop Specification Sheet

Description

Used to control and shut off water flow to fixtures or appliances for maintenance and repair. Featuring a 1/2 in. nominal sweat inlet connection and quarter-turn full-port brass ball valve.

Features And Benefits

- Sleek chrome finish for an attractive appearance.
- Quarter-turn full-port brass ball valve.
- Compatible with copper pipe.

Specification Data

| Materials | |
|----------------|--------------|
| Valve body | DZR LF brass |
| Knurled Handle | ZINC |
| Valve ball | DZR LF brass |
| Seat | PTFE |

Temperature Performance

- Minimum working temperature 33°F
- Maximum working temperature 160°F
- Maximum working pressure is 125 psi

Flow Rate

- 3/8" Compression 4.0 GPM at 20 psi

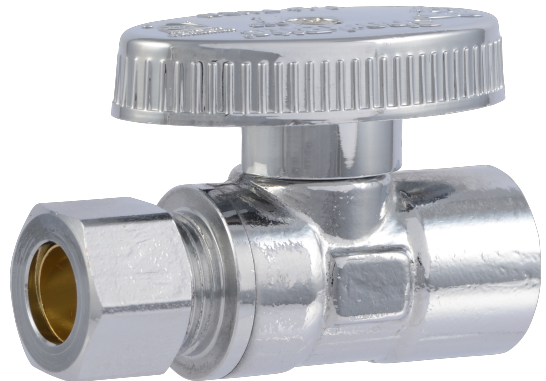

Part Listing

☐ NSWTS1238Z 1/2 in. Nominal Sweat x 3/8 in. OD Compression

Dimensions

| Part Number | DIM A (IN) | DIM B (IN) |
|-------------|------------|------------|
| NSWTS1238Z | 1.14 | 2.78 |

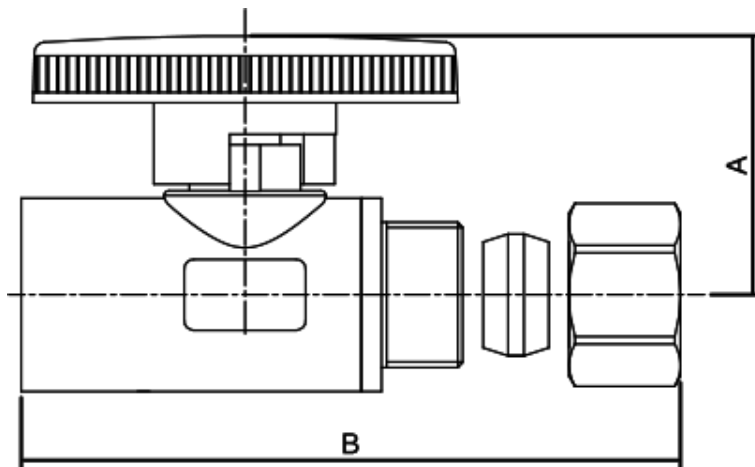

Codes and Listing

cUPC

ASME A112.18.1

CSA B125.1

NSF/ANSI/CAN 61

NSF/ANSI 372

