

HOW TO INSTALL YOUR STAIR PARTS

METAL NEWEL

IMPORTANT - PLEASE READ ALL INSTRUCTIONS BEFORE YOU BEGIN INSTALLATION.

- These instructions are for a square metal newel.
- Refer to your local building code for current regulations.

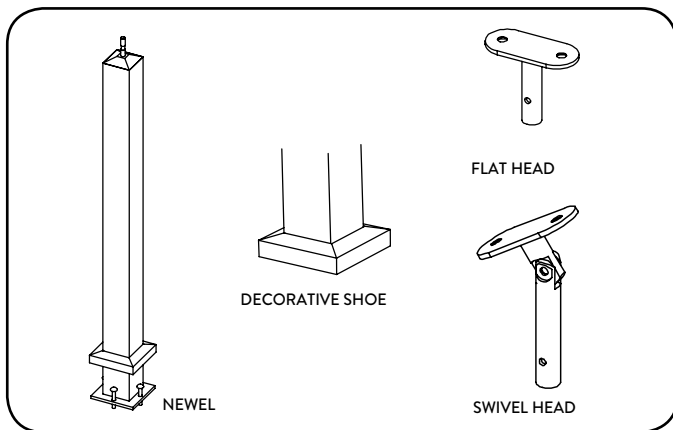

Parts included

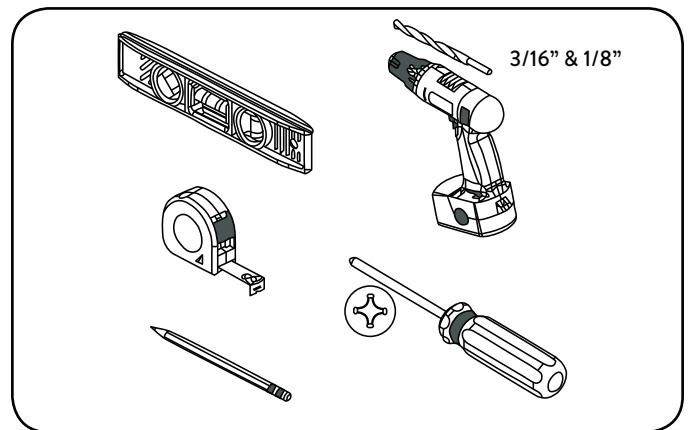

Recommended tools

1. Newel preparation

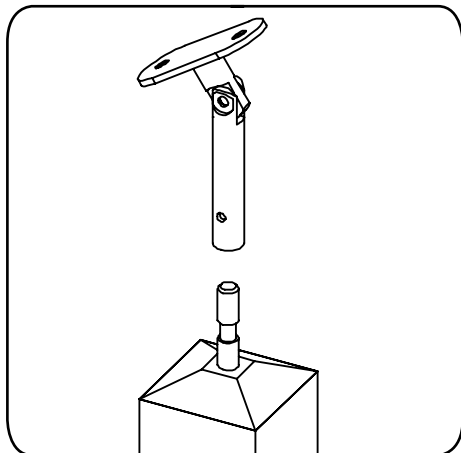

For an installation on stair use the swivel head.

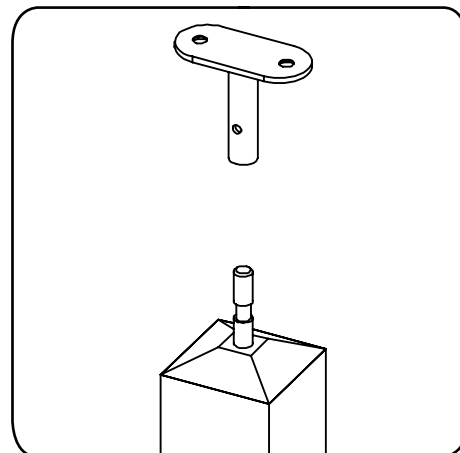

For an installation on horizontal section use the flat head.

2. Newel installation

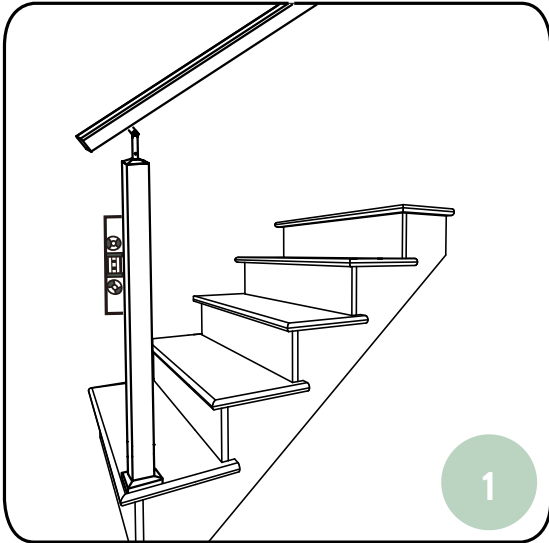

Place the newel at the desired location, using a level, make sur it is straight on all sides.

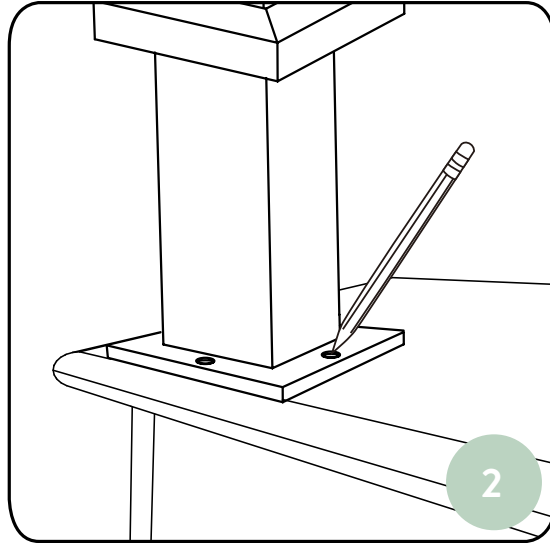

Mark the location of the 4 base's holes.

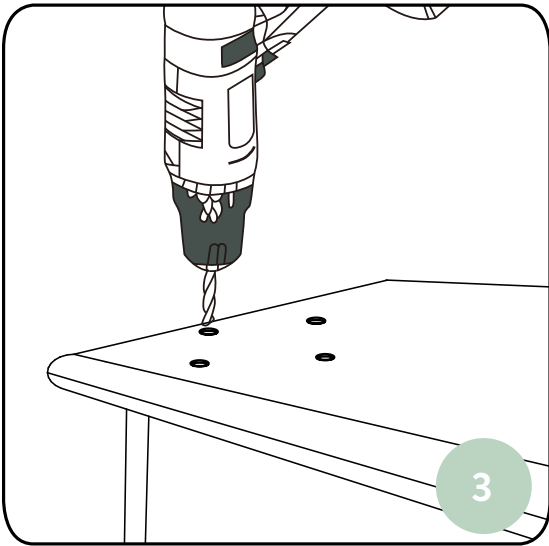

Drill 3/16" pilot holes at each mark.

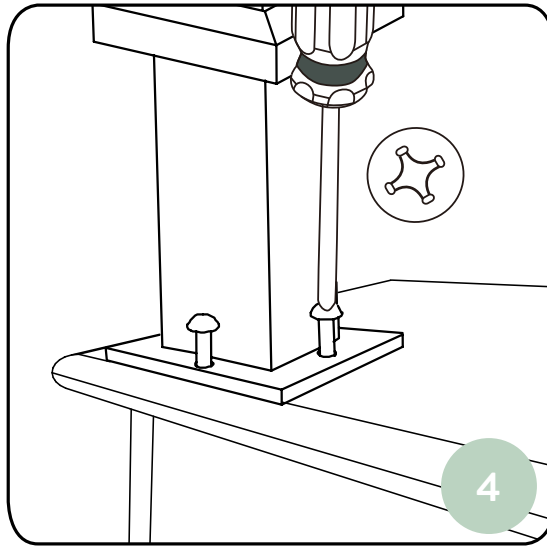

Fix the newel's base with 4 screws.

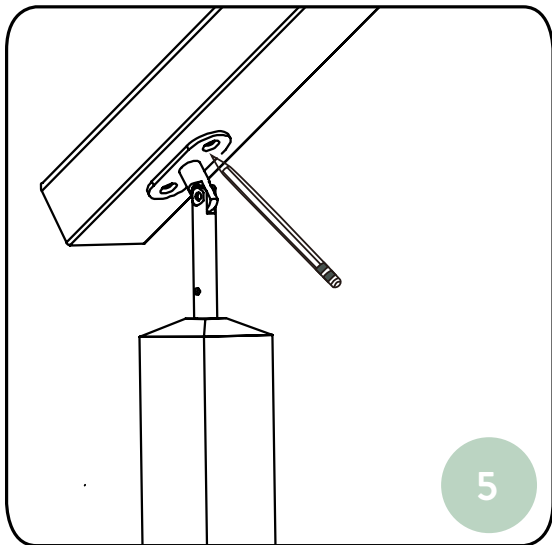

Mark the location of the 2 head's holes under the handrail.

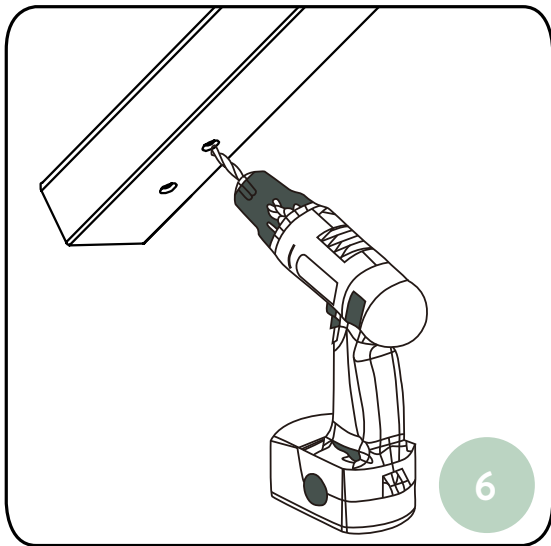

Drill 1/8" pilot holes at each mark.

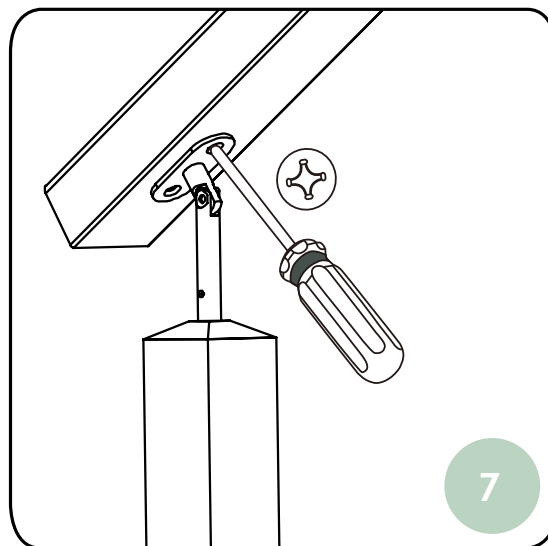

Fix the newel's head with 2 screws.

DO NOT RETURN TO RETAILER

If you have any questions, please contact our customer service at:
info@colonialelegance.com or call toll free at: 1-800-361-2030

VISIT OUR WEB SITE

www.colonialelegance.com

***1 year limited warranty**