



HARBOR BREEZE and logo design are trademarks or registered trademarks of LF, LLC. All rights reserved.

ITEM #5257160

MODEL #42958

# ADARA FANDELIER

**Español p. 15**

**ATTACH YOUR RECEIPT HERE**

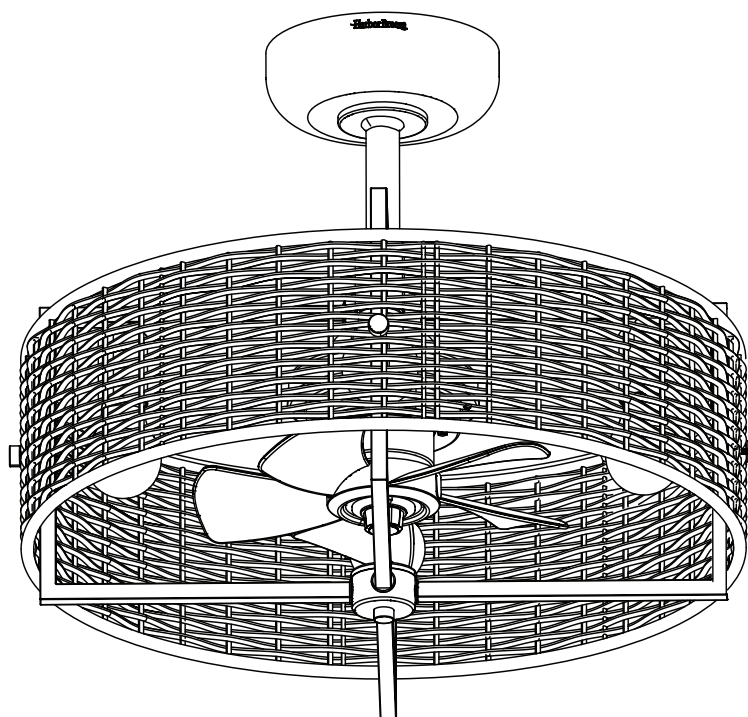

**Intertek**

Purchase Date \_\_\_\_\_

Thank you for purchasing this HARBOR BREEZE product.  
Questions, problems, or missing parts?  
Before returning, contact us at:  
**888-251-1003**, 8 a.m. - 8 p.m., EST, Monday - Sunday or at **ascs@lowes.com**.

**TABLE OF CONTENTS**

---

Package Contents. . . . . 3

Preparation . . . . . 3

Safety Information. . . . . 4

Assembly Instructions. . . . . 6

Operating Instructions. . . . . 12

Care and Maintenance. . . . . 13

Troubleshooting. . . . . 13

Warranty. . . . . 14

Replacement Parts List . . . . . 15

## PACKAGE CONTENTS

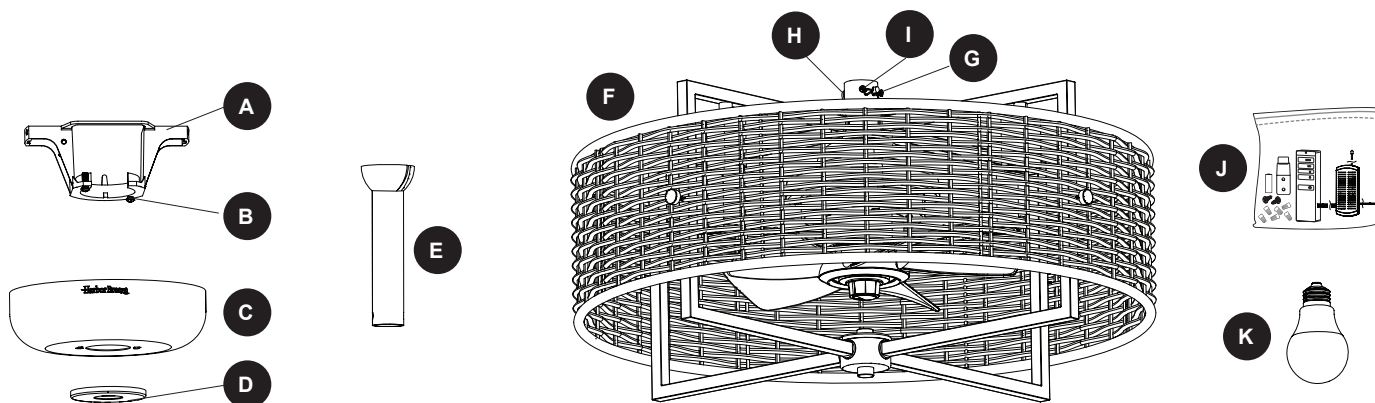

PART	DESCRIPTION	QUANTITY
A	Mounting Bracket (preassembled to Canopy [C])	1
B	Canopy Screw (preassembled to Mounting Bracket [A])	2
C	Canopy	1
D	Canopy Cover	1
E	Downrod	1
F	Motor Assembly	1
G	Downrod Clip (preassembled to Motor Assembly [F])	1
H	Downrod Pin (preassembled to Motor Assembly [F])	1
I	Set Screw (preassembled to Motor Assembly [F])	2
J	Remote Pack	1
K	Bulb	4

## PREPARATION

**Estimated Assembly Time:** 30 minutes

Tools Required for Assembly (not included): Step ladder, Phillips screwdriver, Wire stripper/cutter, safety glasses, and electrical tape.

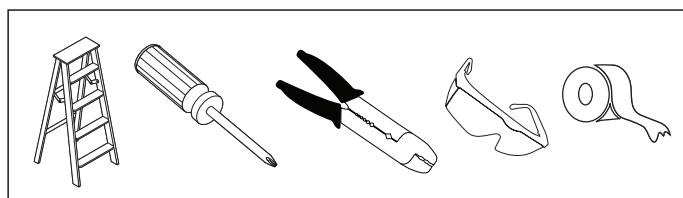

## SAFETY INFORMATION

---

Please read and understand this entire manual before attempting to assemble, operate or install the product. Failure to do so could lead to electrical shock, fire or other injuries that could be hazardous or even fatal.

- Before you begin installing the fixture, disconnect the power by removing fuses or turning off the circuit breakers.
- Make sure that all electrical connections comply with local codes, ordinances, the National Electrical Code, and ANSI/NFPA 70-199. Hire a qualified electrician or consult a do-it-yourself wiring handbook if you are unfamiliar with installing electrical wiring.
- The net weight of the fixture is 10.78 lbs.

### LISTED FOR DAMP LOCATION



#### **DANGER:**

- DO NOT connect this fixture to an electrical system that does not provide a means for equipment grounding. Never use a fixture in a two-wire system that is not grounded. Installing a fixture into an electrical system not having a proper grounding means could cause metal parts of the fixture to carry electrical currents if any of the fixture wires, wire connections or splices were to become broken, cut or loose during the mounting or normal operation of the fixture. Under this condition, anyone coming in contact with the fixture would be subject to electrical shock, which could cause serious injury or death.
- DO NOT connect the bare or green insulation fixture ground wire to the black (hot) current-carrying wire or the white neutral house wire. Connection of the bare or green fixture ground wire to the black or white house wires may cause metal parts of the fixture to carry electrical currents. Under this condition anyone coming in contact with the fixture will receive electrical shock, which could cause serious injury or death.
- DO NOT damage or cut the wire insulation (covering) during installation of the fixture. DO NOT permit wires to contact any surface having a sharp edge. To do so may damage or cut the wire insulation, which could cause serious injury or death from electrical shock.



#### **WARNING:**

- All electrical connections must be in agreement with local codes and ordinances, the National Electric Code (NEC) and ANSI/NFPA 70-1999. Contact your municipal building department to learn about your local codes, permits and/or inspections. Risk of fire - most dwellings built before 1985 have supply wire rated for 140°F. Consult a qualified electrician before installation.
- To avoid personal injury, the use of gloves may be necessary while handling fixture parts with sharp edges.
- DO NOT suspend any fixture by the house wires. A fixture must always be mounted directly to a an outlet box. Wire connectors will not support the weight of a fixture. Suspending a fixture by the house wires and wire connectors will result in the fixture falling, with the possibility of personal injury and the danger of electrical shock or fire.
- To reduce the risk of fire, electrical shock, or personal injury, each wire connector used with this fixture should accept only one 18-gauge wire from the fixture and one 18-gauge wire from the outlet box. If there are three or more wires to connect or any of the wires is larger than 18 gauges, consult an electrician for the proper size wire connectors to use.

#### **CAUTION:**

- To reduce the risk of personal injury, do not bend the blades. Do not insert any objects in the path of the blades.

## **SAFETY INFORMATION**

---

### **CAUTION:**

- This device complies with part 15 of FCC Rules. Operation is subject to the following two conditions: 1) This device may cause harmful interference, and 2) this device must accept any interference received, including interference that may cause undesired operation.
- This equipment has been tested and found to comply with the limits for a Class B digital device, pursuant to Part 15 of the FCC Rules. These limits are designed to provide reasonable protection against harmful interference in a residential installation. This equipment generates, uses and can radiate radio frequency energy and, if not installed and used in accordance with the instructions, may cause harmful interference to radio communications. However, there is no guarantee that interference will not occur in a particular installation. If this equipment does cause harmful interference to radio or television reception, which can be determined by turning the equipment off and on, the user is encouraged to try to correct the interference by one or more of the following measures:
  - Reorient or relocate the receiving antenna.
  - Increase the separation between the equipment and receiver.
  - Connect the equipment into and outlet on a circuit different from that to which the receiver is connected.
  - Consult the dealer or an experienced radio/TV technician for help.

Please note changes or modifications not expressly approved by the party responsible for compliance could void the user's authority to operate the equipment.

HKC-US, 3350 Players Club Parkway, Suite 225, Memphis, TN 38125, 888-251-1003

## ASSEMBLY INSTRUCTIONS

1. Turn off the circuit breakers and the wall switch to the supply line leads.

**⚠ DANGER:** Failure to disconnect the power supply prior to installation may result in serious injury or death.

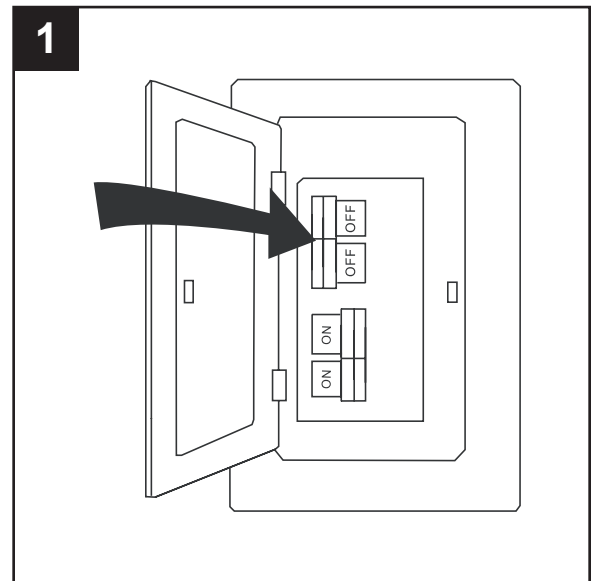

2. Determine the mounting method to use.

**Standard Mounting** is best suited for ceilings 8 ft. or higher. For taller ceilings you may want to use a longer downrod (not included).

**Angle Mounting** is best suited for angled or vaulted ceilings. Important: If using the angle mount, check to ensure the ceiling angle is not steeper than 10°.

**Flushmount installation** is not available for this item.

**Closemount installation** is not available for this item.

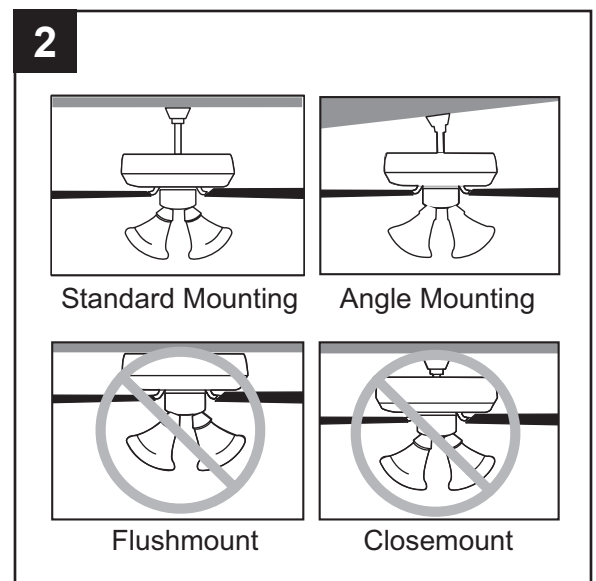

3. Loosen both and remove the canopy screw (B) from the round hole at the bottom of the mounting bracket (A). Turn the canopy (C) counterclockwise and remove the canopy (C) from the mounting bracket (A).

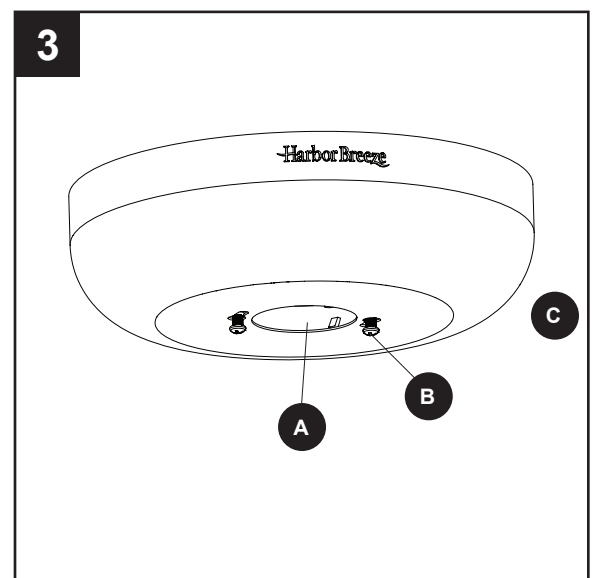

## ASSEMBLY INSTRUCTIONS

4. Install the mounting bracket (A) to the outlet box (not included) using the screws and washers provided with the outlet box.

**WARNING:** To reduce the risk of fire, electric shock, or personal injury, mount to the outlet box marked “acceptable for fan support” and use the mounting screws and washers provided with the outlet box.

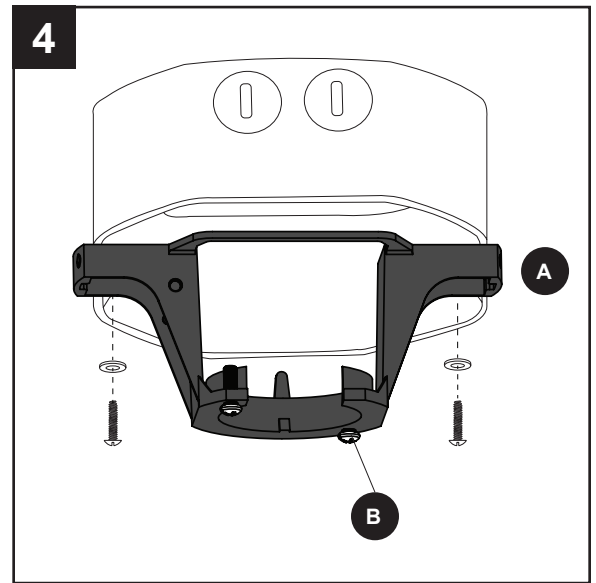

5. Remove the downrod clip (G) and downrod pin (H) from the yoke at the top of the motor assembly (F) and save for downrod (E) assembly. Then, loosen but do not remove the two set screws (I) at the top of the yoke.

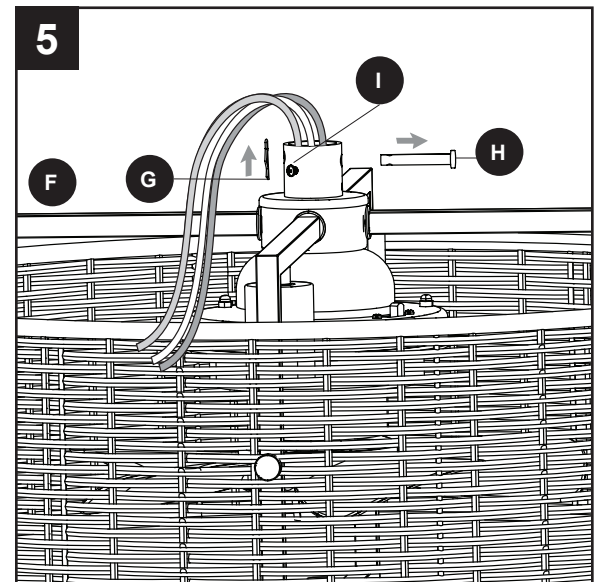

6. Insert the downrod (E) through the canopy (C) and canopy cover (D). Feed the wires from the motor assembly (F) through the downrod (E).

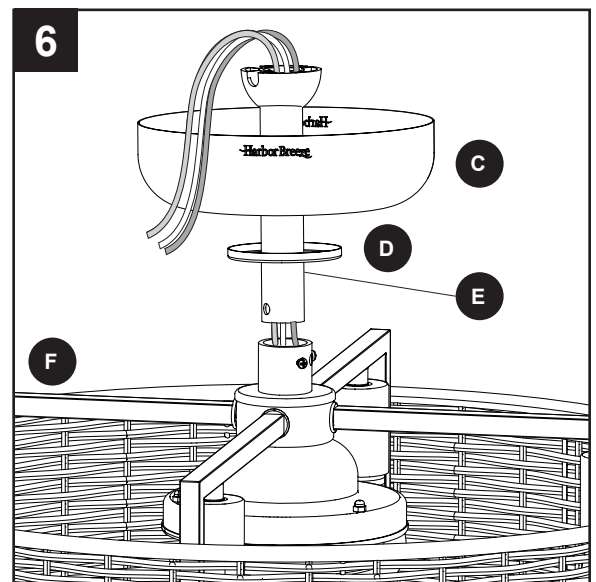



## ASSEMBLY INSTRUCTIONS

7. Slide the downrod (E) into the yoke of the fan assembly (F), align the holes, then re-install the downrod pin (H) and downrod clip (G). Secure with the two set screws (I).

**Note:** With wiring extending out of the downrod, measure 8 inches of lead wire and cut the excess wire with wire cutters (not included). Then strip 1/2" of insulation from the end of each wire.

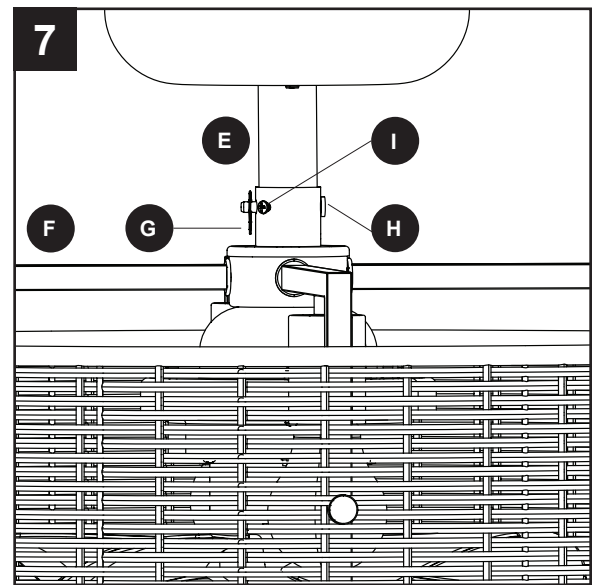

8. Install the ball end of the downrod (E) into the opening of the mounting bracket (A). Rotate the downrod (E) until the tab in the mounting bracket (A) is seated in the slot in the downrod ball.

**WARNING:** The fan and/or downrod (E) should not rotate in the mounting bracket (A), if installed correctly. Failure to align the slot in the downrod ball with the tab on the mounting bracket (A) may result in fan falling causing serious injury or death.

9. Secure all wiring connections together with wire connectors from remote pack (J) according to the diagram and these steps:

- Connect the green wires from the downrod and mounting bracket to the bare/green (ground) supply wire.
- Connect the Blue wire (FOR LIGHT) from the receiver to the Blue fan wire.
- Connect the Black wire (TO MOTOR L) from the receiver to the Black fan wire.
- Connect the White wire (TO MOTOR N) from the receiver to the White fan wire.
- Connect the Red wire (AC IN L) from the receiver to the Black (hot/power) supply wire.
- Connect the White (AC IN N) from the receiver to the White (neutral) supply wire.

**Important:** After the connections have been made, the connected wires should be turned upward and pushed carefully up into the outlet box. Place the black and white wire connections on opposite sides of the outlet box.

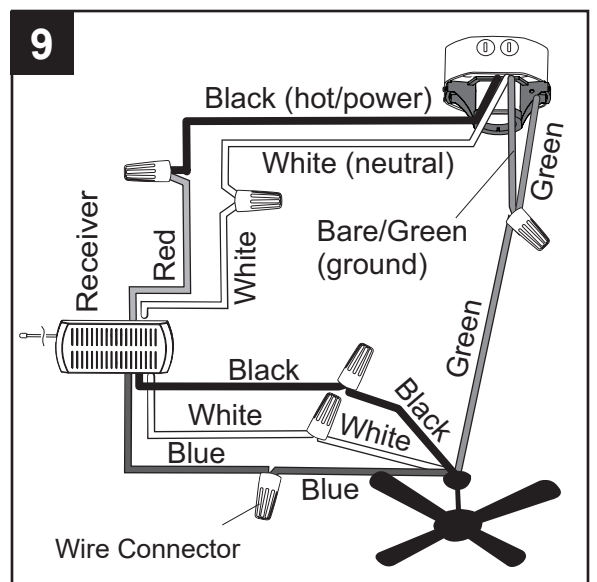
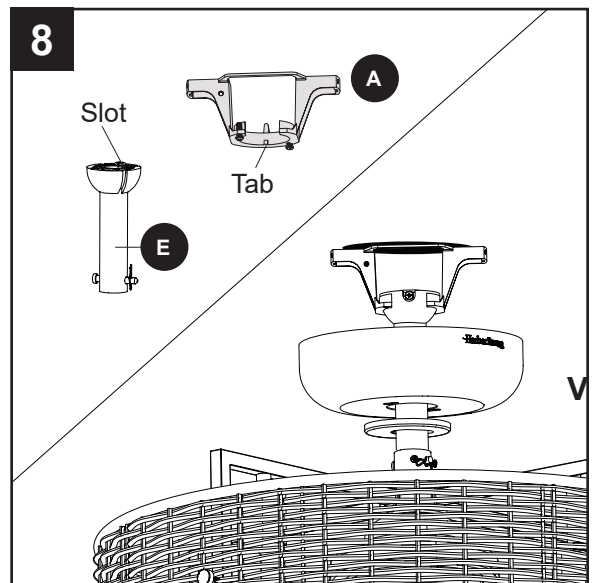



## ASSEMBLY INSTRUCTIONS

10. Wrap electrical tape (not included) around each individual wire connector down to the wire.

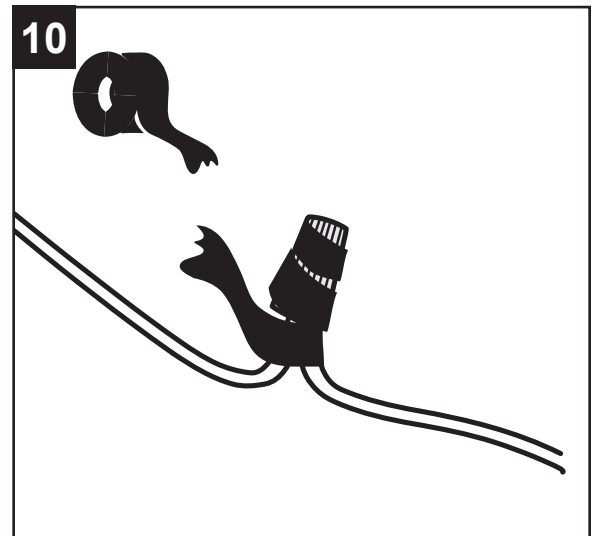

11. Turn the spliced/taped wires upward and gently push the wires and wire connectors into the outlet box.

**WARNING:** Ensure no bare wire strands are visible after making connections. Place the ground and neutral supply wire connections on opposite sides of outlet box from the hot wire connection.

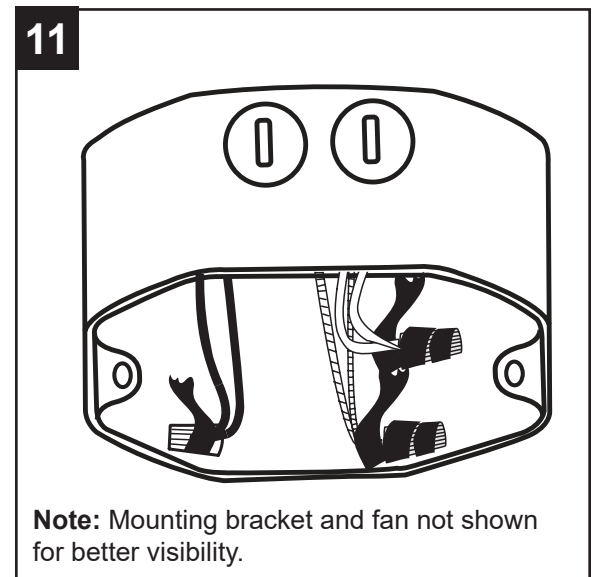

12. Insert the receiver from remote pack (J), antenna first, into the mounting bracket (A) with the flat side facing the ceiling.

**Note:** The receiver will rest directly on top of the downrod (E).

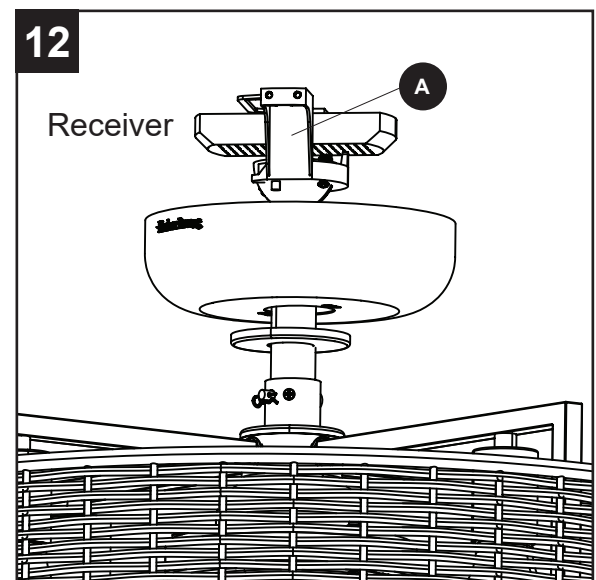

## ASSEMBLY INSTRUCTIONS

13. Slide the key slot in the canopy (C) over the head of the canopy screw (B) preassembled to the mounting bracket (A). Twist the canopy (C) clockwise to lock. Replace the canopy screw (B) in the round hole in the bottom of the canopy (C) and tighten both screws.

Lift the key slots in the inside of the canopy cover (D) over the heads of the canopy screws (B) preassembled to the mounting bracket (A). Twist the canopy cover (D) clockwise to lock.

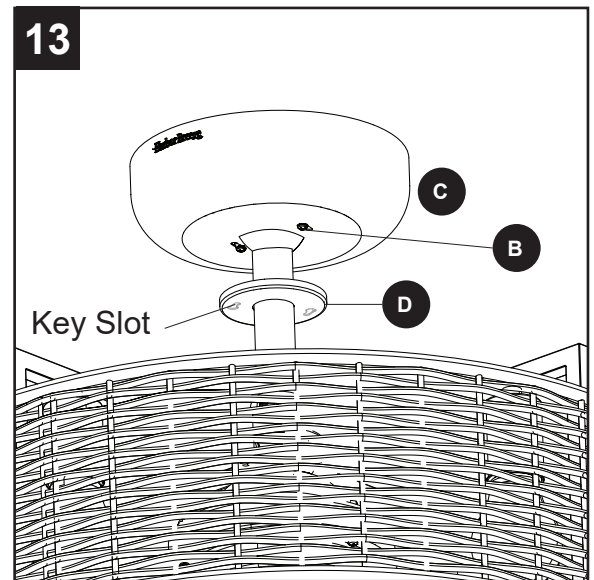

14. Install the E26-base LED bulbs (K) into the sockets of the light kit.

**Important:** Make sure you allow the bulbs and sockets to cool before you replace the bulbs.

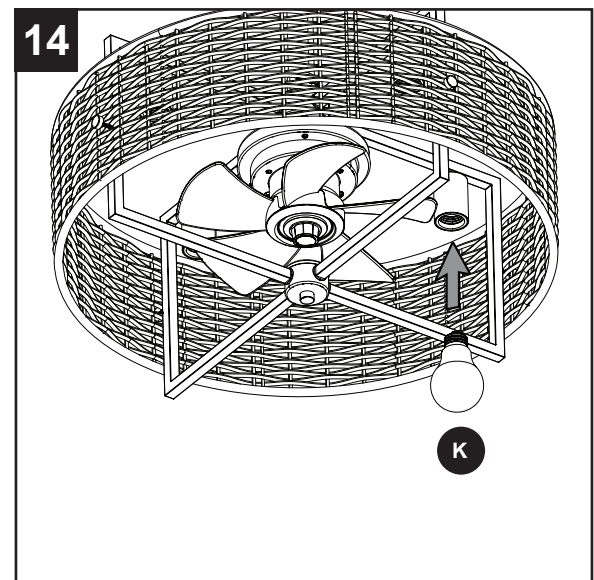

15. Remove the battery cover from the back of the remote found in remote pack (J). Insert the battery from remote pack (J) into the remote; ensure polarity of battery matches the polarity indicated in the battery compartment -- positive (+) to positive (+) and negative (-) to negative (-). Replace the battery cover and press the high fan speed button on the remote to ensure the remote turns on the fan.

**Note:** If remote does not turn on fan, see TROUBLESHOOTING (page 13).

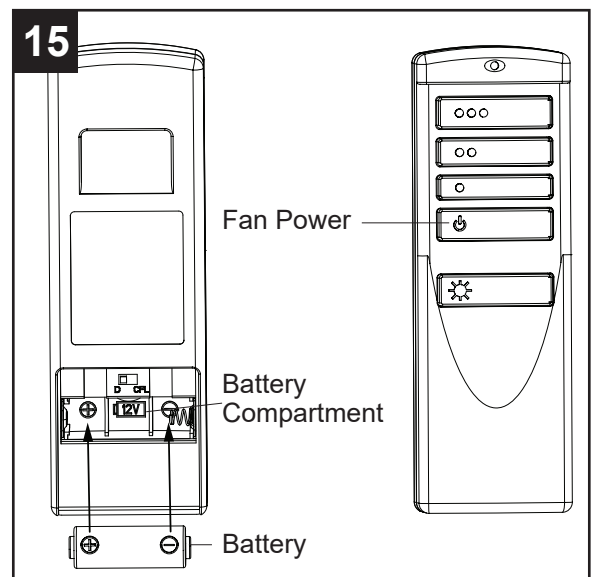

## ASSEMBLY INSTRUCTIONS

16. If desired, the remote pack wall bracket (J) can be mounted on a wall with the supplied mounting screws. The remote control of the remote pack (J) can be stored in the wall bracket for easy access.

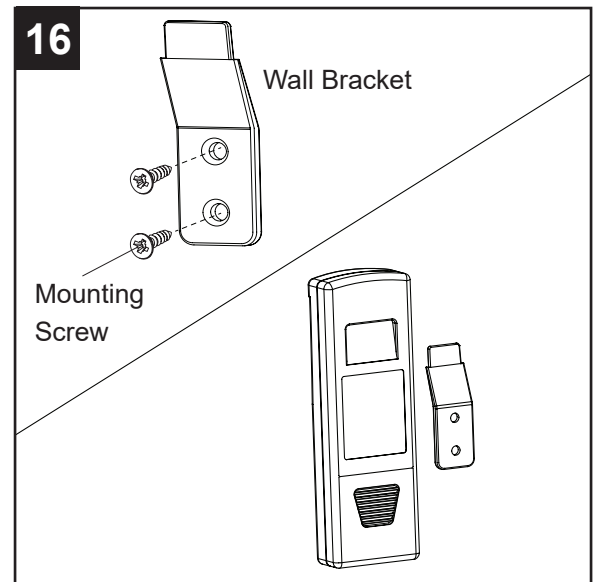

17. Turn on the circuit breakers and the wall switch to the fan supply line leads.  
Assembly is complete.

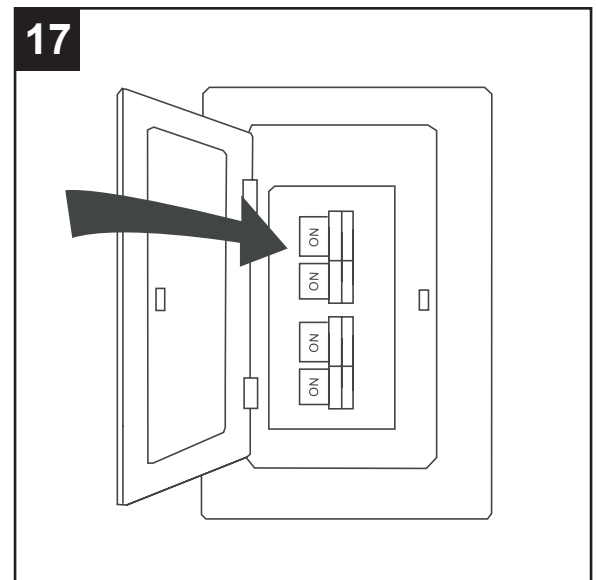

## OPERATING INSTRUCTIONS

1. To operate the fan using the remote, press and release the following buttons:

- 1 - High fan speed
- 2 - Medium fan speed
- 3 - Low fan speed
- 4 - Fan Power - Turns the fan off.

Light Delay Off mode - Press and hold the fan power button (4) for five seconds, which will turn off light after one minute. The LED indicator on the remote will flash four times to confirm mode setting.

5 - Light Control: Tap light control button to turn the light off and on. Press and hold the light control to dim and brighten lights.

6 - D/CFL Switch: Set to "D" at the factory. The switch should remain in the "D" position.

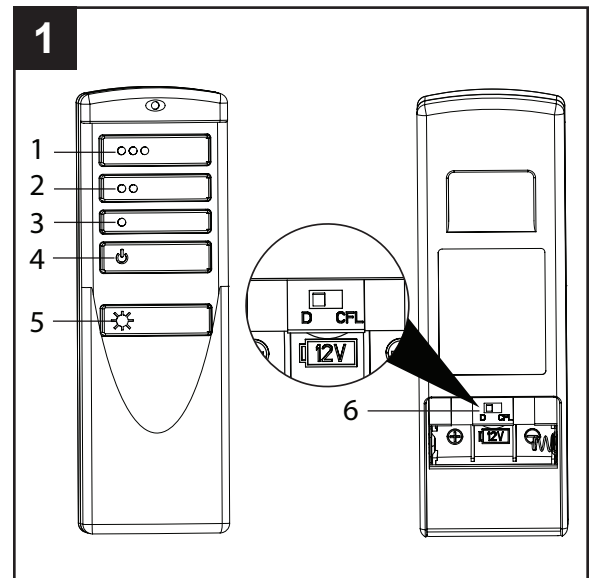

## CARE AND MAINTENANCE

At least twice each year, tighten all screws on the fan. Clean the motor housing with only a soft brush or lint-free cloth to avoid scratching the finish. Clean the blades with a lint-free cloth.

**Bulb Replacement:** Use 40-watt max. E26-base LED, CFL or incandescent bulbs. Halogen bulbs are not recommended for this item.

**Battery Replacement:** Use A23, 12-volt battery. Exhausted batteries should be removed from the remote. Non-rechargeable batteries should not be recharged. Do not dispose of batteries in fire, as they may explode or leak.

**Important:** Shut off the main power supply before you begin any maintenance tasks. Do not use water or a damp cloth to clean the ceiling fan.

## TROUBLESHOOTING

PROBLEM	POSSIBLE CAUSE	CORRECTIVE ACTION
The fan does not move.	<ol style="list-style-type: none"><li>1. The power is off or the fuse is blown.</li><li>2. There is a faulty wire connection.</li></ol>	<ol style="list-style-type: none"><li>1. Turn the power on or check the fuse.</li><li>2. Turn the power off. Loosen the canopy and check all connections.</li></ol>
The fan operates correctly, but the lights are not working.	There is a faulty wire connection.	Turn the power off and check all connections at the ceiling outlet box.
Remote control does not work.	<ol style="list-style-type: none"><li>1. Power surge may have cleared memory and remote needs to be re-synced to the receiver.</li><li>2. Battery in remote control needs to be replaced.</li><li>3. Interference from another remote.</li></ol>	<ol style="list-style-type: none"><li>1. After installation is complete, switch the power off and back on again. Within 30 seconds, press and hold the "LEARN" button, located in the battery compartment, for 5 seconds. Fan will turn on at low speed and light off. This confirms that the SMART SYNC is active.</li><li>2. Insert new 12V battery in battery compartment of the remote control (see page 10).</li><li>3. If there are several fans in proximity, turn power off to other fans and re-sync the remote (see Corrective Action 1 above).</li></ol>

## **LIMITED LIFETIME WARRANTY**

---

Set forth below, the manufacturer warrants the fan motor for this ceiling fan to be free from defects in workmanship and material for the life of the product. Also, subject to the limitations below, the manufacturer warrants all ceiling fan parts ("ceiling fan parts" excludes the motor and parts made in whole or in part with glass) to be free from defects in workmanship and material for a period of one year after the date of purchase by the original purchaser at retail.

All claims must be made by the original purchaser from an authorized dealer, whether such purchaser purchased the product through a store or contractor. Ceiling fan part defects must be reported within the first year from the date of purchase. Parts made in whole or in part with glass and the finishes of metal and other surfaces are not warranted.

Purchasers are responsible for all costs of removing and reinstalling the product. Any damage to any part caused by ordinary wear and tear, accident, misuse, or improper installation, is not covered by this warranty. The manufacturer assumes no responsibility whatsoever for fan installation. Any service performed by a non-licensed electrician will render the warranty invalid.

The manufacturer's sole responsibility shall be to repair or replace the motor, parts, or product within the terms stated above. The manufacturer shall not be liable for any loss or damage of any kind, including any incidental or consequential damages resulting directly or indirectly, from any breach of warranty, express or implied, or any other failure of this product. Some states do not allow the exclusion or limitation of incidental or consequential damages so this limitation may not apply to you.

If the original purchaser ceases to own the fan, this warranty is voided.

Should the purchaser encounter a problem with your fan related to defects in workmanship or materials within the warranty period associated with the defective part, the manufacturer agrees to replace the defective part without charge, or at its option, to replace the ceiling fan with a comparable or superior model.

The manufacturer's warranties are limited to the written warranties set out in this ceiling fan limited lifetime warranty. All other express and implied warranties, including, without limitation, the implied warranty of fitness for a particular purpose and the implied warranty of merchantability is disclaimed. Some states do not allow the disclaimer of implied warranties, so this disclaimer may not apply to you.

REPLACEMENT PARTS LIST

For replacement parts, call the customer service department at **888-251-1003**, 8 a.m. - 8 p.m., EST, Monday - Sunday. You could also contact us at **ascs@lowes.com**.

PART	DESCRIPTION	PART#	COVERED UNDER WARRANTY
A	Mounting Bracket	4L000016910	YES - 1 year
C	Canopy	4L000016920	YES - 1 year
D	Canopy Cover	4L000016930	YES - 1 year
E	Downrod	4L000016940	YES - 1 year
J	Remote Pack	4L000016950	YES - 1 year

