

**KCHS0025-MB**

## PART LIST

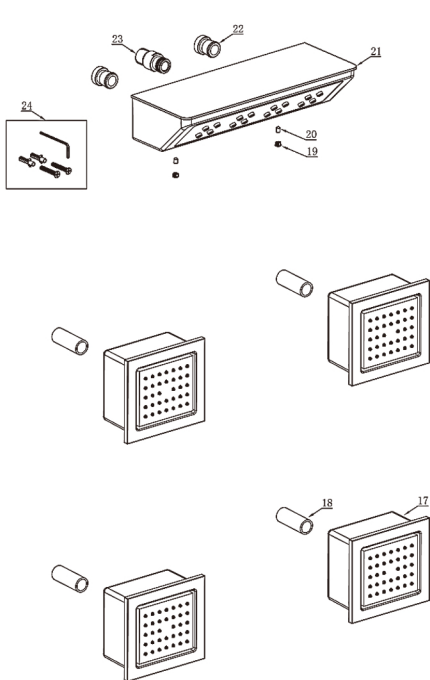

NO.	Part name	QTY
1	Valve Body	1
2	Valve trim panel	1
3	Temperature knob	1
4	Set screw	1
5	Screw hole plug	1
6	Set screw	4
7	Push button connector	4
8	Screw	4
9	Push button cap	4
10	Anchor kit	1
11	Hand shower arm connector	1
12	Trim plate	1
13	Shower hose	1
14	Set screw	1
15	Hand shower arm	1
16	Hand shower	1
17	Body jet	4
18	Body jet connector	4
19	Screw hole plug	2
20	Set screw	2
21	Back spray head	1
22	Mounting adapter	2
23	Back spray connector	1
24	Anchor kit	1

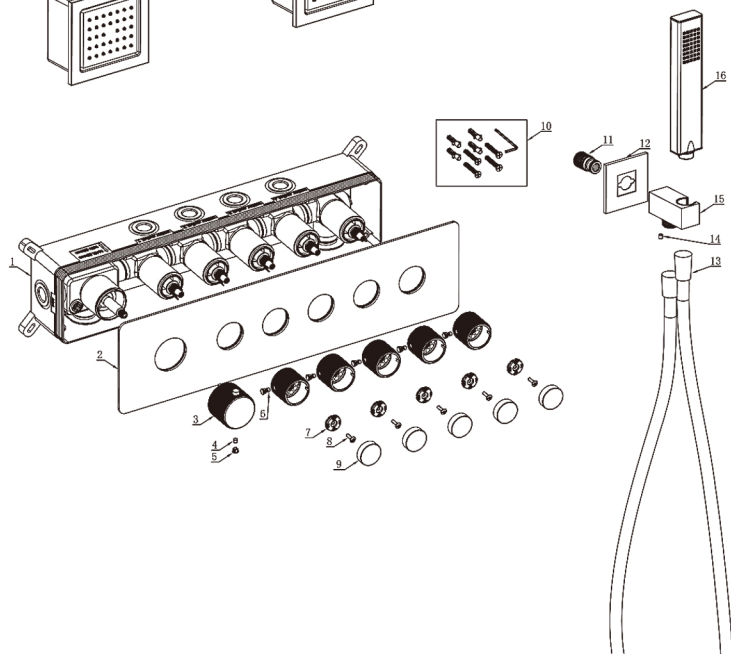

## Piping diagram

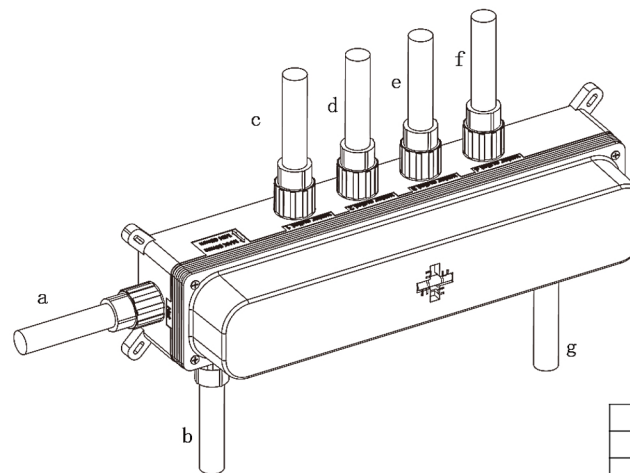

a	Hot water inlet
b	Cold water inlet
c	Shower head outlet
d	Waterfall head outlet
e	Back spray head outlet
f	Body jet outlet
g	Hand outlet outlet

## Installation depth of valve body

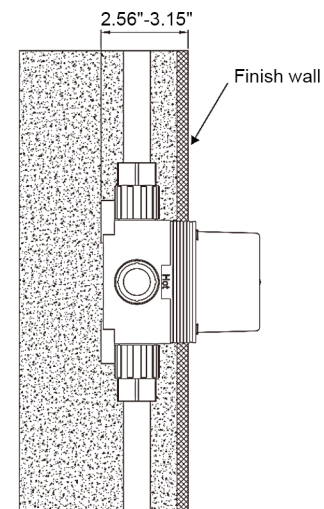

1. Secure the valve body to the mounting surface ensuring the valve body is level.

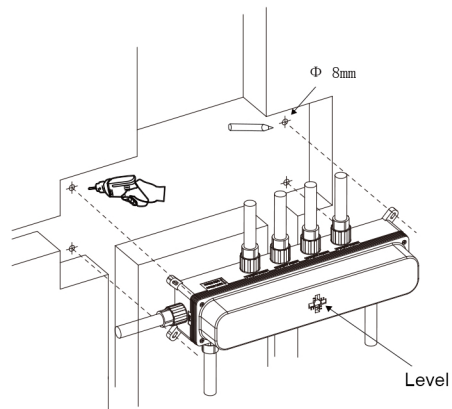

2. Wrap teflon tape around the threads of the male adapters and connect the hot, cold, shower head, and hand shower, back spray and body jet water lines to the valve body.

NOTE: See Step 12 Hand shower, Step 18 Back spray head, Body jet installation.

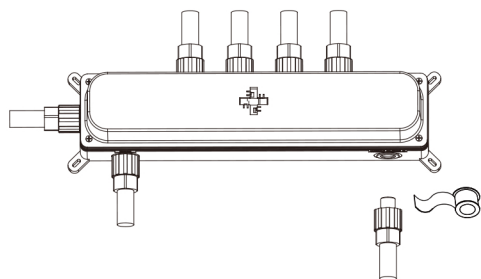

3. After the wall is finished, remove the plasterboard from the valve body and cut the valve body casing flush with the wall if necessary. Discard the plasterboard.

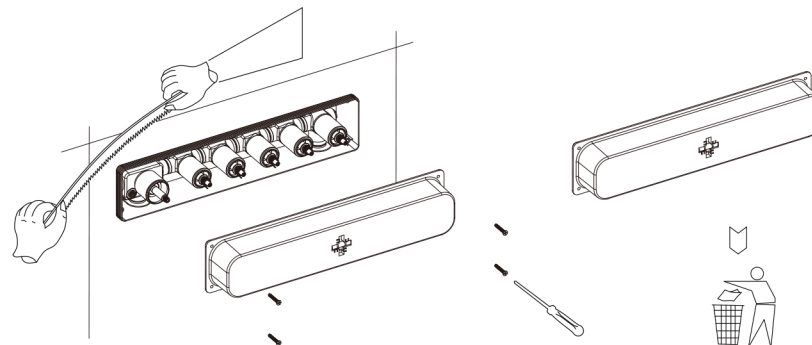

4. Rotate all the valve stems clockwise to their stopping point.

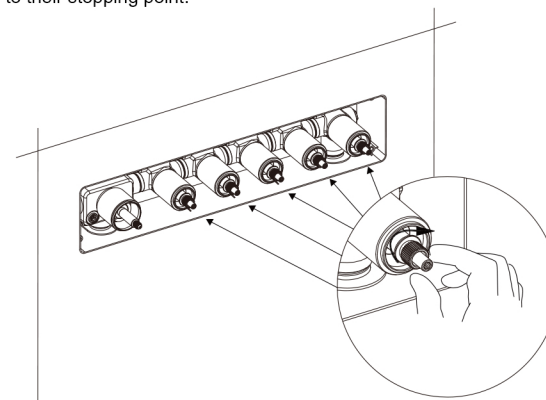

5. On the back side of the valve trim panel, run a bead of silicone around the edge and place it onto the valve body securing it to the finish wall.

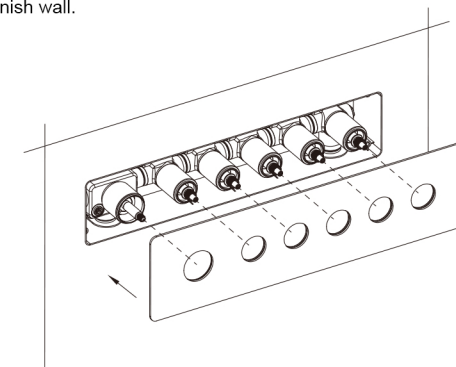

6. Install the valve trim panel and the diverter knobs as shown in the image below. Secure the knobs by using an Allen wrench to tighten the set screws.

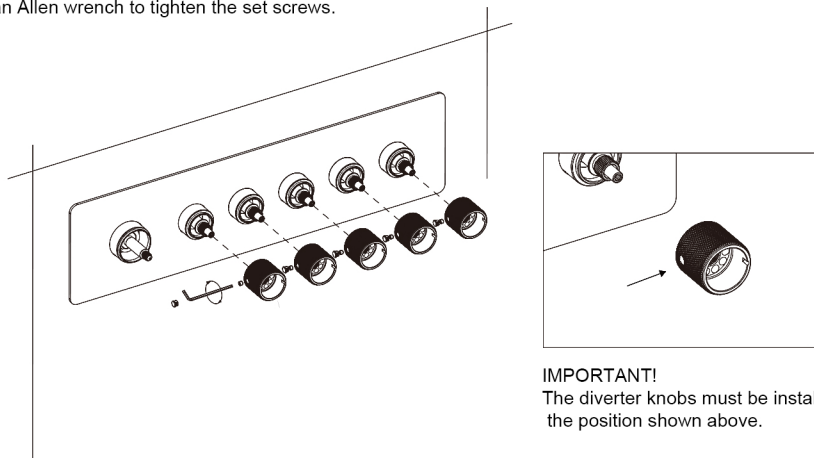

7. Insert the push button connectors into the knobs and secure.

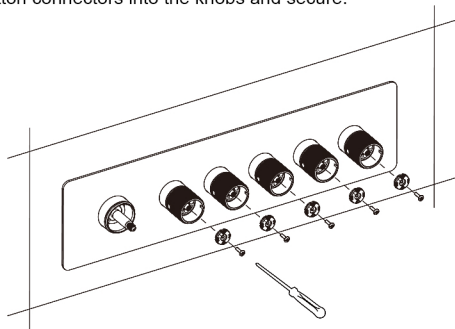

8. Insert the push buttons caps onto the diverter knob connectors making sure that they are even with the end of the knobs.

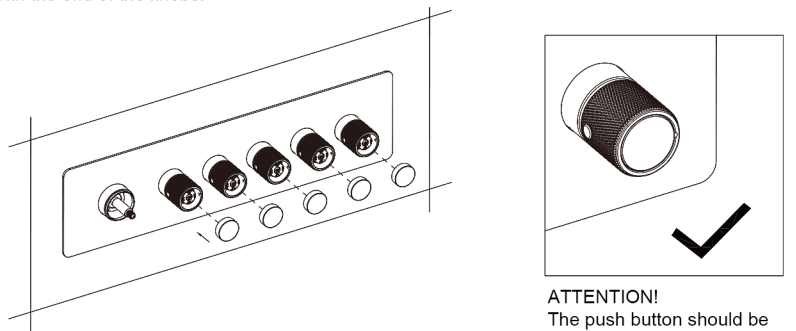

9. Install the temperature control knob exactly how it is shown in the image below. Secure the knob by using an Allen wrench to tighten the set screw.

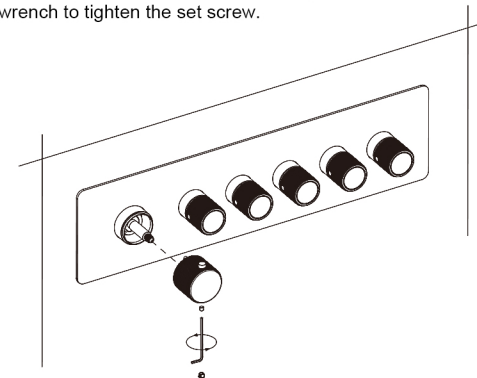

10. Valve trim panel and knob installation finished.

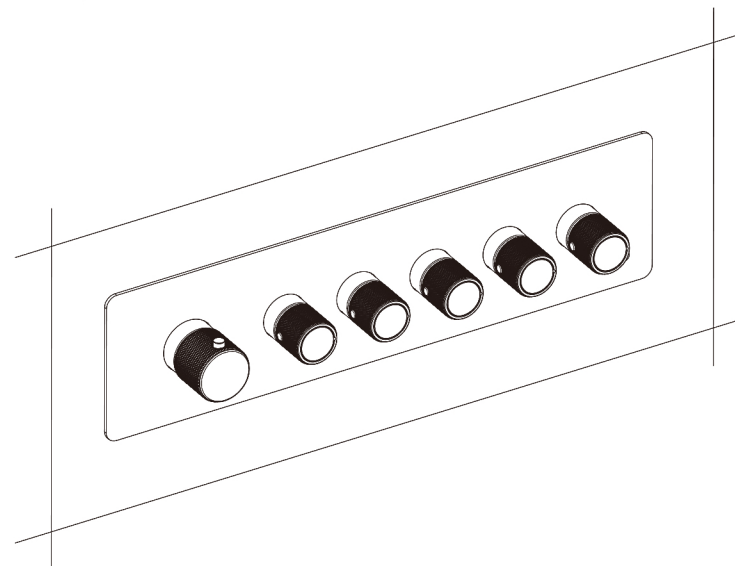



11. Install hand shower arm

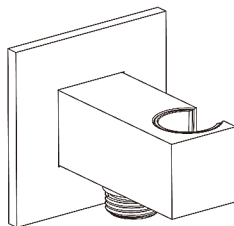

12. When piping the valve body, ensure that the connection for the hand shower is installed correctly, as shown in the images.

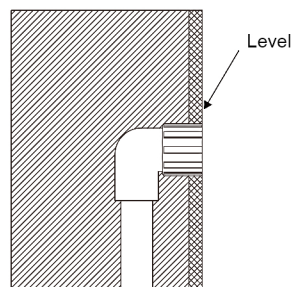
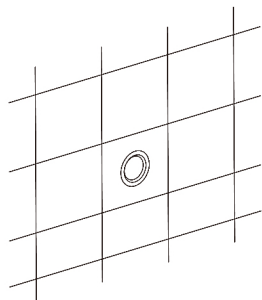

13. Wrap the threads of the hand shower arm connector and screw it into the wall connection, as shown in the images.

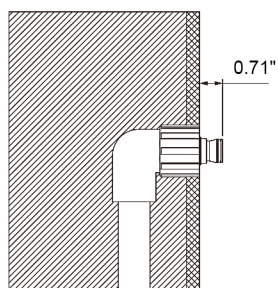
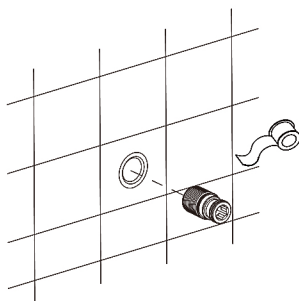

14. Place the trim plate onto the hand shower arm and secure the hand shower arm to the connector.

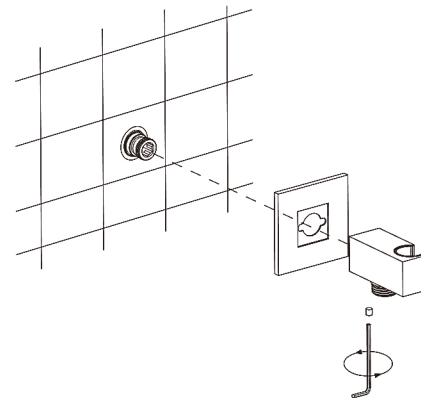

15. Connect the hand shower hose.

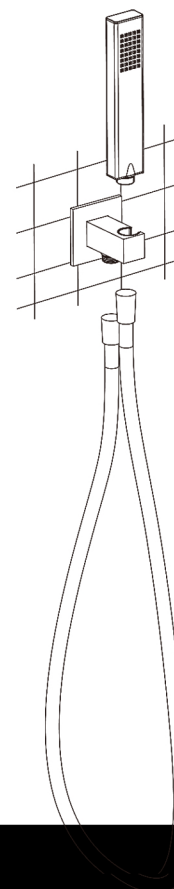

16. Hand shower installation finished.

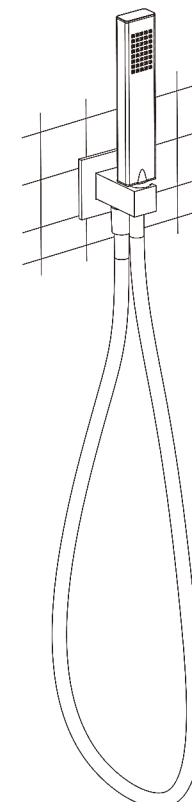

17. Install the back spray head

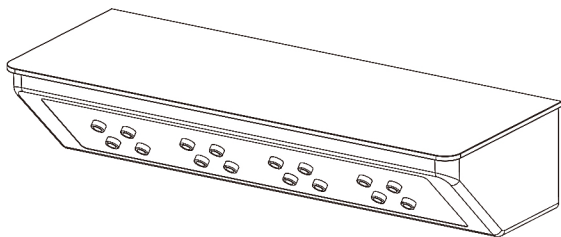

18. When piping the valve body, ensure that the connection for the back spray head piping is installed as shown in the images.

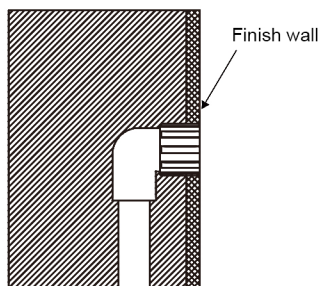
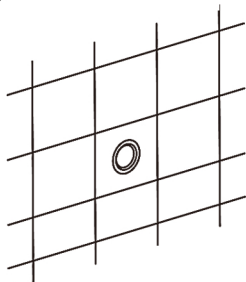

19. After verifying the center of the water outlet and distance needed for the mounting adapters mark the locations ensuring that both marks are level.

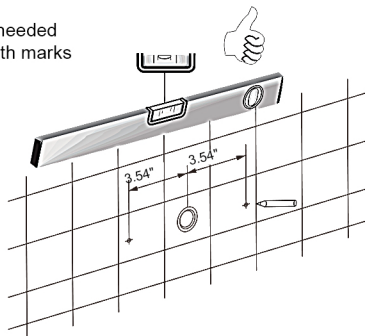

20. Wrap the threads of the back spray head outlet connector and screw it into the wall connection as shown in the images.

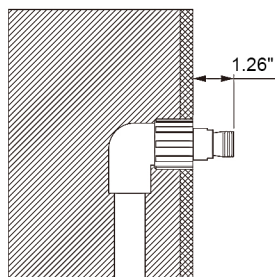
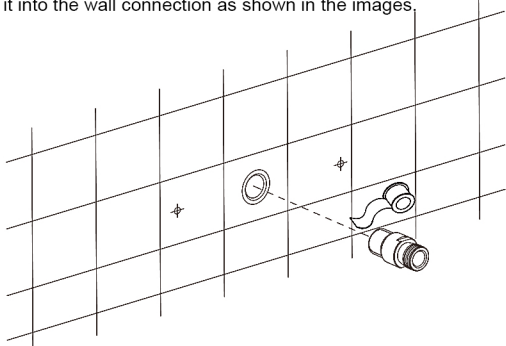

21. Drill out the two marks and secure the mounting adapters to the finish wall.

NOTE: If the adapters are not level across you will have a difficult time installing the back spray head.

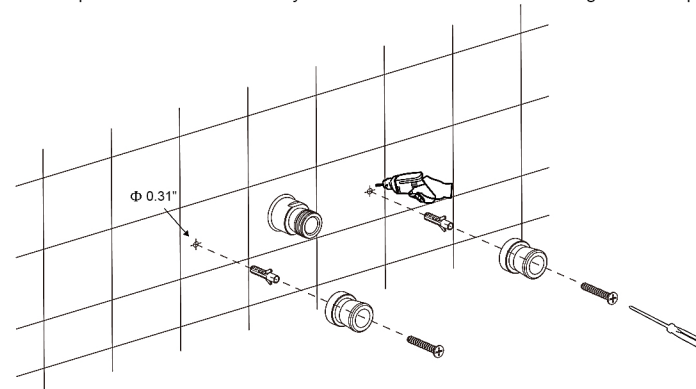

22. Install the back spray head onto the outlet connector and mounting adapters.

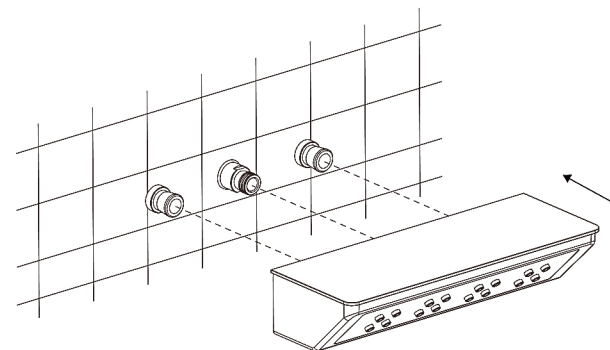

23. Tighten the two M5 screws to secure the back spray head.

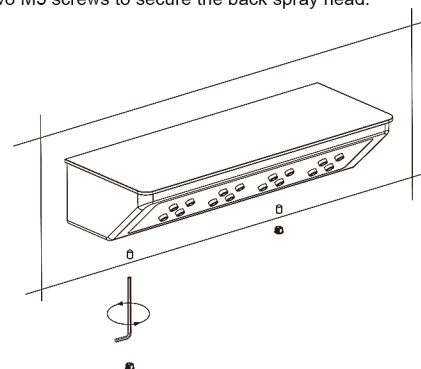

24

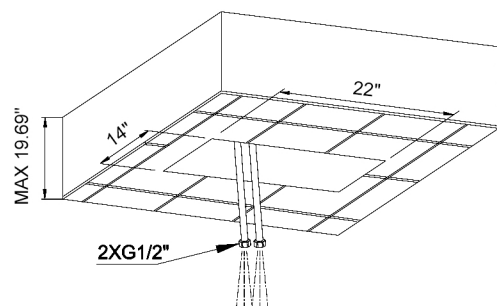

25

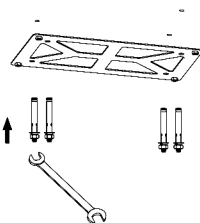
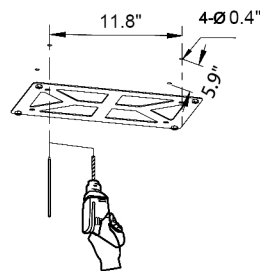
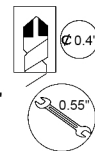

26

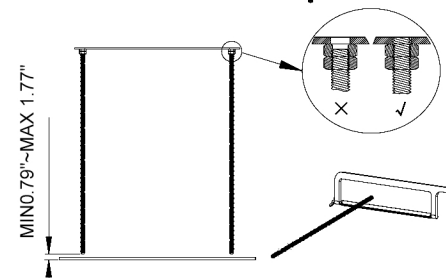
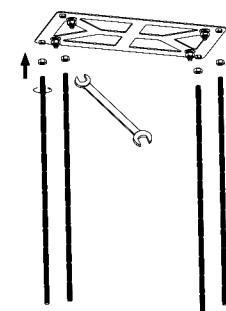

27

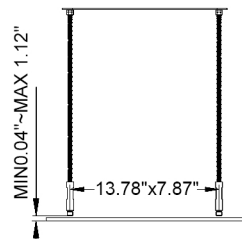
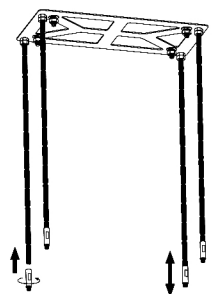

28

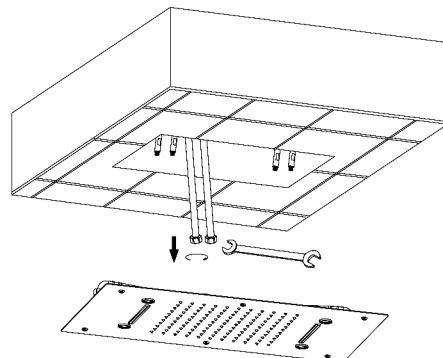

29

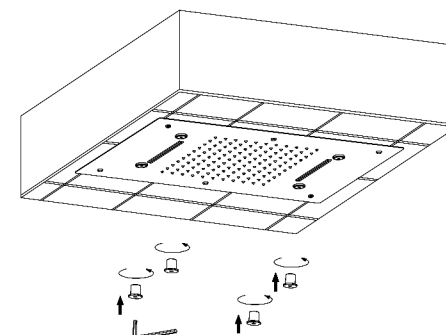

## 1. Parts list

1. Front plate
2. M4x12 Screws
3. Nozzle plate
4. M4x20 Screws
5. Main body
6. Connector
7. Cove plate
8. Cover
9. 1/2-NPT connector



the tools may be needed

## 2. Dimension

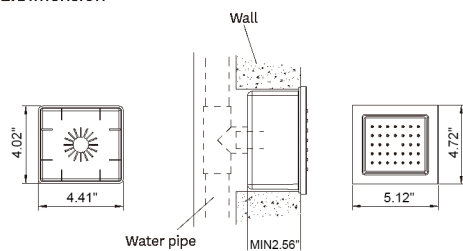

## 3. Drill a hole (size as below) in the wall

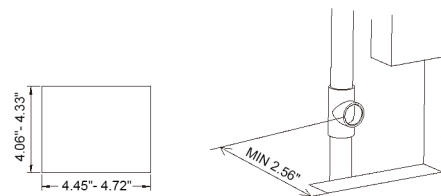

## 4. Install the 1/2-NPT connector as the photos shown

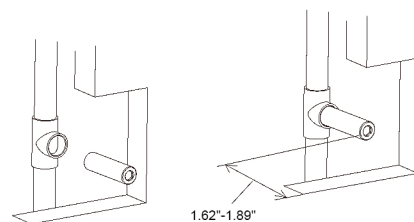

## 5. Install the cover as the photos shown

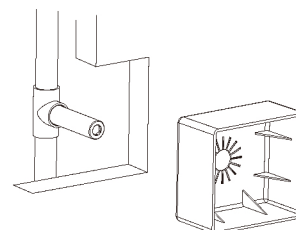

## 6. Install the cover plate as the photos shown

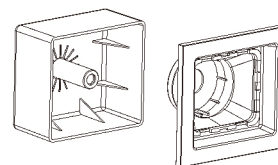

## 7. Install the connector as the photos shown

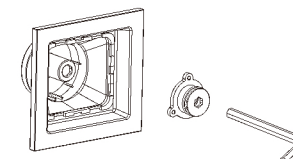

## 8. Install the main body as the photos shown

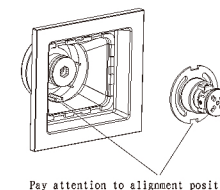

## 9. Lock the main body on the connector with the M4x20 Screws

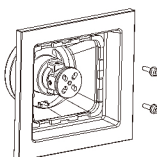

## 10. Lock the nozzle plate on the main body with the M4x12 Screws

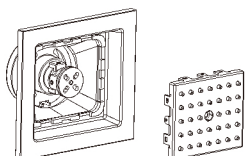

## 11. install the front plate as the photos shown

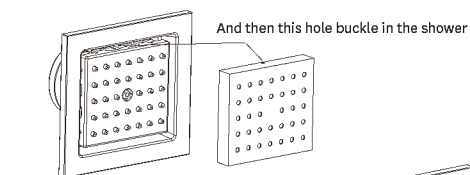
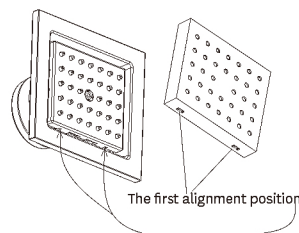

## 12. The installation is complete

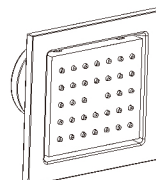

## CLEANING

Water contains lime which remains on the surface after the water has evaporated. These lime deposits can be prevented from forming by wiping immediately after use.

To clean the chrome-plated surfaces use a soft cloth, soap and warm water. Never use cleaning agents that contain a corrosive acid or a scouring additive.



Do not clean shower head nozzles with any sharp objects

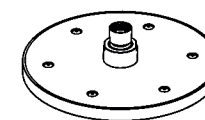

Clean filter washer periodically.

