

# 2 Pieces Rocking Chair Set

## Assembly Instructions

A103-001-001

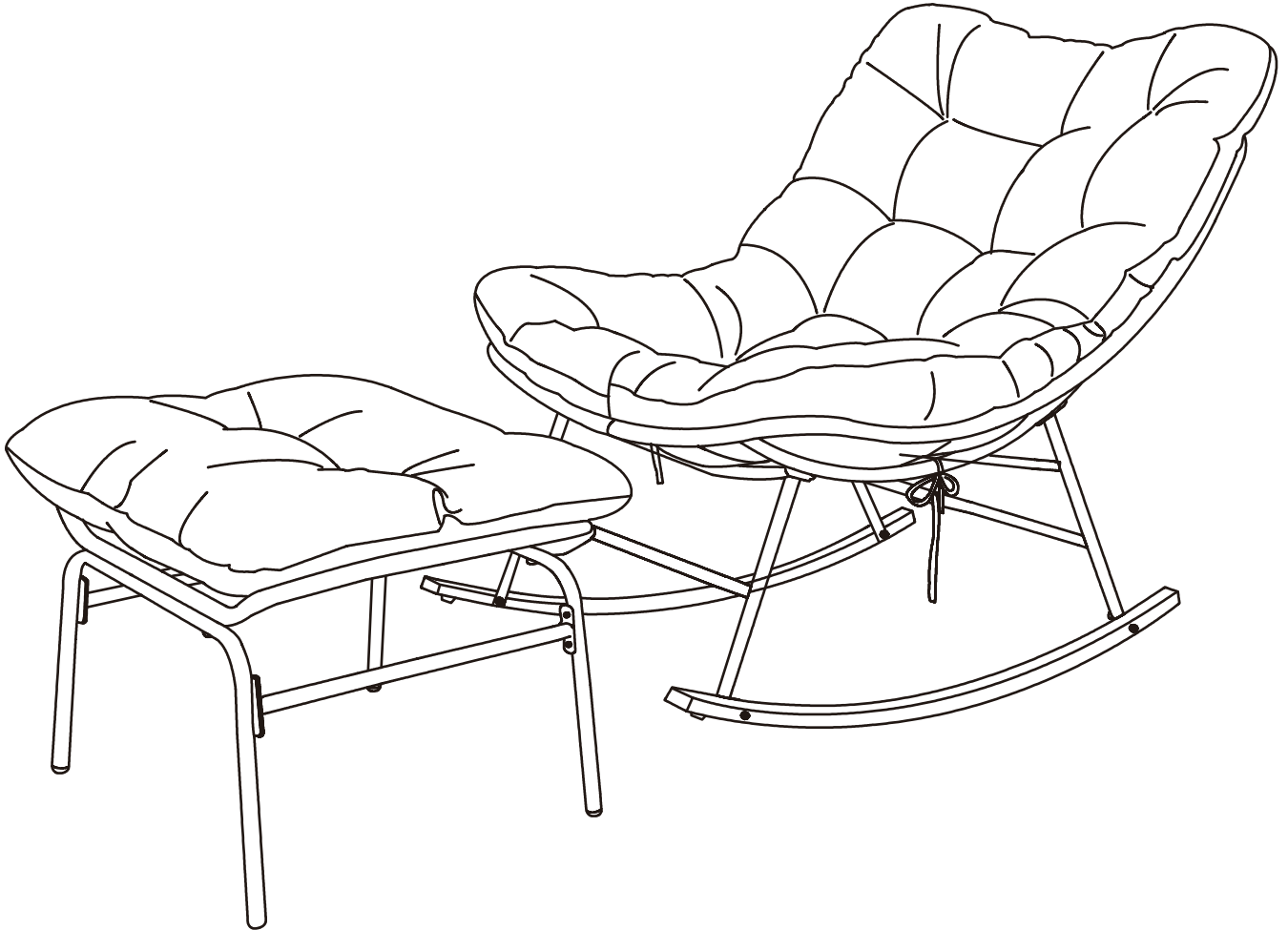

**KINDLY NOTICE-** Please read these instructions carefully before starting assembly

### HASSEL-FREE WARRANTY

We proudly provide 1-YEAR warranty, if there are any questions with the products, please feel free to contact with us.

✉ Email: [support@patio-outdoor.com](mailto:support@patio-outdoor.com)



The assembly will be easier with 2 people while 1 person could also do the job.



Around 20 MINS ASSEMBLY



# Parts List

Note: All parts of the screws should not be completely tightened the first time  
please tighten all screws after all parts are installed.

## Overview

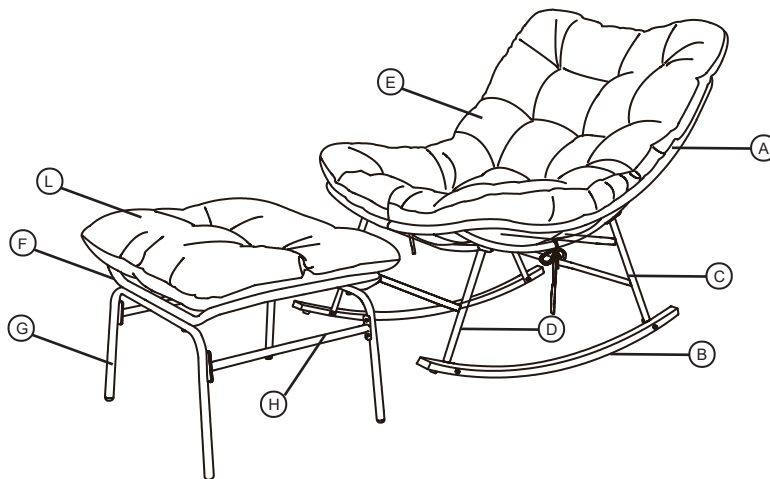

A1 1PCS	A2 1PCS	B 2PCS	C 1PCS Long leg	D 1PCS Short leg
E 1PCS	F 11PCS	G1 1PCS	G2 1PCS	H 2PCS
L 1PCS	① 4PCS M6x60mm	② 4PCS M6x35mm	③ 16PCS M6x15mm	④ 4PCS M8x80mm
⑤ 1PCS	⑥ 1PCS			



# Assembly-Rocking Chair

Note: All parts of the screws should not be completely tightened the first time please tighten all screws after all parts are installed.

## Step1

Connecting A1 and A2 with M6x60mm.

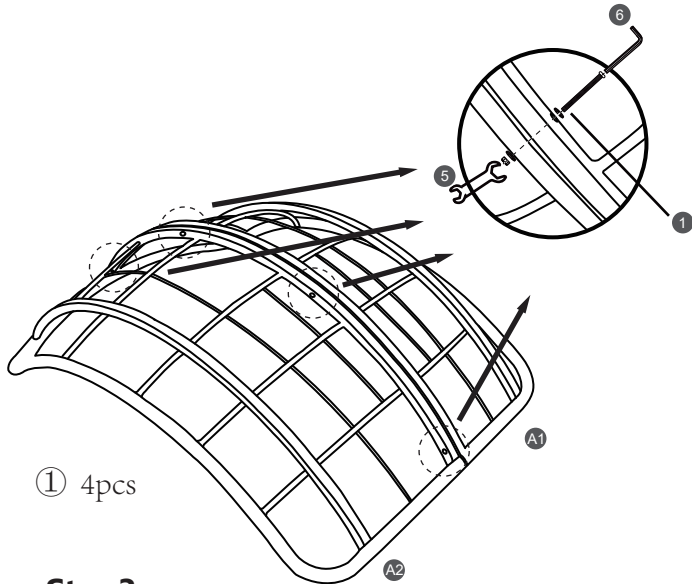

## Step2

Connect C and D to A1 and A2 using M6x15mm.

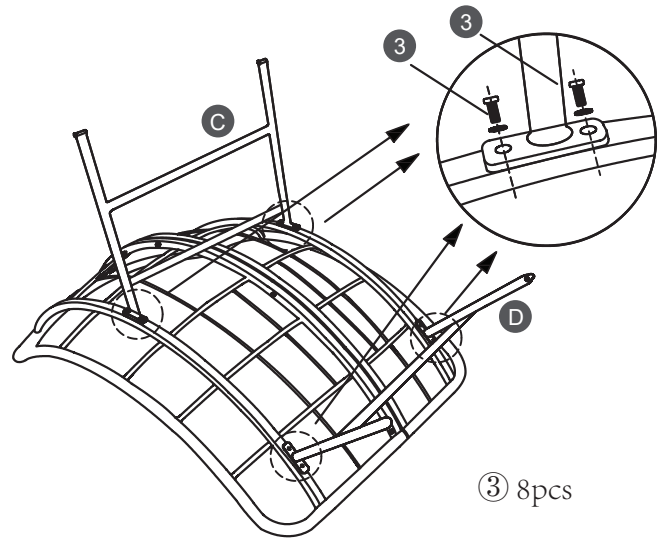

## Step3

Connecting B to C and D using M8x60mm.

**Note: Please place B on the outside of C and D when assembling.**

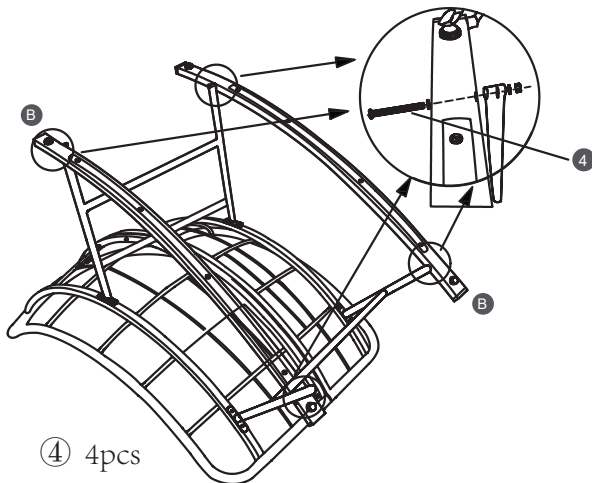

## Step4

Secure the E by tying it with a knot.

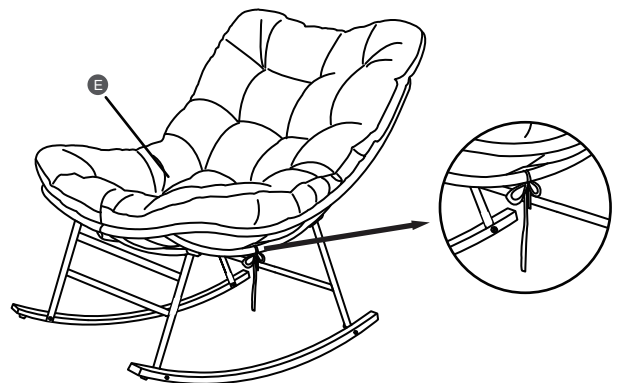



# Assembly-Ottoman

Note: All parts of the screws should not be completely tightened the first time please tighten all screws after all parts are installed.

## Step1

Connecting G1 and G2 to F using M6x45mm.

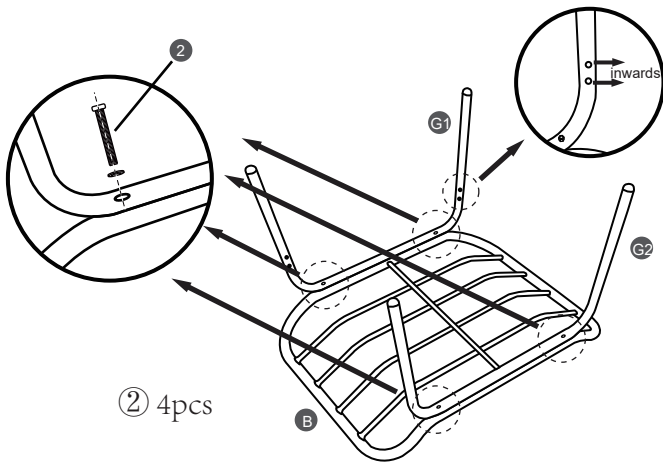

## Step2

Use M6x15mm to connect H to G1 and G2.

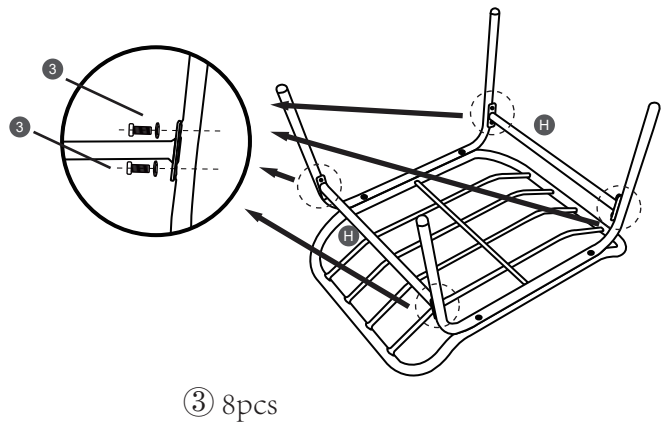

## Step3

Place L on top of F.

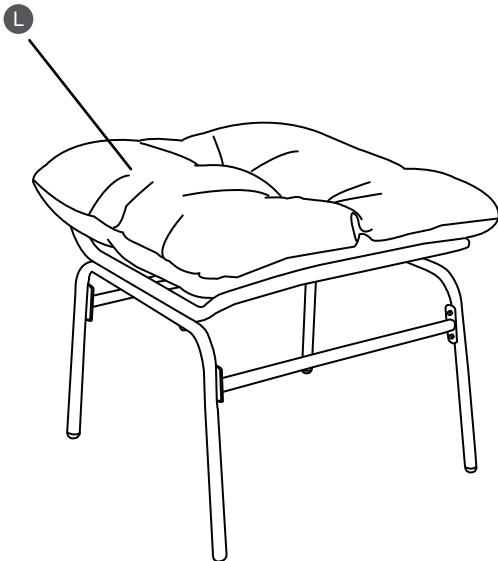





# WARRANTY

Outdoor furniture  
1-year Warranty Program

For a period of one (1) years after date of purchase, the Manufacturer will either repair or replace defective components in accordance with this Limited Warranty. This warranty is between the Manufacturer and the original purchaser and is valid only when accompanied by the original purchaser's sales receipt showing original date of purchase

The manufacturer or its authorized dealer can accept or reject warranty claims based on its findings. This warranty applies in normal residential use only and is not intended for commercial use. The Manufacturer can make substitutions as required of materials, components, and sub-components of comparable value and utility. This warranty is limited to product repair or replacement (to be determined solely by the Manufacturer). Warranty return is limited to only the single affected component.

This limited warranty covers only manufacturing defects and does not cover normal wear and tear, damage due to acts of nature (such as, but not limited to freezing or high winds), abuse or misuse, including chemical damage from suntan oil or other chemicals, exposure to extreme heat or cold, abrasion or excessive weight. This product is intended to be used in standard installations only. This warranty is void if the product is not used for its intended purpose. The Manufacturer disclaims liability for any aspect of installation and any inconvenience caused by a defective part of a component

## **Certain items are not covered by this warranty. These include, but are not limited to the following:**

1. Components subjected to abuse, including abuse intended to simulate failure
2. Damages caused by retailer, shipper or installation error (such as scratches, dents, tears, chips, etc.)
3. Any part that only shows normal wear and tear on the surface, including debris, scratches, or material stretching and stitching.
4. Tears, punctures, scratches or any damage caused by improper installation or use.

## **General care & maintenance**

Only clean using a damp cloth and mild detergent, do not use bleach or abrasive cleaners.

***\* If you need after-sales service, please provide the original purchase record and a brief description of the problem. Please also provide your email address or mobile number***