

ASSEMBLY INSTRUCTIONS



CAUTION

◆ Inspect the wire insulation for any cuts, abrasions, or exposed copper that may have resulted during shipping. If there is a defect in the wire, do not attempt installation.

◆ Before starting installation of this fixture or removal of a previous fixture, disconnect the power by turning off the circuit breaker or by removing the fuse at the fuse box.

TOOLS REQUIRED



Ladder



Safety glasses



Electrical tape



Phillips screwdriver



Flat blade screwdriver



Pliers

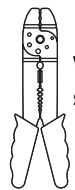

Wire strippers

HARDWARE INCLUDED

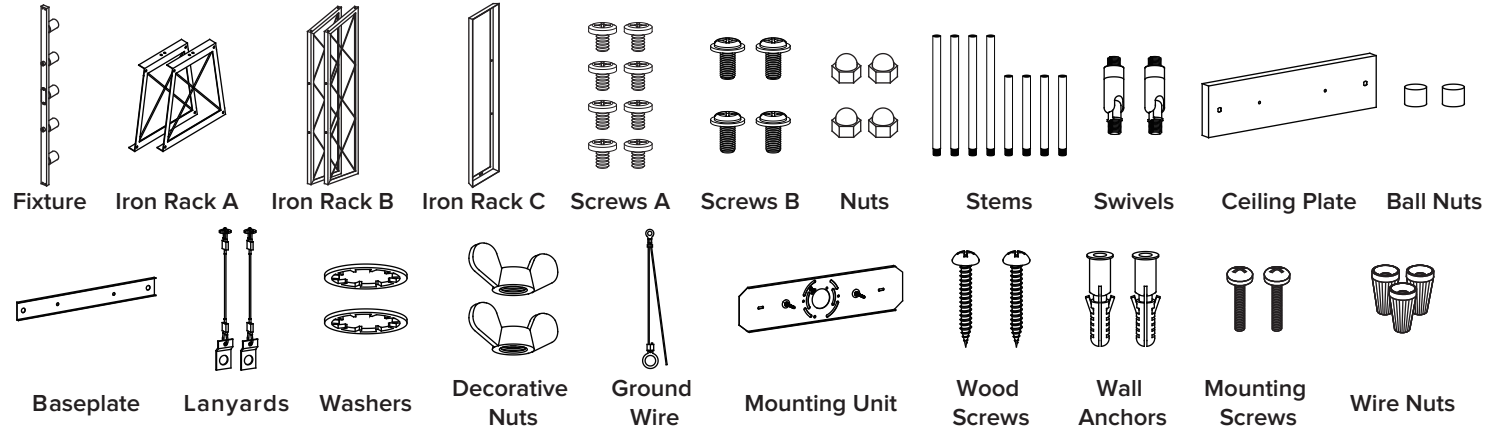

*PARTS SHOWN MAY DIFFER SLIGHTLY PER LIGHT FIXTURE

EXPLODED PARTS

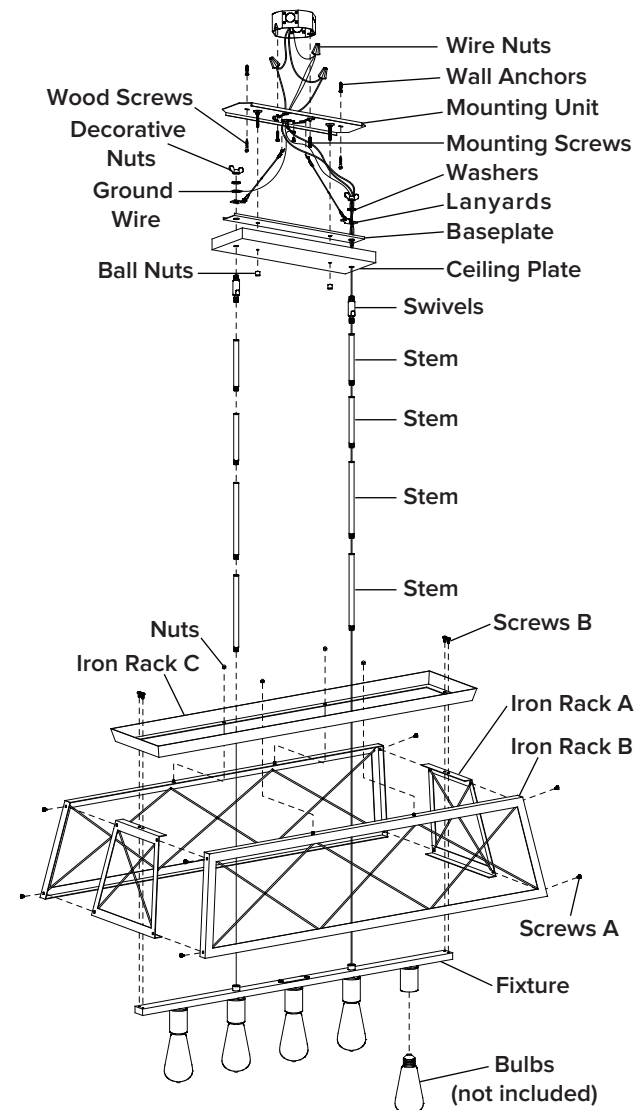

INSTALLATION

STEP 1

Attach the **iron rack B** into **iron rack A** using **screws A** as shown.

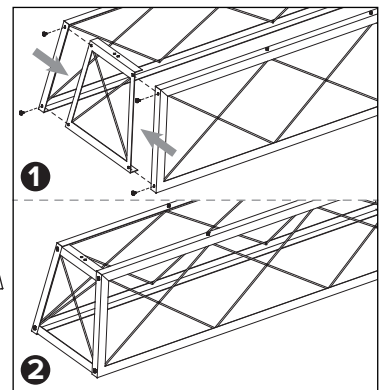
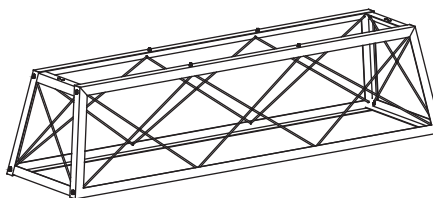

STEP 2

Attach the **iron rack C** into **iron rack B** using **nuts**.
Attach the **iron rack C** and **fixture** into **iron rack A** using **screws B**.

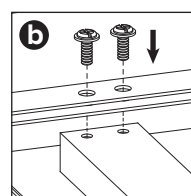
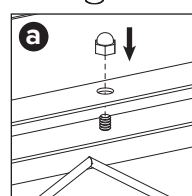
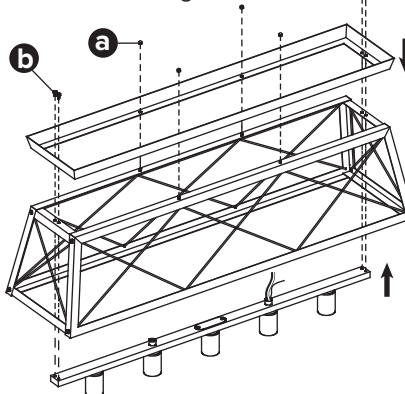

STEP 3

1. Unscrew the **ball nuts** and **green grounding screw** from the **mounting unit**.
2. Disassemble the **swivels** under the **ceiling plate** by unscrewing **decorative nuts**. Keep the **baseplate**, **washers**, **ground wire** and **lanyards** for later use.

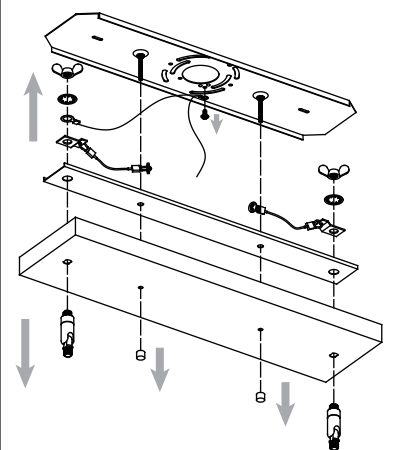

ASSEMBLY INSTRUCTIONS (INSTALLATION)

STEP 4

1. Weave the fixture wire and fixture ground wire through the **stems** and **swivel**.
2. Install **swivels** and **stems** into the **fixture**. Install **stems** based on the desired length of the item on the **fixture**.

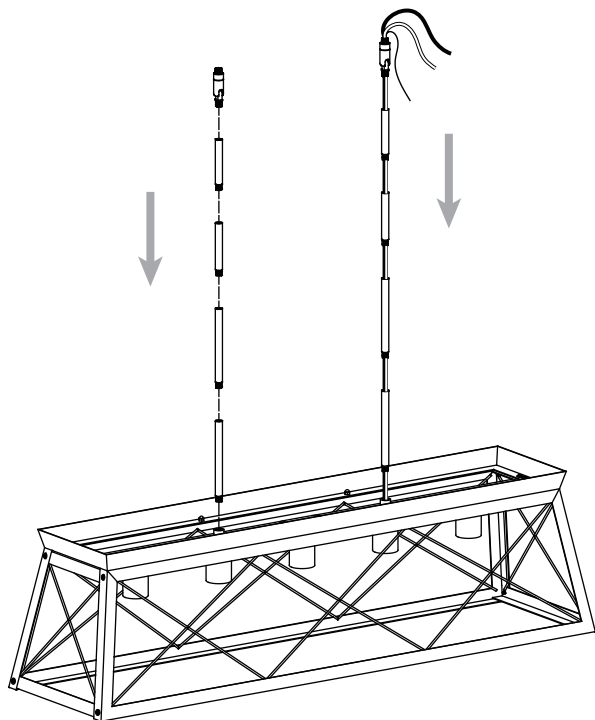

STEP 5

1. Weave the fixture wire and fixture ground wire through the **ceiling plate**, **baseplate**, **ground wire**, **lanyards**, **washer** and **decorative nut**.
2. Install **baseplate**, **lanyards**, **ground wire** and **swivels** into the **ceiling plate**, and secure with **washers** and **decorative nuts**.

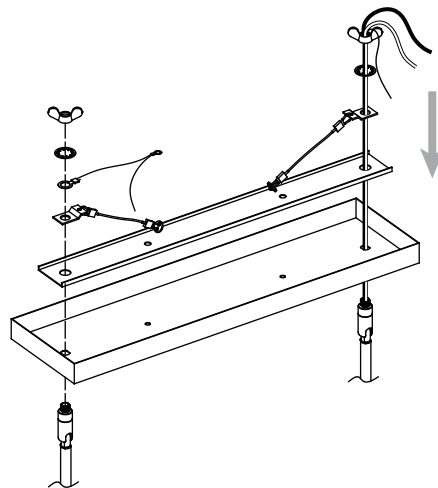

STEP 6

- Attach the **mounting unit** to the junction box using the **mounting screws**. Secure **mounting unit** to ceiling with **wood screws** and **wall anchors**.

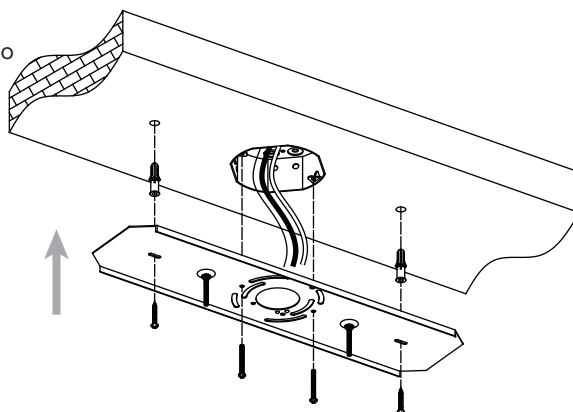

STEP 7

1. Attach the **lanyards** on to the mounting unit.
2. Make the electrical connection from the junction box to the **fixture**. Connect the **ground wire** to the **mounting unit** using the preinstalled green ground screw. Then, connect the positive, negative and ground wires with the supplied **wire nuts**. Secure with electrical tape.

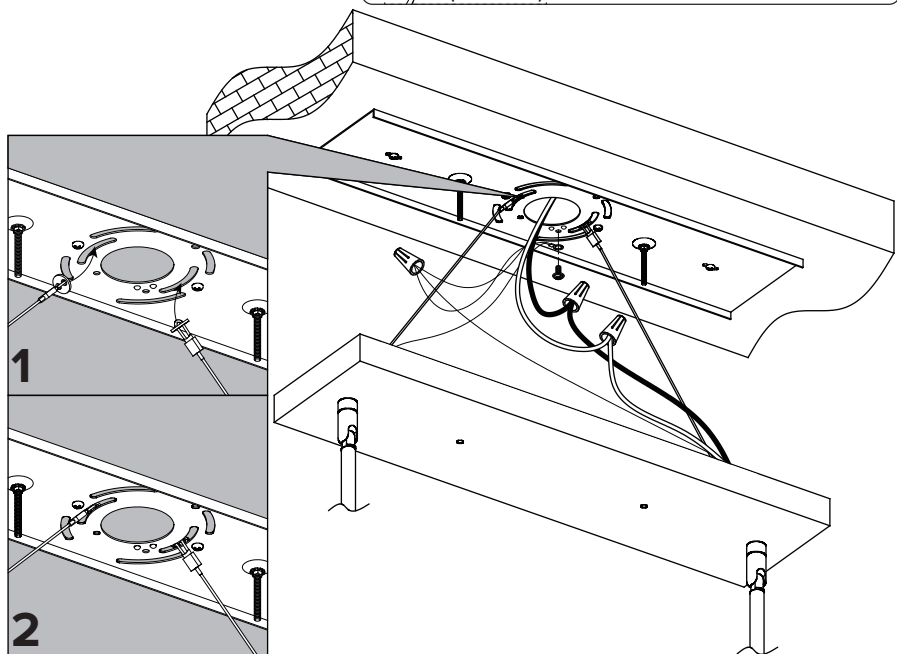
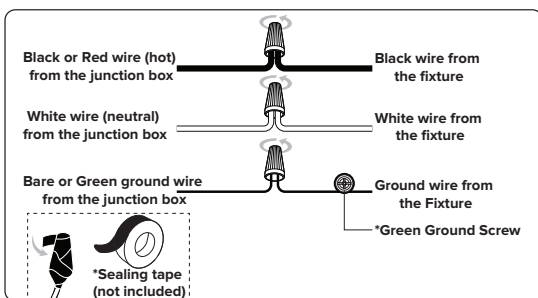

STEP 8

- Attach the **ceiling plate** to the **mounting unit** through screw holes as shown, and secure it with **ball nuts**.

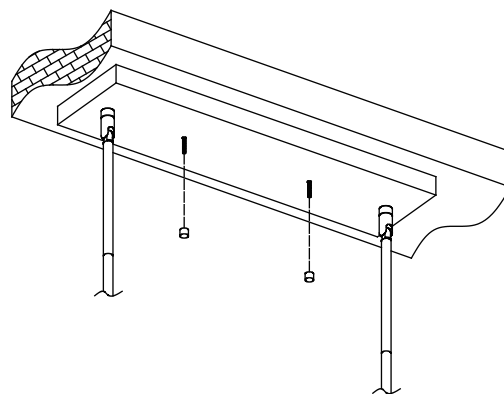

STEP 9

- Install bulbs (not included)

