

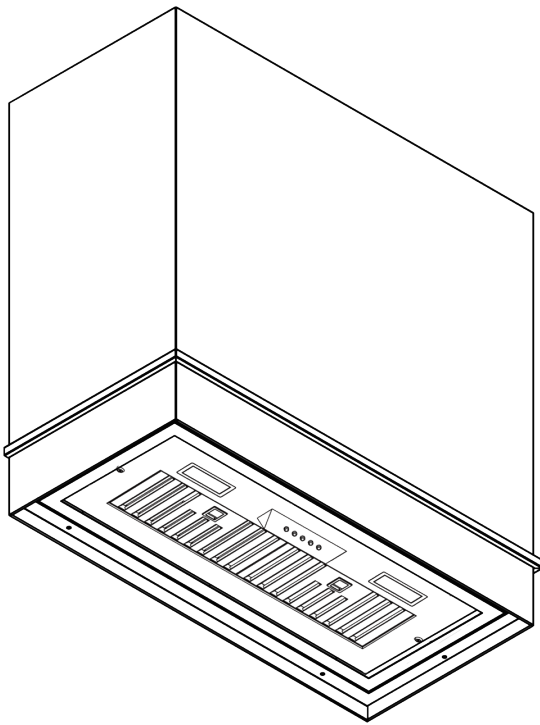

# Installation Manual

## MODEL NO.: NX-Hood 30 / 36



### MFG PART # :

AK-HS30HA-SWC	AK-HS36HA-SWC
AK-HS30HA-SWG	AK-HS36HA-SWG
AK-HS30HA-SWN	AK-HS36HA-SWN
AK-HS30HA-BSC	AK-HS36HA-BSC
AK-HS30HA-BSG	AK-HS36HA-BSG
AK-HS30HA-JBC	AK-HS36HA-JBC
AK-HS30HA-JBG	AK-HS36HA-JBG
AK-HS30HA-JBN	AK-HS36HA-JBN

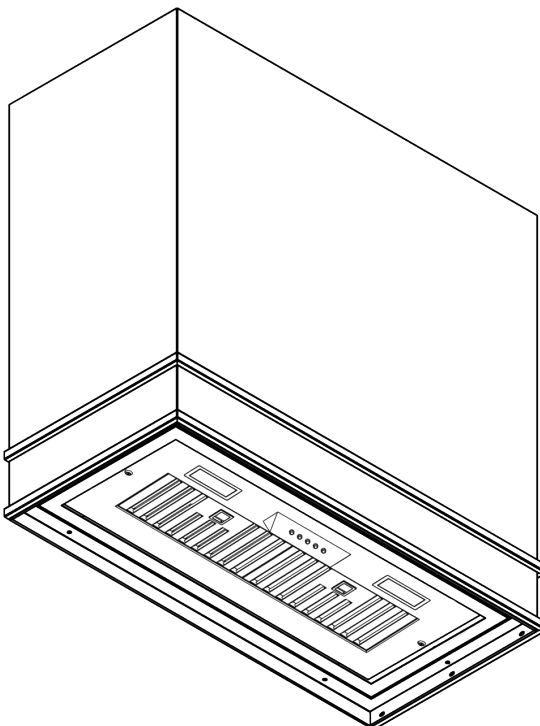

### MFG PART # :

AK-HS30HB-SWC	AK-HS36HB-SWC
AK-HS30HB-SWG	AK-HS36HB-SWG
AK-HS30HB-SWN	AK-HS36HB-SWN
AK-HS30HB-BSC	AK-HS36HB-BSC
AK-HS30HB-BSG	AK-HS36HB-BSG
AK-HS30HB-JBC	AK-HS36HB-JBC
AK-HS30HB-JBG	AK-HS36HB-JBG
AK-HS30HB-JBN	AK-HS36HB-JBN

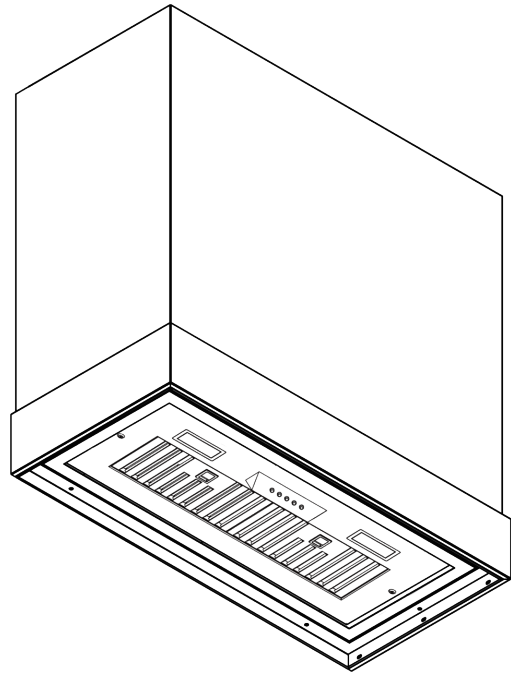
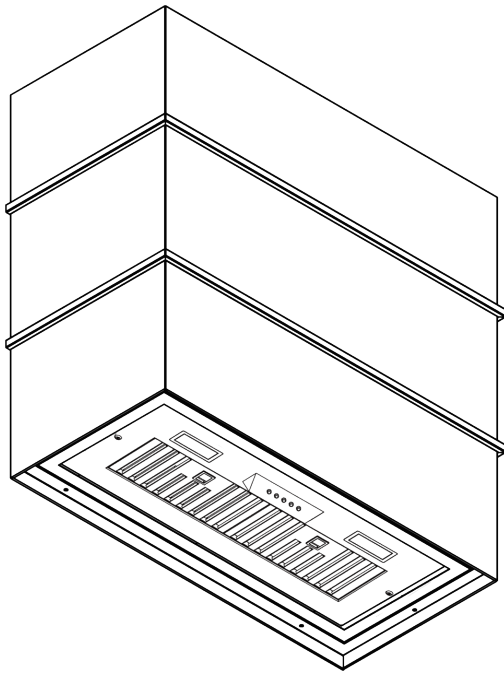

## MFG PART # :

AK-HS30HC-SWC	AK-HS36HC-SWC	AK-HS30HD-SWC	AK-HS36HD-SWC
AK-HS30HC-SWG	AK-HS36HC-SWG	AK-HS30HD-SWG	AK-HS36HD-SWG
AK-HS30HC-SWN	AK-HS36HC-SWN	AK-HS30HD-SWN	AK-HS36HD-SWN
AK-HS30HC-BSC	AK-HS36HC-BSC	AK-HS30HD-BSC	AK-HS36HD-BSC
AK-HS30HC-BSG	AK-HS36HC-BSG	AK-HS30HD-BSG	AK-HS36HD-BSG
AK-HS30HC-JBC	AK-HS36HC-JBC	AK-HS30HD-JBC	AK-HS36HD-JBC
AK-HS30HC-JBG	AK-HS36HC-JBG	AK-HS30HD-JBG	AK-HS36HD-JBG
AK-HS30HC-JBN	AK-HS36HC-JBN	AK-HS30HD-JBN	AK-HS36HD-JBN



**Prior to installation, please read the safety instructions carefully.**

This product is designed for two specific ventilation methods: top ventilation and rear wall ventilation. It is not compatible with side cabinet ventilation.

I would recommend conducting an electrical test before installation to ensure that the product functions properly. If you encounter any issues during the installation process, please don't hesitate to contact us at our after-sales service email address: [service@akiconshop.com](mailto:service@akiconshop.com). We will provide you with installation videos for reference.

There is an 8-inch pre-drilled hole at the rear of the product. Please ensure that the power panel is positioned to align with this hole. When arranging the placement of the ventilation duct and the power panel, be sure to do so thoughtfully to avoid any conflicts or obstructions.

## Step 1: Remove the insert vent from the hood.

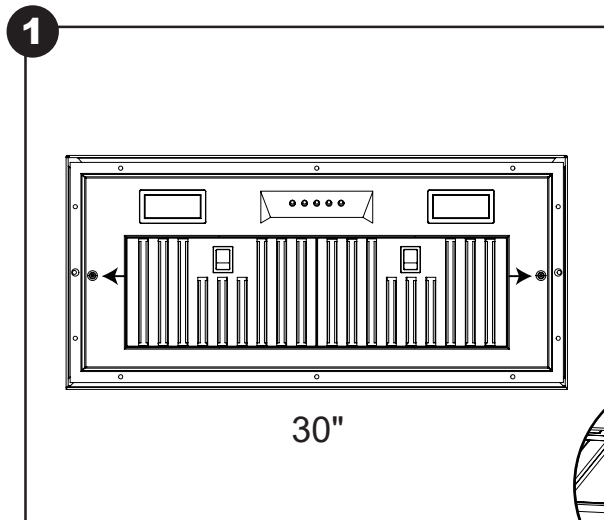

Loosen 2 pcs screws on the panel.

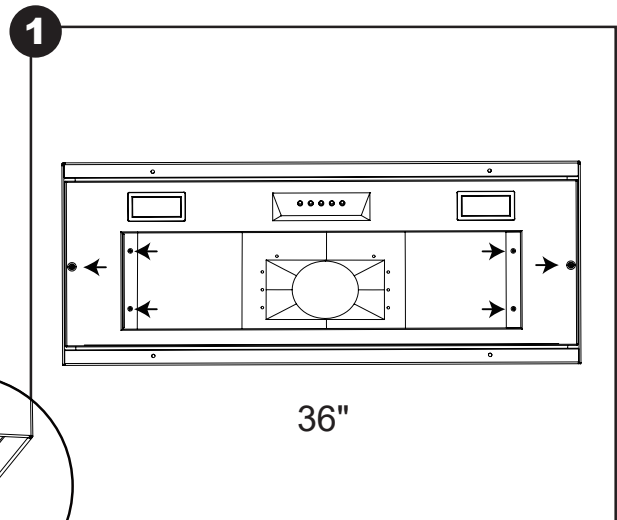

Loosen 6 pcs screws on the panel.

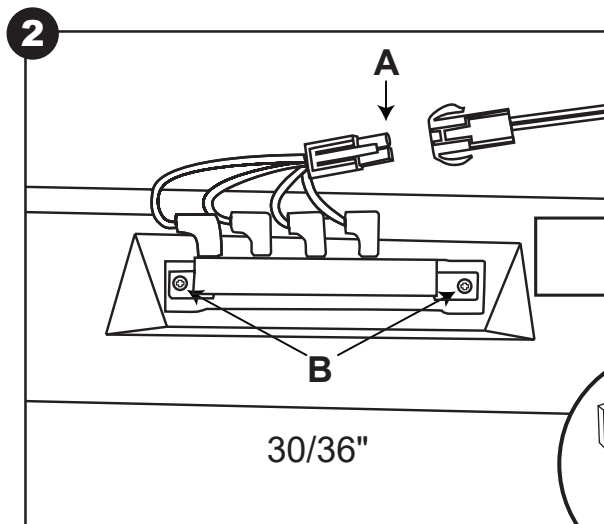

Loosen B screws and A plug to remove the button.

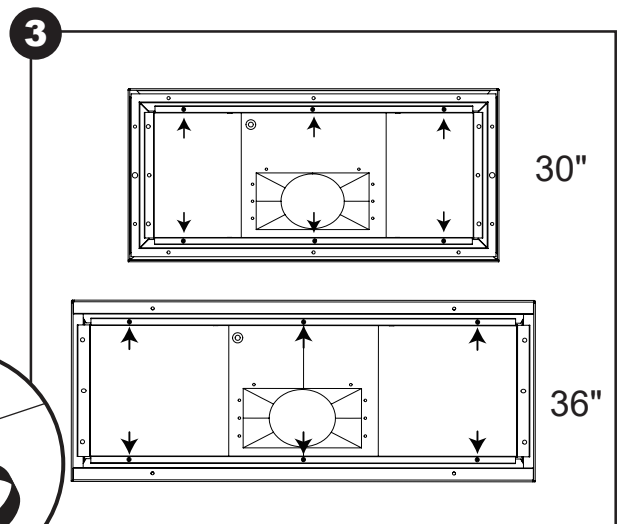

Loosen 6 pcs screws on the housing.

## Step 2: Install the hood on the wall.

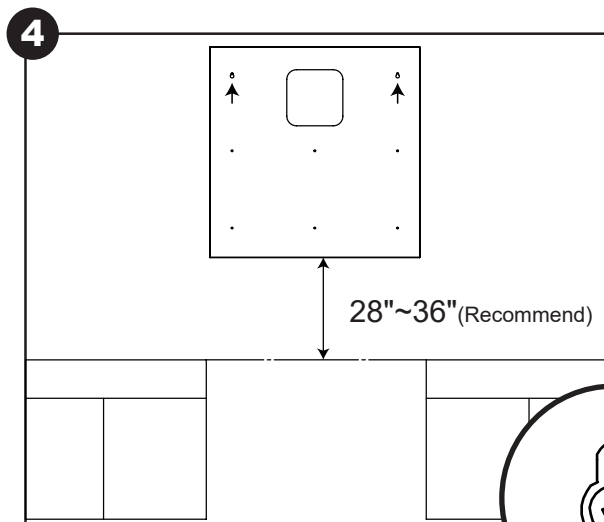

Level and use the template to fix the holes.

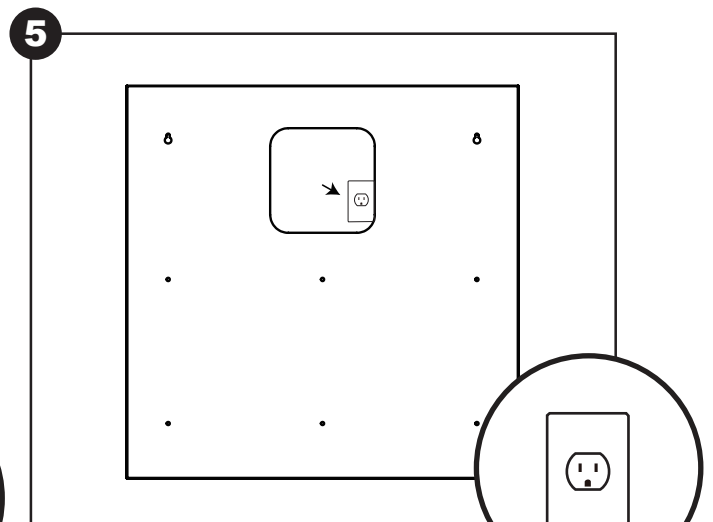

Install the power socket in the reserved hole

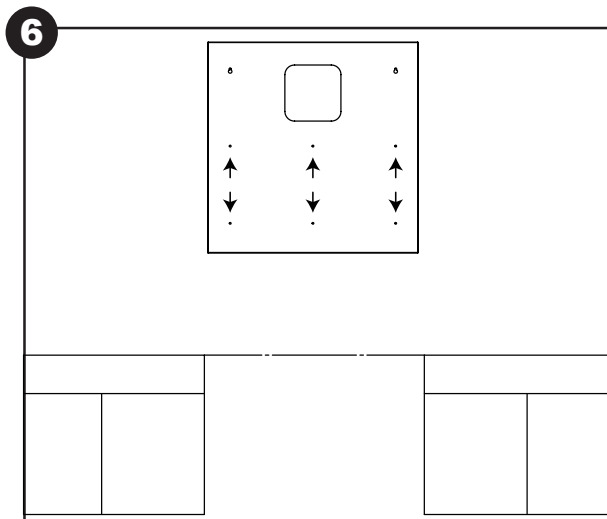

Install the hood on the wall.

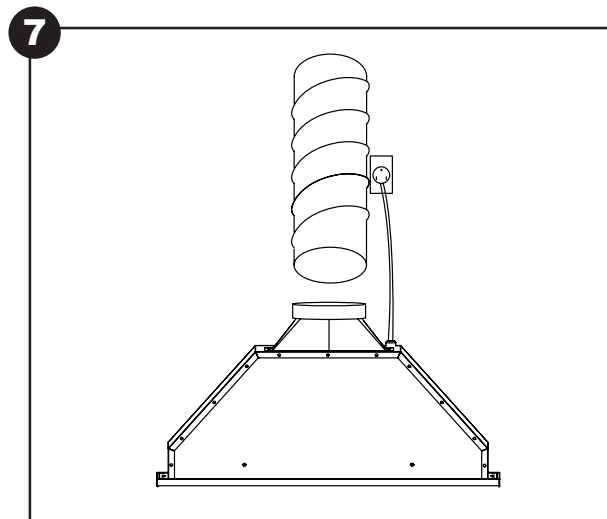

Install ventilation duct and plug in.

### Step 3: Install the insert vent on the hood.

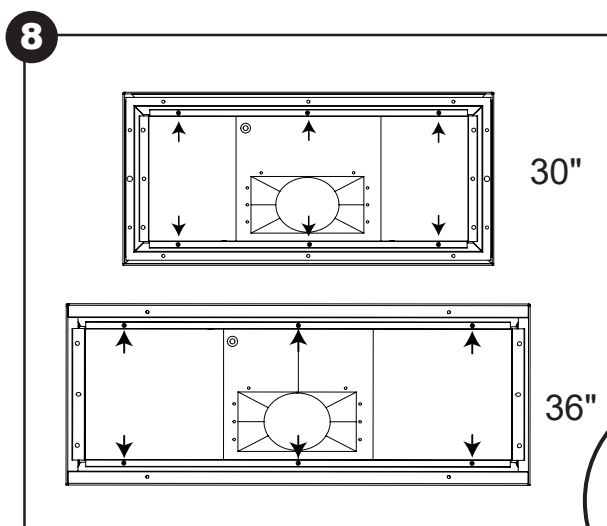

Secure 6 pcs screws on the housing.

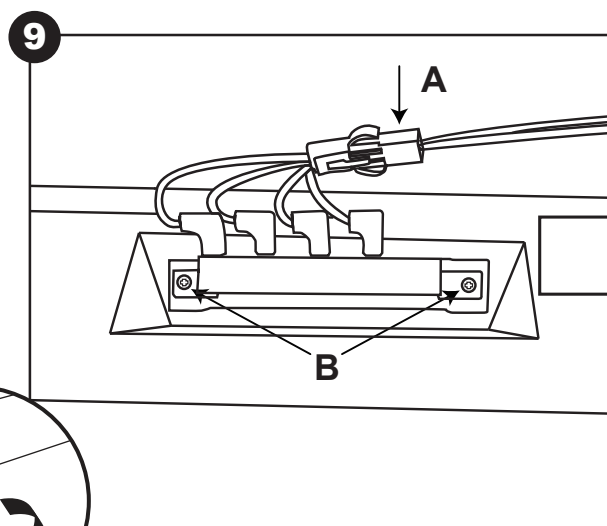

Secure B screws and A plug to reinstall the button.

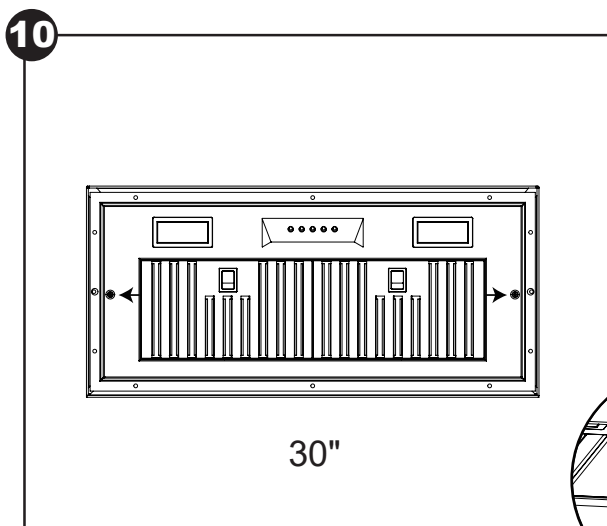

Secure 2 pcs screws on the panel.

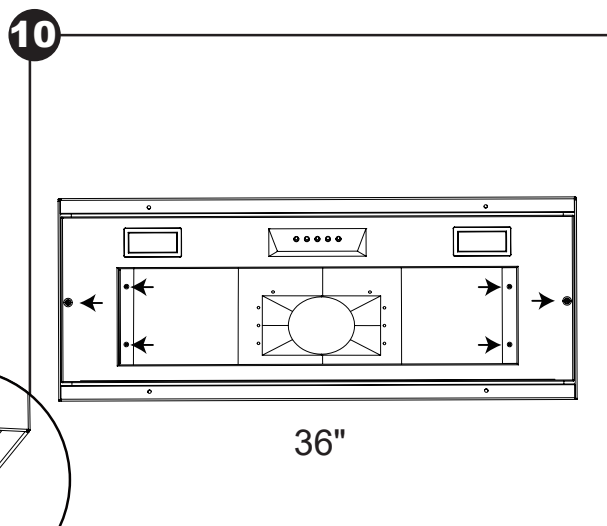

Secure 6 pcs screws on the panel.



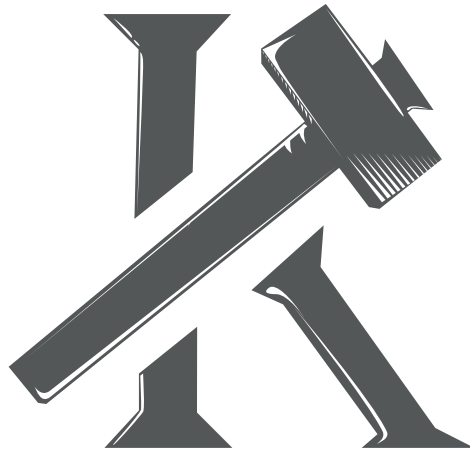

*Premium Quality*



**HANDCRAFT  
AKICON**

**TO BE A KITCHEN ICON**

**AKICON INC.**

**Tel: 1-(626)-363-4414**

**Toll Free Number: 1-(888)-828-2025**

**Email: [service@akiconshop.com](mailto:service@akiconshop.com)**

**Website: [www.akiconshop.com](http://www.akiconshop.com) / [www.akicon.com](http://www.akicon.com)**

**Address: 18555 Gale Ave, City of industry, CA 91748**