

SOUND  
GALLERY

**THANK YOU FOR PURCHASING THE  
SOUND GALLERY WALL ART SPEAKER.**

**FOR CONTINUOUS MAXIMUM PERFORMANCE,  
PLEASE READ THE FOLLOWING INSTRUCTIONS  
CAREFULLY. KEEP THIS MANUAL HANDY  
FOR FUTURE REFERENCE.**

Do not return this product to the store if you have damaged or missing parts.

For any issues, please reach out to SOUND GALLERY directly.

## **INCLUDED IN BOX**

1. SOUND GALLERY
2. Owners Manual
3. 10-foot USB-A to USB-C Charging Cable
4. WIRELESS MAGNETIC BATTERY PACK\*

\* Included with sizes: 24x24, 30x20,  
40x26, 40x40, 48x32 & larger.



1



2



3



4

## D-RING HANGING INSTRUCTIONS

### To properly hang your new SOUND GALLERY wall art speaker unit

This item comes to you with special hangers securely fastened to the back of the unit. **DO NOT USE PICTURE WIRE** to hang this SOUND GALLERY. Instead, drive the proper size picture hooks securely into the wall, spaced so that the hangers will hang from those hooks. This will give even distribution of weight and safe installation. Picture wire does not evenly distribute the weight of the SOUND GALLERY and causes strain to both wire and hangers.



## CHARGING THE SOUND GALLERY FOR SIZES - 11X14, 15X15 & 16X20

1. Insert the included USB-C charging cable into the USB-C port located on the control panel and connect the USB-A end of the cable into a power adapter.

*\*Power adaptor not included.*

2. Plug the adapter into a wall outlet to charge. The red indicator light on the control panel will turn off when the device is fully charged.

*\*Charging time will vary depending on the size of the device*

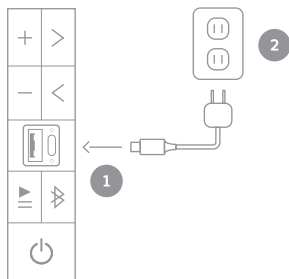

## CHARGING THE SOUND GALLERY FOR SIZES - 24X24, 30X20, 26X40, 40X40 & 48X32

### How to use the WIRELESS, MAGNETIC BATTERY PACK

The WIRELESS, MAGNETIC BATTERY PACK is designed to quickly, safely, and wirelessly charge the SOUND GALLERY device by magnetically attaching to the bottom side providing a completely wireless experience from listening to charging.

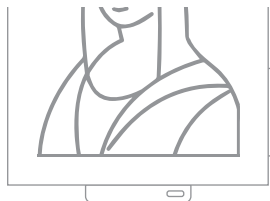

## Charging the WIRELESS, MAGNETIC BATTERY PACK

Before using the WIRELESS, MAGNETIC BATTERY PACK for the first time, fully charge it using the included Type C to USB cable.

1. Plug one end of the Type C to USB cable into the Type C connector on the WIRELESS, MAGNETIC BATTERY PACK.
2. Plug the other end of the cable into a USB power adapter, then plug the adapter into a power outlet. A red light will flash, indicating that the power is on. While the WIRELESS, MAGNETIC BATTERY PACK is charging, the blue status lights will flash. The WIRELESS, MAGNETIC BATTERY PACK has 4 blue indicator lights showing the different levels of charging: **25%, 50%, 75%, and 100%.**

As the WIRELESS, MAGNETIC BATTERY PACK is charging, the blue indicator lights will come on as each level is reached.

*\*Power adaptor not included.*

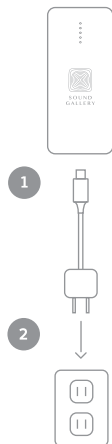

## Attaching and removing the WIRELESS, MAGNETIC BATTERY PACK

Attaching the WIRELESS, MAGNETIC BATTERY PACK is a snap. The perfectly aligned magnets keep it attached to the SOUND GALLERY device — providing safe and reliable wireless charging.

1. Turn on the WIRELESS, MAGNETIC BATTERY PACK and align it with the receiver found at the middle of the bottom side of the SOUND GALLERY device. The WIRELESS, MAGNETIC BATTERY PACK will magnetically attach to the SOUND GALLERY device and start charging. The power indicator light on the WIRELESS, MAGNETIC BATTERY PACK will turn from red to green while it is charging the SOUND GALLERY device. The red indicator light on the control panel will remain solid red when the SOUND GALLERY device is charging, and the light will turn off when it is fully charged.

If the WIRELESS, MAGNETIC BATTERY PACK is not removed after fully charged it will blink intermittently.

2. Once the SOUND GALLERY device has been fully charged, remove the WIRELESS, MAGNETIC BATTERY PACK by gently pulling it off the bottom of the SOUND GALLERY device. This is the perfect time to recharge your WIRELESS, MAGNETIC BATTERY PACK to make sure it is ready when needed.



## GETTING STARTED

### Powering on and connecting to your wireless bluetooth device

1. Press and hold the power button on the control panel for three seconds to power on.
2. The blue indicator light on the control panel will be blinking and the Bluetooth mode prompt will sound when ready to pair.
3. Go to the Bluetooth settings within your phone and turn on Bluetooth.
4. Search for the pairing name "SOUND GALLERY" and select it to connect.
5. After the connection is successful, the device will alert you with a prompt to indicate Bluetooth is connected and the indicator light on the control panel will turn solid blue.

*NOTE: Any connection after this initial pairing will happen automatically.*

*If the Bluetooth connection fails, press and hold the MODE button to clear the pairing and restart the Bluetooth pairing process.*

### Pairing two SOUND GALLERY devices at once (TWS - True Wireless Stereo)

Prior to connecting to Bluetooth, turn each of the SOUND GALLERY devices on.

Press and hold the Play/Pause button on either device to pair the two devices together.

A prompt will let you know when the two devices are paired.

### Listening to music via the USB Thumb Drive Port

Insert a USB thumb drive into the USB port on the control panel to automatically play music via USB. When a USB thumb drive is removed, the device will revert back to Bluetooth mode.

*NOTE: Device will automatically turn off after 30 minutes without use.*

## AUDIO PROMPTS

SOUND GALLERY comes equipped with audio notification prompts alerting you to the many functions available on the device. Please visit [www.soundgallery.art/prompts](http://www.soundgallery.art/prompts) to familiarize yourself with the different prompts for each function included.

POWER ON

TWS CONNECT

LOW BATTERY

BLUETOOTH MODE

TWS DISCONNECT

MAX VOLUME

BLUETOOTH PAIRED

USB CONNECT

POWER OFF

BLUETOOTH DISCONNECT

INCOMING CALL

### Technical Specs:

Speakers - 5W - Sizes 11x14, 15x15 and 16x20

10W - Sizes 24x24, 30x20, 26x40, 40x40 and 48x32

Bluetooth

## CONTROL PANEL

### BUTTON FUNCTIONS

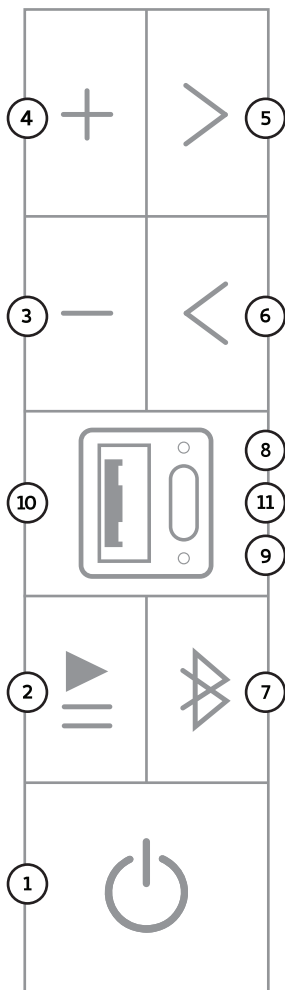

1

**Power** - Press and hold this button for three seconds to turn the device on and off.

2

**Play / Pause** - Press this button to play, press it again to pause.

#### To Pair Two Devices / Activate TWS

Prior to connecting Bluetooth, turn each of the SOUND GALLERY on, press and hold the Play/Pause button on either device for three seconds to pair the two devices together. Any connection after this initial pairing will happen automatically.

#### To Disconnect TWS

Press and hold the Play/Pause button for 3 seconds to disconnect TWS. An alert will sound to let you know it has been disconnected.

3

**Volume Down**

4

**Volume Up**

5

**Next Track**

6

**Previous Track**

7

**Mode** - Press and hold this button for 3 seconds to disconnect Bluetooth. An alert will sound to let you know it has been disconnected.

8

**LED Light Indicator (Top)** - This indicator light will be solid red when charging and the light will turn off when fully charged.

9

**LED Light Indicator (Bottom)** - This indicator light will be blinking blue when turned on and waiting to connect to Bluetooth. It will turn solid blue when connected.

10

**USB Thumb Drive Port** - Insert USB thumb drive into port (10) on control panel to play music via USB thumb drive. Music will automatically start playing when the thumb drive is inserted. The device will revert back to Bluetooth when the USB thumb drive is removed.

11

**USB - C charging cable port.**

# IMPORTANT SAFETY INSTRUCTIONS

## Safety Precautions / Warnings

Read all instructions and warnings prior to using this product. Improper use of this product may result in product damage, excess heat, toxic fumes, fire, or explosion for which damages you ("The Purchaser"), and not SOUND GALLERY ("The Manufacturer") are responsible.

- Before using your SOUND GALLERY for the first time, fully charge the device.
- Please reference "CHARGING THE DEVICE" area of this manual as charging method varies depending on size.
- Do not store the WIRELESS, MAGNETIC BATTERY PACK or SOUND GALLERY in high-temperature environment or high humidity including heat caused by intense sunlight or other forms of heat.
- Do not place in fire or other excessively hot environments. Exposure to fire or temperature above 212°F (100°C) may cause explosion.
- The WIRELESS, MAGNETIC BATTERY PACK should be charged only in open-air conditions. It should not be charged in an enclosed, unventilated space. Failure to follow these instructions may damage the product by overheating.
- Do not store WIRELESS, MAGNETIC BATTERY PACK in an enclosed vehicle.
- Be cautious of drops, bumps, abrasions, or other impacts to the battery pack included with this product. If there is any damage to the WIRELESS, MAGNETIC BATTERY PACK such as dents, punctures, deformities, or corrosion due to any cause, discontinue use. Contact manufacturer or dispose of it in an appropriate manner at your local battery-recycling center.
- Do not expose the WIRELESS, MAGNETIC BATTERY PACK to rain or snow.
- Do not use the WIRELESS, MAGNETIC BATTERY PACK in excess of its output rating. Overloading outputs above rating may result in a risk of fire or injury to persons.
- Do not disassemble the product, attempt to re-purpose, or modify it in any manner.
- Do not attempt to replace any part of this device.
- Do not use with wireless battery packs that are not approved and provided by SOUND GALLERY as this could damage the device and may result in a risk of fire or injury to persons.
- If this device is accessible to or may be used by a minor, purchasing adult agrees to be solely responsible for providing supervision, instructions, and warnings. Purchaser agrees to defend, indemnify, and hold manufacturer harmless for any claims or damages arising from unintended use or misuse by a minor.
- All products have gone through a thorough quality assurance inspection. If you find that your SOUND GALLERY or WIRELESS, MAGNETIC BATTERY PACK is excessively hot, is emitting odor, is deformed, or demonstrating an abnormal phenomenon, immediately stop all product use and contact manufacturer.
- Never dispose of batteries in the garbage. Disposal of batteries in the garbage is unlawful under state and federal environmental laws and regulations. Always take used batteries to your local battery recycling center.
- Unplug the WIRELESS, MAGNETIC BATTERY PACK when it is not in use or being charged.
- The WIRELESS, MAGNETIC BATTERY PACK will automatically switch off when disconnected from a device.
- If you haven't used your SOUND GALLERY in a while or plan to go long periods of time without using it, be sure to charge the device once a month to prevent damage to the lithium-ion batteries over time.

## LEGAL

Manufacturer shall not in any way be liable to you or to any third party for any damages you or any third party may suffer as a result of use, intended or unintended, or misuse of this product in conjunction with any device or accessory other than the appropriate device for which this product is designed. Manufacturer will not be responsible for any damages you or any third party may suffer as a result of misuse of this product as outlined above. Purchaser agrees to defend, indemnify, and hold manufacturer harmless for any claims or damages arising from unintended use or misuse, including use with an unintended device.

©2022 SOUND GALLERY ALL RIGHTS RESERVED. SOUND GALLERY uses proprietary and patent pending technology, and authorized products are only available from SOUND GALLERY and its customers and licensees. SOUND GALLERY™ is a proprietary mark of SOUND GALLERY registered in the United States and/or other countries. Five-Year Limited Warranty. Contents and colors may vary from illustrated. For ages 12+. **This is not a toy.**

The sale of this product shall in no way be interpreted as a grant of any present or future license or transfer of intellectual property rights, including but not limited to trademark, copyright, or patent rights, in the underlying product or in the images displayed through the product.

Bluetooth – The Bluetooth® word mark and logos are registered trademarks owned by Bluetooth SIG, INC. and any use of such marks by SOUND GALLERY is under license. Other trademarks and trade names are those of their respective owners.

This device complies with part 15 of the FCC Rules. Operation is subject to the following two conditions:

(1) this device may not cause harmful interference, and (2) this device must accept any interference received, including interference that may cause undesired operation. NOTE: This equipment has been tested and found to comply with the limits for a Class B digital device, pursuant to part 15 of the FCC Rules. These limits are designed to provide reasonable protection against harmful interference in a residential installation. This equipment generates, uses, and can radiate radio frequency energy. If it is not installed and used in accordance with the instructions, it may cause harmful interference to radio communications. However, there is no guarantee that interference will not occur in a particular installation.

### Lithium Battery – Size, Playtime & Charge Time

- 3600 mAh – up to 8 hours playtime / charge for 2–3 hours (Sizes 11x14, 15x15 and 16x20)
- 4000 mAh – up to 10 hours playtime / charge for 6 hours (Sizes 24x24 and 30x20)
- 9000 mAh – up to 24 hours playtime / charge for 12 hours (Sizes 26x40, 40x40 and 48x32)
- \* Playtime may vary based on volume levels and functions used.

Using your SOUND GALLERY at lower volumes will help prolong the battery life between charges.

- \* SOUND GALLERY wall art speaker devices should only be charged with SOUND GALLERY approved battery packs.
- \* Charging time will vary depending on the size of the device.



*(Qi for wireless charging, battery pack models only)*

### MODIFICATION

Any changes or modification of this device could void the warranty.

MADE IN CHINA



### DROP US A NOTE: TEXT / CALL / EMAIL

415.980.2207  
611 Gateway Boulevard  
San Francisco, CA 94080 USA  
info@soundgallery.art

### VISIT US:

WWW.SOUNDGALLERY.ART

### FOLLOW US:

      
@SOUNDGALLERYART

Warranty – At Sound Gallery®, we believe in our products. That's why we back them all with a Five-Year Limited Warranty and provide friendly, easy-to-reach support.

Register your Sound Gallery device at [www.soundgallery.art/register](http://www.soundgallery.art/register)