

**MAX PERFORMANCE
EXTRA FUN**

MAXXT

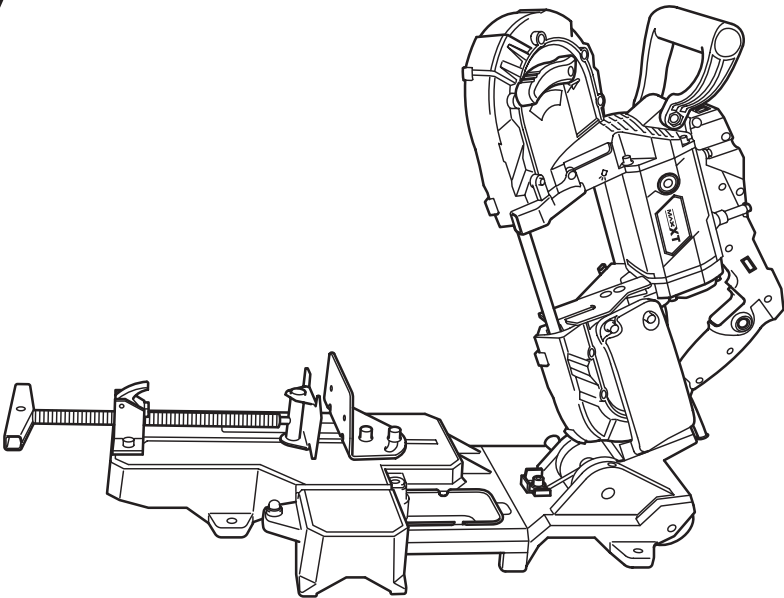

R2103-100-2+P1103

INSTRUCTION MANUAL



EN

PORTABLE BAND SAW WITH BASE

P3-P26

WWW.MAXXT-TECH.COM

CONTACT US

In Canada
Hyperfit Tools Inc
Tel: 289 644 7621
E-mail: info@hyperfit-tools.ca
www.hyperfit-tools.ca

In Other Countries
E-mail: service@maxxt-tech.com
www.maxxt-tech.com



MAXXT-TECH



MAXXT-TECH



MAXXT-TECH



MAXXT-TECH

EN

ORIGINAL INSTRUCTIONS

Fig.A

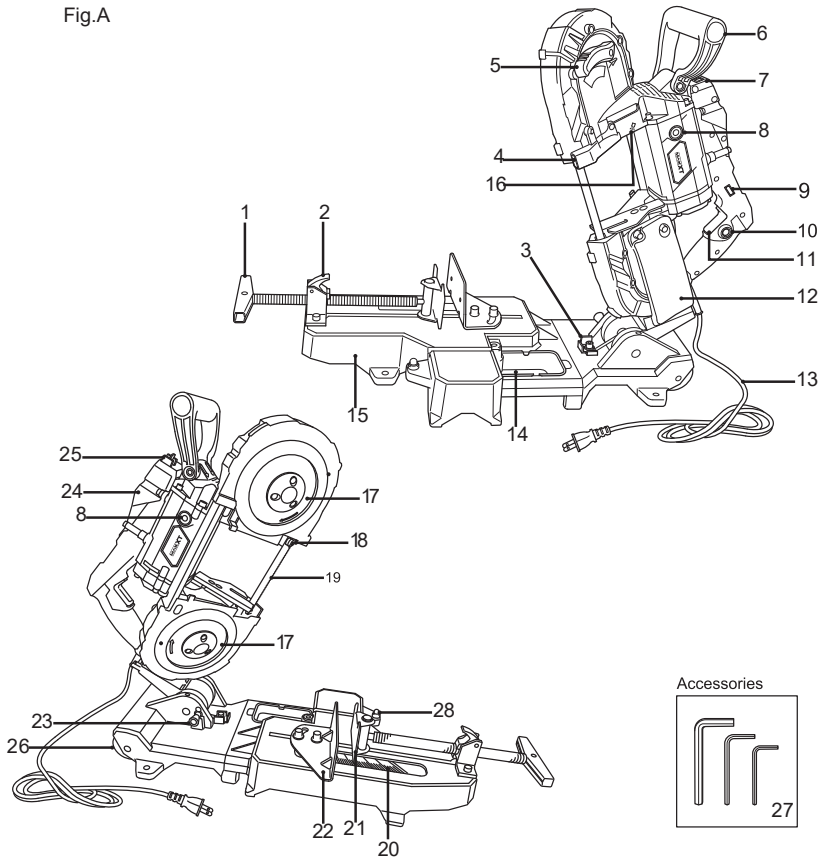





- | | |
|---------------------------|-------------------------------------|
| 1. Push-pull rod | 15. Base |
| 2. Screw nut | 16. LED light |
| 3. Load adjustment plate | 17. Drive plate |
| 4. Automatic stop button | 18. Guide roller |
| 5. Adjustable wrench | 19. Saw blade |
| 6. Auxiliary handle | 20. Angle scale |
| 7. Motor start button | 21. Push-pull rod base |
| 8. Brush cap | 22. Moving jaw |
| 9. Speed adjustment dial | 23. Lock pin |
| 10. Trigger-Lock button | 24. Mode switch |
| 11. Trigger-switch | 25. Emergency power off dial button |
| 12. Connect shelf | 26. Wheels |
| 13. Power cord | 27. Hex wrench (4mm, 6mm, 8mm) |
| 14. Chips collection tray | 28. Automatic stop device |



TECHNICAL SPECIFICATIONS

Model No.		R2103-100-2+P1103	
Motor		Single-phase series commutator motor	
Voltage		120V	
Electric Current		10A	
Frequency		60Hz	
Electricity Consumption		1100W	
RPM	Minimum		0FPM
	Maximum		435FPM
Maximum Cutting Capacity	0° (Right angle) Cutting (When using only the main body)	Round Pipe	115mm (120mm)
		Square Pipe	100 × 100mm (120 × 120mm)
	45°Cutting	Round Pipe	45mm
		Square Pipe	(40 × 40mm)
Insulation Method		Double Insulation	
Size (Including the base part)	Full Length		525mm (690mm)
	Full Width		165mm (300mm)
	Overall Height		290mm (360mm)
WEIGHT (Including base)		9.0kg (16.0kg)	19.84lbs (35.27lbs)

SAFETY ALERT SYMBOLS AND WORDS

This instruction manual uses the following safety alert symbols and words to alert you to hazardous situations and your risk of personal injury or property damage.

-  **DANGER:** Indicates an imminently hazardous situation which, if not avoided, will result in death or serious injury.
-  **WARNING:** Indicates a potentially hazardous situation which, if not avoided could result in death or serious injury.
-  **CAUTION:** Indicates a potentially hazardous situation which, if not avoided, may result in minor or moderate injury. (Used without word) Indicates a safety related message.
-  **NOTICE:** Indicates a practice not related to personal injury which, if not avoided, may result in property damage.

-  **WARNING:** Read all safety warnings and all instructions. Failure to follow the warnings and instructions may result in electric shock, fire and/or serious injury.
-  **WARNING:** To reduce the risk of injury, read the instruction manual.

GENERAL POWER TOOL SAFETY WARNINGS

 **WARNING!** Read all safety warnings and all instructions. Failure to follow the warnings and instructions may result in electric shock, fire and/or serious injury. Save all warnings and instructions for future reference. The term "power tool" in the warnings refers to your mainsoperated (corded) power tool or battery-operated (cordless) power tool.

1) WORK AREA SAFETY

- a) **Keep work area clean and well lit.**
Cluttered or dark areas invite accidents.
- b) **Do not operate power tools in explosive atmospheres, such as in the presence of flammable liquids, gases or dust.** Power tools create sparks which may ignite the dust or fumes.
- c) **Keep children and bystanders away while operating a power tool.** Distractions can cause you to lose control.

2) ELECTRICAL SAFETY

- a) **Power tool plugs must match the outlet. Never modify the plug in any way. Do not use any adapter plugs with earthed (grounded) power tools.** Unmodified plugs and matching outlets will reduce risk of electric shock.
- b) **Avoid body contact with earthed or grounded surfaces such as pipes, radiators, ranges and refrigerators.**
There is an increased risk of electric shock if your body is earthed or grounded.
- c) **Do not expose power tools to rain or**

- wet conditions.** Water entering a power tool will increase the risk of electric shock.
- d) **Do not abuse the cord. Never use the cord for carrying, pulling or unplugging the power tool.** Keep cord away from heat, oil, sharp edges or moving parts. Damaged or entangled cords increase the risk of electric shock.
- e) **When operating a power tool outdoors, use an extension cord suitable for outdoor use.** Use of a cord suitable for outdoor use reduces the risk of electric shock.
- f) **If operating a power tool in a damp location is unavoidable, use an earth leakage circuit breaker.** Use of an earth leakage circuit breaker reduces the risk of electric shock.

3) PERSONAL SAFETY

- a) **Stay alert, watch what you are doing and use common sense when operating a power tool. Do not use a power tool while you are tired or under the influence of drugs, alcohol or medication.** A moment of inattention while operating power tools may result in serious personal injury.
- b) **Use personal protective equipment. Always wear eye protection.** Protective equipment such as dust mask, non-skid safety shoes, hard hat, or hearing protection used for appropriate conditions will reduce personal injuries.
- c) **Prevent unintentional starting. Ensure the switch is in the off-position before connecting to power source and/or battery pack, picking up or carrying the**

tool. Carrying power tools with your finger on the switch or energising power tools that have the switch on invites accidents.

- d) **Remove any adjusting key or wrench before turning the power tool on.** A wrench or a key left attached to a rotating part of the power tool may result in personal injury.
- e) **Do not overreach. Keep proper footing and balance at all times.** This enables better control of the power tool in unexpected situations.
- f) **Dress properly. Do not wear loose clothing or jewelry.** Keep your hair, clothing and gloves away from moving parts. Loose clothes, jewelry or long hair can be caught in moving parts.
- g) **If devices are provided for the connection of dust extraction and collection facilities, ensure these are connected and properly used.** Use of dust collection can reduce dust-related hazards.

4) POWER TOOL USE AND CARE

- a) **Do not force the power tool. Use the correct power tool for your application.** The correct power tool will do the job better and safer at the rate for which it was designed.
- b) **Do not use the power tool if the switch does not turn it on and off.** Any power tool that cannot be controlled with the switch is dangerous and must be repaired.
- c) **Disconnect the plug from the power source and/or the battery pack from the power tool before making any adjustments, changing accessories, or storing power tools.** Such preventive safety measures reduce the risk of starting the power tool accidentally.
- d) **Store idle power tools out of the reach of children and do not allow persons unfamiliar with the power tool or these instructions to operate the power tool.** Power tools are dangerous in the hands of untrained users.
- e) **Maintain power tools. Check for misalignment or binding of moving parts, breakage of parts and any other condition that may affect the power tool's operation. If damaged, have the power tool repaired before use.** Many accidents are caused by poorly maintained power tools.
- f) **Keep cutting tools sharp and clean.**

Properly maintained cutting tools with sharp cutting edges are less likely to bind and are easier to control.

- g) **Use the power tool, accessories and tool bits etc., in accordance with these instructions, taking into account the working conditions and the work to be performed.** Use of the power tool for operations different from those intended could result in a hazardous situation.
- #### 5) SERVICE
- a) **Have your power tool serviced by a qualified repair person using only identical replacement parts.** This will ensure that the safety of the power tool is maintained.

SAFETY INSTRUCTIONS FOR PORTABLE BAND SAW

To work that does not follow safety rules can lead to serious accidents.

Be sure to read and fully understand this instruction manual before operating the product or performing daily inspections. The safety labels used in this manual and this product are used as follows depending on the content and degree of danger.

DANGER

DANGER indicates that there is an imminent danger leading to serious personal injury or death.

The message describes the nature of the danger and precautions to avoid it.

WARNING

WARNING indicates that there is a risk that could lead to serious personal injury or death.

The message describes the nature of the danger and precautions to avoid it.

ATTENTION

ATTENTION indicates that there is a risk that could result in personal injury or serious damage to the product.

The message describes the nature of the danger and precautions to avoid it.

IMPORTANT

IMPORTANT indicates that it may cause damage to the product or significant performance degradation.

We cannot predict all the dangers that may occur when working in any environment. Therefore, the precautions contained in this manual are not exhaustive, and it is the customer's responsibility to use the product with care.

GENERAL

Please read the "Instruction Manual" carefully before using the power tool and fully understand it before using it correctly.

Read the instruction manual



DANGER

- Do not use power tools until you have read and understood the instruction manual. Incorrect use may result in personal injury, electric shock or power tool failure. Follow the instructions in the instruction manual to use it correctly.



WARNING

- Do not allow children or anyone who does not understand the knowledge and usage of power tools to use it.
- Keep children and animals away from the area during use.



ATTENTION

- Always keep the instruction manual and make it read repeatedly by all users.
- If you lose the instruction manual, please obtain it from the store or our sales office immediately.
- When lending or handing over to another person, please also hand over the instruction manual.

Pay attention to the working environment.



WARNING

- Keep your workplace tidy and clean at all times.
- If dust is scattered, it may catch the cord, and fall while holding the machine, or cause a big accident.
- Work in a sufficiently bright place. When working in a dark place, turn on the lights and brighten the working place before starting work.
- Do not use around these areas with flammable liquids, gases or dust. There is a risk of explosion due to sparks from electric tools.
- Keep children and third parties away during use. You will not be able to concentrate on your work and it may cause an unexpected

accident.

- Do not allow anyone other than the operator to touch the power tool or power cord.
- Use a power supply that meets the standards. Using a power supply other than the standard may cause a tool failure or fire.

IMPORTANT

- Sufficient performance cannot be obtained in extremely hot or cold environments.

Be careful of electric shock and short circuit.



WARNING

- Use a power outlet suitable for the power plug of the power tool. Do not modify the power plug. Also, make sure that the plug with the installation is grounded.
- Do not touch the grounded object (metal pipe, heater, microwave oven, refrigerator outer frame, etc.) while using the power tool. There is a risk of electric shock.
- Do not get the power tools wet. Also, do not use it in a damp or wet place. It may cause electric shock or short circuit.
- Handle the power cord with care. Do not pull the cord when unplugging the power plug. Also, do not lift or move the power cord by holding it. Damaged cord may cause a short circuit.
- Do not use outdoors on a rainy day or in a humid place. There is a risk of electric shock and short circuit.
- Keep the power cord away from heating fixtures, fire, heat sources, and oils. Also, make sure that the power cord does not slip into the corner. It may damage the cord, cause an electric shock, or cause a short circuit.
- Keep the power cord away from heating fixtures, fire, heat sources, and oils.
- When using an extension cord outdoors, please choose an extension cord suitable for outdoor use cable.
- Do not touch the power plug with wet hands as you may get an electric shock.

Precautions When Using Power Tools



WARNING

- Before inserting the power plug into the power outlet, adjust the power tool, adjust the position of the moving parts, and replace the accessories. Also, check that there are no abnormalities in the tightening condition, damage, or mounting condition of the moving parts.

- Before starting work, thoroughly inspect the condition of each part, and make sure the switches function normally. Does it work as prescribed? Please check.
- Do not use power tools whose switches do not function properly.
- Before turning on the power tool, make sure that the tools used to adjust the power tool and replace accessories have been removed.
- If a over-load operation is applied, it may cause a malfunction or damage to moving parts, resulting in an accident.
- For safe and efficient work, select a power tool attachment suitable for the intended use and loading.
- Use the specified accessories and attachments. Accessories and attachments not specified in the instruction manual. Using them may cause a malfunction or accident.
- If the product is out of order, wait until the maintenance is completed before using it.

Precautions When Working



WARNING

8

- Do not allow children or anyone who does not understand the knowledge and usage of power tools to use it.
- Keep children and animals away from the surrounding area while using the power tool.
- Be careful when working. Even if you are accustomed to handling power tools, please work carefully, paying close attention to the handling method, work method, and surrounding conditions. Do not work if you are taking medicines, tired or drink.
- Do not use power tools, attachments, accessories, or tip tools for purposes other than those described in the instruction manual. It may cause a serious accident as well as a tool failure.
- Be careful not to start it unexpectedly. Make sure that the power switch of the power tool is "OFF" before inserting the power plug into the outlet. Also, do not stop the power tool by unplugging the power plug from the outlet. Be sure to turn off the power switch of the power tool.
- Do not carry the power tool with the power plug connected to the outlet. When carrying it, remove the power plug from the outlet.
- When using power tools, be sure to wear protective goggles. If necessary, wear gas masks, anti-slip safety shoes, helmets,

earplugs, and other safety protective equipment.

- Do not wear loose clothing, necklaces, or other jewelry as they may get caught in the rotating parts of the power tool. Keep hair, clothes, gloves, etc. away from rotating parts. Cover long hair with a hat or helmet. When working outdoors, it is recommended to wear safety shoes with non-slip.
- When using a power tool, work on a flat floor. If it is unavoidable to use it on an unstable place such as a slope, take necessary safety measures such as fall prevention and fall prevention.
- When working, firmly fix the material with a clamp, vise, etc. so that the material does not splash or bounce. Also, by fixing it, you can safely use the power tool with both hands.
- If you experience any of the following symptoms while using a power tool, immediately stop using it, turn the power switch to "OFF", unplug the power plug from the outlet, and contact your dealer or our sales office. Continued use may cause accidents such as smoke and fire, electric shock, and injury.
- The power cord and power plug are abnormally hot.
- There are deep scratches or deformation on the power cord or power plug.
- When you move the power cord, it turns on or off.
- There is a strange odor.
- There is a strange noise.
- Abnormal vibration.
- It does not work even if the switch is turned on.

Maintenance and Storage of Power Tools

If the power tools are not properly maintained and inspected, they will not be able to fully demonstrate their capabilities. In addition, it may cause an accident as well as a tool failure and shorter life.



WARNING

- Always maintain the teeth of saw blade and replace them if necessary. With proper care and replacement, you can work smoothly and efficiently.
- Follow the instruction manual for lubrication and replacement of accessories.
- Use genuine parts for replacement parts.
- Keep the grip of the power tool and the area around the switch clean. If it gets wet with

water or oil, it may cause a malfunction.

- If you are using an extension cord, inspect the cord regularly and replace it if it is damaged.
- Store power tools in a dry, locked place out of the reach of children.
- Repairs or disassembly without sufficient knowledge and skills may cause a fire, malfunction, or a serious accident.
- For repair of power tools, contact your dealer or our sales office. Or you could contact us via service@maxxt-tech.com.

Prohibition of Modification

WARNING

- Please do not modify without the permission of the manufacturer.
Please do not modify or disassemble. Not only it can cause tool failure and shortened life, but it can also cause serious accidents.

Band Saw Information

In Chapter 1, we mentioned general precautions for power tools, but in this chapter, we will explain the precautions that you should follow when using a band saw.

WARNING

- Use the power supply used at the voltage indicated on the name plate. If used at a voltage higher than the indicated value, the rotation will be abnormally fast and may cause a serious accident. It may also damage the motor or control device.
- Keep your hands and face away from the saw blade, chips, and other discharge parts during use. It may cause injury.
- It may be swung around or dropped, resulting in an accident.

Be sure to hold the band saw when using it.

- Check in advance if there are any buried objects such as electric wires, water pipes, gas pipes, etc. around the band saw. If there are electric wires or buried objects, the saw blade may touch and cause electric shock, electric leakage, or gas leakage.
- If you feel any abnormal noise, odor, heat generation, or abnormal vibration during use, immediately turn off the power and stop using the product, and request repair or inspection from your dealer or our sales office. Continued use may cause a serious accident.
- If you accidentally drop or hit the saw blade during use, inspect the saw blade and body for damage, cracks, and deformation.

Damage, cracks or deformation can cause an accident.

- Do not use for any purpose other than that described in the instruction manual. Also, do not work beyond your ability. It may cause a malfunction or accident of the band saw.

ATTENTION

- Make sure to attach the saw blade and accessories according to the instructions in the instruction manual. If the saw blade and accessories are not securely attached, they may come off and cause injury.
- Do not use a deformed or worn saw blade. The saw blade may break or kickback may occur.
- Do not apply liquid lubricant or oil to the saw blade. The saw blade may slip or come off, resulting in injury.
- Install a saw blade suitable for the material. Working with a saw blade that is not suitable for the material may cause damage to the saw blade, biting or locking, resulting in kickback or injury.
- Do not wear gloves when using the band saw. Working with gloves may get caught in the saw blade.
- Install the band saw on a flat surface with no inclination, and use it in a stable state (when mounting the base). If you work in an unstable condition, the material may move and the saw blade may be damaged, resulting in injury.
- Do not drop the saw blade onto the material as it may damage the saw blade.
- Cut the material only by the weight of the band saw. Forcibly cutting the saw blade may cause the saw blade to come off or be damaged, resulting in injury.
- If the saw blade locks during disconnection, immediately release the trigger switch. Continuing to work in the locked state may damage the saw blade and motor.
- Do not touch the material, saw blade, and chips immediately after cutting as they are hot. It may cause burns.

ATTENTION

- Wipe off chips from the saw blade and mounting surface. The saw blade may come off or be damaged, resulting in injury.
- Do not fix the trigger switch with a string or wire as it may cause an accident.
- When working in high places, make sure that there are no people underneath and





take necessary fall protection measures.

Also, do not hook the cord.

- Do not place your hand or power cord on the material you are trying to cut. It may cause injury or electric shock.
- Securely fix the material with the vise attached to the main body or a vise. Insufficient fixing can damage the saw blade, cause the material to splash and bounce, resulting in injury.
- Rotate the saw blade and then apply the saw blade to the material. If you hit the material with the saw blade stopped, the saw blade may bite into the material and kickback may occur.
- Release the trigger switch and allow the saw blade to stop completely before removing the band saw from the material. If the band saw is separated from the material during rotation, kickback may occur.
- After releasing the trigger switch, do not stop the saw blade by pressing the side of the saw blade. The saw blade may be damaged or kickback may occur.

SYMBOLS

On the product, the rating label and within these instructions you will find among others the following symbols and abbreviations. Familiarise yourself with them to reduce hazards like personal injuries and damage to property.

V ~	Volt, (Alternating voltage)	A	Amperes
Hz	Hertz	W	Watt
min	Minutes	~ or AC	Alternating current
≡ or DC	Direct current		Class I Construction (grounded)
⎓ or AC/DC	Alternating or direct current		Class II Construction (double insulated)
n ₀	No load speed	/min or min ⁻¹	per minute
BPM	Beats per minute	n	Rated speed
IPM	Impacts per minute	RPM	Revolutions per minute
	Earthing terminal	sfp _m	Surface feet per minute
dB(A)	Decibel (A-rated)	m/s ²	Metres per seconds squared
kg	Kilogram	mm	Millimetre
°C	Degree celsius	SPM	Strokes per minute
	Safety alert symbol		



Lock/to tighten or secure.



Unlock/to loosen.



Note/ Remark.



Caution/ Warning.



Read the instruction.



Wear hearing protection.



Wear eye protection.



Wear a dust mask.



Wear protective gloves.



Wear protective, slip-resistant footwear.



Switch the product off and disconnect it from the power supply before assembly, cleaning, adjustments, maintenance, storage and transportation.



This product is of protection class II. That means it is equipped with enhanced or double insulation.



The product complies with the applicable European directives and an evaluation method of conformity for these directives was done.



WEEE symbol. Waste electrical products should not be disposed of with household waste. Please recycle where facilities exist. Check with your Local Authority or local store for recycling advice.



For use in dry indoor rooms only.



Crossed out dust bin. Batteries and battery packs should not be disposed of with household waste. Please recycle where facilities exist. Check with your Local Authority or local store for recycling advice.



Switch the product off and remove battery pack before assembly, cleaning, adjustments, maintenance, storage and transportation.



Do not dispose of battery packs in rivers or immerse in water.



Do not dispose of battery packs in fire. They will explode and cause injury.



Do not expose battery pack to heat in excess of 40°C. Do not charge or store the battery pack below 0°C (32°F) and above 40°C (104°F).



Do not smoke in the work area, around the product and in the vicinity of flammable materials!



Open flames in the work area, around the product and in the vicinity of flammable materials are prohibited!

HOW TO USE PORTABLE BAND SAW

Function of Main Body

1. Mode Switch

When using this unit by hands, set the operation selector switch to "I". When using with the base attached, set it to "O".

When the operation selector switch is "I", the automatic disconnection function cannot be used.

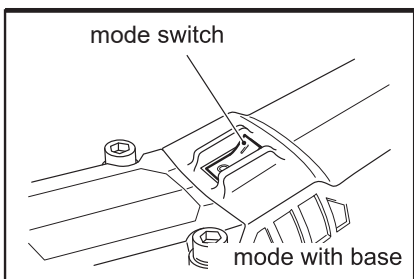
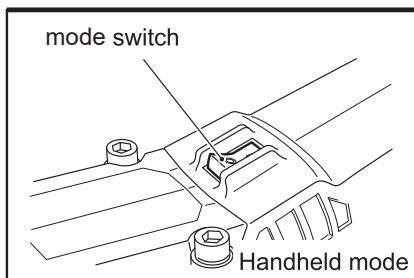

2. Emergency Power Off Dial Button

You can operate the trigger switch by turning the emergency power off dial button "ON". When set to "OFF", the trigger switch cannot be operated.

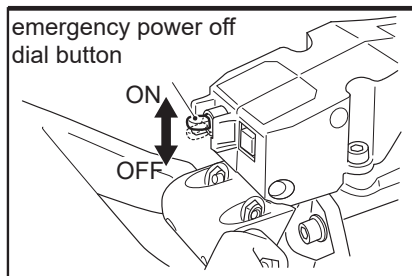

⚠ ATTENTION

- When fixing the material, set the emergency power off.
- dial button to "OFF". Touching the trigger switch may cause the saw blade to rotate and cause injury.

3. Motor Start Switch

When the mode switch is "O", the emergency power off dial button is "ON", and the trigger switch is locked, pressing the motor start switch can automatically cut the material.

For the method of automatic disconnection, refer to the section "7-3. Automatic disconnection".

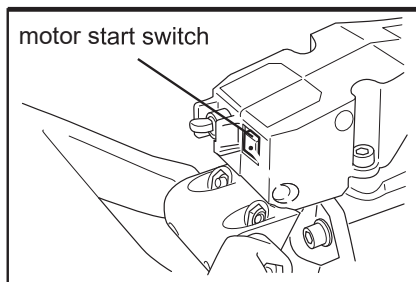

4. Trigger Switch

When you grasp the trigger switch, the light turns on and the saw blade rotates, allowing you to cut the material.

When you release the trigger switch, the saw blade will stop.

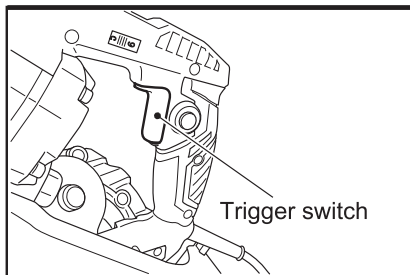

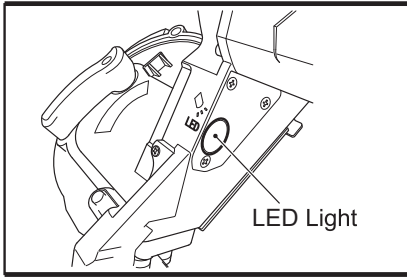

⚠ ATTENTION

Use the trigger switch to start and stop the band saw. Do not unplug or plug the power plug.

IMPORTANT

When the emergency power off dial button is "OFF", the LED light lights up when the trigger switch is operated, but the saw blade does not rotate.

5. Trigger lock button

When you hold the trigger switch and press the trigger lock button, the trigger switch is fixed at the gripped position and the saw blade continues to rotate even if you release the trigger switch.

When you squeeze the trigger switch again, the trigger switch is unlocked, the trigger switch returns to the position before you squeezed it, and the saw blade stops.

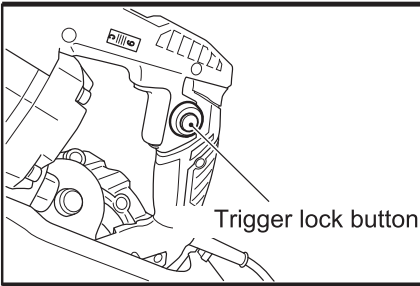

6. Speed Adjustment Dial

You can adjust the rotation speed of the saw blade in 6 steps with the speed adjustment dial.

The larger the number on the scale of the speed adjustment dial, the faster the rotation, and the smaller the number, the slower the rotation.

The rotation speed of the saw blade is adjusted according to the material of the

cutting material and the number of ridges of the saw blade used.

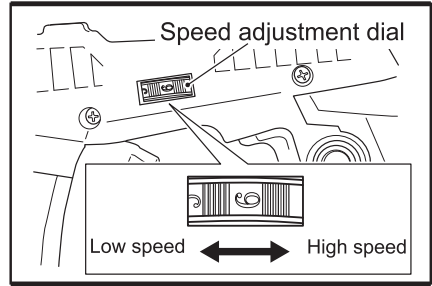

⚠ ATTENTION

- The adjustment range of the speed adjustment dial is "1 to 6 steps". Do not force the dial beyond "1" or "6". It may cause damage to the dial.
- Do not change the rotation speed while cutting the material. It may cause the band saw to malfunction or the saw blade to be damaged.

Estimated speed adjustment dial position

Dial	Material
1	Stainless steel, alloy
2	Stainless steel, alloy
3	Stainless steel, alloy
4	Carbon steel
5	Carbon steel
6	Aluminum alloy, Resin products(plastic)

7. Adjustable Wrench

Used when installing or removing the saw blade.

For details, refer to the section "6-1. Installing and removing the saw blade".

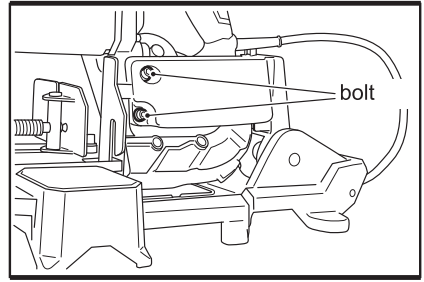
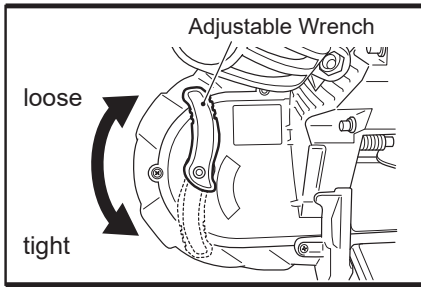

⚠ WARNING

- When using the band saw, be sure to use the adjustable wrench in the "tight" position. Do not put the wrench in the "loose" position during use. The saw blade may come off or be damaged, and cause injury.

8. Lock Pin

You can move the connect shelf up and down by pulling the lock pin toward you and setting it to the "release" position. The arm is locked when the arm is in any position (0°, 45°, 90°) and the lock pin is in the "lock" position.

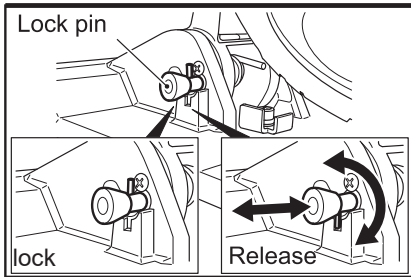
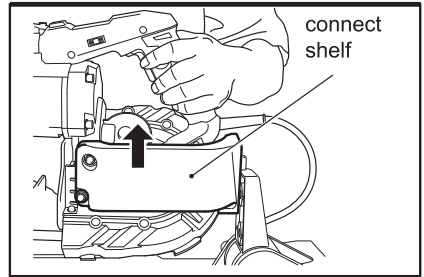

⚠ ATTENTION

- When transporting or moving, set the arm to the lowest point (0°) and set the lock pin to the "lock" position to fix the arm.

Function of the Base Part

1. How to attach / detach the base
To use base when fixing the material to be cut.
For how to fix the material, refer to the section "7-2-3. How to fix the material".

⚠ ATTENTION

- When attaching or detaching the base, turn the emergency power off dial button to "OFF" and unplug the power outlet. Touching the trigger switch may cause the saw blade to rotate, resulting in injury.
 - Wear leather gloves when attaching or detaching the base.
- 1) Remove the bolts (2) on the connect shelf with the included hex wrench.
 - 2) Remove the main body from the base so as not to touch the saw blade.
 - 3) When installing, align the bolt holes on the main body with the bolt holes on the arm, pass the bolts through both holes, and lightly tighten them by hand. Shake the main body a little to adjust the bolts so that they are horizontal, then tighten them by hand, and then use hexagon bolts to evenly tighten the upper and lower bolts.
2. Push-pull Rod, Moving Jaw, Push-pull Rod Base, Screw Nut
Used when fixing the material to be cut. For how to fix the material, refer to the section "7-2-3. How to fix the material".

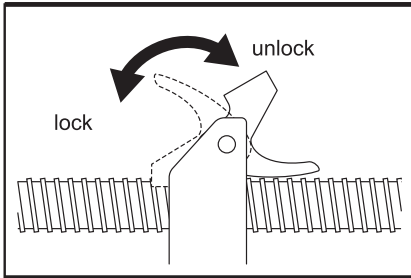
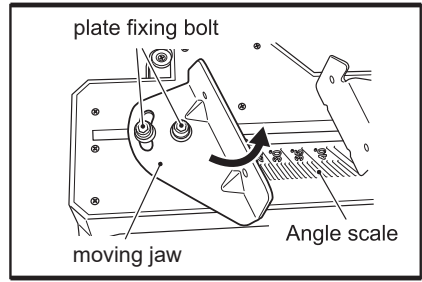
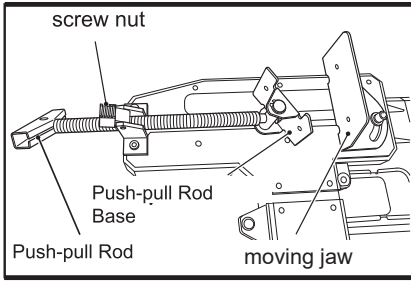

WARNING

- When fixing the material to be cut with a vise, remove the power plug from the power outlet.
- Do not put the screw nut in the "unlock" position while cutting the material. The material may be splashed or the saw blade may be damaged, resulting in injury.
- When cutting the material, fix the moving jaw firmly so that it does not move with the plate fixing bolts.
- The material may move during cutting, causing damage to the material and injury.

3. Angle Scale

When cutting material at an angle, the moving jaw can be cut at an angle to the scale of the angle scale (range 0 ° to 45 °). For how to cut at an angle, refer to the section "7-2-3. How to fix the material when cutting at an angle".

WARNING

- When adjusting the angle cut, turn the emergency power off.
- dial button to "OFF" and unplug the power outlet.
- When cutting at an angle, make sure that the moving jaw is firmly fixed with the plate fixing bolts. The material may move during cutting, causing damage to the material and injury.

4. Chips Collection Tray

If metal powder or wood powder collects on the tray, dispose of it.

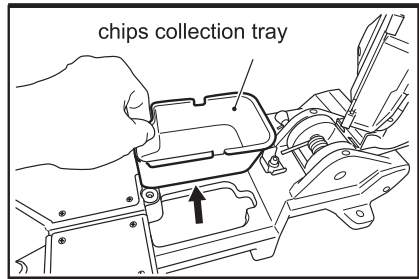

PREPARATION

WARNING

- When preparing or adjusting the band saw, remove the power plug from the power outlet and avoid touching the trigger switch.

ATTENTION

- Check if the power supply used is suitable for the band saw standard (120V).
- Check that the power outlet and cord are not damaged or deformed.
- When working with an extension cord, use an extension cord of sufficient thickness to make it as short as possible.

※Estimated thickness and length of extension cord:

cord thickness (conductor cross-sectional area)	Estimated cord length
2.00mm ²	Up to 30m

Saw Blade Installation and Removal

For the saw blade to be installed, select a saw blade suitable for the material to be worked on by referring to "11. Saw blade selection table".

⚠ WARNING

- When installing or removing the saw blade, set the emergency power off dial button to "OFF" and remove the power plug from the power outlet.

⚠ ATTENTION

- Be careful not to touch the cutting edge of the saw blade. Wear leather gloves when handling the saw blade.
- Wear safety goggles when installing or removing the saw blade. The saw blade may jump and cause injury. Operate the saw blade carefully.
- The saw blade is hot after work. When replacing the saw blade, let it to cool before re-starting work.

1. How to Install the Saw Blade

⚠ ATTENTION

- When installing the saw blade, wipe off the saw blade and chips on the mounting surface before mounting. T
- 1) Move the adjustable wrench from the "tight" position to the "loose" position. (When the lever is in the "loose" position, the drive plate (A) moves inward.

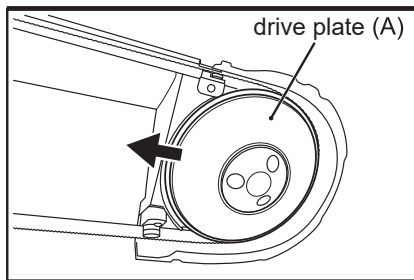
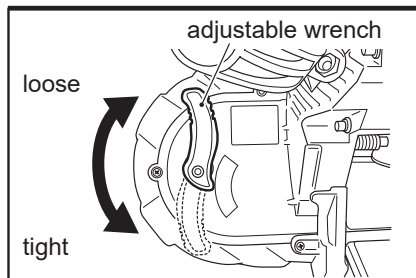

- 2) From the back of the saw blade, insert the saw blade between the guide roller and the guide roller of one holder. When one is inserted, insert the saw blade into the other holder, push the tooth side of the saw blade, and push it until the back of the saw blade hits the back of each holder.

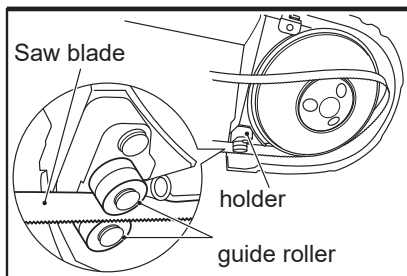

⚠ ATTENTION

- Check the rotation direction of the saw blade before mounting.
- 3) Hang the saw blade on one wheel and push it in until the back of the saw blade hits the bottom of the wheel. Hang the saw blade on the other drive plate in the same way, and push it in until the back of the saw blade hits the back of the wheel.

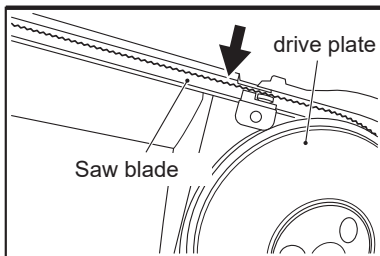

- 4) While holding the saw blade by hand so that the position of the saw blade does not shift, set the adjustable wrench to the "tight" position.

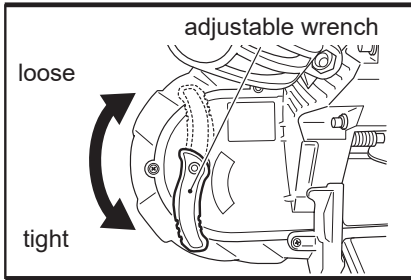

- 5) Perform a test to see if the saw blade is installed correctly.

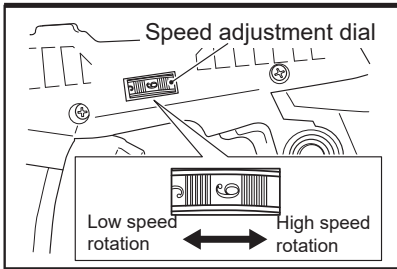

⚠ WARNING

- After installing the saw blade, test is performed, so do not stand in front of the band saw (wheel side) to avoid injury. It is very dangerous if the saw blade comes off or is damaged.

Set the speed adjustment dial to "1" (minimum speed). Set the mode switch to any work method and set the emergency power off dial button to "ON". Operate the trigger switch to rotate the wheel 2-3 times, and the saw blade runs on the wheel without meandering.

2. How to Remove the Saw Blade

- 1) Slowly move the adjustable wrench from the "tight" position to the "loose" position.

⚠ WARNING

- When the adjustable wrench is set to the "loose" position, the saw blade may come out. To avoid injury, do not stand in front of the band saw (wheel side) when operating the adjustable wrench.

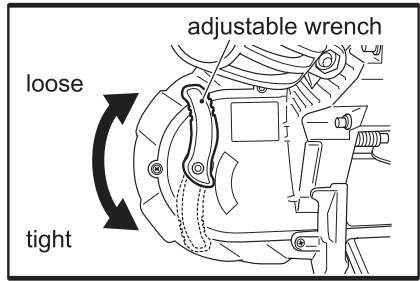

- 2) Remove the saw blade in the reverse order of installation.

How to Adjust the Auxiliary Handle

1. Angle Adjustment

Use the included hex wrench (6mm) to adjust the auxiliary handle to any angle.

- 1) Use a 6mm hex wrench to loosen the grip fixing bolts.
- 2) Adjust the grip to any angle.
- 3) Tighten the grip fixing bolt with a 6mm hexagon wrench to fix the grip.

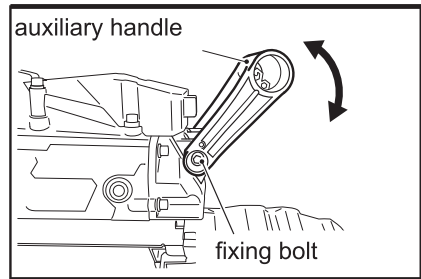

Stopper Plate Adjustment

Adjust the lower limit position of the cutting edge of the saw blade so that the cut material is not left uncut when it is carried and used. When working normally, adjust the stopper plate to the lower limit position.

How to Adjust the Stopper Plate

- 1) Loosen the countersunk head screws (2 places) on the stopper plate with the included hex wrench (4 mm).
- 2) Lower the stopper plate to the lower limit position.

⚠ IMPORTANT

- When cutting the material, if there is any uncut part, adjust the stopper plate to the upper side of the lower limit position again.
- 3) After adjusting the position of the stopper

plate, tighten the countersunk head screws (2 places) of the stopper plate with the attached hexagon wrench (4 mm).

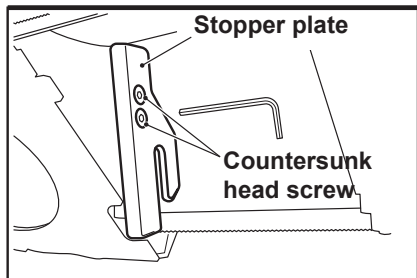

Operation Method

How to Operate by Hands

IMPORTANT

- When working with the band saw, follow the instructions in Chapter 2, "Safety Precautions for Band Saw" on page 5.

WARNING

- Make sure to fix the material before starting work. Inadequate fixation can cause material to bounce, or damage the saw blade, resulting in a serious accident.

WARNING

- Be sure to hold the band saw when using it as it may be swung around or dropped and cause an accident.

ATTENTION

- When you replace the saw blade with a new one, be sure to perform a trial cut.
- Do not cut heat-softening plastic or rubber. The heat of cutting may melt the material and cause it to bite into the cutting edge of the saw blade.
- Wear a dust-proof mask when performing a job that brings harmful chips.

ATTENTION

- When working at heights, make sure there are no people underneath and take the necessary fall prevention measures. Please do not hook the cord.

1) Fix the material with a base.

WARNING

- When fixing the material, turn the emergency power off dial button to "OFF",

remove the power plug from the power outlet, and do the work without touching the trigger switch.

- Do not set the adjustable wrench to the "release" position during work. The material may bounce or bounce, or the saw blade may be damaged, resulting in a serious accident.
- 2) Adjust with the stopper plate so that the material is not left uncut. For how to adjust the stopper plate, refer to the section "Adjusting the stopper plate".
 - 3) Select the position that the saw blade can take two or more ridges of material to cut.
 - 4) Set the mode switch to "I".

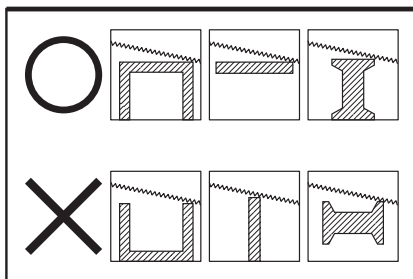

- 5) Make sure that the emergency power off dial button is "OFF", and then put the power plug of the band saw into the power outlet.
- 6) Set the speed adjustment dial, for the details, refer to the section "5-1-5. Speed adjustment dial".

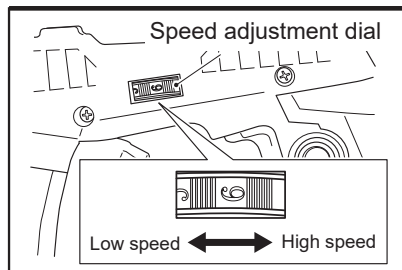

WARNING

- Do not change the rotation speed while cutting the material. It may cause the band saw to malfunction or the saw blade to be damaged.
- 7) Place the saw blade against the stopper plate at a position where it does not hit the material, and set the emergency power off dial button to "ON".
 - 8) Operate the trigger switch to rotate the saw

blade. (The lamp lights up when the saw blade rotates.)

- 9) After the saw blade runs stably, push the material slowly to the saw blade so as not to hit the saw blade.

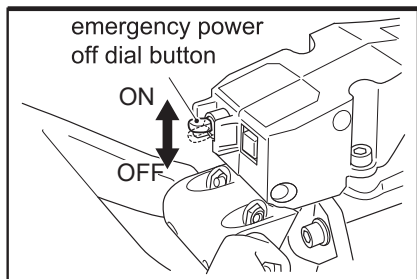

! IMPORTANT

- Trigger-If you press the trigger lock button while operating the switch, the trigger switch will be locked at that position. If you hold the trigger switch again, it will be released.
- 10) When you finish cutting, lift the main body slightly and finish cutting slowly.

! Warning

- When working, cut only with the weight of the band saw. If you press the band saw more than necessary to work, the band saw may break down or the saw blade may be damaged, resulting in inefficient work.

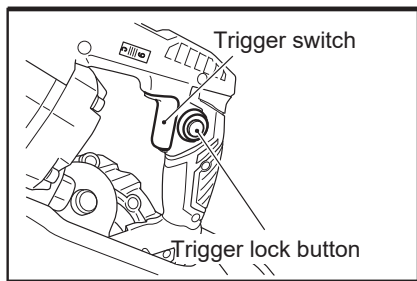

When using the base

By attaching the base to the band saw body, you can fix the material, cut the angle, and cut the material with the automatic cutting function.

1. How to install and remove the base Refer to the section "5-2-1. How to attach / detach the base" for attaching / detaching the main body to / from the base.
2. How to operate using the base.

! Warning

- When fixing the material, turn the emergency power off dial button to "OFF" and remove the power plug from the power outlet.
- Do not set the adjustable wrench to the "loose" position during work. The material may bounce or bounce off, causing a serious accident. It may also damage the saw blade.

! IMPORTANT

- When fixing the material, fix it at a position where the cutting edge of the saw blade touches the cut surface at least two ridges.

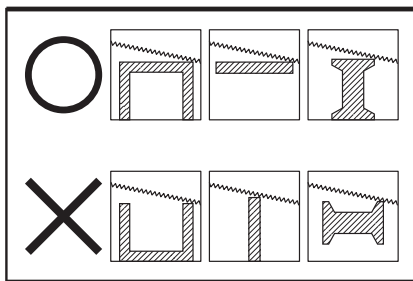

- 1) Fix the material.

- How to fix the material

- (1) Set the screw nut to the unlock position.
- Put the material between the moving jaw and the push-pull rod base, push the push-pull rod to fix the material .
- With the vise stopper nut in the locked position, turn the pushpull rod clockwise to fix the material.

! Warning

- Make sure that the moving jaw is firmly fixed with the bolts (2).
- Do not allow chips to adhere to the screws. When fixing the material, it may get caught in the screw nut and damage the screw thread.

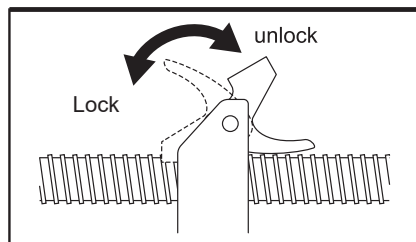

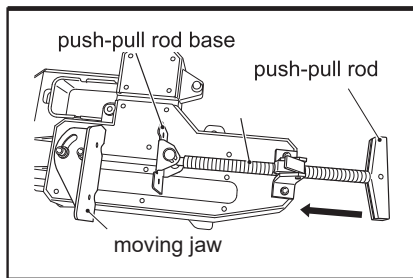

⚠ IMPORTANT

You can work more safely by fixing other parts of the material with a clamp.

- How to fix when cutting at an angle.

⚠ Warning

- When fixing the material, turn the lever switch to "OFF" and remove the power plug from the power outlet.
- Do not set the adjustable wrench to the "loose" position during work. The material may bounce or bounce off, causing a serious accident. It may also damage the saw blade.

⚠ IMPORTANT

- When fixing the material, fix it at a position where the cutting edge of the saw blade touches the cut surface at least two ridges.

- ① With the screw nut in the unlock position, pull the push-pull rod base to the position where it hits the screw nut.
- ② Loosen the two bolts on the moving jaw with the included hex wrench(8mm).
- ③ Move the moving jaw to the cutting angle position on the angle scale and align the vise guide plate with the cutting angle (0° to 45°).
- ④ Tighten the moving jaw bolts (2) with the included hex wrench(8mm).

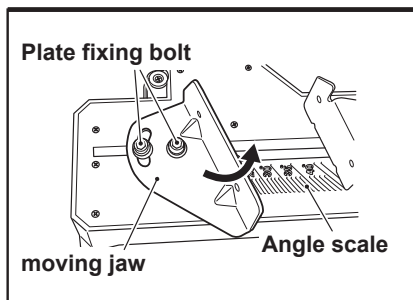

⚠ ATTENTION

- Make sure to fix the moving jaw. If it moves during work, it may damage the saw blade or distort the cut surface.
- ⑤ Put the material between the moving jaw and the push-pull rod base, push the push-pull rod to fix the material.

⚠ IMPORTANT

- You can work more safely by fixing other parts of the material with a clamp.
- ⑥ With the vise screw nut in the locked position, turn the pushpull rod clockwise to secure the material.

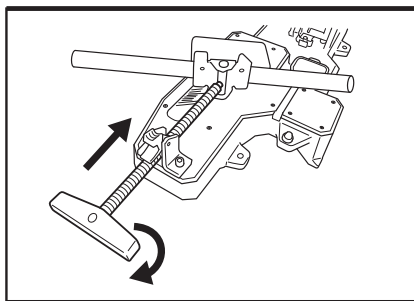

How to Automatically Disconnect

This function automatically cuts the material. When the cutting of the material is completed, the blade will stop automatically.

⚠ IMPORTANT

- Automatic cutting is performed by attaching the base to the machine. when the mode is changed to handhold cutting, the automatic cutting function can not be used.
- 1) Fix the connect shelf at any angle so that the band saw body does not move.
 - 2) Set the emergency power off dial button to "OFF".
 - 3) Set the mode switch to "o".
 - 4) Fix the material according to the requirements.
 - 5) Squeeze the trigger switch and press the trigger lock switch. Lock the rigger switch.
 - 6) Set the speed with the speed adjustment dial.
 - 7) Release the lock pin and set the emergency power off dial button to "ON".
 - 8) Press the start button. The saw blade rotates.
 - 9) After the saw blade run stably, push the material to slowly to the saw blade so as

not to hit the saw blade.

10) Automatic disconnection will start. When the cutting is completed, the saw blade will stop.

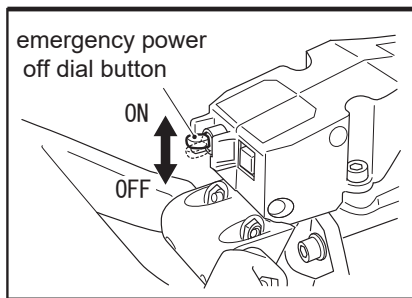

⚠ ATTENTION

- When using the automatic cutting continuously, be sure to turn the emergency power off dial button "OFF" to stop the saw blade when fixing the material.

⚠ IMPORTANT

- To stop the automatic disconnection, turn the emergency power off dial button to "OFF" to stop the saw blade.

1. Automatic Cutting Speed Adjustment
Automatic cutting cuts the material by dropping due to the weight of the main body. You can adjust the falling speed of the main body with the load adjustment plate.

The higher of the plate that hits the spring, the slower the cutting speed, and the lower of the plate, the faster the cutting speed.

Adjust the height of the plate by turning the bolt.

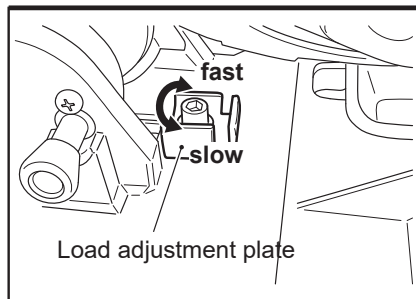

2. Adjustment of Automatic Stop Device
If the saw blade does not stop even after the self-propelled cutting is completed, adjust the

height of the automatic stop stopper.

How to Adjust

⚠ WARNING

- When adjusting the automatic stop device, set the emergency power off dial button to "OFF" and disconnect the power plug from the outlet.
- 1) Fix the automatic stop device with pliers.
 - 2) When the nut of the automatic stop device is loosened, the position of the stopper lever becomes higher and the saw blade stops faster during automatic cutting. Tightening will slow down the saw blade to stop.

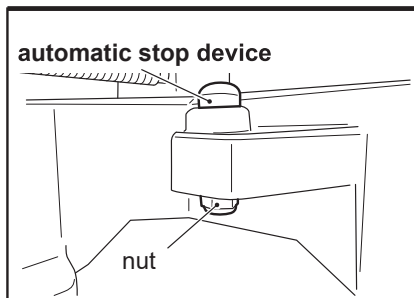

Vertical Setup

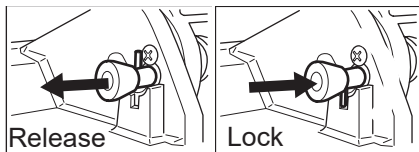
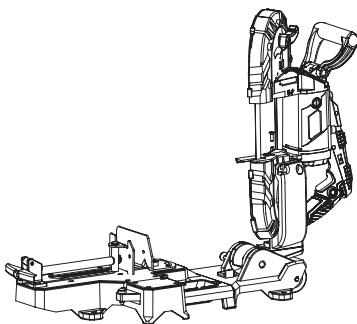

- Pull out the locating pin and raise the support arm to a vertical position.
- Lock the pin to secure the support arm.

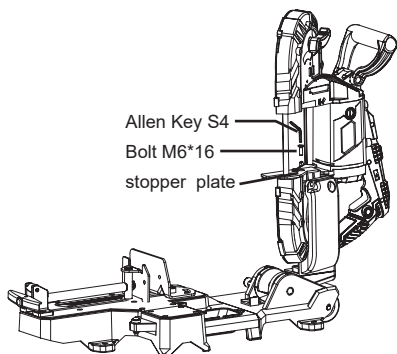

- Using an S4 allen key, loosen the two M6*16 bracket bolts to slide the stopper plate to the outermost position for maximum workspace.
- Remove one bolt that is farthest from the saw blade and set it aside. Tighten the remaining bolt to secure the stopper plate in place.

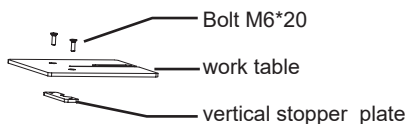

- Use an S4 allen key and two M6*20 bolts to assemble the vertical stopper plate and worktable; do not fully tighten the screws

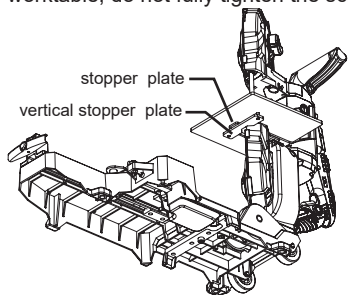

- Install the assembly on the stopper plate, extending it outward for maximum workspace, ensuring the vertical stopper plate is positioned under the stopper plate.

saw blade should be in the middle of U-shape slot

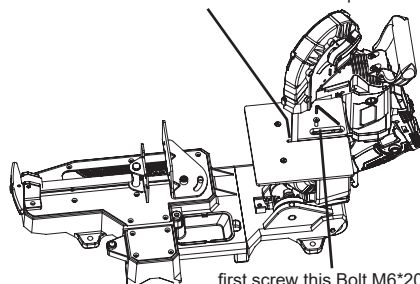

- Adjust the worktable to center the blade in the U-shaped slot, aiming for symmetry to prevent the saw blade from rubbing against the worktable.
- Begin by tightening the remaining M6*20 bolt to its corresponding position, and then tighten the other two bolts last.

Cleanup and Storage

After finishing the work, clean the band saw before storing it. This not only will make the work be done smoothly next time, but will also extend the life of the band saw.

⚠ WARNING

- When cleaning the band saw, remove the power plug from the power outlet.

Cleanup

Remove dust, dirt and chips from the band saw body, saw blade, cutting edge and base (especially the threaded part).

⚠ WARNING

- When cleaning the saw blade, wear leather gloves to prevent injury.

Wipe off the dirt on the machine unit with a dry, soft cloth.

⚠ IMPORTANT

- Do not use benzene or solvent. It may cause deterioration or discoloration.

How to Store

- Keep out of reach of children and in a locked place.
- Do not store in a place exposed to wind and rain or in high humidity.
- Store in a dry, cool and dark place out of direct sunlight.

- Do not store near highly flammable materials such as gasoline.
- For long-term storage, remove the saw blade before storing.

Transportation

⚠ ATTENTION

- When transporting or moving, set the connect shelf to the lowest position and lock pin is set to the "lock" position to fix the connect shelf.
- When transporting or moving, turn the emergency power off dial button "OFF" position.

Refer to the section "5-1-7. Lock pin" for how to lock the connect shelf.

Transportation

When moving with the wheels, hold the base part and pull the whole set like suitcase.

24

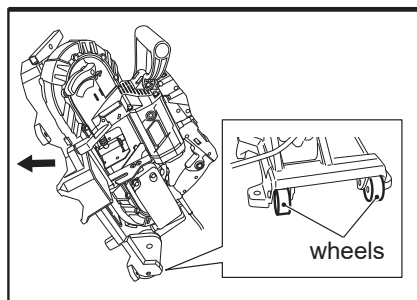

INSPECTION

⚠ WARNING

Before inspecting or servicing the band saw, remove the power plug from the power outlet.

⚠ ATTENTION

Wipe off any wax or chips on the rubber of the drive plate with a dry cloth. The saw blade may slip or come off, resulting in injury.

Replacing the Rubber Belt on the Drive Plate

If the rubber belt on the wheel wears and the saw blade slips or becomes easy to come off, the rubber belt needs to be replaced.

1. How to Replace the Rubber Belt on the Drive Plate.
- 1) Remove the rubber belt from the drive plate.

- 2) Attach the new rubber belt to the convex on the outside of the drive plate and the recess on the inside of the rubber.
- 3) Rotate the saw blade at the lowest speed and make sure the rubber belt is not meandering.

⚠ IMPORTANT

- When replacing the rubber belt, replace both left and right at the same time.

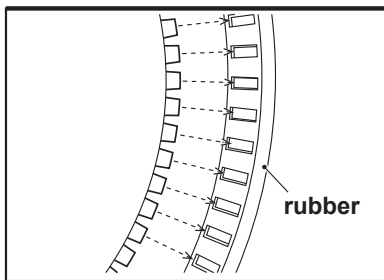
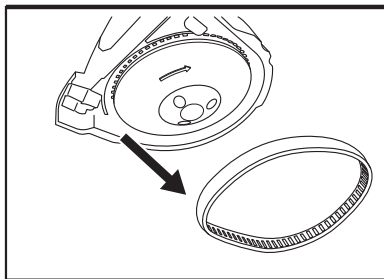
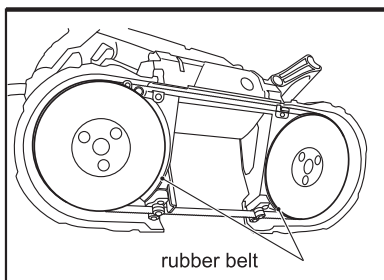

Inspection / replacement of motor carbon brush

Check the carbon brush of the motor regularly.

1. How to inspect and replace the motor brush
 - 1) Turn the brush cap with a screwdriver to remove the cap. (There are two motor brushes on the left and right.)
 - 2) Take out the brush inside the cap.
 - 3) Inspect the brush for wear to the marginal

wear line. If it is worn up to the limit wear line, replace it with a new brush.

⚠ IMPORTANT

- When replacing the brush, replace it on both the left and right sides. If you replace only one of them, the brush will be worn out and it may cause the motor to malfunction.
- Be careful not to let foreign matter get inside the brush cap and to prevent dust from adhering to the brush. It may cause the motor to malfunction.

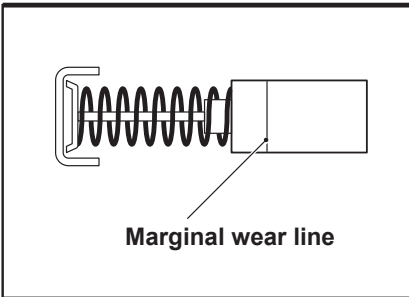
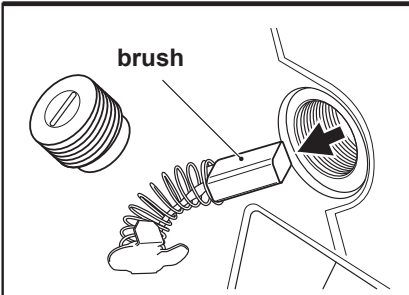
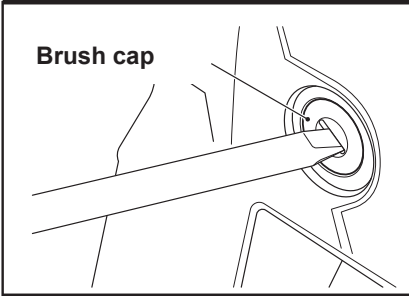

4) Reinstall the brush and install the brush cap.

Maintenance/Service

Preventive maintenance performed by unauthorized personnel may result in misplacing of internal wires and components which could cause serious hazard. We recommend that all tool service be performed by MAXXT Service Team.

To purchase repair parts in North America, you can directly visit www.hyperfit-tools.ca

For other countries, please contact service@maxxt-tech.com for purchasing.

⚠ do not attempt to clean ventilation slots by inserting pointed objects through openings.

⚠ disconnect the plug before cleaning.

ENVIRONMENT

Do not dispose of electric tools, accessories and packaging together with household waste material (only for EU countries)

- In observance of European Directive on waste of electric and electronic equipment and its implementation in accordance with national law, electric tools that have reached the end of their life must be collected separately and returned to an environmentally compatible recycling facility.

Application Chart

Warning

- Select a saw blade suitable for the material from the selection table. Also, when working, set the rotation speed suitable for the material with the speed adjustment dial.
- If you work with a saw blade that is not suitable for the material or at a rotation speed, not only will the cutting system be reduced, but the saw blade may be damaged.
- When selecting the number of saw blade ridges, select a saw blade that requires two or more ridges at the cutting point of the material.

●Optimal ○Appropriate

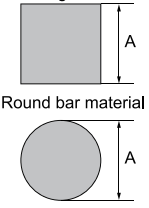
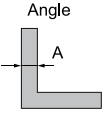
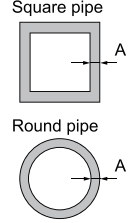
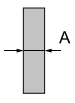
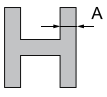
Cutting Material		Applicable length teeth number A	1140mm				
			10/14	14	18	24	
	Structure Steel	Small	3 ~ 25	○	●	○	
		Medium	25 ~ 50				
		Large	50 ~ 100				
	Stainless	Small	3 ~ 25	○	●	○	
		Medium	25 ~ 50				
		Large	50 ~ 100				
	Non-ferrous Metals	Small	3 ~ 25	○	●	○	
		Medium	25 ~ 50				
		Large	50 ~ 100				
	Plastic		3 ~ 110		○	○	
	Ordinary Shaped Steel	Thin	3 ~ 6	○	●	○	○
		Thick	6 ~ 13	○	●		
	Stainless	Thin	3 ~ 6		○	●	○
		Thick	6 ~ 13	○	●		
	Non-ferrous Metals	Thin	3 ~ 6		●	○	○
		Thin	6 ~ 13	○	●		
Plastic		6 ~ 13		○	○		
	Ordinary Shaped Steel	Thin	3 ~ 13			○	○
		Medium	13 ~ 25		○	○	
		Thin	25 ~ 50	○			
	Stainless	Thin	3 ~ 13			●	○
		Medium	13 ~ 25	○	●	○	
	Non-ferrous Metals	Thin	25 ~ 50				
		Thin	3 ~ 13		○	●	○
		Medium	13 ~ 25	○	○		
	Thin	25 ~ 50					
	Plastic		3 ~ 50		○	○	
	Ordinary Shaped Steel	Thin	3 ~ 25	○	○		
		Thin	25 ~ 50				
	Stainless	Thin	3 ~ 25		●	○	
		Thin	25 ~ 50	○			
	Non-ferrous Metals	Thin	3 ~ 25	○	●	○	
		Thin	25 ~ 50	○			
Plastic		3 ~ 50		○	○		
	Structure Steel	Thin	3 ~ 6		●	○	○
		Thin	6 ~ 15	○	○		
	Ordinary Steel	Thin	3 ~ 6		●	○	○
		Thin	6 ~ 13	○	○		
	Stainless	Thin	3 ~ 6		○	●	○
		Thin	6 ~ 13	○	●		

24 piles are ideal for shaped steel with a wall thickness of 3 mm or less.

MAXXT

CONTACT US

In Canada
Hyperfit Tools Inc.(AGENT)
Tel:289 644 7621
E-mail: info@hyperfit-tools.ca
www.hyperfit-tools.ca

In Other Countries
E-mail: service@maxxt-tech.com
www.maxxt-tech.com



MAXXT-TECH



MAXXT-TECH



MAXXT-TECH



MAXXT-TECH

