

Features

- Set includes: Cabinet, precut Silestone® quartz vanity top, sink, cabinet hardware, mounting hardware for sink
- Vanity top has single faucet hole with pilot holes for optional 8" (203 mm) widespread faucet configuration
- Full-extension 18" (457 mm) depth drawer with soft-close undermount slides for smooth opening
- Solid wood drawer with dovetail joint construction
- Vanity top is covered under the Silestone® 25-Year Limited Warranty
- Silestone® quartz provides exceptional durability and stain resistance, making it easy to maintain
- Caxton® Rectangle undermount sink has a streamlined design that is easy to clean
- Customize your storage with optional in-drawer accessories, medicine cabinet surrounds and side kits (sold separately)
- Optional vanity top side and backsplashes available (sold separately)

Material

- Solid and composite wood
- Silestone® quartz vanity top
- Vitreous china sink
- Premium metal hardware for durability and reliability

Installation

- Wall-hung

Required Products/Accessories

K-28263 Silestone® quartz 37" backsplash
K-28266 Silestone® quartz side splash
K-33568 10" cabinet pull

Included Components

K-28250 Silestone® 37" quartz vanity top with rectangular cutout
K-EC20000 20-1/2" rectangular undermount bathroom sink
K-27939 13" cabinet pull
K-33566 36" wall-hung bathroom vanity cabinet



Codes/Standards



EPA TSCA Title VI/CARB P2

KOHLER® One-Year Limited Warranty

See website for detailed warranty information.

Available Colors/Finishes

Color tiles intended for reference only.

Color	Code	Description
	1WA	Linen White
	1WX	Slate Grey

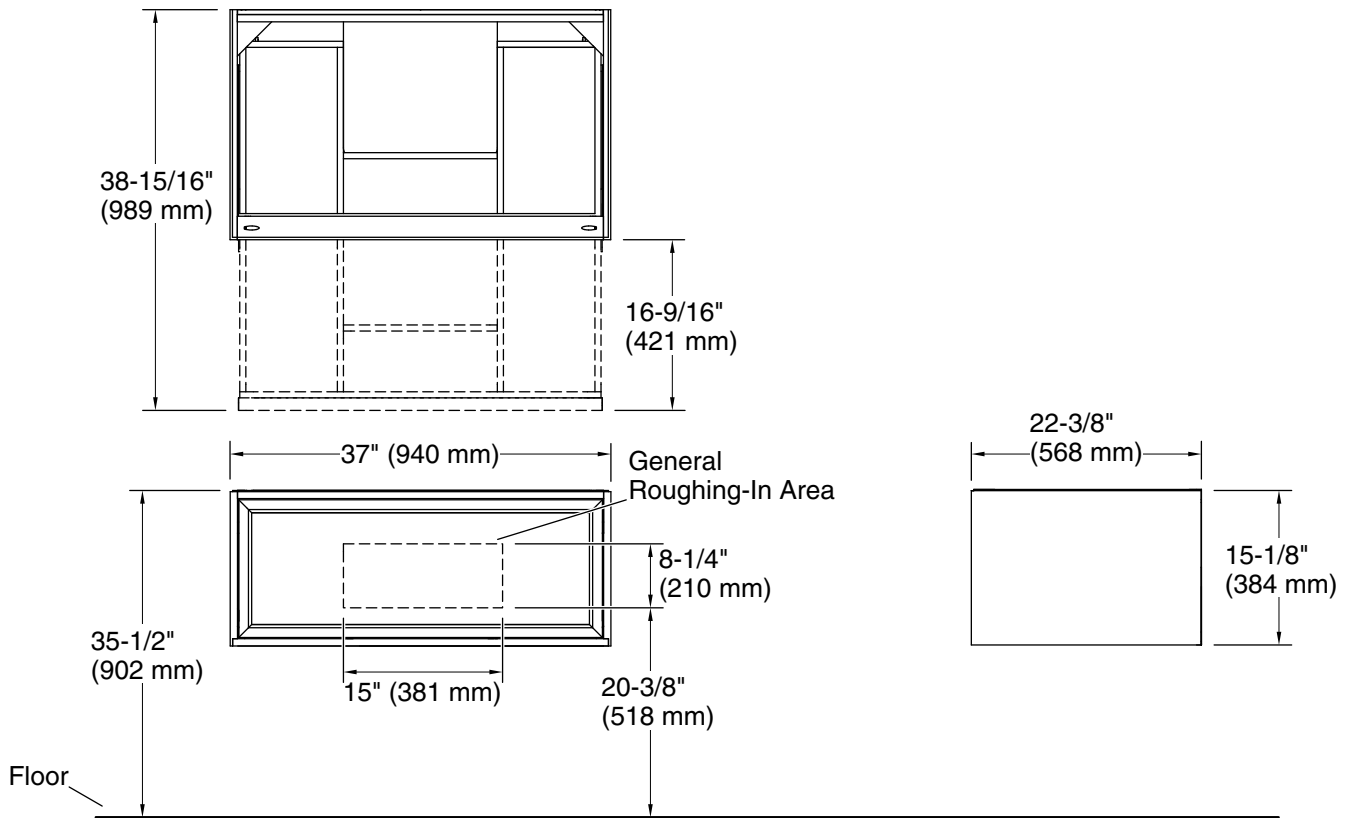

Technical Information

All product dimensions are nominal.

Lighting included: No

Notes

Install this product according to the installation instructions.