

---

# ASSEMBLY INSTRUCTIONS

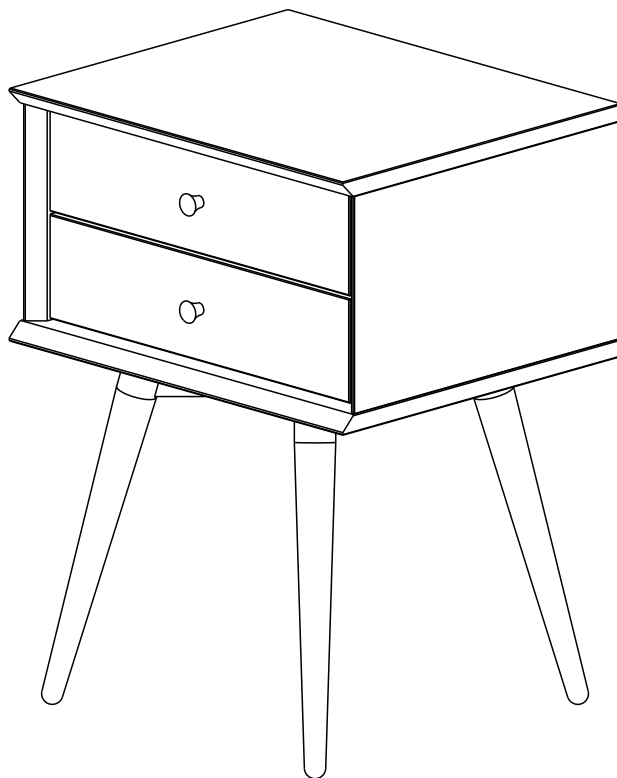

Mid-Century Night Stand 2 Drawers

01:00 Hs

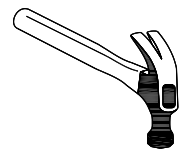
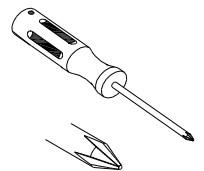
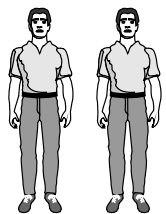

## HARDWARE INCLUDED

---



**A - 8,0x30 Wood Dowel**  
Qty. 16

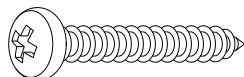

**B - 4,0x30 Screw**  
Qty. 08



**C - 3,5x14 Screw**  
Qty. 24

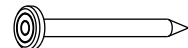

**D - 10x10 Nail**  
Qty. 12

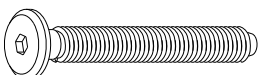

**E - 1/4x50 Screw**  
Qty. 05

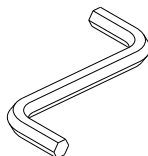

**F - Allen Key**  
Qty. 01

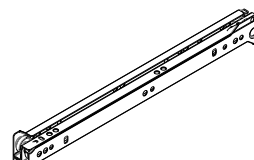

**G - Slide 300mm**  
Qty. 02

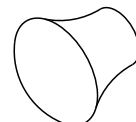

**H - Knob**  
Qty. 02



**I - M4x25 Screw**  
Qty. 02

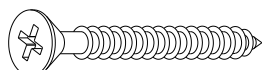

**J - 4,0x45 Screw**  
Qty. 04

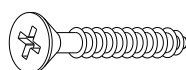

**K - 3,5x30 Screw**  
Qty. 08

---



# PARTS INCLUDED

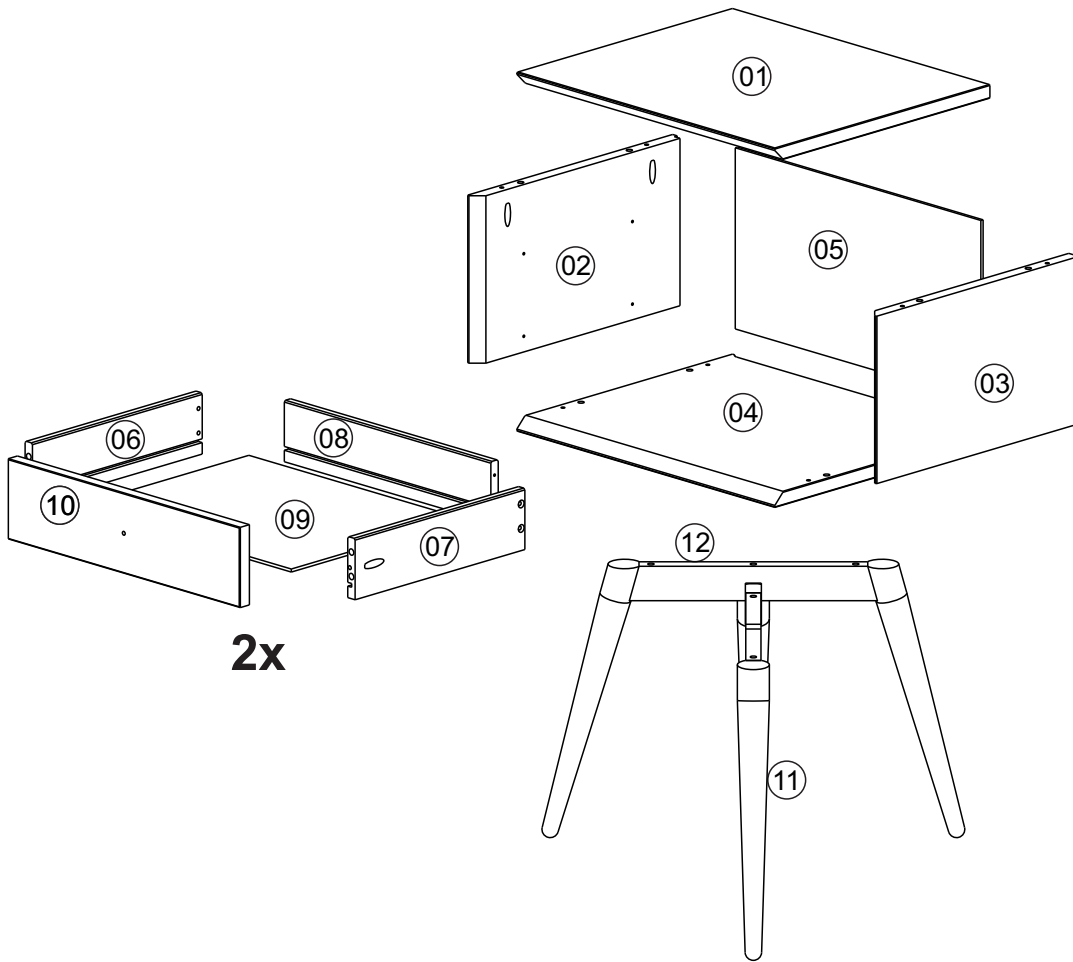

STEP 1

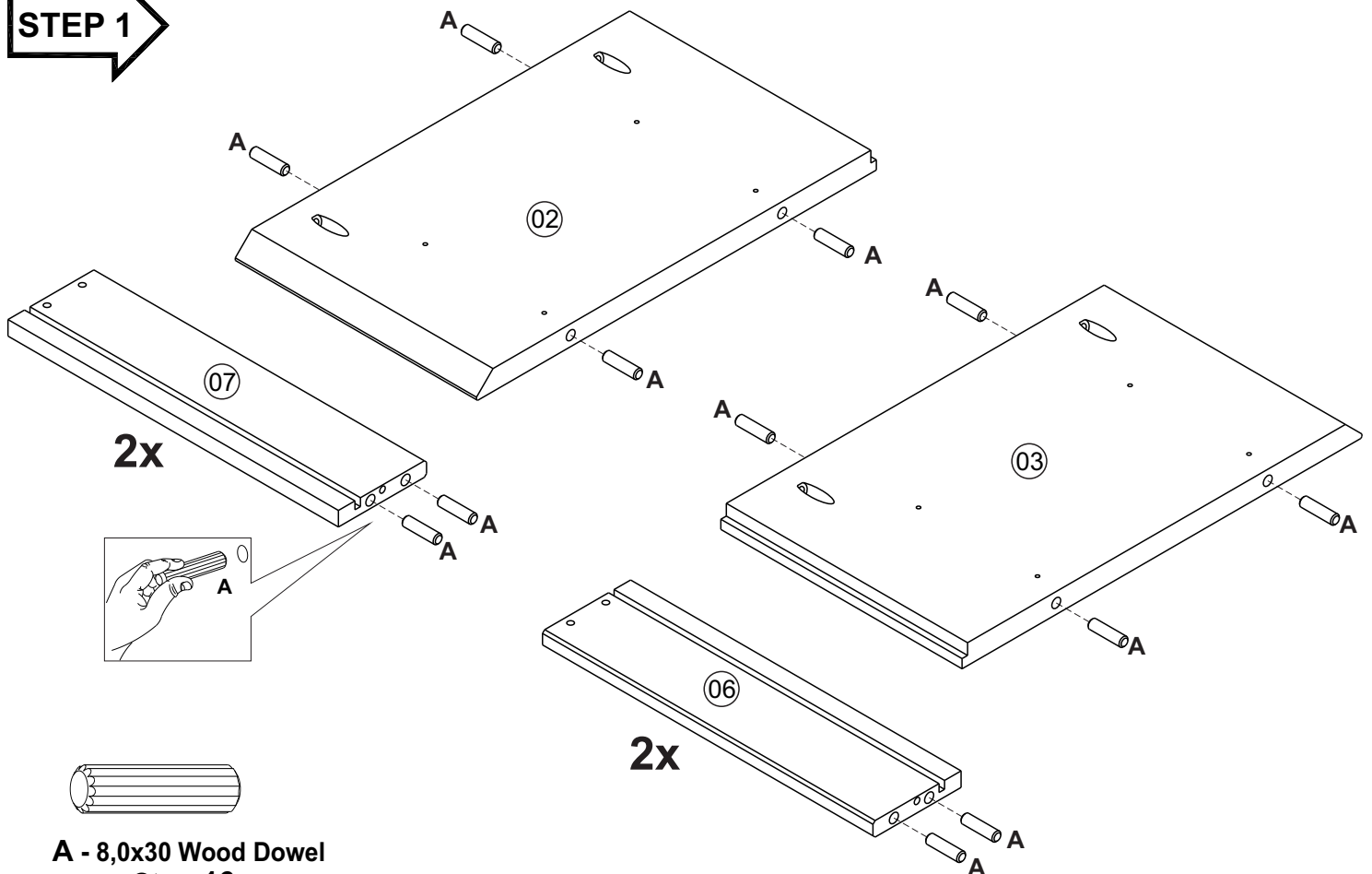

A - 8,0x30 Wood Dowel  
Qty. 16



## STEP 2

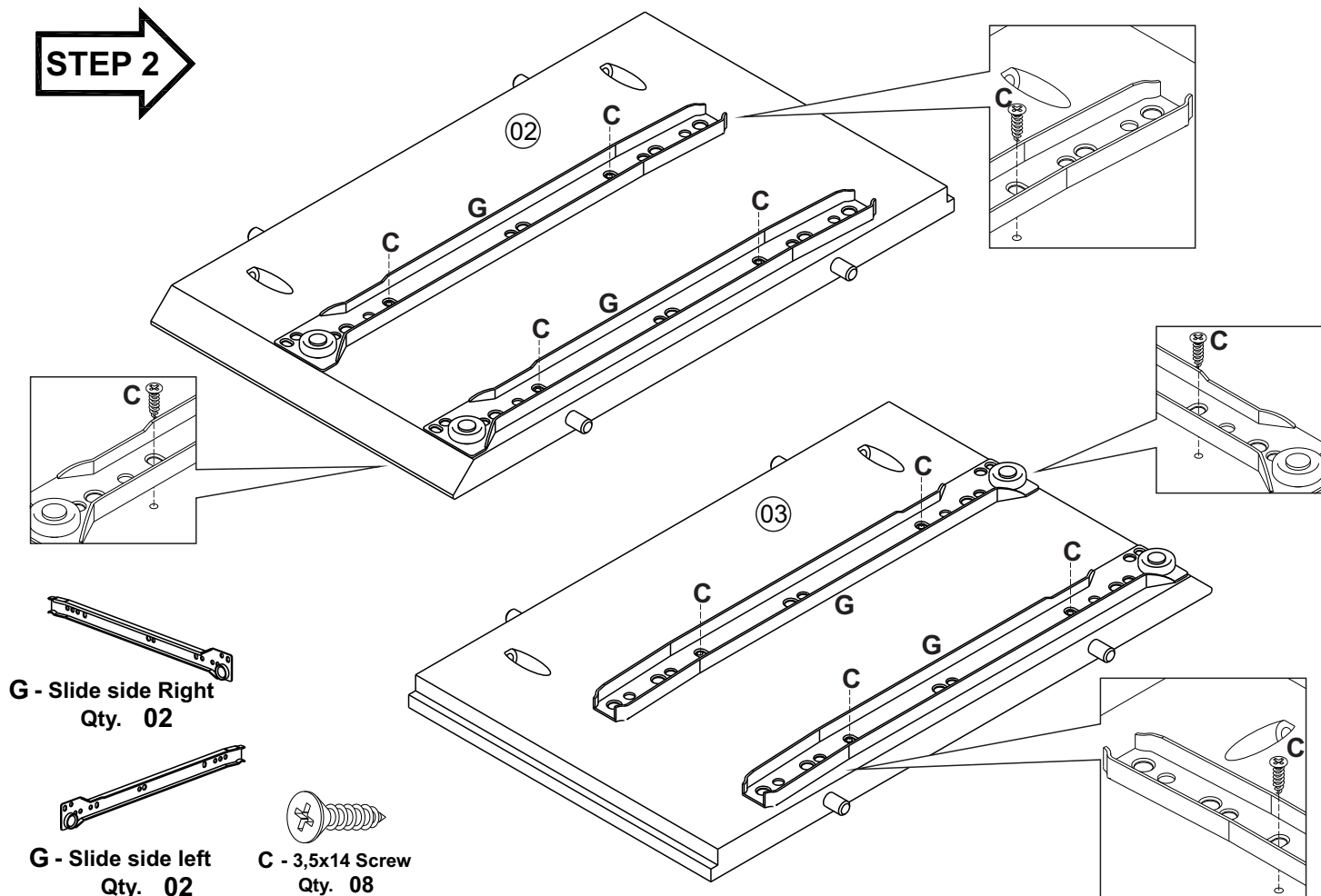

## STEP 3

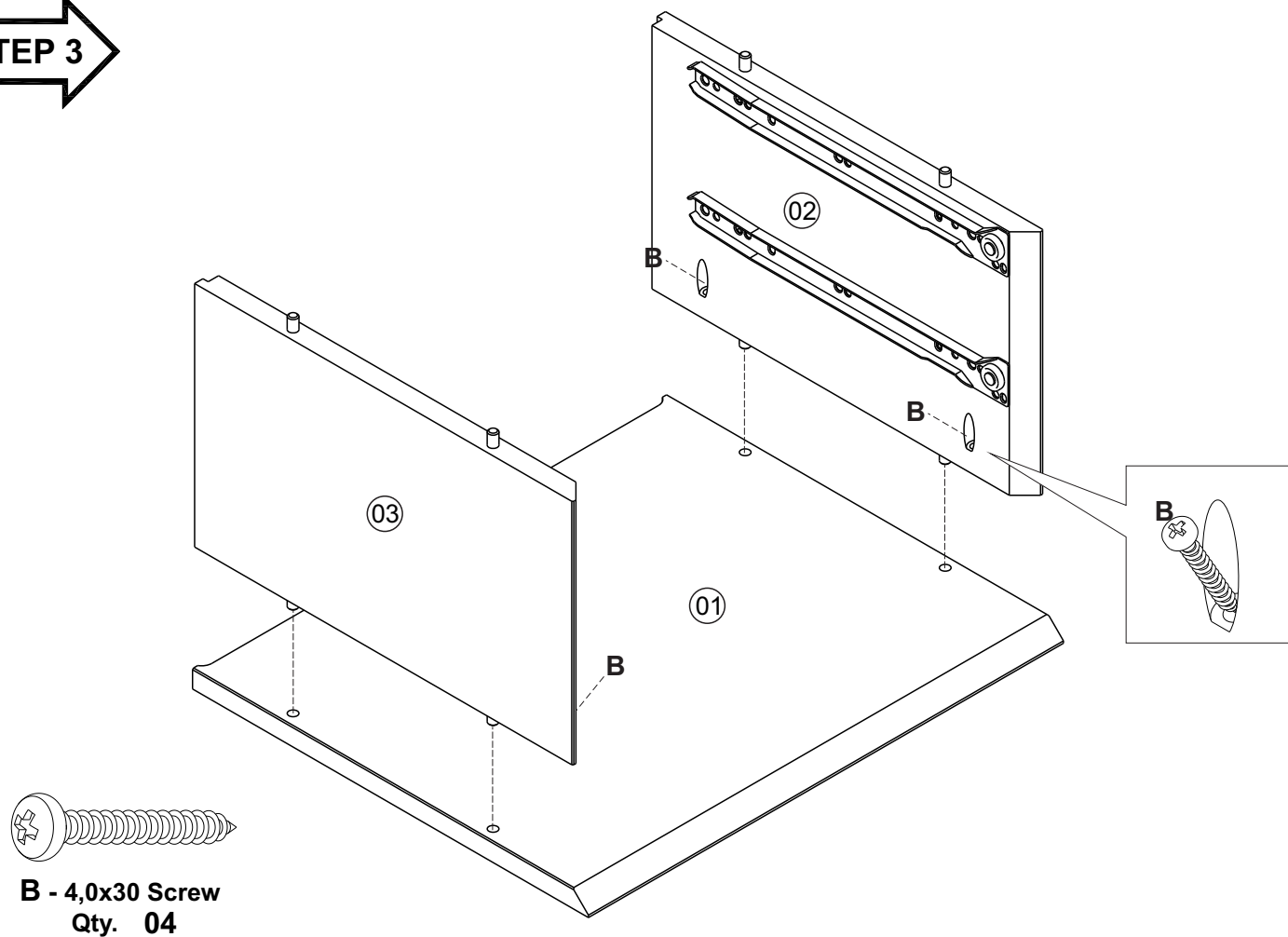



**STEP 4**

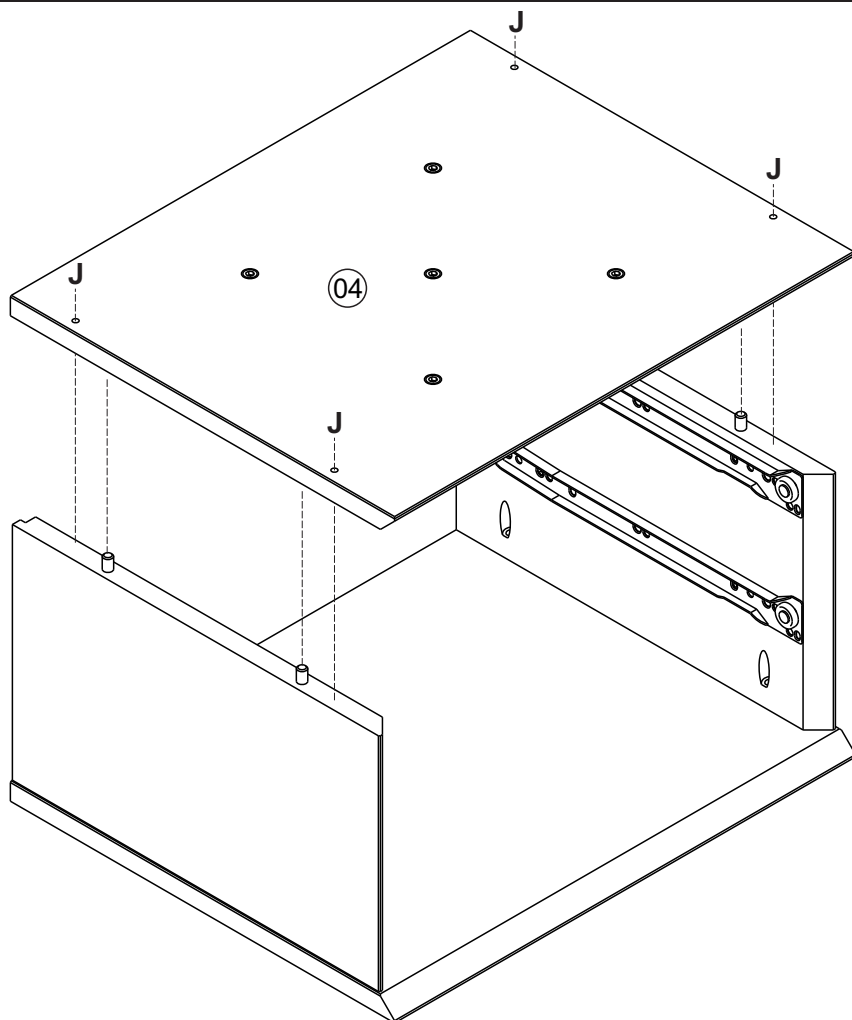

**J - 4,0x45 Screw**  
Qty. 04

**STEP 5**

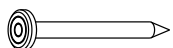
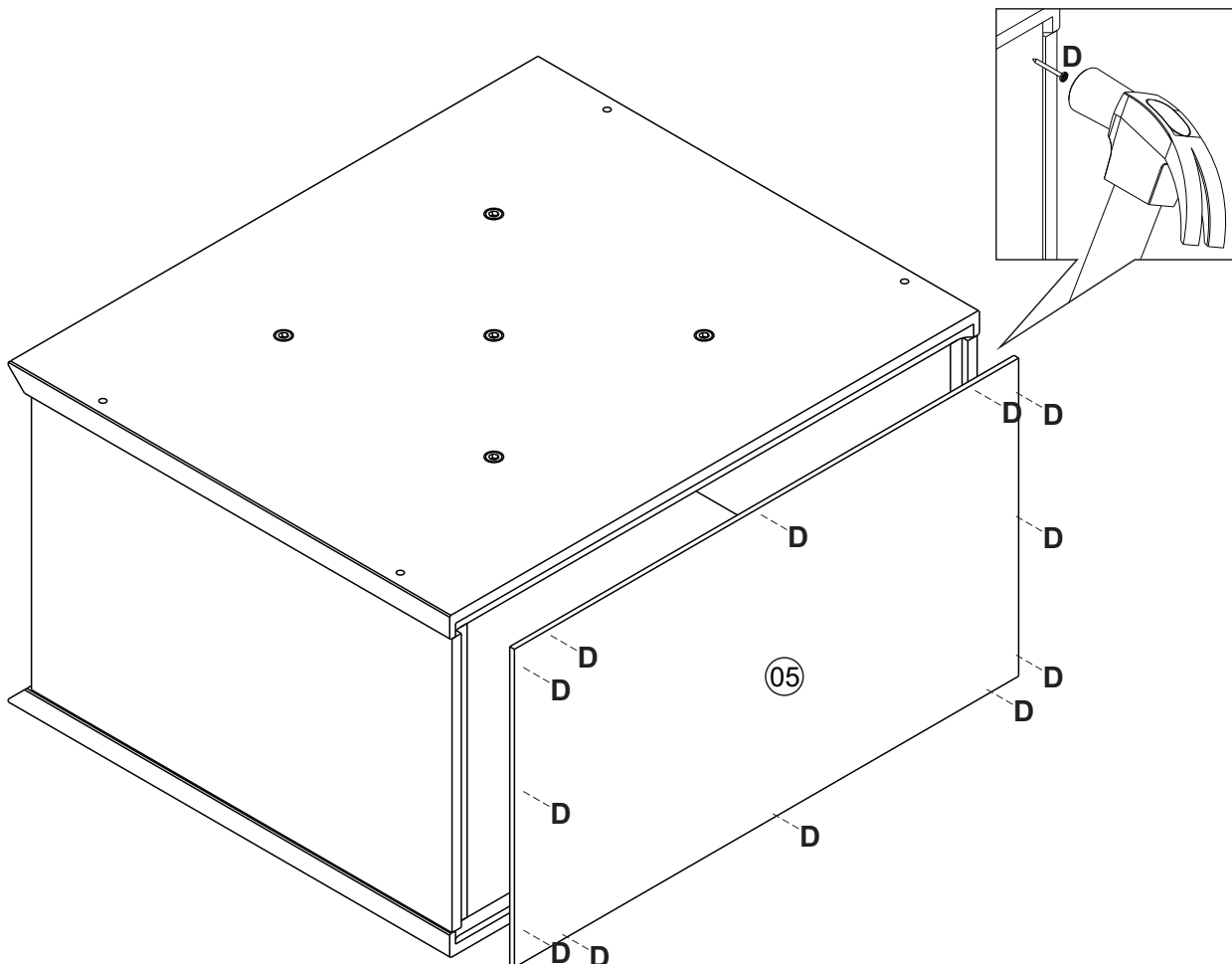

**D - 10x10 Nail**  
Qty. 12



## STEP 6

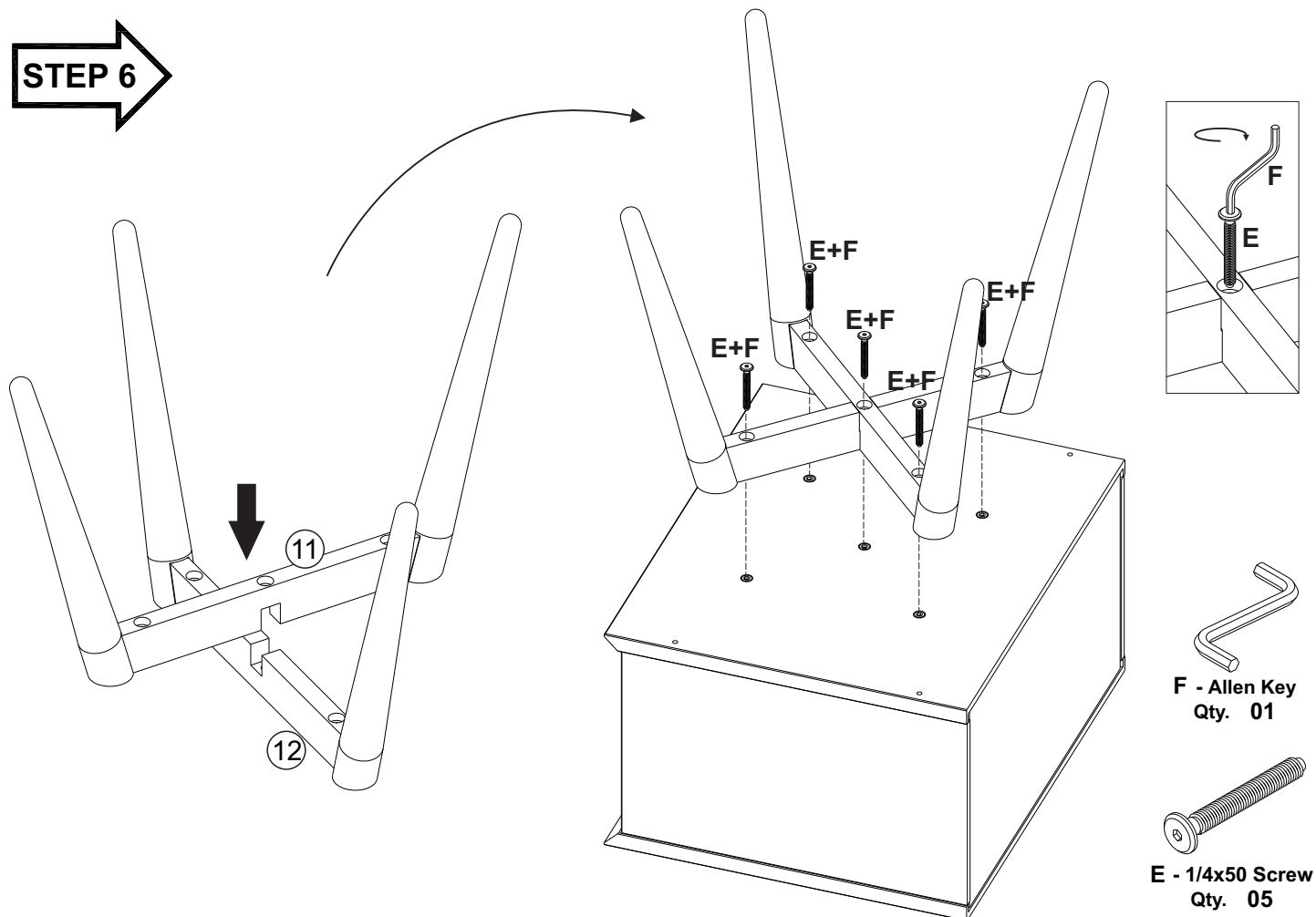

## STEP 7

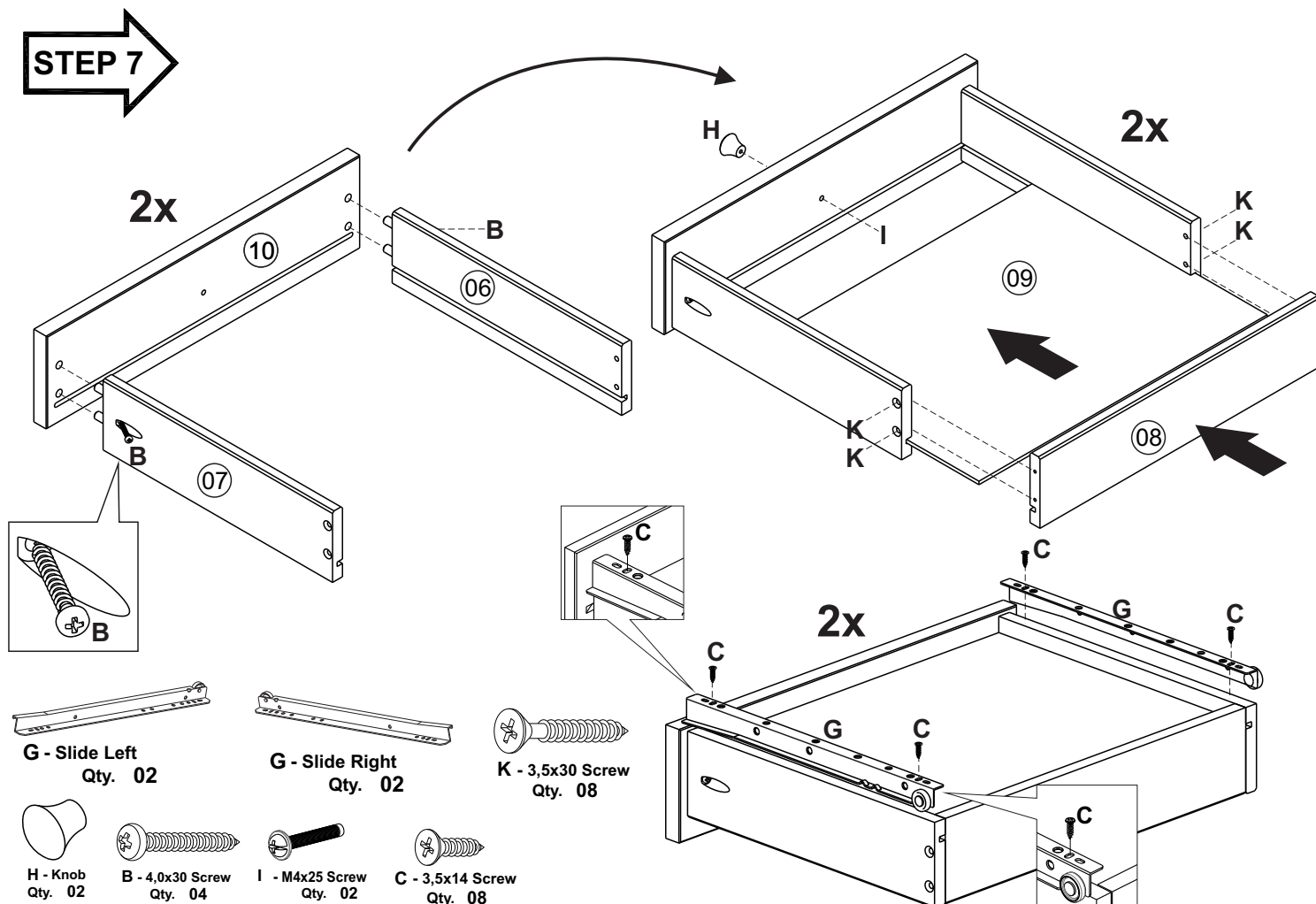



---

---

## STEP 8

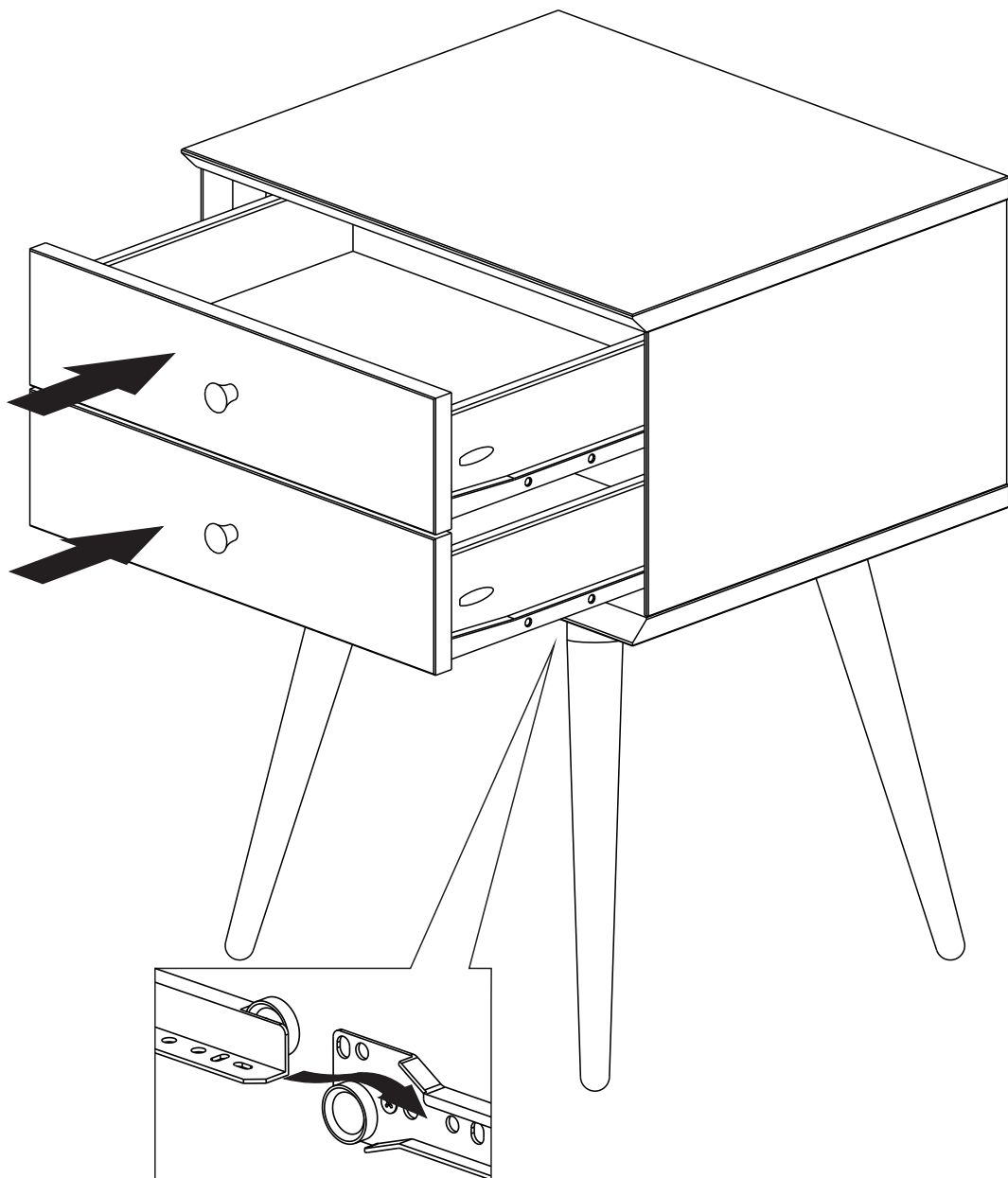

### Drawer Glide Adjustments:

The metal drawer glides are designed to allow for slight adjustments vertically and horizontally, if necessary.

#### Horizontal Glide Adjustment:

Remove drawer from chest. Loosen screws indicated on side of metal track. Make needed space adjustment and re-tighten screws and add 2 additional screws in holes as indicted in diagram below:

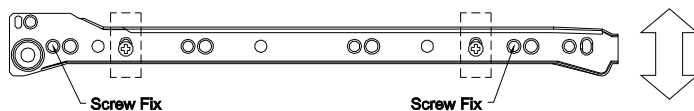

#### Vertical Glide Adjustment:

Remove drawer from chest. Loosen Screws on underside of metal track. Make needed space adjustment and re-tighten screws as indicated in diagram below:

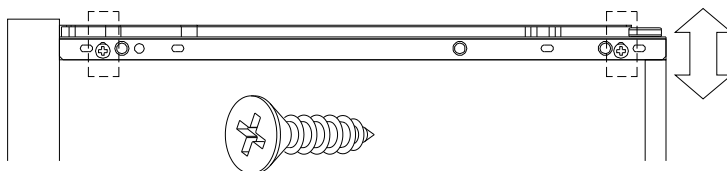

**C - 3,5x14 Screw**  
**Qty. 08**

---

---