

ASSEMBLY INSTRUCTIONS

If you have any questions, please feel free to contact us.
Email: lowes.team@qualfurn.net

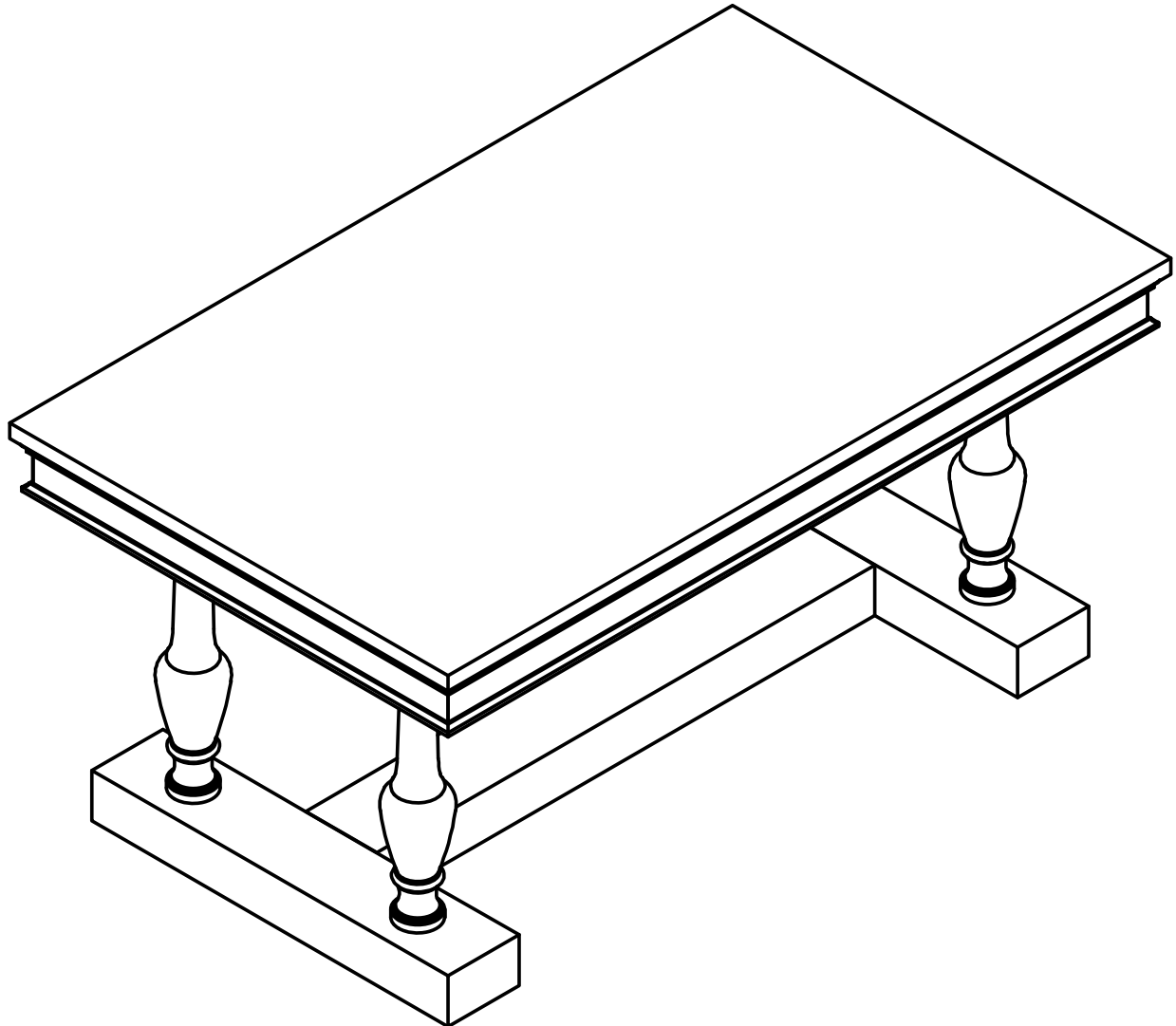

WF315034AAB
WF315034AAE

PRE ASSEMBLY INTRODUCTION

We understand building ready-to-assemble furniture can be a challenging experience for some. To help avoid confusion, we have provided some helpful tips that may speed up the process.

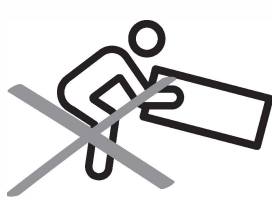

Teamwork

ALWAYS have at least two people to help with transporting and assembling the product to avoid potential injury and/or damage.

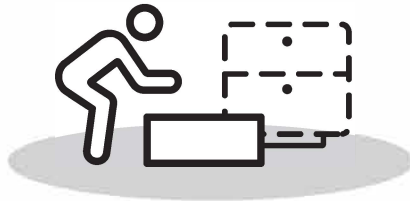
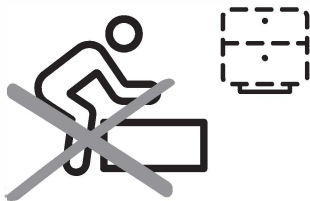

Suitable Location

Assembling near the area of the intended location is highly recommended.



Sufficient Space

Make sure you have enough space to move around during the assembly.



Avoid Scratches

Use cardboard, blankets or a carpeted area while assembling furniture to prevent scratches.

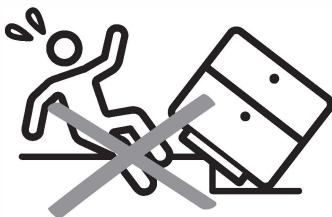

Flat Surface

Make sure the furniture rests on a flat and level surface with each leg evenly touching the floor.

PARTS

#A 1pc

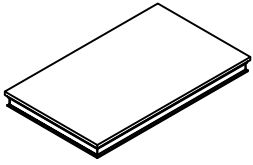
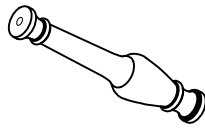

Table Top

#B 4pcs



Pedestal

#C 2pcs

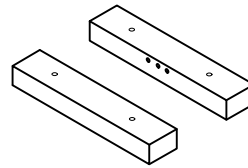
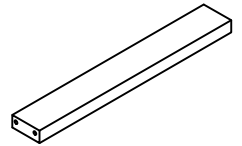

Table Base

#D 1pc



Cross Bar

#E 2pcs

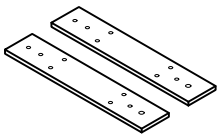

Mounting Plate

HARDWARE

#1

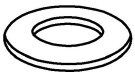

Flat Washer Ø5/16" x 24pcs

#2



Lock Washer Ø5/16" x 24pcs

#3



Bolt Ø5/16" x 2" x 24pcs

#4



Allen Key 4mm x 1pc

ASSEMBLY INSTRUCTIONS

Step 1

Part (#E) 2pcs

Part (#B) 4pcs

Hardware (#1) 4pcs

Hardware (#2) 4pcs

Hardware (#3) 4pcs

Attach Mounting plate (#E) on the Pedestal (#B) by using Flat washer (#1), Lock washer (#2), Bolt (#3) with Allen key (#4).

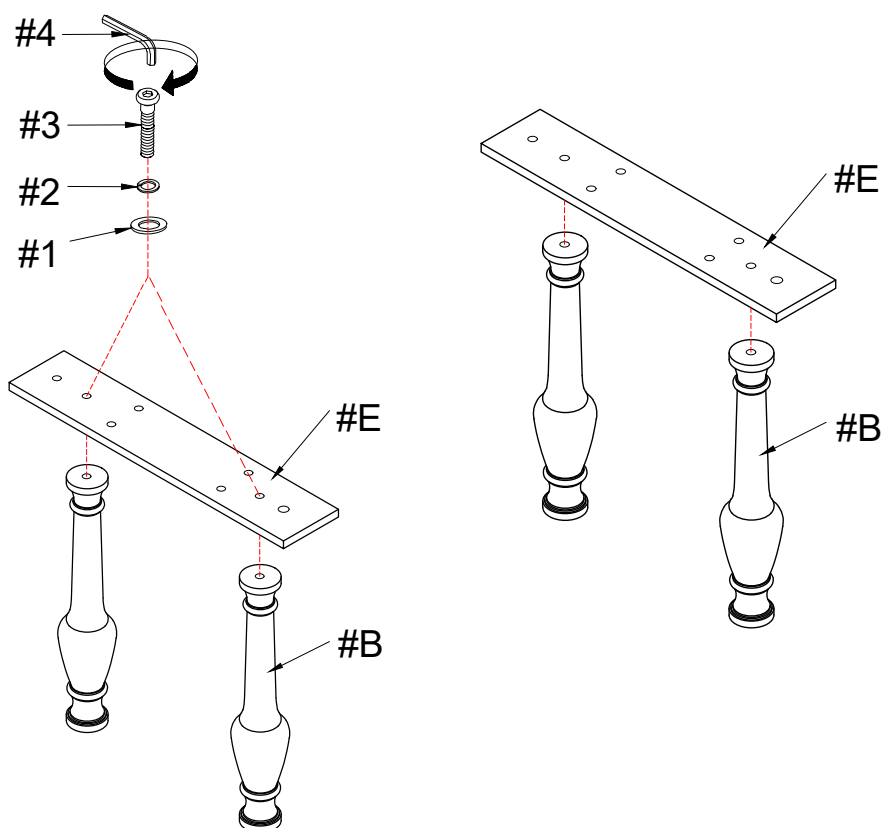

Step 2

Part (#C) 2pcs

Part (#D) 1pc

Hardware (#1) 4pcs

Hardware (#2) 4pcs

Hardware (#3) 4pcs

Attach Cross bar (#D) on the Table base (#C) by using Flat washer (#1), Lock washer (#2), Bolt (#3) with Allen key (#4).

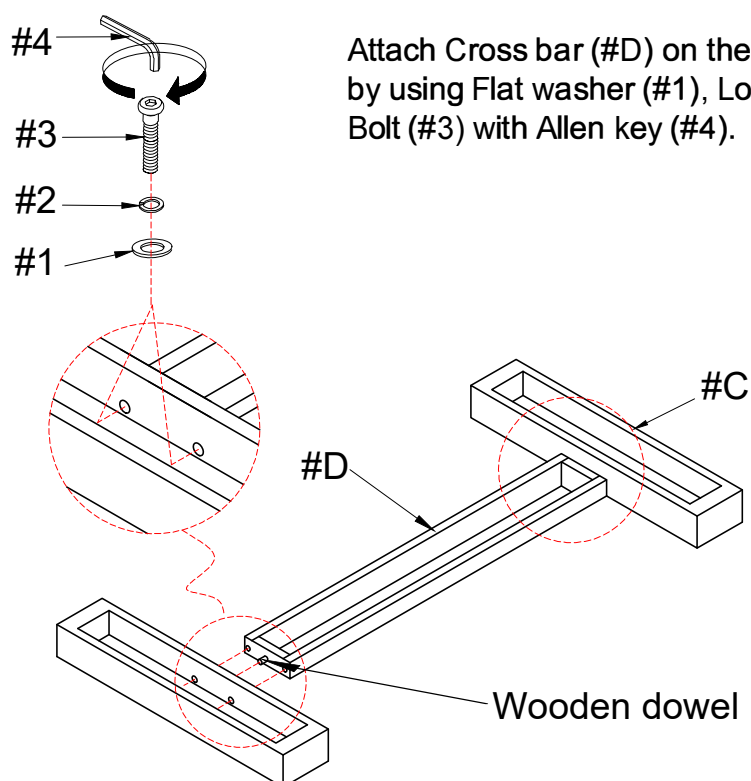

ASSEMBLY INSTRUCTIONS

Step 3

Part #A 1pc

Hardware #1 12pcs

Hardware #2 12pcs

Hardware #3 12pcs

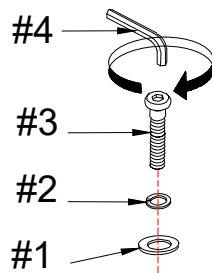

Attach Mounting plate (#E) with the Pedestal (#B) on the Table top (#A) by using Flat washer (#1), Lock washer (#2), Bolt (#3) with Allen key (#4).

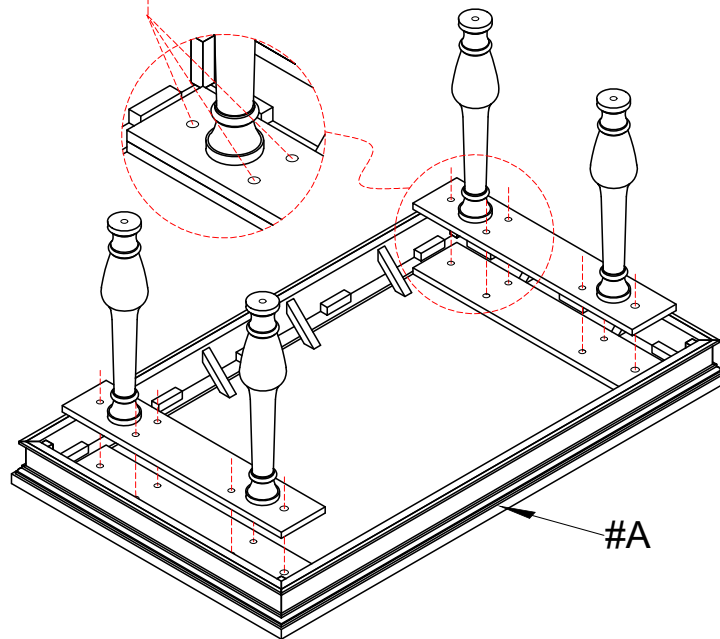

Step 4

Hardware #1 4pcs

Hardware #2 4pcs

Hardware #3 4pcs

Attach Cross bar (#D) with the Table base (#C) on the Pedestal (#B) by using Flat washer (#1), Lock washer (#2), Bolt (#3) with Allen key (#4).

