

## **INSTALLATION INSTRUCTIONS**

### **VOLT® LOW VOLTAGE LANDSCAPE LIGHTING**

VOLT® Bi-Pin Flood Light

**ITEM: LFL-2100-4-BBZ**

**IMPORTANT: PLEASE READ BEFORE INSTALLATION**

This luminaire is intended for installation in accordance with local codes and the National Electric Code (NEC). Failure to adhere to these codes and instructions may result in serious injury, property damage and void the warranty.

These instructions do not intend to cover all variations in installation, operation maintenance or mounting situations.

1. Make sure that the power is turned OFF before installing or servicing this fixture.
2. This fixture is perfect for placing in water fountains, water falls, ponds, pools, etc.
3. This fixture is intended to be used only with a power supply (transformer) rated maximum of 300 watts (25 AMPS) at 12 volts ~ 22 volts.
4. Underground Low Energy Cable must not be buried over 6" (15.2 cm) in order to connect to the main low voltage cable.
5. Wiring connections must be made with UL listed wire connectors that is suitable for outdoor use.
6. Position the wire connector so that it is located within 6 inches (15.2 cm) from a building structure, a luminaire, or fitting.

**INSTRUCTIONS PERTAINING TO A RISK OF FIRE, OR INJURY TO PERSONS  
LIGHTED LAMP IS HOT!****WARNING – TO REDUCE THE RISK OF FIRE OR INJURY TO PERSONS.**

1. Turn off/unplug and allow to cool before reducing lamp.
2. Lamp gets HOT quickly!
3. Do not touch the hot lens, guard or cowl.
4. Keep lamp away from materials that may burn.
5. Do not touch lamp at any time.
6. Use a soft cloth.
7. Oil from skin may damage lamp.

**SAVE THESE INSTRUCTIONS**

## PACKAGE CONTENTS

- A. (1) Fixture
- B. (1) Stake
- C. (1) Coupling
- D. (1) G4 Bi-pin Lamp

## PRODUCT DIMENSIONS

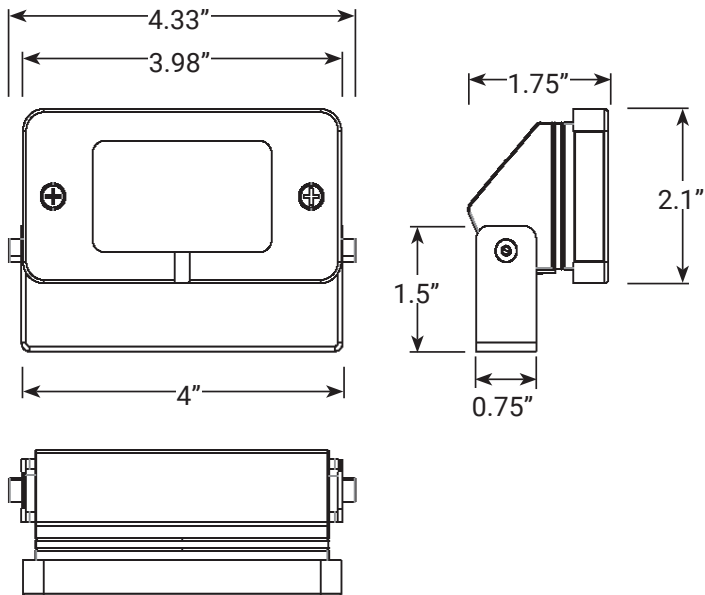

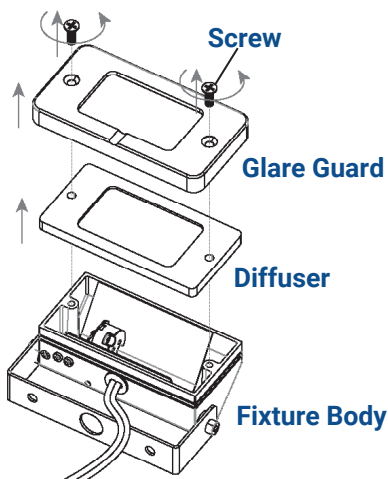
**1 REMOVE GLARE GUARD AND DIFFUSER**

By using a screwdriver, loosen the screws to remove the glare guard and the diffuser from the fixture body.

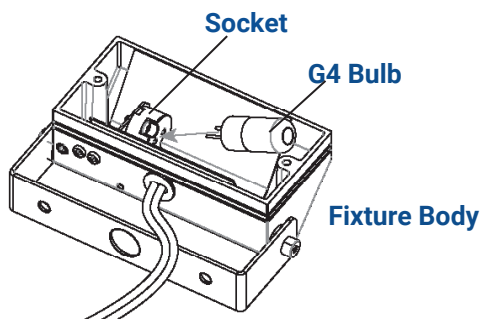
**2 INSTALL G4 BULB**

Insert G4 bulb with correct wattage and type marked on fixture label.

**CAUTION:** Do not exceed maximum wattage marked on luminaire label.

### 3 INSTALL GLARE GUARD AND DIFFUSER

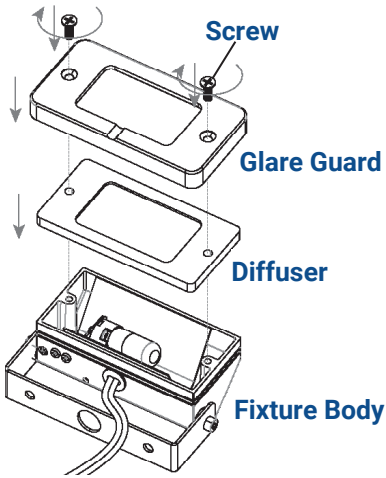

Place the diffuser and the glare guard back onto the fixture body in turn. Secure by using the previously removed screws. Hand tighten until snug with a screwdriver.

### 4 INSTALL STAKE TO FIXTURE BODY

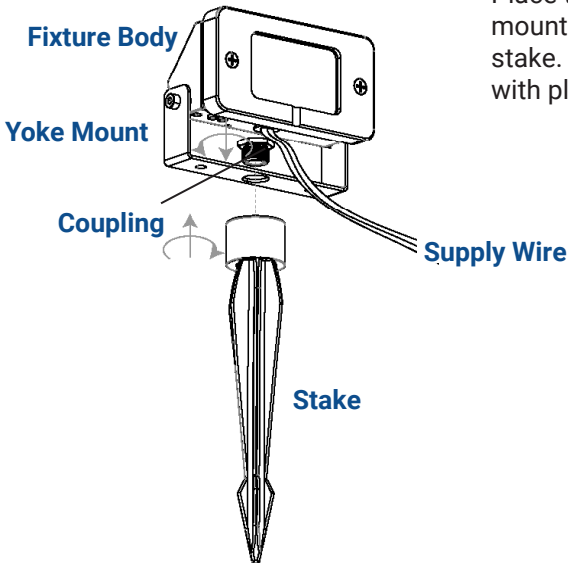

Place the coupling onto the yoke mount and thread it onto the stake. Hand tighten until snug with pliers or wrench.

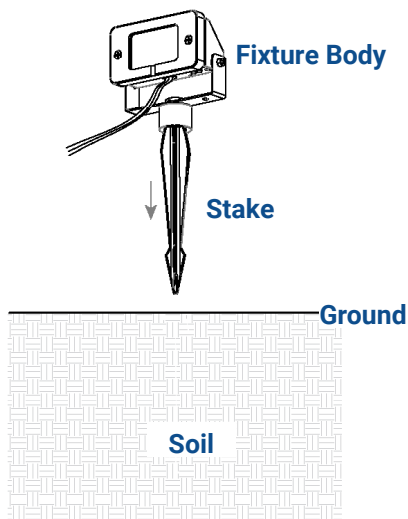
**5 INSTALL STAKE TO GROUND**

Determine the desired location for mounting the stake. Insert the stake into the ground until flange of stake is flush to grade.

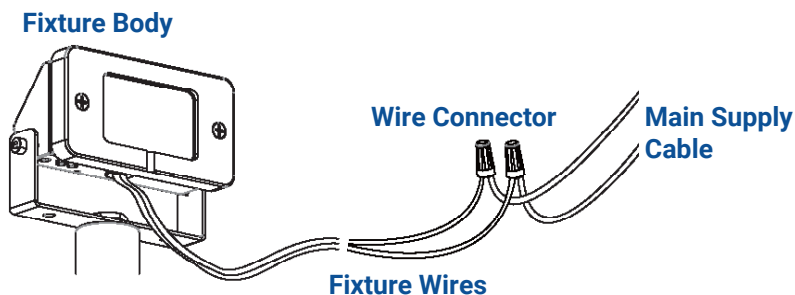
**6 WIRE CONNECTIONS**

Strip both leads from the fixture wires. Using two UL listed wire connectors (sold separately), connect the leads from the fixture wires to the main supply cable leads.

## 7 ADJUST FIXTURE BODY DIRECTION

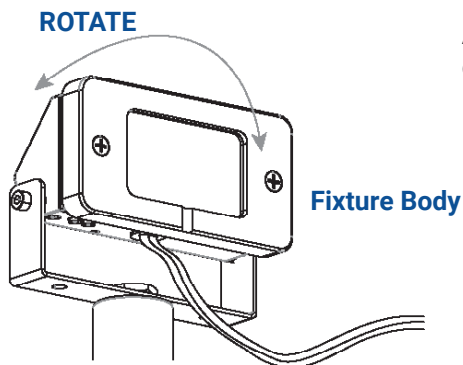

Adjust the fixture body to the desired orientation.

After installation,

- A. Check to make sure the fixture is mounted properly.
- B. Check to make sure the wires are connected properly.

Last, turn on the power and check if the lighting fixture works. If not, turn off the power and contact your local electrician.

## INSTALL/REPLACE G4 BULB

Please reverse Step 1 - Step 3 to expose the G4 bulb and replace it with the correct wattage and type marked on the fixture label. Then, reinstall the diffuser and the glare guard.

**IMPORTANT:** The G4 bulb must be protected from moisture and dust at all times. Always reinstall the diffuser and the glare guard when moved.



1-813-978-3700 • Mon-Fri 8am-8pm • Sat-Sun 10am - 6pm (EST)

Specifications and product details subject to change without notice.  
© Copyright 2023, VOLT® Lighting, Lutz FL USA 33549 • All rights reserved.  
[customersupport@voltlighting.com](mailto:customersupport@voltlighting.com) • [www.voltlighting.com](http://www.voltlighting.com)