

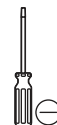

by Hukoro

TOOLS REQUIRED

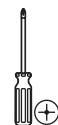

If you need further assistance, please contact us by Email: customersupport@superiordecorinc.com

*** PARTS SHOWN MAY DIFFER SLIGHTLY PER LIGHT FIXTURE**

HARDWARE INCLUDED

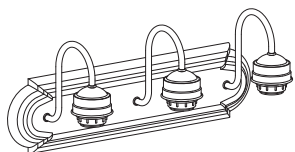

Fixture



Glass shade



Ball Nuts

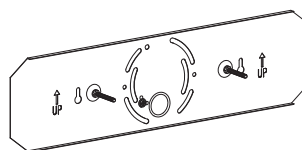

Mounting Unit

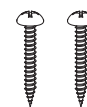

Wood Screws

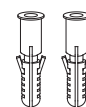

Wall Anchors



Mounting Screws



Wire Nuts

EXPLODED PARTS

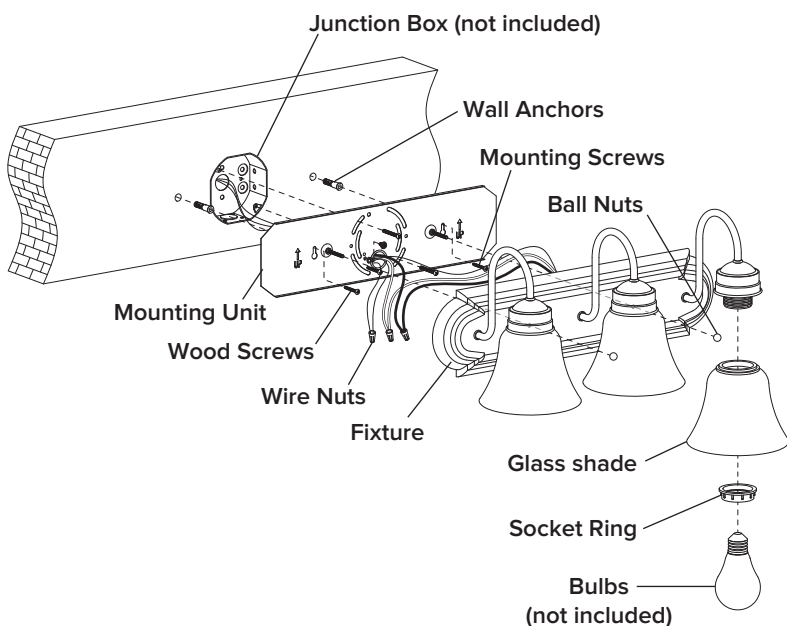

INSTALLATION

STEP 1

Unscrew the **ball nuts** and **green grounding screw** from the **mounting unit**.

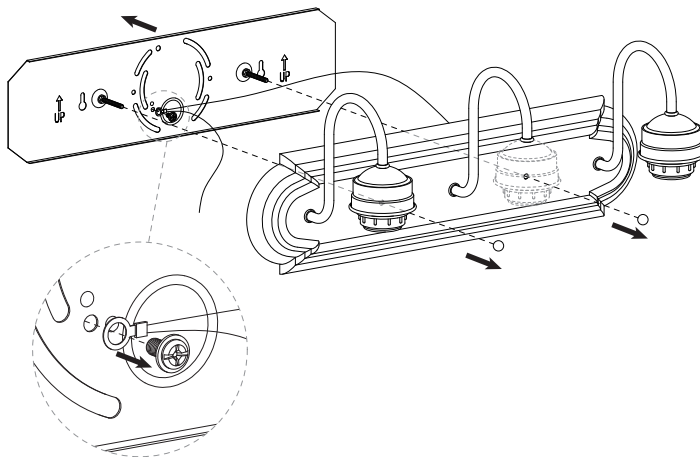

STEP 2

Secure **mounting unit** to wall with **wood screws** and **wall anchors**. Attach the **mounting unit** to the junction box (not included) using the **mounting screws**.

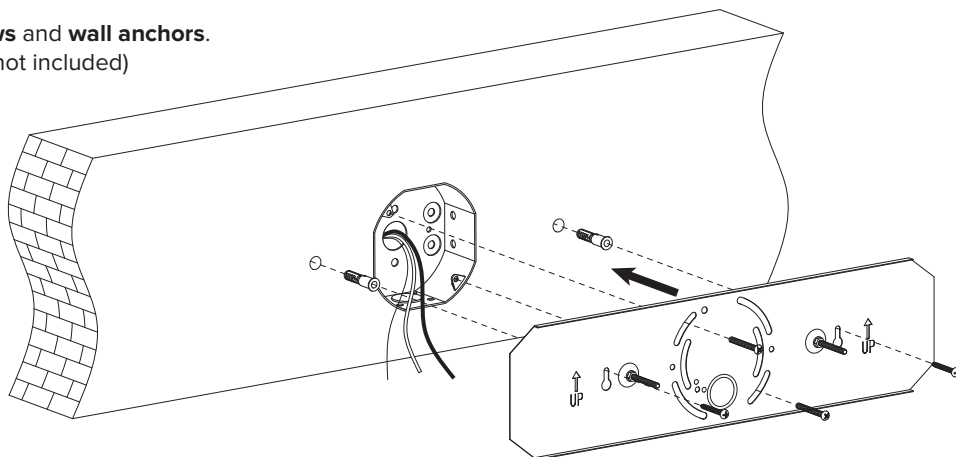

STEP 3

Make the electrical connection from the junction box (not included) to the **fixture**. Connect the ground wire to the **mounting unit** using the preinstalled green ground screw. Next, connect the live wire, neutral wire and ground wires with the supplied **wire nuts**. Secure with electrical tape.

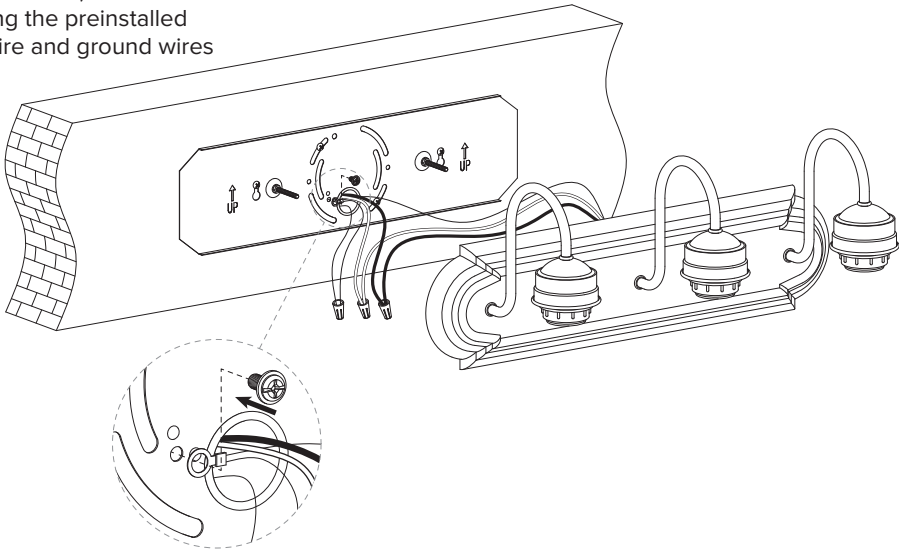
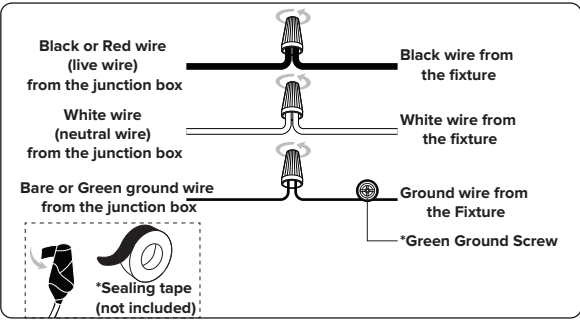

STEP 4

Secure the **fixture** to the **mounting unit** with the **ball nuts**.

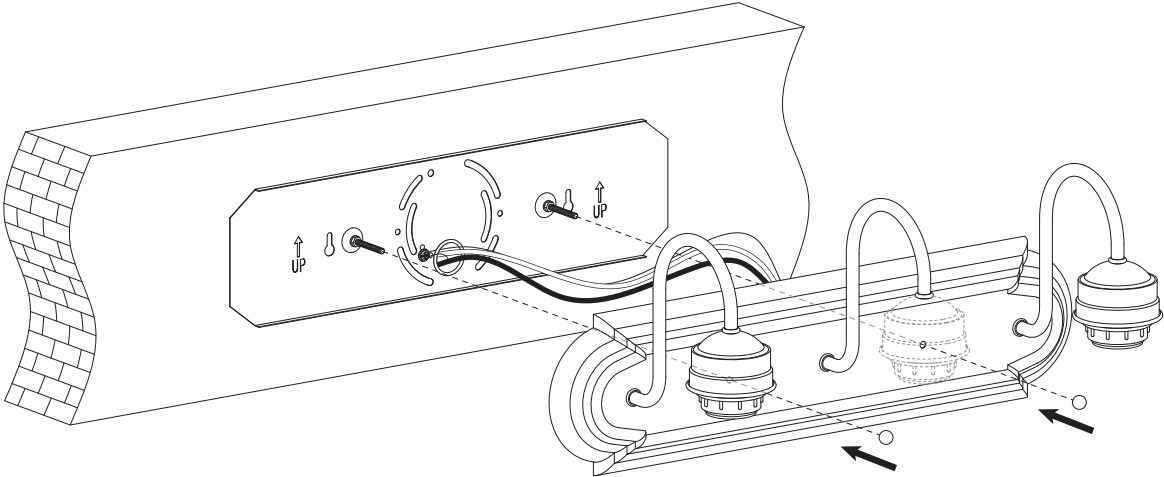

STEP 5

Remove the **socket rings** from the socket. Attach the **glass shade** onto **fixture** using **socket rings**.

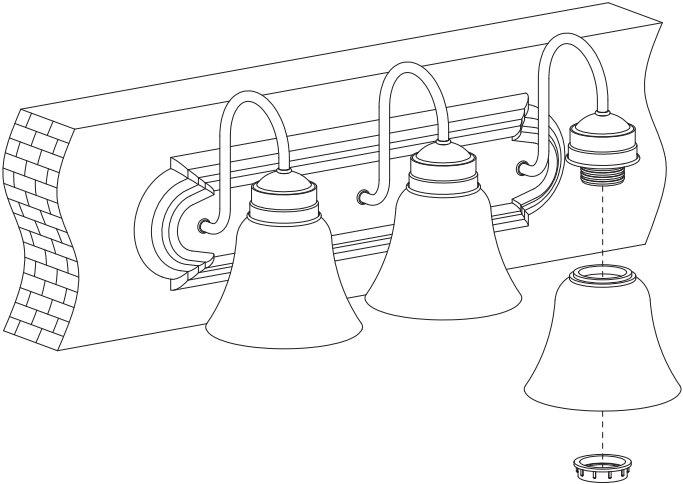

STEP 6

Install bulbs (not included)

